

HQ3 QUICK GUIDE

V1.1

2021.06

Handheld gimbal

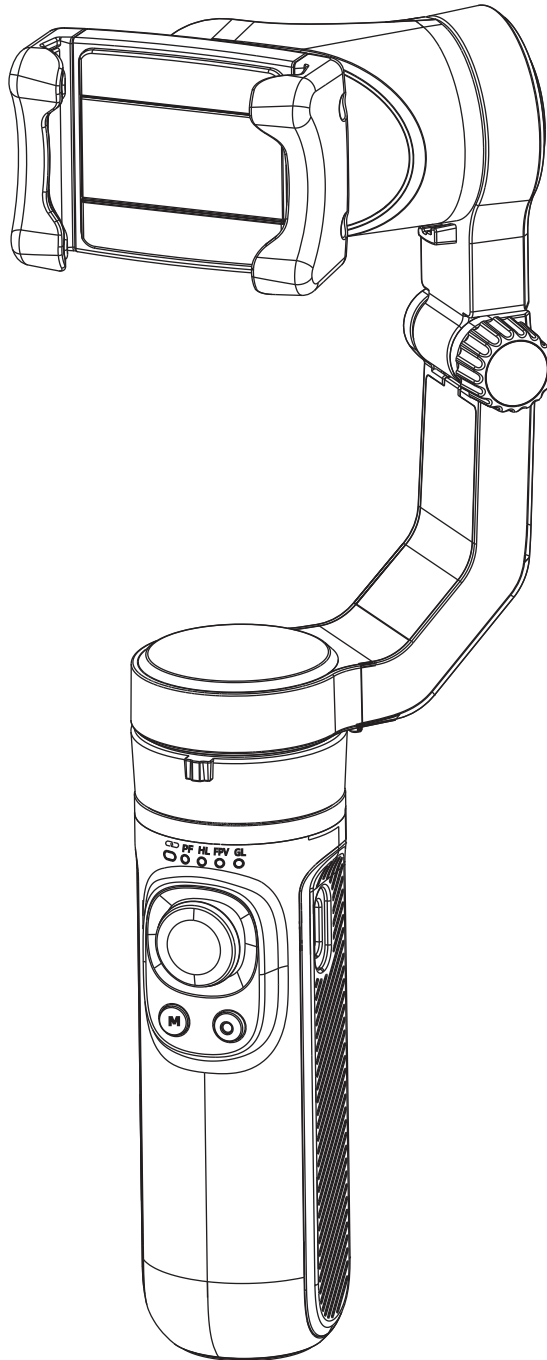

Contents

Product Overview	1
Packing List	1
Get to know HQ3	2
Product Use	3
Battery Charging	3
Before use	3
Mounting of Mobile Phone	4
Power Button	5
Function Operations	6
Function Description of Mode	6
Mode Switch Button	7
Four-directional Joystick operation	8
Trigger Button Operation	9
Manual Lock	9
Indicator Light Status	10
Disclaimer and Warning	11
Product Specifications	12

Product Overview

Hq3 is a hand-held stabilizer specially designed for mobile phone, which enables mobile phones to take stable and smooth pictures. Foldable storage, supporting horizontal and vertical screen of Mobile phone, with perfect functional design and simple operation.

Packing List

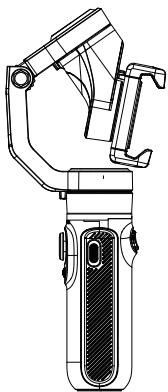

Stabilizer ×1

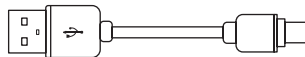

Charging Cable ×1

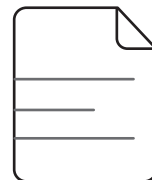

Instructions ×1

Get to know HQ3

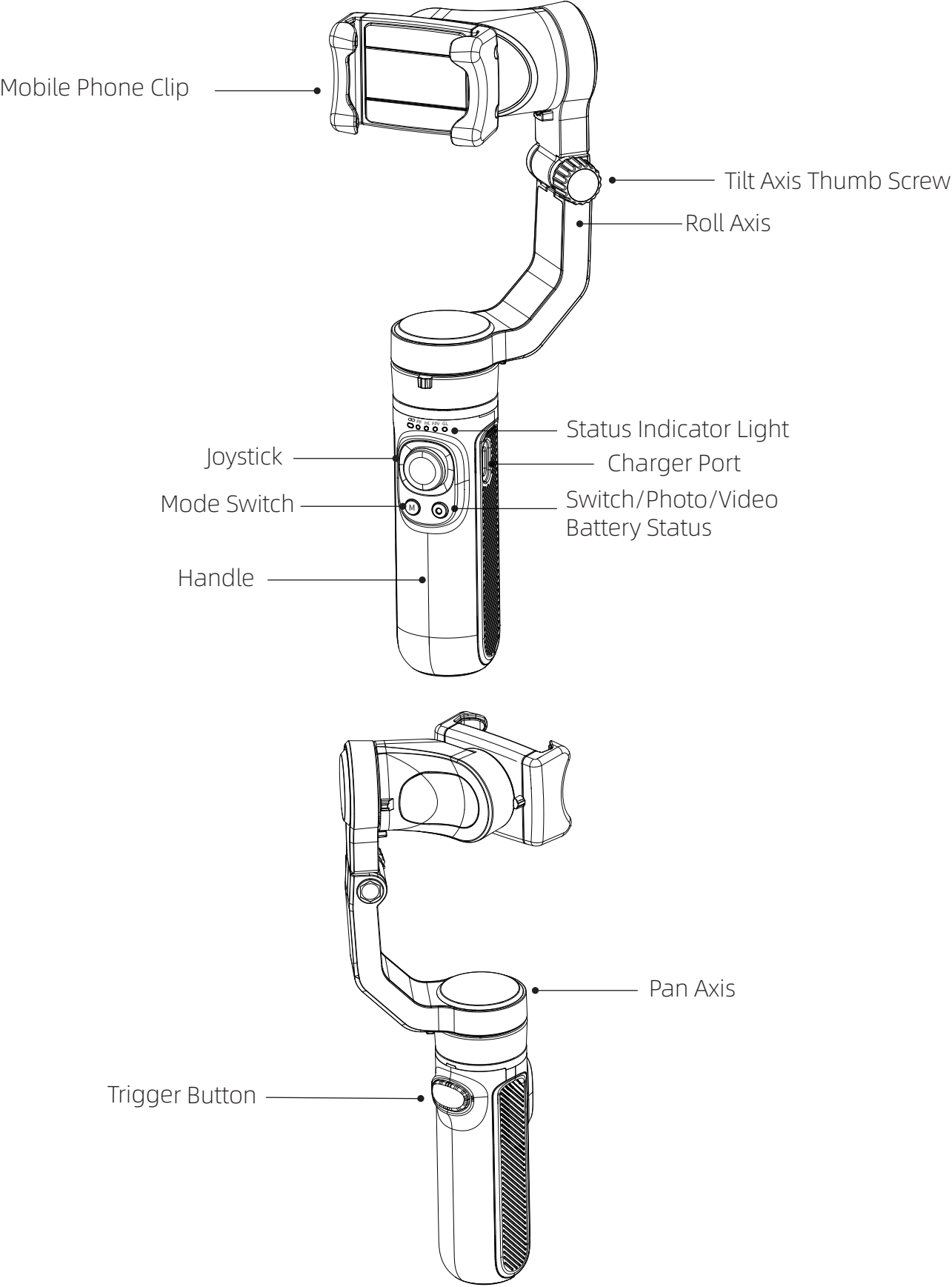

- Mobile Phone is not included in the packing list.

Product Use

Battery Charging

Charging with a Type-C cable. The blue light flashes during charging, while the four lights are constant on when the battery is fully charged.

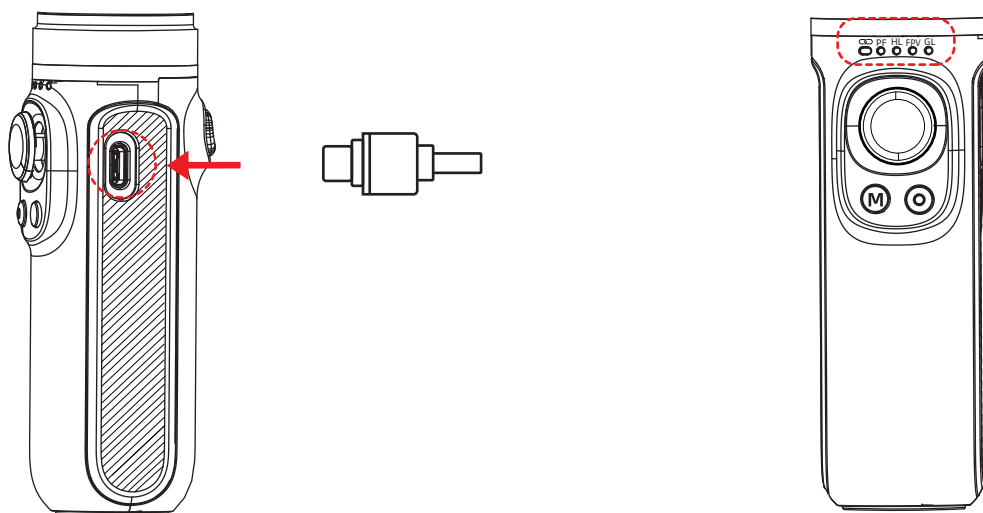

- ⚠ NOTE:
- Make sure to fully charge the stabilizer when using for the first time.
 - Charge the stabilizer immediately if the power is too low and the red-light flashes slowly.
 - Turn off the power if not in use.

Before Use

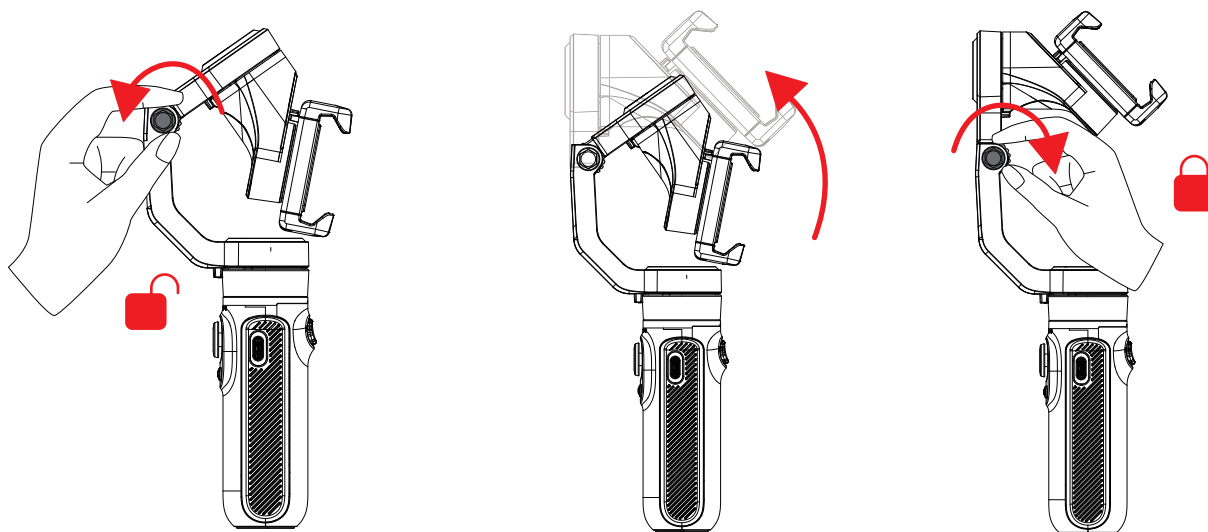

①Loosen the screw on the stabilizer.

②Spread it up.

③Tighten the screw.

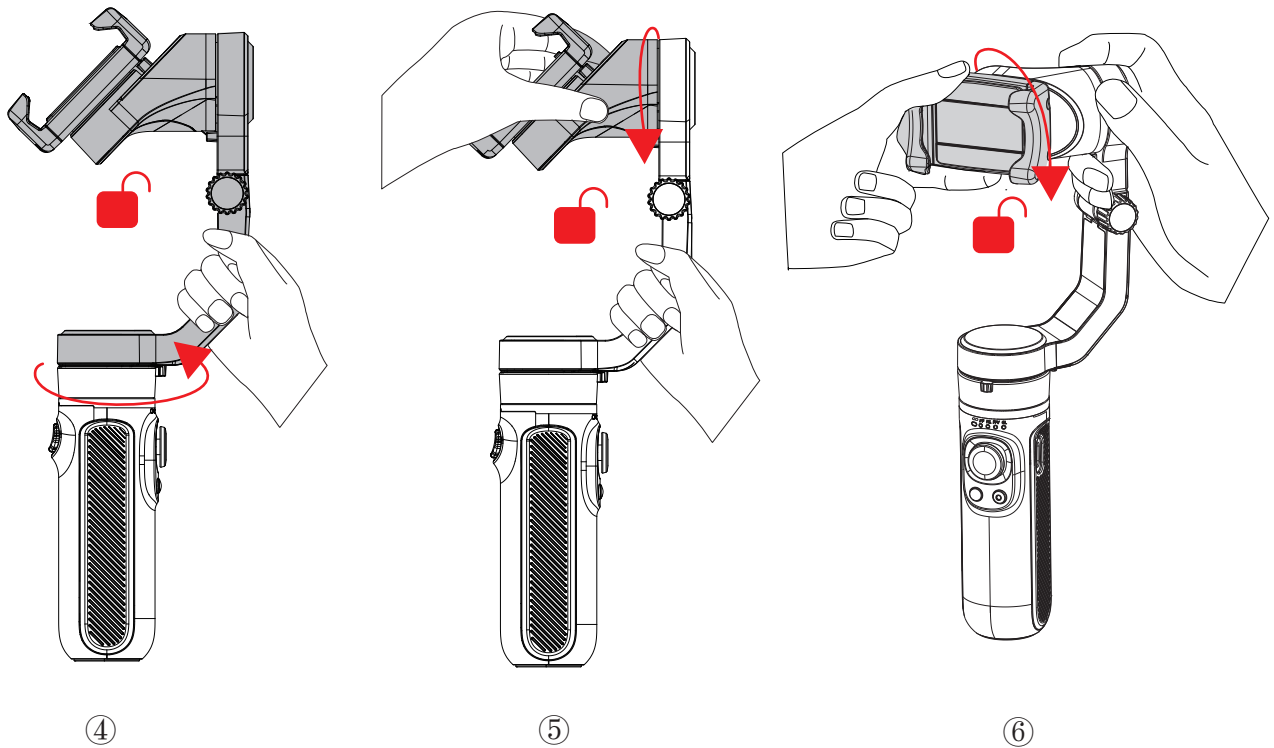

Mounting of Mobile Phone

***It is recommended to remove the protective cover of the Mobile Phone before mounting.**
Pull out the mobile phone clip and place the mobile phone in the center. Mount the mobile phone according to the direction indicated by the arrow.

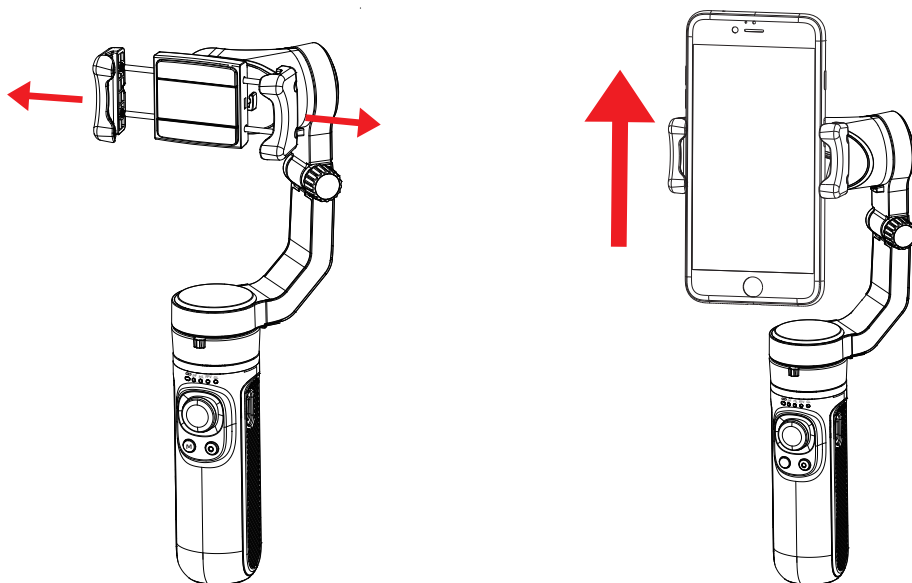

Power Button

- ① Under the condition of power on or off, press the power button for two seconds to turn on or turn off.
- ② Under the condition of power on or off, click the power button to display the power of the stabilizer.
- ③ In the power-on state, single click to photo/record.
- ④ In the power-on state, double-click the power button into standby mode, then click any button to restore the working state of the stabilizer.
- ⑤ In the power-on state, continuously and quickly click eight times to clear the remote-control pairing (too slow will trigger standby).

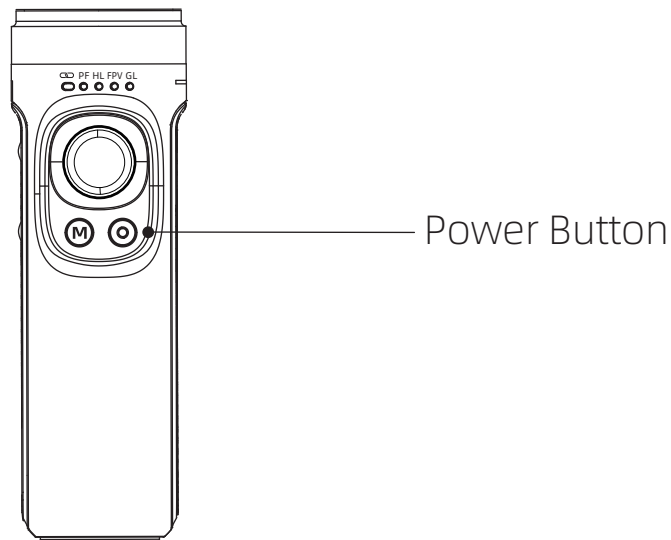

 Tip: Turn on the phone only after it is firmly installed.

Function Operations

Function Description of Mode

① Mode

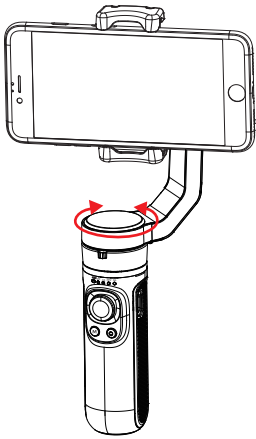

Pan following Mode

Single click mode button

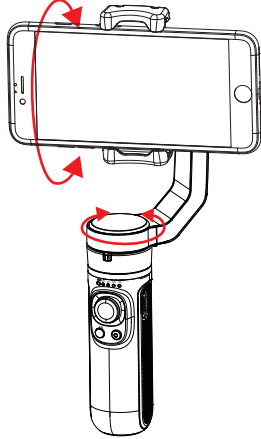

Pan and Tilt Following Mode

Click again mode button

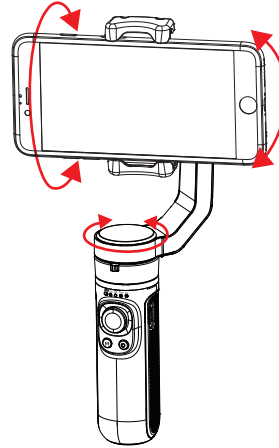

Full Following Mode

Click again mode button

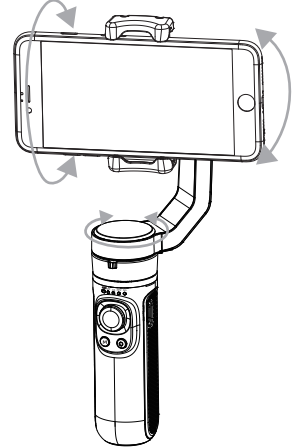

Lock Mode

Press and hold the trigger button

⚠ The red arrow indicates that the motor follows the movement of the handle to change the angle, and the gray arrow indicates that the motor locks the angle and does not follow the movement of the handle.

② Horizontal/Vertical Shooting

Double click the mode button to switch between horizontal and vertical shooting.

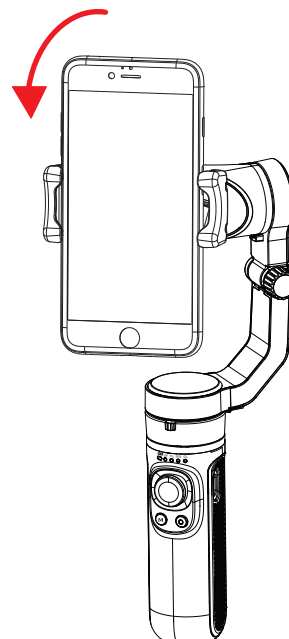
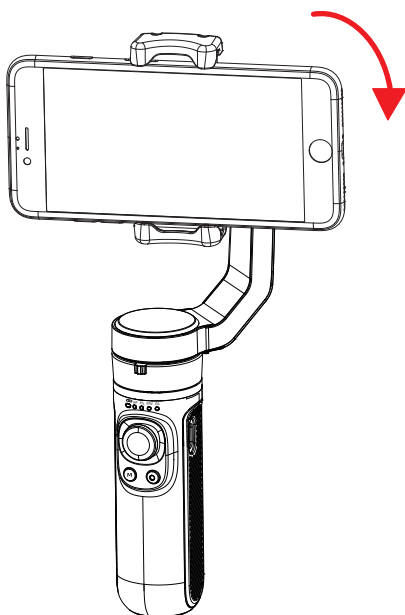

Mode	Description
Pan Following Mode (Default Mode)	The direction of tilt and roll axes remain unchanged, and the lens rotates with the direction of the handle.
Pan and Tilt Following Mode	The roll axis direction remains unchanged, and the lens rotates with the direction of the handle.
Lock Mode	The direction of lens remains unchanged.
Reset	Return to pan following mode, tilt axis, roll axis and pan axis return to initial level.
Pull Lock	Pull the mobile phone to the specified angle of pan and tilt axes for half a second to lock the current angle.
Horizontal/Vertical Shooting	Assist the mobile phone to shoot horizontally or vertically.

Mode Switch Button

1、Description

- ① Single click to switch PF - HL - FPV mode in cycle.
- ② Double click to enter vertical shooting.
- ③ Long press the trigger button to enter GL mode (Lock mode), release to back to the previous mode(GL mode only takes effect in PF or HL mode.)

Four-directional Joystick operation

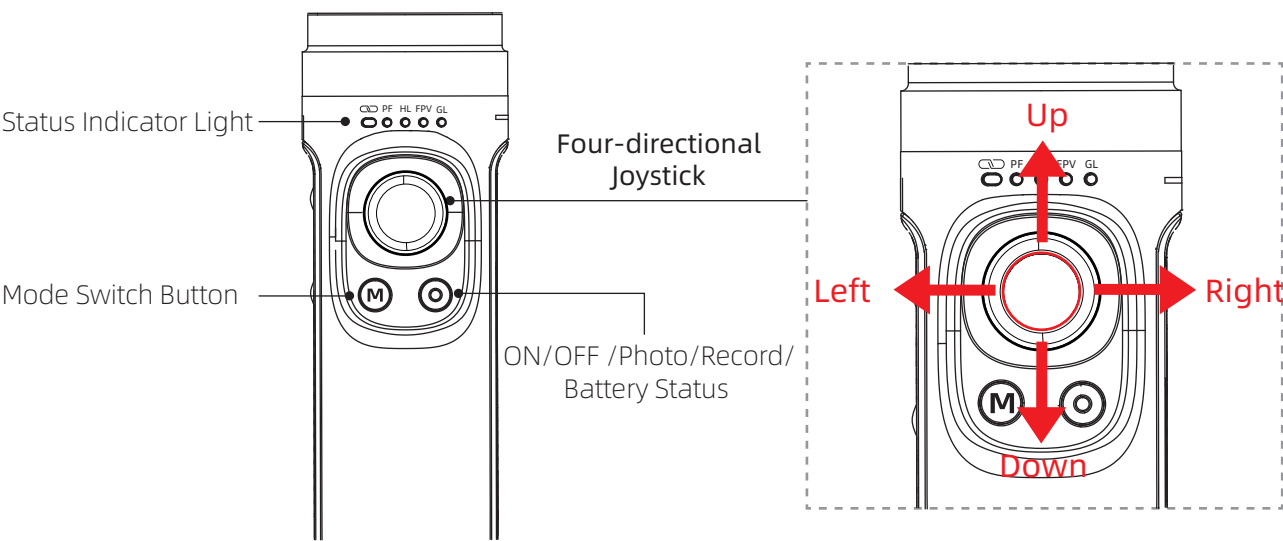

Joystick Operation	Description
Push up/ Push down	Control the tilt axis rotating up and down
Left push / Right push	Control the pan axis rotating left and right

Trigger Button Operation

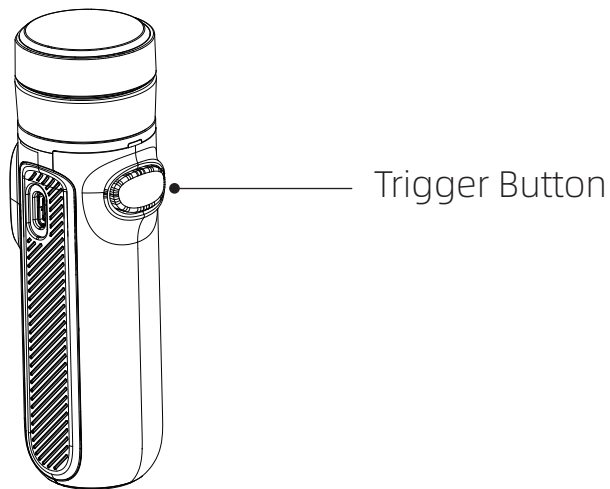

Trigger Button	Description
Hold on	Enter GL mode (Press and release to return to previous mode)
Double click	Reset (Tilt axis and pan axis)
Triple hit	The gimbal follows faster/ slower

Manual Lock

Hold the mobile phone clip by hand, pull it to the specified angle in the tilt direction, and stay for half a second to lock the current angle.

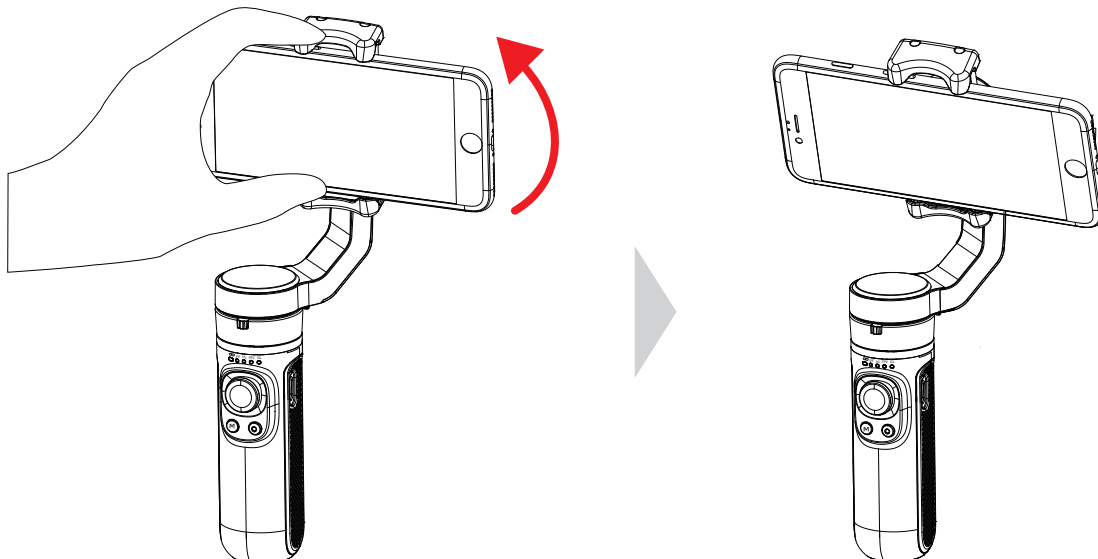

Indicator Light Status

Indicator Light Status	Description
Blue LED Light	Under turn off and standby mode display the current power from the left: 0-25%,25-50%, 50%-75%, 75-100%
	Represent the mode status after boot from left to right: Pan following (PF), Horizontal Lock (HL), Full Following (FPV), Lock Mode (GL).
Green LED Light	Display the Bluetooth connection status. It is always on when Bluetooth is connected, and it is always off when there is no connection. After pairing is cleared, the light flashes slowly during Bluetooth scan. If it is connected, the light is always on, while it will be off if there is no connection.
Red LED Light	Display the current upgrade status. The red-light flashes quickly when upgrading, after upgrading it will be on for three seconds and then turn off. When the power is less than 10%, the red light will flash slowly. If the upgrade fails or cannot be upgraded the red light will always on.

Disclaimer and Warning

Warning

The contents mentioned in this article are related to your safety, legal rights and responsibilities. Please read them carefully and set up and use this product correctly according to the instructions. If you do not follow the instructions and warnings in this article, it may cause harm to you and the people around you and damage the product or the products around you. Any illegal use by any user is prohibited. The user will be responsible for all actions of purchasing and using the product. For this product, the company does not bear all the risks and responsibilities (including direct, indirect, or third-party losses) of the end customers during the debugging and use of this product. Our company will not provide any service for any products obtained from abnormal channels or for unknown purposes.

Disclaimer

- Ensure that the motor rotation is not blocked by external force during and after the stabilizer is on.
- Do not contact the stabilizer with water or other liquids.
- Do not disassemble the whole stabilizer. If it is disassembled carelessly and causes abnormal operation, please send it back for re debugging. All the expenses arising therefrom shall be borne by the customer.
- Long time continuous operation may cause the surface temperature of the motor to rise, please operate with caution.
- It is strictly forbidden to fall or collide. Falling or colliding the stabilizer may damage it and cause abnormal operation. In case of abnormal work caused by falling or collision, please contact the after-sales department in time.

Storage and maintenance

- Please keep this product out of the reach of children and pets.
- It is forbidden to place the product near the heat source (stove or heater, etc.) or in the car in hot weather.
- Please store in a dry environment.
- Do not overcharge or discharge the battery, otherwise it will cause damage to the cell.
- Do not use this product in high or low temperature environment.

Product Specifications

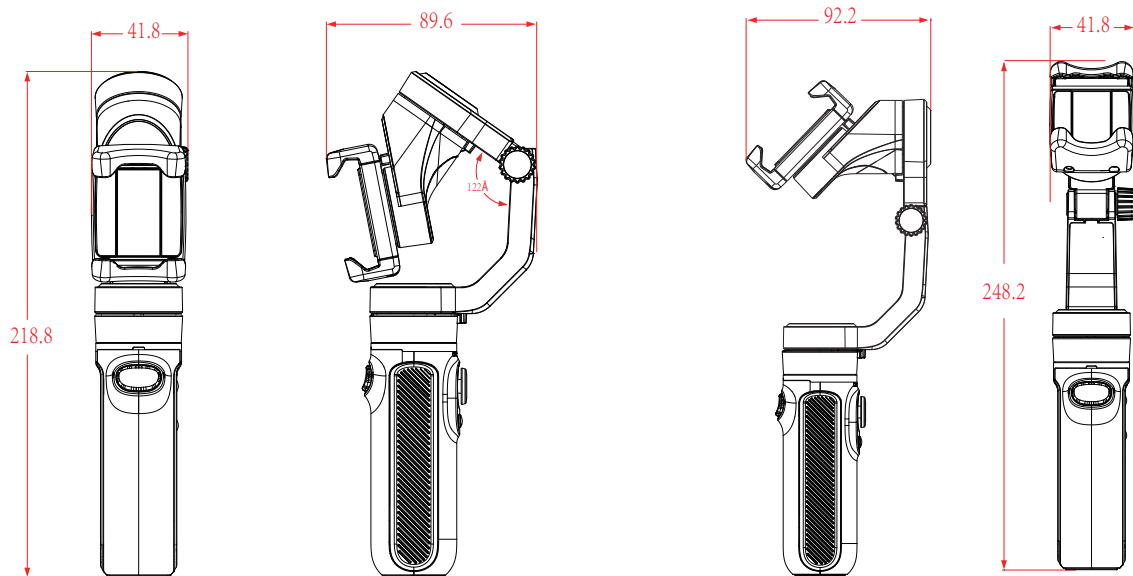

Product Dimensions:	218.8mm×41.8mm×98.6mm (folded) 92.2mm×248.2mm×41.8mm (unfolded)
Name of product:	HQ3 Gimbal Stabilizer for Mobile Phone
Product Material:	Environmental Protection ABS + Glass Fiber
Charging Method:	5V1A
Charging Voltage:	5V
Bluetooth Version:	Bluetooth 5.0
Battery Capacity:	2200mAh
Product Load:	280g
Endurance Time:	Laboratory stationary placement test results are 9 hours.
Product Weight:	295g (battery included)
Name of Bluetooth Device:	HQ3+ Last 4 serial number
Remote Control Distance:	Within 10M

FCC Statement

Changes or modifications not expressly approved by the party responsible for compliance could void the user's authority to operate the equipment.

This equipment has been tested and found to comply with the limits for a Class B digital device, pursuant to Part 15 of the FCC Rules. These limits are designed to provide reasonable protection against harmful interference in a residential installation. This equipment generates uses and can radiate radio frequency energy and, if not installed and used in accordance with the instructions, may cause harmful interference to radio communications. However, there is no guarantee that interference will not occur in a particular installation. If this equipment does cause harmful interference to radio or television reception, which can be determined by turning the equipment off and on, the user is encouraged to try to correct the interference by one or more of the following measures:

- Reorient or relocate the receiving antenna.
- Increase the separation between the equipment and receiver.
- Connect the equipment into an outlet on a circuit different from that to which the receiver is connected.
- Consult the dealer or an experienced radio/TV technician for help

This device complies with part 15 of the FCC rules. Operation is subject to the following two conditions (1) this device may not cause harmful interference, and (2) this device must accept any interference received, including interference that may cause undesired operation.