

# Retekess

## Queue Wireless Calling System User Manual

### T116

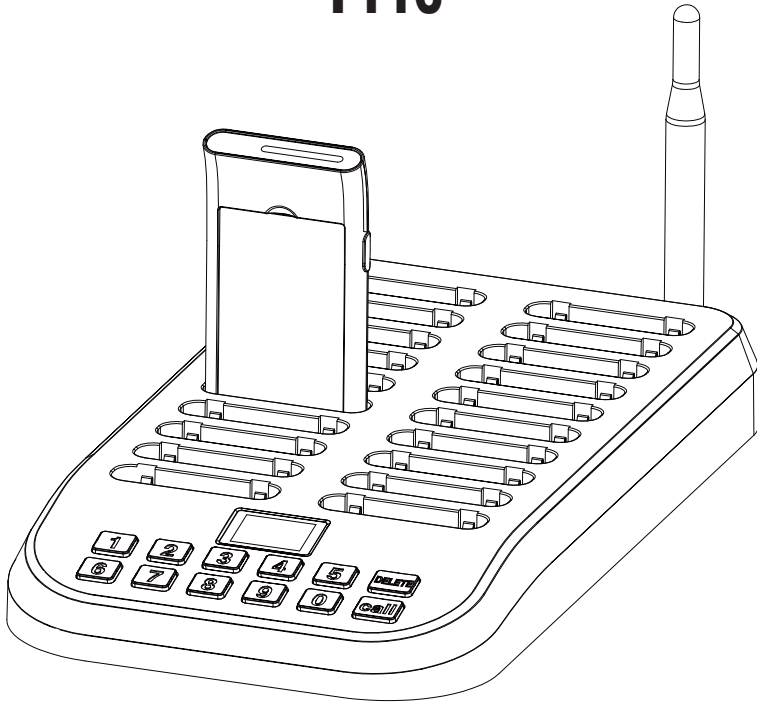

Wireless Calling System

# Retekess T116

## Queue Wireless Calling System User Manual

### Product introduction

Thanks for using our company's wireless calling system, it adopts RF wireless technology with millions of different learning codes. The system consists of 1 call button keypad and 20 portable receivers, the receiving pager supports 999-channel extensions, the call button keypad has 20 battery charging slots. Each receiver is rechargeable and labeled with a number, in standby status, it is plugged into the charging slots, while the guest places an order, he/she will be dispatched one receiver with a number, when the order is ready, the waiter will press the keypad to call the number, the guest will get it through the buzzer/vibration/LED indications.

The queue system greatly improves the work efficiency and avoid the guest waiting in a long queue. It is widely used in fast food restaurant, church, dessert shop, auto 4S shop, food truck or other queue occasions.

### The diagram of the call button keypad

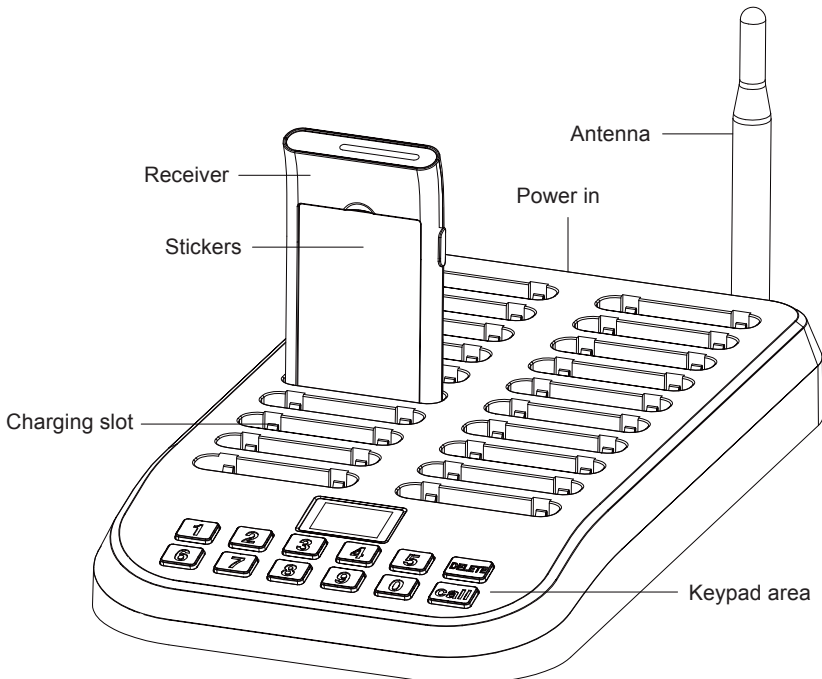

## The diagram of the receiver

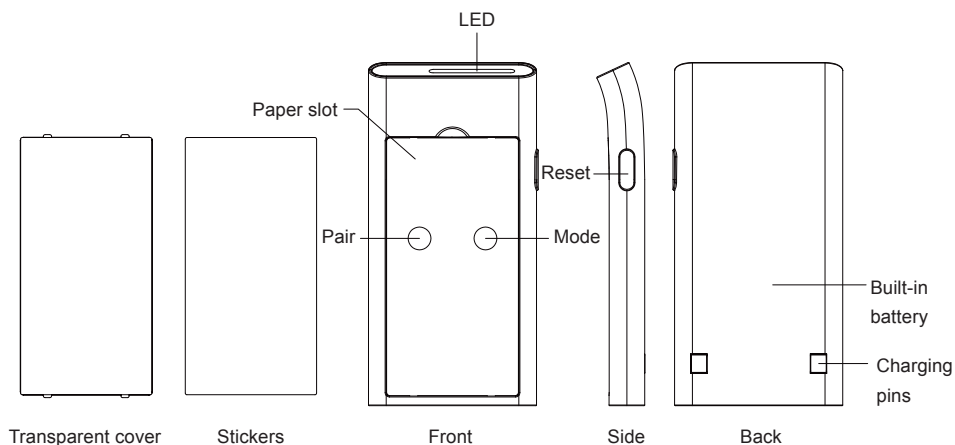

## Technical data

<b>Receiver</b>	
Working voltage	DC 3.7V (Rechargeable battery)
Charging voltage	DC 5V
Working frequency	433.92MHz
Standby current	10±5mA
Working current	100±20mA (Max.)
Receive sensitivity	-107±2dBm
Battery capacity	360mAh
Decoder	Learning code (AM)
Dimmension	104*50*8mm
<b>Keypad call button</b>	
Working voltage	DC 5V/6A
Working frequency	433.92MHz
Standby current	24±5mA
Transmit current	100±30mA
Encoder	Learning code (AM)
Dimmension	280*158*34mm

## Operation instruction

1. Open the package, connect the call button keypad to power, it executes the self-testing procedure, then power icon turns on.
2. When guest places an order, the service people give one receiver to him(her) and note down the number.
3. While the order is ready, the waiter press keypad to call the guest (number), the corresponding receiver gets the information and prompts vibration/buzzer/light for 5 min, remind the guest to complete the order.
4. At last, the guest returns the pager to the waiter and the service is completed.

## Function Description

1. The keypad call button is connected to the power supply through the power adapter, host digital screen display "000", the pager is inserted into the charging slot of the host, the pager is opened and charged, and the red light of the pager indicator is often lit.
2. After the charge of the pager is full, the indicator light is shown to be a green light.
3. After the pager is taken out, the pager enters the waiting call state, indicating that the light blue light flashes once every 3 sec.
4. When the host is called, the pager receives the call information. It flashes every 0.3 sec by vibrant, buzzing and blue lights for reminding.
5. The pager reminding time is 30 sec, can short press the side button of the pager to close the reminder, or insert the host charging slot to close the reminder.
6. The pager in the charging process, when the host call, the light blue light of reception indicator flashes every 0.3 sec for a reminder.
7. When the power of the pager is low, the red light of the indicator is flicker once every 1sec.
8. When the pager is inserted into the host charging slot, press 999 on the keypad call button and then press the call key, the pager in all the charging slots can be turned off.

## Pairing method

1. Pairing - The pager is in standby state, short press the "Set" button, the blue indicator light of the receiving pager is always bright, then press the call number on the keypad, the pager gets the signal and blue lamp turns off and accompanied by buzz and vibration reminding, which represents the success of the code.
2. Deleting - The pager is in standby state, press and holds on the "Set" button for 3 sec, the receiving indicator light goes from blue to extinguish, then release the button, all the paired call buttons will be deleted.

## Reminder mode switching

The receiving pager is in the standby state, short press the mode button on the pager, change the reminder mode. There are four kinds of modes, the default is the vibration, the buzzing, and the LED lights, the other three are Vibration and buzz; Vibration plus light; Beep and lamplight.

Four mode cycle switching, when switching to the corresponding mode, the receiving card shall remind the time 5 sec according to the corresponding reminder mode.

## Change Stickers

Take out the transparent plexiglass cover in the front of the pager, then put a Sticker inside the paper slot, and then put back the cover.

Note: While doing the pairing operation, take out the cover and paper firstly.

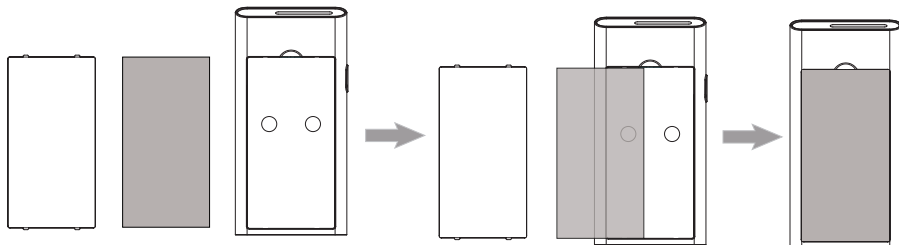

## FAQ

Problems	Reasons	Solutions
While power on, the number display on keypad is not on.	The power adaptor is broken.	Change the power adaptor.
The distance of some pager gets near.	The power of battery is low.	Charge the battery in time.
Pager cannot get any signal from keypad call button.	The pairing is deleted; The number is not correct.	Pair the pager again to the keypad.
Forget the number of pager.		Delete the pairing first, then pair it again.

## Packing List

Name	Quantity
Call button keypad	1 pc
pager	20 pcs
Power adaptor	1 pc
User manual	1 pc
Warranty card	1 pc

## FCC Statement



This equipment has been tested and found to comply with the limits for a Class B digital device, pursuant to Part 15 of the FCC Rules. These limits are designed to provide reasonable protection against harmful interference in a residential installation. This equipment generates uses and can radiate radio frequency energy and, if not installed and used in accordance with the instructions, may cause harmful interference to radio communications. However, there is no guarantee that interference will not occur in a particular installation. If this equipment does cause harmful interference to radio or television reception, which can be determined by turning the equipment off and on, the user is encouraged to try to correct the interference by one or more of the following measures:

- Reorient or relocate the receiving antenna.
- Increase the separation between the equipment and receiver.
- Connect the equipment into an outlet on a circuit different from that to which the receiver is connected.
- Consult the dealer or an experienced radio/TV technician for help.

§ 15.21 Information to user.

Any Changes or modifications not expressly approved by the party responsible for compliance could void the user's authority to operate the equipment.

§ 15.19 Labelling requirements.

This device complies with part 15 of the FCC Rules. Operation is subject to the following two conditions: (1) This device may not cause harmful interference, and (2) this device must accept any interference received, including interference that may cause undesired operation.

## IC Statement



This device complies with Industry Canada's licence-exempt RSSs. Operation is subject to the following two conditions:

- (1) This device may not cause interference; and
- (2) This device must accept any interference, including interference that may cause undesired operation of the device.

Le présent appareil est conforme aux CNR d'Industrie Canada applicables aux appareils radio exempts de licence. L'exploitation est autorisée aux deux conditions suivantes: (1) l'appareil ne doit pas produire de brouillage, et (2) l'utilisateur de l'appareil doit accepter tout brouillage radioélectrique subi, même si le brouillage est susceptible d'en compromettre le fonctionnement.

IC SAR warning:

The information listed above provides the user with information needed to make him or her aware of a RF exposure, and what to do to assure that this radio operates within the RSS exposure limits of this radio.

The device complies with RF specifications when the device used at 5mm from your body. Third-party belt-clips, holsters, and similar accessories used by this device should not contain any metallic components. Body-worn accessories that do not meet these requirements may not comply with RF exposure requirements and should be avoided.

## CE Statement



**WARNING**

- 1.Risk of explosion if battery is replaced by an incorrect type. Dispose of used batteries according to the instructions.
- 2.Adapter shall be installed near the equipment and shall be easily accessible.
- 3.The operating temperature of the EUT can't exceed 40 °C and shouldn't be lower than -10 °C .
- 4.The plug considered as disconnect device of adapter.
- 5.The device complies with RF specifications when the device used at 20cm from your body

Hereby, Henan Eshow Electronic Commerce Co.,Ltd declares that this product is in compliance with essential requirements and other relevant provisions of Directive 2014/53/EU. This product is allowed to be used in all EU member states.

**EU Importer:**

Importer: Germany Retevis Technology GmbH

Address: Uetzenacker 29,38176 wendeburg