



 **Husqvarna**[®]



BLi100C, BLi200C, BLi300C

Contents

Introduction.....	2	Transportation, storage and disposal.....	6
Safety.....	3	Technical data.....	7
Operation.....	4	Federal Communication Commission	
Maintenance.....	5	Interference Statement.....	9
Troubleshooting.....	6	EC Declaration of Conformity.....	10

Introduction

Product overview

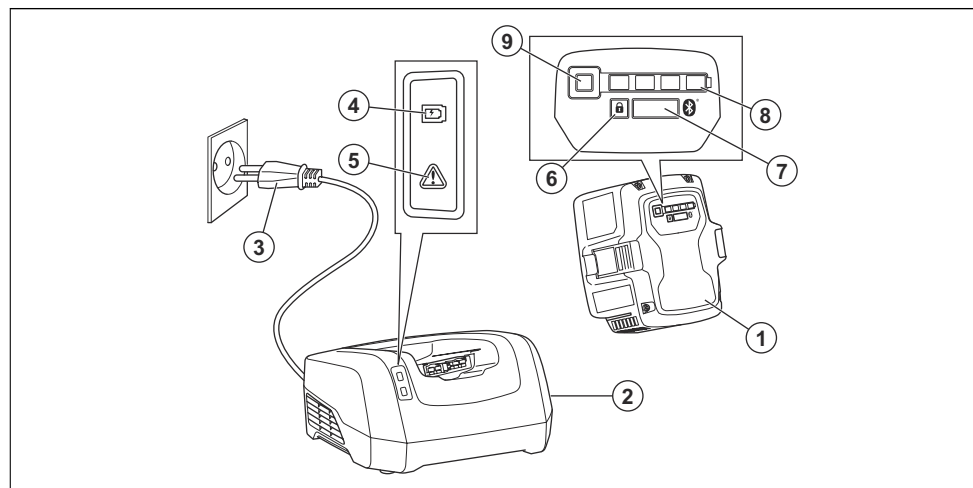

1. Battery
2. Battery charger
3. Plug
4. Charging LED
5. Warning LED
6. Lock LED
7. Connection LED
8. LED indicator for the state of charge
9. Battery indicator button

understand the contents of the operator's manual.



Please read the operator's manual carefully and make sure you understand the instructions before using the product.



Do not submerge the battery in water.

Symbols on the product



WARNING! Incorrect or careless use of a battery can turn it into a dangerous tool that can cause serious or even fatal injury. It is extremely important that you read and



The product features *Bluetooth®* wireless technology.¹

¹ The *Bluetooth®* word mark and logos are registered trademarks owned by the Bluetooth SIG, Inc. and any use of such marks by Husqvarna AB (publ) is under license. Other trademarks and trade names are those of their respective owners.



Symbols on the product or its packaging indicate that this product cannot be handled

as domestic waste. This product must be deposited at an appropriate recycling facility.



The product agrees with the applicable EC directives.

The type plate shows the Husqvarna ID.	Article number	Factory and production line	Production date	Serial number/ Batch ID	Control number
	XXXXXXXXXX	XXX	XXXXXXXXXX	XXXXXX	X

Other symbols/decals on the product refer to special certification requirements for certain markets.

Safety

Safety definitions

Warnings, cautions and notes are used to point out specially important parts of the manual.



WARNING: Used if there is a risk of injury or death for the operator or bystanders if the instructions in the manual are not obeyed.



CAUTION: Used if there is a risk of damage to the product, other materials or the adjacent area if the instructions in the manual are not obeyed.

Note: Used to give more information that is necessary in a given situation.

Battery safety

(1) to (9) refer to *Product overview on page 2*.



WARNING: Read all safety warnings and all instructions. Failure to follow the warnings and instructions may result in electric shock, fire and/or serious injury.

Note: Save all warnings and instructions for future reference.

Only use Husqvarna original batteries for Husqvarna products and only charge them in original QC330 or QC500 battery charger from Husqvarna. The batteries are software encrypted.

The rechargeable BLi100C, BLi200C, BLi300C battery (1), is exclusively used as a power supply for the relevant Husqvarna cordless appliances. To avoid injury, the battery must not be used as a power source for other devices.

- Do not dismantle, open or shred batteries.
- Do not expose cells or batteries to heat or fire. Avoid storage in direct sunlight.
- Regularly check that the battery charger and the battery are intact. Damaged or modified batteries may exhibit unpredictable behaviour resulting in fire, explosion or risk of injury.
- Never use a battery or appliance that is faulty, modified or damaged.
- Never attempt to modify or repair the battery. Entrust all repairs to your authorized dealer only.
- Do not subject batteries to mechanical shock.
- Do not remove a battery from its original packaging until required for use.
- In the event of leaking, do not allow the liquid to come in contact with the skin or eyes. If contact has been made, wash the affected area with copious amounts of water and seek medical advice.
- Keep batteries out of the reach of children.
- Keep battery clean and dry.
- Wipe the battery terminals with a clean dry cloth if they become dirty.
- Batteries need to be charged before use. Always use Husqvarna QC330 or QC500 battery charger.
- Do not leave a battery on prolonged charge when not in use.
- Remove the battery from the equipment when not in use.
- When battery is not in use, keep it away from other metal objects, like paper clips, coins, keys, nails, screws or other small metal objects, that can make a connection from one terminal to another. Shorting the battery terminals together may cause burns or a fire.

Operation

Husqvarna Connect

This battery features *Bluetooth®* wireless technology and is capable of connecting to mobile devices with the Husqvarna Connect App installed. Husqvarna Connect is a free App for your mobile device that allows you to utilize the full potential of your Husqvarna battery and product.

The Husqvarna Connect App will provide additional functions to your Husqvarna battery and product, for instance:

- Lock and unlock function to prevent unauthorized use.
- Enhanced product information display.
- Convenient control of and help with, product parts and servicing needs.

A battery connected to the Husqvarna Connect App

A battery with *Bluetooth®* wireless technology that is connected to the Husqvarna Connect App will provide information about both the battery and the product that uses the battery. The battery will collect and share data from the battery and the product with the Husqvarna Connect App. The battery and the product will collect data if the battery is not connected to the Husqvarna Connect App. The stored data will be available when the battery is connected to the Husqvarna Connect App again.

Note: Availability of the Husqvarna Connect App is limited to selected markets and products. For more information about Husqvarna Connect, please visit www.husqvarna.com or speak to your dealer.

To get started with Husqvarna Connect

1. Download the Husqvarna Connect App at the App Store ² or on Google Play ³.



2. Register an account in the Husqvarna Connect App.
3. Follow the instructions in the Husqvarna Connect App to connect and register the battery.
4. Press the battery indicator button (9) to complete the connection process.

To connect the battery to the Husqvarna Connect App

1. Make sure that the battery is charged.
2. Open the Husqvarna Connect App.
3. Push the battery indicator button (9) to connect the battery to the Husqvarna Connect App.

Battery LED information

The LED lights on the battery give information about the battery and the battery status. The LED lights show the battery status for 5 seconds when you push the battery indicator button (9).

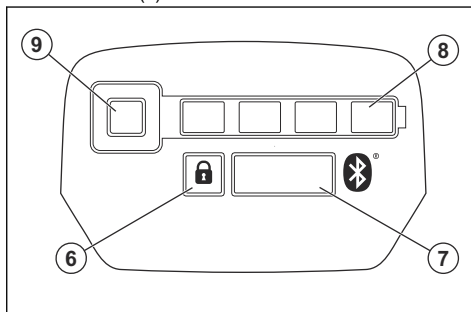

- The LED indicator (8) shows the state of charge.
- The Connection LED (7) shows the connection status of the *Bluetooth®* wireless technology or if an error has occurred.

² Apple and the Apple logo are trademarks of Apple Inc., registered in the U.S. and other countries. App Store is a service mark of Apple Inc., registered in the U.S. and other countries.

³ Google Play and the Google Play logo are trademarks of Google LLC.

- The Lock LED (6) shows if the battery is locked.

Battery LED lights

LED indicator (8)	State of charge
All LEDs are on.	The battery is 75%-100% charged.
3 LEDs are on.	The battery is 50%-75% charged.
2 LEDs are on.	The battery is 25%-50% charged.
1 LED is on.	The battery is 5%-25% charged.
1 LED flashes.	The battery is empty.

Connection LED light (7)	Battery status
Connection LED flashes blue.	The battery identification process starts on a device with <i>Bluetooth®</i> wireless technology.
Connection LED is blue.	The battery is connected to a device with <i>Bluetooth®</i> wireless technology.
Connection LED is off.	The battery is not connected to a device with <i>Bluetooth®</i> wireless technology.
Connection LED flashes red.	Temporary battery error. Refer to <i>Troubleshooting on page 6</i>
Connection LED is red.	Permanent battery error. Refer to <i>Troubleshooting on page 6</i>

LED light with lock symbol (6)	Battery status
The LED with lock symbol is on.	The battery is locked.
The LED with lock symbol is off.	The battery is unlocked.

To charge the battery

Charge the battery before the first time of operation. The battery is only 30% charged when delivered.

1. Put the battery in the battery charger. Make sure that the battery (1) is connected to the battery charger (2).
2. When the battery is connected to the battery charger, the charging LED (4) on the charger is on.

3. The battery is fully charged when all LEDs on the LED indicator (8) are on.
4. Remove the battery from the battery charger.



CAUTION: Use the battery charger only when the surrounding temperature is between 5 °C (41°F) and 40 °C (114°F).

Maintenance

To do maintenance

- Make sure that the battery, battery charger and terminals on the battery are clean and dry before you put the battery in the battery charger.
- Make sure that the battery guide tracks are clean.
- Clean plastic parts with a clean and dry cloth.
- Make sure that the battery and the battery charger are not damaged.

Troubleshooting

Battery

Condition	Possible faults	Possible action
The Connection LED (7) flashes red.	Temperature deviation.	Use the battery in ambient temperatures between -10 °C (14°F) and 40 °C (104°F).
	The battery is empty.	Charge the battery.
	The battery is too hot.	Let the battery cool down.
Connection LED (7) is red.	Permanent battery error.	Speak to your dealer.
A connection to a device with <i>Bluetooth®</i> wireless technology is not found.	The battery disconnects from the device with <i>Bluetooth®</i> wireless technology, if the battery is moved out of range.	Move the battery or the device into range to connect the battery automatically. If the battery does not connect automatically, refer to <i>To connect the battery to the Husqvarna Connect App on page 4</i> to connect manually. If it is not possible to connect manually, re-start the device with the Husqvarna Connect App installed. If the problem stays, speak to your dealer.

Battery charger

Condition	Possible faults	Possible action
The Warning LED (5) flashes.	Permanent battery charger error.	Speak to your dealer.
The Charging LED (4) flashes.	The battery is too hot.	Let the battery cool down. Let the battery charger cool down the battery. The battery charger starts to charge the battery when the battery has the correct temperature.
	Temperature deviation.	Charge the battery in ambient temperatures between 5°C (41°F) and 40°C (104°F).

Transportation, storage and disposal

Transportation and storage

- The supplied Li-ion batteries obey the Dangerous Goods Legislation requirements.
- Obey the special requirement on package and labels for commercial transportations, including by third parties and forwarding agents.
- Speak to a person with special training in dangerous material before you send the product. Obey all applicable national regulations.
- Use tape on open contacts when you put the battery in a package. Put the battery in the package tightly to prevent movement.
- Remove the battery for storage or transportation.
- Put the battery and the battery charger in a space that is dry and free from moisture and frost.
- Do not keep the battery in an area where static electricity can occur. Do not keep the battery in a metal box.
- Put the battery in storage where the temperature is between 5 °C (41 °F) and 25 °C (77 °F) and away from open sunlight.
- Put the battery charger in storage where the temperature is between 5 °C (41 °F) and 45 °C (113 °F) and away from open sunlight.

- Charge the battery 30% to 50% before you put it in storage for long periods.
- Put the battery charger in storage in a space that is closed and dry.
- Keep the battery away from the battery charger during storage. Do not let children and other not approved persons to touch the equipment. Keep the equipment in a space that you can lock.
- Clean the product and do a full servicing before you put the product in storage for a long time.
- Attach the product safely during transportation.

on the environment and people that can otherwise result through the incorrect waste management of this product. For more detailed information about recycling this product, contact your municipality, your domestic waste service or the shop from where you purchased the product.

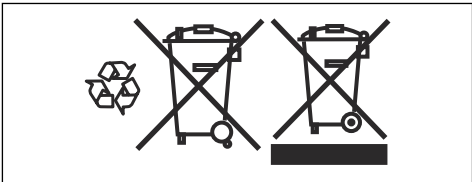

Disposal

Symbols on the product or the packaging of the product indicate that this product cannot be handled as domestic waste. It must be submitted to an appropriate recycling station for the recovery of electrical and electronic equipment.

By ensuring that this product is taken care of correctly, you can help to counteract the potential negative impact

Technical data

Technical data

	BLi100C	BLi200C	BLi300C
Types of battery	Lithium-Ion	Lithium-Ion	Lithium-Ion
Nominal voltage, V	36	36	36
Nominal capacity, Ah	2.6	5.2	9.4
Nominal energy, Wh	94	187	338
Weight, kg/lb	0.8/1.8	1.3/2.9	1.9/4.2
Ambient temperature during operation	-10 °C (14°F) and 40 °C (114°F).		

Radio frequency data

	BLi100C	BLi200C	BLi300C
Frequency range, MHz	2402-2480	2402-2480	2402-2480
Output power, dBm	3.7	3.7	3.7

Approved battery chargers for the product

Battery charger	QC330	QC500
Mains voltage, V	220-240	240

Battery charger	QC330	QC500
Frequency, Hz	50-60	50-60
Power, W	330	500

Federal Communication Commission Interference Statement

Federal Communication Commission Interference Statement

For USA

This device complies with Part 15 of the FCC Rules. Operation is subject to the following two conditions: (1) This device may not cause harmful interference; and (2) This device must accept any interference received, including interference that may cause undesired operation.

This equipment has been tested and found to comply with the limits for a Class B digital device, pursuant to part 15 of the FCC Rules. These limits are designed to provide reasonable protection against harmful interference in a residential installation. This equipment generates, uses and can radiate radio frequency energy and, if not installed and used in accordance with the instructions, may cause harmful interference to radio communications. However, there is no guarantee that interference will not occur in a particular installation. If this equipment does cause harmful interference to radio or television reception, which can be determined by turning the equipment off and on, the user is encouraged to try to correct the interference by one or more of the following measures:

- Reorient or relocate the receiving antenna.
- Increase the separation between the equipment and receiver.
- Connect the equipment into an outlet on a circuit different from that to which the receiver is connected.
- Consult the dealer or an experienced radio/TV technician for help.



CAUTION: Changes/Modifications not approved by the responsible party could void the user's authority to operate the equipment.

Federal Communication Commission Interference Statement

For Canada

This device complies with Industry Canada's licence-exempt RSSs. Operation is subject to the following two conditions:

- This device may not cause interference; and
- This device must accept any interference, including interference that may cause un-desired operation of the device.

This radio transmitter (identify the device by certification number) has been approved by Industry Canada to operate with the antenna types listed below with the maximum permissible gain indicated. Antenna types not included in this list, having a gain greater than the

maximum gain indicated for that type, are strictly prohibited for use with this device.

Approved antenna type	Maximum permissible antenna gain (dBi)
2.4-GHz Inverted F-Antenna (PCB)	+3.3



CAUTION: Changes/Modifications not approved by the responsible party could void the user's authority to operate the equipment.

EC Declaration of Conformity

EC Declaration of conformity

We, Husqvarna AB, SE-561 82 Huskvarna, Sweden, tel: +46-36-146500, declares under sole responsibility that the battery product;

Description	Battery
Brand	Husqvarna
Type / Model	BLi100C, BLi200C, BLi300C

Complies fully with the following EU directives and regulations:

Directive/Regulation	Title
2011/65/EU	RoHS Directive
2014/53/EU	Radio Equipment Directive

The harmonized standards and/or technical specifications are applied as follows:

- ETSI EN 300 328 v.2.1.1
- EN 62311:2008
- EN 62368-1:2014+AC:2015
- Draft ETSI EN 301 489-1 v.2.2.0
- Draft ETSI EN 301 489-17 v.3.1.0
- EN 55032:2015
- EN 55024:2010+A1:2015

The battery is in accordance with the UN-Manual of Tests ST/SG/AC/Revision 5, Criteria Part III, Subsection 38.3.

Huskvarna, 2018-02-01



Lars Roos, Global R&D Director



www.husqvarna.com

Original instructions

1159656-38



2018-09-07