

SMART WIRELESS Grill **THERMOMETER**

USER MANUAL

FOR

WP



Get to know the device

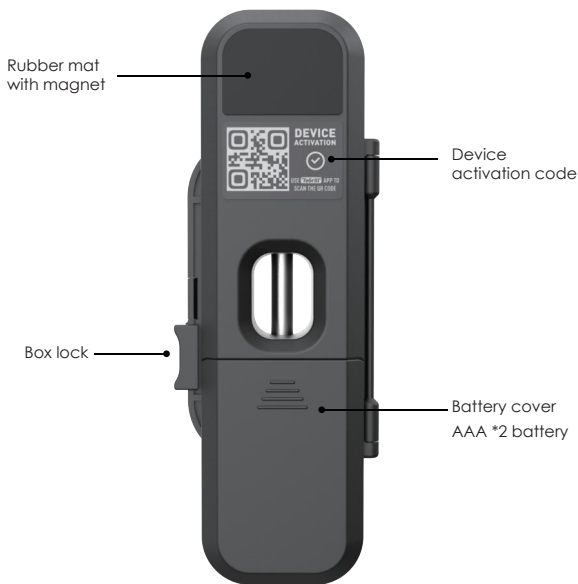

2AAA size batteries are needed for this charging case. Make sure they are put in the right direction on the unit.

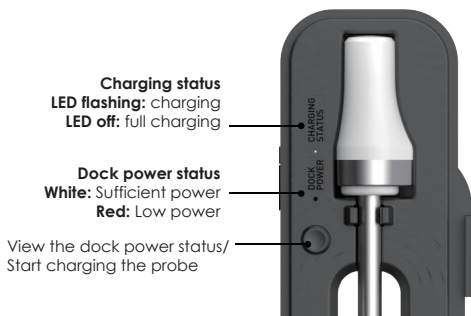

Download the APP

Search the keyword '**ToGrill**' in Appstore or Google Play, or scan the following QR code with your phone. Download and install it for free.

Make sure your phone meets the requirements:

iOS devices running version 11.0 or later.

Android devices running version 5.0 or later with blue-tooth 4.0 module or later.



APP DOWNLOAD

Activate probe and pair with your phone

❶ Switch on your device and keep the blue-tooth switch of your phone on.

- ❷ **Activate device:**
- Launch the '**ToGrill**' app,
 - **Enable mobile phone permissions**
 - Follow the instructions in the app to activate the device

Use ToGrill APP to Scan

Scan the QR Code at back of the charging dock or right.



DEVICE ACTIVATION

❸ **Pairing:** Chose the probe you have on app

❹ Connected successfully.

Once Paired the probe with your phone, you don't need to do it again, unless you change to other phones.

Enjoy your barbecue time

Choose food type and preference for the food where each probe is inserted, the app and the device will display its current and target temperature.

When the food is ready, the app and the device will alarm.

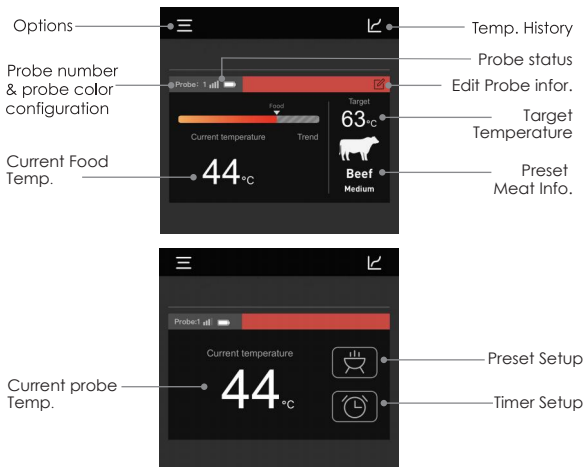

**The user interface of the app may be changed when upgrade.
Please follow the instructions in the app.**

Probe color configuration

It's difficult for you to distinguish different probes when you have several probes in using in the same time.

The app provides 6 colors for each channel, which enables users set them to be identical to the color of the probes. The probes come in 6 colors as well.

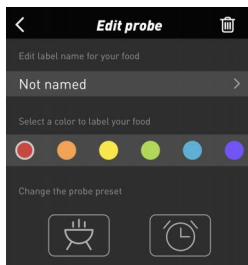

WARNING

The heat resistance varies in different components of the probe,
DO NOT put the probe needle part directly in fire flame.
And probes are NOT dishwasher safe.



Please clean the probe each time you use it to make sure there is no dust and oil on the charging electrode.

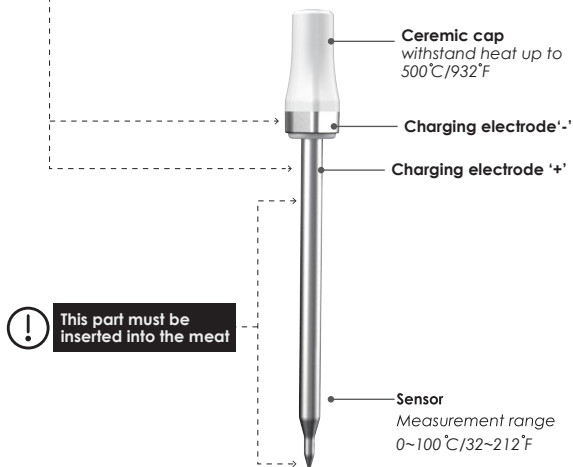

Attention: Temp Probes above for reference only, subject to the actual probes .

Operation is subject to the following two conditions:

(1) This probe may not cause interference; (2) This probe must accept an interference, including interference that may cause undesired operation of this device.

App Store is a service mark of Apple Inc.

Google Play is a service mark of Google Inc:



FCC Caution.

This device complies with part 15 of the FCC Rules. Operation is subject to the following two conditions: (1) This device may not cause harmful interference, and (2) this device must accept any interference received, including interference that may cause undesired operation.

15.21 Information to user.

Any Changes or modifications not expressly approved by the party responsible for compliance could void the user's authority to operate the equipment.

15.105 Information to the user.

Note: This equipment has been tested and found to comply with the limits for a Class B digital device, pursuant to part 15 of the FCC Rules. These limits are designed to provide reasonable protection against harmful interference in a residential installation. This equipment generates uses and can radiate radio frequency energy and, if not installed and used in accordance with the instructions, may cause harmful interference to radio communications. However, there is no guarantee that interference will not occur in a particular installation. If this equipment does cause harmful interference to radio or television reception, which can be determined by turning the equipment off and on, the user is encouraged to try to correct the interference by one or more of the following measures:

- Reorient or relocate the receiving antenna.
- Increase the separation between the equipment and receiver.
- Connect the equipment into an outlet on a circuit different from that to which the receiver is connected.
- Consult the dealer or an experienced radio/TV technician for help.

This equipment complies with FCC radiation exposure limits set forth for an uncontrolled environment. This equipment should be installed and operated with minimum distance 5mm between the radiator & your body.

