

80mm

Soundsystem 105 Häfele

Betrieb & Bedienung / Operation / Fonctionnement et commande

Nehmen Sie sich bitte einen Moment Zeit für diese kurze technische Information.

Please read this manual carefully, especially the safety and security information.

Veuillez consacrer un peu de votre temps à prendre connaissance de cette brève information technique.

VERSION
01.12.2015

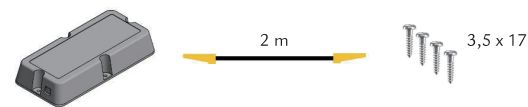

Material für Exciter	Materials for Exciter	Matériau approprié pour Exciter
<input checked="" type="checkbox"/> Glas 3...6 mm	<input checked="" type="checkbox"/> Glass 3...6 mm	<input checked="" type="checkbox"/> Verre 3...6 mm
<input checked="" type="checkbox"/> Plexiglas 3 mm	<input checked="" type="checkbox"/> Acrylic Glass 3 mm	<input checked="" type="checkbox"/> Verre Acrylique 3 mm
<input checked="" type="checkbox"/> Rigips	<input checked="" type="checkbox"/> Plasterboard	<input checked="" type="checkbox"/> Plaque de plâtre
<input checked="" type="checkbox"/> Spanplatte 10...20 mm	<input checked="" type="checkbox"/> Chipboard 10...20 mm	<input checked="" type="checkbox"/> Panneaux de particules 10...20 mm
<input checked="" type="checkbox"/> Cerankochfeld	<input checked="" type="checkbox"/> Ceramic Hob	<input checked="" type="checkbox"/> Plaque de cuisson vitrocéramique
<input checked="" type="checkbox"/> Granitarbeitsplatte	<input checked="" type="checkbox"/> Granite Slab	<input checked="" type="checkbox"/> Comptoir de granit
<input checked="" type="checkbox"/> Acrylbadewanne	<input checked="" type="checkbox"/> Acrylic Bath tub	<input checked="" type="checkbox"/> Baignoire en acrylique
<input checked="" type="checkbox"/> Spiegel	<input checked="" type="checkbox"/> Mirror	<input checked="" type="checkbox"/> Miroir
<input checked="" type="checkbox"/> Möbel (z.B. Sideboard)	<input checked="" type="checkbox"/> Furniture (e.g. Sideboard)	<input checked="" type="checkbox"/> Meubles (par exemple, Buffet)
<input checked="" type="checkbox"/> Blechschrank	<input checked="" type="checkbox"/> Sheet Metal Cabinet	<input checked="" type="checkbox"/> Fiche armoire métallique

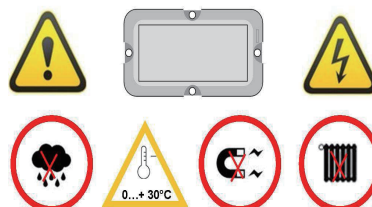
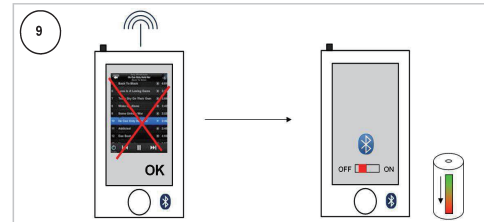
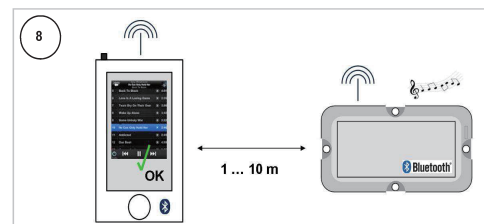
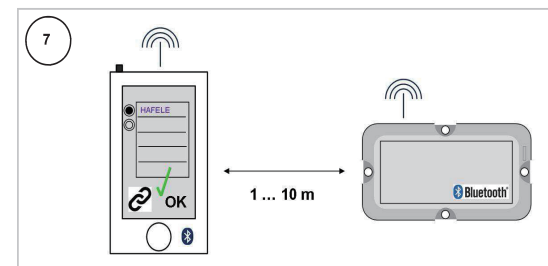
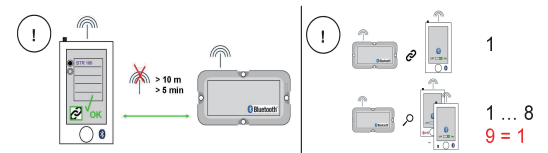
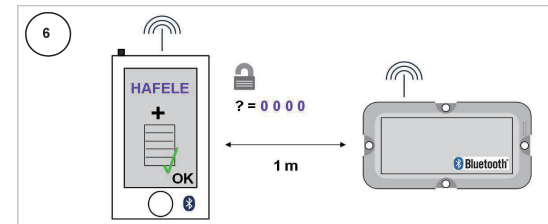
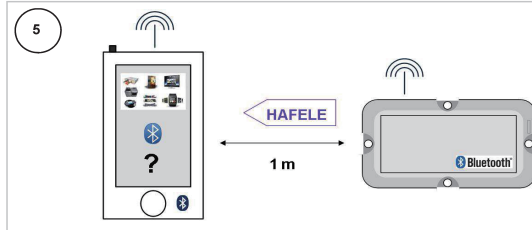
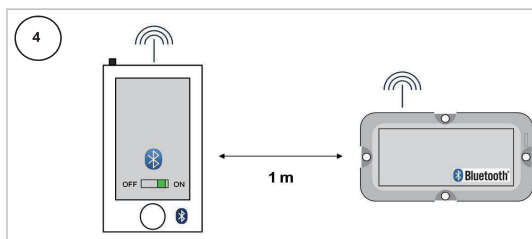
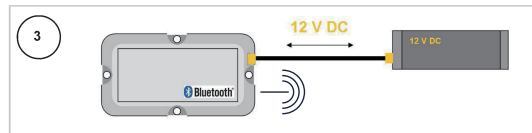
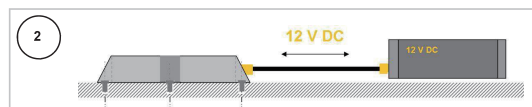
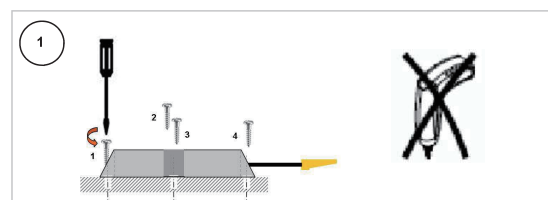

This device complies with part 15 of the FCC Rules. Operation is subject to the following two conditions:
(1) This device may not cause harmful interference, and
(2) this device must accept any interference received, including interference that may cause undesired operation.



Häfele GmbH & Co KG - Adolf-Häfele-Str. 1 - D-72202 Nagold
+49 (0)74 52 / 95 - 0 +49 (0)74 52 / 95 - 2 00
info@haefele.de www.haefele.de



This equipment has been tested and found to comply with the limits for a Class B digital device, pursuant to part 15 of the FCC Rules. These limits are designed to provide reasonable protection against harmful interference in a residential installation. This equipment generates, uses and can radiate radio frequency energy and, if not installed and used in accordance with the instructions, may cause harmful interference to radio communications. However, there is no guarantee that interference will not occur in a particular installation. If this equipment does cause harmful interference to radio or television reception, which can be determined by turning the equipment off and on, the user is encouraged to try to correct the interference by one or more of the following measures:

- o Reorient or relocate the receiving antenna.
- o Increase the separation between the equipment and receiver.
- o Connect the equipment into an outlet on a circuit different from that to which the receiver is connected.
- o Consult the dealer or an experienced radio/TV technician for help.

Caution: Any changes or modifications to this device not explicitly approved by manufacturer could void your authority to operate this equipment.

The device has been evaluated to meet general RF exposure requirement. The device can be used in portable exposure condition without restriction.