

HB235B Bluetooth Keyboard

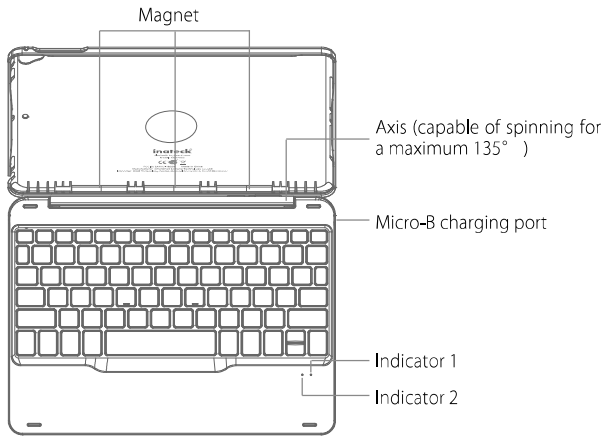

English

Product Overview



Status of Indicator 1	Meaning
Green light lit for 3s then go off	HB235B powers on
Red light flashes	Low battery, requires charging
Red light lit	Charging, turns green when battery is full
Green light lit	Full battery

Status of Indicator 2	Meaning
Green light lit	Upper case locked
Blue light flashes	Under Bluetooth pairing mode, waiting for pairing, light goes off when paired successfully

Note: Please refer to the installation and dismantling instruction manual to learn how to install and dismount an iPad. Or you can click the below link to see the detailed illustration of installation and dismantling.

How to power on/power off the HB235B

Powering on: Flip open the iPad protective case. The power indicator will lit green and go off in 3 seconds. The keyboard turns on automatically. (keyboard powers on through auto-induction)

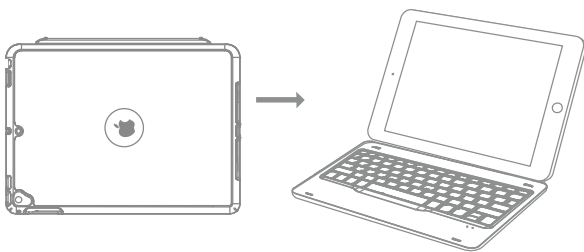

Powering off: Close the case with keyboard. Keyboard powers off automatically.

How to pair an iPad

Step 1: Install iPad and Power on the keyboard

Step 2: Press fn + delete keys simultaneously. Indicator 2 will flash blue, which means the keyboard is under Bluetooth pairing mode.

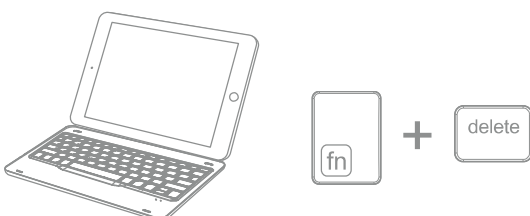

Step 3: On the iPad, select Settings- Bluetooth-On.

Step 4: The iPad will display "HB235" as an available device.

Step 5: Select "HB235B" on the iPad.

Step 6: Indicator 2 goes off, which means the keyboard has been paired with iPad successfully.

Note:

- After you successfully pairing the keyboard for the first time, the HB235B would reconnect your iPad automatically in 3 seconds next time you flip open it, saving your trouble in manual reconnection.
- If you need to frequently detach your iPad from the keyboard case, you may turn off Bluetooth on your iPad accidentally. And the next time, your iPad won't reconnect HB235B automatically. To reconnect, please follow the below steps.
 - Delete all Bluetooth pairing record related to KHB235B on your iPad
 - Turn off Bluetooth on iPad
 - Follow '**How to pair an iPad**' to connect.
- If iPad reminds: Connection Unsuccessful, Make sure 'HB235' is turned on and in range. Please follow the below steps to reconnect.
 - Delete all Bluetooth pairing record related to HB235B on your iPad
 - Turn off Bluetooth on iPad
 - Follow '**How to pair an iPad**' to connect.
- How to restore factory for HB235B
Press fn + shift (left) + backspace three keys simultaneously.

If the above steps don't help, please reach us through email We'll come to your help timely.

Keyboard backlight Guide

- Press + to adjust brightness
- Press + to change the backlight colors(there are 7 backlight colors)
- When the battery is below 20%, backlight turns off automatically.
- The backlight only works when the keyboard is paired with your iPad.

Functions Keys

Note: if you want to use Caps Lock Key in normal to switch the case of alpha Characters, please follow the steps to change the iPad settings:

Find General-Keyboard-Hardware Keyboard: TURN OFF Caps Lock and Switch to/from Latin

	Home		Decrease		Increase
	Siri		Screenshots		Search
	Virtual keyboard		Switch language		Previous track
	Play / Pause		Next track		Mute
	Volume down		Volume up		Lock
	Copy		Paste		Select all
	Cut		Search		Switch language
	Switch APP				

Note: press and hold the cmd key to see shortcuts in any app that supports them.



Times green light flashes	Remaining battery of keyboard
Once	0-25%
Twice	25%-50%
3 times	50%-75%
4 times	75%-100%

Charging

When the battery is low, indicator will flashes red. If there is no light displayed at all, the battery is completely drained. For both situations, it is time to charge the keyboard.

The required voltage for charging is 5V, and current under 250mA. A current control chip is set inside the keyboard for overcurrent protection- filtering out excessive current to ensure a 250mA charging, which guarantees normal use as long as the charging voltage is 5V. You can charge it via an ordinary phone charger or USB port on a computer that regularly output voltage at 5V.

The keyboard will be fully charged in approximately 2-3 hours. Indicator will lit red during charging. The battery indicator will turn green when the keyboard is fully charged.

Note: You can use the keyboard while charging.

Sleeping mode

The keyboard will sleep automatically when not in use for 30 minutes and wake up by pressing any button. Under sleep mode, Bluetooth will disconnect automatically, and you can reconnect by pressing a random key to restore normal use.

Product Specifications

Bluetooth version	Bluetooth V3.0
Effective range	10 meters
Modulation	GFSK
Working voltage	3.0-4.2V
Charging time	2-3h
Continuously working time with backlight	About 5h
Continuously working time without backlight	About 180h
Working temperature	-10° - +55°
Bluetooth Operating Frequency	2402-2480MHZ
Bluetooth transmission power	0dBm
Key press force	60 ± 10g
Battery capacity	500mAh
Compatible iPad model	iPad air 1 / iPad 5(2017) / iPad 6(2018)

FAQs

1) When iPad reminds: Connection Unsuccessful Make sure 'HB235B' is turned on and in range, please follow the below steps to reconnect.

Answer: The problem is with Bluetooth on your iPad. All you need to do is follow the steps:

- Delete all Bluetooth pairing record related to HB235B on your iPad;
- Turn off Bluetooth on iPad;
- Follow '**How to pair an iPad**' to reconnect.

2) How to restore factory for HB235B

Press fn + shift (left) + backspace three keys simultaneously.

FCC Statement

This equipment has been tested and found to comply with the limits for a Class B digital device, pursuant to Part 15 of the FCC Rules. These limits are designed to provide reasonable protection against harmful interference in a residential installation. This equipment generates uses and can radiate radio frequency energy and, if not installed and used in accordance with the instructions, may cause harmful interference to radio communications. However, there is no guarantee that interference will not occur in a particular installation.

If this equipment does cause harmful interference to radio or television reception, which can be determined by turning the equipment off and on, the user is encouraged to try to correct the interference by one or more of the following measures:

- Reorient or relocate the receiving antenna.
- Increase the separation between the equipment and receiver.
- Connect the equipment into an outlet on a circuit different from that to which the receiver is connected.
- Consult the dealer or an experienced radio/TV technician for help.

Changes or modifications not expressly approved by the party responsible for compliance could void the user's authority to operate the equipment.