

尺寸：105 * 148 mm 材质：105G双铜纸,单面印刷,风琴折页

PANTONE 4291 C

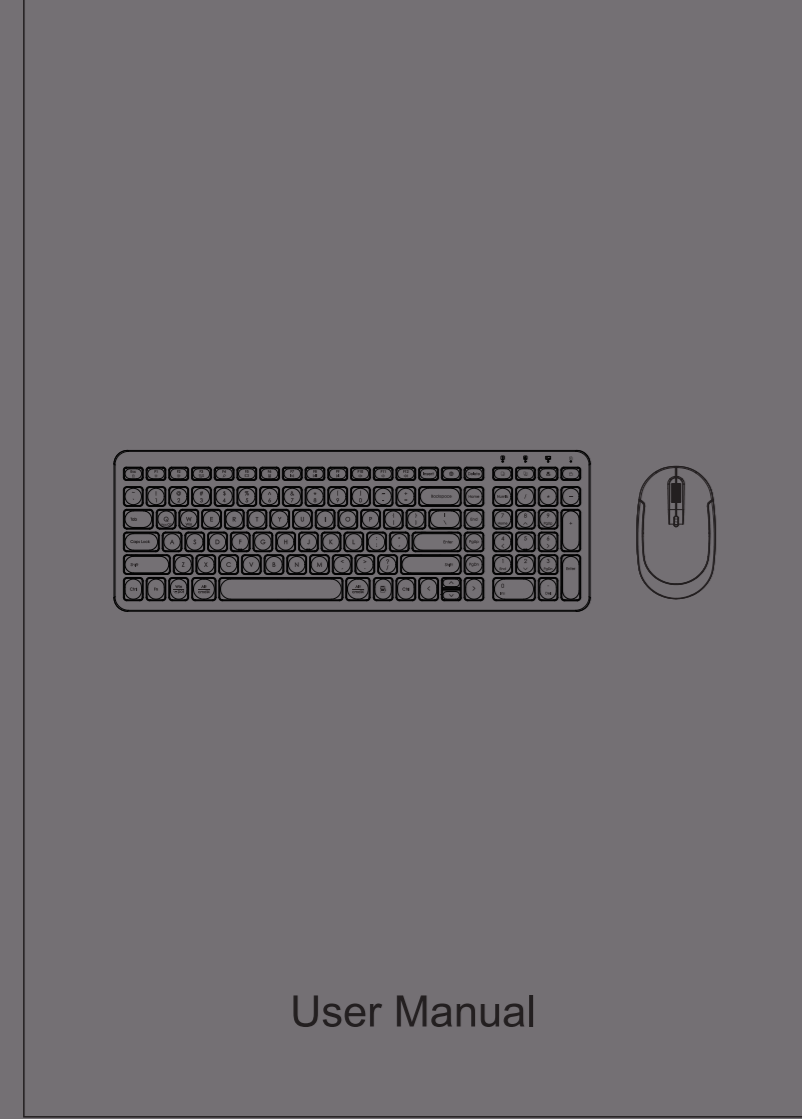

Thank you very much for purchasing this product. Please read the manual carefully before use to confirm that the product can be used normally.

Package Contents

- 1* Keyboard
- 1* Mouse
- 1* USB Receiver
- 1* User manual
- 1* Hairbrush

Specification of Keyboard

Applicable system	WIN 7(and above) system, MAC OS
Battery specifications	Dry cell 2*AAA
Standby time	600 hours
Button life	3 million tap tests
Working current	≤ 3 mA
Continuous working time	Depends on the battery used
Product size	400*135.1*32.2mm
Effective transmission distance	Within 10 meters
Sleep time (Bluetooth mode)	Automatic sleep after 15 minutes without operation
Wake-up method	Press any key to wake up

Specification of Mouse

DPI	800、1200 (Default) 、1600
Battery specifications	Dry cell 2*AAA
Key life	3 Million strokes Tset
Effective transmission distance	Within 10 meters
Work current	≤ 12mA
Product dimension	107.2*60*25.7mm
Sleep time	Sleeps for 15 minutes after no operation
Wake up way	Press any key

Product Layout

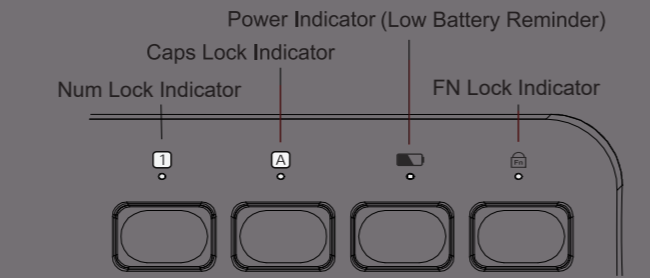

After 3 seconds of inactivity on the keyboard, the indicator light will automatically turn off. When any key is pressed, the indicator light will light up.

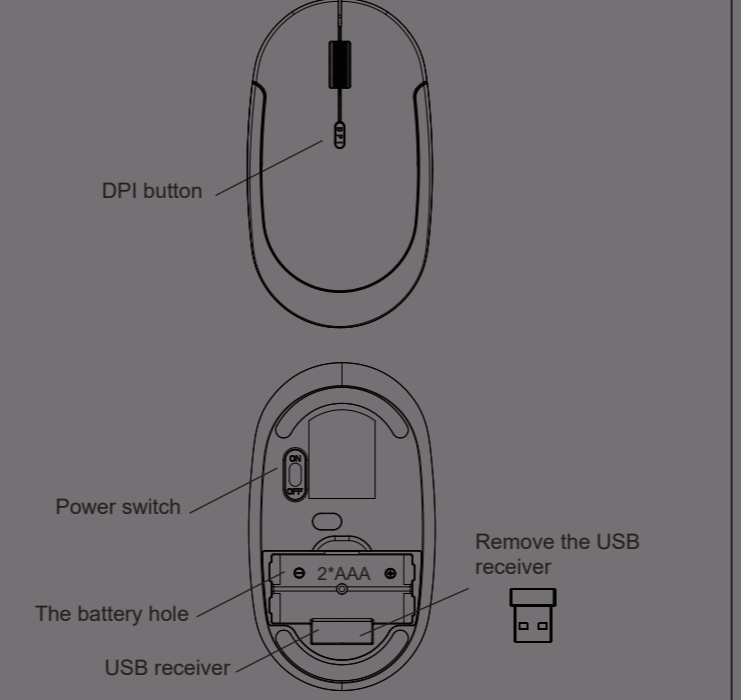
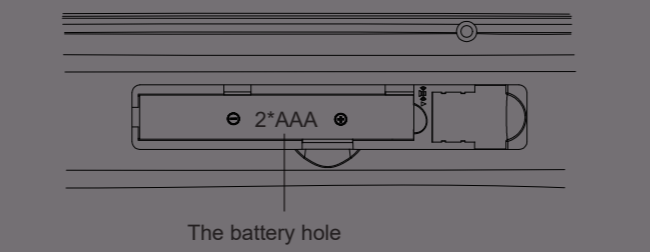
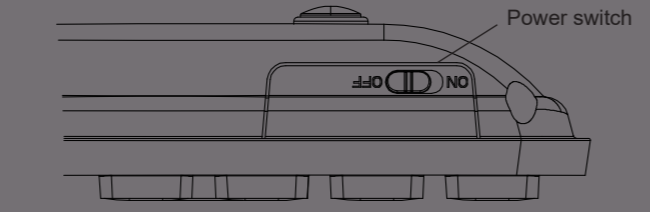

2.4G Connection

1. Turn on the keyboard and mouse power switch.
2. Take out the USB receiver from the receiver hole on the bottom of the mouse.
3. Plug the USB receiver into your computer's USB port.
4. Then the keyboard and mouse is successfully connected.

Keys and Function

Keys	Windows	MAC OS
☼	Decrease brightness	Decrease brightness
☼	Increase brightness	Increase brightness
☐	Window switching	Window switching
🔍	Search	Search
📄	Application switching	Application switching
🧮	Calculator	/
⏪	Previous	Previous
⏩	Play&Stop	Play&Stop
⏮	Next	Next
🔇	Mute	Mute
🔊	Volume down	Volume down
🔊	Volume up	Volume up
🌐	Switch input method	Switch input method
📄	Copy	Copy
📄	Paste	Paste
🖨	Print	Print
🔒	Lock screen	Lock screen
🔒	Press FN+ESC to turn ON/OFF the FN function	

- FN+ Q (MacOS) : Choose to switch to a MacOS system.
- FN+ W (Win) : Choose to switch to a Windows system.

2.4G mode re-pairing method

We completed the 2.4G mode pairing during the product production process. If you plug the USB receiver into the computer and turn on the power switch, the keyboard or mouse is no response, can not use normally, please re-pairing by yourself. The keyboard and mouse can be paired separately as follows steps.

Keyboard re-pairing steps:

1. Turn on the power switch of the keyboard, Press "ESC" and "="(in front of the Backspace key) long for 3 seconds. The green indicator ligh flashes that the keyboard has entered the pairing mode.
2. Plug the USB receiver into your computer USB port.
3. The connection is successful when the green indicator light is always on.

Mouse re-pairing steps:

1. Turn on the power switch of the mouse.
2. Press and hold the left mouse button, the scroll wheel, and the right mouse button together for 5 seconds until the indicator light flashes quickly.
3. Plug the USB receiver into your computer USB port.
4. The connection is successful when the white indicator light is on and then off.

NOTE: This equipment has been tested and found to comply with the limits for a Class B digital device, pursuant to part 15 of the FCC Rules. These limits are designed to provide reasonable protection against harmful interference in a residential installation. This equipment generates, uses and can radiate radio frequency energy and, if not installed and used in accordance with the instructions, may cause harmful interference to radio communications. However, there is no guarantee that interference will not occur in a particular installation. If this equipment does cause harmful interference to radio or television reception, which can be determined by turning the equipment off and on, the user is encouraged to try to correct the interference by one or more of the following measures:

- Reorient or relocate the receiving antenna.
- Increase the separation between the equipment and receiver.
- Connect the equipment into an outlet on a circuit different from that to which the receiver is connected.
- Consult the dealer or an experienced radio/TV technician for help.

Changes or modifications not expressly approved by the party responsible for compliance could void the user's authority to operate the equipment.