

# DS-PD2-D15AME

15m Dual-tech Detector



## Diagram references

**A** Anti-Masking: DS-PD2-D15AME uses the patented Anti-Masking technology to detect when both PIR and Microwave technologies are Masked. The detector is able to detect aluminium foil, spray and any object position on or in front of the detector with the purpose of obstructing the field of view of the PIR or MW sensors.

**A1** The Mask is adjustable between 0 to 1M.

**A2** The Masking area is entered the Blue LED starts flashing to show that the area has been compromised. If the obstacle is removed after 30 seconds the detector will reset to normal. If the obstacle still remains after 1 minute, the MASK and ALARM relay will open and the Green and Orange LEDs will be permanently activated. To reset the detector, the obstacle must be removed and a walk test must be done.

**B** Blocking: This feature is to detect a partial obstruction of the PIR up to 15m when the panel is disarmed. When blocking is detected the alarm relay will open and the GREEN and ORANGE LEDs will be activated. To reset the blocking, the DS-PD2-D15AME must be walk tested so that the PIR and MW sensors are activated.

**B1** Blocking Enabled/Disabled: To enable the feature, switch 6 must be OFF and the RI input should be connected to an output on the control panel which gives DV when DISARMED and removes DV when ARMED.

**C** DS-PD2-D15AME is supplied with the following:

BRACKETW (Wall Bracket), BRACKETC (Ceiling Bracket) and TAMPER (Back tamper)

**E** NOTE: When the 2 optional lenses are used the Microwave range remains at 15m.

## Technical Specification

Coverage	35° (Recess System, Curtain)
Maximum range	150/200/250m
Optimal installation height	1.8-2.4m
Cable length restriction	100m
Key Features	
Adjustable anti-masking (anti-spray)	Yes
Anti-flooding technology	Yes
Blue Wave Technology	Yes
Advanced sensitivity	Yes
Digital temperature compensation	Yes
Smart motion detection	Yes
Emergency frequencies to avoid interference	Yes
LEDs visible on board	Yes
Tamper detection included	Yes
Signal strength indicators (SSI)	Yes
Wired	Yes
Power supply	8-16 DC (1200 nominal)
Current consumption (standby)	1.5mA
Current consumption (alarm)	100mA
Relay type	Solid state
Output polarity	NO/NC, Open collector
Tamper terminal	120C max, 50mA max
Resistor load capacity	100mA
Microwave frequency	31.5GHz, 31.5GHz, 31.5GHz
Dimensions (depth)	22mm
Direct light filter	5600 lum
Optics	5.6mm
Geometric lens configuration	3D
Operating temperature	-30°C ~ +60°C
Humidity	10% ~ 95%
Weight	115g (65 x 45 mm)
Accessories	
Wall brackets included	Yes
Long range and curtain lenses included	Yes
Resistor load material included	Yes
Certification and approvals	
CE	Yes
RoHS	Yes
Warranty	3 years

## Product Warning Information

Copyright © 2018 Hangzhou HIKVISION Digital Technology Co., Ltd.  
All RIGHTS RESERVED.  
Any and all information, including, among others, writings, pictures, graphs are the properties of Hangzhou HIKVISION Digital Technology Co., Ltd. or its subsidiaries (hereinafter referred to as "HIKVISION"). This user manual (hereinafter referred to as "the Manual") cannot be reproduced, changed, translated, or distributed, partially or wholly, by any means, without the prior written permission of HIKVISION. Unless otherwise stipulated, HIKVISION does not make any warranties, guarantees or representations, express or implied, regarding to the Manual.

This Manual is applicable to detector.  
The Manual includes instructions for using and managing the product. Pictures, charts, images and all other information hereinafter are for descriptions and explanations only. The information contained in the Manual is subject to change, without notice, due to firmware updates or other reasons. Please find the latest version in the company website.

(http://overseas.hikvision.com/en/)  
Please use this user manual under the guidance of professionals.

Trademarks Acknowledgement  
HIKVISION and other HIKVISION's trademarks and logos are the properties of HIKVISION in various jurisdictions. Other trademarks and logos mentioned below are the properties of their respective owners.

CE This product and, if applicable, the supplied accessories are marked with "CE" and comply therefore with the applicable harmonized European standards listed under the EMC Directive 2014/53/EU, the LVD Directive 2014/35/EU, the RoHS Directive 2011/65/EU.

## START

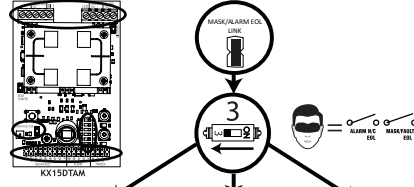
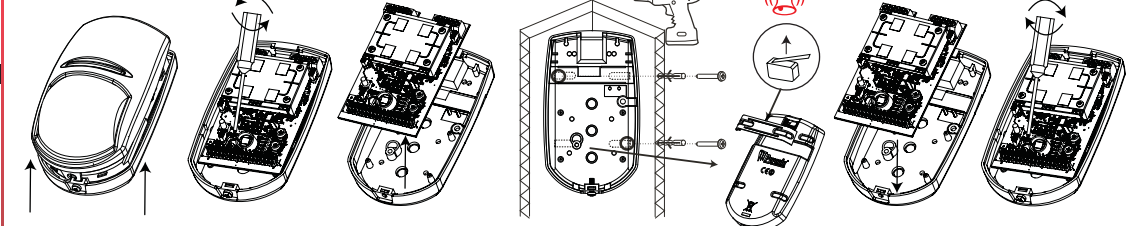

The Input voltage should meet both the SELV (Safety Extra Low Voltage) and the Limited Power Source according to the IEC60950-1 standard. Please refer to technical specifications for detailed information.

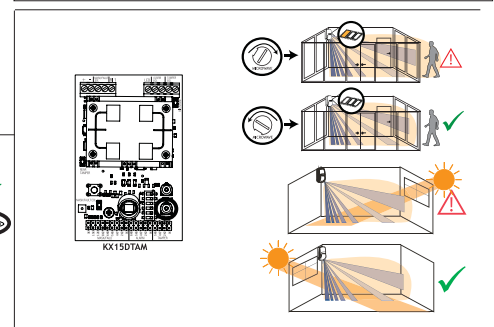
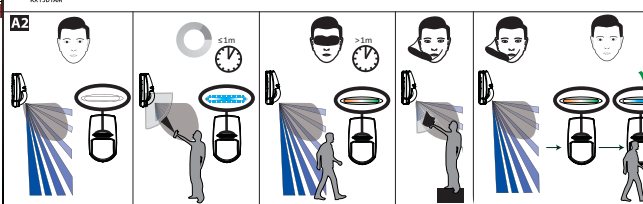
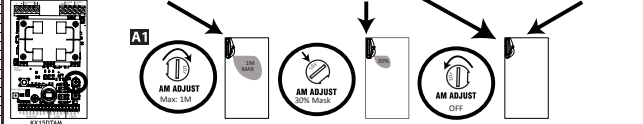
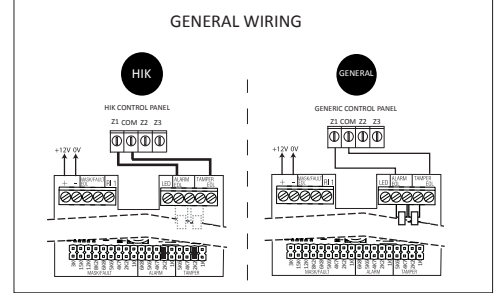
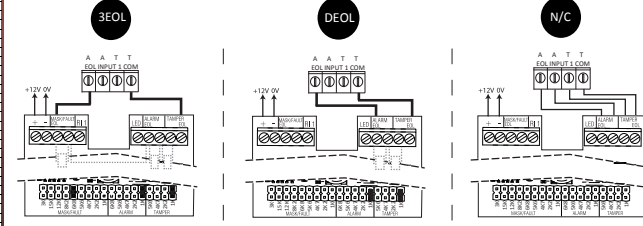

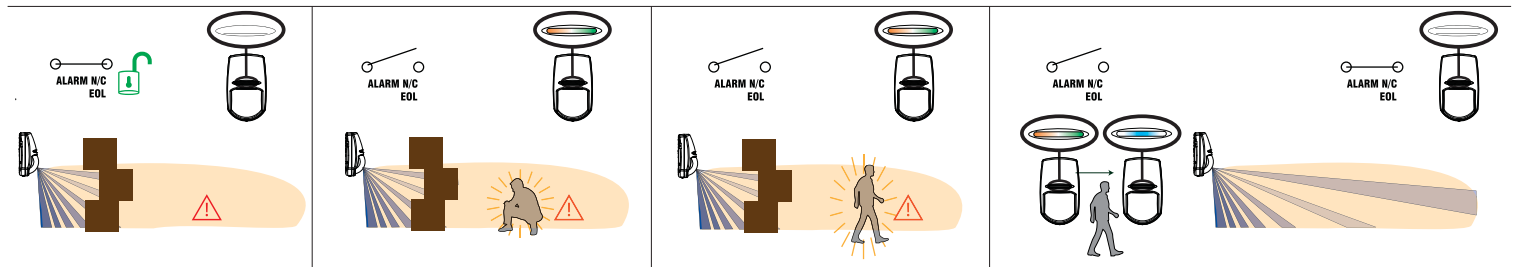
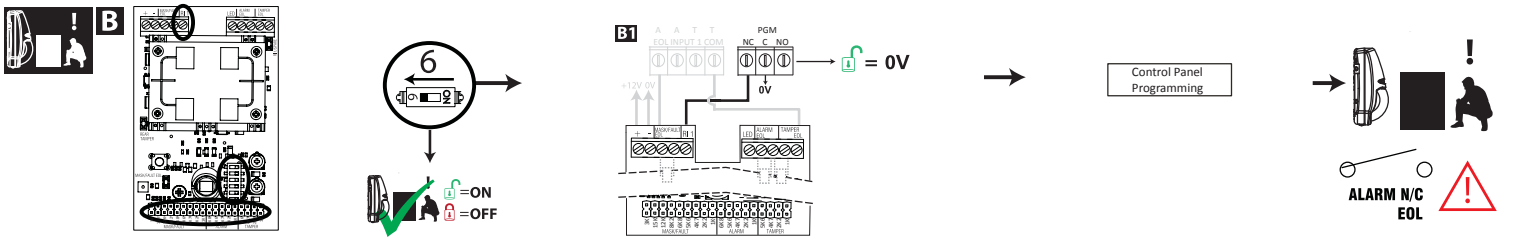

**E**

**15m Volumetric Lens**  
85°  
60 zones  
7 planes

**18m Curtain Lens**  
20°  
24 zones  
6 planes  
For INCERT compliance, set pulse count to 1 (see switch 4 diagram)

**30m Long Range Lens**  
90°  
48 zones  
6 planes  
For INCERT compliance, set pulse count to 1 (see switch 4 diagram)

Horizontal Coverage

Vertical Coverage

Horizontal Coverage at Minimum Range

Horizontal Coverage at Maximum Range

Vertical Coverage

Horizontal Coverage

Vertical Coverage

Horizontal Coverage

Vertical Coverage

1

2

4

5

1

2

4

5

AUTO

PULSE COUNT 1

0.25 - 2.5m/s

0.25 - 2.5m/s

AND

OR

LED

X LED

C  
G

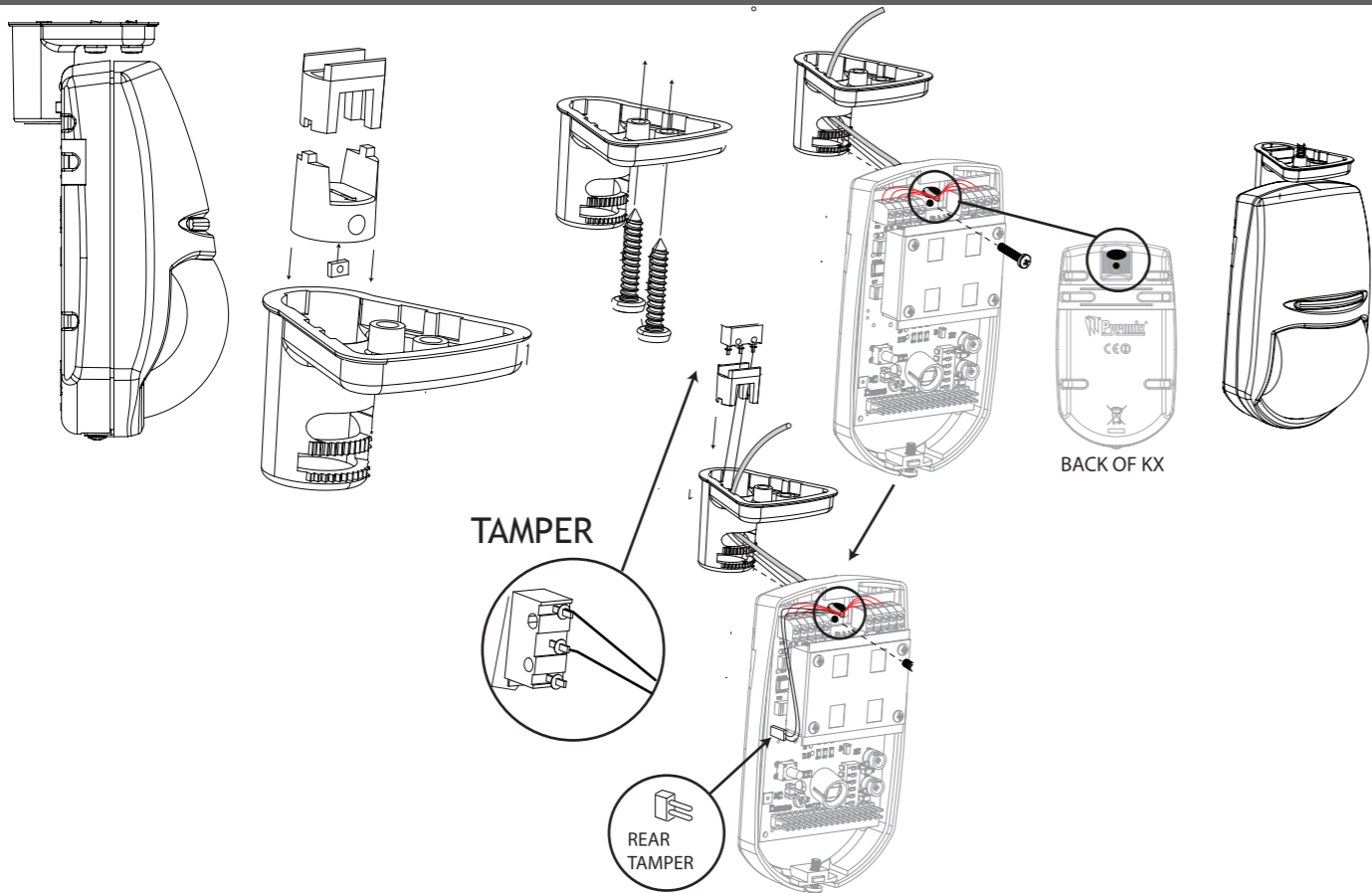

2

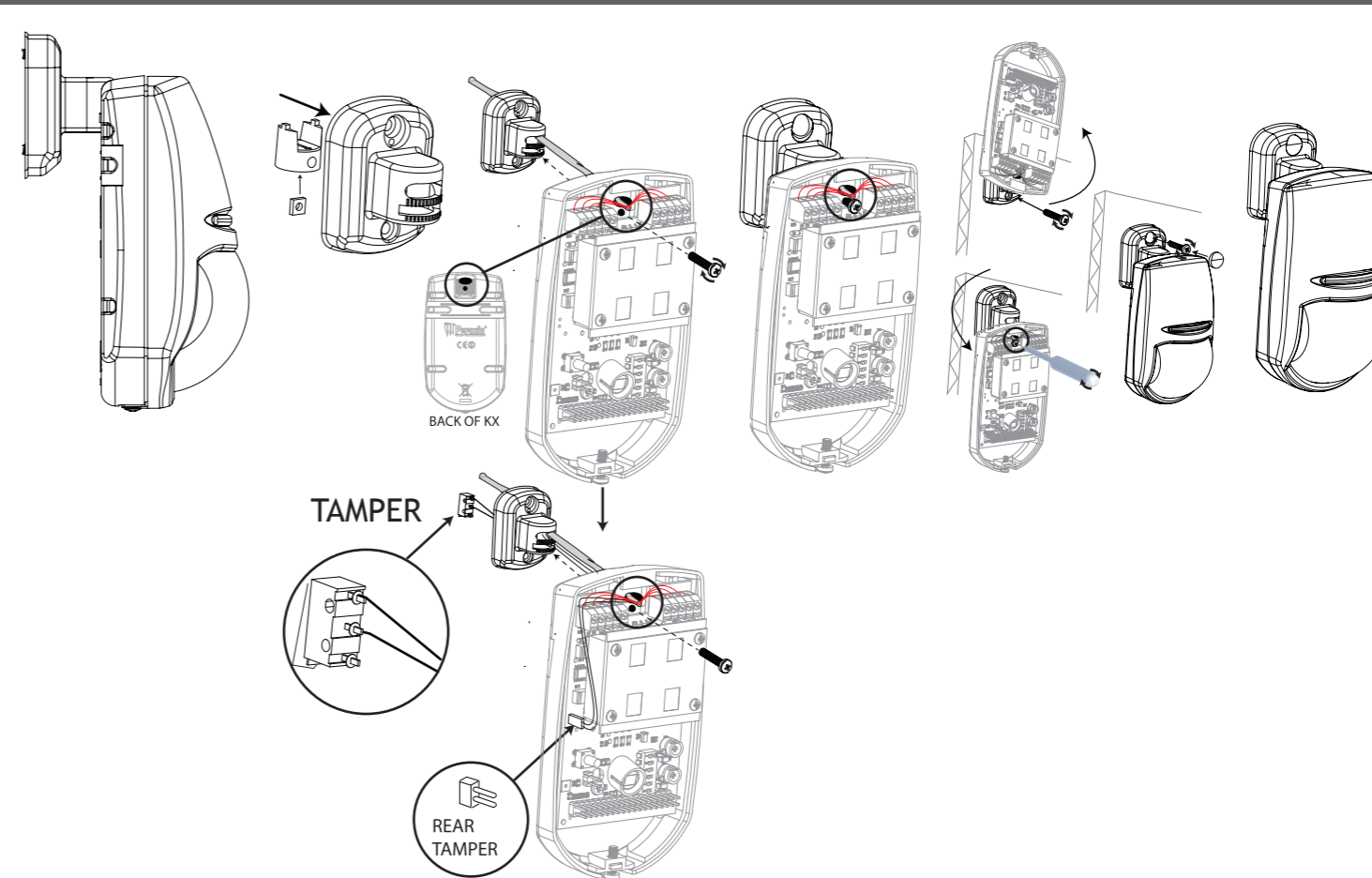

FCC Information

Please take attention that changes or modification not expressly approved by the party responsible for compliance could void the user's authority to operate the equipment.

FCC compliance: This equipment has been tested and found to comply with the limits for a Class B digital device, pursuant to part 15 of the FCC Rules. These limits are designed to provide reasonable protection against harmful interference in a residential installation. This equipment generates, uses and can radiate radio frequency energy and, if not installed and used in accordance with the instructions, may cause harmful interference to radio communications. However, there is no guarantee that interference will not occur in a particular installation. If this equipment does cause harmful interference to radio or television reception, which can be determined by turning the equipment off and on, the user is encouraged to try to correct the interference by one or more of the following measures:

- Reorient or relocate the receiving antenna.
- Increase the separation between the equipment and receiver.
- Connect the equipment into an outlet on a circuit different from that to which the receiver is connected.
- Consult the dealer or an experienced radio/TV technician for help

FCC Conditions

This device complies with part 15 of the FCC Rules. Operation is subject to the following two conditions:

1. This device may not cause harmful interference.
2. This device must accept any interference received, including interference that may cause undesired operation.

