Speed 3C

ORIGINALITY DESIGN SMART – AND BEAUTIFUL

.....

CAMERA



QUICK GUIDE

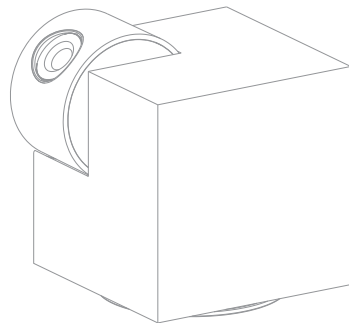

18411030

Functions

Pan/Tilt

Rotate your camera by sliding on your smartphone, providing you with 360 degrees of vision.

Video flip

Flip your video stream up or down for maximum flexibility.

Motion detection

Built-in motion sensors detect movement, and the camera will send you push notifications and app alerts.

Record

Support 24H continuous recording with high capacity SD storage.

Day & Night

Never miss a moment, even in complete darkness, with powerful night-vision technology.



Daytime



Night

What's in the box

Consult the checklist below for all components.

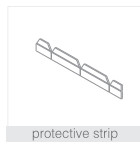
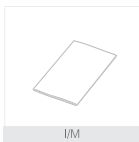
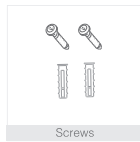
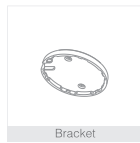
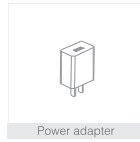
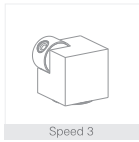

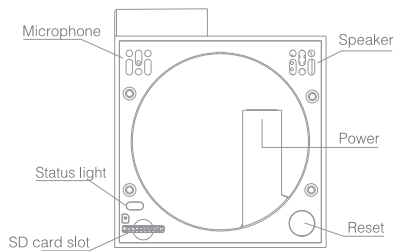

Bottom of camera

Description

Power	DC5V ± 10%
Status light	<ul style="list-style-type: none"> Red light solid on: the camera network is abnormal Red light blinked: awaiting WiFi connection, or currently connecting (faster blinking) Blue light solid on: camera running correctly Blue light blinked: awaiting manual WiFi configuration, or currently connecting (faster blinking)
Microphone	Captures sound for your video
SD card slot	Supports local SD Card storage (Max.128G)
Reset	<p>Press and hold the 'reset' for 5 seconds to reset the device(if you have modified settings, they will return to factory defaults)</p> <p>Pressing for 1 second will activate manual WiFi setup mode</p>

Connect

Download

Download the CloudEdge App and install it on your smartphone (App download consumes a certain amount of traffic, it is best to use WiFi.)

• Support



Set up router

This product only supports 2.4GHz frequency band router, does not support 5GHz frequency band router, please set the relevant parameters of the router before WiFi configuration, set the router and write down the name and password of WiFi. When the Speed 3 is in the WiFi configuration, the mobile phone and Speed 3 are as close to the router as possible, which can speed up the configuration.



Registration process

Step 1 Open the CloudEdge App, click 'SIGN UP', input a valid email address and select 'registration means agreement with user agreement privacy agreement' then click 'NEXT'.

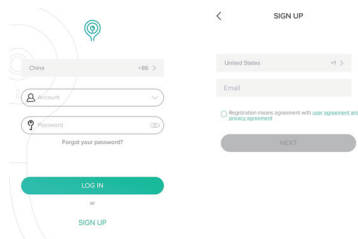

Step 2 Enter the email address and click 'OK', create a nickname and login password.

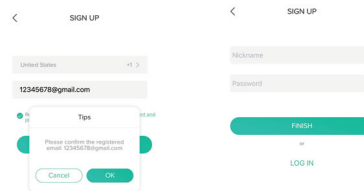

Note: Make sure your router, camera, and mobile phone are nearby.

QR Code Configuration

Few notices before adding the device

1. This camera only supports 2.4GHz WiFi router, please make sure you are using a 2.4GHz wifi router.
2. Please follow the instructions and make sure the password is inputed correctly.
3. One camera can only be added with one App account, if the camera has been added with another account already, then it can't be added to any another account again.

Process

Step 1 Open the Cloudedge App, click '+', and select the type of device to add.

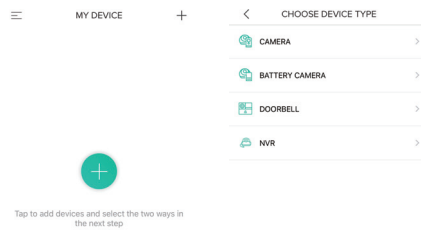

Step 2 Please confirm the red LED light blinks, select 'The device has flashed red slowly or you hear a tone', click 'Next'. Then input the wireless password, click 'Next'.

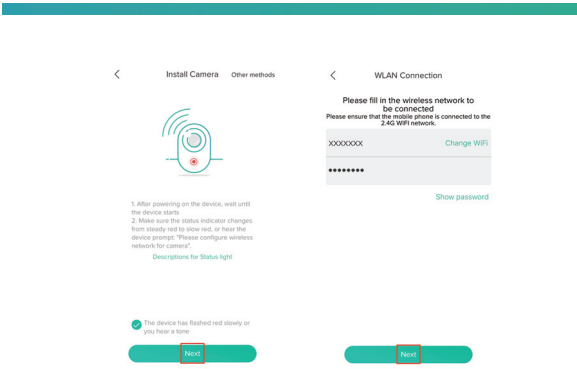

Step 3 The device is scanning the QR code at a distance of 15~25cm (you can click the 'operation' to view the scanning mode). After the device scans successfully, click 'Hear tone'.



Step 4 The device is successfully connected to the network. After the configuration is completed, the App automatically adds the successfully scanned device, and clicks 'Finish' to return to the device list. The configuration is completed.

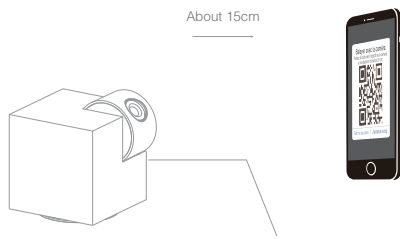
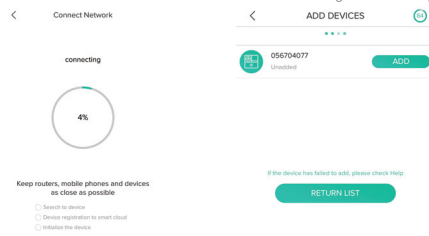

Install

- 1 Use the included mounting bracket to fix the camera to a clean surface.

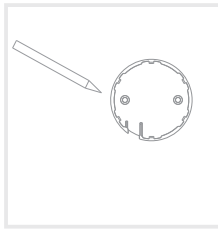

Step 1 Use the marker to draw the positions of the 2 screw holes on the wall surface to be installed.

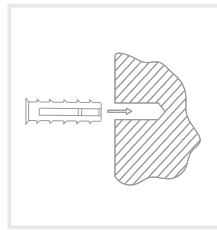

Step 2 Screw 2 expansion screws into the newly marked position.



Step 3 Fix the mounting bracket to the wall.

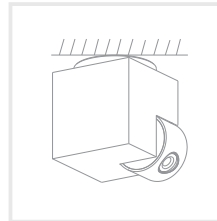

Step 4 Snap camera base into bracket

2 Or, stick the camera to an inclined surface with the adhesive tape we provided.

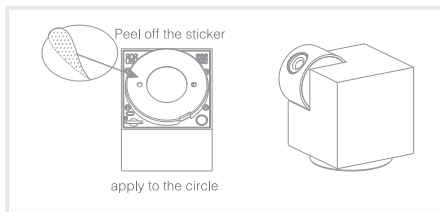

If required, you can apply the protective strip on Camera's edge to avoid any damage or hurt.



Step 1

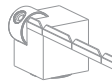

Step 2



Step 3



Step 4

FCC Statement

Any Changes or modifications not expressly approved by the party responsible for compliance could void the user's authority to operate the equipment.

This device complies with part 15 of the FCC Rules. Operation is subject to the following two conditions:

- (1) This device may not cause harmful interference, and
- (2) This device must accept any interference received, including interference that may cause undesired operation.

FCC Radiation Exposure Statement:

This equipment complies with FCC radiation exposure limits set forth for an uncontrolled environment. This equipment should be installed and operated with minimum distance 20cm between the radiator & your body.

NOTE: This equipment has been tested and found to comply with the limits for a Class B digital device, pursuant to part 15 of the FCC Rules. These limits are designed to provide reasonable protection against harmful interference in a residential installation. This equipment generates, uses and can radiate radio frequency energy and, if not installed and used in accordance with the instructions, may cause harmful interference to radio communications. However, there is no guarantee that interference will not occur in a particular installation. If this equipment does cause harmful interference to radio or television reception, which can be determined by turning the equipment off and on, the user is encouraged to try to correct the interference by one or more of the following measures: