

Connecting KAT SENSORS

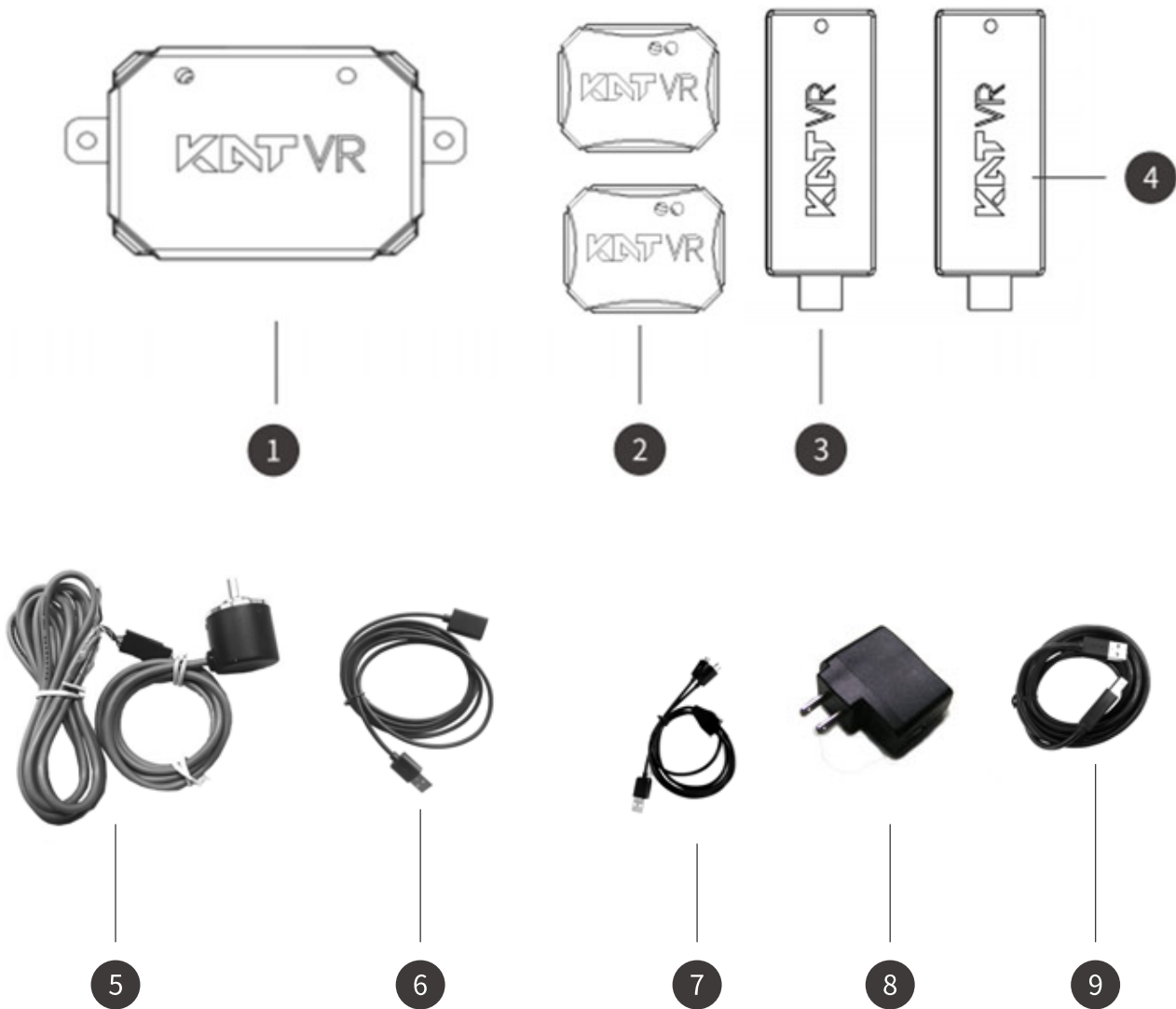

Number	Name	Quantity	Remark
1	KATVR-Back Sensor	1	Already installed to the connecting rod
2	KATVR-Foot Sensor	1	
3	KATVR-Central Sensor	1	Port for the KATVR-Top Sensor on the side
4	Wireless receiver	1	No port for the KATVR-Top Sensor on the side
5	KATVR-Top Sensor	1	Already installed to the girder
6	USB-A type extension cable	2	One for connecting the KATVR-Central and sending the KATVR-Back data to PC The other for connecting the wireless receiver and sending the two KATVR-Foot Sensor data to PC
7	Charging cable	1	Charging KATVR-Foot Sensor
8	Charger	1	Charging KATVR-Foot Sensor
9	Charging cable	1	Charging Back Sensor