



Molshell Smart Case

User Manual

Warning on Removal

When removing or installing Molshell smart case, it is forbidden to lever an iPhone at a large angle. Otherwise it will lead to breakage of Molshell interface.



Introduction to Product Functions

Welcome!

First of all, thank you for selecting Molshell Smart Case. Once you own this product, you are able to let your iPhone use a second SIM card to realize standby and calling, which greatly improves feasibility and convenience of communication. Meanwhile, the battery attached to this product is able to extend your iPhone's battery life at critical moments, enabling you to travel further.

Introduction to Product Functions

- Molshell Smart Case is a protective shell for iPhones. Its excellent design will not significantly increase the size and weight of iPhone. Instead, it can reliably protect the iPhone to considerably reduce scratches or damages caused by accidental falls or collision.
- The second function is also the most attractive one. Molshell Smart Case is equipped with a SIM card slot, in which a Mobile or Unicom Nano SIM card can be inserted so as to realize the additional SIM communication service for the iPhone.
- The principle applied to Molshell Smart Case can also help you to solve the issue of considerable expensive international roaming expenses. You are able to use the domestic SIM card when roaming in a foreign country to enjoy calling and sending messages within the domestic telecom charge package.
- Meanwhile, Molshell Smart Case also comes with a built-in 2400mAh high-quality polymer battery, which could charge your iPhone at any time so as to extend your iPhone's battery life.

Introduction to Product Specifications

| | | |
|------------------------------------|---|-----------------------|
| Product model | BE6086BX | BE6096AX |
| Supported model | iPhone6/6S | iPhone6 plus /6S plus |
| Product size | 142x71x11mm | 164x84.5x12.5mm |
| Product weight | 69g | 89g |
| Supported network types | * support China Unicom 3G and 4G and China Mobile 3G and 4G (* in several roaming areas, cards or group cards may not be used normally) | |
| SIM card specification | Nano SIM card | |
| Bluetooth protocol | Bluetooth V4.1 | |
| Transmission power | Support Class II standard | |
| Working frequency | 2.402G-2.48G | |
| Battery type | Lithium polymer battery | |
| Battery capacity | 2400mAh/3.8V, 9.12Wh | |
| Limited voltage for battery charge | 4.35V | |
| Supported input | DC5V, 0.5A-2.1A | |
| Rated output | DC5V, 1.0A | |
| Working temperature | 20-60°C (discharge), -10-45°C (charge) | |

Method for Product Installation——SIM Card Installation

Please insert Nano SIM card into SIM card slot and meanwhile, ensure it is correctly installed and reliably covered with the outer cover.

Position of Nano SIM card is as shown in the following figure:

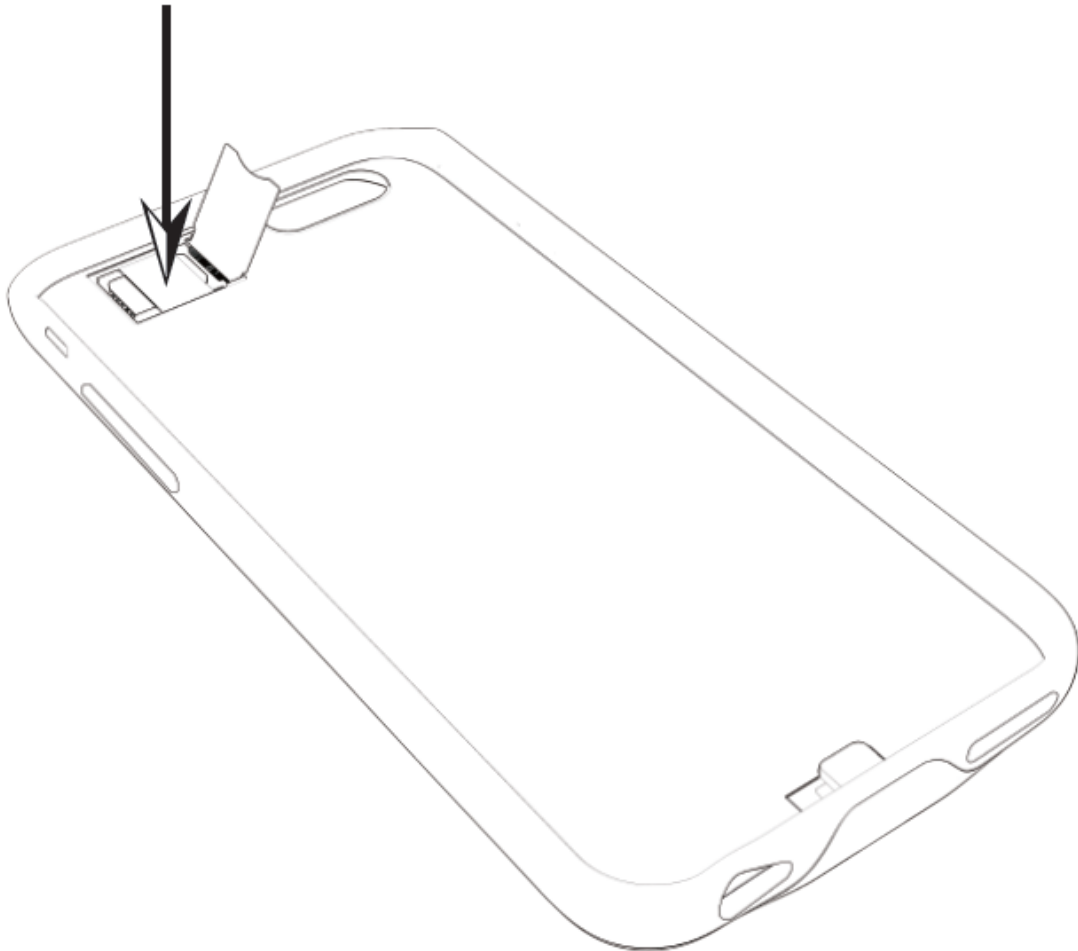

Installation Method for Product (BE6086BX)

Installation of Molshell Case for iPhone 6S/6.

01

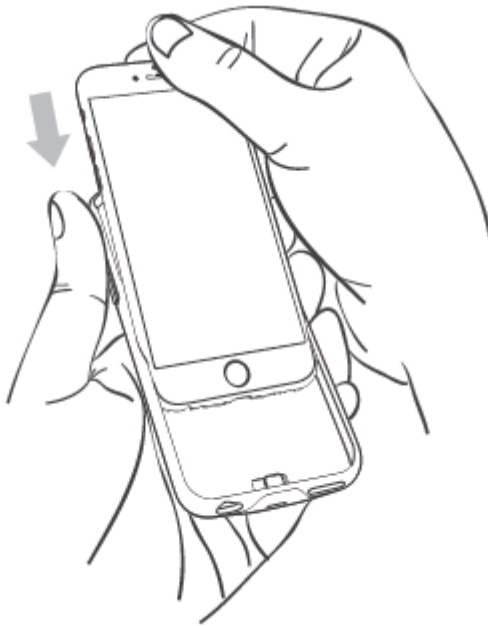

02

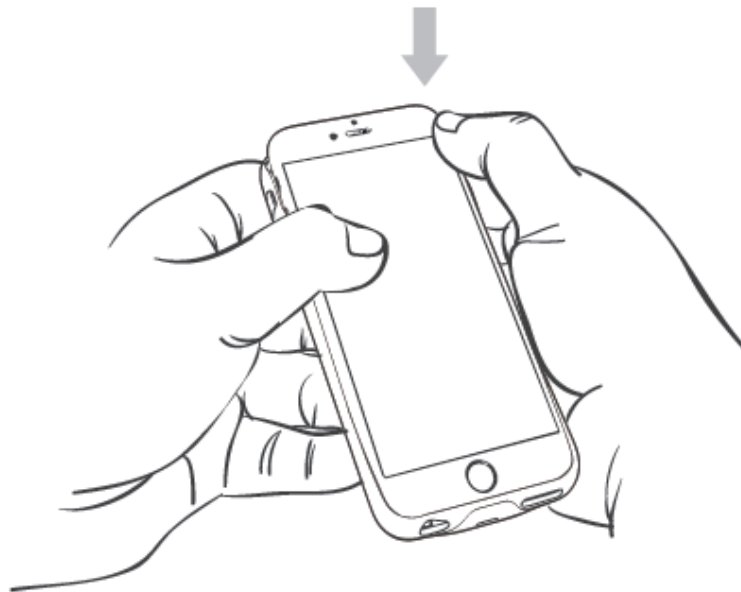

Removal of Molshell Case for iPhone 6S/6.

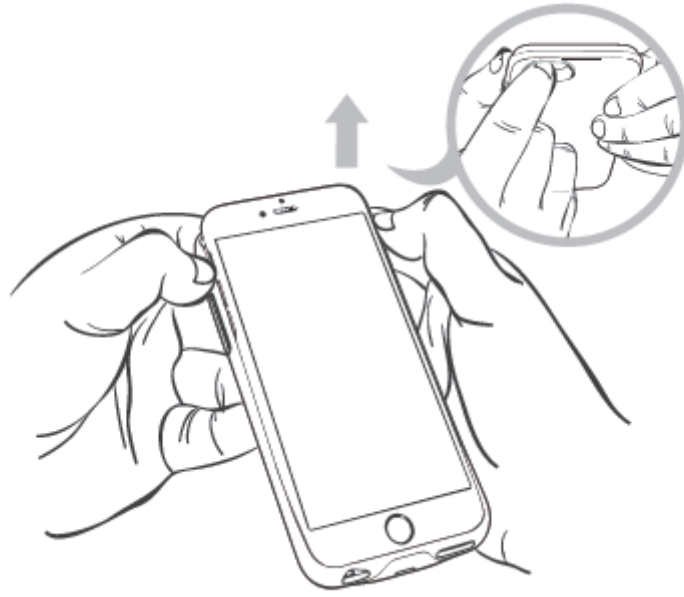

Method for Product (BE6096AX) Installation

Installation of Molshell Case for iPhone 6S/6 Plus.

01

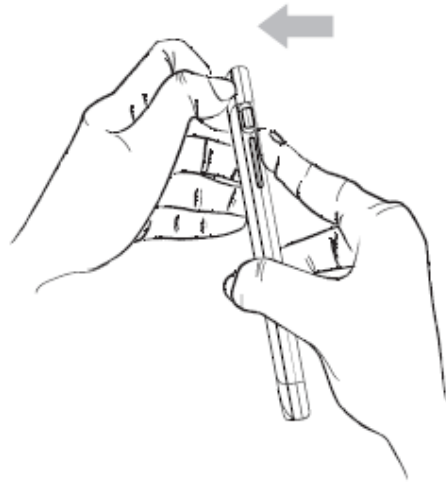

拆分结构示意图

Schematic diagram of split structure

02

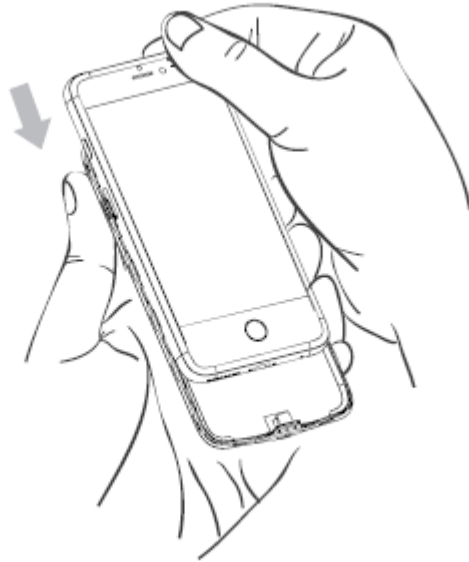

Removal of Molshell Case for iPhone 6S/6 Plus.

01

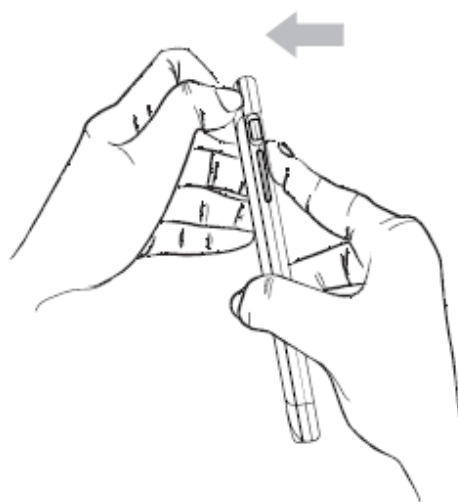

02



Basic Product Operation

Switch On/Off of charging function: double click the ON/OFF button.

Bluetooth pairing mode: press and hold the ON/OFF button for more than 6 seconds.

***Note: Standby and calling functions of SIM card will not be affected regardless of ON/OFF of charging function.**



Schematic diagram of power

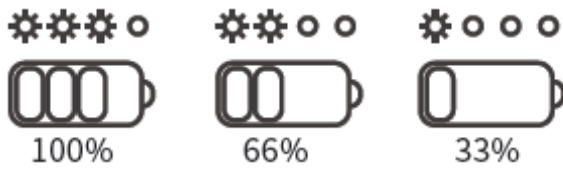

***Note:** Please charge timely if the indicator light on the left-most side flashes rapidly when double clicking the ON/OFF button. It indicates the product is in power shortage.

Meaning of Bluetooth Status Indicator Light:

Fast flashing

Bluetooth pairing mode;

Slow flashing

Work/calling status/sleep status (no effect on SIM card standby).

Introduction to Product Charging Function

When Molshell is fully charged for the first time (3 indicator lights are always on), please continue to charge for another hour to allow Molshell's battery reach its maximum capacity.

Recommend to use a battery charger that is consistent with Apple standard.

Hints on Molshell Charging:

An iPhone can be charged together with Molshell. During charging, the corresponding indicator lights will flash according to the current electricity capacity; once the 3 indicator lights are always on, it means the battery is fully charged.

*Note: when an iPhone is being charged or data is being transmitted, there is no need to remove Molshell.

* Note: Molshell's charging function will not be affected if SIM card is not inserted.

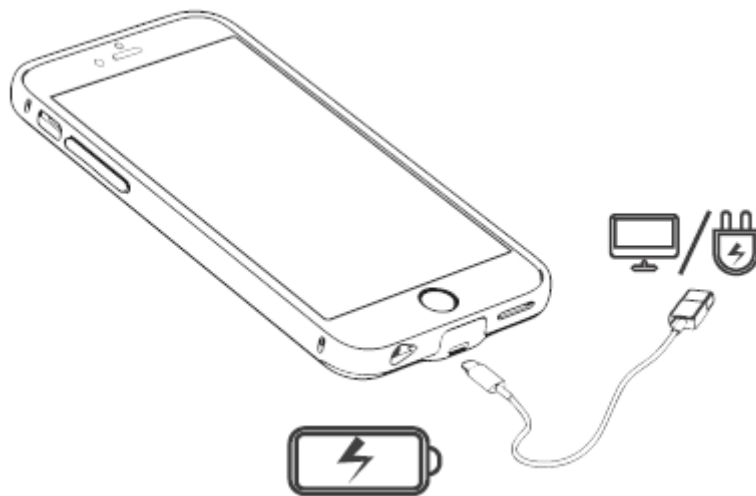

Preferential Charging:

When Molshell and iPhone are charged together, the iPhone will be charged preferentially.

Key Hints:

Please note the following information before using Molshell in order to avoid unnecessary injuries:

Recommend to use a USB cable consistent with Apple standard.

Do not disassemble

Do not use Molshell in an environment exceeding the operating temperature range.

Do not place Molshell in a humid environment.

Do not place Molshell next to the heat source.

Do not crush or disrupt the battery.

Certification Standard



Software Installation and Registration

Software Download and Installation:

This product shall be used together with “Molshell” APP. Please install “Molshell” APP in your iPhone. You could scan the following QR code to download and install APP or directly log in Appstore to search, download and install the APP.



Software Registration and Login

Registration: Please input the mobile phone number of SIM card inserted in Molshell to complete the registration.



***Note: please input the mobile phone number of SIM card inserted in Molshell; otherwise, it cannot be verified and corresponding calling and messaging functions cannot be used.**

Mobile Phone Number Verification

***Note: due to different software versions, the following steps may be omitted. Bluetooth pairing could be proceeded after mobile phone number registration was completed.**

Verification: (1) If the SIM card to be verified is inserted in the mobile phone, please select “SIM card is in the mobile phone” and input the mobile phone number to acquire the verification code.

Then input the correct verification code to complete verification and login.

(2) If the SIM card to be verified in Molshell, please select “SIM card is in Molshell”, and then directly click the “Complete” button to complete registration and login.

Applidium 11:27 AM 100 %

< 验证

验证号码: +86XXXXXXXXXXXX

SIM卡在手机内

请输入手机号码

SIM卡在盒子内

Bluetooth Pairing & Calling and Short Message Functions

Method for Bluetooth Pairing

- Turn on Bluetooth in iPhone's setting;
- Press and hold Molshell's operation button for more than 6seconds and the blue Led light on the right-most side will start flashfast and enter into Bluetooth pairing mode;
- Click Pairing in the APP and at this time, Bluetooth pairing in APP and SIM in Molshell will be completed.



*Note ①: Bluetooth pairing is only necessary for first use. Subsequently, all functions could be used by starting APP except when there are changes in SIM card or software environment.

*Note②: During Bluetooth pairing, you could only find relevant hardware device in "Molshell" APP, and it shall not appear in an iPhone or other mobile phones' Bluetooth device searching list. It is not a defect but the requirement of device binding and encryption.

Bluetooth Pairing&Calling and Short Message Functions

Dial and Answer Calls

- Select “Communication” on APP’s main interface and select a phone number from “contact persons” or “dialing board” to call someone;
- When dial a number stored in SIM in Molshell, APP will automatically pop up in the call interface. Click Answer to receive the call.

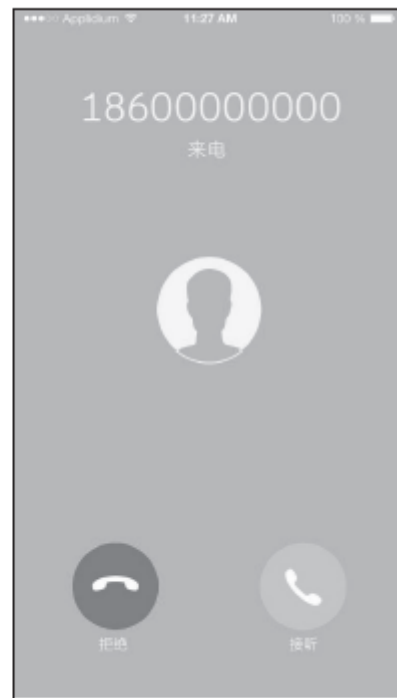

Receive and Send &Edit Messages

- Select “Message” on APP’s main interface and you can see the previous message records.
- Click any messages and you could edit a new message in the message dialog box, or click New Message on the right upper corner.



Product's Three Guarantees and Quality Assurance Services

Three-guarantee certificate is only valid during the effective guarantee period under normal use condition. With regard to non-human damages due to the product's quality issues, the following three-guarantee services are granted relying on the relevant invoice and this three-guarantee certificate according to three-guarantee provisions:

- Within 7 days since the purchase date, customers are entitled to choose return, replace or repair the product if the product suffers from performance defect.
- From the 8th day to the 15th day since the purchase date, customers are entitled to choose replace or repair the product if the product suffers from performance defect.
- Within the effective period of three guarantees, once the product suffers from performance defect, customers are entitled to enjoy free maintenance service.
- The effective period of the three-guarantee service is 1 year.

Once one of the following cases (but not limited to the following cases) occurs, three-guarantee service is not provided:

- Contents in the three-guarantee certificate are inconsistent with the mark of the physical commodity or it is obliterated.
 - Damages caused by disassembly conducted by a repairer who is not committed to three guarantees.
 - Damages caused by failure of use, repair and maintain the product according to the product instructions for use.
 - Damages caused by force majeure.
 - Missing of three-guarantee certificate and valid invoice, or no evidence proving the product is in the effective period of three guarantees.
 - Exceeding the effective period of three guarantees.
 - Damages caused by user's improper use (such as dropping, pressing and immersion).
-

Description of Product Return, Replacement and Maintenance

Please contact the relevant dealer or log in the official website for detailed information related to application for maintenance and product return or replacement after-sales service.

Official website: www.lianluo.com

Customer service hotline: 400 968 5665 (workdays 9:30 a.m.-6:30 p.m.)

Three-guarantee policy is only applicable to Mainland China

Hangzhou Liaison Interactive Information Technology Co., Ltd. reserves the final interpretation

Warning Statement

This equipment has been tested and found to comply with the limits for a Class B digital device, pursuant to part 15 of the FCC Rules. These limits are designed to provide reasonable protection against harmful interference in a residential installation. This equipment generates, uses and can radiate radio frequency energy and, if not installed and used in accordance with the instructions, may cause harmful interference to radio communications. However, there is no guarantee that interference will not occur in a particular installation. If this equipment does cause harmful interference to radio or television reception, which can be determined by turning the equipment off and on, the user is encouraged to try to correct the interference by one or more of the following measures:

- Reorient or relocate the receiving antenna.
- Increase the separation between the equipment and receiver.
- Connect the equipment into an outlet on a circuit different from that to which the receiver is connected.
- Consult the dealer or an experienced radio/TV technician for help.

Caution: Any changes or modifications to this device not explicitly approved by manufacturer could void your authority to operate this equipment.

This device complies with part 15 of the FCC Rules. Operation is subject to the following two conditions: (1) This device may not cause harmful interference, and (2) this device must accept any interference received, including interference that may cause undesired operation.

The device has been evaluated to meet general RF exposure requirement. The device can be used in portable exposure condition without restriction.