



Smart Watch User Manual

Basic introduction to the product



Basic Product Operation

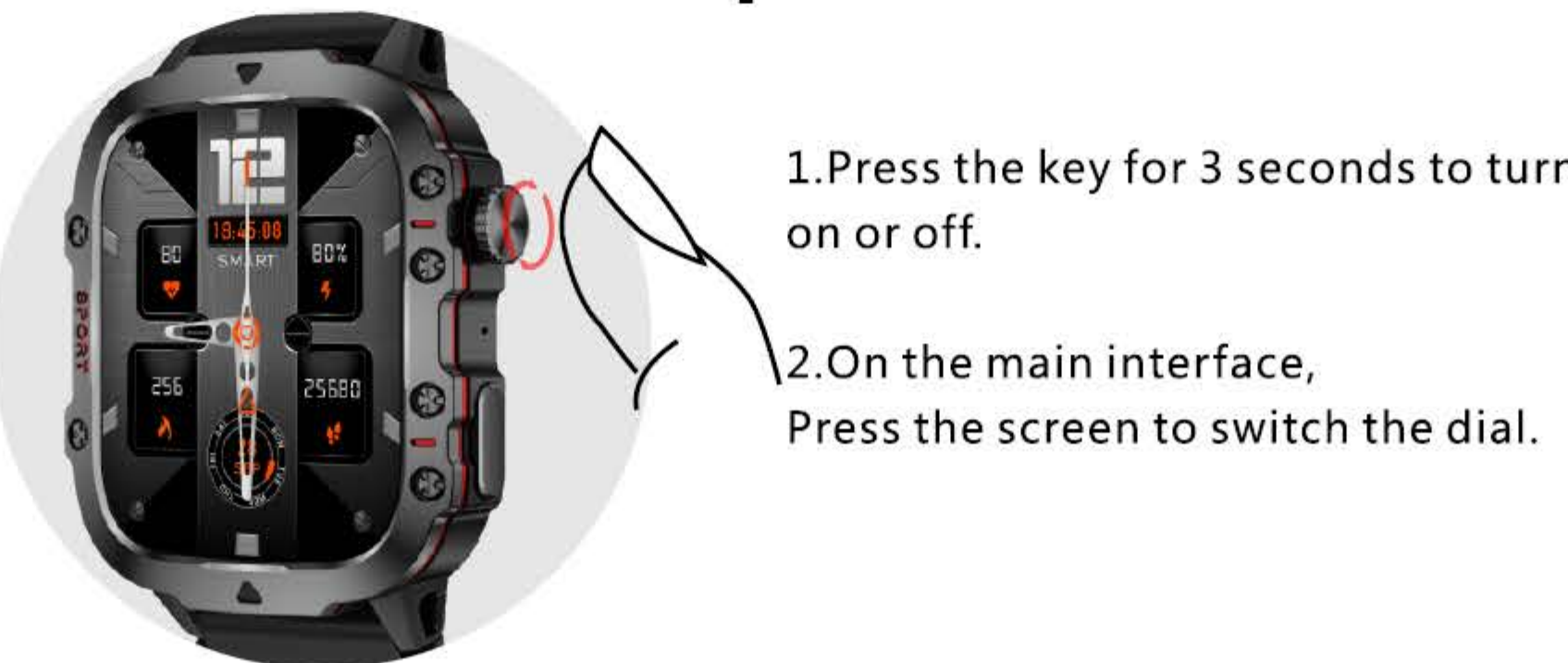

APP download, installation and use

1. Scan the following QR code or enter each major application market to download and install "GloryFit"
Equipment requirements: ios 9.0 and above; Android 5.0 and above



GloryFit

2. After the download is completed, start the new user registration or third-party login. And improve personal basic information

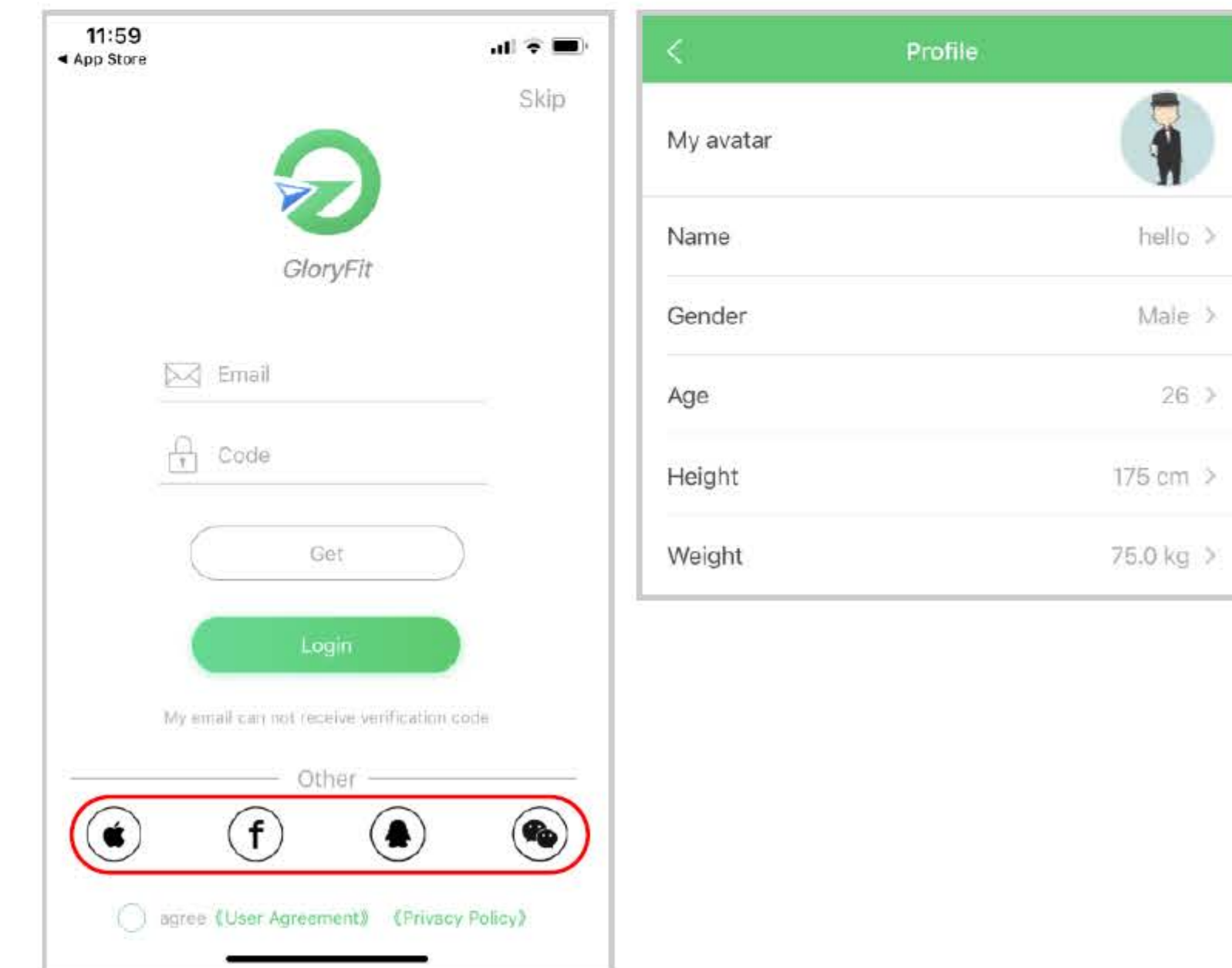

English

3. Start binding watch (Bluetooth, for example)
Screenshots showing the app's 'Add a new device' screen, the 'Searching' screen, and the 'Bluetooth Pairing Request' dialog.
4. After the binding is successful, start to set the functions of the watch in the APP according to your habits

★ IMPORTANT NOTICE ★ How to make music and social media playing?



Basic product functions

1. Motion Real time recording of current steps, distance, and calories Calories 320 kcal Distance 12.06 km Steps 8000 steps	2. Call The watch can dial directly, store 100 phone numbers, and has recent call records Contact Call history Dialpad
3. Heart rate Real time measurement of current heart rate indices. The APP can set an alert index Heart rate 70 bpm Max 120 Min 56	4. Blood oxygen Real time automatic measurement of blood oxygen saturation, can also be actively measured, and vibration prompts indicate measurement completion. Blood oxygen 97% Max 98% Min 94%

5. Blood pressure Timely measure the high and low voltage at that time and synchronize it with the APP Blood pressure 120/80 Max Min	6. Sleep monitoring Wenn Sie eine Uhr in den Schlaf tragen, überwacht die Uhr automatisch Daten wie Tiefschlaf, leichter Schlaf, Wachzustand und Augenbewegung Sleep 07h 26m 23:00 08:00
7. Weather forecast After successfully connecting to the app, the watch can view the weather conditions of the day and the past few days Shen Zhen Cloudy 24° 20/28°C Medium 60% Rainy	8. Information reminder Watch saves the last 8 message prompts. Click to view the content, or click to clear the message Information Wechat 08:00 Li sir: Turning to "new kinetic ener..." Wechat 08:00 Li sir: Turning to "new kinetic ener..."
9. 100+ Sport mode Enter the selected sports mode and start, swipe to the right to pause, stop, or continue Exercise Outdoor run Indoor run Outdoor walk	10. Voice Assistant Click on voice, speak to the watch, and control the phone to achieve the goal Voice assistant Click the screen to start
11. Music control Watch Bluetooth plays music from the phone, can pause/play, previous, next, volume adjustment Music Lost Control	12. SOS Synchronize the emergency number to the watch end in the app, and click on SOS to make a call. SOS
13. Bluetooth photography Open Bluetooth camera in the app, click on the watch to control the phone to take photos Camera	14. Game Built in multiple entertainment decompression games Total score: 0038
15. Breathing exercise Set the time and frequency in the watch, follow the practice, and achieve the purpose of breathing training. Inhalo...	

- Other functions of the watch :**
Do Not Disturb Mode/Stopwatch/Countdown/Flashlight/Calculator/
Female Physiological Cycle/Call Reminder/Alarm clock reminder/
long sitting reminder/Find phone /goal achievement reminder

Matters needing attention

- 1, Please avoid strong impact, high temperature and exposure to the sun.
- 2, Do not disassemble, repair or modify the machine by yourself.
- 3, This machine can be charged with 5V 500MA -- 5V 2A charger.
It is strictly prohibited to use the over-voltage load power supply for charging.
- 4, It is prohibited to charge when there is water stain.
- 5, This product is an electronic consumption monitoring product and is not used for medical purposes.
The measured data are for reference only.

FCC Warning Statement
Changes or modifications not expressly approved by the party responsible for compliance could void the user's authority to operate the equipment. This equipment has been tested and found to comply with the limits for a Class B digital device, pursuant to Part 15 of the FCC Rules. These limits are designed to provide reasonable protection against harmful interference in a residential installation. This equipment generates uses and can radiate radio frequency energy and, if not installed and used in accordance with the instructions, may cause harmful interference to radio communications. However, there is no guarantee that interference will not occur in a particular installation. If this equipment does cause harmful interference to radio or television reception, which can be determined by turning the equipment off and on, the user is encouraged to try to correct the interference by one or more of the following measures:
-- Reorient or relocate the receiving antenna.
-- Increase the separation between the equipment and receiver.
-- Connect the equipment into an outlet on a circuit different from that to which the receiver is connected.
-- Consult the dealer or an experienced radio/TV technician for help.
FCC Radiation Exposure Statement
The device has been evaluated to meet general RF exposure requirement. The device can be used in portable exposure condition without restriction. This device complies with Part 15 of the FCC Rules.
Operation is subject to the following two conditions:
(1) This device may not cause harmful interference, and
(2) This device must accept any interference received, including interference that may cause undesired operation.