

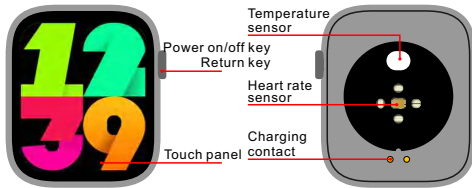

SMART WATCH User Manual Model No.:QX7 Pro

Basic introduction to the product

1 , Appearance introduction



2 , Watch strap installation method

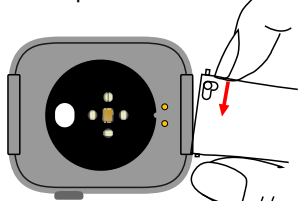

Basic Product Operation



- 1.Press the key for 3 seconds to turn on or off, and press it briefly to return to the main interface
- 2.On the main interface, long press for 3 seconds to switch the dial.
- 3.Slide the screen up, down, left and right to access various functions.

APP download, installation and use

- 1.Scan the following QR code or enter each major application market to download and install "GloryFit"

Equipment requirements: ios 8.0 and above; Android 4.4 and above



GloryFit

- 2.After the download is completed, start the new user registration or third-party login.And improve personal basic information

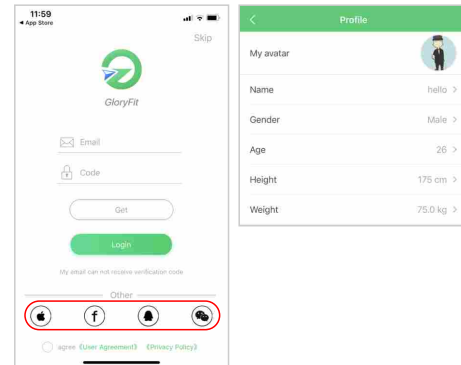

3.Start binding watch (Bluetooth, for example)

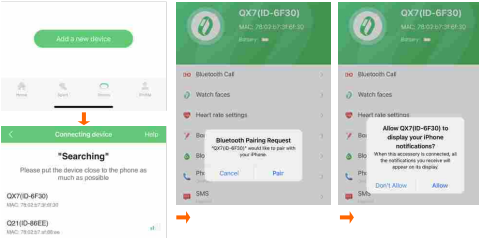

- 4.After the binding is successful, start to set the functions of the watch in the APP according to your habits

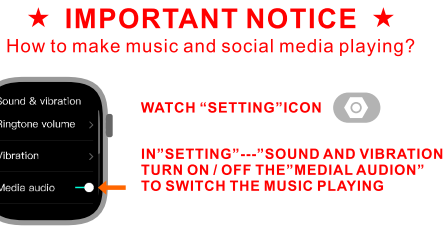

Basic product functions

- 1.Main interface/dial
Long press the main interface for 3 seconds to switch the dial
- 2.Motion state
Record the current steps, distance and calories in real time
- 3.Temperature monitoring
The current body temperature can be measured in time and uploaded to the APP for recording.

4.Heart rate monitoring

Switch to the heart rate monitoring interface, start to automatically measure the current index of heart rate, and slide to exit the measurement.Real time heart rate measurement can be turned on or off in APP settings

5.Blood oxygen saturation monitoring

Enter the blood oxygen saturation interface to start the measurement, and the vibration indicates that the measurement is completed.

6.Blood pressure monitoring

The current high voltage and low voltage can be measured in time and synchronized to the APP

(Please note that this function is not enabled in some versions)

7.Sleep monitoring

Switch the sleep monitoring interface to view the sleep situation last night. When wearing a watch to sleep, the watch willAutomatic monitoring of deep sleep, shallow sleep, awake, total duration.

8.Weather forecast

After successful APP connection, you can view the weather conditions of the current day and recent days

9.Information reminder

The watch saves the last 8 information prompts. Click to view the contents, or click to clear the information

10.100+ Sport mode

Click the sport mode to enter the sport list, click the selected sport mode to start calculation, and slide to the rightPause, stop, or continue

11.Voice Assistant

Click the voice assistant and speak to the watch to control the phone to achieve the goal

12.Bluetooth call

The watch dials directly and can store 100 phone numbers. The watch has recent call records

13.Find your phone

Click Search, and the phone will sound a reminder.
(The audio button on the watch should be turned off)

14.Music control

Click the music control to pause/play, the previous song, the next song, and the volume adjustment

15.Remote control photography

Click the watch to control the phone to take photos

16.SOS

The emergency number can be stored in the APP and synchronized to the watch end. Click it to make a circular call.

17.Game

Built in 2 entertainment games

18.Respiratory training

Time and frequency can be set to achieve the purpose of training your breathing effect.

Other functions of the watch :

Do Not Disturb Mode/Stopwatch/Countdown/Flashlight/Calculator/
Female Physiological Cycle/Call Reminder/Message Reminder/
Alarm clock reminder/long sitting reminder/
goal achievement reminder

Matters needing attention

- 1 , Please avoid strong impact, high temperature and exposure to the sun.
- 2 , Do not disassemble, repair or modify the machine by yourself.
- 3 , This machine can be charged with 5V 500MA -- 5V 2A charger.
It is strictly prohibited to use the over-voltage load power supply for charging.
- 4 , It is prohibited to charge when there is water stain.
- 5 , This product is an electronic consumption monitoring product and is not used for medical purposes.
The measured data are for reference only.

Notice:

The company reserves the right to modify the contents of this manual without any notice.It is normal that some functions are different in specific software versions.

FCC Warning

This device complies with part 15 of the FCC Rules. Operation is subject to the following two conditions:

- (1) This device may not cause harmful interference, and (2) this device must accept any interference received, including interference that may cause undesired operation.
- Any Changes or modifications not expressly approved by the party responsible for compliance could void the user's authority to operate the equipment.

Note: This equipment has been tested and found to comply with the limits for a Class B digital device, pursuant to part 15 of the FCC Rules. These limits are designed to provide reasonable protection against harmful interference in a residential installation. This equipment generates uses and can radiate radio frequency energy and, if not installed and used in accordance with the instructions, may cause harmful interference to radio communications. However, there is no guarantee that interference will not occur in a particular installation. If this equipment does cause harmful interference to radio or television reception, which can be determined by turning the equipment off and on, the user is encouraged to try to correct the interference by one or more of the following measures:

- Reorient or relocate the receiving antenna.
- Increase the separation between the equipment and receiver.
- Connect the equipment into an outlet on a circuit different from that to which the receiver is connected.
- Consult the dealer or an experienced radio/TV technician for help.

The device has been evaluated to meet general RF exposure requirement. The device can be used in portable exposure condition without restriction.