



INSTRUCTIONS FOR USE



D · **GB** · F · I · E · P · TR

You have chosen a hearing system from HANSATON

We take pleasure in your choice and congratulate you on your decision, because with a HANSATON hearing system you own a high-quality product of the most modern technology. For more than 50 years, we have been helping people with our devices to achieve better hearing and better speech understanding, hence a higher quality of life.

Behind our products stand many years of development and production experience, as a corporate philosophy centred on people and their needs.

If you read this brochure carefully and follow the advice on use and care, you will get much enjoyment from your new hearing system.

This product has passed every phase of the independently-certified HANSATON quality management system.



Contents

Your hearing system	Page 30	Functionalities	Page 41
Intended use	Page 32	– i-com/i-com2	Page 41
General notes on safety	Page 33	– Power-on-delay	Page 41
Changing batteries	Page 35	Advice on care	Page 42
Inserting and removing your hearing system	Page 37	– Daily cleaning	Page 42
Turning your hearing system on/off	Page 38	– Domes and Receiver Molds	Page 43
– Via battery compartment	Page 38	– Exchanging the Receiver Unit	Page 46
– Via pushbutton	Page 38	Accessories	Page 47
How to tell which system is which	Page 39	Trouble shooting	Page 48
Changing the hearing program	Page 39	Technical Information	Page 50
– Via program pushbutton	Page 39	Disposal information	Page 50
– Via remote control	Page 40		

Your hearing system



Features

- 1 Receiver Unit
- 2 Dome
- 3 Microphone cover
- 4 Battery compartment
- 5 Program pushbutton
- 6 Receiver Mold
- 7 C-Guard



Caution

Risk of injury caused by incorrect use of Domes.

- Always wear the Receiver Unit with the Dome.
- Make sure that the Dome is completely attached to the Receiver Unit.
- If the Dome remains in your ear, have it removed by a medical professional.
- Replace the Dome if it breaks.
- Insert the Receiver Unit with the Dome carefully and not too deeply into the ear.

- Use the Receiver Unit and Dome only in the manner described in this user guide.

Your hearing system professional offers an assortment of receiver lengths and Dome sizes to best fit your ear.



Intended use

Hearing systems are intended to improve the hearing of hearing impaired persons. Diagnosis and prescription of a hearing system must be performed by hearing health specialists, e.g. ENT doctors, audiologists or acousticians.

Read and follow the instructions of this user guide to avoid injuries or damage to the hearing system.

Symbols



WARNING! points out a situation that could lead to serious injuries.

CAUTION! indicates a situation that could lead to minor and moderate injuries.



indicates possible property damage.



Advice and tips on how to handle your hearing system better.

- Instruction. Indicates that something has to be done.

Indicates an option that not every hearing system has. Ask your hearing system professional to check off the relevant information.

General notes on safety

Your hearing system is sensitive to extreme heat, high humidity, strong magnetic fields (> 0.1T), X-rays and mechanical stress.

- Do not expose your hearing system to extreme temperature or high humidity.
- Do not leave it in direct sunlight.
- Do not wear it in the shower or when you apply make-up, perfume, aftershave, hairspray or suntan lotion.
- Do not wear your hearing system when you are exposed to short-waves, a strong magnetic field, a high frequency field or X-rays.



WARNING!

Choking hazard posed by small parts.

- Keep hearing systems, batteries and accessories out of children's reach.
- If swallowed consult a physician or hospital immediately.
- If infants, small children or mentally disabled persons need to wear hearing systems ensure adequate supervision.



WARNING!

Risk in explosive environments, e.g. mining areas!

- Don't use your hearing systems (and remote control) in areas where there is a danger of explosions.
- i** In some countries restrictions for the usage of wireless equipment exist.
- Refer to local authorities for further information.

Changing batteries

Battery type: 312

- If the sound becomes fainter or you hear alerting signals, change the standard battery or charge the rechargeable battery.
- Always use the right size battery.
- Open the battery compartment and insert the new battery. Make sure the battery and compartment symbols are aligned.

Battery type
original size

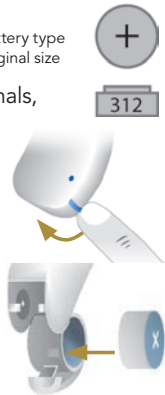

- Close the battery compartment.
- If it does not close easily, check to see if the battery was inserted properly.
- When the battery door is completely closed, your hearing system is ready for use.



With a new battery, it may take a few minutes for the battery to develop its full output. Only then you should close the battery compartment.

Safety instructions



WARNING!

Never attempt to recharge batteries that are not designed for that purpose (danger of explosion)!

Leaking batteries damage the system.

- Remove batteries when the hearing systems are not in use for a prolonged period of time.
- Turn your hearing systems off when not in use to preserve the battery.

Batteries contain harmful substances that pollute the environment.

- Do not throw used batteries into household trash.
- Dispose batteries according to national regulations or return them to your hearing system professional.

Inserting and removing your hearing system

Do not use lubricant when you insert the Dome/Receiver Mold, because it may clog the sound outlet.

- For hearing systems with Receiver Mold, handle by holding the Receiver Mold. Do not pull the tube.

Inserting your hearing system

- Turn your hearing system off.
- Hold the receiver with the Dome/Receiver Mold between your thumb and index finger and insert it carefully into the ear canal. You may find it helpful to pull your ear slightly

upward or to the back.

- Place your hearing system behind your ear.
- Turn your hearing system on.

Removing your hearing system

- Turn your hearing system off.
- Hold the Receiver Unit/Receiver Mold between your thumb and index finger and carefully pull it out. You may find it helpful to lightly push your ear from the back.



WARNING!

- Attach the Dome properly. If the Dome remains in the ear, have it removed by your hearing system professional.

Switch your hearing system on and off

Via battery compartment

Switch on

- Close the battery compartment.

Switch off

- Open the battery compartment.



Via pushbutton

Switch on

- Press the pushbutton for 2 seconds.



Switch off

- Press the pushbutton for 2 seconds.

i You can also use the remote control to turn the hearing system on and off.

How to tell which system is which:

In switched-off position the visible colour indicates for which ear the hearing system has been optimised.

Red = right ear **Blue** = left ear



Changing the hearing program

Via pushbutton

- Use the program button to select one of the hearing programs individually programmed for you.
- When changing, your hearing system uses signal sounds to indicate which program you have selected.
The number of signal sounds is based on the relevant program (e. g. 1st program 1 signal sound, 2nd program 2 signal sounds, 3rd program 3 signal sounds, 4th program 4 signal sounds, 5th program: Melody beep).

- You can thus adjust your instrument to the relevant hearing situation and thus, for example, make use of the advantages of MultiMic technology, especially in conversation in groups.

Via remote control

- Refer to the remote control user guide.

Hearing program/Description

1	
2	
3	
4	
5	

Functionalities

Your hearing system professional can activate or deactivate the following functionalities.

i-com/i-com2

- automatically adjusts both hearing systems simultaneously to changes in the hearing system settings, e.g. volume and program.
- allows use of a remote control.

i The performance of i-com2 may be affected by electromagnetic interference – e.g. from a computer monitor or halogen lamp system controlled by a switching power supply.

- Move away from the source of interference if you experience difficulty.

Power-on-delay

- allows you to turn the hearing systems on with an automatic delay of 6, 12 or 18 seconds to avoid feedback (whistling).

Advice on care

Daily cleaning

You are advised to use our HADEO care products to clean your hearing system. These products were developed specifically for this purpose and are available exclusively from your hearing system professional.

Do not put the hearing systems in water.

- Clean hearing systems regularly to prevent damage to the hearing systems and to avoid health problems.



- Our HADEO care booklet can be obtained from your hearing system professional who will be glad to advise you on any questions you may have about caring for your system. with a soft, dry tissue as necessary.
- If the hearing systems sound distorted or weak ask your hearing system professional to exchange the microphone cover.
- The hearing system must be kept dry. Please put it in a HADEO Drying Bag or Drying Container overnight to extract any moisture from the inside of the instrument.

Care Booklet

Our HADEO care booklet can be obtained from your hearing system professional who will be glad to advise you on any questions you may have about caring for your system.



Advice on care

Domes and Receiver Molds



Caution!

Risk of injury caused by incorrect use of Domes.

- Always wear the Receiver Unit with the Dome/Receiver Mold.
- Make sure that the Dome/Receiver Mold is completely attached to the Receiver Unit.
- If the Dome/Receiver Mold remains in your ear, have it removed by a medical professional.



- Replace the Dome/Receiver Mold if it breaks.
- Insert the Receiver Unit with the Dome/Receiver Mold carefully and not too deeply into the ear.
- Use the Receiver Unit and Dome/Receiver Mold only in the manner described in this user guide.

Your hearing systems have one of the following earpieces:



Dome with C-Guard



Grid-Dome



Receiver Mold



- Clean Domes, Grid-Domes and Receiver Molds right after taking the hearing systems off. This way cerumen can not dry and harden.
- Remove cerumen with a soft tissue. If necessary moisten the tissue with a cerumen solvent.

i Full functionality of Domes, Grid-Domes and Receiver Molds is only assured with a working wax guard.

- Do not disassemble the Receiver Mold yourself. Ask your hearing system professional for

help when the Receiver Mold needs extensive cleaning.

Domes, Grid-Domes and Receiver Molds are easily damaged when handled wrongly.

- Never use brushes or sharp objects for cleaning.
- Never use running water or immerse the hearing systems.
- Never use pressure or rotating action while cleaning.
- Don't spray cerumen solvent directly onto the

- C-Guard!
- Do not pull the receiver out of the Receiver Mold.

Cerumen (ear wax) on the Domes, Grid-Domes and Receiver Molds affect sound quality.

Advice on care

Exchanging the Receiver Unit

i The Receiver Unit can be changed as needed by your hearing system professional. If you need to replace the Receiver Unit by yourself follow these directions carefully.



- Turn Receiver Unit 45° counterclockwise.

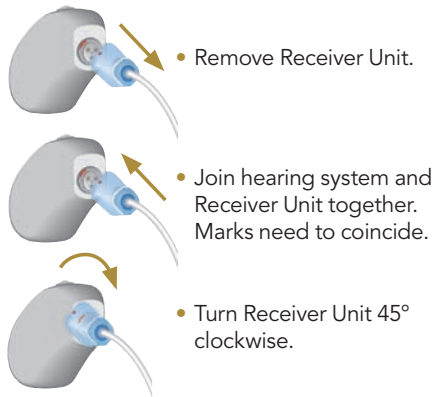

Accessories

Remote control eMote2

The wireless function of your hearing systems allows you to use a remote control to change the program and volume of your hearing systems. For detailed information and instructions refer to the User guide or ask your hearing system professional.

i In case the hearing system is controlled by another person's remote control, return to your hearing system professional with your remote control and hearing systems.

Remote control Media

Your hearing systems together with the Media remote control will allow you to connect your hearing systems to the growing world of technology. Via a special Bluetooth connection it is possible to receive audio signals from your mobile, your television or your mp3-player. For detailed information and instructions refer to the Media user guide or ask your hearing system professional.

Trouble shooting

Your X-Mini hearing systems are reliable devices. Should a problem occur, it can usually be corrected quickly. Use these troubleshooting tips to resolve simple issues. If you still encounter problems after trying these suggestions, consult your hearing system professional.

Problem	Possible Cause	Possible Solution
Sound is weak.	Weak or dead battery. Dome/Receiver Mold clogged. Volume too low.	Insert new standard battery. Clean Receiver Mold/clean or change Dome. Increase volume (with remote control).
Instrument emits whistling sound.	Improper seating in ear. Volume too high. Clogged with wax or excessive wax in ears.	Try reinserting the Receiver Unit until it fits securely. Lower volume (with remote control). Clean Dome/Receiver Mold or contact your hearing system professional.
Sound is distorted.	Volume too high. Weak battery.	Lower volume (with remote control). Replace battery.
Instrument emits signal tones.	Battery compartment not completely closed. Weak battery.	Gently close battery compartment completely. Replace battery.
Instrument does not work.	Instrument is not turned on. Battery compartment not completely closed. Dead battery. Battery polarity reversed. Power-on delay is active.	Turn instrument on. Gently close battery compartment completely. Replace battery. Make sure battery is inserted correctly. Wait 18 seconds and check again.

Technical Information

FCC-ID: WU7-WL002BTE

Operating frequencies: $F_C = 3.28$ MHz

Changes or modifications not expressly approved by the party responsible for compliance could void the users authority to operate the equipment.

This device complies with Part 15 of the FCC Rules.

Operation is subject to the following conditions:

(1) this device may not cause harmful interference, and

(2) this device must accept any interference received, including interference that may cause undesired operation.

This equipment has been tested and found to comply with the limits for a Class B digital device, pursuant to Part 15 of the FCC Rules. These limits are designed to provide reasonable protection against harmful interference in a residential installation. This equipment generates, uses and can radiate radio frequency energy and, if not installed and used in accordance with

the instructions, may cause harmful interference to radio communications. However, there is no guarantee that interference will not occur in a particular installation. If this equipment does cause harmful interference to radio or television reception, which can be determined by turning the equipment off and on, the user is encouraged to try to correct the interference by one or more of the following measures:

- Reorient or relocate the receiving antenna.
- Increase the separation between the equipment and receiver.
- Connect the equipment into an outlet on a circuit different from that to which the receiver is connected.
- Consult the dealer or an experienced radio/TV technician for help.

Disposal information

Within the European Union, the marked equipment is covered by „Directive 2002/96/EC of the European Parliament and of the Council of 27 January 2003 on waste electrical and electronic equipment“.

Amended by „Directive 2003/108/EC“ (WEEE).



i Recycle the device and batteries according to national regulations.

With the CE marking HANSATON confirms compliance with the European Directive 93/42/EEC concerning medical devices.



FDA information (valid for USA only)

Use your hearing systems all day long

The best way to ensure better hearing is to practice listening with your hearing systems until you are able to wear them comfortably all day.

Generally, infrequent use of the hearing system does not provide you with the full benefit of amplification.

Your hearing systems will not restore normal hearing. Hearing systems will not prevent or improve hearing impairment resulting from a physiological condition. Hearing systems will help you to make better use of your residual

hearing.

The use of hearing systems is only part of hearing rehabilitation; auditory training and lip reading instruction may be required as well.

Possible side effects

The hearing system or earmold is a custom-made product. If you are experiencing discomfort, see your audiologist or hearing instrument dispenser immediately for modification of the hearing system or earmold at the point of irritation. A hearing system or earmold may cause an

accelerated accumulation of cerumen (earwax). Also in rare cases, the otherwise non-allergenic material may cause a discharge from the ear, allergic reaction, or any other unusual condition. Please seek immediate consultation with a physician if these conditions occur.

Warning to Hearing Instrument Dispensers

A hearing instrument dispenser should advise a prospective hearing instrument user to consult promptly with a licensed physician (preferably an ear specialist) before dispensing a hearing

instrument if the hearing instrument dispenser determines through inquiry, actual observation, or review of any other available information concerning the prospective user, that the prospective user has any of the following conditions:

- (i) Visible congenital or traumatic deformity of the ear.
- (ii) History of active drainage from the ear within the previous 90 days.
- (iii) History of sudden or rapidly progressive hearing loss within the previous 90 days.
- (iv) Acute or chronic dizziness.

- (v) Unilateral hearing loss of sudden or recent onset within the previous 90 days.
 - (vi) Audiometric air-bone gap equal to or greater than 15 decibels at 500 hertz (Hz), 1,000 Hz and 2,000 Hz.
 - (vii) Visible evidence of significant cerumen accumulation or a foreign body in the ear canal.
 - (viii) Pain or discomfort in the ear.
- Special care should be exercised in selecting and fitting a hearing instrument whose maximum sound pressure level exceeds 132 decibels because there may be risk of impairing the re-

maintaining hearing of the hearing instrument user.

Important Notice for Prospective Hearing Instrument Users

Good health practice requires that a person with a hearing loss have a medical evaluation by a licensed physician (preferably a physician who specializes in diseases of the ear) before purchasing a hearing instrument. Licensed physicians who specialize in diseases of the ear are often referred to as otolaryngologists, otologists or otorhinolaryngologists. The purpose of

medical evaluation is to assure that all medically treatable conditions that may affect hearing are identified and treated before the hearing instrument is purchased.

Following the medical evaluation, the physician will give you a written statement that states that your hearing loss has been medically evaluated and that you may be considered a candidate for a hearing instrument. The physician will refer you to an audiologist or a hearing instrument dispenser, as appropriate, for a hearing instrument evaluation.

The audiologist or hearing instrument dispenser will conduct a hearing instrument evaluation to assess your ability to hear with and without a hearing instrument. The hearing instrument evaluation will enable the audiologist or dispenser to select and fit a hearing instrument to your individual needs.

If you have reservations about your ability to adapt to amplification, you should inquire about the availability of a trial-rental or purchase-option program. Many hearing instrument dispensers now offer programs that permit you to wear

a hearing instrument for a period of time for a nominal fee after which you may decide if you want to purchase the hearing instrument. Federal law restricts the sale of hearing instruments to those individuals who have obtained a medical evaluation from a licensed physician. Federal law permits a fully informed adult to sign a waiver statement declining the medical evaluation for religious or personal beliefs that preclude consultation with a physician. The exercise of such a waiver is not in your best health interest and its use is strongly discouraged.

Children with hearing loss

In addition to seeing a physician for a medical evaluation, a child with a hearing loss should be directed to an audiologist for evaluation and rehabilitation since hearing loss may cause problems in language development and the educational and social growth of a child. An audiologist is qualified by training and experience to assist in the evaluation and rehabilitation of a child with a hearing loss.

Identification information

The year of manufacture is incorporated into the serial number. The warranty is based upon the date of purchase, not date of manufacture. The serial number may look similar to this sample: AJ12345. The second letter of this serial number refers to the date of manufacture of the hearing system. The letters progress in one-year increments, each reflecting the corresponding year. The letter J means the year of manufacture is 2002, the letter K indicates that the manufacture year is 2003, and so on. Your hearing system

professional can answer any questions you may have about the identifying code on your hearing system.