



INSTRUCTIONS FOR USE



D · **GB** · F · I · E · P · TR

You have chosen a Hearing System from HANSATON

We take pleasure in your choice and congratulate you on your decision, because with a HANSATON hearing system you own a high-quality product of the most modern technology. For more than 50 years, we have been helping people with our devices to achieve better hearing and better speech understanding, thus a higher quality of life.

Behind our products stand many years of development and production experience, as a corporate philosophy centered on people and their needs.

If you read this brochure carefully and follow the advice on use and care, you will get much enjoyment from your new hearing system.

This product has passed every phase of the independently-certified HANSATON quality management system.

Contents

| | | | |
|------------------------------------|---------|--------------------------|---------|
| Your Hearing System | Page 30 | – Via Program Pushbutton | Page 41 |
| Intended Use | Page 31 | – Via Remote Control | Page 42 |
| General Notes on Safety | Page 33 | Functionalities | Page 43 |
| Installation and Battery Change | Page 36 | – i-com/i-com2 | Page 43 |
| Turning Your Hearing System On/Off | Page 39 | – Power-on-Delay | Page 43 |
| – Via Battery Compartment | Page 39 | Advice on Care | Page 44 |
| – Via Pushbutton | Page 39 | Accessories | Page 46 |
| – Via Remote Control | Page 39 | Terms | Page 46 |
| How To Tell Which System is Which | Page 40 | Troubleshooting | Page 49 |
| Adjusting Volume | Page 40 | Technical Information | Page 51 |
| – Via Volume Control | Page 40 | Disposal Information | Page 53 |
| – Via Remote Control | Page 41 | FDA Information | Page 54 |
| Switching Hearing Program | Page 41 | | |

Standard



Open

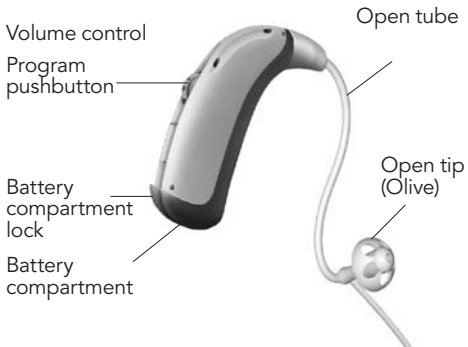

Option: Remote control

The remote control functions are outlined in a separate instruction manual.

Intended Use

Hearing systems are intended to improve the hearing of hearing-impaired persons. Diagnosis and prescription of a hearing system must be performed by hearing health specialists (e.g., ENT specialists, audiologists,).

Read and follow the instructions of this user guide to avoid injuries or damage to the hearing system.

Symbols



WARNING! points out a situation that could lead to serious injuries.

CAUTION! indicates a situation that could lead to minor and moderate injuries.



indicates possible property damage.



Advice and tips on how to handle your hearing system better.

- Instruction. Indicates that there is something you must do.



Indicates an option that not every hearing system has. Ask your hearing system professional to checkmark the relevant information.

General Notes on Safety

Your hearing system is sensitive to extreme heat, high humidity, strong magnetic fields (>0.1T), Xrays, and mechanical stress.

- Do not expose your hearing system to extreme temperature or high humidity.
- Do not leave it in direct sunlight.
- Do not wear it in the shower or when you apply makeup, perfume, aftershave, hairspray or suntan lotion.

- Do not wear your hearing system when you are exposed to short-waves, a strong magnetic field, a high-frequency field or X-rays.
- Do not place your hearing systems in the microwave.

i When using mobile telephones, however, electromagnetic-field effects cannot be ruled out.



WARNING!

Choking hazard posed by small parts.

- Keep hearing systems, batteries, and accessories out of children's reach.
- If swallowed, immediately consult a physician or hospital.
- If infants, small children, or mentally disabled persons need to wear hearing systems ensure adequate supervision.



WARNING!

Risk in explosive environments, e.g. mining areas!

- Don't use your hearing systems (and remote control) in areas where there is a danger of explosions.
- **i** In some countries restrictions on the use of wireless equipment exist.
- Consult local authorities for further information.



WARNING!

- Never use a tip that has been worn by someone else or if it becomes dirty, torn, or disfigured.
- Only use tips. Tips from other manufacturers will not yield the best performance or proper fit.
- Do not insert the hearing aid if you think you may have a foreign object in the ear canal.
- The hearing aid and tips are made of modern non-allergenic materials. Still, in rare cases, skin irritation can occur. If you experience

discomfort or skin irritation in the ear or in the ear canal, discontinue use, and contact your Physician immediately.

- If tip is lodged in your ear canal, please see a Physician immediately to ensure it is safely removed.

Installation and Battery Change

Battery type: 312

- Open the battery compartment and insert the battery into the compartment, so that the negative pole faces into the compartment.
- Close the compartment.

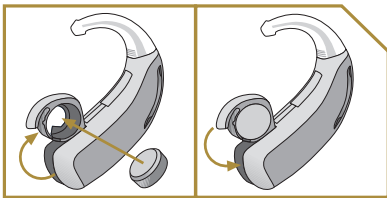

With a new battery, it may take a few minutes for the battery to develop its full output. Only then should you close the battery compartment.



negative pole



Battery Compartment Lock

To lock or unlock, move the slide with a suitable pointed tool.

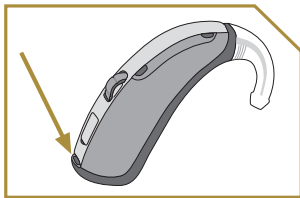

Safety Instructions



WARNING!

Never attempt to recharge batteries that are not designed for that purpose (danger of explosion)!

Leaking batteries damage the system.

- Remove batteries when the hearing systems are not in use for a prolonged period of time.
- To preserve the battery, turn your hearing systems off when not in use.

Batteries contain harmful substances that pollute the environment.

- Do not throw used batteries into household trash.
- Dispose of batteries according to federal and local regulations, or return them to your hearing system professional.

Switch Your Hearing System On and Off

Via battery compartment

Switch On

- Close the battery compartment.

Switch Off

- Open the battery compartment as far as the first stop.

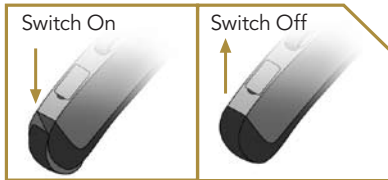

Via Pushbutton

Switch On

- Press the pushbutton for 2 seconds.

Switch Off

- Press the pushbutton for 2 seconds.

Via Remote Control

- Refer to the remote control user guide.

How to Tell Which System is Which:

When switched off, the visible color indicates for which ear the hearing system has been optimized.

Red = right ear **Blue** = left ear

Adjusting Volume

With Volume Control

You can adjust the loudness of your hearing system using the volume control on the back of the hearing system.

Quietest position:

controller back

Loudest position:

controller front

Option: Remote control

If you have reached the maximum or minimum

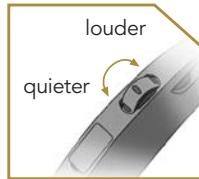

volume, short signals sound in succession.

Via Remote Control

- Refer to the remote control user guide.

Switching Hearing Programs

Via Pushbutton

- Use the program pushbutton to select one of the hearing programs individually programmed for you.
- When changing, your hearing system uses signal sounds to indicate which program you have selected.

The number of signal sounds is based on the relevant program (e.g., 1st program: 1 signal sound,



2nd program: 2 signal sounds, 3rd program: 3 signal sounds, 4th program: 4 signal sounds, 5th program: melody beep).

- You can thus adjust your instrument to the relevant hearing situation and, for example, make use of the advantages of MultiMic technology, especially in conversation in groups.

Via Remote Control

- Refer to the remote control user guide.

Hearing Program/Description

| | |
|---|--|
| 1 | |
| 2 | |
| 3 | |
| 4 | |
| 5 | |

Functionalities

Your hearing system professional can activate or deactivate the following functionalities.

i-com/i-com2

- Automatically adjusts both hearing systems simultaneously to changes in the hearing system settings (e.g., volume and program).
- Allows use of a remote control.

i The performance of i-com2 may be affected by electromagnetic interference – for example, from a computer monitor or halogen lamp system controlled by a switching power supply.

- Move away from the source of interference if you experience difficulty.

Power- on- Delay

- Allows you to turn the hearing systems on with an automatic delay of 6, 12, or 18 seconds to avoid feedback (whistling).

Advice on Care (Standard)

- You are advised to use our HADEO care products to clean your hearing system. These products were developed specifically for this purpose and are available exclusively from your hearing system professional.
- When necessary, remove the sound tube from the hearing system and put the earmould for at least 15 minutes into the HADEO cleaning liquid.

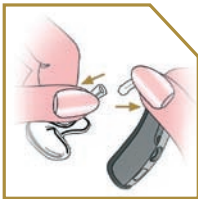

- The hearing system itself must **not** be placed in water or cleaning fluid. Clean your hearing system (preferably in the morning) with a soft cloth, keeping it dry.
- The hearing system must be kept dry. Please put it in a HADEO DryBox, Drying Bag, or Drying Container overnight to remove any moisture from inside the system.

Care Primer

Our HADEO care primer can be obtained from your hearing system professional who will be glad to advise you on any questions you may have about caring for your system.



Advice on Care (Open)

- You are advised to use our HADEO care products to clean your hearing system. These products were developed specifically for this purpose and are available exclusively from your hearing system professional.
- The hearing system itself must **not** be placed in water or cleaning fluid.
- The hearing system must be kept dry. Please put it in a HADEO DryBox, Drying Bag, or Drying Container overnight to remove any moisture from inside the instrument.

- Clean your hearing system (preferably in the morning) with a soft cloth, keeping it dry. The sound outlet openings can be freed of residues using a small brush.
- If required, disconnect the hearing system from the Open tube. Starting from the hearing system side, push the cleaning wire completely through the Open tube.

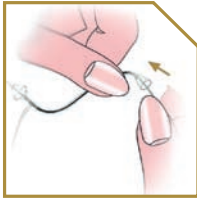

Care Primer

Our HADEO care primer can be obtained from your hearing system specialist who will be glad to advise you on any questions you may have about caring for your system.



Accessories

Remote Control eMote/eMote2

The wireless function of your hearing systems allows you to use a remote control to change the program and volume of your hearing systems. For detailed information and instructions, refer to the user guide, or ask your hearing system professional.



 If the hearing system is controlled by another person's remote control, return to your hearing system professional with your remote control and hearing systems.

Remote Control Media

Your hearing systems, together with the Media remote control, will allow you to connect your hearing systems to the growing world of technology. Using a special Bluetooth connection, it is possible to



receive audio signals from your mobile phone, your television, or your Mp3 player. For detailed information and instructions, refer to the Media user guide or ask your hearing system professional.

Terms

The **telephone coil** allows inductive signal reception (e.g., when telephoning). The reception of noise through the microphone is reduced or suppressed.

Please refer all questions concerning your hearing instrument to your hearing system professional.

Troubleshooting

Should a problem occur, you can usually correct it quickly. Use these troubleshooting tips to resolve simple issues.

If you still encounter problems after trying these suggestions, consult your hearing system professional.

| Problem | Possible Cause | Possible Solution |
|-----------------------------------|---|---|
| Sound is weak. | Weak or dead battery. Dome/Receiver Mold clogged. Volume too low. | Insert new standard battery. Clean Dome/Receiver Mold. Increase volume (with remote control). |
| Instrument emits whistling sound. | Improper proposition in ear. Volume too high. Clogged with wax or excessive wax in ears. | Try reinserting the Receiver Unit until it fits securely. Lower volume (with remote control). Clean Dome/Receiver Mold, or contact your hearing system professional. |
| Sound is distorted. | Volume too high. Weak battery. | Lower volume (with remote control). Replace battery. |
| Instrument emits signal tones. | Battery compartment not completely closed. Weak battery. | Gently close battery compartment completely. Replace battery. |
| Instrument does not work. | Instrument is not turned on. Battery compartment not completely closed. Dead battery. Battery polarity reversed. Power-on-delay is active. | Turn instrument on. Gently close battery compartment completely. Replace battery. Make sure battery is inserted correctly. Wait 18 seconds and check again. |

Technical Information

FCC-ID: WU7-WL002SLIM

Operating frequencies: $F_c = 3.28$ MHz

Changes or modifications not expressly approved by the party responsible for compliance could void the user's authority to operate the equipment.

This device complies with Part 15 of the FCC Rules.

Operation is subject to the following conditions:

(1) This device may not cause harmful interference, and

(2) This device must accept any interference received, including interference that may cause undesired operation.

This equipment has been tested and found to comply with the limits for a Class B digital device, pursuant to Part 15 of the FCC Rules. These limits are designed to provide reasonable protection against harmful interference in a residential installation. This equipment generates, uses, and can radiate radio frequency energy and, if not, installed and used in accordance with

the instructions, may cause harmful interference to radio communications. However, there is no guarantee that interference will not occur in a particular installation. If this equipment does cause harmful interference to radio or television reception, which can be determined by turning the equipment off and on, the user is encouraged to try to correct the interference by one or more of the following measures:

- Reorient or relocate the receiving antenna.
- Increase the separation between the equipment and receiver.

- Connect the equipment into an outlet on a circuit different from that to which the receiver is connected.
- Consult the dealer or an experienced radio/TV technician for help.

Disposal information

Within the European Union, the marked equipment is covered by „Directive 2002/96/EC of the European Parliament and of the Council of 27 January 2003 on waste electrical and electronic equipment“.

Amended by „Directive 2003/108/EC“ (WEEE).



i Recycle the device and batteries according to national regulations.

With the CE marking HANSATON confirms compliance with the European Directive 93/42/EEC concerning medical devices.



0124

FDA Information (valid for USA only)

Use Your Hearing Systems All Day Long

The best way to ensure better hearing is to practice listening with your hearing systems until you are able to wear them comfortably all day.

Generally, infrequent use of the hearing system does not provide you with the full benefit of amplification.

Your hearing systems will not restore normal hearing. Hearing systems will not prevent or improve hearing impairment resulting from a physiological condition. Hearing systems will help you to make better use of your residual

hearing.

The use of hearing systems is only part of hearing rehabilitation; auditory training and lip reading instruction may be required as well.

Possible Side Effects

The hearing system or earmold is a custom-made product. If you are experiencing discomfort, see your audiologist or hearing system professional immediately for modification of the hearing system or earmold at the point of irritation. A hearing system or earmold may cause an

accelerated accumulation of cerumen (earwax). Also in rare cases, the otherwise non-allergenic material may cause a discharge from the ear, allergic reaction, or any other unusual condition. Please seek immediate consultation with a physician if these conditions occur.

Warning to Hearing System Professionals

A hearing system professional should advise a prospective hearing system user to consult promptly with a licensed physician (preferably an ear specialist) before dispensing a hear-

ing system if the hearing system professional determines through inquiry, actual observation, or review of any other available information concerning the prospective user, that the prospective user has any of the following conditions:

- (i) Visible congenital or traumatic deformity of the ear.
- (ii) History of active drainage from the ear within the previous 90 days.
- (iii) History of sudden or rapidly progressive hearing loss within the previous 90 days.
- (iv) Acute or chronic dizziness.

- (v) Unilateral hearing loss of sudden or recent onset within the previous 90 days.
 - (vi) Audiometric air-bone gap equal to or greater than 15 decibels at 500 hertz (Hz), 1000 Hz and 2000 Hz.
 - (vii) Visible evidence of significant cerumen accumulation or a foreign body in the ear canal.
 - (viii) Pain or discomfort in the ear.
- Special care should be exercised in selecting and fitting a hearing system whose maximum sound pressure level exceeds 132 decibels because there may be risk of impairing the remain-

ing hearing of the hearing system user.

Important Notice for Prospective Hearing System Users

Good health practice requires that a person with a hearing loss have a medical evaluation by a licensed physician (preferably a physician who specializes in diseases of the ear) before purchasing a hearing system. Licensed physicians who specialize in diseases of the ear are often referred to as otolaryngologists, otologists, or otorhinolaryngologists. The purpose of

medical evaluation is to assure that all medically treatable conditions that may affect hearing are identified and treated before the hearing system is purchased.

Following the medical evaluation, the physician will give you a written statement that states that your hearing loss has been medically evaluated and that you may be considered a candidate for a hearing instrument. The physician will refer you to an audiologist or a hearing system professional, as appropriate, for a hearing system evaluation.

The audiologist or hearing system professional will conduct a hearing system evaluation to assess your ability to hear with and without a hearing system. The hearing system evaluation will enable the audiologist or dispenser to select and fit a hearing system to your individual needs.

If you have reservations about your ability to adapt to amplification, you should inquire about the availability of a trial-rental or purchase-option program. Many hearing system professionals now offer programs that permit you to

wear a hearing system for a period of time for a nominal fee after which you may decide if you want to purchase the hearing system. Federal law restricts the sale of hearing systems to those individuals who have obtained a medical evaluation from a licensed physician. Federal law permits a fully informed adult to sign a waiver statement declining the medical evaluation for religious or personal beliefs that preclude consultation with a physician. The exercise of such a waiver is not in your best health interest and its use is strongly discouraged.

Children with Hearing Loss

In addition to seeing a physician for a medical evaluation, a child with a hearing loss should be directed to an audiologist for evaluation and rehabilitation since hearing loss may cause problems in language development and the educational and social growth of a child. An audiologist is qualified by training and experience to assist in the evaluation and rehabilitation of a child with a hearing loss.

Identification Information

The year of manufacture is incorporated into the serial number. The warranty is based upon the date of purchase, not date of manufacture. The serial number may look similar to this sample: AJ12345. The second letter of this serial number refers to the date of manufacture of the hearing system. The letters progress in one-year increments, each reflecting the corresponding year. The letter J means the year of manufacture is 2002, the letter K indicates that the manufacture year is 2003, and so on. Your hearing system

professional can answer any questions you may have about the identifying code on your hearing system.



OTHER WARNINGS!

- Do not use your hearing system in potentially explosive environments.
- If you experience dizziness, drainage or bleeding from the ear, or sudden hearing loss, see your Physician immediately.
- A hearing system may cause an accelerated accumulation of cerumen (earwax).
- Keep hearing systems out of the reach of children, pets, and individuals with diminished mental capacity.
- Hearing systems should be used only as directed and adjusted by your trained hearing system professional.
- A hearing system may stop functioning, e.g. if the battery goes dead. You should be aware of this possibility, in particular if you are in traffic or otherwise depend on warning sounds.
- Do not switch hearing systems between ears or allow others to wear or use your hearing systems.

- HEARING SYSTEMS WILL NOT RESTORE NORMAL HEARING AND WILL NOT PREVENT OR IMPROVE A HEARING IMPAIRMENT RESULTING FROM ORGANIC CONDITIONS.
- IN MOST CASES, INFREQUENT USE OF A HEARING SYSTEM DOES NOT PERMIT USER TO ATTAIN FULL BENEFIT FROM IT.
- THE USE OF THE HEARING SYSTEM IS ONLY PART OF HEARING HABILITATION AND MAY NEED TO BE SUPPLEMENTED BY AUDITORY TRAINING AND INSTRUCTION IN LIP READING.