

eNote Board Installation

User Manual V2.0





Table of contents

TABLE OF CONTENTS.....	2
Safety Information.....	3
Product Information.....	5
Package Checklist.....	5
Cable Connection.....	6
LED status and functions.....	8
Taking and Erasing Notes.....	9
ENOTE BOARD APP.....	10
Installation of eNote in Android OS.....	10
Installation of eNote in iOS.....	11
How to Log-in.....	12
Login Page.....	12
Gesture.....	13
Detail Functions.....	13
Marker Pen.....	13
Library.....	14
Save Page.....	14

NOTE

For your own safety, please read this User Manual carefully before use. Follow all the installation instructions carefully and keep this User Manual properly for future reference.

Safety Information

Meaning of Signal Words	
 WARNING	Indicates a potential hazard that could result in serious injury or death and/or property damage.
 CAUTION	Indicates hazards that could result in minor or moderate injury and/or property damage.

1. Safety Information (Continue....)

- Follow all the installation instructions carefully.
- This product is designed and intended for indoor use only.
- Do not expose this product to water or moisture in order to avoid fire and electric shock. Do not operate this product in a damp environment.
- Always place this product on stable and level surface.
- Use only the designated wall mount or mobile stand hardware.
- Always use this product at the indicated supply voltage only. Failure to do so may result in fire, electric shock, or product damage.
- Use only the included power cord, power plug or power adaptor. Use of other types of power cord, power plug, or adaptor may result in fire or electric shock.
- Always insert the power plug or power adaptor fully into the power outlet. Otherwise, it may result in overheat, electric shock or fire.

1. Safety Information (Continue....)**WARNING**

- If the power plug does not fit into the power outlet, contact a licensed electrician to replace the obsolete outlet.
- When unplugging the power plug or power adaptor, hold it by the plug. Do not pull on the power cord as it may damage to the power cord and may cause fire or electric shock.
- Do not bend or twist, or place any heavy object on the power cord.
- Protect the power cord from being walked on or pinched particularly at plugs, convenience receptacles, and the point where they exit from the apparatus.
- Do not open or alter the casing of this product. Electric shock or injury may result.
- Do not attempt to repair, modify, or disassemble this product. If any part of this product is damaged or frayed, contact an authorized service representative.
- Never handle this product with wet hands as it may result in electric shock.
- If the product emits smoke, excessive heat, abnormal smell or unusual noise, turn off the product and unplug the power plug immediately. Contact an authorized service representative.
- Do not insert any metallic objects into this product or into a contact.
- Unplug the power plug or power adaptor before cleaning. Always use a dry, soft cloth for cleaning.
- Carefully locate any parts and/or accessories of this product to avoid potential tripping hazards.
- Do not operate this product at high temperature and/or high humidity environment. Application ambient conditions: Temperature: 10°C to 40°C; Humidity: 10% to 80%; Non-condensing.

Product Information

Package Checklist

eNote Board		
Item	Description	Quantity
1	eNote Board	1
2	Power Adapter	1
3	User Manual	1

Note: Please contact your local distributor for more details.



CAUTION

- Do not install this product in location where it may be exposed directly to sunlight, near heating equipment, or near air-conditioning vents.
- Do not install this product in strong sunlight or strong lighting location.
- Do not install this product in location where the temperature may change suddenly.

Installation

Wall mount

46" enote board

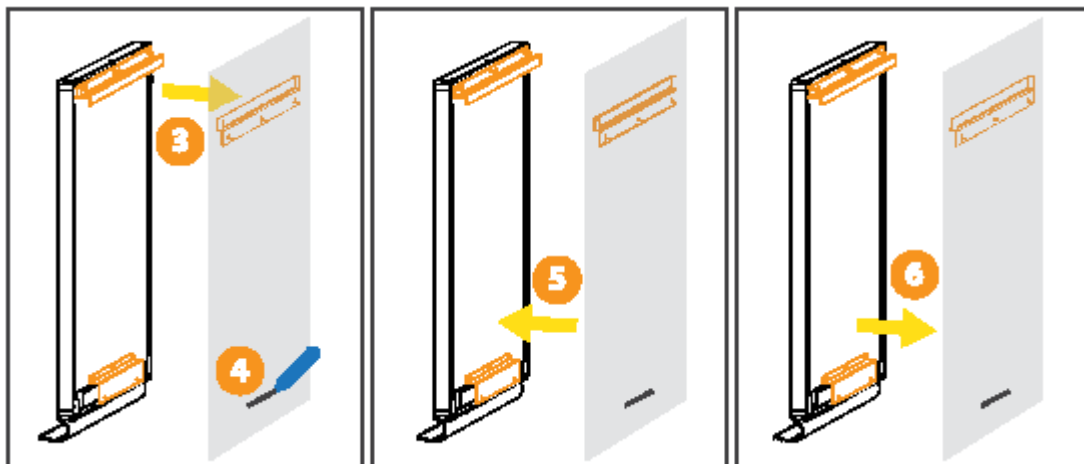
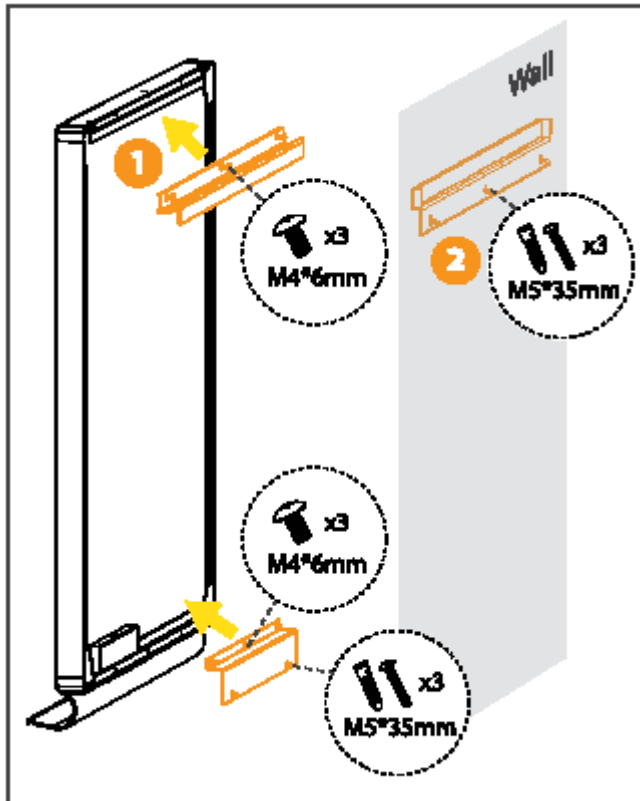

1. Install the wall mount (both top and bottom mount) to the eNote board
2. Install the bracket to the wall
3. Hang the eNote board to the wall
4. Mark the position of the bottom screw
5. Take out the eNote board and install the bottom screw
6. Hang back the eNote board to the wall

76"enote board

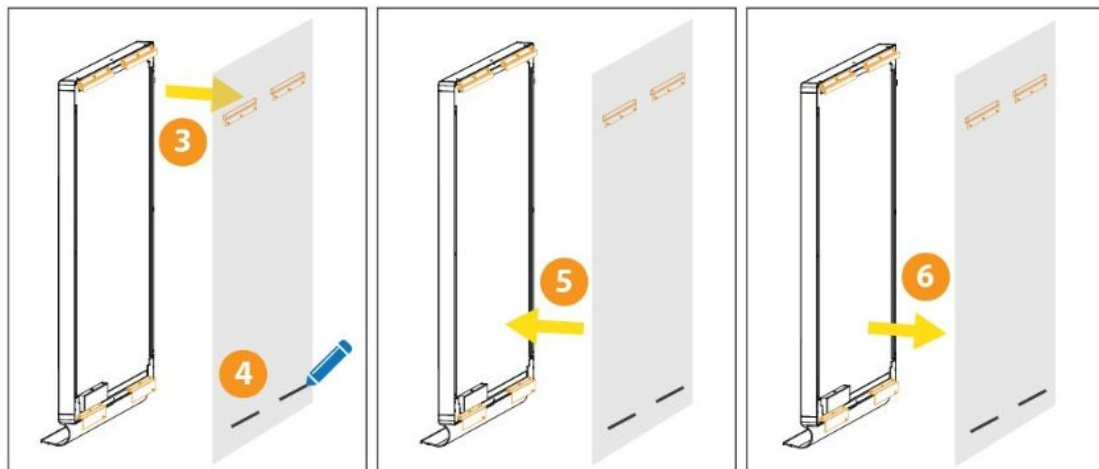
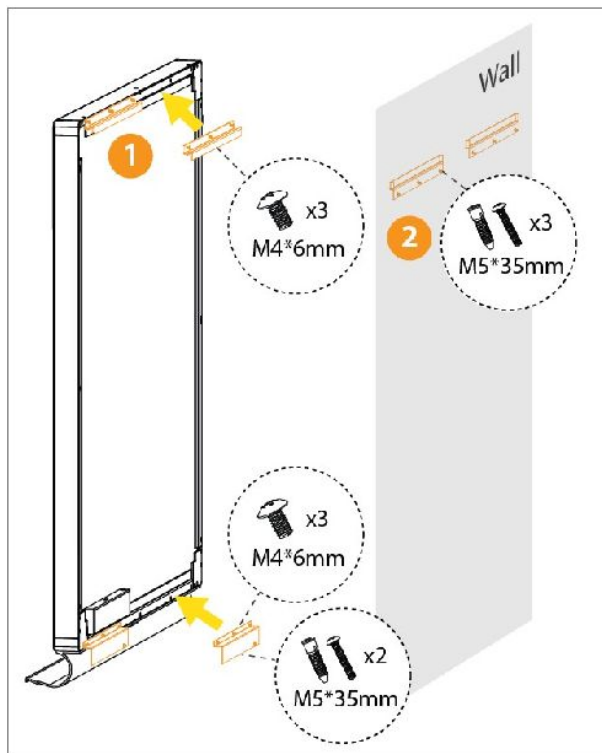

7. Install the wall mount (both top and bottom mount) to the eNote board
8. Install the bracket to the wall
9. Hang the eNote board to the wall
10. Mark the position of the bottom screw
11. Take out the eNote board and install the bottom screw
12. Hang back the eNote board to the wall

Cable Connection

Connect the AC to DC Power Adapter to the power socket.

Connect another end (DC cable) of Power adapter to the eNote Board.

Please connect the power adapter before using the eNote Board.

To Turn On/Off the eNote Board

To turn on, Press the  on the board.

To turn off, Press the  again.

Blue LED indicates the board is on.

LED status and functions



Press to power On/Off



Currently device has connected



Currently drawing



Currently using eraser



Press to add new page

eNote board include the LED buttons to show current board status.

Blue led shows that the function is currently in active status.

Taking and Erasing Notes

eNote Board is a traditional dry erase board which require normal whiteboard pen and eraser to use.

With the pen sensor and touch technology used in the eNote Board, it is possible to detect drawing and eraser in the eNote app. It will detect automatically for the pen or eraser when you do the presentation.

Contents will be synchronized to the mobile phone/tablet.

eNote Board App

Installation of eNote in Android OS

1. Please search and download the “eNote Flip Chart”app from the Google PlayStore or install the .apk file.



2. Pair up the device by Bluetooth In Setting page of the Android system

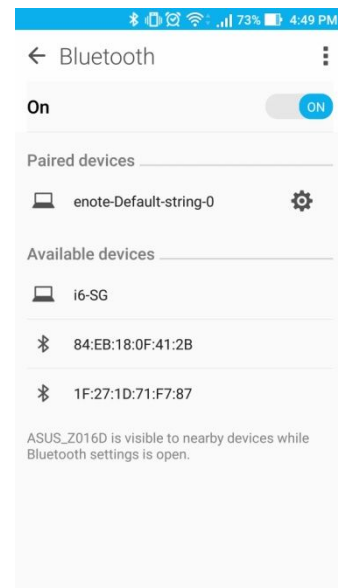

3. Click ‘eNote Flip Chart’ Apps in your mobile.



Installation of eNote in iOS

1. Please search and download the “eNote Flip Chart” app from the apple Appstore.



2. Click 'eNote Flip Chart' Apps in your mobile.







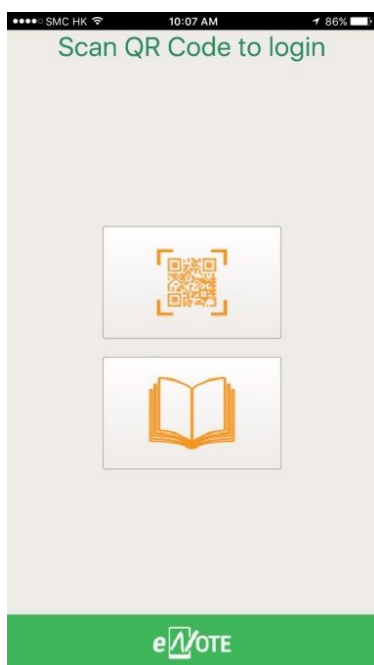

How to Log-in

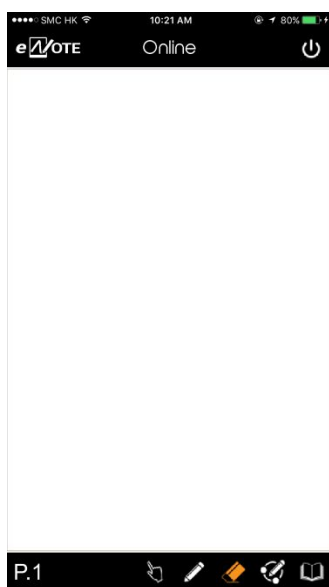
1. To Login, please click 'QR code" to scan the QR code on eNote board.
2. After scanning the QR code, enter the Log-in Pin to enter the section.





Login Page



Icon	Description	Functions
	Pointer	Scaling the Scrolling the whiteboard
	Marker Pen	Drawing in one's own device
	Eraser	Erasing in one's own device
	Share Pen	Drawing while synchronizing with other devices
	Library	Storage for saved files
	Logout	Go Offline/Exit

Gesture

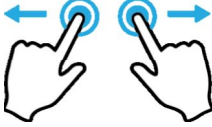
Toolbar will be hidden as default, you can call it out by tapping the screen for few seconds. Also, you can use gesture to zoom in, zoom out and calling the tool bar.

Gesture	The way to perform	
Calling tool bar	Tap for few seconds	
Zoom in	1 Finger on each hand moving away each other	
Zoom out	1 Finger on each hand moving toward each other	

Detail Functions

Marker Pen

You can change the color by press and hold on the Marker Pen's / Share pen's Icon

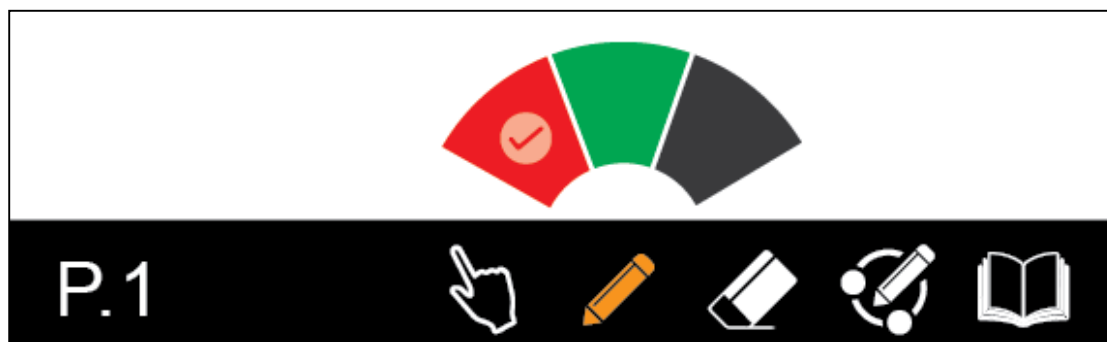

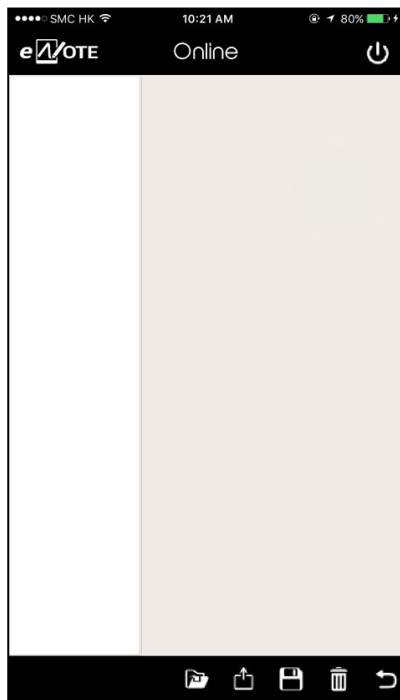

Icon	Description	Functions
	Open File	Open an existing file
	Share	Sharing the file by Email/Bluetooth etc.
	Save	Save the file as PDF format
	Delete	Delete the file
	Back	Back to last action

Save Page

You need to input the file name in order to save the file.

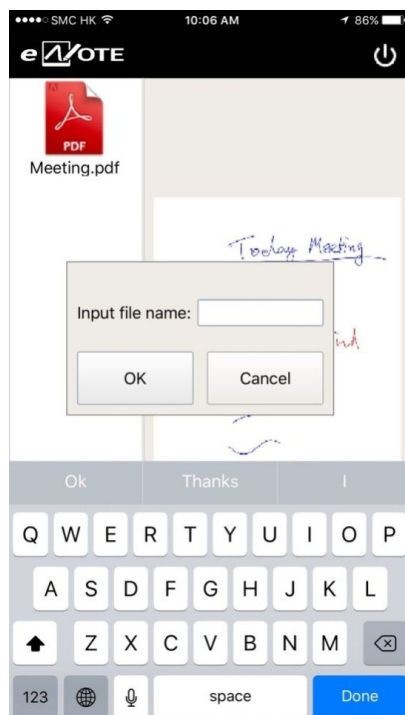

Notices

Every effort has been made to ensure all information contained in this user guide is correct, but the accuracy or completeness is not guaranteed. Before using this product, you must evaluate it and determine if it is suitable for your intended application. You assume all risks and liability associated with such use. Any statements related to this product which is not contained in this manual or any contrary statements contained on your purchase order shall have no force of effect unless expressly agreed upon, in writing, by this company.

Without this company permission, reproduction or reprinting this user guide or any part is prohibited.

The contents of this user guide are subject to change without prior notice.

Date of modification: 3-Mar-2017

This device complies with Part 15 of the FCC Rules. Operation is subject to the following two conditions: (1) this device may not cause harmful interference, and (2) this device must accept any interference received, including interference that may cause undesired operation.

Changes or modifications not expressly approved by the party responsible for compliance could void the user's authority to operate the equipment.

NOTE: This equipment has been tested and found to comply with the limits for a Class B digital device, pursuant to Part 15 of the FCC Rules. These limits are designed to provide reasonable protection against harmful interference in a residential installation. This equipment generates, uses instructions, may cause harmful interference to radio communications. However, there is no guarantee that interference will not occur in a particular installation. If this equipment does cause harmful interference to radio or television reception, which can be determined by turning the equipment off and on, the user is encouraged to try to correct the interference by one or more of the following measures:

- Reorient or relocate the receiving antenna.
- Increase the separation between the equipment and receiver.
- Connect the equipment into an outlet on a circuit different from that to which the receiver is connected.
- Consult the dealer or an experienced radio/TV technician for help.