

THE HIQ MEDIA CHAIR BY KLAUSSNER®



OWNER'S MANUAL

CONGRATULATIONS!

Thank you for choosing your new HiQ Media Chair by Klaussner®. With proper installation and operation, you will enjoy years of trouble-free use.

Klaussner manufactures the industry's most complete line of furniture and is known for innovation.

To see the complete Klaussner product assortment, visit us on the Internet at www.Klaussner.com.

TABLE OF CONTENTS

Introduction	1
Important Safety Instructions	2
Limited Warranty	3
Features and Benefits	4
Set Up Considerations	5
Set Up and Connectors	5
Basic Use	6
Options Section	7
Frequently Asked Questions	8

INTRODUCTION

The HiQ Media Chair by Klaussner® is uniquely designed for ease of use while providing superior sonic quality. 3DS™ (3 Dimensional Sound) employs advanced technology to recreate premium performance surround sound with pinpoint accuracy within the confines of the chair. Dolby® Digital and Dolby Pro Logic II as well as custom signal processing allows a unique and full 5.1 surround experience. Clear Voice allows you to clearly hear and follow the dialog. The wireless transmitter controller allows you to connect virtually any audio (receivers, CD players, and MP3 players) or video source with audio outputs (DVD player, VCR) and transmit the sound wirelessly to the chair—up to 30 feet away.



Manufactured under license from Dolby Laboratories. Dolby, Pro Logic, and the double-D symbol are trademarks of Dolby Laboratories.

• **Limited Warranty** - KLAUSSNER FURNITURE INDUSTRIES, L.L.C. ("KFI") warrants this product to be free from defects in materials and workmanship (subject to the terms set forth below) for a period of one (1) year from the date of purchase. During the Warranty period, KFI will repair or replace (at KFI's option) this product or any defective parts. To obtain Warranty service, please contact the KFI authorized dealer from which you purchased this product. If your dealer is not equipped to perform the repair of your product, please call KFI at 800-422-3961 Extension 3218 for instructions. Proof of purchase in the form of a bill of sale or receipted invoice, which is evidence that this product is within the Warranty period, must be presented or included to obtain Warranty service. This Warranty is invalid if the factory - applied serial number has been altered or removed from this product. This Warranty is only valid for the original purchaser and will automatically terminate prior to expiration if this product is sold or otherwise transferred to another party. This Warranty does not cover cosmetic damage or damage due to misuse, abuse, negligence, acts of God, accident, or modification of, or to any part of, the product. This Warranty does not cover damage due to improper operation, maintenance or installation, or attempted repair by anyone other than KFI or a KFI dealer which is authorized to do KFI warranty work. Any unauthorized repairs will void this Warranty. This Warranty does not cover product sold AS IS or WITH ALL FAULTS. REPAIRS OR REPLACEMENTS AS PROVIDED UNDER THIS WARRANTY ARE THE EXCLUSIVE REMEDY OF THE CONSUMER. KFI SHALL NOT BE LIABLE FOR ANY INCIDENTAL OR CONSEQUENTIAL DAMAGES FOR BREACH OF ANY EXPRESS OR IMPLIED WARRANTY ON THIS PRODUCT. EXCEPT TO THE EXTENT PROHIBITED BY LAW, THIS WARRANTY IS EXCLUSIVE AND IN LIEU OF ALL OTHER EXPRESS AND IMPLIED WARRANTIES WHATSOEVER, INCLUDING BUT NOT LIMITED TO, THE WARRANTY OF MERCHANTABILITY AND FITNESS FOR A PRACTICAL PURPOSE.

Some states do not allow the exclusion or limitation of incidental or consequential damages or implied warranties so the above exclusions may not apply to you. This Warranty gives you specific legal rights, and you may have other rights, which vary from state to state.



The lightning flash with arrowhead symbol, within an equilateral triangle, is intended to alert the user to the presence of uninsulated dangerous voltage within the product's enclosure that may be of sufficient magnitude to constitute a risk of electric shock to persons.



The exclamation point within an equivalent triangle is intended to alert the user to the presence of important operating and maintenance (servicing) instructions in the literature accompanying the appliance.

WARNING: To reduce the risk of fire or electric shock, do not expose this apparatus to rain or moisture

1. Read these instructions.
2. Keep these instructions
3. Heed all warnings.
4. Follow all instructions.
5. Do not use this apparatus near water.
6. Clean only with a dry cloth.
7. Do not block any ventilation openings. Install in according with the manufacturer's instructions.
8. Do not install near any heat sources such as radiators, heat registers, stoves, or other apparatus (including amplifiers) that produce heat.
9. Do not defeat the safety purpose of the polarized or grounding-type plug. A polarized plug has two blades with one wider than the other. A grounding type plug has two blades and a third grounding prong. The wide blade or the third prong are provided for your safety. If the provided plug does not fit into your outlet, consult an electrician for replacement of the obsolete outlet.
10. Protect the power cord from being walked on or pinched particularly at plug, convenience receptacles, and the point where they exit from the apparatus.
11. Only use attachments/accessories specified by the manufacturer.
12. Use only with a cart, stand, tripod, bracket, or table specified by the manufacturer, or sold with the apparatus. When a cart is used, use caution when moving the cart/apparatus combination to avoid injury from tip-over.
13. Unplug this apparatus during lightning storms or when unused for long periods of time.
14. Refer all servicing to qualified service personnel. Servicing is required when the apparatus has been damaged in any way, such as power-supply cord or plug is damaged, liquid has been spilled or objects have fallen into the apparatus, the apparatus has been exposed to rain or moisture, does not operate normally, or has been dropped.
15. Do not expose this equipment to dripping or splashing and ensure that no objects filled with liquids, such as vases, are placed on the equipment.
16. To completely disconnect this equipment from the AC mains, disconnect the power supply cord plug from the AC receptacle.
17. The main plug of the power supply cord shall remain readily operable.²

FEATURES AND BENEFITS

- **3DS™** - (3 Dimensional Sound) isolates premium performance surround sound audio with pinpoint accuracy within the confines of the chair.
- **Dolby® Digital** - each HiQ media chair utilizes Dolby Digital and Dolby Pro Logic II Surround Processing to further enhance your audio experience. Custom signal processing allows a full 5.1 surround experience.
- **Clear Voice** - reduces loud music, sound effects and background noise for crisp clear dialogue. You will no longer have to constantly turn the volume up and down to hear the dialogue clearly in your favorite movie or television show. Just use the convenient remote to adjust the Clear Voice to your desired preference and enjoy.
- **Powerful Bass** - for the most realistic experience, remotely adjust the transducer intensity and feel what you are hearing. The High Performance Subwoofer and Tactile Sound Transducer work in tandem to deliver an experience you can't get with traditional sound systems.
- **Cleaning and Care** - the only thing you should ever need to do regarding cleaning your system is to dust the speaker grilles or transmitter controller occasionally. Never apply any abrasive or solvent-based cleaner or any harsh detergents.
- **Wireless Transmitter Controller** - simply plug your furniture into a power outlet and plug the wireless transmitter controller into your receiver or TV and you're ready to go. Sound is wirelessly transmitted to your chair with a line of sight range of 30 feet. The transmitter controller includes 4 analog inputs, 2 Digital Coax inputs and 2 Optical Digital inputs for compatibility with virtually any audio or video source available today.

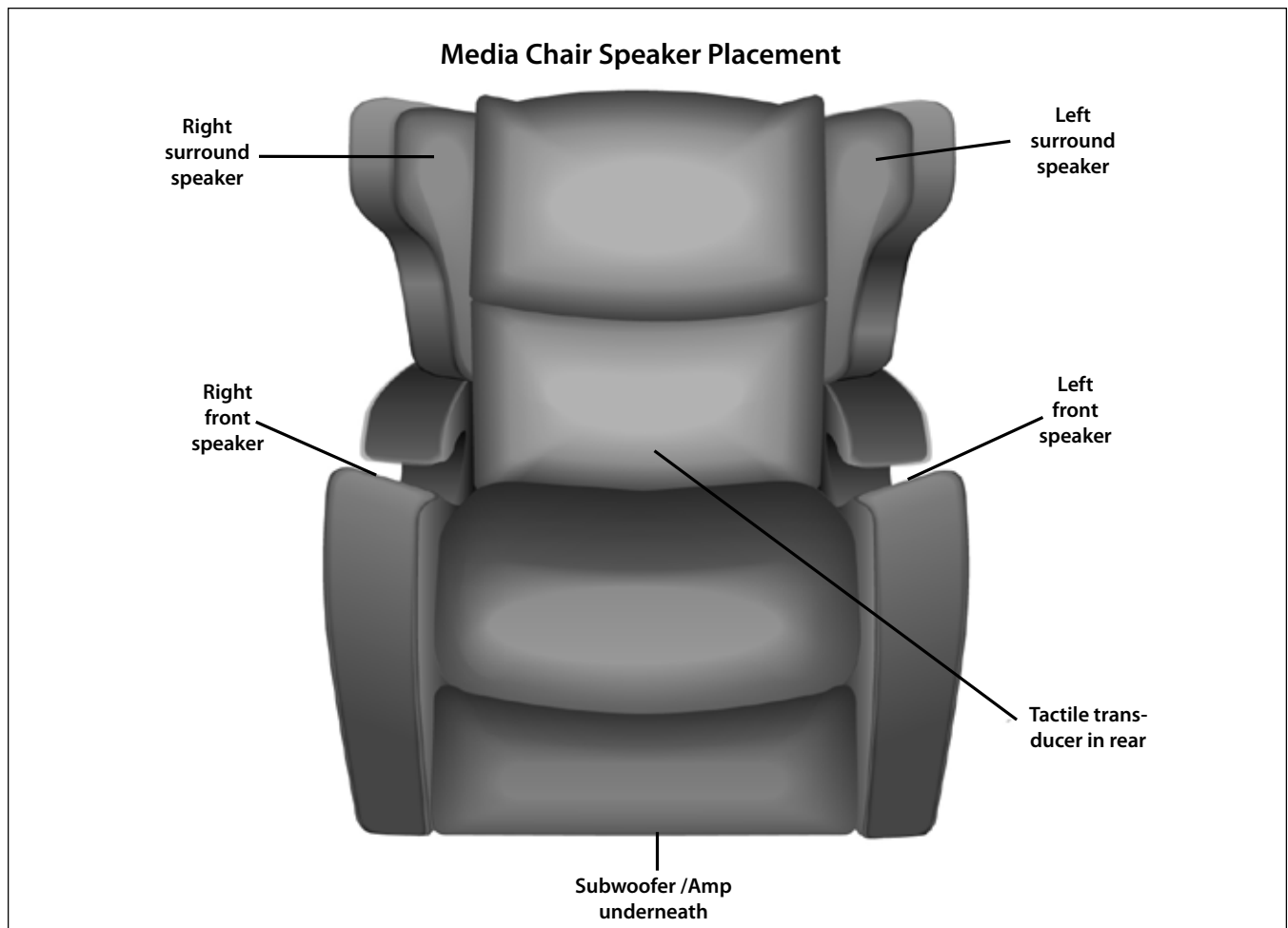

Subwoofer and Amplifier

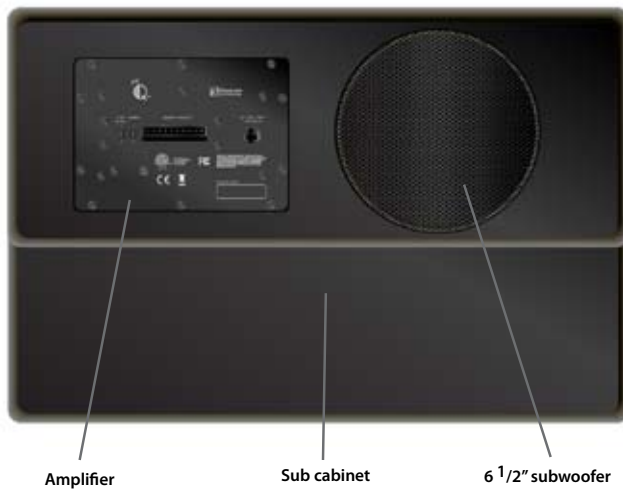

Amp Panel Detail

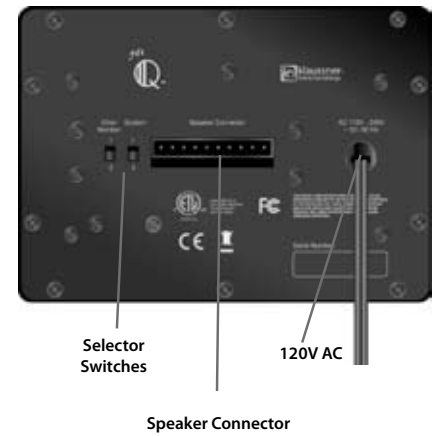

Remote Control Functions

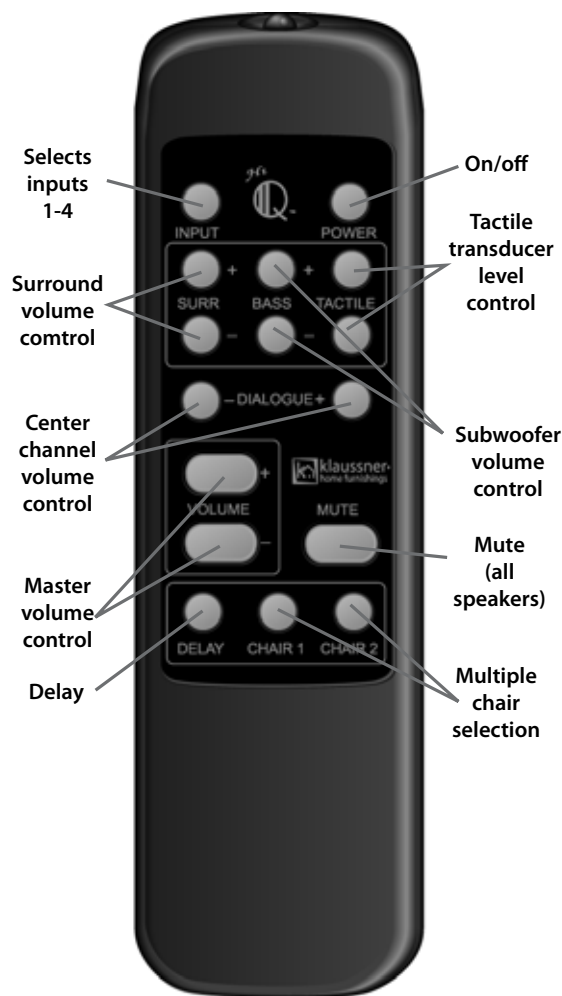

Transmitter Controller

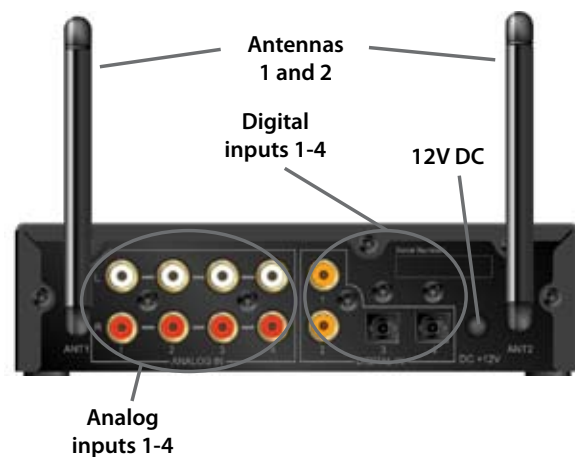
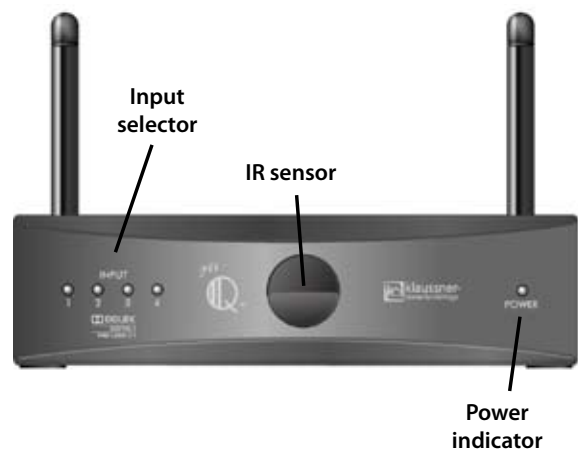

SET UP CONSIDERATIONS

Your wireless transmitter controller and the wireless receiver built in to your furniture feature sophisticated design to maximize the range in a typical environment to a line of sight range of thirty feet. Trying to extend the range beyond this or use in a situation that is not line of sight greatly increases the odds of poor performance. Avoid placing either the transmitter controller or furniture in an area that would block wireless signals. Some environments, such as masonry or steel stud walls, can create issues that can usually be corrected by adjusting the transmitter controller antennas or the placement of the transmitter controller.

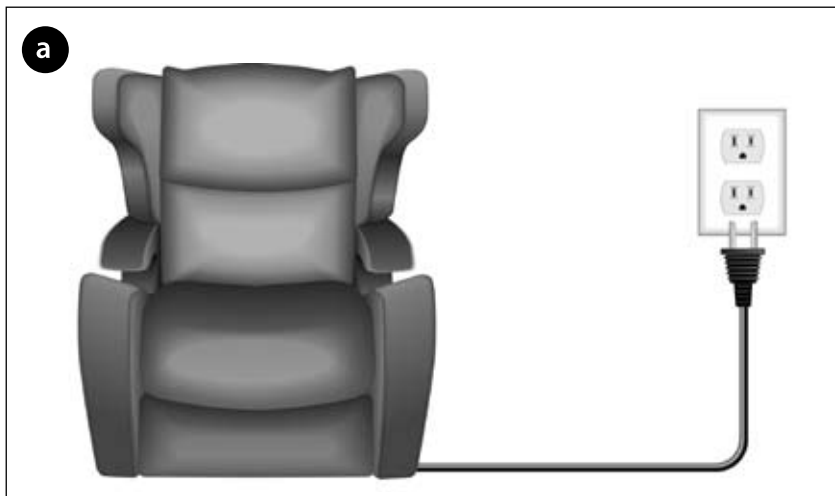

For Analog line-level input connections, use high-quality RCA cables that feature low impedance, double shielding, and gold-plated connectors. Use similar quality RCA connections for the Digital Coax connections and high-quality Toslink cables for the Digital Optical connections. Use the provided setup poster for a fast and easily visible reference tool.

SET UP AND CONNECTIONS

1. Connect to power source.

(a) Plug in furniture to AC power. Furniture can operate on AC voltage from 100-240v at 50 or 60Hz. if necessary use the appropriate plug adapter for your location.

2. Connect sources to transmitter controller.

(b) Items that typically have high use, such as cable or satellite receivers or DVD players should use digital connections whenever possible. Please note that up to four inputs may be used at any time. The inputs for both analog (red and white RCA connectors) and digital (orange RCA connectors for coax and black Toslink for optical) connections are numbered 1 through 4.

Input priority-If you use Digital input #1, do not connect a device to Analog Input #1 and so forth. Your transmitter controller will not be damaged if you do so, but the advanced software will choose and prioritize the Digital input when it detects a signal, which could prevent you from being able to hear the analog item if it is connected to an input that is the same number as a Digital input.

3. Connect wireless transmitter controller to power. (c)

4. Put the two included AA batteries in remote. (d)

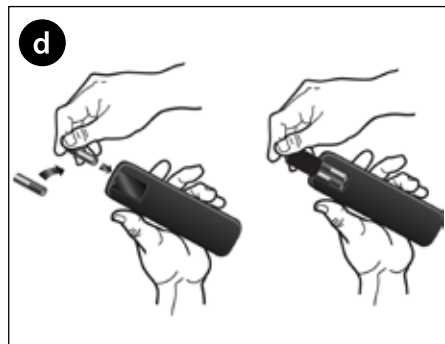
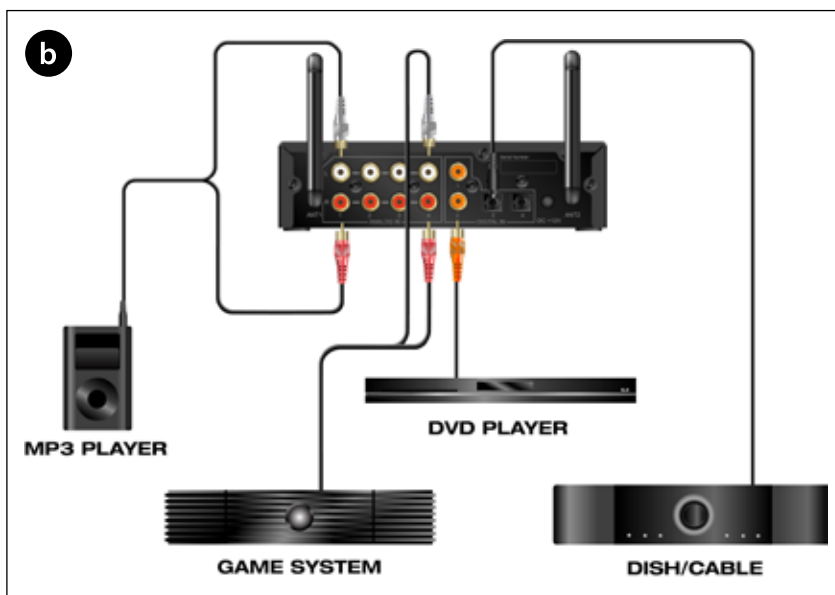

5. POWER on transmitter controller using remote control.

6. Transmitter will automatically sync to furniture.

BASIC USE

Refer to page 5 for remote functions

Transmitter controller power LED remains red when off, and will alternate red and blue when remote power button is pressed. Light will remain blue when synchronized with media chair. **(b)** Selecting items connected to your transmitter controller. **(c)**

Simply press and release the **Input** key to change through the various inputs. The appropriate light on the front of your transmitter controller will light to indicate the Input chosen.

Simply press and hold the **VOLUME +** key or the **VOLUME –** key to raise or lower total system volume. **(d)**

To mute all speakers, press the **MUTE** key. Pressing **MUTE** again or the **VOLUME +** OR **VOLUME –** key will unmute your system. To adjust the levels of different speakers, use the + or – key for the channel that you wish to adjust.

To utilize Clear Voice, adjust the **DIALOG +** or – keys to increase or decrease the volume of dialog. The **SURR** keys raise or lower the volume of the rear speakers near your head. Use the **BASS +** or – keys to raise or lower the amount of bass. The **TACTILE** keys will raise or lower the level of the transducer. The level of transducer intensity is a matter of personal taste, and media source.

Restore settings—If you are unsatisfied with your personal settings and wish to restore them all to factory settings and start again, simply press and hold both the **SURR +** and – keys, and factory settings will immediately reset. You may now begin adjusting levels again to obtain the levels that you prefer.

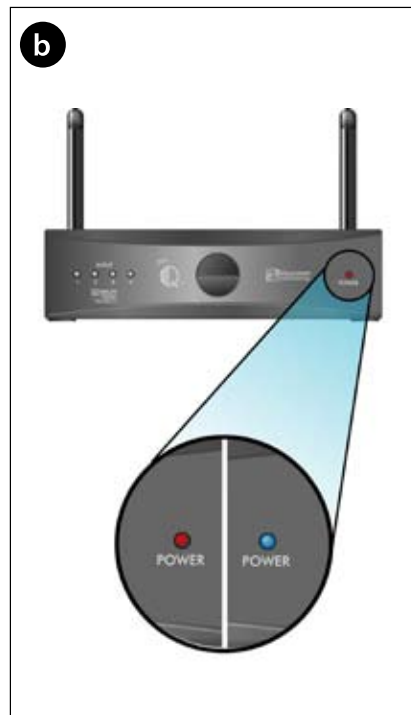

Delay Adjustment

The video processing in today's advanced video devices can sometimes delay the video being displayed. This can cause the sound from your audio system to be out of sync with what you are seeing. If this occurs with your Media Chair system simply press the **DELAY** button on your remote control. The Media Chair has 4 levels of audio delay to help you perfectly synchronize your audio and video. The amount of audio delay selected will be displayed by the Input LEDs when you press the **DELAY** button. One LED indicates level 1 (minimum delay) and 4 LEDs indicates level 4 (maximum delay). Press the delay button until you feel the audio and video are best synchronized.

OPTIONS SECTION

Two or more pieces of furniture using ONE transmitter controller

Use this option to connect more than one HiQ media chair by Klaussner(r) to a single transmitter controller. Using this option means that the item (DVD, Cable Receiver, etc.) that is connected to the transmitter controller and selected will be able to be 'heard' by all media chairs that are set as described below.

- Set up the first chair following the steps in 1-4 on page 5.
- Add any additional chairs following the same steps.

Two or more pieces of furniture using TWO transmitter controllers (Two separate systems in one area).

Note: The transmitter controllers must be installed at least 10' apart to ensure proper operation.

This is the option that you would choose if you want to have two separate systems and enjoy one or more HiQ media chairs by Klaussner® with each system.

- Set up the first system following the steps 1-7 on page 5. The first system should already be assigned as System 1 based on factory defaults. To ensure transmitter controller is set to System 1, power it on then press and hold **SURR +** and **Dialog** - keys at the same time. The Input 1 LED should flash to indicate System 1 has been assigned.
- Set the amplifier System switch on each chair in the second system to 2.
- Follow the setup steps that you did for the first system. To assign the second transmitter controller to System 2, power it on then press **SURR +** and **Dialog** + keys at the same time. The Input 2 LED should flash to indicate System 2.

Controlling Volume

- If you wish for the Volume and all other settings to be the same on all media chairs, leave amplifier setting for each Chair set to 1. That is the factory default setting.
- For volume to be independent between two or more chairs, set the Chair setting on the amplifier of the chairs that need to be separate to **2**.
- Now simply press the **CHAIR 2** button on the second remote/the additional chair(s) volume and other audio settings will be controlled with this remote.



These switches are located on the subwoofer box amp panel on the underside of the chair

FREQUENTLY ASKED QUESTIONS

What cables do I need to connect media sources to wireless transmitter?

Below is a list of cables needed, which are usually included in media devices. The HiQ Media Chair by Klaussner® does not include these cables.



Stereo RCA jacks



Coax digital



TOSLINK (Optical)



3.5mm (1/8 inch) stereo
to RCA stereo jacks

Will the HiQ Media Chair by Klaussner® interfere with my other home wireless products?

The advanced 2.4GHz wireless technology found in both the media chair and transmitter controller examines the entire 2.4GHz band in the area to detect any other wireless technologies that are in use, such as wireless routers, and then transmits around the spectrum used by those sources.

*If you experience wireless network issues after installing a media chair, you may need to adjust your router settings, such as range extension features.

Can I use a HiQ Media Chair by Klaussner with other wireless products?

The HiQ media chair by Klaussner® transmitter controller will only work with the HiQ chair. It will not work, or interfere, with any other wireless products.

What is the maximum distance that HiQ media chair by Klaussner® products can transmit and receive wireless signals?

These products were designed to have an average line of sight transmitting/receiving distance of 30 feet. While it is possible to transmit through walls, ceilings and floors, every scenario will be different because every environment is different.

Will my transmitter controller work inside a cabinet or entertainment center?

In most cases the transmitter controller's wireless capability will pass through cabinets. However, the remote control is infrared (IR), which requires that the remote 'sees' the transmitter controller to control it. The remote and transmitter controller are compatible with virtually all IR extender or repeater systems if the transmitter controller must be located in a place where it is out of sight from the remote.

Can I program my universal remote to work with the HiQ Media Chair by Klaussner®?

Universal remote manufacturers do not have the media chair IR codes in their databases; therefore a non-learning universal remote will not work with this system. However, the IR control codes for the transmitter controller remote should be able to be learned by almost any learning universal remote control.

If my neighbor and I both own HiQ Media Chair by Klaussner® products, will our systems interact?

The System code feature allows you to select a unique channel for your HiQ Media Chair by Klaussner® to keep your system from interfering with a nearby system. The factory default System code is 1 for all HiQ Media Chair by Klaussner® components and does not need to be changed unless another HiQ Media Chair is nearby and interfering.

Can I have more than one HiQ media chair by Klaussner® in one home?

Yes. Thanks to great system flexibility, you can have more than one chair assigned to one transmitter controller. You can also have two completely separate systems in one home with as many chairs as you would like assigned to each transmitter controller.

The transmitter controller doesn't have an HDMI input. How do I get an HD signal through the system?

With the appropriate cables, connect your set-top box or DVD player digital or analog audio outputs to the transmitter controller.

Can I connect an MP3 player to the transmitter controller?

Yes, simply use the headphone output of your MP3 player to connect a cable that has a 3.5mm (1/8") stereo connector on one end and two RCA connectors on the other end to one of the analog inputs of the transmitter controller. These cables are widely available at most electronic stores.

What if my HiQ media chair by Klaussner® is not working?

- 1) Check to make sure that the chair's power cord is plugged in. Even though the chair receives the audio signal wirelessly, it still requires power from an outlet.
- 2) If the power is on and you don't hear a signal, check to ensure the transmitter controller is powered on and the blue power LED indicates that the transmitter controller is synchronized with the media chair.
- 3) Check that you have selected an input on the transmitter controller that has something connected to it that has an active signal.
- 4) If you are still experiencing problems after correcting the input mode, try replacing the remote's battery.
- 5) Then, if that does not work, contact Klaussner technical support at 800-422-3961 extension 3218, Fax: 800-586-9722, or sclark@klaussner.com.

I have been adjusting the bass, front back balance, etc. and now the sound is not good. Can I reset the chair back to the factory balance?

With system powered on press both **Volume +** and **-** at the same time until sound levels are reset.

What I am watching and what I am hearing are not the same.

Repeatedly press the **INPUT** button on the remote until the picture and sound match.

The sound I am hearing is not synchronized with the video I am seeing.

Press the **DELAY** button on the remote to select one of four different audio delay settings. Choose the one that synchronizes the audio and video best.

I have spilled a liquid on the speaker grill on the armrest. What should I do?

The speaker areas have been designed to drain out of the chair. If you wish to dry the area beneath the grill, pop off the caps on the speaker grill screws, and using a medium length Phillips screw driver, remove the grill and dry the speaker area.

My neighbor and I both have HiQ Media Chairs by Klaussner®. I can hear their audio on my chair. What do I do?

Simply change your chair and transmitter controller to the System 2 settings.

I have two HiQ Media Chairs by Klaussner®, can they be set to operate independently? Different volume levels, bass, etc on each chair?

Yes, each chair should be assigned to the same system number, either System 1 (factory default) or System 2. Then the first chair should be set to Chair 1 and second chair to Chair 2 for independent level control.

I have two HiQ Media Chairs by Klaussner®. Do I need to connect my DVD player, cable/satellite boxes to both of the transmitter controller boxes?

No, one transmitter controller can work with two or more chairs, greatly simplifying system setup.

When I see something on screen is going from left to right, I am hearing it go from right to left. What's wrong?

This can happen on an analog input. On these inputs you connect two plugs. Check to make sure that the left audio output on your VCR, cable/satellite box, DVD, etc. is connected to the left audio input on the transmitter controller box, and the right to the right.

No matter how high I turn the back surrounds up, nothing is coming out of these speakers.

Older mono broadcasts and movies will not have any surround information. And in many movies with surround information there will not be anything coming out of the surround speakers during many parts of the program when there is not any action.

The lights on my transmitter controller are off, but it is plugged into the wall.

Some wall outlets are switched. And if your transmitter controller is plugged into the back of an audio video receiver or a cable box, often these outlets are also switched. Check the owners manual of the receiver or cable box.

The lights on the transmitter controller are on, but the chair is not operating.

Some wall outlets are switched. Check to see if your chair is plugged into a switched outlet and ensure that the switch is in the on position.

I put fresh batteries in the remote but the system is still not responding.

Please check to be sure that the batteries are installed correctly. Also, the transmitter controller must be able to 'see' the remote control. If you cannot see the transmitter controller, it cannot see the remote control.

I have a source connected to a digital input on the transmitter controller but get no sound.

If you are using an optical input (Toslink cable), please ensure that the cable is not kinked and is properly connected on both ends. Also check the source component's set up menu to ensure that the digital output is turned on and sending out the correct type of signal.

The power light on the transmitter controller is flashing red and blue. What's wrong?

It is initializing the wireless connection between the transmitter controller and the chair. This should only occur when the chair and transmitter controller are first turned on. Please check to ensure that the chair has power and is within range (up to 30' line of sight) of the transmitter controller. Next check that it is set to the same system number as the transmitter controller.

This device complies with Part 15 of the FCC Rules. Operation is subject to the following two conditions: (1) this device may not cause harmful interference, and (2) this device must accept any interference received, including interference that may cause undesired operation

Changes or modifications not expressly approved by the party responsible for compliance could void the user's authority to operate the equipment.

This equipment has been tested and found to comply with the limits for a Class B digital device, pursuant to part 15 of the FCC Rules. These limits are designed to provide reasonable protection against harmful interference in a residential installation. This equipment generates uses and can radiate radio frequency energy and, if not installed and used in accordance with the instructions, may cause harmful interference to radio communications. However, there is no guarantee that interference will not occur in a particular installation. If this equipment does cause harmful interference to radio or television reception, which can be determined by turning the equipment off and on, the user is encouraged to try to correct the interference by one or more of the following measures:

- Reorient or relocate the receiving antenna.
- Increase the separation between the equipment and receiver.
- Connect the equipment into an outlet on a circuit different from that to which the receiver is connected.
- Consult the dealer or an experienced radio/TV technician for help.

The transmitter of this device has been designed to operate with the attached antennas, and having a maximum gain of 1.8dBi. Antennas not identical as that or having a gain greater than 1.8dBi are strictly prohibited for use with this device. The required antenna impedance is 50 ohms. To reduce potential radio interference to other users, the antenna type and its gain should be so chosen that the equivalent isotropically radiated power (e.i.r.p.) is not more than that permitted for successful communication

MPE Reminding

1. The installed antennas must not be located in a manner that allows exposure of the general population at a distance of less than 20cm.
2. Mount the antennas in a manner that prevents any personnel from entering the area within 20cm from the central position of the antenna.

Klaussner® Furniture Industries, Inc.
405 Lewallen Rd. | Asheboro, NC 27205
1.888.732.5948 | www.klaussner.com