

vifa

COPENHAGEN
owner's manual

You've chosen well

The Vifa Copenhagen. A speaker that looks as good as it sounds. That you can bring almost everywhere. That will help you celebrate life.

It's designed to be intuitive for you to use. This manual just spells out the details - for instance, how to connect wirelessly in a flash.

Enjoy!

Introduction.....	3
Buttons and indicators on Copenhagen.....	6
Status indicator.....	7
Input options.....	8
Connecting priority.....	9

Connection to Copenhagen

Bluetooth.....	10
Wi-Fi direct.....	11
Wi-Fi Network manual setup.....	12
Wi-Fi Network using a iOS device.....	14
Wi-Fi Network using WPS.....	16
Playback through Wi-Fi.....	17
Wired connection - optical, analog or USB.....	18
Battery charge.....	19
Reset and set to factory default.....	20
Vifa app.....	21
Product care.....	22
Troubleshooting.....	23
Specifications.....	24
Register and Trademarks.....	25

For manuals in other languages, please visit: www.vifa.dk/support

BUTTONS AND INDICATORS ON COPENHAGEN

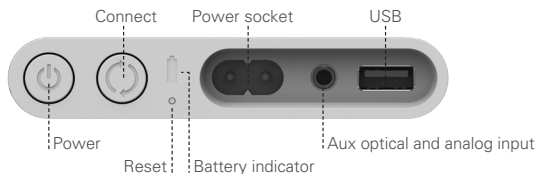
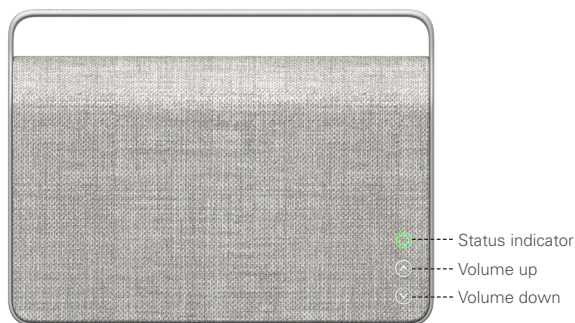

STATUS INDICATOR

No light – Copenhagen is in standby mode

Breathing – Copenhagen is hibernating

(Copenhagen will automatically go to hibernation after 5 min. without signal)

To wake up Copenhagen press the POWER button.

- From standby for 2 seconds
- From hibernation just play music on one of the inputs, press the power or one of the vol. buttons shortly

Rapidly flashing – Copenhagen is in setup mode

- WHITE: Wi-Fi setup
- YELLOW: USB or WPS network setup
- GREEN: Locking on to wired input

Constant light – Copenhagen is on

- WHITE: Wi-Fi connection
- BLUE: Bluetooth connection
- GREEN: Wired connection
- YELLOW: No connection or signal

To power down Copenhagen press the power button.

- To hibernation for 2 seconds
- To standby for 4 seconds

Note: Putting Copenhagen into hibernation mode will double your battery time and still allow you to wake it up rapidly. In standby mode Copenhagen will have approx. 7 days of battery time and consume less than 0,5 watt from the power outlet.

INPUT OPTIONS

- **Bluetooth**

Fast and easy and works for virtually every phone, tablet or MAC/PC - supports aptX for Hi-Fi sound.

- **Wi-Fi**

Works for phones, tablets, MAC/PC Wi-Fi and networked dlna enabled devices - supports Wi-Fi Direct.

- **Wired optical or analog**

For music players or media players without wireless connection.

- **Wired USB**

Works for iOS device at present – will charge your iOS device while playing music from it.

CONNECTING PRIORITY

Copenhagen makes automatic selection of input for you based on the following rules.

1. 1st priority is Wi-Fi and USB

If Wi-Fi or USB is connected and playing music, other connections are disconnected.

2. 2nd priority is Bluetooth

If Bluetooth is connected and playing music, a wired analog or optical connection will be disconnected.

3. 3th priority is wired

When no Bluetooth, USB or Wi-Fi is used, you can use the wired input. You can however lock Copenhagen to wired input, look for further information on page 20.

CONNECTING WITH BLUETOOTH

Fast and easy wireless connection for virtually every phone



 **iPhone**

 **Android**

1. Select Bluetooth pairing on your device.
2. Select the Vifa device on your Bluetooth enabled device.
3. Let the music play.

You can adjust to volume up and down on the front of Copenhagen and on the playback device.

Note: Release of the Bluetooth pairing can be done either on Copenhagen or the paired device, on Copenhagen just press and hold both the "Volume up" and "Volume down" simultaneously until the indicator flashes BLUE 3 times.



CONNECTING DIRECT WITH WI-FI

For Airplay and dlina direct playback



 **iPhone**

 **Android**

1. Press and hold the  CONNECT button until the status indicator flashes WHITE rapidly and then release the  CONNECT button – the indicator will now start to pulse until it receives a music signal.
2. Find Wi-Fi network settings on your device.
3. Select the network called VIFA_..... (No password required)
4. Play music on your device - when the status indicator turns WHITE the connection is established.

Note: You can release Copenhagen from Wi-Fi direct mode - just press the connect button shortly.

CONNECTING TO YOUR WI-FI NETWORK

Manual Set-up

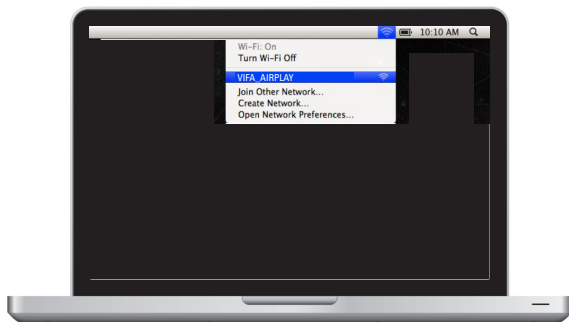

1. Press and hold the ©CONNECT button until the status indicator flash WHITE rapidly and then release the ©CONNECT button – the indicator will now start to pulse until it receives a music signal.
2. Find Wi-Fi network settings on your device
3. Select the network called VIFA_..... (No password required)
4. On your device open the browser (e.g. Safari or Internet Explorer) and enter 192.168.1.1 in the address line, and press enter.

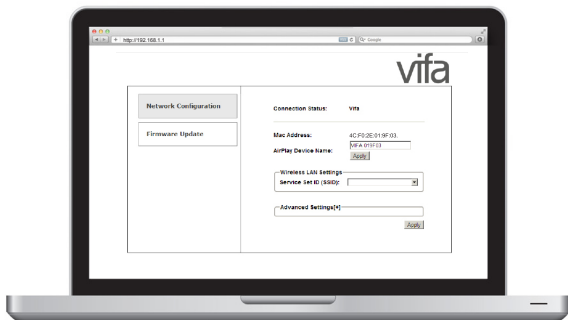

5. Now the Copenhagen setup page open up.
6. Choose your network and enter the password if needed. Then type in the name you want displayed for Copenhagen on the network ex. "Copenhagen Living room".
7. Then press "Apply".
8. On your device, remember to change network back to your preferred network.
9. Play music on your device - when the status indicator turns WHITE the connection is established.

CONNECTING TO YOUR WI-FI NETWORK

Using iOS device



1. Make sure your iOS device is connected to your network.
2. Connect your iOS device to Copenhagen using a USB cable.
3. Press and hold the **Ⓢ CONNECT** button on Copenhagen until the status indicator flashes **YELLOW** rapidly and then release the **Ⓢ CONNECT** button.





4. The iOS device will ask you if it may transfer network settings to the speaker. Press Allow on the iOS device.
5. When the status indicator on Copenhagen turns WHITE, the connection is established.

CONNECTING TO YOUR WI-FI NETWORK

Using WPS



1. Press  WPS button on your router.
2. Press and hold the  CONNECT button until the status indicator flashes YELLOW rapidly and then release the  CONNECT button.
3. When the status indicator on Copenhagen turns WHITE, the connection is established.

PLAYBACK THROUGH WI-FI

Connect your playback device and Copenhagen to the same Wi-Fi network - And playback is simple, choose Copenhagen as sound device or renderer on your playback device.



For iOS device just press the Airplay logo and choose Copenhagen.

Using iTunes on a MAC/PC, you can stream music through your network to multiple Vifa Copenhagen simultaneously. You can even remote control iTunes with a free Apple remote app. This way you can control the music stream from iTunes to multiple Vifa Copenhagen with your iPhone, iPod or iPad

LIVE STREAMING

We recommend that you connect Copenhagen to your home Wi-Fi network when possible. This gives you access to Wi-Fi streaming within your entire Wi-Fi network range, and allows you to have stable stream from internet radio services or music services.

Outside your Wi-Fi network range, the access to live streaming from internet radio and music services, will have to come from the mobile network, this can have limited bandwidth compared to your Wi-Fi network, which can result in dropouts in the music. When using a mobile network for streaming music, please beware of the price of your download from the mobile network.

We recommend that your play music stored on your device, when outside your Wi-Fi network.

WIRED CONNECTION

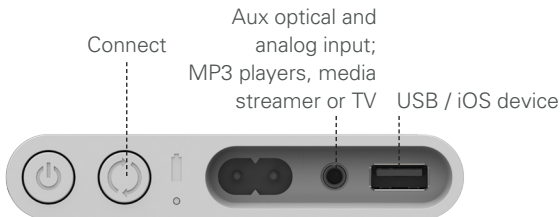

- On the back of Copenhagen the 3,5 mm mini-jack auxiliary input, will support 2 channel analog signal or optical input with a digital data stream up to 24bit/192kHz.
- To lock on to wired input press and hold the ©CONNECT button, until the status indicator flashes rapidly GREEN and then release.
- To release the locked wired input, just press shortly on the ©CONNECT button, then the status indicator will flash GREEN 3 times and normal input priority is restored.
- You can use USB as a playback input from your iOS device. Copenhagen will charge your iOS simultaneously.
- The USB port on Copenhagen will be able to charge most smart devices.

BATTERY CHARGE

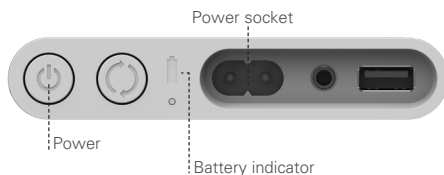

A full charge will take 3-4 hours. Keep Copenhagen plugged in when near power outlet. The intelligent power management will keep the battery in perfect condition. When charging you can see the progress.



Low: Battery level below 15% RED flashing



Medium: Battery level between 15 and 80% ORANGE flashing



Full: Battery level above 80% GREEN constant light

When the power is on and the power cable is unplugged, press the  POWER button shortly and the battery indicator will light up.

RESET AND SET TO FACTORY DEFAULT

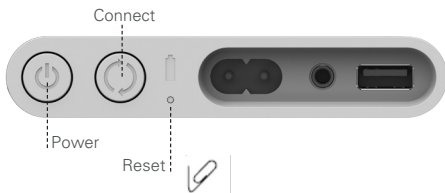

RESET

- USED IF COPENHAGEN LOCKS UP

To reset Copenhagen press the reset button shortly
- no user settings will be lost.

FACTORY DEFAULT

- SET'S COPENHAGEN'S SOFTWARE BACK TO FACTORY SETTINGS

To factory default Copenhagen – press and hold the ⏻ POWER and the 🔗 CONNECT button simultaneously until the status indicator starts triple flashing. Release the buttons and Copenhagen will go to factory default – after factory default ALL USER SETTINGS WILL BE LOST.

To firmware update Copenhagen, please go to the www.Vifa.dk/support for further information.

THE VIFA APP

To get the most of your Vifa Copenhagen download the free Vifa app. You can find link's to the app. under "support" on the Vifa WEB

This will allow you to: / The Vifa app allows you to:

- Adjust the sound to your preferred taste or surroundings
- Change the name that Copenhagen will show on the Wi-Fi network.
- Change the network settings on Copenhagen
- Manage your inputs on Copenhagen
- Adjust the light intensity of the "status indicator"



www.Vifa.dk/support

PRODUCT CARE

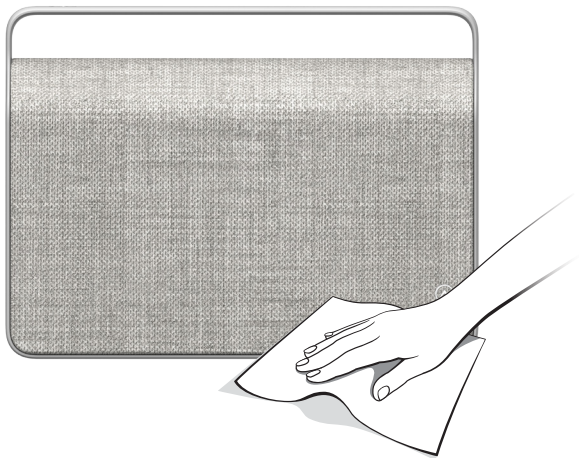

This product is designed to premium music performance in normal living space. Exposure to rain, moisture, high humidity or sources of heat may damage the product. The intended use is within a temperature range of 5 - 40°C (40 - 105°F).

CLEANING

Your Vifa product is covered by beautiful highly durable textile from Kvadrat. Remove non-greasy stains by carefully dabbing with a lint-free cloth or use a lint roller to remove lint from the textile.



Never use a vacuum cleaner, this can cause damage on the loudspeaker units behind the textile.

TROUBLESHOOTING

If the status indicator lights RED constantly – please set Copenhagen to standby mode by pressing the ⏻ POWER button for 4 seconds.

After this, please unplug the power cord and wait for approximately 5 min. before plugging in Copenhagen to the power again.



**Here you can find further support
on our Vifa products:
www.vifa.dk/support**

SPECIFICATIONS

Description	Portable wireless loudspeaker
Technical features	Bluetooth aptX. Wi-Fi direct. Apple AirPlay Works with dlna DSP signal processing Lithium Ion battery Force Balanced Woofers Digital pure path amplifiers
Driver units	
Tweeter	2 X 28 mm Vifa driver unit with soft dome and neodymium magnet
Midrange	2 X 50 mm Vifa driver unit with aluminium cone and neodymium magnet
Woofer	2 X 80 mm Vifa driver unit with flat sandwich cone and neodymium magnet. Mounted mechanically back to back in a force balanced configuration supported by 4 passive radiators
Frequency response	50Hz - 20kHz @ +/- 3 dB
Input voltage	100Volt - 240Volt 50/60 hz
Max. Rated power consumption	150 watt
Standby power consumption	Less than 0,5 watt
Output	USB 5 volt / 2.1 A (plugged in to the mains) 0.5 A (battery mode)
Inputs	Bluetooth aptX. Wi-Fi direct Wi-Fi networked Wired optical or analog (3.5 mm minijack) Wired USB (only iOS device at present)
Dimensions Height/Width/Depth	268 mm / 362 mm / 90 mm
Net weight	4.65 kg
Frame	One piece diecast aluminium
Enclosure	ABS reinforced
Grilles	Custom made Kvadrat textile

REGISTER



We encourage you to register your product at:
www.vifa.dk/register

A Vifa product is in compliance with CE directives of relevance, including RoHS directive – see product label for more regional regulatory approvals.



Vifa Copenhagen AirPlay works with iPod touch (4th, 3rd and 5th generation), iPhone (5S, 5C, 5, 4S, 4, 3GS), iPad (4th, 3rd, 2nd and 1st generation), iPad mini, with iOS 4.3.3 and iTunes 10.2.2 (Mac or PC) or later.

Made for iPod touch (4th, 3rd and 5th generation), iPod nano (7th, 6th, 5th, 4th), iPhone (5S, 5C, 5, 4S, 4, 3GS), iPad (4th, 3rd, 2nd and 1st generation), iPad mini.

AirPlay, iPad, iPhone, iPod nano and iPod touch are trademarks of Apple Inc., registered in the U.S. and other countries.



The Wi-Fi Certified Logo is a certification mark of the Wi-Fi Alliance.



The Bluetooth logo, the Bluetooth name and the combination are trademarks owned by Bluetooth SIG Inc.



© 2013 CSR pic and its group companies.

The aptX® mark and the aptX logo are trade marks of CSR pic or one of its group companies and may be registered in one or more jurisdictions.

IMPORTANT STATEMENTS:

This device complies with Part 15 of the FCC Rules. Its operation is subject to the following two conditions:

- 1. This device may not cause harmful interference, and*
- 2. This device must accept any interference received, including interference that may cause undesired operation.*

Cet appareil est conforme à la section 15 des réglementations de la FCC. Le fonctionnement de l'appareil est sujet aux deux conditions suivantes :

- 1. Cet appareil ne doit pas provoquer d'interférences néfastes, et*
- 2. Cet appareil doit tolérer les interférences reçues, y compris celles qui risquent de provoquer un fonctionnement indésirable.*

Note: This product has been tested and found to comply with the limits for a Class B digital device, pursuant to Part 15 of the FCC Rules. These limits are designed to provide reasonable protection against harmful interference in a residential installation. This product generates, uses, and can radiate radio frequency energy and, if not installed and used in accordance with the instructions, may cause harmful interference to radio communications.

However, there is no guarantee that interference will not occur in a particular installation. If this product does cause harmful interference to radio or television reception, which can be determined by turning the equipment off and on, the user is encouraged to try to correct the interference by one or more of the following measures:

- Reorient or relocate the receiving antenna.*
- Increase the separation between the equipment and receiver.*
- Connect the equipment into an outlet on a circuit different from that to which the receiver is connected.*
- Consult the dealer or an experienced radio/TV technician for help.*

User manuals for licence-exempt radio apparatus shall contain the following or equivalent notice in a conspicuous location in the user manual or alternatively on the device or both.

This device complies with Industry Canada licence-exempt RSS standard(s).

Operation is subject to the following two conditions:

- 1. This device may not cause interference, and*
- 2. This device must accept any interference, including interference that may cause undesired operation of the device.*

Le présent appareil est conforme aux CNR d'Industrie Canada applicables aux appareils radioexempts de licence. L'exploitation est autorisée aux deux conditions suivantes :

- 1. l'appareil ne doit pas produire de brouillage, et*
- 2. l'utilisateur de l'appareil doit accepter tout brouillage radioélectrique subi, même si le brouillage est susceptible d'en compromettre le fonctionnement.*

To satisfy FCC RF exposure requirements, a separation distance of 20 cm or more should be maintained between this device and persons during device operation.

Pour satisfaire aux exigences de la FCC d'exposition aux radiofréquences, une distance de séparation de 20 cm ou plus doit être maintenue entre cet appareil et des personnes lors de fonctionnement du dispositif.

C €1588

Important Notice:

Please take attention that changes or modification not expressly approved by the party responsible for compliance could void the user's authority to operate the equipment.