

PITTSBURGH[®] PRO

1/2" Drive Digital Torque Adapter

68283 1/2" Drive Digital Torque Adapter

⚠ WARNING

Read this material before using this product.
Failure to do so can result in serious injury.
SAVE THIS MANUAL.



When unpacking, make sure that the product is intact and undamaged. If any parts are missing or broken, please call 1-800-444-3353 as soon as possible.

Visit our website at: <http://www.harborfreight.com>

Specifications

| | |
|-------------------|--|
| Drive Size | 1/2" |
| Accuracy | ± 2% |
| Included Adapters | 1/2" - 3/8" 1/2" - 1/4" |
| Torque Range | 29.5 ft-lb. to 147.5 ft-lb. |
| Auto Shutdown | After 80 Seconds |
| Memory | Stores up to 50 torque readings |
| Battery | One 3-volt CR2032 button cell battery (Included) |

Save This Manual

Keep this manual for the safety warnings and precautions, assembly, operating, inspection, maintenance and cleaning procedures. Write the product's serial number in the back of the manual near the assembly diagram (or month and year of purchase if product has no number). Keep this manual and the receipt in a safe and dry place for future reference.

Important Safety Information

In this manual, on the labeling, and all other information provided with this product:



This is the safety alert symbol. It is used to alert you to potential personal injury hazards. Obey all safety messages that follow this symbol to avoid possible injury or death.

DANGER

DANGER indicates a hazardous situation which, if not avoided, will result in death or serious injury.

WARNING

WARNING indicates a hazardous situation which, if not avoided, could result in death or serious injury.

CAUTION

CAUTION, used with the safety alert symbol, indicates a hazardous situation which, if not avoided, could result in minor or moderate injury.

NOTICE

NOTICE is used to address practices not related to personal injury.

CAUTION

CAUTION, without the safety alert symbol, is used to address practices not related to personal injury.

General Safety Warnings



WARNING Read all safety warnings and instructions. Failure to follow the warnings and instructions may result in serious injury. Save all warnings and instructions for future reference.

1. Do not exceed the Digital Torque Adapter's max. torque value.
2. Position battery in proper polarity and do not install battery of different type.
3. Do not submerge Digital Torque Adapter.
4. Do not disassemble Digital Torque Adapter.
5. Do not expose the Digital Torque Adapter to extreme temperature, humidity, or direct sunlight.
6. Do not excessively shake Digital Torque Adapter.
7. This product is not a toy. Keep it out of reach of children.
8. The warnings, precautions, and instructions discussed in this instruction manual cannot cover all possible conditions and situations that may occur. It must be understood by the operator that common sense and caution are factors which cannot be built into this product, but must be supplied by the operator.



SAVE THESE INSTRUCTIONS.

Instructions for Putting into Use



Read the **ENTIRE IMPORTANT SAFETY INFORMATION** section at the beginning of this manual including all text under subheadings therein before set up or use of this product.

Note: For additional information regarding the parts listed in the following pages, refer to *Parts List and Assembly Diagram* on page 4.

Functions



Operating Instructions



Read the **ENTIRE IMPORTANT SAFETY INFORMATION** section at the beginning of this manual including all text under subheadings therein before set up or use of this product

1. Securely fasten Adapter to ratchet.
2. Attach an adapter to end of anvil, if desired. Once fastened, press the Power button to activate the Adapter. The LCD Display will show "trACE" and "PtoP."
3. After two seconds, the Display will show "00.0".
4. Swing the Adapter. The Display will show the measured torque.
5. **Note:** If you do not use the Adapter for 80 seconds, the Adapter will automatically shut off.
6. Press the Memory ("M") button and the "P/T" button at the same time to select the desired torque unit.
7. The Adapter contains three unit selections: kg-m, ft-lb and N-m.
8. To increase the current torque value, press and hold down the Increase ("+") button until value is reached.
9. To lower the current torque value, press and hold down the Decrease ("-") button until value is reached.
10. **Note:** The Display will show "00.0" if no selection is made after ten seconds.
11. During operation, the LED light will flash GREEN.
12. Once you are 20% away from targeted torque, the LED will flash YELLOW and the buzzer will beep.
13. When targeted torque is reached, the LED will change to RED and a long buzz will sound.
14. To set peak torque, press and release the "P/T" button when Adaptor is on.
15. The Display will show "PtoP" and then "00.0" two seconds later.
16. To trace torque setting, press and release the "P/T" button.
17. The Display will show "trACE" and then "00.0" two seconds later.
18. To store a torque reading, have the digital torque wrench in "PtoP" mode. When you use it, the torque wrench can store the reading automatically.
19. Press the Memory button. The Display Panel will show the stored reading as "P01".
20. To show the second stored reading, press the Memory button again for one second. The second torque value will be designated as "P02".
21. You can continue to store settings until you reach fifty saved settings, or "P50".

22. **Note:** "P50" will be the most recent saved setting while "P01" will be the oldest.
23. If the torque setting is exceeded by 125% of the full scale, the LED will flash RED and the alarm will beep.
24. **WARNING!** Do not press the Memory and Power buttons at the same time. This will calibrate the tool and alter the preset values.
25. To turn off the Adapter, press the Power button OR wait 80 seconds for the Adapter to turn off automatically.
26. Clean, then store the tool indoors out of children's reach.

depend on battery quality and amount of hours tool is used. Typical battery life is 110 hours.

2. To replace battery, remove Battery Cap.
3. Remove old battery.
4. Install new CR2032 button cell battery, making sure to follow indicated polarity (the "+" should face upwards).
5. Replace Battery Cap.
6. Remove the battery if Torque Adapter will be stored for a long time.

Maintenance and Servicing



Procedures not specifically explained in this manual must be performed only by a qualified technician.

Replacing Batteries



1. **NOTE:** When battery power is low, a " " icon will appear on the display screen. Battery life will

1. **BEFORE EACH USE**, inspect the general condition of the tool. Check for loose hardware, misalignment or binding of moving parts, cracked or broken parts, damaged electrical wiring, and any other condition that may affect its safe operation.
2. **AFTER USE**, wipe external surfaces of the tool with clean cloth.
3. Do not use cleaning agents to clean the plastic parts

Parts List

PLEASE READ THE FOLLOWING CAREFULLY

THE MANUFACTURER AND/OR DISTRIBUTOR HAS PROVIDED THE PARTS LIST AND ASSEMBLY DIAGRAM IN THIS MANUAL AS A REFERENCE TOOL ONLY. NEITHER THE MANUFACTURER OR DISTRIBUTOR MAKES ANY REPRESENTATION OR WARRANTY OF ANY KIND TO THE BUYER THAT HE OR SHE IS QUALIFIED TO MAKE ANY REPAIRS TO THE PRODUCT, OR THAT HE OR SHE IS QUALIFIED TO REPLACE ANY PARTS OF THE PRODUCT. IN FACT, THE MANUFACTURER AND/OR DISTRIBUTOR EXPRESSLY STATES THAT ALL REPAIRS AND PARTS REPLACEMENTS SHOULD BE UNDERTAKEN BY CERTIFIED AND LICENSED TECHNICIANS, AND NOT BY THE BUYER. THE BUYER ASSUMES ALL RISK AND LIABILITY ARISING OUT OF HIS OR HER REPAIRS TO THE ORIGINAL PRODUCT OR REPLACEMENT PARTS THERETO, OR ARISING OUT OF HIS OR HER INSTALLATION OF REPLACEMENT PARTS THERETO.

Parts List

| Part | Description | Qty. |
|------|---------------|------|
| 1 | Upper Housing | 1 |
| 2 | Control Panel | 1 |
| 3 | Display Panel | 1 |
| 4 | LED | 1 |
| 5 | Circuit Board | 1 |
| 6 | Adapter | 1 |
| 7 | Ratchet Gauge | 1 |

| Part | Description | Qty. |
|------|----------------|------|
| 8 | Buzzer | 1 |
| 9 | Lower Housing | 1 |
| 10 | Screw | 10 |
| 11 | Battery Holder | 1 |
| 12 | Battery | 1 |
| 13 | Battery Cap | 1 |

Record Product's Serial Number Here: _____

Note: If product has no serial number, record month and year of purchase instead.

Note: Some parts are listed and shown for illustration purposes only, and are not available individually as replacement parts.

Assembly Diagram

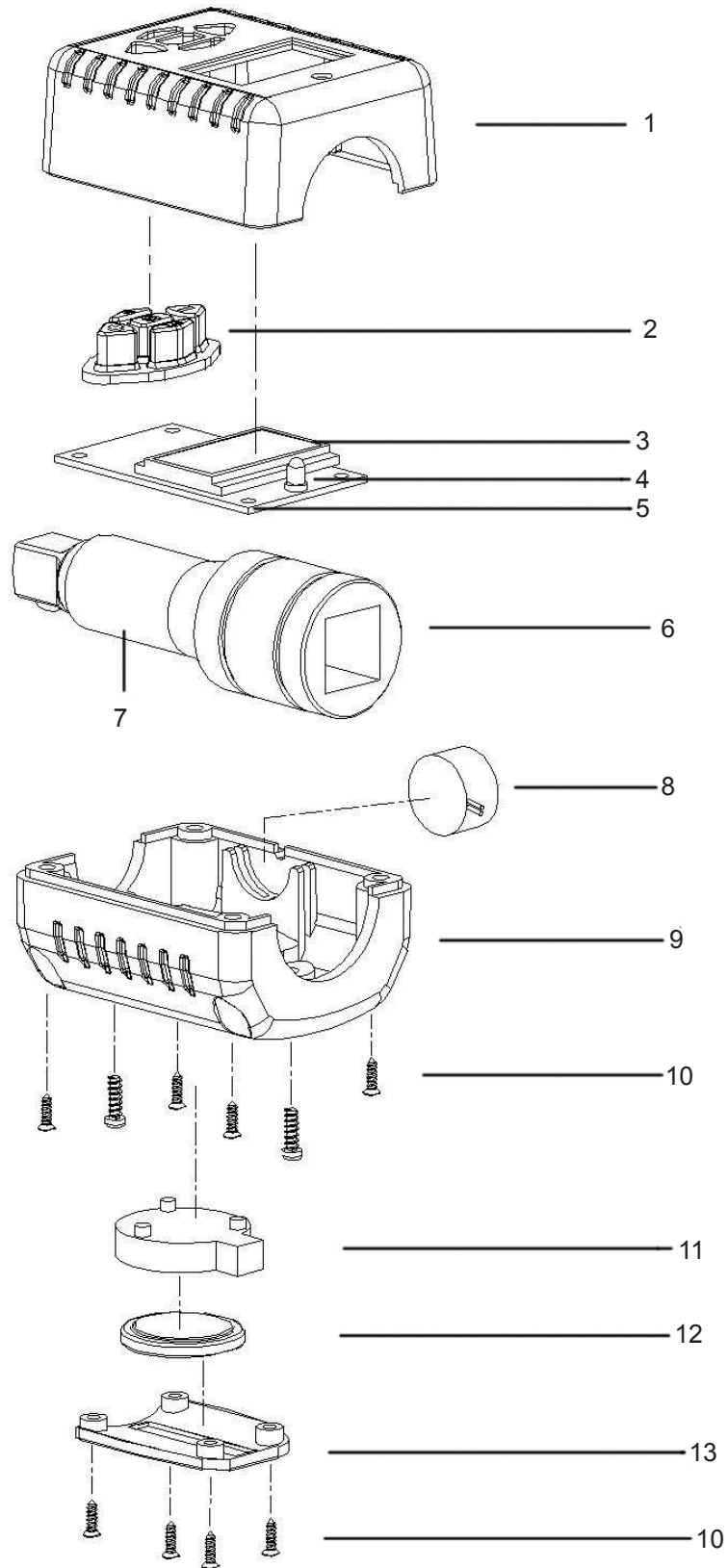

***PITTSBURGH*[®] PRO**

3491 Mission Oaks Blvd. • PO Box 6009 • Camarillo, CA 93011 • (800) 444-3353