

TWISTING ATTACHMENT FOR 31980

Model 36620

ASSEMBLY AND OPERATING INSTRUCTIONS



Visit our website at: <http://www.harborfreight.com>



**Read this material before using this product.
Failure to do so can result in serious injury.
SAVE THIS MANUAL.**

Copyright© 1997 by Harbor Freight Tools®. All rights reserved. No portion of this manual or any artwork contained herein may be reproduced in any shape or form without the express written consent of Harbor Freight Tools. Diagrams within this manual may not be drawn proportionally. Due to continuing improvements, actual product may differ slightly from the product described herein. Tools required for assembly and service may not be included.

For technical questions or replacement parts, please call 1-800-444-3353.

SPECIFICATIONS

ITEM	36620
Capacity	1/2" Pickets; 36" Long
Metal Type	Hot Rolled, Square Mild Steel
Handle	25" x 1-1/4"

SAVE THIS MANUAL

You will need this manual for the safety instructions , operating instructions, and parts list. Put it in a safe, dry place for future reference. **Keep your invoice with this manual. Write the invoice number on the inside front cover.**

**READ ALL INSTRUCTIONS
BEFORE ASSEMBLING OR
OPERATING THIS TOOL!**

SAFETY WARNINGS & CAUTIONS

WARNING: When using electric tools, machines or equipment, basic safety precautions should always be followed to reduce the risk of fire, electric shock, and personal injury.

READ ALL INSTRUCTIONS BEFORE USING THIS TOOL

- 1. KEEP WORK AREA CLEAN.** Cluttered areas invite injuries.
- 2. CONSIDER WORK AREA CONDITIONS.** Don't use in damp, wet, or poorly lit locations. Do not expose to rain. Keep work area well lit.
- 3. KEEP CHILDREN AWAY.** All children should be kept away from the work area. Don't let them handle machine.
- 4. STORE IDLE EQUIPMENT.** When not in use, tools should be locked up in a dry location to inhibit rust. If possible, store in an area out of reach of children.
- 5. DO NOT FORCE THE MACHINE OR TOOL.** It will do the job better and more safely at the rate for which it was intended.
- 6. USE THE RIGHT TOOL.** Don't force a small tool or attachment to do the work of a larger industrial tool. Don't use a tool for a purpose for which it was not intended.
- 7. DRESS PROPERLY.** Don't wear loose clothing or jewelry. They can be caught in moving parts. Protective gloves and non-skid footwear are recommended when working. Wear restrictive hair covering to contain long hair, preventing it from getting caught in machinery.
- 8. USE EYE AND EAR PROTECTION.** Use a full face mask if the work you're doing produces metal filings, dust or wood chips. Goggles are acceptable in other situations. Wear a clean dust mask if the work creates a lot of fine or coarse dust. When operating for extended periods of time, use approved ear protection. Safety goggles and ear protectors are available from Harbor Freight Tools.

9. **SECURE WORK.** Use clamps or a vise to hold the work if possible. It's safer than using your hands and it frees both hands to operate the tool.
10. **DO NOT OVERREACH.** Keep proper footing and balance at all times.
11. **MAINTAIN TOOLS WITH CARE.** Keep tools sharp and clean for better and safer performance. Follow instructions for lubricating and changing accessories. Keep handles dry, clean, and free from oil and grease.
12. **STAY ALERT.** Watch what you are doing, use common sense. Don't operate any tool when you are tired.
13. **CHECK DAMAGED PARTS.** Before using any tool, any part that appears damaged should be carefully checked to determine that it will operate properly and perform its intended function. Check for alignment of moving parts, binding of moving parts, breakage of parts, mounting, and other conditions that may affect its operation. Any part that is damaged should be properly repaired or replaced by an authorized service center unless otherwise indicated elsewhere in the instruction manual.
14. **REPLACEMENT PARTS AND ACCESSORIES.** When servicing, use only identical replacement parts. Only use accessories intended for use with this tool. Approved accessories are available from Harbor Freight Tools.
15. **DO NOT OPERATE TOOL IF UNDER THE INFLUENCE OF ALCOHOL OR DRUGS.** Read warning labels on prescriptions to determine if your judgment or reflexes are impaired while taking drugs. If there is any doubt, do not operate machine.

UNPACKING

When unpacking, refer to the list below. If any parts are missing or broken, please call Harbor Freight Tools at the number on the cover of this manual.

NO.	ITEM DESCRIPTION	QTY
NA	Handle & Grip Assembly	1
05	Bracket	1
06	Lower Frame	1
07	Frame Bolt	1
08	Frame Bolt Knob	1
09	Depth Stop	1
10	Depth Stop Lock Knob	1

ASSEMBLY

- Step 1: Using the FRAME BOLT (07) and FRAME BOLT KNOB (08), attach the LOWER FRAME (06) to the bottom of the STAND (11) of the Compact Bender. See Figure 1.
- Step 2: Insert the DEPTH STOP (09) into the round hole of the LOWER FRAME (06) and attach using the DEPTH STOP LOCK KNOB (10).

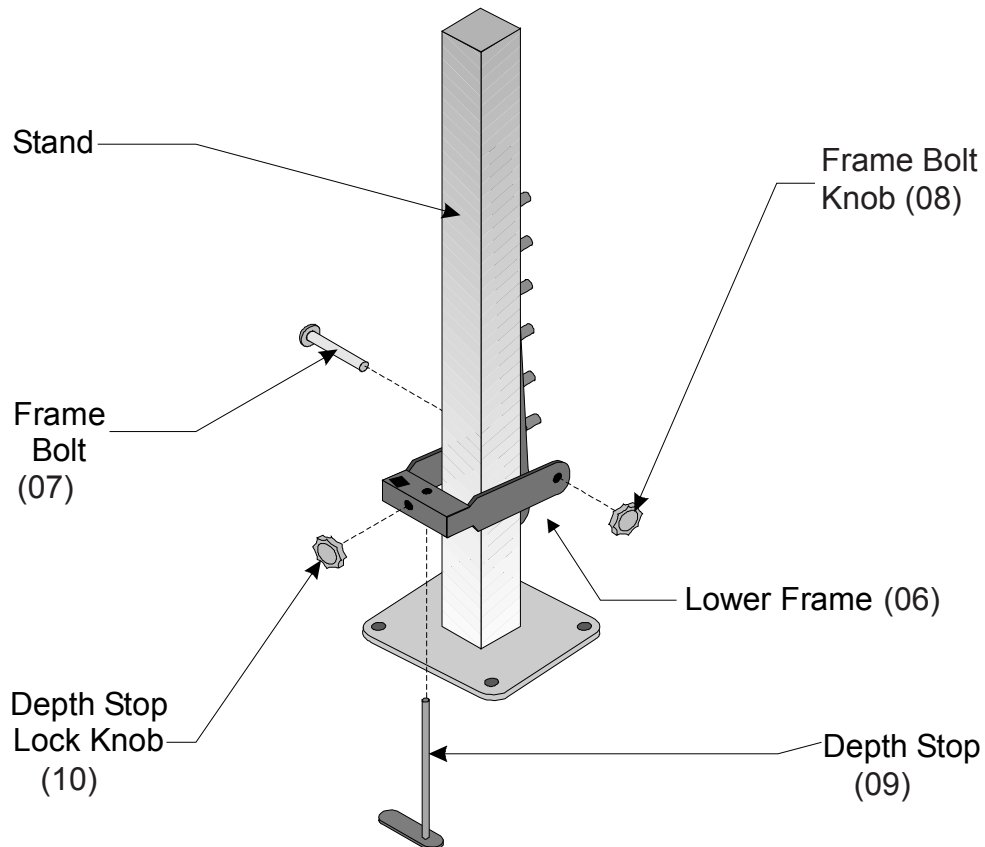

Figure 1 — Lower Frame Assembly

Step 3: Attach the BRACKET (05) to the RING ASSEMBLY/DIE RECEIVER (10) of the Compact Bender using two LONG PINS (1). Use Holes 5 & 6. See Figure 2.

Step 4: Insert the HANDLE (01) into the BRACKET (05).

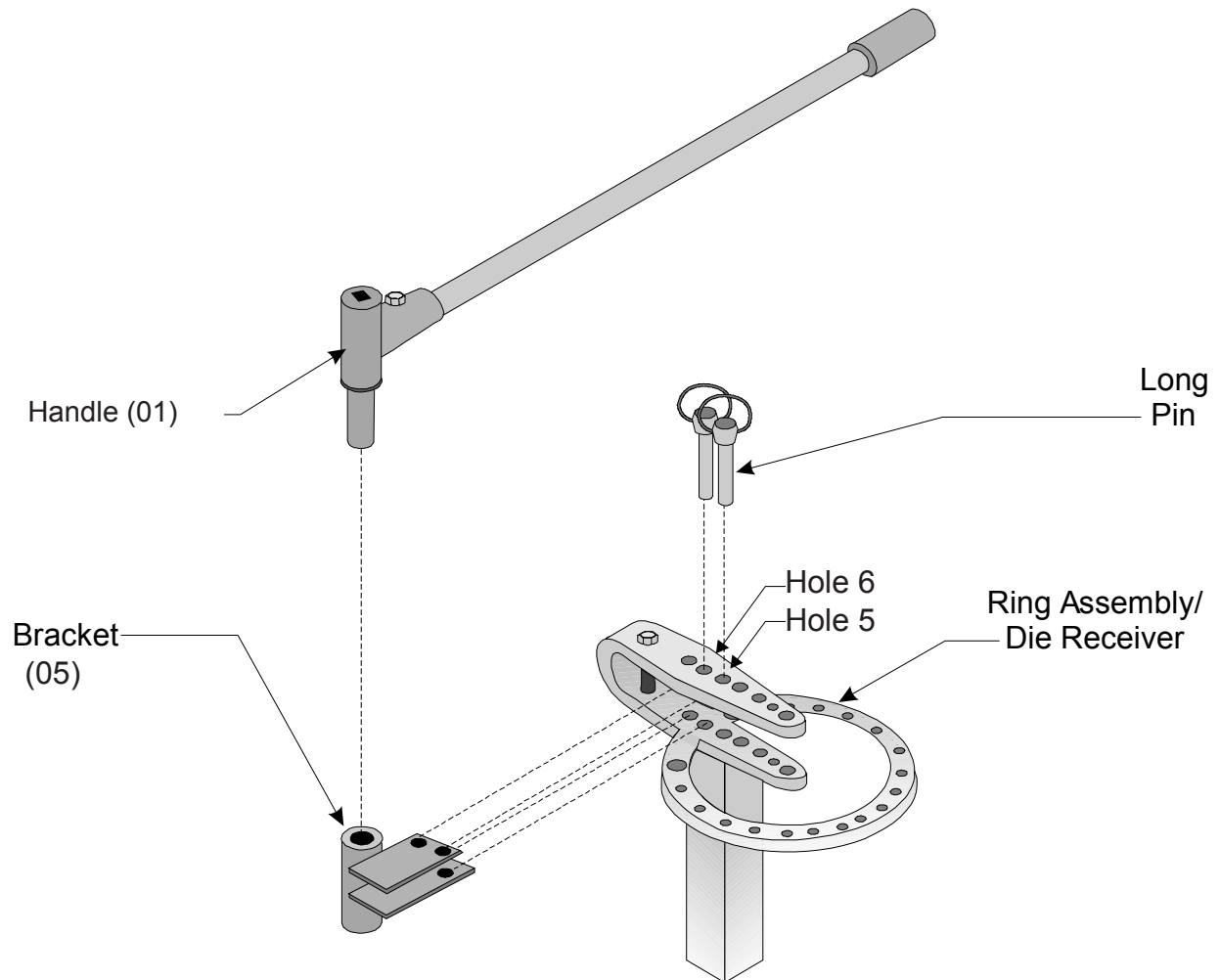

Figure 2 — Handle Head Assembly

OPERATIONS

- Step 1: Determine the length of stock you wish to twist and cut it accordingly.
- Step 2: Determine the length of stock you wish to leave unbent on either end, and mark using chalk.
- Step 3: Insert stock through the square holes of the HANDLE (01) and the LOWER FRAME T06). See Figure 3.

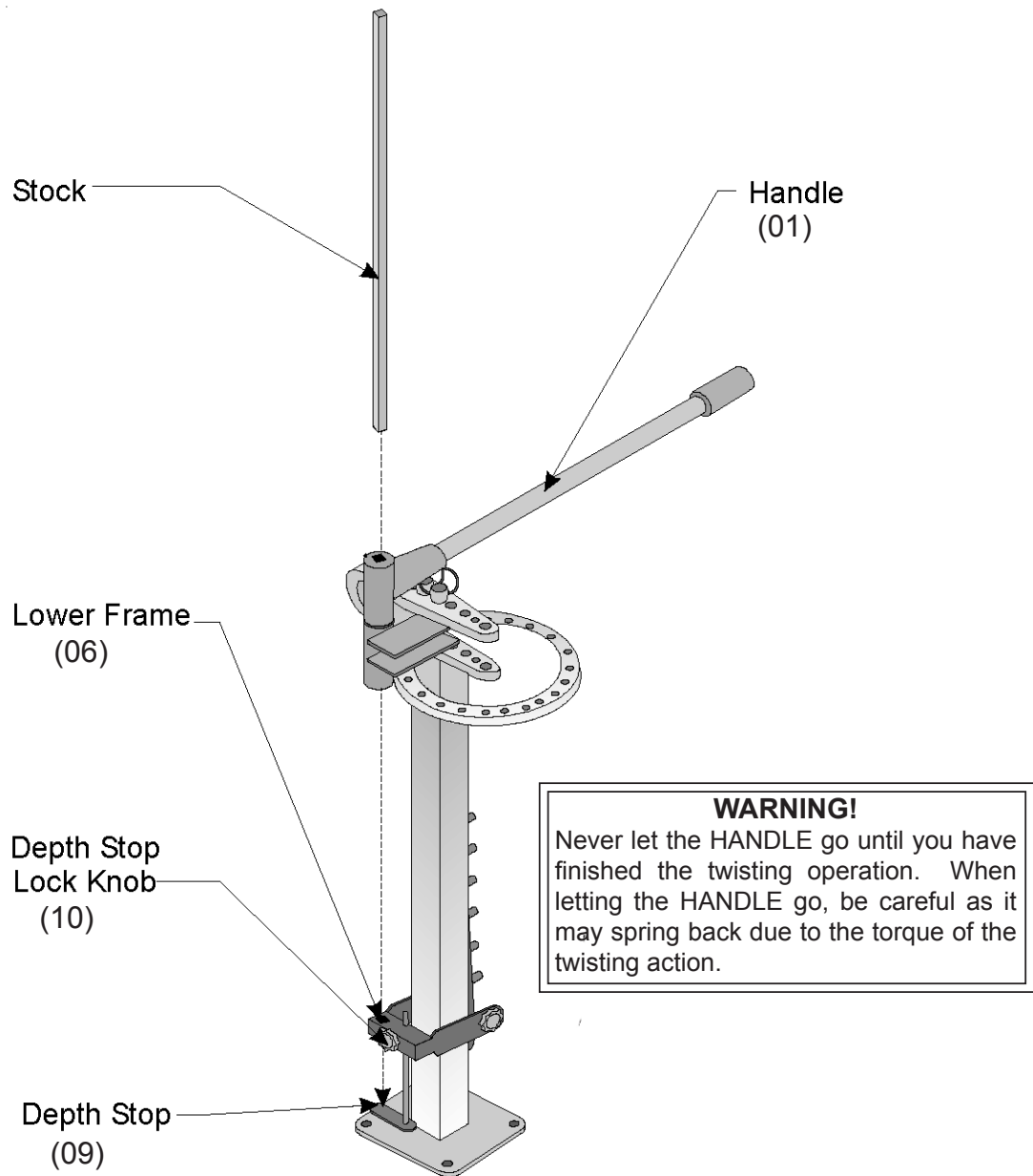

Figure 3 —Operation

- Step 4: Adjust the DEPTH STOP (09) so that the chalk mark is even with the top of the LOWER FRAME (06) when the stock is resting on the DEPTH STOP'S foot. Secure the DEPTH TOP (09) using the DEPTH STOP LOCK KNOB (10).
- Step 5: Rotate the handle either clockwise or counterclockwise (depending upon the desired direction of the twist).
- Step 6: Continue rotating the handle until you have the desired twist.
- Step 7: The length of your stock will not change even as you twist.

PLEASE READ THE FOLLOWING CAREFULLY

THE MANUFACTURER AND/OR DISTRIBUTOR HAS PROVIDED THE PARTS LIST AND ASSEMBLY DIAGRAM IN THIS MANUAL AS A REFERENCE TOOL ONLY. NEITHER THE MANUFACTURER OR DISTRIBUTOR MAKES ANY REPRESENTATION OR WARRANTY OF ANY KIND TO THE BUYER THAT HE OR SHE IS QUALIFIED TO MAKE ANY REPAIRS TO THE PRODUCT, OR THAT HE OR SHE IS QUALIFIED TO REPLACE ANY PARTS OF THE PRODUCT. IN FACT, THE MANUFACTURER AND/OR DISTRIBUTOR EXPRESSLY STATES THAT ALL REPAIRS AND PARTS REPLACEMENTS SHOULD BE UNDERTAKEN BY CERTIFIED AND LICENSED TECHNICIANS, AND NOT BY THE BUYER. THE BUYER ASSUMES ALL RISK AND LIABILITY ARISING OUT OF HIS OR HER REPAIRS TO THE ORIGINAL PRODUCT OR REPLACEMENT PARTS THERETO, OR ARISING OUT OF HIS OR HER INSTALLATION OF REPLACEMENT PARTS THERETO.

PARTS LIST

PART NO.	DESCRIPTION	QTY
01	Handle	1
04	Grip	1
05	Bracket	1
06	Lower Frame	1
07	Frame Bolt M10x100	1
08	Frame Bolt Knob	1
09	Depth Stop	1
10	Depth Stop Lock Knob	1

ASSEMBLY DIAGRAM

