

Maintenance Schedule

To ensure prolonged life of your engine, perform regular maintenance as suggested in the table below.

Procedure	Before Each Use	Monthly or every 20 hrs of use	Every 3 mths or 50 hrs of use	Every 6 mths or 100 hrs of use	Yearly or every 300 hrs of use	Every 2 Years
Brush off outside of engine	✓	✓	✓	✓	✓	✓
Check engine oil level	✓	✓	✓	✓	✓	✓
Check air cleaner	✓		✓	✓	✓	✓
Check deposit cup	✓			✓	✓	✓
Change engine oil		✓		✓	✓	✓
Clean/replace air cleaner			✓*	✓	✓	✓
Check and clean spark plug				✓	✓	✓
Check/adjust idle speed						
Check/adjust valve clearance						
Clean fuel tank, strainer and carburetor					✓**	✓**
Clean carbon build-up from combustion chamber						
Replace fuel line if necessary						✓**

* Service more frequently when used in dusty areas.

** These items should be serviced by a qualified technician.

PREDATOR™ ENGINES

QUICK START GUIDE

Vertical Shaft Gas Engine

Item: 69731

Engine Components

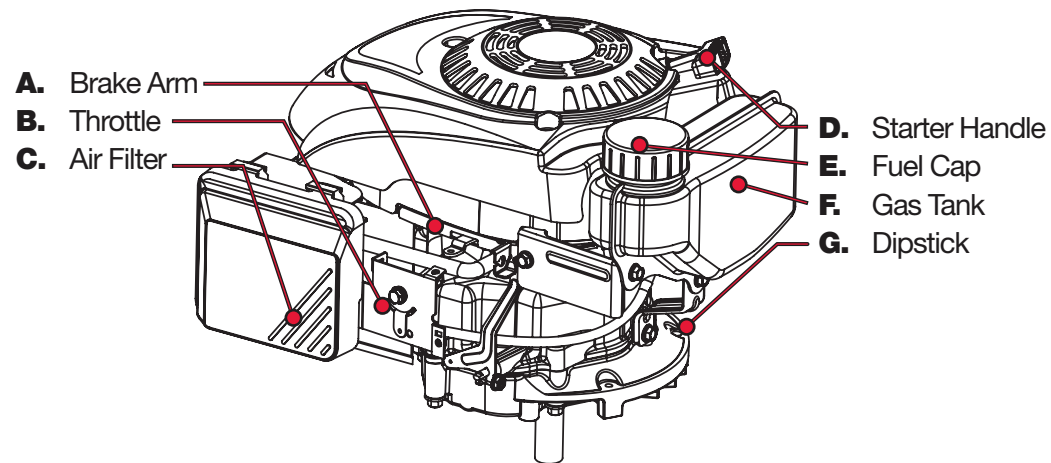

READ AND UNDERSTAND USER MANUAL BEFORE USE.

Mount Engine

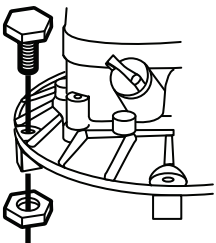

Attach Cables To Brake Arm And throttle

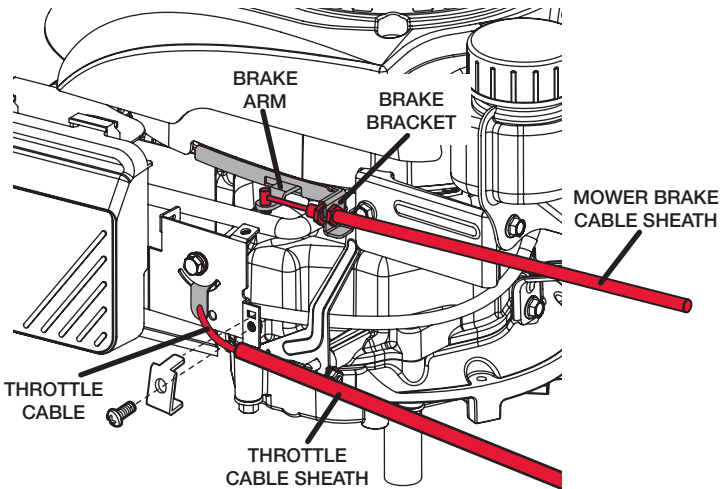

Check engine for oil and fuel on a flat surface. If engine does not have the recommended amount, fill as shown below

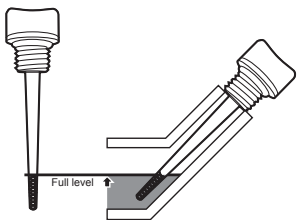

Check engine fuel level and add fuel to within 1" of the rim of the tank

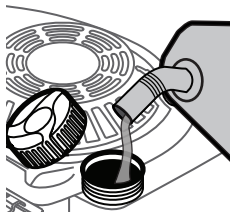

Starting Procedure

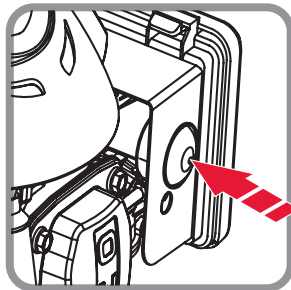

1. PRESS PRIMER TWICE

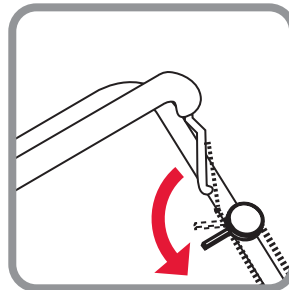

2. CLOSE THROTTLE*

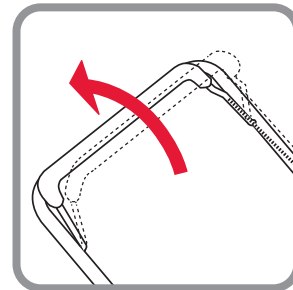

3. HOLD MOWER HANDLES TOGETHER

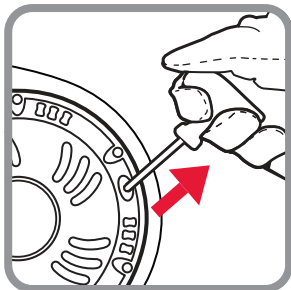

4. PULL CORD

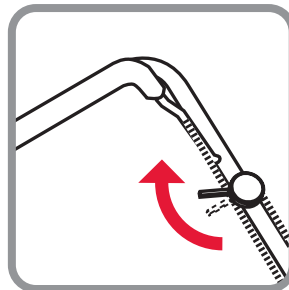

5. SLOWLY OPEN THROTTLE

*NOTE:
Location, operation and design of throttle may vary

IMPORTANT: Breaking-in the engine will help to ensure proper equipment and engine performance. The operational break-in period will last about 3 hours of use. During this period: • Do not apply a heavy load to the equipment • Do not operate the engine at its maximum speed.

PREDATOR™
ENGINES