

CENTRAL MACHINERY

®

Mobile / Folding Power Tool Stand

Model 40612

SET UP AND OPERATING INSTRUCTIONS

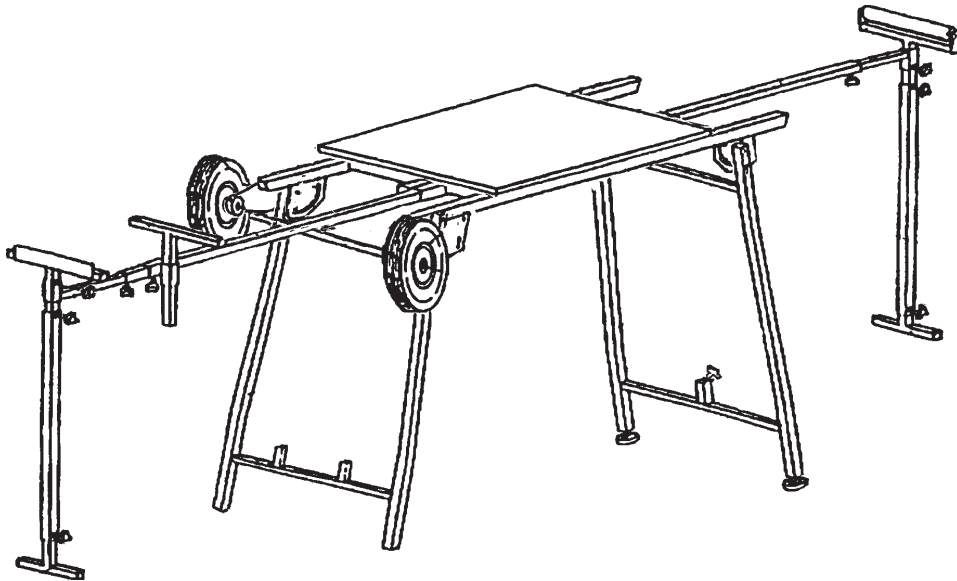

Distributed exclusively by Harbor Freight Tools®.

3491 Mission Oaks Blvd., Camarillo, CA 93011

Visit our website at: <http://www.harborfreight.com>



**Read this material before using this product.
Failure to do so can result in serious injury.
SAVE THIS MANUAL.**

Copyright© 1999 by Harbor Freight Tools®. All rights reserved. No portion of this manual or any artwork contained herein may be reproduced in any shape or form without the express written consent of Harbor Freight Tools. Diagrams within this manual may not be drawn proportionally. Due to continuing improvements, actual product may differ slightly from the product described herein. Tools required for assembly and service may not be included.

For technical questions or replacement parts, please call 1-800-444-3353.

Cover Revised 05e, 09c

SPECIFICATIONS

| | |
|----------------------------|---------------------|
| Maximum Extension Length | 13' x 10" |
| Table Top Dimensions | 28" x 19-1/2" |
| Extension Wings Max. Width | 57" |
| Overall Dimensions | 22" x 52" x 37-3/4" |
| Wheel Diameter | 7-3/4" |
| Roller Diameter | 1-1/4" |
| Material | Square Steel Tubing |
| Net Weight | 71 lb. |

ASSEMBLY INSTRUCTIONS

Please refer to the Parts Diagram to confirm identification of the parts discussed below. The Mobile/Folding Tool Stand comes partially assembled. All that remains is to attach the legs and wheels to one end. It is best to have someone help align the parts as you work. Lay the table upside down at a comfortable working height, and proceed as follows.

1. Slide one Latch Spring (#19) over one Latch Pin (#18) until the spring stops. Insert the spring end through the large diameter hole on one side of the leg assembly. The handle of the Latch Pin should be toward the outside of the square tubing.
2. Place the narrow end of the legs over the outside of the pivot brackets that are welded to the table frame -here is where help is needed. Take one Axle Plate (#5) and slide the small round hole over the handle of Latch Pin (#18). Note that the long straight edge of the axle plate should be facing down, toward the table top. Hold together tightly, and insert one Bolt (#24) through the lower square hole in the plate, the leg, and pivot bracket. Fasten loosely with one Washer (#27) and one Locking Nut (#28). Repeat this with the upper square hole, but use a Locking Knob (#20) on the thread in place of the lock nut.

This bolt goes through the curved slot in the pivot bracket. Note how the Latch Pin (#18) is meant to engage the holes adjacent to either end of the curved slot.

3. Repeat steps 1 and 2 on the other side of the table. Install the Leveling Guides (#21) to the bottom of the legs. Tighten the fasteners on both sides of the leg assembly.
4. Insert Axle (#6) through one of the Axle Plates (#5), then slide both Axle Collars (#23) over the axle. Leave loose for now. Slide end of axle through the other Axle Plate. Install Wheels (#8) on each side of axle, and fasten with a Flat Washer (#26) and Axle Bolt (#22). Slide each axle collar next to the axle plates, and tighten the Hex Bolt (#29).
5. By loosening the Locking Knobs (#20) and pulling outward on the Latch Pins, the legs can either be extended for use or folded for storage. When folded, the table can be moved about on the Wheels.
6. The table can be configured in multiple ways by moving and adjusting the stops and rollers to suit the application.

WARNING

Read All Instructions and warnings before using this product.

COMMON SENSE AND CAUTION ARE FACTORS WHICH CANNOT BE BUILT INTO ANY PRODUCT; THESE SAFETY FACTORS MUST BE SUPPLIED BY THE OPERATOR.

1. Select a level surface, free from obstructions, when working with power tools.
2. **Properly anchor tools to the table work surface before starting work. Power tools must be bolted securely to the Power Tool Stand before using.**
3. When folding or unfolding the stand, be careful not to pinch fingers.
4. Align all work supports with work surfaces.
5. **Wear ANSI-approved safety goggles during assembly.**
6. Work supports must be within safe operating limits, and locked into place before starting power tools.
7. When working with long or heavy workpieces (over 50 lb.) use additional supports.
8. Test your work set-up for stability before beginning work.
9. Always unplug your power tool when making adjustments or repairs to the work set-up area.
10. Keep Work area Clean and uncluttered. Clutter, grease and debris can cause accidents.
11. Keep children away while tools are being set up or in use.
12. Never leave power tools unattended where children or unauthorized persons can use them.
13. **Do not exceed 550 lb. capacity. Be aware of dynamic loading!** Sudden load movement may briefly create excess load causing product failure.
14. Do not operate power tools, or use this product if over-tired or under the influence of drugs, alcohol or medicines.
15. Do not wear loose clothing or jewelry when operating power equipment.
16. Never reach over or across running power tools.
17. Always check that adjusting wrenches or keys are removed from any machine before starting.
18. Check for alignment and binding of all moving parts, broken parts or other conditions that may affect safe operation. Any damaged part should be repaired or replaced by a qualified technician.
19. Never force any tool or fixture beyond its design limits. This will damage the tool, and may cause injury or property damage.
20. When repairing this table or any tool, use only factory original parts.

For replacement parts, contact Harbor Freight Tools.

MAINTENANCE

Your Mobile / Folding Power Tool Stand requires very little maintenance. Keep it clean and dry, and occasionally put a small amount of machine oil on the threaded parts.

PLEASE READ THE FOLLOWING CAREFULLY

THE MANUFACTURER AND/OR DISTRIBUTOR HAS PROVIDED THE PARTS DIAGRAM IN THIS MANUAL AS A REFERENCE TOOL ONLY. NEITHER THE MANUFACTURER NOR DISTRIBUTOR MAKES ANY REPRESENTATION OR WARRANTY OF ANY KIND TO THE BUYER THAT HE OR SHE IS QUALIFIED TO MAKE ANY REPAIRS TO THE PRODUCT OR THAT HE OR SHE IS QUALIFIED TO REPLACE ANY PARTS OF THE PRODUCT. IN FACT, THE MANUFACTURER AND/OR DISTRIBUTOR EXPRESSLY STATES THAT ALL REPAIRS AND PARTS REPLACEMENTS SHOULD BE UNDERTAKEN BY CERTIFIED AND LICENSED TECHNICIANS AND NOT BY THE BUYER. THE BUYER ASSUMES ALL RISK AND LIABILITY ARISING OUT OF HIS OR HER REPAIRS TO THE ORIGINAL PRODUCT OR REPLACEMENT PARTS THERETO, OR ARISING OUT OF HIS OR HER INSTALLATION OF REPLACEMENT PARTS THERETO.

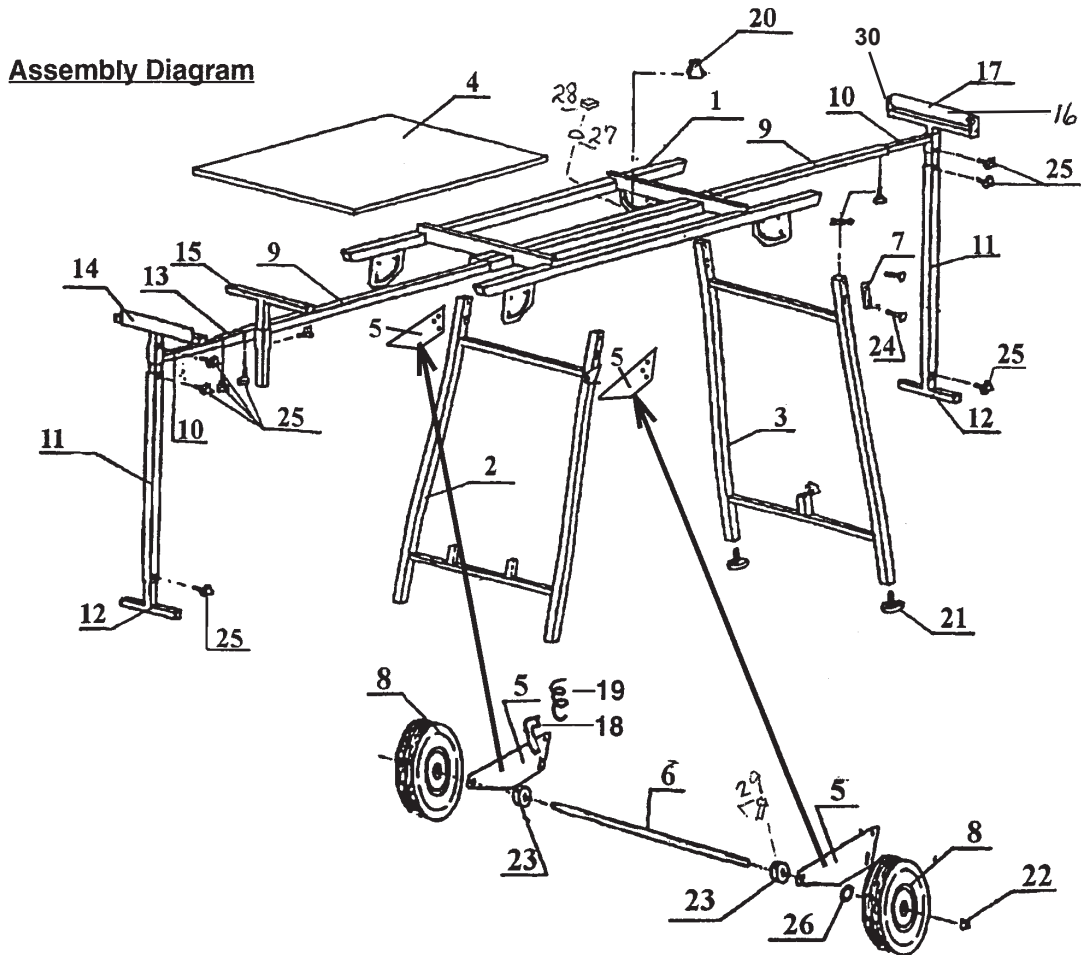

Note: Some parts are listed and shown for illustration purposes only, and are not available individually as replacement parts.

PARTS LIST

| Part | Description | Qty |
|-------------|--------------------|------------|
| 1 | Top Frame | 1 |
| 2 | Left Leg Assembly | 1 |
| 3 | Right Leg Assembly | 1 |
| 4 | Table Top | 1 |
| 5 | Axle Plate | 2 |
| 6 | Axle Shaft | 1 |
| 7 | Leg Plate | 2 |
| 8 | Wheel | 2 |
| 9 | Outrigger - 1" sq. | 2 |
| 10 | Outer Extension | 2 |
| 11 | Support Leg | 2 |
| 12 | Adjustable Foot | 2 |
| 13 | Adaptor Tee | 1 |
| 14 | Posi-stop Tee | 1 |
| 15 | Support Tee | 1 |

| Part | Description | Qty |
|-------------|---------------------------------|------------|
| 16 | Support Roller Tee | 1 |
| 17 | Roller 1-3/8" x 10" | 1 |
| 18 | Latch Pin | 2 |
| 19 | Latch Spring | 2 |
| 20 | Locking Knob | 4 |
| 21 | Leveling Glide | 2 |
| 22 | Axle Bolt 1/2" x 20 | 2 |
| 23 | Axle Collar | 2 |
| 24 | Carriage Bolt 1/4" x 20 x 1.75" | 8 |
| 25 | Locking Knob 5/16" male | 12 |
| 26 | Flat Washer 1/2" | 2 |
| 27 | Flat Washer 1/4" | 14 |
| 28 | Self Locking Nut 1/4" | 8 |
| 29 | Hex Bolt 1/4" x 20 x | 2 |
| 30 | Locking Pin for Roller | 2 |