

# Owner's Manual & Safety Instructions

**Save This Manual** Keep this manual for the safety warnings and precautions, assembly, operating, inspection, maintenance and cleaning procedures. Write the product's serial number in the back of the manual near the assembly diagram (or month and year of purchase if product has no number). Keep this manual and the receipt in a safe and dry place for future reference.

**PITTSBURGH** MOTORCYCLE

**ITEM 60810**

## ***MOTORCYCLE TIRE CHANGER ATTACHMENT***



Visit our website at: <http://www.harborfreight.com>  
Email our technical support at: [tech@harborfreight.com](mailto:tech@harborfreight.com)

When unpacking, make sure that the product is intact and undamaged. If any parts are missing or broken, please call 1-800-444-3353 as soon as possible.

Copyright© 2013 by Harbor Freight Tools®. All rights reserved.  
No portion of this manual or any artwork contained herein may be reproduced in any shape or form without the express written consent of Harbor Freight Tools. Diagrams within this manual may not be drawn proportionally. Due to continuing improvements, actual product may differ slightly from the product described herein.  
Tools required for assembly and service may not be included.

### **⚠ WARNING**





**Read this material before using this product.  
Failure to do so can result in serious injury.  
SAVE THIS MANUAL.**

# Table of Contents

Safety .....	2	Maintenance .....	9
Specifications .....	3	Parts List and Diagram .....	10
Setup .....	4	Warranty .....	12
Operation.....	5		

## **PITTSBURGH** MOTORCYCLE

### WARNING SYMBOLS AND DEFINITIONS

	This is the safety alert symbol. It is used to alert you to potential personal injury hazards. Obey all safety messages that follow this symbol to avoid possible injury or death.
	Indicates a hazardous situation which, if not avoided, will result in death or serious injury.
	Indicates a hazardous situation which, if not avoided, could result in death or serious injury.
	Indicates a hazardous situation which, if not avoided, could result in minor or moderate injury.
	Addresses practices not related to personal injury.

SAFETY

SETUP

OPERATION

MAINTENANCE

# IMPORTANT SAFETY INFORMATION

## WARNING

Read all safety warnings and instructions.

*Failure to follow the warnings and instructions may result in serious injury or death.*

Save all warnings and instructions for future reference.

## General Safety Warnings

1. Deflate tire completely before changing.
2. Do not use old or repaired tires or tubes. Replacement tires or tubes must be new.
3. Do not exceed rated rim capacity.
4. Wear ANSI-approved safety goggles and heavy-duty work gloves during assembly and use.
5. Read manual before use.
6. Inspect before every use; do not use if parts loose or damaged.
7. This product can only be used with Pittsburgh Automotive Portable Tire Changer.
8. Do not change automobile tires with this product. For use with motorcycle tires only.
9. **Keep the work area clean and well lit.** Cluttered and dark areas increase the risks of injury to persons.
10. **Keep bystanders, children, and visitors away while operating the tool.** Distractions are able to result in the loss of control of the tool.
11. **Stay alert. Watch what you are doing and use common sense when operating the Motorcycle Tire Changer Attachment.**
12. **Do not use Motorcycle Tire Changer Attachment while tired or under the influence of drugs, alcohol, or medication.** A moment of inattention while operating the tool increases the risk of injury to persons.
13. **Do not overreach. Keep proper footing and balance at all times.** Proper footing and balance enables better control of the tool in unexpected situations.
14. Assemble only according to these instructions. Improper assembly can create hazards.
15. This product is not a toy. Do not allow children to play with or near this item.
16. Use as intended only.
17. Maintain product labels and nameplates. These carry important safety information. If unreadable or missing, contact Harbor Freight Tools for a replacement.
18. The warnings, precautions, and instructions discussed in this instruction manual cannot cover all possible conditions and situations that may occur. It must be understood by the operator that common sense and caution are factors which cannot be built into this product, but must be supplied by the operator.



## SAVE THESE INSTRUCTIONS.

## Specifications

Rim Capacity	11" - 25" Diameter
--------------	--------------------

# Assembly Instructions



Read the **ENTIRE IMPORTANT SAFETY INFORMATION** section at the beginning of this document including all text under subheadings therein before set up or use of this product.

SAFETY

**Note:** For additional information regarding the parts listed in the following pages, refer to Parts List and Assembly Diagram on page 10 and Owner's Manual for Pittsburgh Automotive Portable Tire Changer.

1. Attach Adjustable Support Tube (8) and Support Tubes (5) to Base (9) with Bolts (12) and Nuts (13).
2. Thread Bolts (11) loosely into Adjustable Wheel Clamp.
3. Thread Knob (10) into Base. (See Figure A.)
6. Attach Vertical Support Bar (3) to Adjustable Support Tube and secure with Bolt (12) and Nut (13).
7. Attach Support Arm (2) to Vertical Support Bar and secure with Bolt (12) and Nut (13).
8. Slide Center Post (1) down Support Arm tube and into Base. Thread Knob (10) into Support Arm.
9. Secure Center Post by tightening Knob. (See Figure C.)

SETUP

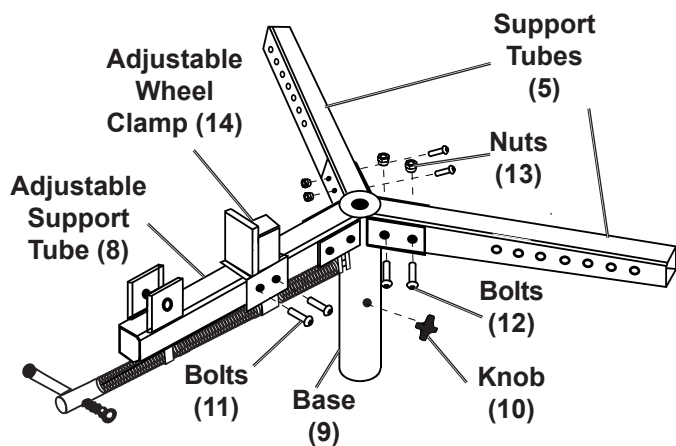

Figure A

4. Mount Motorcycle Tire Changer Attachment Base over Portable Tire Changer Center Post. Secure by tightening Knob.
5. Slide Wheel Clamps (4) onto Support Tubes and secure with Pins (6) and R-Clips (7). (See Figure B.)

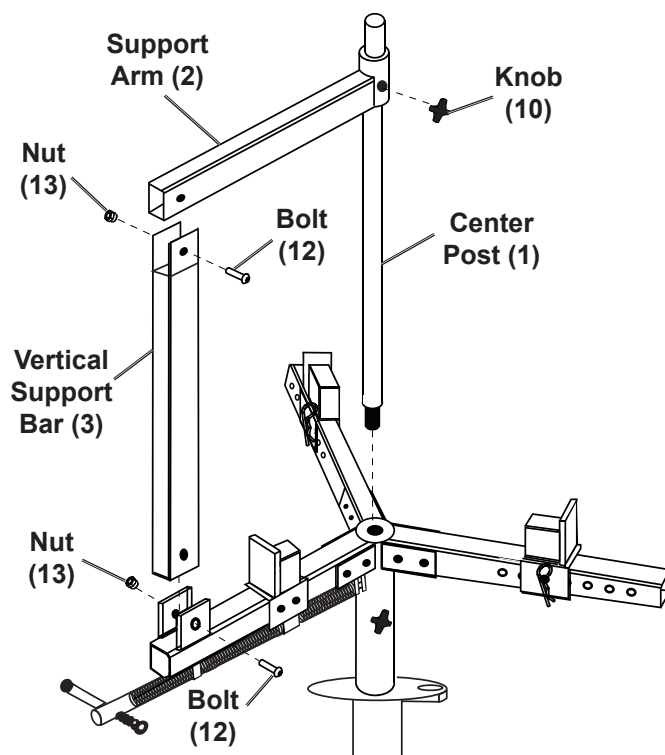

Figure C

OPERATION

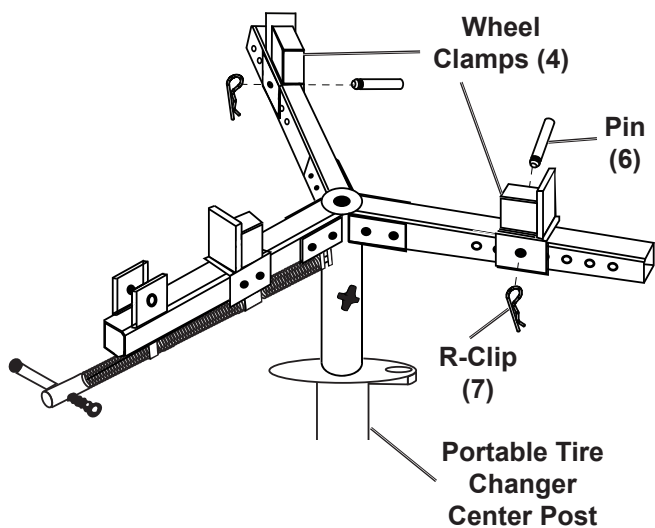

Figure B

MAINTENANCE

## Operating Instructions



Read the **ENTIRE IMPORTANT SAFETY INFORMATION** section at the beginning of this document including all text under subheadings therein before set up or use of this product.

## Demounting Tire

### Bead Breaking

**Note:** Before removing tire, mark rotation direction on rim to ensure correct replacement.

**Note:** Use tire lubricant (not included) as needed.

1. Remove valve cap. Deflate tire by removing valve core with valve core remover (not included).

**For Tubed Tires:** Remove valve nut.

**CAUTION!** Tire is under extreme pressure. Maintain firm grip on core and remover to prevent pressure from propelling them and causing injury.

2. Lubricate area where sidewall meets rim.

**Note:** Use blocks and rim protectors (not included) to protect rim and/or rotor from damage.

3. Insert flat end of Mount/Demount Bar (from Portable Tire Changer) into Bead Breaker Handle.
4. Set Shoe against edge of rim.

**Note:** To adjust Shoe, remove R-Clip and Pin, move Shoe, then replace Pin and R-Clip.

5. Push down on Mount/Demount Bar, forcing bead off the rim. Repeat in several locations if necessary.

6. After bead is broken, turn tire over and break bead on other side. (See Figure D.)

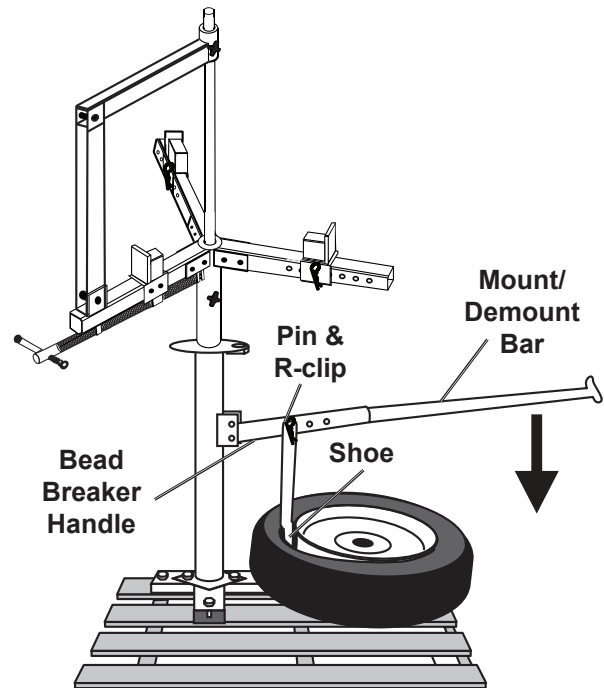

Figure D

**PITTSBURGH** MOTORCYCLE

# Components

SAFETY

SETUP

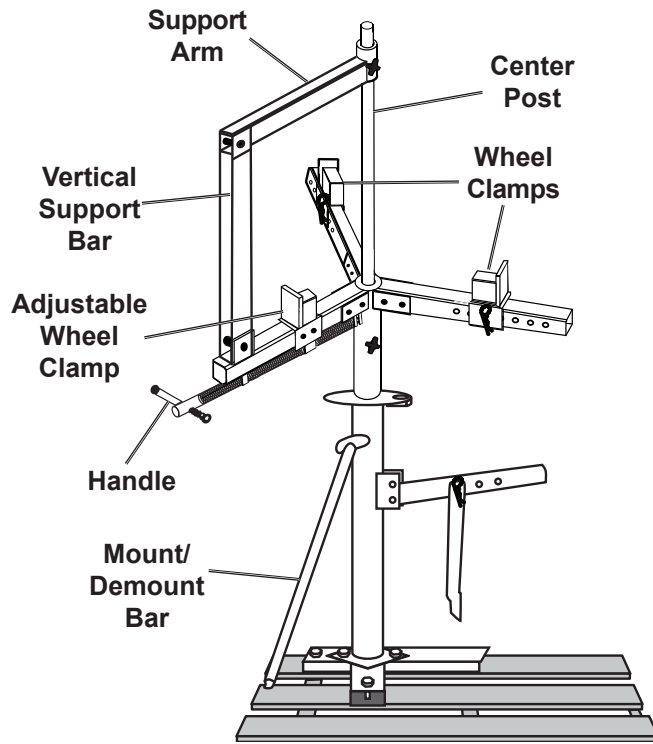

Figure E

## Removing Top Bead

1. Loosen Knob on Support Arm, pull Center Post up enough for tire to clear, then tighten Knob.
2. Place tire on Changer, making sure edges of Wheel Clamps are positioned between tire and rim. (See Figure F.)
3. Turn Handle to tighten Adjustable Wheel Clamp until rim is firmly secure and will not move, then tighten bolts on Adjustable Wheel Clamp.
4. Lower and secure Center Post.
5. Lubricate as needed.
6. Starting to left of Vertical Support Bar, force flat end of Mount/Demount Bar straight down between tire and rim.
7. Pull Mount/Demount Bar across tire to force bead up over rim.
8. Slide Mount/Demount Bar clockwise around tire, using Center Post for leverage, until bead is completely off rim. (See Figure G.)

**Note:** If tire has rotor, place it on Changer rotor side up.

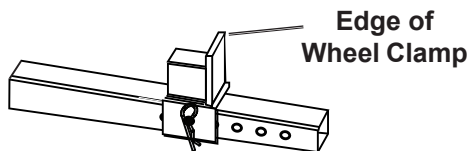

Figure F

3. Turn Handle to tighten Adjustable Wheel Clamp until rim is firmly secure and will not move, then tighten bolts on Adjustable Wheel Clamp.
4. Lower and secure Center Post.
5. Lubricate as needed.
6. Starting to left of Vertical Support Bar, force flat end of Mount/Demount Bar straight down between tire and rim.
7. Pull Mount/Demount Bar across tire to force bead up over rim.

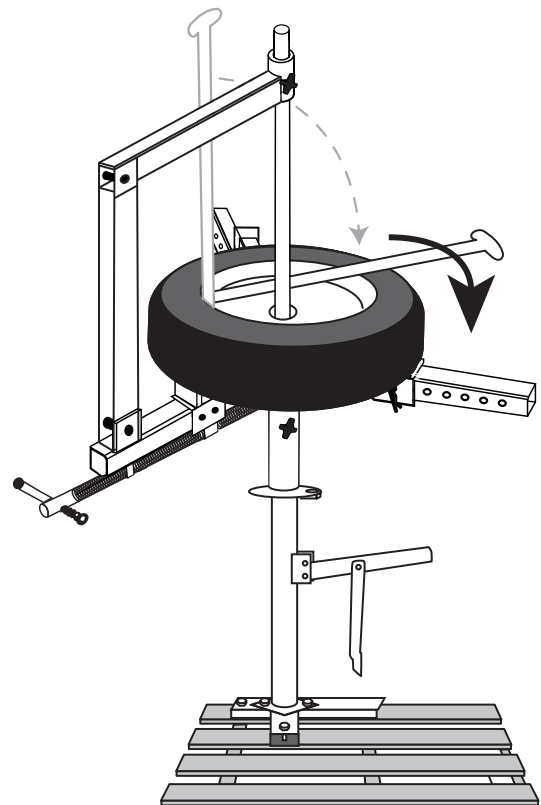

Figure G

OPERATION

MAINTENANCE

## Removing Bottom Bead

1. Starting to left of Vertical Support Bar, lift up tire, then force flat end of Mount/Demount Bar straight down between tire and rim until Mount/Demount Bar is hooked under bottom bead.
2. Pull Mount/Demount Bar across tire and, while lifting up on tire, slide Mount/Demount Bar clockwise around rim, using Center Post for leverage until bead is completely off rim. **(See Figure H.)**
3. Pull up and secure Center Post, then remove tire.

**For Tubed Tire:** Remove tube from tire.

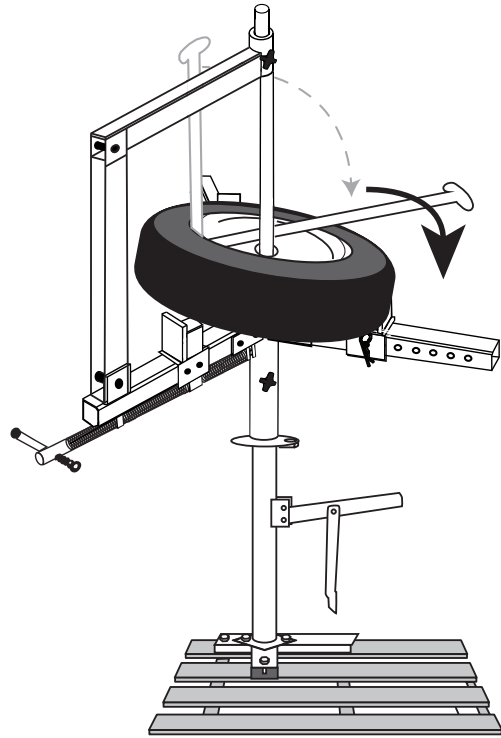

Figure H

SAFETY

SETUP

OPERATION

MAINTENANCE

**PITTSBURGH** MOTORCYCLE

# Mounting Tire

SAFETY

**WARNING!** Do not use old or repaired tires or tubes. Replacement tires or tubes must be new.

1. Clean rim edges, then set tire on top of rim.
2. Check marks on sidewall for rotation direction and valve stem alignment:
  - a. Make sure arrow on tire matches rotation marking on rim.
  - b. If there is a dot on tire, align it with valve stem. (See Figure I.)

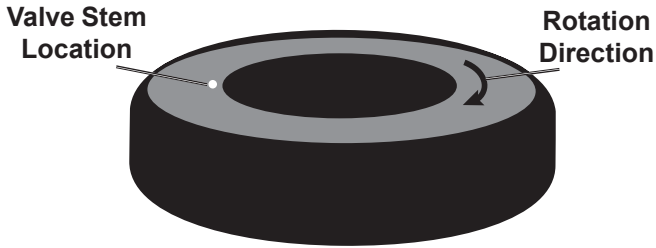

Figure I

### For Tubed Tire:

- c. Insert tube into tire, align valve stem and push through rim.
  - d. Add enough compressed air to give tube shape.
  - e. Loosely secure valve stem with valve nut.
3. Lubricate both sides of tire, at bead and sidewall, as needed.
  4. Place tire at an angle over rim and push down. It should easily pop over rim.

**For Tubed Tire:** Be careful to not pinch tube.

5. Lower and secure Center Post.
6. Lubricate again as needed.
7. Starting to left of Vertical Support Bar, lay Mount/Demount Bar across rim, inserting hook end under rim.

SETUP

OPERATION

MAINTENANCE

8. Push down on tire while sliding Mount/Demount Bar clockwise around rim, using Center Post for leverage. (See Figure J.)

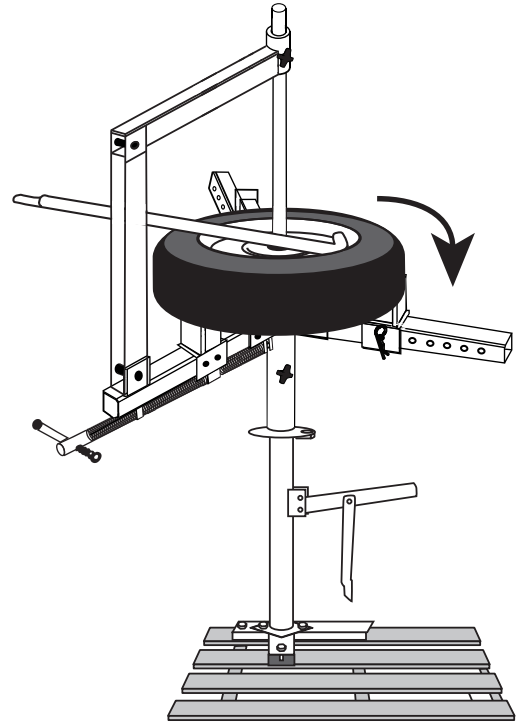

Figure J

9. After bead is completely under rim, pull up and secure Center Post and remove tire.
10. Fill tire or tube with compressed air until both beads pop.

**For Tubeless Tire:** Replace valve core.

**For Tubed Tire:** Tighten valve nut.

**WARNING!** Check for leaks and balance tire before installing.

11. After installation, inflate tire to manufacturer's recommended pressure, then replace valve cap.



## Maintenance Instructions



Procedures not specifically explained in this manual must be performed only by a qualified technician.

### **WARNING**

**TO PREVENT SERIOUS INJURY FROM TOOL FAILURE:**  
Do not use damaged equipment.

## Maintenance and Cleaning

1. **BEFORE EACH USE**, inspect the general condition of the Motorcycle Tire Changer Attachment. Check for:
  - loose hardware,
  - misalignment or binding of moving parts,
  - cracked or broken parts, and
  - any other condition that may affect its safe operation.
2. **AFTER USE**, wipe external surfaces of Motorcycle Tire Changer Attachment with clean cloth.

**PITTSBURGH** MOTORCYCLE

## Parts List and Diagram

### PLEASE READ THE FOLLOWING CAREFULLY

THE MANUFACTURER AND/OR DISTRIBUTOR HAS PROVIDED THE PARTS LIST AND ASSEMBLY DIAGRAM IN THIS DOCUMENT AS A REFERENCE TOOL ONLY. NEITHER THE MANUFACTURER OR DISTRIBUTOR MAKES ANY REPRESENTATION OR WARRANTY OF ANY KIND TO THE BUYER THAT HE OR SHE IS QUALIFIED TO MAKE ANY REPAIRS TO THE PRODUCT, OR THAT HE OR SHE IS QUALIFIED TO REPLACE ANY PARTS OF THE PRODUCT. IN FACT, THE MANUFACTURER AND/OR DISTRIBUTOR EXPRESSLY STATES THAT ALL REPAIRS AND PARTS REPLACEMENTS SHOULD BE UNDERTAKEN BY CERTIFIED AND LICENSED TECHNICIANS, AND NOT BY THE BUYER. THE BUYER ASSUMES ALL RISK AND LIABILITY ARISING OUT OF HIS OR HER REPAIRS TO THE ORIGINAL PRODUCT OR REPLACEMENT PARTS THERETO, OR ARISING OUT OF HIS OR HER INSTALLATION OF REPLACEMENT PARTS THERETO.

### Parts List

Part	Description	Qty
1	Center Post	1
2	Support Arm	1
3	Vertical Support Bar	1
4	Wheel Clamp	2
5	Support Tube	2
6	Pin	2
7	R-Clip	2
8	Adjustable Support Tube	1

Part	Description	Qty
9	Base	1
10	Knob	2
11	Bolt (M10x25)	2
12	Bolt (M10x60)	8
13	Nut (M10)	8
14	Adjustable Wheel Clamp	1
15	Handle	1

Record Serial Number Here:

**Note:** If product has no serial number, record month and year of purchase instead.

**Note:** Some parts are listed and shown for illustration purposes only, and are not available individually as replacement parts.

# Assembly Diagram

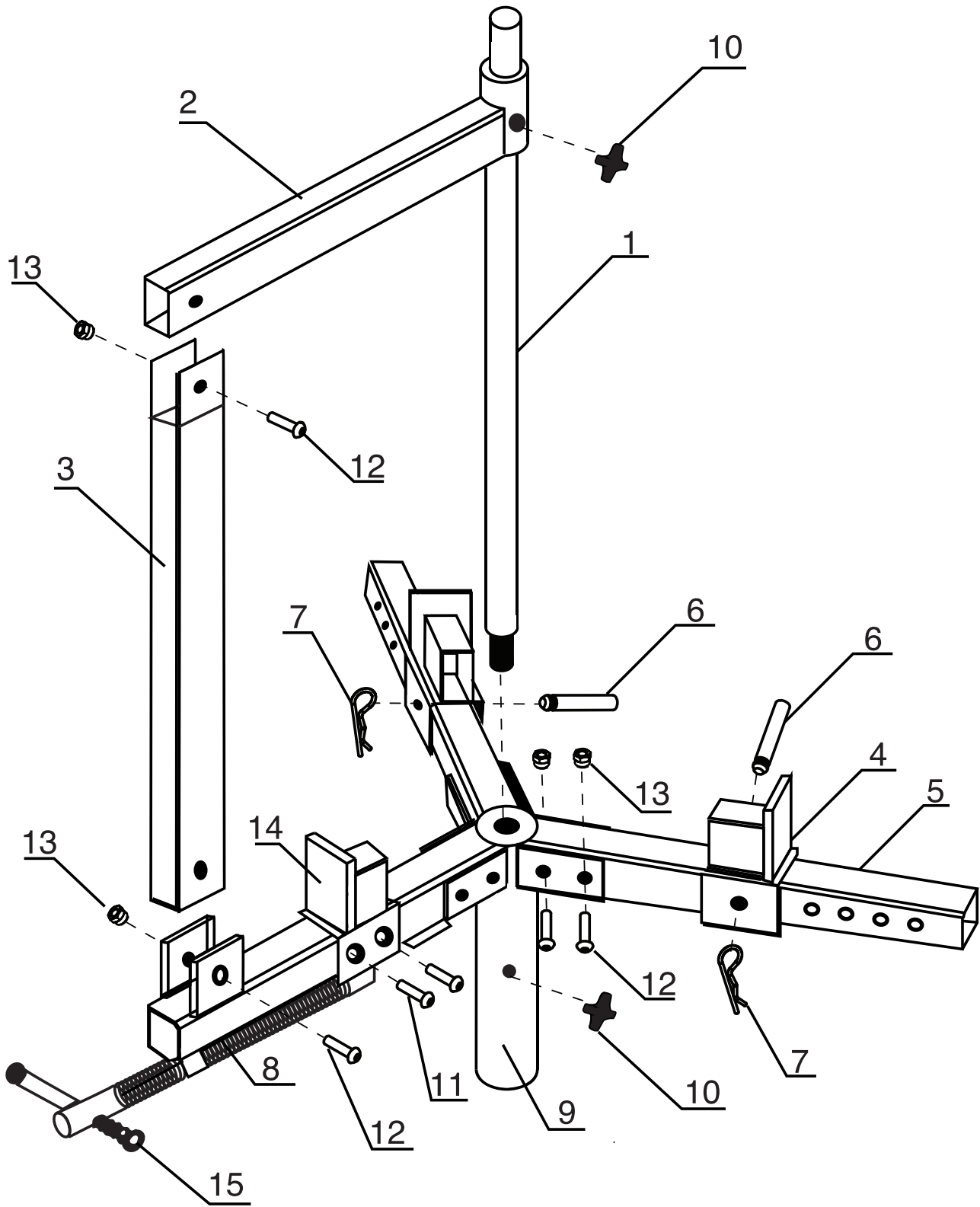

SAFETY

SETUP

OPERATION

MAINTENANCE

## Limited 90 Day Warranty

Harbor Freight Tools Co. makes every effort to assure that its products meet high quality and durability standards, and warrants to the original purchaser that this product is free from defects in materials and workmanship for the period of 90 days from the date of purchase. This warranty does not apply to damage due directly or indirectly, to misuse, abuse, negligence or accidents, repairs or alterations outside our facilities, criminal activity, improper installation, normal wear and tear, or to lack of maintenance. We shall in no event be liable for death, injuries to persons or property, or for incidental, contingent, special or consequential damages arising from the use of our product. Some states do not allow the exclusion or limitation of incidental or consequential damages, so the above limitation of exclusion may not apply to you. THIS WARRANTY IS EXPRESSLY IN LIEU OF ALL OTHER WARRANTIES, EXPRESS OR IMPLIED, INCLUDING THE WARRANTIES OF MERCHANTABILITY AND FITNESS.

To take advantage of this warranty, the product or part must be returned to us with transportation charges prepaid. Proof of purchase date and an explanation of the complaint must accompany the merchandise. If our inspection verifies the defect, we will either repair or replace the product at our election or we may elect to refund the purchase price if we cannot readily and quickly provide you with a replacement. We will return repaired products at our expense, but if we determine there is no defect, or that the defect resulted from causes not within the scope of our warranty, then you must bear the cost of returning the product.

This warranty gives you specific legal rights and you may also have other rights which vary from state to state.

***PITTSBURGH***<sup>®</sup> ***MOTORCYCLE***

3491 Mission Oaks Blvd. • PO Box 6009 • Camarillo, CA 93011 • (800) 444-3353