

Owner's Manual & Safety Instructions

Save This Manual Keep this manual for the safety warnings and precautions, assembly, operating, inspection, maintenance and cleaning procedures. Write the product's serial number in the back of the manual near the assembly diagram (or month and year of purchase if product has no number). Keep this manual and the receipt in a safe and dry place for future reference.



METAL

PLANISHING HAMMER STAND



Specifications

Mounting Plate	12-3/4" L x 5-1/2" W
Top Plate Mounting Holes/Slots	(4x) 3/4" dia. (4x) 1" L x 7/16" W
Base Mounting Holes	(3x) 7/16" dia.

Item 94847, Planishing Hammer not included .
Visit our website at: <http://www.harborfreight.com>
Email our technical support at: tech@harborfreight.com

ITEM 69032

When unpacking, make sure that the product is intact and undamaged. If any parts are missing or broken, please call 1-800-444-3353 as soon as possible.

Copyright© 2011 by Harbor Freight Tools®. All rights reserved.
No portion of this manual or any artwork contained herein may be reproduced in any shape or form without the express written consent of Harbor Freight Tools. Diagrams within this manual may not be drawn proportionally. Due to continuing improvements, actual product may differ slightly from the product described herein. Tools required for assembly and service may not be included.

⚠WARNING

**Read this material before using this product.
Failure to do so can result in serious injury.
SAVE THIS MANUAL.**

Important Safety Information

Assembly Precautions

1. Assemble only according to these instructions. Improper assembly can create hazards.
2. Wear ANSI-approved safety goggles and heavy-duty work gloves during assembly.
3. Keep assembly area clean and well lit.
4. Keep bystanders out of the area during assembly.
5. Do not assemble when tired or when under the influence of drugs or medication.
6. Weight capacity and other product capabilities apply to properly and completely assembled product only.
7. Only fill the Stand with sand.

Use Precautions

1. This product is not a toy. Do not allow children to play with or near this item.
2. Only use to support item 94847, Planishing Hammer.
3. Inspect before every use; do not use if parts are loose or damaged.
4. Maintain product labels and nameplates. These carry important safety information. If unreadable or missing, contact Harbor Freight Tools for a replacement.
5. Use on a flat, level, hard surface capable of supporting the Stand, the Planishing Hammer, the metal being worked on, and the vibration of the planishing process.
6. Do not sit, stand, or climb on this Stand.

Assembly Instructions



Read the **ENTIRE IMPORTANT SAFETY INFORMATION** section at the beginning of this document including all text under subheadings therein before set up or use of this product.

Note: Refer to Parts List and Diagram during assembly.
Do not tighten hardware fully until directed to do so.

1. Connect Pedestal (1) to Leg (5), using Bolts (2) and Nuts (3).
2. Connect Foot (6) to Pedestal (1), also using Bolts (2) and Nuts (3).
3. Connect Cross Brace (7) between Foot (6) and Leg (5), using Bolts (2).
4. Rest the Stand upright on a flat, level surface to make certain that it sits evenly. Then, fully tighten all hardware.
5. Unscrew and remove both Plugs (4) and fill the Stand with sand to reduce noise when using the Planishing Hammer. Only use sand to fill the Stand. Screw the Plugs back onto the Stand.
6. Place the Planishing Hammer on top of the Stand and align the mounting holes of both Stand and Planishing Hammer. Position the operating portion of the planishing hammer above the Foot (6) of the stand as shown on the cover picture.
7. Secure Planishing Hammer to the top of the Pedestal (1) using grade 5 bolts, washers, and nylon insert nuts (none included).
8. For stability, anchor the Stand to a concrete floor using proper concrete anchors and nuts (none included) through the holes at the base of the Foot (6) and Leg (5).

Parts List and Diagram

Part	Description	Qty
1	Pedestal	1
2	Bolt	6
3	Nut	4
4	Plug	2
5	Leg	1
6	Foot	1
7	Cross Brace	1

Record Serial Number Here:

Note: If product has no serial number, record month and year of purchase instead.

Note: Some parts are listed and shown for illustration purposes only, and are not available individually as replacement parts.

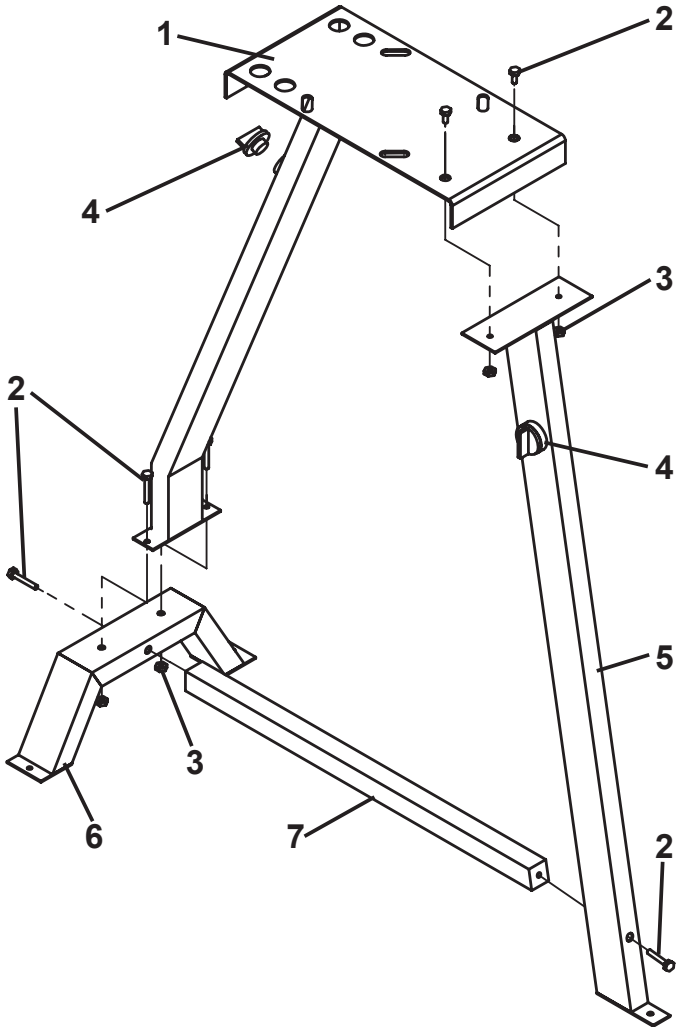

PLEASE READ THE FOLLOWING CAREFULLY

THE MANUFACTURER AND/OR DISTRIBUTOR HAS PROVIDED THE PARTS LIST AND ASSEMBLY DIAGRAM IN THIS DOCUMENT AS A REFERENCE TOOL ONLY. NEITHER THE MANUFACTURER OR DISTRIBUTOR MAKES ANY REPRESENTATION OR WARRANTY OF ANY KIND TO THE BUYER THAT HE OR SHE IS QUALIFIED TO MAKE ANY REPAIRS TO THE PRODUCT, OR THAT HE OR SHE IS QUALIFIED TO REPLACE ANY PARTS OF THE PRODUCT. IN FACT, THE MANUFACTURER AND/OR DISTRIBUTOR EXPRESSLY STATES THAT ALL REPAIRS AND PARTS REPLACEMENTS SHOULD BE UNDERTAKEN BY CERTIFIED AND LICENSED TECHNICIANS, AND NOT BY THE BUYER. THE BUYER ASSUMES ALL RISK AND LIABILITY ARISING OUT OF HIS OR HER REPAIRS TO THE ORIGINAL PRODUCT OR REPLACEMENT PARTS THERETO, OR ARISING OUT OF HIS OR HER INSTALLATION OF REPLACEMENT PARTS THERETO.

Limited 90 Day Warranty

Harbor Freight Tools Co. makes every effort to assure that its products meet high quality and durability standards, and warrants to the original purchaser that this product is free from defects in materials and workmanship for the period of 90 days from the date of purchase. This warranty does not apply to damage due directly or indirectly, to misuse, abuse, negligence or accidents, repairs or alterations outside our facilities, criminal activity, improper installation, normal wear and tear, or to lack of maintenance. We shall in no event be liable for death, injuries to persons or property, or for incidental, contingent, special or consequential damages arising from the use of our product. Some states do not allow the exclusion or limitation of incidental or consequential damages, so the above limitation of exclusion may not apply to you. THIS WARRANTY IS EXPRESSLY IN LIEU OF ALL OTHER WARRANTIES, EXPRESS OR IMPLIED, INCLUDING THE WARRANTIES OF MERCHANTABILITY AND FITNESS.

To take advantage of this warranty, the product or part must be returned to us with transportation charges prepaid. Proof of purchase date and an explanation of the complaint must accompany the merchandise. If our inspection verifies the defect, we will either repair or replace the product at our election or we may elect to refund the purchase price if we cannot readily and quickly provide you with a replacement. We will return repaired products at our expense, but if we determine there is no defect, or that the defect resulted from causes not within the scope of our warranty, then you must bear the cost of returning the product.

This warranty gives you specific legal rights and you may also have other rights which vary from state to state.

