

Pulley Remover & Installer Set

Item 40749

INSTRUCTIONS & PRECAUTIONS



Visit our website at:
<http://www.harborfreight.com>

!WARNING

Read this material before using this product. Failure to do so can result in serious injury. SAVE THIS MANUAL.

When unpacking, make sure that the product is intact and undamaged. If any parts are missing or broken, please call 1-800-444-3353 as soon as possible.

Copyright© 2011 by Harbor Freight Tools®. All rights reserved. No portion of this document or any artwork contained herein may be reproduced in any shape or form without the express written consent of Harbor Freight Tools. Diagrams within this document may not be drawn proportionally. Due to continuing improvements, actual product may differ slightly from the product described herein. Tools required for assembly and service may not be included.

For technical questions or replacement parts, please call 1-800-444-3353.

Manual Revised 11c

Specifications

Jackscrew	5/8" - 18
Ford® 4.6L	0.365" - 16 to 0.311" - 20
GM® 3.1L	0.367" - 16
Quad 4	0.367" - 16 to 0.369" - 16
All others	0.366" - 16 to 0.365" - 16

Important Safety Information

Precautions

1. Use only according to these instructions. Improper assembly and usage can create hazards.
2. Wear ANSI-approved safety goggles and heavy-duty work gloves during usage.
3. Keep area clean and well lit.
4. Keep children and other bystanders out of the area.
5. Do not use when tired or when under the influence of drugs or medication.
6. Use as intended only.
7. Inspect before every use; do not use if parts are loose or damaged.
8. Maintain product labels and nameplates. These carry important safety information. If unreadable or missing, contact Harbor Freight Tools for a replacement.

Instructions



Read the **ENTIRE IMPORTANT SAFETY INFORMATION** section at the beginning of this document including all text under subheadings therein before set up or use of this product.

Removal

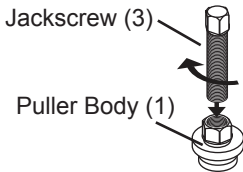

Figure 1

1. Coat Jackscrew (3) with lubricant and thread into Puller Body (1).

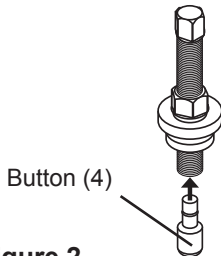

Figure 2

2. Push Button (4) or appropriate Puller Pin (7 or 9) into hole in Jackscrew.

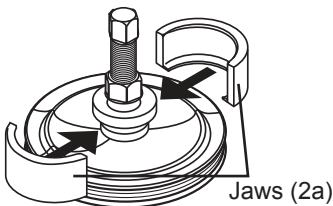

Figure 3

3. Assemble Jaws (2a) over Puller Body (1) and pulley flange.

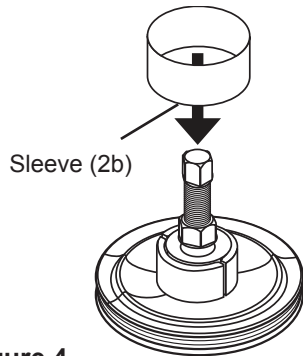

Figure 4

4. Hand tighten Jackscrew and slide Jaw Sleeve (2b) into position over jaws.

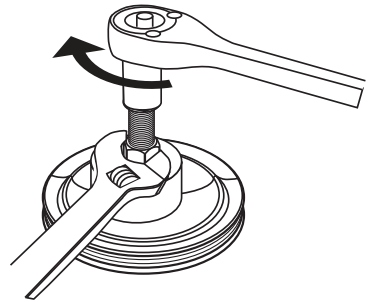

Figure 5

5. Hold Puller Body (1) with 1" or adjustable wrench (sold separately). Turn Jackscrew with 1/2" socket wrench (sold separately) until pulley is removed.

Installation (All Models)

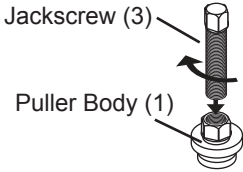

Figure 6

1. Coat Jackscrew (3) with lubricant and thread into Puller Body (1).

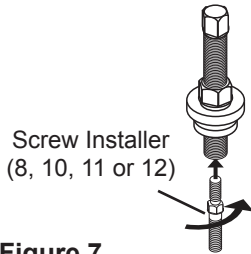

Figure 7

2. Insert small end of appropriate screw installer (8, 10, 11 or 12) into hole in Jackscrew and tighten in place.

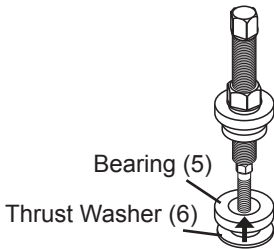

Figure 8

3. Place Bearing (5) then Thrust Washer (6) over the Screw Installer and up next to the Puller Body (1).
4. Insert the pilot end of the appropriate Screw Installer through the pulley and thread into the pump shaft until screw Installer bottoms.

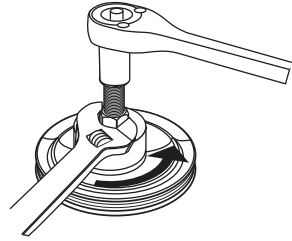

Figure 9

5. Hold Jackscrew with a 1/2" socket wrench (sold separately) and turn Puller Body with a 1" or adjustable wrench (sold separately) until the pulley is in position.

Parts List

PLEASE READ THE FOLLOWING CAREFULLY

Part	Description	Qty
1	Puller Body	1
2a	Jaw	2
2b	Sleeve	1
3	Jackscrew	1
4	Button	1
5	Bearing	1
6	Thrust Washer	1
7	Puller Pin for Quad 4	1
8	Screw Installer for Quad 4	1
9	Puller Pin for GM® 3.1L	1
10	Screw Installer for GM® 3.1L	1
11	Screw Installer for Ford® 4.6L Modular	1
12	Screw Installer for All Others	1

THE MANUFACTURER AND/OR DISTRIBUTOR HAS PROVIDED THE PARTS LIST IN THIS DOCUMENT AS A REFERENCE TOOL ONLY. NEITHER THE MANUFACTURER OR DISTRIBUTOR MAKES ANY REPRESENTATION OR WARRANTY OF ANY KIND TO THE BUYER THAT HE OR SHE IS QUALIFIED TO MAKE ANY REPAIRS TO THE PRODUCT, OR THAT HE OR SHE IS QUALIFIED TO REPLACE ANY PARTS OF THE PRODUCT. IN FACT, THE MANUFACTURER AND/OR DISTRIBUTOR EXPRESSLY STATES THAT ALL REPAIRS AND PARTS REPLACEMENTS SHOULD BE UNDERTAKEN BY CERTIFIED AND LICENSED TECHNICIANS, AND NOT BY THE BUYER. THE BUYER ASSUMES ALL RISK AND LIABILITY ARISING OUT OF HIS OR HER REPAIRS TO THE ORIGINAL PRODUCT OR REPLACEMENT PARTS THERETO, OR ARISING OUT OF HIS OR HER INSTALLATION OF REPLACEMENT PARTS THERETO.



Record Serial Number Here:

Note: If product has no serial number, record month and year of purchase instead.

Note: Some parts are listed and shown for illustration purposes only, and are not available individually as replacement parts.

PITTSBURGH AUTOMOTIVE

3491 Mission Oaks Blvd. • PO Box 6009 •
Camarillo, CA 93011 • (800) 444-3353

REV 11c