

MMI Navigation plus English Nordamerika 11.2009

MMI high B8, for internal use only

## **MMI Navigation plus** Operating Instructions

**MMI high B8, for internal use only**

© 2009 AUDI AG

It has always been Audi's policy to continuously improve its products. Audi, therefore, reserves the right to make changes in design and specifications, and to make additions or improvements in its products without incurring any obligation to install them on products previously manufactured. Text, illustrations and specifications in this book are based on the most up-to-date information available at the time of printing.

May not be reproduced or translated without the written consent of AUDI AG. All rights reserved. No liability for alteration or amendment.

**Editorial deadline: 08/28/2009**

 **For the sake of the environment**  
Printed on environmentally friendly paper (FSC certified, chlorine free, recyclable)

## Foreword

**You have decided on the Audi MMI Navigation plus - thank you very much for your confidence in us.**

With your new Audi, you are receiving a vehicle with a state-of-the art system that allows you the change the vehicle's settings and operate the electronic equipment using a Multi Media Interface called the *Audi MMI*.

We recommend that you read these Operating Instructions carefully so that you quickly get to know all of the functions and possibilities that the MMI offers and are able to make full use of them while driving. **MMI high B8, for internal use only**

Please note that these operating instructions are a supplement to your vehicle Owner's Manual and should only be used in conjunction with your current vehicle Owner's Manual.

Should you have any further questions about the MMI in your vehicle, please ask your authorized Audi dealer for assistance.

We hope you enjoy driving your Audi.

**AUDI AG**

## Table of contents

<b>About this book</b> .....	4	Setting the time .....	36	Directory .....	57
<b>MMI components</b> .....	6	Restarting the MMI (Reset) .....	37	Introduction .....	57
Overview .....	7	Additional settings .....	38	Opening the directory .....	57
Controls at a glance .....	7	Listening to the radio .....	40	Storing a new directory entry ...	57
MMI: Multi Media Interface .....	7	Introduction .....	40	Importing directory entries .....	58
Traffic safety tips .....	7	System information .....	40	Exporting address cards .....	60
Tips on caring for the MMI .....	8	Starting radio mode .....	41	Using a directory entry .....	61
<b>Drives</b> .....	9	Activating your Satellite Radio	41	Editing a directory entry .....	63
Introduction .....	9	service .....	41	Managing profiles .....	66
Overview of drives .....	9	Selecting frequency band .....	42	Additional settings .....	68
CD/DVD mode general		Selecting a station from the		<b>Calling</b> .....	69
information .....	11	station list .....	43	Introduction .....	69
Memory card general information	12	Selecting the station .....	43	Starting Telephone mode .....	69
Jukebox .....	12	Scanning stations .....	44	Dialing a telephone number .....	70
CD/DVD drive .....	14	Storing stations .....	45	Answering/ignoring a call .....	72
CD changer .....	14	Selecting a stored station .....	45	Ending a call .....	72
Memory card reader .....	16	Additional settings .....	46	Storing a phone number in the	
Audi music interface .....	17	<b>Playing media</b> .....	46	directory .....	73
Aux-in connection .....	21	Introduction .....	48	Dialing stored phone numbers ..	74
<b>Cell phone prep</b> .....	22	Starting Media mode .....	48	Deleting local call lists .....	74
Introduction .....	22	Selecting source .....	48	Bluetooth settings .....	75
Starting .....	22	Selecting a folder .....	49	Additional settings .....	75
<b>MMI control panel</b> .....	26	Selecting a track .....	49	<b>Navigating</b> .....	78
General operation .....	28	Fast forward/rewind .....	50	Introduction .....	78
All MMI menus at a glance .....	28	Next/previous track or chapter ..	50	Starting Navigation mode .....	79
Switching on/off .....	28	Track information .....	51	Entering a destination .....	79
Operating the system .....	29	Repeat options .....	51	Stopping route guidance .....	85
MMI Display .....	29	Shuffle .....	52	Display .....	86
Adjusting the volume .....	33	DVD main menu .....	52	Storing a destination .....	87
Adjusting the sound .....	34	DVD full screen display .....	53	Loading a destination .....	89
		DVD parental control .....	53	Additional settings .....	90
		Pausing/continuing playback ...	54	<b>Calling up traffic information</b> ..	95
		Additional settings .....	55	Introduction .....	95
				Calling up TMC traffic reports ...	95

MMI high B8, for internal use only

**Multifunction steering wheel** .....

General operation .....	98
Introduction .....	98
Adjusting the volume .....	99
Listening to the radio .....	99
Playing media .....	100
Calling .....	102
Navigating .....	105
Name tag .....	105

**Voice recognition system** .....

Voice recognition system .....	106
Voice recognition system .....	107
Introduction .....	107
General operation .....	108
Calling .....	109
Using addresses .....	111
Navigating .....	112

MMI high E6, for internal use only

**Alphabetical index** .....

MMI components

MMI control panel

Multifunction steering wheel

Voice recognition system

## About this book

This book contains important information, tips, suggestions and warnings for using your vehicle.

Keep this book in your vehicle at all times. This is especially important if you loan your vehicle to others or sell it.

This book describes the **equipment range** specified for this model at the time of the editorial deadline. Individual items of equipment may not yet be available at the time of printing or may only be offered in certain countries.

Some sections in this book do not apply to all vehicles. When this is the case, the beginning of the section indicates the **validity**, for example “Applies to vehicles: with telephone”. Optional equipment is also identified with an asterisk “\*”.

The **illustrations** are designed as schematic images. Some of the details on your vehicle may look slightly different than illustrated.

There is a **Table of Contents** at the beginning of this book that lists all of the topics covered in this book in the order that they appear.

There is also an alphabetically arranged **Index** at the end of this book.

All **directions** such as “left”, “right”, “front” and “rear” are based on the vehicle's direction of travel.

\* Optional equipment.

▶ The section continues on the next page.

■ Marks the **end of a section**.

® Registered trademarks are identified with ®. The absence of this symbol does not warrant unrestricted use of a term.

⇒ ⚠ Cross reference to a “WARNING” within a section. If a page number is indicated, the WARNING is located outside of the section.



### WARNING

Text with this symbol contains information about safety and how to reduce the risk of serious personal injury or death.



### Note

Text with this symbol contains information about avoiding damage to your vehicle.



### For the sake of the environment

Text with this symbol contains information on protecting the environment.



### Tips

Text with this symbol contains additional useful information. ■

MMI High 198, for internal use only

**MMI high B8, for internal use only**

MMI components

MMI control panel

Multifunction steering wheel

Voice recognition system

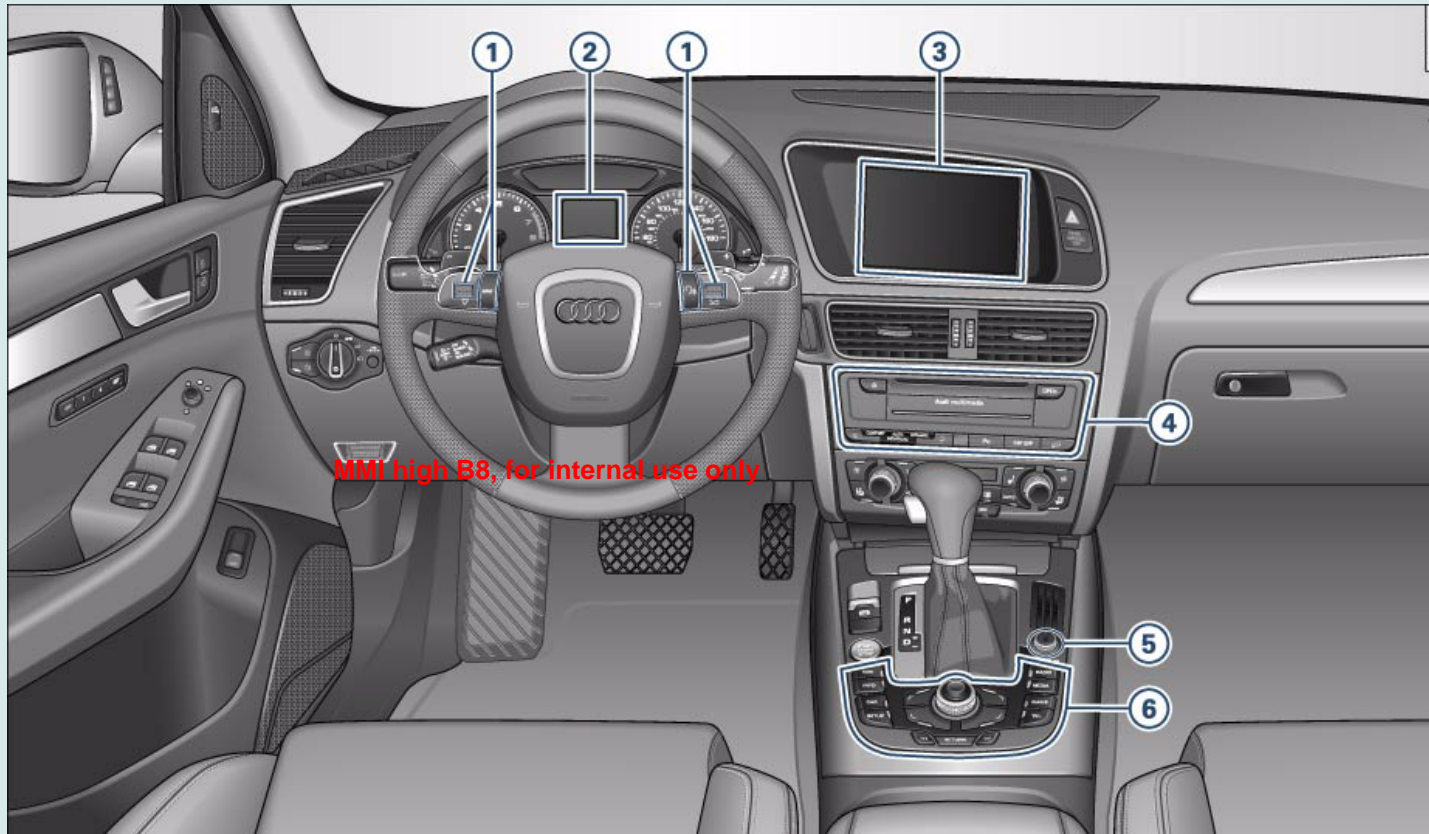

Fig. 1 MMI controls



## Overview

### Controls at a glance

*The various MMI controls are located centrally in the cockpit and are easy to reach.*

① Multifunction steering wheel .....	98
② Driver information system .....	98
③ MMI Display .....	29
④ MMI drives .....	9
⑤ On/Off knob .....	28
⑥ MMI control panel .....	29

#### Tips

- Please note that this manual only describes MMI components. You can find additional information on operating your vehicle in your vehicle Owner's Manual.
- On vehicles with right-hand drive steering\*, the layout of the controls differs somewhat from what is shown here ⇒ page 6, fig. 1. The symbols for the controls are the same. ■

### MMI: Multi Media Interface

*The Audi Multi Media Interface, or MMI for short, combines various communication and entertainment systems in your Audi.*

Through the MMI, you can listen to the radio and CDs and connect portable audio devices\*. The MMI also has two memory card readers and an internal hard drive where you can store your favorite music. The navigation system can guide you to your destination using the shortest route, or you can add up to three stopovers. Or you can follow your own tour plan with up to nine intermediate destinations.

Information about traffic conditions is taken into account during route guidance. You can also use many of the functions on your cell phone. The MMI also combines many driver assistance systems in your vehicle.

There are several ways you can access the wide range of MMI functions in your vehicle. You can access all of the functions through the MMI control panel with its intuitive controls. You can also comfortably access the MMI functions that you use most frequently through the multifunction steering wheel or voice recognition system. ■

### Traffic safety tips

Audi recommends only performing important functions such as entering a navigation destination when the vehicle is stationary. Always remember to stop using the MMI if necessary to ensure your safety and the safety of other drivers.

#### WARNING

- **Driving requires your complete and undivided attention. As the driver, you have complete responsibility for safety in traffic. Only use the MMI system when traffic conditions permit and always in a way that allows to maintain complete control over your vehicle.**
- **Adjust the volume of the audio system so signals from outside the vehicle such as police and fire sirens can be heard easily at all times.**
- **Obey all applicable laws regarding use of telephones in vehicles.** ■

MMI High B8, for internal use only

MMI components

MMI control panel

Multifunction steering wheel

Voice recognition system

## Tips on caring for the MMI

---

The *Cleaning and Protection* chapter in your vehicle owner's manual provides instructions on caring for and cleaning the MMI components. ■

**MMI high B8, for internal use only**

## Drives

### Introduction

The MMI is equipped with a CD/DVD drive, a CD changer\*, two memory card readers and a Jukebox. You can also connect a portable audio device (such as an iPod or USB storage device) to the Audi music interface\* and operate it through the MMI control panel. ■

### Overview of drives

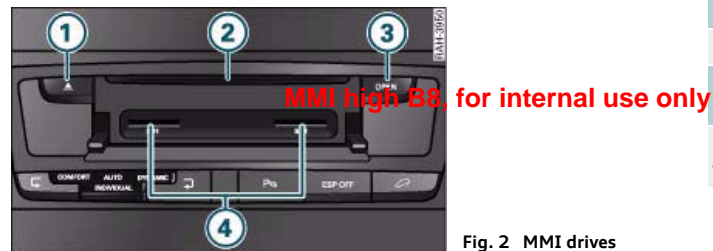

Fig. 2 MMI drives

- ① Eject button
- ② CD/DVD slot
- ③ **OPEN** button
- ④ Memory card reader

The MMI drives are located in the center console and are started and operated through the MMI ⇒ *page 48*. Opening the card reader cover with the **OPEN** button ③ ⇒ fig. 2 provides access to both memory card readers.

The CD/DVD drive, Jukebox, memory card reader and USB storage device connection\* support the following audio file properties:

	MP3 Files	WMA files	AAC files
Format	MPEG-1 Layer 3 MPEG-2 Layer 3	Version 7, 8 and 9	MPEG-4
Profile			LC - Low Complexity
File extension	.mp3	.wma	.m4a
File system	Memory card and USB storage device: FAT or FAT32 method, only one partition CD/DVD drive: Joliet (CDs single session and multisession; DVDs only single session)		
Standard	ISO 9660-Level 1 and 2		
Bit rates	32 to 320 kbits/s and variable bit rates in sampling frequencies from 8 to 48 kHz		
Playlist format	M3U and PLS		

MMI components

MMI control panel

Multifunction steering wheel

Voice recognition system

	MP3 Files	WMA files	AAC files
Number of files	CD/DVD drive: max. 1000 files per medium and directory Jukebox: max. 3000 files total USB storage device and memory card: max. 4000 files total and max. 1000 files per directory		
Supported media	Memory card reader: Memory cards with a capacity up to 32 GB CD/DVD drive: Audio CDs, MP3/WMA/AAC CDs with a capacity up to 700 MB MP3/WMA/AAC DVDs in DVD-5, -9, -10, -14 and -18 formats, Standard DVD-V and DVD-V compatible DVD-A Audi music interface: iPod ⇒ <i>page 19</i> , USB storage device ⇒ <i>page 20</i>		
Metadata	ID3 tag up to 50 characters	WMA tag up to 50 characters	Metadata support

MMI high B8, for internal use only

 **WARNING**

The card reader must always be closed while driving for safety reasons.

 **Tips**

- The Jukebox does not support playlists.
- The more files/folders/playlists are on a medium, the longer it will take to load the audio files. Audi recommends using storage mediums that only contain audio files.
- To decrease the time it takes to load audio files, create subfolders (for example according to artist or album).
- To access audio files as quickly as possible, Audi recommends using SD cards that are class 4 or higher.

- For compressing MP3 files, Audi recommends a bit rate of at least 160 kbit/s.
- When playing MP3 files with a variable bit rate, there may be a discrepancy between the play time displayed and real time.
- The MMI drives do not support files protected by DRM.
- The functionality of individual storage mediums may be limited due to the variety of blank CDs/DVDs available and the various capacities.
- Audio CDs or video DVDs with copy protection or CDs/DVDs that do not conform to the standard may not play or playback may be limited. CDs that conform to the standard have the logo "Compact Disc Digital Audio" on the CD.
- Multisession CDs may not play or playback may be limited. Audi recommends finalizing the recording process when creating multisession CDs.
- Specific characters (such as those in ID3 tag information) display differently depending on the MMI system language and cannot always be guaranteed.
- Never store important data on the memory cards, Jukebox, CDs/DVDs or portable audio devices. Audi is not responsible for damaged or lost files.
- Please note that audio files are subject to copyright laws. ■

## CD/DVD mode general information

This general information applies to CDs and DVDs.

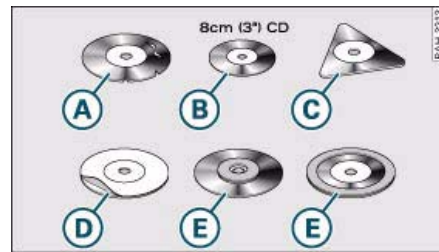

Fig. 3 CDs/DVDs that must not be used

### Requirements for good sound quality

To ensure good, high-quality sound reproduction and to prevent damage to the drives, please observe the following:

- Do not use damaged or scratched CDs/DVDs (A).
- Do not use single CDs/DVDs (3 inch/8 cm diameter) (B).
- Do not use CDs/DVDs that are not round (shape CDs/DVDs) (C).
- Do not add any labels (D).
- Do not use protective rings (E).
- Do not use dirty CDs/DVDs.
- Do not use protective CD/DVD file or stabilizer.
- Always keep CDs/DVDs in a protective sleeve and do not expose to direct sunlight.

### Cleaning drives, CDs and DVDs

Clean CDs/DVDs with a soft, lint-free cloth. Wipe the CD/DVD in a straight line from the center toward the outer edge. Dirty areas can be cleaned with a commercial CD cleaner or isopropyl alcohol. Never use gasoline, paint thinner, or record cleaner since they can damage CDs/DVDs.

### Using laser equipment

Laser equipment is divided into safety classes 1 to 4 in accordance with DIN IEC 76 (CO) 6/VDE 0837. The various types of audio equipment installed conform to safety class 1. The laser uses so little power or is shielded so there is no danger when it is used correctly.

### Read error message

A read error message in the display may be caused by the following:

Problem	Solution
The CD/DVD is dirty.	Clean the CD/DVD.
The CD/DVD is scratched.	Replace the CD/DVD with one that is not scratched.
The CD/DVD was inserted upside down.	Insert the CD with the label side facing up.
Condensation has formed on the CD/DVD.	Wait until the CD/DVD is dry.
The mechanism for the drive is malfunctioning.	Please see your authorized Audi dealer or other qualified workshop to have the malfunction repaired.

### Note

Labels on the inner hub of a CD/DVD can loosen when exposed to high temperatures and damage the drive. Do not leave CDs/DVDs that have labels on the inner hub in the drive when they are not playing.

### Tips

- CD/DVD playback may be temporarily unavailable if outside temperatures are extremely hot or cold. A thermal protection switch is installed to protect the CD/DVD and the laser.
- Do not remove the cover from the device. The device does not contain any parts that the owner can repair. ■

## Memory card general information

*Both SD and MMC memory cards can be used.*

The memory card reader has been tested with many of the products available on the market. However, in isolated cases it is possible that individual memory cards may not be recognized.

Always keep the memory card in a suitable case to protect it from dirt, dust particles and other damage.

### ! Note

Only use one-piece memory cards. If adapter cards (memory cards with more than one piece) are used, the card could fall out of the adapter when driving because of vibrations. Individual pieces could then become stuck in the drive. ■

## Jukebox

MMI high B8, for internal use only

### Introduction

The MMI is equipped with a Jukebox that has 10 GB of memory available for audio files. Jukebox mode is started and operated through the MMI ⇒ *page 48*.

For information on the properties of supported file formats, refer to ⇒ *page 9*.

### i Tips

- Please note that music files are subject to copyright law. Reset the Jukebox to the original default settings when selling your vehicle ⇒ *page 38*.
- When the vehicle is at an altitude above approximately 3000 meters, the MMI hard drive shuts down temporarily to protect it. Navigation mode and the Jukebox are not available when that

happens. All of the MMI functions will be available again as usual once you start the engine again at a location below 3000 meters. ■

## Importing files

*Audio files on a CD/DVD ROM in the CD/DVD drive, a USB storage device\* or a memory card can be imported.*



Fig. 4 Importing files

- Press the **MEDIA** function button.
- Press the **Import** control button.
- Turn the control knob to a source (such as **SD/MMC**, **CD/DVD** or **USB**) and press the knob. After checking the selected source, the MMI display shows a file structure.
- Turn the control knob to **All files/folders** or select individual files for import and press the control knob.
- To start the import, turn the control knob in the top directory level to **Start import**. The progress of the import is shown in the MMI display.

You can select all of the files in a folder for import by turning the control knob to select the folder and then press and hold the knob. ►

The Jukebox automatically sorts music files during import into artist, album, title and genre folders using the stored metadata (such as ID3 tags).

If the Jukebox does not contain any files, a message appears in the MMI display with the option **Import new tracks**. Press the control knob to enter the import menu.

You can stop the import at any time by selecting **Cancel** with the control knob and pressing it. The import will also be cancelled if you switch off the MMI, remove the source (such as **SD/MMC**, **CD/DVD** or **USB**) or start the engine during the import. Tracks that have already been imported remain stored in the Jukebox.

### Tips

- Only import audio files when the engine is running.
- Playing and importing audio files in the CD/DVD drive at the same time can lead to limitations in playback or importing. Audi recommends playing audio files in the CD/DVD drive once the import is completed successfully. **MMI high B8, for internal use only**
- Importing from a CDDA (Compact Disc Digital Audio or typical store bought CD) Compact disc or DVD-A DVD Disc to the Jukebox is not supported.
- Importing music files directly from an iPod to the Jukebox is not supported.
- The Jukebox does not provide an export function due to legal reasons.
- Files that are already present are automatically overwritten when importing.
- Files/tracks without stored metadata are listed as **unknown**. Audi recommends importing audio files with their accompanying metadata (such as ID3 tags). ■

## Erasing files

Requirement: The media mode must be activated ⇒ *page 48* and the Jukebox must contain audio files.

- Press the **SETUP** function button.
- Turn the control knob to **Delete jukebox** and press the knob.
- Turn the control knob to **All files/folders** or select individual files or folders for import and press the control knob.
- To erase selected files/folders, turn the control knob in the top directory level to **Start deletion** and press the knob.
- Turn the control knob to **Yes** and press the knob. The progress of the deletion is shown in the MMI display.

You can select all of the files in a folder for deletion by turning the control knob to select the folder and then press and hold the knob. Jukebox playback stops during the deletion process and starts again automatically once the deletion is complete.

### Tips

If functionality is restricted, reset the Jukebox to the default settings ⇒ *page 38*. ■

## CD/DVD drive

### Introduction



Fig. 5 CD/DVD drive

- ① Eject button
- ② CD/DVD slot

The CD/DVD drive is located in the MMI high 08 for internal use only. Audio CDs and video DVDs can be loaded in the CD/DVD drive. CD/DVD mode is started and operated through the MMI ⇒ page 48.

For information on the properties of supported file formats, refer to ⇒ page 9. ■

### Loading a CD/DVD

*Never force a CD/DVD into the drive. The CD/DVD is pulled in automatically.*

- Make sure there is no CD/DVD in the drive ② ⇒ fig. 5.
- Slide the CD/DVD with the writing facing up straight into the drive ②. ■

### Ejecting a CD/DVD

- Press the eject button ① ⇒ fig. 5. The CD/DVD is ejected.

The CD/DVD is pulled in again automatically if it is not removed from the slot within 12 seconds of ejecting it. ■

## CD changer

Applies to vehicles: with CD changer

### Introduction

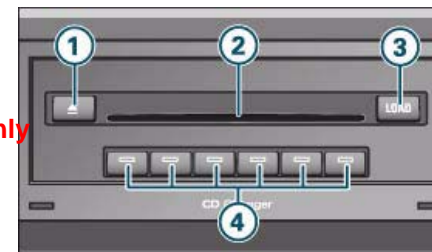

Fig. 6 CD changer

- ① Eject button
- ② CD slot
- ③ [LOAD] button
- ④ Position buttons with LEDs

The CD changer is located in the glove compartment. Audio CDs or MP3/WMA CDs can be loaded into the CD changer. CD mode is started and operated through the MMI ⇒ page 48.

The CD changer supports the following file formats: ▶



	MP3 Files	WMA files
Format	MPEG-1 Layer 3 MPEG-2 Layer 3	Version 7, 8 and 9
File extension	.mp3	.wma
Standard	ISO 9660-Level 1 and 2	
File system	Joliet (single session and multisession)	
Number of files/ directories	Max. 255 files per directory, max. 255 directories, total of no more than 512 files and directories per medium	
Bit rates	32 to 320 kbits/s and variable bit rate and variable bits in sampling frequencies from 8 to 48 kHz	
Supported media	Audio CDs and MP3/WMA CDs with a capacity of 700 MB	
Metadata	ID3 tag up to 30 characters	WMA tag up to 30 characters

### Tips

- Please follow the instructions for handling CDs ⇒ *page 11*.
- The CD changer does not support playlists and files with DRM protection.
- The functionality of individual storage mediums may be limited due to the variety of blank CDs available and the various capacities.
- Audio CDs with copy protection or CDs that do not conform to the standard for audio CDs may not play or playback may be limited. CDs that conform to the standard have the logo “Compact Disc Digital Audio” on the CD. ■

Applies to vehicles: with CD changer

### Loading a CD

Never force a CD into the drive. The CD is pulled in automatically.

### Loading a CD

- Press the **LOAD** button **3** ⇒ *page 14*, fig. 6. The red LEDs at the side of the CD slot **2** blink when the CD changer is ready to be loaded.
- Slide the CD straight into the slot **2** with the label facing up. The CD is automatically loaded in the next empty position in the CD changer. The LED in the corresponding button **4** illuminates.

### Loading all CDs

- Press and hold the **LOAD** button **3** for more than two seconds.
- Wait until the red LEDs at the side of the CD slot **2** begin blinking.
- Slide all six CDs one at a time straight into the slot **2** with the label facing up.

### Loading the CD in a specific empty position

- Press the **LOAD** button **3**. The LED in the button **4** for an empty position will blink.
- Press one of the blinking buttons **4**.
- Wait until the LEDs at the side of the CD slot **2** begin blinking.
- Slide the CD straight into the slot **2** with the label facing up. ▶

### Loading a CD into a specific occupied position

- Press the **LOAD** button ③. The LEDs in the buttons ④ for occupied positions will illuminate.
- Press one of the illuminated buttons ④. The corresponding CD is ejected.
- Remove the CD from the CD slot ②.
- Slide the CD you would like to load straight into the CD slot ② with the label facing up.

If you press the **LOAD** button ③ a second time while all CDs are being loaded, the loading procedure stops. ■

Applies to vehicles: with CD changer

### Ejecting a CD

#### Ejecting a CD

**MMI high B8, for internal use only**

- Press the eject button ① twice to eject the current CD ⇒ *page 14*, fig. 6.
- To eject any of the CDs, press the eject button ① and then one of the illuminated buttons ④.

#### Ejecting all CDs

- Press and hold the eject button ① for more than two seconds. All the CDs are ejected one at a time.

The CD is pulled back into the CD changer automatically if you do not remove it from the CD slot within 30 seconds after ejecting it. ■

## Memory card reader

### Introduction

The MMI is equipped with two memory card readers ⇒ *page 9*, fig. 2. SC/MMC memory cards can be loaded in the memory card reader.

Memory card mode is started and operated through the MMI ⇒ *page 48*.

For information on the properties of supported file formats, refer to ⇒ *page 9*.

### ! WARNING

The card reader must always be closed while driving for safety reasons.



### Tips

Please follow the instructions for handling memory cards ⇒ *page 12*. ■

### Inserting a memory card

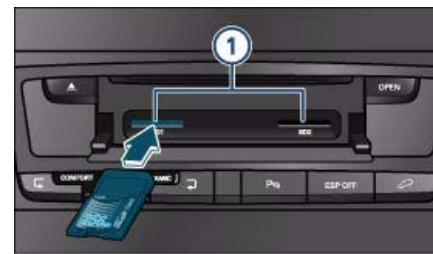

Fig. 7 Inserting a memory card

- Press the **OPEN** button. The card reader cover opens. ►

- Slide the memory card in the card reader slot with the label side up (contact surface down) ① ⇒ page 16, fig. 7. The angled corner of the memory card must point toward the right front.
- Then push the memory card into the slot until it clicks into place.

### ! WARNING

The card reader must always be closed while driving for safety reasons. ■

### Removing a memory card

- Press on the memory card briefly. The card is released from the slot.
- Remove the memory card. ■

**MMI high B8, for internal use only**

## Audi music interface

Applies to vehicles: with Audi music interface

### Introduction

Various portable audio devices can be connected to the Audi music interface.

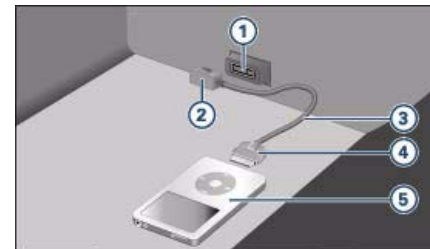

Fig. 8 Audi music interface with iPod adapter cable and iPod

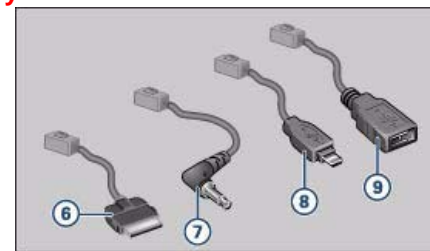

Fig. 9 Audi music interface: Adapter cable

- ① Interface on Audi music interface
- ② Jack for connecting to the Audi music interface
- ③ Adapter cable\* (such as iPod adapter cable\*)
- ④ iPod jack on iPod adapter cable\*
- ⑤ iPod
- ⑥ iPod adapter cable\*

MMI components

MMI control panel

Multifunction steering wheel

Voice recognition system

- ⑦ 3.5 mm stereo jack adapter cable\*
- ⑧ Mini USB adapter cable\*
- ⑨ USB adapter cable\*

The Audi music interface is located in the glove compartment. The Audi music interface is started and operated using the **(MEDIA)** button ⇒ *page 48*.

You can connect a portable audio device such as an MP3 player to the Audi music interface using a special adapter cable\*. You can purchase adapter cables\* from your authorized Audi dealer or an electronics store.

#### ⚠ Note

- Extremely high or low temperatures which can occur inside vehicles can damage portable audio devices or affect their performance. Never leave a portable audio device in the vehicle in extremely high or low temperatures.
- Handle the adapter cable **carefully**. **MMI High End, for internal use only**

#### ℹ Tips

For up-to-date information on the Audi music interface, visit [www.audiusa.com/mp3](http://www.audiusa.com/mp3). ■

Applies to vehicles: with Audi music interface and adapter cable

### Connecting the adapter cable to the Audi music interface

- Open the glove compartment.
- Connect the adapter cable to the Audi music interface ⇒ *page 17, fig. 8*.
- Then connect the portable audio device to the Audi music interface. ■

Applies to vehicles: with Audi music interface and adapter cable

### Disconnecting the adapter cable from the Audi music interface

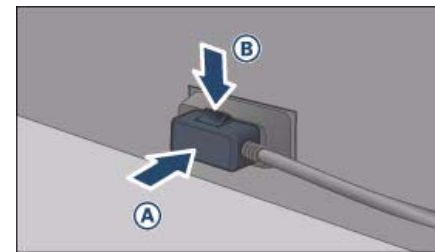

Fig. 10 Adapter cable: releasing the jack on the Audi music interface

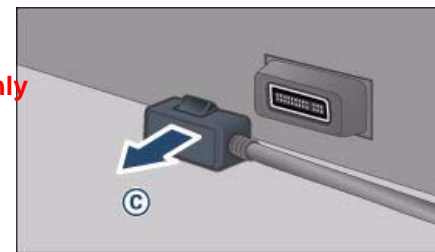

Fig. 11 Adapter cable: removing the released jack from the Audi music interface

Requirement: The glove compartment must be open.

- Press the jack **(A)** ⇒ fig. 10 into the Audi music interface\* while pressing the release catch **(B)** on the jack down. The jack is released.
- Hold the release catch down while pulling the jack out of the Audi music interface **(C)** ⇒ fig. 11. ▶

**!** **Note**

Remove the connector from the Audi music interface carefully so it is not damaged. ■

Applies to vehicles: with Audi music interface and iPod adapter cable

### Connecting an iPod using the iPod adapter cable

The iPod is connected to the Audi music interface with the iPod adapter cable.

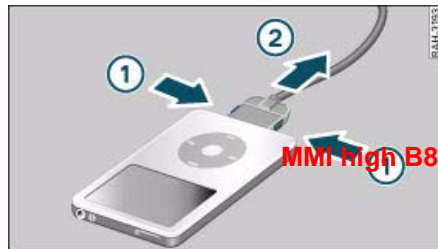

Fig. 12 Disconnecting the iPod jack from the iPod

#### Connecting the iPod jack

- Connect the iPod adapter cable\* to the iPod.

#### Disconnecting the iPod jack

- Press the buttons ① to release the catch ⇒ fig. 12.
- Carefully pull the jack out of the iPod ②.

When the vehicle ignition is on, the iPod battery charges through the iPod adapter cable\* once the iPod is connected to the Audi music interface.

The following iPods can be connected to the iPod adapter cable\*:

- iPod mini - (version 1.3.0 and higher)
- iPod nano 1G, 2G, 3G and 4G
- iPod 4G - fourth generation (version 1.2.1 and higher)
- iPod 5G - fifth generation Video
- iPod 6G - sixth generation classic
- iPod touch
- iPhone

Other iPod versions (such as the iPod shuffle) cannot be connected with the iPod adapter cable\*. These can be connected as portable audio devices with the optional 3.5 mm stereo jack adapter cable\* ⇒ page 20.

Connect the adapter cable to the Audi music interface first and then connect the portable audio device to the Audi music interface.

The MMI does not support the following iPod functions:

- Rating music tracks
- Skipping to a certain place in a track
- Adding tracks to the “On-the-go” playlist
- Displaying the “Compilations” folder. Also, tracks marked with “Part of a Compilation” are not entered into the artist list if the compilation was activated in the iPod.
- Marking viewed/new Podcasts

**i** **Tips**

- Only use the adapter cable with the number 4F0 051 510 K to connect an iPod.
- Problems with the iPod can affect operation of the MMI. Reset your iPod if this is the case (refer to the iPod instruction manual).
- For additional information on operating the iPod through the MMI, refer to ⇒ page 48.
- Refer to the iPod instruction manual for important information on operating your iPod. ▶

- Audi recommends updating the iPod software to the latest version. ■

Applies to vehicles: with Audi music interface and USB/Mini USB adapter cable

### Connecting a portable audio device with the USB/Mini USB adapter cable

*You can connect various USB storage devices to the Audi music interface with a USB/Mini USB adapter cable.*

The Audi music interface supports USB storage devices from “USB Device Subclasses 1 and 6”. The manufacturer of the storage device can provide information about its “USB Device Subclass”.

The following USB storage devices are supported:

- USB sticks
- USB MP3 players that do not require any special driver software
- External USB flash memory
- External USB hard disks (HDD) - 1", 1.8", 2.5" - drives with an operating/continuous current of 500 mA maximum

For information on the properties of supported file formats, refer to ⇒ [page 9](#).

For instruction on operating the USB storage device through the MMI, refer to ⇒ [page 48](#).



#### Tips

- MTP players and USB hubs are not supported.
- Do not use USB extension cables or adapters. They may affect the functionality.
- Functionality is not guaranteed for portable audio devices that do not meet the USB 2.0 specification.
- The USB storage device connection was tested with a variety of products on the market. However, it is possible that some memory cards may not be recognized.

- An iPod cannot be connected to the Audi music interface with a USB adapter cable\*. An iPod adapter cable\* ⇒ [page 17](#) must be used. ■

Applies to vehicles: with Audi music interface and 3.5 mm stereo jack adapter cable

### Connecting a portable audio device with the 3.5 mm stereo jack adapter cable

*You can connect portable audio devices (such as MP3 players) to the Audi music interface with the 3.5 mm stereo jack adapter cable.*

- Insert the 3.5 mm stereo jack in the headphone socket on the portable audio device. Audio playback takes place through the vehicle sound system.

If the external audio input or Audi music interface is already selected as the **Source** ⇒ [page 48](#), fig. 45, you may hear static when connecting or disconnecting the 3.5 mm stereo jack or the audio device connected to the stereo jack. To avoid this static, either mute the portable audio device ⇒ [page 33](#) or switch to another audio source (such as radio ⇒ [page 41](#) or CD) before connecting or disconnecting the device.



#### Tips

We recommend adjusting the volume of the portable audio device to approximately 70 percent of the maximum output. The volume can be adjusted (for example at the radio volume) ⇒ [page 55](#). ■

MMI high B8, for internal use only

## Aux-in connection

Applies to vehicles: with Aux-in connection

### Introduction

*A portable audio device is connected to the Aux-in connection with a 3.5 mm stereo jack.*

The Aux-in connector is located in the center armrest. It is compatible with portable audio devices with a 3.5 mm stereo jack. Correct function of all portable audio devices cannot be guaranteed.



#### Note

Extremely high or low temperatures which can occur inside vehicles can damage portable audio devices or affect their performance. Never leave a portable audio device in the vehicle in extremely high or low temperatures.



#### Tips

For information on operating the audio device, see the manufacturer's instructions. ■

Applies to vehicles: with Aux-in connection

### Connecting or removing an audio device

Requirement: The MMI must be switched on ⇒ *page 28*.

- Connect the audio device with a 3.5 mm stereo jack\* and insert the extension cable in the Aux-in connection.
- Press the **MEDIA** function button.
- Press the **Source** control button.

- Turn the knob to **external audio input** press it ⇒ *page 48*. **External audio source active** will appear in the MMI display when the device is recognized successfully.

Static can occur when connecting or disconnecting the 3.5 mm stereo jack. To avoid this static, either mute the portable audio device or switch to another audio source (such as radio or CD) before connecting or disconnecting the device.

You select audio files using the controls on the audio device. You can adjust the volume using the on/off knob ⇒ *page 33*, the **input level** function ⇒ *page 55*, the multifunction steering wheel ⇒ *page 99* or directly on the audio device.



#### WARNING

**Driving requires your complete and undivided attention. As the driver, you have complete responsibility for safety in traffic. Never operate a portable audio device while driving because this increases the risk of an accident.**

MMI high B8, for internal use only



#### Tips

- We recommend adjusting the volume of the portable audio device to approximately 70 percent of the maximum output.
- The vehicle battery discharges when the engine is stopped and the audio device is switched on. ■

## Cell phone prep

Applies to vehicles: with cell phone prep

### Introduction

*A cell phone is paired with the cell phone prep via Bluetooth.*

The factory-installed cell phone package in the vehicle allows you to connect particular GSM or CDMA cell phones via Bluetooth ⇒ *page 23*. Calls can be made wirelessly through the cell phone prep hands-free system. You can operate your cell phone through the MMI control panel ⇒ *page 69*, multifunction steering wheel ⇒ *page 102* or voice recognition system ⇒ *page 106*.

#### WARNING

**MMI high B8, for internal use only**

- Medical experts warn that cell phones can interfere with the function of pacemakers. Always maintain a minimum distance of 20 centimeters between the cell phone antenna and the pacemaker.
  - Do not carry the cell phone in a pocket directly over the pacemaker when the phone is switched on.
  - Switch the cell phone off immediately if you suspect it may be interfering with the pacemaker.
- Do not use voice recognition system ⇒ *page 106* in emergencies because your voice may change in stressful situations. It may take longer to dial the number or the system may not be able to dial it at all. Dial the emergency number manually.

#### Note

- Obey all applicable laws regarding use of telephones in vehicles.

- Switch your cell phone off in areas where use of cell phones is prohibited.
- Switch your cell phone off in areas at risk for an explosion. These locations are not always clearly marked. They may include gas stations, equipment that stores or transports fuel or chemicals, or locations where fuel vapors (such as propane or gasoline vapor in vehicles or buildings), chemicals or large quantities of dust particles (such as flour or sawdust) may be present in the air. This also applies to all other locations where you would normally switch your vehicle off.

#### Tips

- The telephone functions depend on whether your cell phone is compatible with the cell phone prep or not and if the cell phone service provider supports these functions.
- For up-to-date information on the cell phone prep, visit [www.audiusa.com/telephone](http://www.audiusa.com/telephone) or your authorized Audi dealer.
- The cell phone prep is designed for use in GSM and CDMA networks. ■

## Starting

Applies to vehicles: with cell phone prep

### Introduction

Bluetooth must be activated to establish a Bluetooth connection between the cell phone prep and the cell phone. Your cell phone must be *visible to others* ⇒ *page 75*.

The cell phone must be paired one time with the cell phone prep in the vehicle. The steps required for this procedure depend on the cell ►



phone you are using. First, the system searches for available Bluetooth devices within range ⇒ [page 23](#).

#### Pairing Bluetooth-compatible devices

There must not be any other Bluetooth devices connected to the cell phone prep during the pairing procedure. The cell phone that will be paired must not be connected to any other Bluetooth device. Also follow the instructions displayed on your cell phone.

There may be several cell phones paired with the cell phone prep, but only one cell phone at a time can be actively connected to the cell phone prep.

The Bluetooth connection range is limited to inside the vehicle. It also depends on the current circumstances and on interference with other devices.

#### Establishing and disconnecting the Bluetooth connection

An operational cell phone which has been bonded to the cell phone package is automatically connected after the ignition is switched on. For some cell phones you have to confirm the connection.

The Bluetooth connection is disconnected after the ignition key is removed.



#### Tips

For current information on pairing cell phones with the cell phone prep, visit [www.audiusa.com/telephone](http://www.audiusa.com/telephone) or your authorized Audi dealer. ■

Applies to vehicles: with cell phone prep

#### Searching for Bluetooth-compatible devices

*There are two ways to search for Bluetooth-compatible devices.*



Fig. 13 Searching for new cell phones

MMI high E8 for internal use only

Requirement: The MMI Bluetooth function must be activated ⇒ [page 75](#).

#### Searching for cell phones

- Make sure the Bluetooth in your cell phone is activated. Your cell phone must be visible to others.
- Press the **(TEL)** function button. The message **Please connect cell phone** appears in the MMI display.
- Turn the control knob to **Search for new cell phone** ⇒ [fig. 13](#) and press the knob. The available Bluetooth cell phones are shown in the MMI display.

#### Searching for Bluetooth devices

- Press the **(SETUP)** function button. ▶

- Press the **Bluetooth** control button. The **Bluetooth** menu appears in the MMI display.
- Turn the control knob to **Find Bluetooth devices** and press the knob. The available Bluetooth devices are shown in the MMI display.

The **Find Bluetooth devices** function shows all of the Bluetooth devices within range in the MMI display.

### Tips

The MMI only recognizes some cell phones through the Find Bluetooth devices function. ■

Applies to vehicles: with cell phone prep

### Pairing a cell phone

Bluetooth technology allows a cell phone to be connected wirelessly to the vehicle MMI. MMI High SS, for internal use only



Fig. 14 The cell phone is paired with the cell phone prep and connected.

Requirement: An available cell phone must be shown in the MMI display ⇒ page 23.

- Turn the control knob to a cell phone and press the knob.

- To pair the cell phone, turn the control knob to **Handsfree** and press the knob. A 4-digit PIN is shown on the MMI display.
- To enter the 4-digit PIN that is displayed, select **Yes**. Enter the PIN in the cell phone when the vehicle is stationary. The time allowed for entering the PIN is limited to approximately 30 seconds, or
- To enter any 4- to 16-digit PIN, select **No**. Enter any 4- to 16-digit pin in the speller ⇒ page 31. Then enter that PIN in the cell phone when the vehicle is stationary. The time allowed for entering the PIN is limited to approximately 30 seconds.
- Confirm the pairing on the cell phone if requested. The cell phone symbol  ⇒ fig. 14 appears in the status line of the MMI display when the pairing process is complete.

### Tips

You can find additional information about connecting your cell phone in your cell phone operator's manual. ■

Applies to vehicles: with cell phone prep

## Directory entries

The cell phone entries are automatically loaded in the MMI.



Fig. 15 Searching for an entry in the directory

### Tips

- The directory entry display in the MMI depends on the cell phone used.
- The directory entries from the cell phone may not be transferred in alphabetical order. If there are too many directory entries, entries with different first letters may be missing in the MMI. ■

### Loading directory entries

The directory entries load automatically in the MMI after the ignition is switched on. This loading process can last several minutes and depends on the number of entries in the directory.

Directory entries can be stored in a general profile and in up to four personal profiles ⇒ page 67.

### Displaying directory entries

The directory entries are displayed in alphabetical order and identified with a symbol:

- ① Local MMI memory
- ② SIM card
- ③ Cell phone

Private and business entries with land line, cell phone and fax categories can be saved in the address cards.

MMI components

MMI control panel

Multifunction steering wheel

Voice recognition system

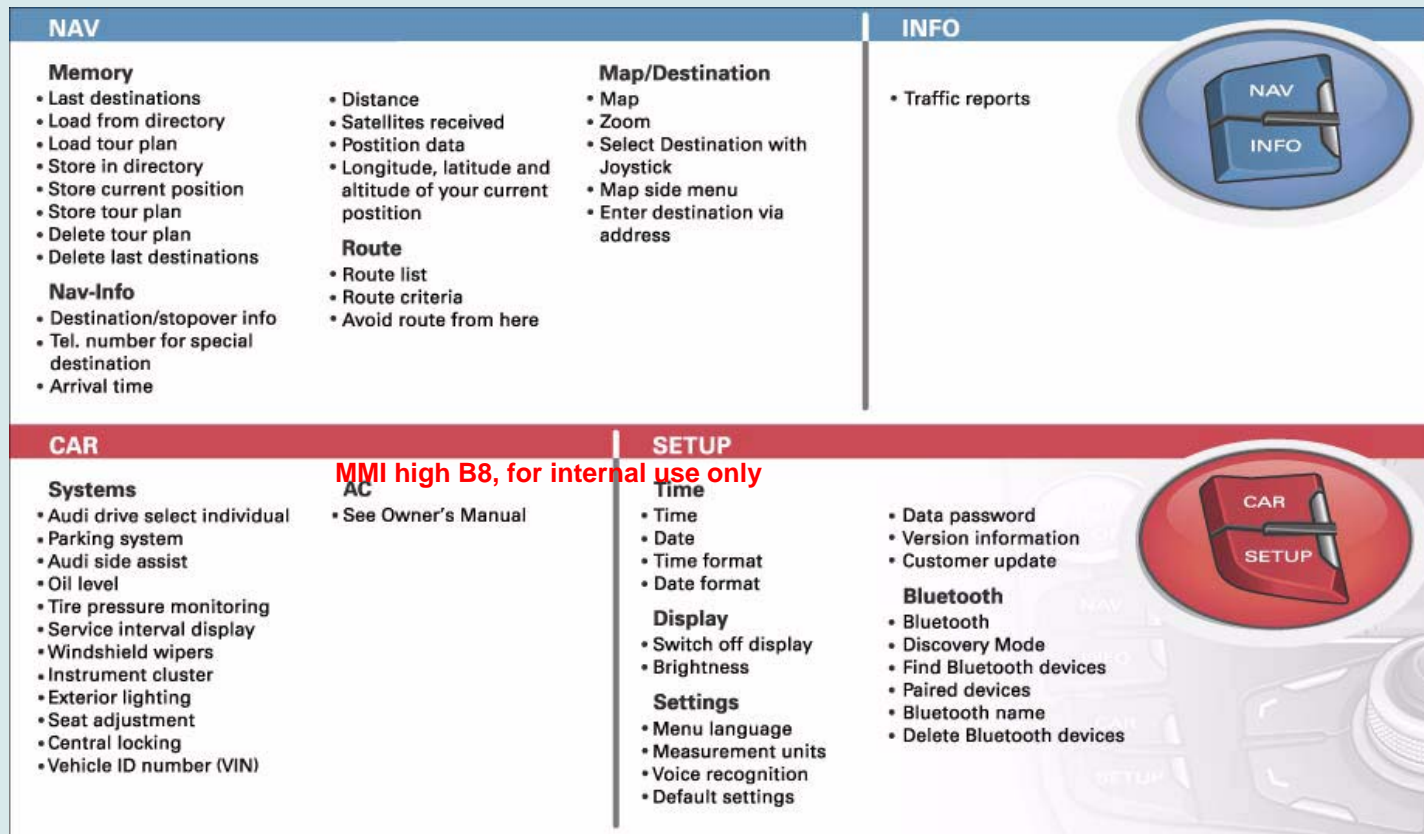

Fig. 16 Overview of MMI menus

RADIO		MEDIA		
	<p><b>Presets</b></p> <ul style="list-style-type: none"> <li>List of presets</li> </ul> <p><b>Tuning</b></p> <ul style="list-style-type: none"> <li>Seek up/down</li> <li>Tuning next/previous</li> <li>TEXT (Radio text)</li> <li>SCAN (Scan)</li> <li>INFO (Info)</li> </ul> <p><b>Band</b></p> <ul style="list-style-type: none"> <li>FM</li> <li>AM</li> <li>Sirius*</li> </ul>	<p><b>Sound</b></p> <ul style="list-style-type: none"> <li>Balance</li> <li>Fader</li> <li>Treble</li> <li>Bass</li> <li>Subwoofer</li> <li>DSP</li> <li>DSP Bang &amp; Olufsen*</li> <li>Volume settings</li> </ul>	<p><b>Import</b></p> <ul style="list-style-type: none"> <li>Import title from source</li> </ul> <p><b>Manual Jukebox/CD/DVD/SD/AMI*</b></p> <ul style="list-style-type: none"> <li>Next/previous track</li> <li>Forward/Rewind</li> <li>Pause</li> <li>Shuffle</li> <li>Title info</li> <li>Repeat options</li> <li>DVD main menu</li> <li>DVD full screen</li> </ul> <p><b>Sound</b></p> <ul style="list-style-type: none"> <li>See RADIO</li> </ul>	<p><b>Source</b></p> <ul style="list-style-type: none"> <li>Jukebox</li> <li>Memory card reader</li> <li>CD-/DVD-Drive</li> <li>CD changer*</li> <li>Audi Music Interface*</li> <li>Aux in</li> </ul>
	NAME		TEL	
	<p><b>Memory</b></p> <ul style="list-style-type: none"> <li>Memory capacity</li> <li>Import phone book</li> <li>Import contacts</li> <li>Export contacts</li> </ul> <p><b>Navigate to</b></p> <ul style="list-style-type: none"> <li>Navigate to contact</li> </ul> <p><b>Dial</b></p>	<p><b>Memory</b></p> <ul style="list-style-type: none"> <li>Directory</li> <li>Dialled numbers</li> <li>Missed calls</li> <li>Received calls</li> <li>Store current number</li> <li>Delete local call lists</li> </ul>		<p><b>Dial</b></p> <p><b>End call</b></p>

MMI high B8, for internal use only

Fig. 17 Overview of MMI menus

## General operation

### All MMI menus at a glance

In the menu structure ⇒ *page 26*, fig. 16 and ⇒ *page 27*, fig. 17 you can find the options that can be selected for the individual main functions.



#### Tips

The menu items shown may differ depending on your vehicle's equipment. ■

### Switching on/off



Fig. 18 On/Off knob

#### Vehicles without comfort key\*

- To switch the MMI on, switch the ignition on. The menu for the last main function selected is displayed. The last selected audio/video source begins playing.
- To switch the MMI off, remove the ignition key. Your settings are saved.

#### Vehicles with comfort key\*

- Press the **(START ENGINE STOP)** button to switch the MMI on ⇒ *page 29*, fig. 19.
- Press the **(START ENGINE STOP)** button twice to switch the MMI off ⇒ *page 29*, fig. 19. Your settings are saved.

#### Manual operation

- Press the On/Off knob briefly to switch the MMI on ⇒ fig. 18.
- To switch the MMI off, press and hold the On/Off knob until the MMI switches off.

An MMI that has been switched off manually does *not* switch on again automatically the next time the ignition is switched on.

The MMI can still be operated for approximately ten minutes after switching the ignition off. If you do not press any function button, control button, or the control knob on the MMI control panel within this time, the MMI automatically switches off again.



#### Tips

- With the engine not running and a low battery charge, MMI switches off automatically.
- If you only press the On/Off knob briefly, the selected audio source is muted ⇒ *page 33*. ■

## Operating the system

Press and turn the buttons on the MMI control panel to perform the MMI functions.

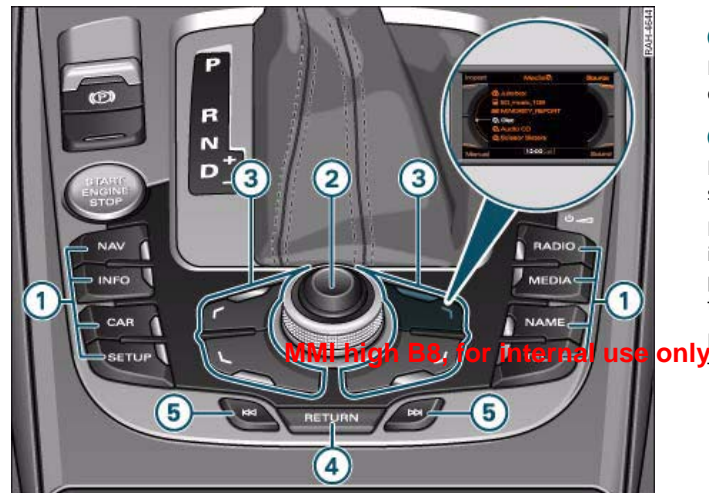

Fig. 19 Buttons on the MMI control panel

### ① Function buttons

Press a function button to start an operating mode. For example, press the **[RADIO]** function button to start the **Radio** mode.

You can open additional settings for the active operating mode using the **[SETUP]** function button.

### ② Control knob with joystick

Turn the control knob to the left or right and press it to select a menu item in the MMI display. You can use the joystick to move the crosshairs in a map or to control the DVD menu ⇒ page 32.

### ③ Control buttons

To access the function shown in one of the four corners of the display, press the control button corresponding to this display corner. For example, the upper right control button corresponds to the upper right corner of the display ⇒ fig. 19.

### ④ Return button

Press the **[RETURN]** button to cancel a selection you have not yet confirmed or to return to the next higher menu level.

### ⑤ Arrow buttons

Press the **[<<]** or **[>>]** button to select the previous/next radio station.

Press the **[>>]** button to select the next track on a CD or a connected iPod. Press the **[<<]** button within the first ten seconds a track is playing to return to the previous track and after ten seconds to return to the beginning of the current track.

Press and hold the **[<<]** or **[>>]** button while in CD mode to fast forward or rewind. ■

## MMI Display

### “Standard” menus



Fig. 20 Navigation Setup



Fig. 21 Radio submenu

A menu appears in the MMI display after you press a function button  
 ⇒ page 29.

Legend	Symbol/Description	Explanation
①	Title line	Selected mode (such as Radio ⇒ page 29). <b>MMI high B8, for internal use only</b> Setup display: Setup menu for the selected mode (for example Navigation Setup ⇒ page 29, fig. 20). On vehicles with the cell phone prep*, the cellular service provider is displayed.
②	TMC symbol	Reception of TMC traffic reports ⇒ page 95.
③	Arrows pointing up/down	Indicate there are additional menu items (scroll forward/back).
④	Cursor	Shows a line selected in a menu.
⑤	Selected text	A menu item you have selected has a white background.
⑥	Options box	Options for the menu item selected.

Legend	Symbol/Description	Explanation
⑦	Arrow	Points to additional options or possible settings.
⑧	Temperature display	Temperature selected on vehicles with an automatic air conditioning system.
⑨	Signal strength bar*	Cell phone connection quality
⑩	Display corners	Show selectable functions. You perform the functions using the control buttons. The top right corner of the display corresponds to the top right control button.
⑪	Subtitle	Tells you about a selected option (e.g. radio station preference).
⑫	Control wheel	Is operated by turning and pressing the control knob.
⑬	Mute symbol	The active audio source is muted.
⑭	Time	Set time.
⑮	Bluetooth symbol*	Active Bluetooth connection.



### Speller

You can enter addresses, navigation destinations and telephone numbers with the speller.



Fig. 22 Number speller: entering a telephone number

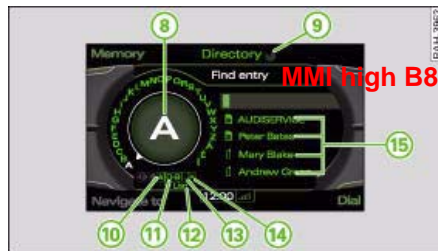

Fig. 23 Letter speller: searching for a directory entry

With some functions in the directory, it is necessary to enter letters or numbers in Telephone\* or Navigation mode. The number speller ⇒ fig. 22 or the letter speller ⇒ fig. 23 appears in the display.

While you are making your entry, you can switch as needed from numbers to letters or from letters to numbers by turning the control knob 0-9 (11) ⇒ fig. 23 or A-Z (5) ⇒ fig. 22 and pressing the knob.

All of the symbols for entering letters and numbers are explained in the table below:

Legend	Symbol/Description	Explanation
①	Selection arrow	Puts a white background behind the selected element and shows it enlarged in the entry ring.
②	◀▶	Moves the cursor forward/backward in the entry field.
③	⬆	Switches from lower case to upper case.
④	OK	Confirms the entry.
⑤	A-Z	Switches from number to letter entry.
⑥	Cursor	Marks the current editing position.
⑦	Entry field	Shows the current entry
⑧	Entry ring	Shows the character selected with the selection arrow enlarged.
⑨	Update symbol	Indicates the data is updating.
⑩	à	Indicates a list with special characters depending on the language.
⑪	0-9	Switches from letter to number entry.
⑫	LIST	Shows a list of suggestions.
⑬	—	Inserts a space in the entry field.
⑭	⬅	Deletes the character to the left of the white highlighted cursor.
⑮	List with suggestions	Lists suggestions in alphabetical order.

MMI components

MMI control panel

Multifunction steering wheel

Voice recognition system

### Entering letters, numbers and symbols using the speller

For an overview of the speller, refer to ⇒ page 31.

#### Entering numbers, letters, and symbols

- Turn the control knob with the selection arrow ① ⇒ page 31, fig. 22 to the letter, number or symbol. Your selection is shown enlarged in the entry ring ⑧ ⇒ page 31, fig. 23.
- To accept the letter, the number or the symbol, press the control knob. Your entry appears in the entry field ⑦ ⇒ page 31, fig. 22.
- When you have entered all the digits, turn the control knob to **OK** ④ ⇒ page 31, fig. 22 and press the knob.

#### Deleting numbers, letters, and symbols

- Turn the control knob with the selection arrow to ◀ ⑭ ⇒ page 31, fig. 23.
- To delete the last digit in the entry field, press the control knob.
- To delete all the digits in the entry field, hold the control knob down until no digits show in the entry field.

In some cases such as in the Navigation menu, the selection of letters may be limited to available entries. Only letters that are part of an available word can be selected.

Enter special characters such as the hyphen or period) with the number speller ⇒ page 31, fig. 22. ■

### Joystick

You can move the crosshairs in a map or control the main menu for a video DVD with the joystick.

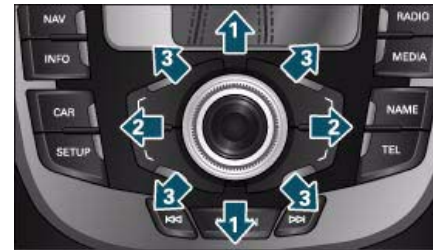

Fig. 24 MMI control panel: possible joystick movements

Requirement: A map must be visible in the MMI display ⇒ page 86 or a video DVD must be playing ⇒ page 48.

#### Moving the crosshairs in a map

- To move the crosshairs in a map vertically ① ⇒ fig. 24, move the joystick up or down.
- To move the crosshairs in a map horizontally ②, move the joystick to the right or left.
- To move the crosshairs in a map diagonally ③, move the joystick up or down to the right or left.

#### Controlling the DVD main menu

- Press the **Manual** control button.
- Turn the control knob to **MENU** (display main menu) ⇒ page 52 and press the knob. The DVD main menu is shown in the MMI display. ▶

- Move the joystick up or down ① or right or left ② to select a menu item.
- Press the control knob to confirm the menu selection. DVD mode continues. ■

### Switching the MMI display on/off



Fig. 25 Switching the MMI display on/off

#### Switching the MMI display off

- Press the **Display** control button while in a setup menu.
- Turn the control knob to **Switch off display** ⇒ fig. 25 and press the control knob. The display switches off.

#### Switching the MMI display on

- Press or turn the control knob, or
- Press the function button, a control button or the **RETURN** button.

### Tips

- On vehicles with the cell phone prep\*, if a call is made while the MMI display is switched off, the display will switch on automatically and remain on for the duration of the call.
- You can also change stations or find a selected audio/video source with the *arrow buttons* when the MMI display is switched off. ■

### Adjusting the volume

#### Active audio/video source

You can adjust the volume or mute the audio/video sources using the On/Off knob.

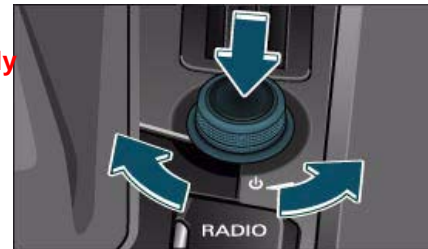

Fig. 26 Adjusting the volume and muting the audio/video sources

#### Adjusting the volume

- Turn the On/Off knob to the right or left ⇒ fig. 26. The adjusted volume is stored.

#### Muting

- Press the On/Off knob briefly. A speaker symbol with a line through it appears in the MMI display. An active audio/video source is stopped. ▶

- To cancel the muting, press or turn the On/Off knob briefly.

Volumes that are too high or too low are automatically set to a predetermined level when the MMI is switched on.

### Tips

You can also adjust the volume using the right thumb wheel on the multifunction steering wheel without taking your hands off the ⇒ page 99. ■

### Additional audio sources

*The volume of the navigation announcements, voice recognition system and telephone\* can be adjusted individually.*



Fig. 27 Volume settings

- Press the **Sound** control button while in the Media or Radio menu ⇒ fig. 27.
- Turn the control knob to **Volume settings**.
- Press the control knob. The **Volume settings** menu appears in the MMI display ⇒ fig. 27.

- Turn the control knob to a menu item such as **Voice recognition volume** and press the knob.
- Turn the control knob to the left or right to adjust the volume as desired.
- Press the control knob to confirm the setting.

The system automatically plays a test announcement while you are adjusting the volume.

### Tips

- With the **In-car entertainment fader**, you can lower the volume of the active audio/video source during navigation announcements or when the Audi parking system\* is active ⇒ page 39.
- On vehicles with a VDA-compatible phone upgrade, you will achieve the best sound quality if you adjust the input volume on the device to a medium level. ■

## Adjusting the sound

### Basic settings



Fig. 28 Selecting balance



Fig. 29 Adjusting balance

- Press the **Sound** control button while in the Media or Radio menu ⇒ page 34, fig. 28.
- Turn the control knob to a menu item such as **Balance** ⇒ page 34, fig. 28 and press the knob. The selected menu item is shown enlarged in the MMI display ⇒ fig. 29.
- Turn the control knob to the right or the left to adjust the sound characteristics.
- Press the control knob to confirm the setting.

The following sound adjustments are possible:

- Balance (right/left sound ratio)
- Fader (front/rear sound ratio)
- Treble
- Bass
- GALA (speed compensated volume)
- Subwoofer\* (additional bass amplification)<sup>1)</sup>
- DSP\* ⇒ page 35
- DSP Bang & Olufsen\* ⇒ page 36

<sup>1)</sup> The subwoofer\* cannot be adjusted on vehicles with the Bang & Olufsen\* sound system.

- Volume settings (for additional audio sources) ⇒ page 34

Treble and bass settings apply to the active mode. The balance and fader settings are independent of the mode. ■

Applies to vehicles: with DSP

### Digital Signal Processing (DSP)

*With Sound Focus, the sound can be optimized for the listener. GALA adjusts the volume and the sound characteristics to the vehicle speed.*

#### Displaying the DSP menu

- Press the **Sound** control button while in the Media or Radio menu.
- Turn the control knob to **DSP** and press the knob. The **DSP** menu appears in the MMI display.

#### Sound Focus

- Turn the control knob to **Sound Focus** and press the knob.
- To achieve a symmetrical sound distribution, turn the control knob to **All** and press the knob.
- To achieve a driver-oriented sound distribution, turn the control knob to **Driver** and press the knob.

#### GALA

- Turn the control knob to **GALA** and press the knob.
- Turn the control knob to **Active** or **Inactive**.
- Press the control knob to save your setting. ■

Applies to vehicles: with DSP Bang & Olufsen - Surround Sound

### DSP Bang & Olufsen®

*With Sound Focus, the sound can be optimized for the listener. Surround Level regulates the volume of the surround effect.*

#### Displaying the DSP Bang & Olufsen menu

- Press the **Sound** control button while in the Media or Radio menu.
- Turn the control knob to **DSP Bang & Olufsen** and press the knob. The **DSP Bang & Olufsen** menu appears in the MMI display.

#### Sound Focus

- Turn the control knob to **Sound Focus** and press the knob.
- To adjust the sound so it is the same for the entire vehicle interior, turn the control knob to **All** and press the knob.
- To achieve a driver-oriented sound distribution, turn the control knob to **Driver** and press the knob.
- To adjust the sound so it is oriented to the front or rear of the vehicle, turn the control knob to **Front/Rear** and press the knob.

#### Surround Level

- Turn the control knob to **Surround level** and press the knob.
- To change the surround effect, turn the control knob to the right or left and press the knob.

#### GALA Plus

- Turn the control knob to **GALA Plus** and press the knob.

- Turn the control knob to **Active** or **Inactive**.
- Press the control knob to save your setting. ■

### Setting the time

*You can choose between the quartz clock and the radio clock\*. You enter the time and date yourself with the quartz clock. The radio clock\* sets the time and date automatically.*



Fig. 30 Setting time

#### Opening the time setting menu

- Press the **SETUP** function button.
- Press the **Time** control button. The time setting menu appears in the MMI display.

#### Selecting the time source\*

- Turn the control knob to **Time source** and press the knob.
- Turn the control knob to **quartz** or **radio clock\*** and press the knob. The **radio clock\*** source is indicated by the “radio clock reception signal” in the tachometer. ►

### Setting the time with quartz time source

- Turn the control knob to **Time** and press the knob ⇒ *page 36, fig. 30*. The hour display is highlighted in white in the MMI display.
- To set the hour, turn the control knob to the left or right and press the knob. The minute display is highlighted in white in the MMI display.
- To set the minutes, turn the control knob to the left or right.
- Press the control knob to save the time you have set.

### Setting the date with quartz time source

- Turn the control knob to **Date** and press the knob ⇒ *page 36, fig. 30*. The day display is highlighted in white in the MMI display.
- To set the day, turn the control knob to the left or right and press the knob. The month display is highlighted in white in the MMI display.
- To set the month, turn the control knob to the left or right and press the knob. The year display is highlighted in white in the MMI display.
- To set the year, turn the control knob to the left or right.
- Press the control knob to complete the date entry.

MMI high B8, for internal use only

### Setting the time format

- Turn the control knob to **Time format** and press the knob ⇒ *page 36, fig. 30*.
- Turn the control knob to **24h** or **am/pm**.
- Press the control knob to save your setting.

### Setting the date format

- Turn the control knob to **Date format** and press the knob.
- To adjust the date format “Day.Month”, turn the control knob to **dd.mm** and press the knob ⇒ *page 36, fig. 30*.
- To adjust the date format “Month/Day”, turn the control knob to **mm/dd** and press the knob.

#### Tips

If the radio clock\* does not receive a radio signal for three days, it automatically switches to the quartz clock. ■

### Restarting the MMI (Reset)

MMI functionality is restored with a specific button combination.

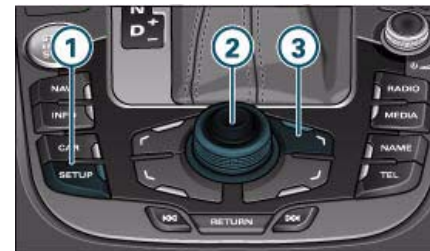

Fig. 31 Button combination to restart the MMI

- Press and hold the **SETUP** function button ①, the control knob ② and the upper right control button ③ *at the same time*.
- Release the buttons. The MMI system switches off and then restarts. ■

## Additional settings

### MMI menu language

- Select: **SETUP** function button > **Settings** control button > **Menu language**.

The displays in the MMI display and driver information system and the language for the navigation announcements and voice recognition system can be changed.

English, French and Spanish are available. ■

### Measurement units

- Select: **SETUP** function button > **Settings** control button > **Measurement units**.

The following measurement units can be set in the MMI display and driver information system.

- Distance (miles or kilometers)
- Speed (mph or km/h)
- Temperature (°F or °C)
- Pressure (psi or bar)
- Consumption (mpg (US), l/100 km, mpg (UK) or km/l)
- Volume (gallon (US), liter or gallon (UK)) ■

### Voice recognition system

- Select: **SETUP** function button > **Settings** control button > **Voice recognition**.

### Short dialogue

When **Short dialogue** is activated, a shorter form of the voice recognition announcements is used.

### Input signal

You can switch the **Beep** input signal during a dialogue on or off.

### Individual training

Individual training improves the recognition function of the voice recognition system by adapting it to your voice or pronunciation. Individual training is comprised of 40 speech entries that consist of commands and sequences of numbers.

For an overview of all voice commands, refer to ⇒ *page 107*.

### Delete all name tags

All of the name tags you have stored (spoken names or telephone numbers) are erased.

MMI high B8, for internal use only



### Tips

**Individual training** can only be performed when the vehicle is stationary. ■

### Default settings

- Select: **SETUP** function button > **Settings** control button > **Default settings**.

You can reset the following functions to the default setting:

- Sound settings
- Radio
- Media settings
- Jukebox
- Directory





- Telephone\*
- Bluetooth\*
- Navigation settings
- Navigation memory
- Voice recognition

After selecting the functions, turn the control knob to **Reset systems**. Confirm your entry by turning the control knob to **Yes** and pressing it.

You can also reset all of the functions listed to the factory default settings by activating the **Select all** option.

If you reset the **Jukebox** to default settings, all of the music files are deleted and the **Media settings** are reset. ■

### MMI display brightness

- Select: **SETUP** function button > **Display** control button > **Brightness**. **MMI high B8, for internal use only**

You can adjusting the brightness of the display by turning the control knob to the right or left. ■

### Version information

- Select: **SETUP** function button > **Settings** control button > **Version information**.

This function shows the MMI and navigation software version. ■

### Data password

- Select: **SETUP** function button > **Settings** control button > **Data password**.

You can protect your personal data such as directory entries, navigation destinations and name tags with a personal password. If the unit is replaced, you can only transfer your personal data to the new MMI unit using your password.



#### Tips

If you do not assign a personal password, "MMI3G" is stored in the MMI automatically as the password. ■

### In-car entertainment fader

- Select: **MEDIA** function button > **SETUP** function button > **In-car entertainment fader**.

With the **In-car entertainment fader**, you can lower the volume of the active audio/video source during navigation announcements or when the Audi parking system\* is active.

You can also adjust the **In-car entertainment fader** in the Radio, Navigation or Car modes. ■

## Listening to the radio

### Introduction



Fig. 32 FM station list



Fig. 33 Sirius station list during loss of reception

The radio has three bands: FM, AM and Sirius\* (satellite radio). The receivable stations are shown on a radio station list and can be selected directly. You can select the next receivable station on the MMI control panel by pressing a button or playing all stations for a few seconds (SCAN). You can also save your favorite stations in a preset list in any order.

#### FM band

The FM station list (maximum 75 stations) is updated automatically.

#### AM band

The AM station list (maximum 165 stations) must be updated manually ⇒ [page 41](#), [fig. 35](#).

The stations in the station list are still displayed after leaving the reception area. Reception is lost.

#### Sirius (satellite radio)\*

The Sirius provider automatically updates the Sirius\* station list (maximum 224 channels). If the last channel playing is no longer available after a station list update, channel 184 will play automatically.

If reception is lost, stations that cannot be received will be identified with the symbol ① ⇒ [fig. 33](#). The symbol disappears when the radio stations are received again.

#### Tips

To receive satellite programs, you must contract the Sirius\* service provider ⇒ [page 41](#). ■

Applies to vehicles: with Satellite Digital Audio Radio Service

### System information

The following system messages can be displayed: ►

System messages	Meaning
ANTENNA	No antenna is connected to the tuner, or there are loose plug contacts on the antenna cable.
LINKING	The tuner is presently not receiving any satellite signal.

### Starting radio mode



MMI high B6, for internal use only

Fig. 34 Station list in the FM band



Fig. 35 Station list in the AM band

Requirement: The MMI must be switched on ⇒ page 28.

- Press the **RADIO** function button. The list of stations or the last active radio menu appears in the MMI display.

The menu that was open the last time you listened to the radio is shown in the MMI display. Press the **RADIO** function button again while in radio mode to open the station list. ■

Applies to vehicles: with Satellite Digital Audio Radio Service

### Activating your Satellite Radio service

*In order to be able to receive satellite programs and traffic message channel (TMC), this service must be enabled.*



Fig. 36 Receiver serial numbers

In order to have the service enabled at your provider, you need the electronic serial number (ESN) of the tuner. To show the electronic serial numbers in the display:

#### Sirius station list

- Press the **Band** control button.
- Turn the control knob to **Sirius** and press the knob. The station list is displayed. ▶

- Turn the knob to **000 Sirius ID** and press the knob.

### Setup menu

- Press the function button **SETUP** in the Satellite Radio menu.
- Select **Receiver serial numbers** by turning the control knob and press the control knob.

The display shows two serial numbers:

- **Audio** - serial number for the Sirius radio program
- **Data** - serial number for TMC traffic reports

### Tips

- Objects such as buildings, tunnels, bridges, terrain, other vehicles or objects on the roof of the vehicle can result in decreased performance.
- Satellite Radio reception is not available in Alaska and Hawaii. ■

**MMI high B8, for internal use only**

Requirement: The radio is on ⇒ *page 41*.

### Band control button

- Press the **Band** control button.
- Turn the control knob to the desired frequency band.
- Press the control knob to select the frequency band. The current frequency band is indicated in the title line of the MMI display.

### RADIO function button

- To select the frequency band, press the **RADIO** function button repeatedly until the desired frequency band is shown in the title line of the MMI display.

### Tips

You can select the frequency band with the multifunction steering wheel just as easily ⇒ *page 99*. ■

## Selecting frequency band

The MMI has three bands: FM, AM and satellite radio\* (Sirius)



Fig. 37 Frequency bands

## Selecting a station from the station list

The receivable stations for the selected frequency band are displayed in the station lists.



Fig. 38 Station list in the FM band



Fig. 39 Station list in the Sirius band

Requirement: The desired frequency band is selected ⇒ page 42 and receivable radio stations are shown in the MMI display ⇒ fig. 38.

- Turn the control knob to the desired radio station.
- Press the control knob to select the station.

To update the station list in the AM band, turn the control knob to **Update station list** ⇒ page 41, fig. 35 and press the knob. The station lists in the FM band and Sirius\* band (satellite radio) are updated automatically.

### Tips

You can also perform this function with the multifunction steering wheel ⇒ page 100. ■

## Selecting the station

Press the knob to select the next station.



Fig. 40 Automatic station search forward (FM band)



Fig. 41 Selecting the station (Sirius band)

MMI components

MMI control panel

Multifunction steering wheel

Voice recognition system

Requirement: The desired frequency band must be selected  
⇒ *page 42*.

#### Selecting the next available station (FM/AM band)

- Press the **Tuning** control button.
- Turn the control knob to >| (Seek up) ⇒ *page 43*, fig. 40 or |< (Seek down).
- Press the control knob. The next receivable station is selected.

#### Selecting the frequency manually (FM/AM band)

- Press the **Tuning** control button.
- Turn the control knob to **TUNE** and press the knob.
- To adjust the frequency in small stages, turn the control knob to the right or left.

#### Selecting the channel (Sirius band)

- Press the **Tuning** control button.
- Turn the control knob to **CH** (Channel number) ⇒ *page 43*, fig. 41 and press the knob.
- Turn the control knob to the right or left to skip to the next/previous channel in station list.

#### Tips

- When in the Sirius band, use the >| (Seek up)/|< (Seek down) function to switch to the Next/Previous station in the station list.

- You can also press the *arrow buttons* on the MMI control panel briefly to switch to the previous/next station in the station list ⇒ *page 29*.
- A station with poor reception will no longer be displayed in the station list once you switch to a different station. However, you can save the station and select it again from the station list ⇒ *page 45*. ■

## Scanning stations

*Using the SCAN function, the receivable stations are played for a few seconds.*



Fig. 42 SCAN function

Requirement: The desired frequency band must be selected  
⇒ *page 42*.

- Press the **Manual** control button.
- Turn the control knob to **SCAN** (Scan) and press the knob.
- Press the control knob again to stop the scan function.
- Press the **Manual** control button. Turn the control knob to **SCAN** (Scan) and press the knob. The current station is selected. ▶

If the scan function is activated in the AM band, the AM band station list will also be updated during the scan process. ■

## Storing stations

The preset list can contain up to 50 stations from all frequency bands.



Fig. 43 Storing stations

Requirement: A station list must be displayed ⇒ page 43, fig. 38.

### Using the control knob

- Press and hold the control knob until the station is stored in the next available position in the preset list and **Store Station name here** appears in the MMI display.
- To change the position in the preset list, turn the control knob to the left or right.
- Press the control knob to store the station in the selected position.

### Using the Memory control button

- Press the **Memory** control button. **Store Station name here** appears in the MMI display ⇒ fig. 43.
- Press the control knob. The selected station is stored in the next available position in the preset list and **Store Station name here** appears in the MMI display.
- To change the position in the preset list, turn the control knob to the left or right.
- Press the control knob to store the station in the selected position.

#### Tips

You can delete an individual station or all stations from the preset list ⇒ page 46. ■

## Selecting a stored station

Requirement: A station must be stored in the preset list ⇒ page 45.

- Press the **Memory** control button. The preset list is displayed.
- To select a station from the preset list, turn the control knob to the station.
- Press the control knob. The station is selected.

#### Tips

Also try selecting a stored station using the multifunction steering wheel ⇒ page 100. ■

## Moving stored stations

Requirement: A station must be stored in the preset list  
⇒ page 45.

- Press the **Memory** control button. The preset list is displayed.
- Turn the control knob to a station and press the knob.
- Turn the control knob to **Move Station name** and press the knob. The station is stored in the next available position in the preset list and **Store Station name here** appears in the MMI display.
- To change the position in the preset list, turn the control knob to the left or right.
- Press the control knob to store the station in the selected position. ■ **MMI high B8, for internal use only**

## Additional settings

### Station names

Requirement: The FM frequency band must be selected  
⇒ page 42.

- Select: **RADIO** function button > **SETUP** function button > **Station names**.

### Scrolling station names

Scrolling text transmitted by the FM stations is shown in the MMI display.

### Fixed station names

Scrolling text transmitted by the FM stations is not shown in the MMI display. Only the current section of the scrolling text is displayed.

### Station names off

Text transmitted by the FM stations is not shown in the MMI display. ■

## Deleting memory entries

Requirement: A frequency band must be selected ⇒ page 42 and a station must be stored in the preset list ⇒ page 45.

- Select: **RADIO** function button > **SETUP** function button > **Delete presets** > **Delete individually** or **Delete all entries**.

### Delete individually

Select **Delete individually** by turning and pressing the control knob. Then select the station to be deleted and press the control knob.

### Delete all entries

Select **Delete all entries** by turning and pressing the control knob. All stored stations are deleted from the preset list. ■

## Displaying radio text

Requirement: The FM frequency band must be selected  
⇒ page 42.

- Select: **RADIO** function button > **Tuning** control button > **TEXT** (Radio text).

Radio texts are additional information transmitted by some stations (e.g. station name, artist or track). ■



Applies to vehicles: with Satellite Digital Radio Service

### Track information

Requirement: Satellite Radio must be activated ⇒ *page 42*.

- Select: **RADIO** function button > **Tuning** control button > **INFO** (Info).

Some radio stations transmit additional information about the program. For example, information about the artist or album could be displayed. ■

Applies to vehicles: with Satellite Digital Radio Service

### Station info

Requirement: Satellite Radio must be activated ⇒ *page 42*.

- Select: **RADIO** function button > **SETUP** function button > **Station info** > **On/Off**. MMI high B8, for internal use only

If information is available for the current track (such as artist or album), it will be displayed in a pop-up window if this function is activated. ■

Applies to vehicles: with Satellite Digital Radio Service

### Station sorting

Requirement: The Sirius frequency band must be selected ⇒ *page 42*.

- Select: **RADIO** function button > **SETUP** function button > **Station sorting**.

#### Channel number

The stations are listed by channel number in ascending order.

#### Channel name

The station categories are listed in the main menu in alphabetical order.

#### Category and channel no.

The stations are listed by category and then by channel number.

#### Category and chan. name

The stations are listed by category and then by channel name.



#### Tips

The stations that are displayed in the stations list can be filtered according to your personal desires as to type of program. ■

Applies to vehicles: with Satellite Digital Radio Service

### Category filter

Requirement: Satellite Radio must be activated ⇒ *page 42*.

- Select: **RADIO** function button > **SETUP** function button > **Category filter**.

The stations that are displayed in the station list can be filtered according to your personal desires as to type of program. The selection of program categories depends on what your provider offers.

If you select the option **Deactivate filter**, all filter options are deactivated and all available channels are displayed in the satellite station list. ■

## Playing media

### Introduction

You can start and operate the CD/DVD drive, CD changer\*, Jukebox, memory card reader and a portable audio device\* (such as an iPod or USB storage device) using the MMI control panel. Different functions are available depending on the active source and the medium inserted. For example, you can select individual tracks or folders directly, play the tracks in random order or display information stored in an ID3/WMA/AAC tag with the current track (such as the artist, album, title, year and genre). ■

### Starting Media mode



Fig. 44 Audio/video source overview

Requirement: The MMI must be switched on ⇒ page 28.

- Press the **MEDIA** function button. The source overview ⇒ fig. 44 or the track that was playing the last time media mode was active will be shown in the MMI display.
- If the source overview is not shown in the MMI display, press the **Source** control button. ■

### Selecting source



Fig. 45 List of possible audio/video sources

Requirement: A source must contain an audio or video file.

Press the **MEDIA** function button.

- Press the **Source** control button.
- Turn the control knob to a source and press the knob. The track list or folder structure for the selected source is shown in the MMI display.
- Turn the control knob to a track or a folder and press the knob.

Possible sources are:

- ① Jukebox
- ② Memory card
- ③ CD/DVD drive
- ④ Audi music interface\* (such as an iPod) or external audio input
- ⑤ CD changer\* ■

## Selecting a folder

The folders for the active audio source are shown in the MMI display.



Fig. 46 Folder structure for an MP3 CD.

Requirement: The selected source must contain audio files.

- Press the **MEDIA** function button. The folder structure for the selected source is displayed ⇒ fig. 46.
- Turn the control knob to a folder.
- Press the control knob to select the folder. The tracks in the folder are displayed.

### Tips

- To reach the next highest level, press the **RETURN** button or turn the control knob to the **Up** folder and press the knob.
- To reach the highest level in the folder structure, press the **MEDIA** function button.
- You can scroll through long lists of folders quickly by turning the control knob quickly. The scrolling speed depends on the number of folders. ■

## Selecting a track

The track with the play time is shown in the MMI display.



Fig. 47 Track list

Requirement: An audio CD or a folder must be selected ⇒ page 49.

- Turn the control knob to a track ⇒ fig. 47.
- Press the control knob to select the track. The track will play.

If metadata (such as an ID3 tag) is available for a current track (such as the artist, album or track), it will be displayed in a pop-up window. The **Display track info** function must be activated ⇒ page 55.

### Tips

- You can also perform this function with the multifunction steering wheel ⇒ page 101.
- You can scroll through long lists of tracks quickly by turning the control knob quickly. The scrolling speed depends on the number of tracks. ■

### Fast forward/rewind

You can skip forward or back within a tracking using fast forward/rewind.



Fig. 48 Fast forward in a CD

Requirement: An audio file or a video DVD must be playing.

- Press the **Manual** control button.
- Turn the control knob to >> (Forward) ⇒ fig. 48 or <<< (Rewind) and hold the knob down.

#### Tips

You can also press and hold the *arrow buttons* on the MMI control panel to fast forward or rewind within a track or video DVD ⇒ page 29. ■

### Next/previous track or chapter

This function makes it possible to skip to the previous or next track or chapter within an audio/video source.



Fig. 49 Next chapter

Requirement: An audio file or a video DVD must be playing.

#### Previous/next track

- Press the **Manual** control button.
- Turn the control knob to >| (Next track) or |< (Previous track).
- Press the control knob to skip to the previous/next track. The track will play.

#### Next/previous chapter (video DVD)

- Press the **Manual** control button.
- Turn the control knob to >| (Next chapter) or |< (Previous chapter).
- Press the control knob to skip to the previous/next chapter. ▶

If you select **Previous track/Previous chapter** within 10 seconds after a track has started to play, the previous track will start playing. If you press it after 10 seconds, the current track will begin playing again from the beginning.

### Tips

You can also press the *arrow buttons* on the MMI control panel briefly to switch to the previous/next track or chapter ⇒ [page 29](#). ■

## Track information



Fig. 50 Track information

Requirement: And audio file must be playing ⇒ [page 49](#).

- Press the **Manual** control button.
- Turn the control knob to **INFO** (Title information) ⇒ [fig. 50](#) and press the knob.

Metadata/tag information stored with the current track (such as artist, album or title) is displayed. ■

## Repeat options



Fig. 51 Repeat

Requirement: And audio file must be playing ⇒ [page 49](#).

- Press the **Manual** control button.
- Turn the control knob to **RPT** (Repeat options) ⇒ [fig. 51](#) and press the knob.

The following functions can be selected for repeat:

- **Off** - the **Repeat options** are switched off.
- **Medium** - if a CD is playing in the CD changer\*, the tracks on the CD will repeat.
- **Folder** - the tracks in the folder will repeat.
- **Track** - the current track playing will repeat.

### Tips

**Shuffle** also depends on the settings for the repeat options ⇒ [page 52](#). ■

## Shuffle

You can play the tracks in random order.



Fig. 52 Shuffle

Requirement: An audio file must be playing ⇒ *page 49* and **Repeat options** must be selected.

- Press the **Manual** control button.
- Turn the control knob to **Shuffle** ⇒ fig. 52 and press the knob.
- **Off** repeat option - all of the files in the active audio source play in random order. First the tracks on the current CD in the CD changer\* are played in random order and then the tracks on the remaining CDs are.
- **Medium** repeat option - if a CD is playing in the CD player\*, the tracks on the CD play in random order.
- **Folder** repeat option - the tracks in the current track list with audio files play in random order. ■

## DVD main menu



Fig. 53 DVD main menu

Requirement: A video DVD must be playing ⇒ *page 48*.

- Press the **Manual** control button.
- Turn the control knob to **MENU** (Display main menu) ⇒ fig. 53 and press the knob. The DVD main menu is shown in the MMI display.
- To select a menu item, turn the control knob to the item and press the knob.

### Tips

You can also control the DVD main menu with the joystick ⇒ *page 32*. ■

## DVD full screen display

The video image is only displayed when the vehicle is stationary for safety reasons. You can still hear the sound.



Fig. 54 DVD full screen

Requirement: A video DVD must be playing ⇒ page 48 and the vehicle must be stopped.

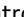
- Press the **Manual** control button.
- Turn the control knob to  (Display full screen) ⇒ fig. 54 and press the knob. The video image expands to fill the entire MMI display.
- To deactivate the full screen display, turn the control knob back to  (Display full screen) and press the knob. ■

## DVD parental control

You can restrict the playback of video DVDs with the parental control. The settings are protected by a password.



Fig. 55 Selecting the content rating

Requirement: A video DVD must be playing ⇒ page 48.

### Selecting the content rating

- Press the **SETUP** function button.
- Turn the control knob to **Parental control** and press the knob.
- Enter the password using the speller.
- Select **OK** in the speller and press the control knob to confirm your entry.
- Turn the control knob to **Content rating** and press the knob.
- Turn the control knob to a level (such as **Level 5**) and press the knob. The selected level is stored. ▶

### Change password

- Press the **SETUP** function button.
- Turn the control knob to **Parental control** and press the knob.
- Enter the password using the speller.
- Select **OK** in the speller and press the control knob to confirm your entry.
- Turn the control knob to **Change password** and press the knob.
- Enter the new parental control password using the speller.
- Select **OK** in the speller and press the control knob.
- Enter the new parental control password again.
- Select **OK** in the speller and press the control knob to confirm your entry. The new password is stored.

In accordance with the Motion Picture Association of America (MPAA), the following eight levels can be selected for **Parental control**:

Parental Level	Description
Level 1 - G	Unrestricted audience
Level 2	Most audiences
Level 3 - PG	Mature young audience
Level 4 - PG-13	Teenage audience
Level 5	Mature teenage audience

Parental Level	Description
Level 6 - R	Mature audience
Level 7 - NC-17	Adult audience
Level 8 - Adult	Most restricted audience

If you select **Level 5**, for example, for the parental control level, all DVDs from level 1-5 can be played. Video DVDs with a higher level will not play.

The **Off** setting deactivates all restrictions.

### Tips

- The password “1234” is set for the **Parental control** at the factory.
- Password entry will be locked for approximately one minute if you enter the incorrect password three times in a row.
- Only your authorized Audi dealer can reset the parental control password. ■

## Pausing/continuing playback



Fig. 56 Pausing/continuing playback

Requirement: An audio file or a video DVD must be playing  
⇒ page 49. ▶



- Press the **Manual** control button.
- Turn the control knob to || (pause) ⇒ *page 54*, fig. 56 and press the knob. Playback is paused and the mute symbol  ⇒ *page 30*, fig. 21 appears in the status line of the MMI display.
- Turn the control knob to || (pause) again and press the knob.

### Tips

- You can also pause and continue playback in the active audio source with the On/Off knob ⇒ *page 99*.
- You can also perform this function with the multifunction steering wheel without removing your hands from the wheel ⇒ *page 101*. ■

## Additional settings

MMI high B8, for internal use only

### Track display

Requirement: A folder with audio files must be playing ⇒ *page 49*.

- Select: **SETUP** function button > **Track display**

#### File name

The name of the file is displayed without the file extension.

#### Track name

The track name, for example from the ID3 tag, is displayed.

### Tips

The **Track display** function is not available for the Jukebox or a connected iPod. ■

### Displaying track information

Requirement: A folder with audio files must be playing ⇒ *page 49*.

- Select: **MEDIA** function button > **SETUP** function button > **Display track info**.

If information is available for the current track (such as artist or album), it will be displayed in a pop-up window if this function is activated. ■

### Aspect ratio

Requirement: A video DVD must be playing ⇒ *page 48*.

- Select: **MEDIA** function button > **SETUP** function button > **Aspect ratio**.

The following functions can be selected for the aspect ratio:

- **Automatic adjustment** - the aspect ratio is adjusted automatically. The image width varies depending on film format.
- **Standard (4:3)** - the DVD image is displayed in **4:3** format.
- **Widescreen (16:9)** - the DVD image is displayed in **16:9** format.
- **Zoom** - the DVD image is expanded to fill the complete display.
- **Cinemascope** - the image is displayed in the **1:2.35** aspect ratio. ■

Applies to vehicles: with Audi music interface or Aux-in connection

### Input level

Requirement: A portable audio device must be connected with the 3.5 mm stereo jack adapter cable\* ⇒ *page 20*. ▶

- Select: **MEDIA** function button > Source External audio input/Audi music interface > **SETUP** function button > **Input level.**

The volume of the portable audio device is adapted to the MMI. Audi recommends adjusting the volume of the portable audio device to 70 percent of the maximum output. ■

**MMI high B8, for internal use only**

## Directory

Applies to vehicles: with cell phone prep

### Introduction

The MMI contains an extensive directory. You can manage up to 5,000 entries with the directory ⇒ *page 68*. You can transfer up to 2000 directory entries from your cell phone to the MMI via Bluetooth. The imported directory entries are stored in the general profile or in your personal profile in the MMI ⇒ *page 66*. You can also manually store up to 100 entries per profile in the MMI local memory.

You can store up to five telephone numbers (land line, cell and fax) for each entry. You can store a private and work navigation destination in the local MMI memory for up to 100 entries. You can then use these entries directly from the directory for communication and navigation. ■

- Press the **[NAME]** function button. A list of entries ⇒ *fig. 57* or the last active directory menu appears in the MMI display.
- If a list of entries ⇒ *fig. 57* does not appear in the MMI display, press the **[NAME]** function button again.

The directory entries are displayed in alphabetical order and identified with a symbol ⇒ *fig. 57*.

- ① Local MMI memory
- ② SIM card
- ③ Cell phone ■

Applies to vehicles: with cell phone prep

### MMI high B8, for internal use only **Storing a new directory entry**

Applies to vehicles: with cell phone prep

### Opening the directory

*You must enter a name for the new entry first. Then you can enter additional optional information such as telephone numbers, address or navigation destination.*



Fig. 57 List of entries

Requirement: The MMI must be switched on ⇒ *page 28*.



Fig. 58 Storing a new entry

Requirement: The directory must be open ⇒ *page 57*. ▶

- Turn the control knob to **New entry** ⇒ page 57, fig. 58 and press the knob. An input field appears in the MMI display.
- Press the control knob to open the **Name** field. The speller appears in the MMI display ⇒ page 31.
- Enter the name using the speller, then select **OK** in the speller and press the knob to confirm your entry. The input field appears again in the MMI display.
- To enter additional data, select a field with the control knob and follow the instructions above.

You can store up to five telephone numbers in an address card. You can also assign a **Type (Business or Private)** and a **Category (Land line, Cell or Fax)** to a telephone number. You can also identify a frequently used telephone number as a **Preferred phone number**. That number is then displayed first in the open address card.

**MMI high B8, for internal use only**

### Tips

- Entries are stored automatically during input.
- The new entry is stored in the local memory for the current profile. The local memory for the current profile is limited to 100 entries. ■

## Importing directory entries

Applies to vehicles: with cell phone prep

### Importing a phone book

*Directory entries from a cell phone can be imported into the directory manually.*



Fig. 59 Importing a phone book

Requirement: The directory must be open ⇒ page 57 and the cell phone prep ⇒ page 22 must be active.

- Press the **Memory** control button.
- Turn the control knob to **Import phone book** ⇒ fig. 59 and press the knob. The phone book in the connected cell phone is imported.

If you have not created a personal profile ⇒ page 66, the phone book will be imported into the personal profile. When connecting a cell phone, the existing entries are overwritten with the entries in the cell phone that is currently connected. Up to 2,000 entries can be imported into the general profile. ▶



**Tips**

The directory entries in the current profile are updated automatically when a cell phone is connected. ■

Applies to vehicles: with cell phone prep

**Importing a phone number**

You can import a phone number for an existing entry in the directory.



Fig. 60 Entering the phone number using the speller

MMI high B6, for internal use only



Fig. 61 Transferring the number from the call lists

Requirement: A new entry must be stored in the directory ⇒ page 57 or an existing entry in the local MMI memory will be edited ⇒ page 63.

- Turn the control knob to **Phone numbers** and press the knob.
- Turn the control knob to **New phone number** and press the knob. An input field appears in the MMI display.
- Turn the control knob to **Number** and press the knob. The speller appears in the MMI display.
- Select **List** ⇒ fig. 60 in the speller and press the control knob. The **Import from** menu appears in the MMI display ⇒ fig. 61.
- Turn the control knob to a call list (for example **Dialed numbers** ⇒ fig. 61) from which the phone number will be imported and press the knob. A list of phone numbers appears in the MMI display.
- Turn the control knob to a phone number and press the knob. The phone number is imported into the address card and stored automatically.

You can also enter a phone number directly in the **Number** field using the speller without using the import function.

If the functions are grayed out, make sure your cell phone is paired with the cell phone prep. Also make sure there are phone numbers in the call lists on your cell phone.



**Tips**

The import function depends on the cell phone. Grayed out functions cannot be selected. ■

Applies to vehicles: with cell phone prep

### Importing address cards

Address cards in vCard format (.vcf) can be imported into the directory with a memory card or a USB storage device\*.



Fig. 62 Importing address cards

Requirement: The directory must be open (pages 19 and 20) and a memory card must be inserted in the memory card reader ⇒ page 16 or a USB storage device must be connected to the Audi music interface\* using a USB adapter cable\* ⇒ page 20.

- Press the **Memory** control button.
- Turn the control knob to **Import contacts** and press the knob.
- Turn the control knob to **SD card 1**, **SD card 2** or **USB storage device** and press the knob.
- Turn the control knob to **All entries** or a certain entry in the list ⇒ fig. 62 and press the knob.
- Turn the control knob to **Import entries** and press the knob to import the selected entry or all entries.

- To search for an entry in the cell phone directory, turn the control knob to **Find entry**. The speller appears in the MMI display ⇒ page 31.
- Enter the name using the speller, then select **OK** in the speller and press the knob to confirm your entry.

### Tips

- The address import depends on the cell phone. Only structured addresses that have information regarding country, city, ZIP code and street can be imported.
- You can check the directory memory capacity at any time ⇒ page 68.
- The imported address cards are stored in the local memory for the current profile. ■

Applies to vehicles: with cell phone prep

### Exporting address cards

Directory entries can be exported to a memory card or USB storage device in vCard format (.vcf).

- Press the **Memory** control button.
- Turn the control knob to **Export contacts** and press the knob.
- Turn the control knob to an entry in the list or **All entries** and press the knob.
- To search for an entry, turn the control knob to **Find entry** ⇒ fig. 62. The speller appears in the MMI display ⇒ page 31. ▶

- Enter the name using the speller, then select **OK** in the speller and press the knob to confirm your entry. The entry is selected.
- Turn the control knob to **Export entries individually** or **Export packed entries** and press the knob.
- Turn the control knob to the source **SD card 1**, **SD card 2** or **USB storage device** and press the knob.

You can export packed directory entries or individual entries.

- **Export entries individually** - a vCard file (.vcf) is created for each directory entry during the export.
- **Export packed entries** - only one vCard file (.vcf) is created for all directory entries during export. ■

## Using a directory entry

MMI high B8, for internal use only

Applies to vehicles: with cell phone prep

### Searching

You can select an entry directly from a list or search for it using the speller.



Fig. 63 Searching for an entry

Requirement: The directory must be open ⇒ *page 57* and entries must be displayed ⇒ *page 57*.

### Selecting an entry from a list

- Turn the control knob to an entry ⇒ *page 57*, fig. 58 and press the knob. The address card is shown in the MMI display.

### Searching for an entry using the speller

- Turn the control knob to **Find entry** ⇒ fig. 63 and press the knob. The speller appears in the MMI display ⇒ *page 31*.
- Enter a name using the speller, or
- Select a name in the speller from **LIST**.
- Select **OK** in the speller and press the control knob to confirm your entry.

### Tips

- You can change, delete ⇒ *page 64*, call up or navigate to ⇒ *page 62* an existing entry.
- You can also search for an entry easily using the voice recognition system ⇒ *page 111*. ■

Applies to vehicles: with cell phone prep

### Selecting

You can make calls to entries with phone numbers.



Fig. 64 Calling up an entry

Requirement: The directory must be open and list of directory entries must be displayed ⇒ page 57.

- Turn the control knob to an entry and press the knob. The address card appears in the MMI display.
- Turn the control knob to a phone number ⇒ fig. 64 and press the **Dial** control button. The call is made, or
- Press the control knob. The telephone menu appears in the MMI display with the speller and the selected phone number.
- Select **OK** in the speller and press the control knob. The connection is established.

#### Tips

You can also make calls easily using the voice recognition system ⇒ page 111. ■

Applies to vehicles: with cell phone prep

### Navigating

You can navigate directly to entries in the directory that have navigation destinations.



Fig. 65 Selecting a navigation destination

Requirement: The directory must be open ⇒ page 57 and must contain stored entries with private or personal navigation destinations ⇒ fig. 65.

- Turn the control knob to an entry and press the knob.
- If an entry contains two navigation destinations (private and business), turn and press the control knob to select a navigation destination.
- Press the **Navigate to** control button, or
- Turn the control knob to **Navigate to** ⇒ fig. 65 and press the knob. The navigation menu appears in the MMI display with the selected navigation destination. ■



## Editing a directory entry

Applies to vehicles: with cell phone prep

### Storing a navigation destination

You can store a business and a personal navigation destination for an existing entry in the directory.



Fig. 66 Navigation destination input field

MMI high B8, for internal use only



Fig. 67 Setting a navigation destination from the last destinations

Requirement: An address card must be open for editing ⇒ fig. 66 and a private/business navigation destination must be selected or a new entry must be created ⇒ page 57.

### Entering a navigation destination

- Turn the control knob to **Create nav. destination** and press the knob. The input field is shown in the MMI display ⇒ fig. 66.
- Turn the control knob to **Country** and press the knob. A list of countries appears in the MMI display.
- Turn the control knob to a country and press the knob. The land is entered in the input field.
- To enter additional data, select a field with the control knob and follow the instructions above. Your entries are automatically stored in the address card.

### Selecting from an address

- Turn the control knob to **Create nav. destination** and press the knob. The stored address is automatically set as the navigation destination.

### Selecting from last destinations

- Turn the control knob to **Create nav. destination** and press the knob. The input field is shown in the MMI display ⇒ fig. 66.
- Turn the control knob to **Last destinations** ⇒ fig. 67 and press the knob. A list of the last destinations appears in the MMI display.
- Turn the control knob to a navigation destination and press the knob. The navigation destination is stored in the address card.

### Setting based on the current position

- Turn the control knob to **Create nav. destination** and press the knob. The input field appears ⇒ fig. 66. ▶

- Turn the control knob to **Current position** ⇒ page 63, fig. 67 and press the knob. The data for the current position is set as the navigation destination.

#### Selecting from points of interest

- Turn the control knob to **Create nav. destination** and press the knob. The input field is shown in the MMI display ⇒ page 63, fig. 66.
- Turn the control knob to **Point of interest** ⇒ page 63, fig. 66 and press the knob.
- Turn the control knob to **Top categories** for example and press the knob.

A private and a business navigation destination can be assigned to each directory entry. You can call up the stored navigation destinations in the Navigation menu using the **Memory** control button (**Load from directory**) ⇒ page 89. **MMI high B8, for internal use only**

You can find the next rest stop, gas station, Audi dealer or hospital under the **Top destinations** menu item. The **Point of interest** ⇒ page 63, fig. 66 menu item contains additional submenus that you can use to create navigation destinations. For more information about the submenus, refer to ⇒ page 82.

#### Tips

- You can also display a navigation destination as a **Favorite**. The navigation destination is then displayed in the destination entry menu under the Navigation menu ⇒ page 90.
- Entries that have an assigned navigation destination are stored in the local memory for the current profile. The current profile is limited to 100 entries. ■

Applies to vehicles: with cell phone prep

#### Changing an entry

*You can edit the entries in the MMI local memory at any time.*



Fig. 68 Editing an entry

Requirement: An address card must be open ⇒ fig. 68.

- Turn the control knob to **Edit entry** ⇒ fig. 68 and press the knob. An input field appears in the MMI display.
- Select a field with the control knob and press the knob to edit the entry data.

You cannot edit directory entries from the cell phone memory directly in the MMI. To edit an entry from the cell phone, turn the control knob to **Copy for editing** and press the knob. A copy of the entry is stored in the MMI memory.

The MMI cannot automatically update changed directory entries in the connected cell phone. Audi recommends editing cell phone entries directly in the cell phone. ■

Applies to vehicles: with cell phone prep

### Deleting an entry

*You can delete the entries in the MMI local memory at any time.*

Requirement: An address card must be open ⇒ *page 64*, fig. 68.

- Turn the control knob to **Delete entry** ⇒ *page 64*, fig. 68 and press the knob.
- Turn the control knob to **Yes** and press the knob to delete an entry. The entry is deleted from the MMI local memory. ■

Applies to vehicles: with cell phone prep

### Reading a name

*The MMI automatically creates a name tag for each entry in the directory. You can also assign up to 50 personal name tags for address cards using the voice recognition system.*

Requirement: The directory must be open ⇒ *page 57*.

#### Reading in an address card

- Turn the control knob to an entry and press the knob. The address card is shown in the MMI display.
- Turn the control knob to **Read name** and press the knob. The name is read.

#### Reading in the SETUP menu

- Press the **SETUP** function button.

- Turn the control knob to **Read voice memos** and press the knob. A list with personal name tags appears in the MMI display.
- Turn the control knob to an entry and press the knob. The name tags are played.

#### Tips

- You can only assign and store personal name tags using the voice recognition system ⇒ *page 112*.
- You can also read all the names easily using the voice recognition system ⇒ *page 112*. ■

Applies to vehicles: with cell phone prep

### Deleting a name tag

Requirement: The directory must be open ⇒ *page 57*.

#### Deleting in the address card

- Turn the control knob to an entry and press the knob. The address card is shown in the MMI display.
- Turn the control knob to **Delete name tag** and press the knob. The name tag is deleted.

#### Deleting in the SETUP menu

- Press the **SETUP** function button.
- Turn the control knob to **Delete voice memos** and press the knob.
- Turn the control knob to **Delete individually** or **Delete all entries** and press the knob. ▶

- Turn the control knob to **Yes** and press the knob to begin the deletion process.

### Tips

- You can only delete personal assigned name tags.
- There is another way to delete all name tags. For more information, refer to ⇒ *page 38*. ■

## Managing profiles

Applies to vehicles: with cell phone prep

### Introduction

A general profile and up to four personal profiles are available in the directory.

A personal profile is useful if you will be connecting different cell phones to the MMI. In the personal profile, you have immediate access to the cell phone directory entries when you connect the phone. The directory entries are updated automatically in the background.

The entries for the connected cell phone are loaded into the general profile. When that happens, the entries from the last cell phone that was connected to the general profile are overwritten. ■

Applies to vehicles: with cell phone prep

### Creating a profile



Fig. 69 Creating a profile

Requirement: The directory must be open ⇒ *page 57*, the cell phone prep ⇒ *page 22* must be activated and the automatic import of cell phone directory entries must be complete.

- Press the **SETUP** function button.
- Turn the control knob to **Manage profiles** and press the knob.
- Turn the control knob to **Create profile** ⇒ *fig. 69* and press the knob. The profile name is shown in the MMI display.
- Turn the control knob to **Yes** and press the knob to store the profile.

The Bluetooth name of the connected cell phone is automatically set as the profile name. However, you can assign your own profile names ⇒ *page 67*. ►

### Tips

The **Create profile** menu item is only available when a cell phone is connected. In addition, there must not be a profile already stored for the connected cell phone. ■

Applies to vehicles: with cell phone prep

### Deleting profiles



MMI high 88, for internal use only  
Fig. 70 Deleting other profiles

Requirement: The directory must be open ⇒ *page 57* and a profile must be stored in the MMI ⇒ *page 66*.

#### Deleting the current profile

- Press the **SETUP** function button.
- Turn the control knob to **Delete current profile** and press the knob.
- Turn the control knob to **Delete current profile** ⇒ *page 66*, fig. 69 and press the knob. All directory entries for the current profile are deleted.

#### Deleting other profiles

- Press the **SETUP** function button.

- Turn the control knob to **Delete current profile** and press the knob.
- Turn the control knob to **Delete other profiles** ⇒ fig. 70 and press the knob. A list with all of the stored profiles and the directory for the general profile appears in the MMI display. The current profile is not displayed in the list.
- Turn the control knob to a stored profile or **Directory** and press the knob.
- Turn the control knob to **Delete profiles** and press the knob.
- Confirm your entry by turning the control knob to **Yes** and pressing it. The speller appears in the MMI display to enter the **ID number**.
- Enter the last seven characters of your vehicle's **VIN** with the speller.
- Select **OK** in the speller and press the control knob to confirm your entry.

You can find the **Vehicle ID number (VIN)** in the **CAR** menu or the vehicle registration. To obtain the **Vehicle ID number (VIN)**, press the **CAR** function button. Turn the control knob to **Vehicle ID number (CAR)** and press the knob. ■

Applies to vehicles: with cell phone prep

### Changing profile names

Requirement: The directory must be open ⇒ *page 57* and a profile must be stored in the MMI ⇒ *page 66*.

- Press the **SETUP** function button. ▶

- Turn the control knob to **Delete current profile** and press the knob.
- Turn the control knob to **Change profile names** and press the knob. The speller appears in the MMI display with the profile name in the input field.
- Turn the speller to  and press the control knob until the profile name in the input field is deleted.
- Enter a new profile name using the speller, then select **OK** in the speller and press the knob to confirm your entry. ■

## Additional settings

Applies to vehicles: with cell phone prep

### Memory capacity

- Select:  function button > **MMI high B8, for internal use only** Memory control button > **Memory capacity**.

The **Memory capacity** for the current profile and the entire memory is displayed.

You can manage up to 5,000 entries with the directory. You can import up to 2000 entries into the general profile or your personal profile. You can also manually store up to 100 entries per profile in the MMI local memory. ■

## Calling

Applies to vehicles: with cell phone prep

### Introduction

You can use a cell phone comfortably with the MMI. Many functions you are familiar with from your cell phone are available: you can answer and end calls or place them on hold. You can also access the MMI directory and the cell phone directory.

The active audio source is muted during an incoming/outgoing call and the drive is paused ⇒ *page 33*. After the call has ended, the audio source is restored to the previous volume level.

If you do not want to hear navigation announcements during a phone call, you can switch off that option ⇒ *page 93*.

#### Note

- Switch the phone system off through the Telephone Setup menu in areas where cell phone usage is prohibited. Obey all applicable instructions and regulations.
- Switch your cell phone off in areas at risk for an explosion. These locations are not always clearly marked. They may include gas stations, equipment that stores or transports fuel or chemicals, or locations where fuel vapors (such as propane or gasoline vapor in vehicles or buildings), chemicals or large quantities of dust particles (such as flour or sawdust) may be present in the air. This also applies to all other locations where you would normally switch your vehicle off.

#### Tips

The telephone functions depend on the cell phone service provider and the cell phone you are using. You can obtain more information from your cell phone service provider. ■

Applies to vehicles: with cell phone prep

### Starting Telephone mode



Fig. 71 Speller for entering a phone number

Requirement: The MMI must be switched on ⇒ *page 28*.

- Press the **TEL** function button. The speller ⇒ *fig. 71* or the last active Telephone menu appears in the MMI display.

You open the speller by pressing the **TEL** function button in telephone mode. ■

MMI high B8, for internal use only

## Dialing a telephone number

Applies to vehicles: with cell phone prep

### Directly through the speller

The speller can be used to enter a phone number directly as a series of numbers or letters.



Fig. 72 Entering telephone numbers using the number speller



Fig. 73 Entering telephone numbers using the letter speller

Requirement: Telephone mode must be active ⇒ page 22 and the speller must appear in the display ⇒ fig. 72.

### Entering the phone number as a sequence of numbers

- Enter the phone number using the speller.
- Confirm your entry by selecting **OK** in the speller and pressing, or
- Press the **Dial** control button. As the number is being dialed, the audio source is muted.

### Entering the phone number as a sequence of letters

- Enter an area code with the speller.
- To change to the letter speller, turn the speller to **A-Z** ① ⇒ fig. 72 and press the control knob.
- Use the speller to enter a series of letters such as **AUDIS-ERVICE** ⇒ fig. 73.
- Confirm your entry by selecting **OK** in the speller and pressing, or
- Press the **Dial** control button. The entered telephone number is dialed.

If you enter a phone number incorrectly, you can press on the **RETURN** button to completely delete the number you entered in the speller.

### **i** Tips

- DTMF tones can be entered directly through the speller or loaded from the stored phone numbers ⇒ page 71.
- The audio source is muted during an incoming/outgoing call. The mute symbol is shown in the MMI display status bar ⇒ page 30, fig. 21. ▶



- If you switch **Off** voice guidance while in navigation mode, navigation commands will not play during a call ⇒ *page 93*.
- If you have switched the MMI display off, it will switch on automatically and remain on for the duration of the call. ■

Applies to vehicles: with cell phone prep

### From a list



Fig. 74 Dialing a phone number from a list

Requirement: Telephone mode must be active ⇒ *page 22*.

### Searching and calling telephone numbers in a list

- Press the **Memory** control button.
- Turn the control knob to **Directory**, **Dialed numbers**, **Missed calls** or **Received calls**.
- Press the control knob. The phone numbers from the selected list appear in the MMI display.
- Turn the control knob to the desired telephone number.
- Press the control knob. The selected telephone number is copied to the speller.

- To initiate the call, turn the speller to **OK** and press the control knob, or
- Press the **Dial** control button.

### Dialed number list quick display and calling a number

- Press the **TEL** function button. The speller is shown in the MMI display. There is *no* telephone number in the entry field of the speller.
- Press the **Dial** control button. The **Dialed numbers** list appears in the MMI display.
- Turn the control knob to the desired telephone number.
- Press the control knob. The selected telephone number is copied to the speller.
- To initiate the call, turn the speller to **OK** and press the control knob, or
- Press the **Dial** control button.

### Tips

The telephone functions depend on the cell phone service provider and the cell phone you are using. You can obtain more information from your cell phone service provider. ■

Applies to vehicles: with cell phone prep

## Answering/ignoring a call



Fig. 75 Answering an incoming call

Requirement: An incoming call.

### Answering a call

- Turn the control knob to **Answer** and press the knob, or
- Press the **Answer** control button.

### Ignoring a call

- Turn the control knob to **Ignore** and press the knob, or
- Press the **Ignore** control button.

The *Name*, *Phone number* or **Unknown** appears in the display depending on whether the caller has been stored in the directory and if the phone number has been transmitted.



#### Tips

- You can accept an incoming call during an active call. The active call is placed on hold automatically.

- The audio source is muted during an incoming/outgoing call. The mute symbol is shown in the MMI display status bar ⇒ *page 30*, fig. 21.
- If you would not like to hear navigation announcements during a phone call, you can switch them off ⇒ *page 93*.
- A call can also be answered/ignored using the multifunction steering wheel ⇒ *page 104*. ■

Applies to vehicles: with cell phone prep

## Ending a call

Requirement: You have an active call or are dialing a call.

- To end a phone call or to cancel dialing, press the **End call** button ⇒ *page 73*, fig. 76.



#### Tips

A call can also be ended using the multifunction steering wheel ⇒ *page 103*. ■

Applies to vehicles: with cell phone prep

## Storing a phone number in the directory

A new phone number or a number from the call lists can be stored in the directory



Fig. 76 Storing the phone number in the directory

Requirement: Telephone mode must be active ⇒ page 22. **MMI high B8, for internal use only**

### New phone number

- Enter a new phone number in the speller ⇒ page 70.
- Press the **Memory** control button ⇒ fig. 76.
- Turn the control knob to **Store current number** and press the knob.
- To create a new entry, turn the control knob to **New entry** ⇒ page 57, fig. 58 and press the control knob ⇒ page 57, or
- To add a phone number to an existing entry, turn the control knob to **Find entry** and press the knob ⇒ page 61, or

- Turn the control knob to an entry in the list and press the knob. The address card opens.
- Turn the control knob to **Store entry** and press the knob. The phone number is stored.

### Phone number from a call list

- Press the **Memory** control button.
- Turn the control knob to **Dialed numbers, Received calls** or **Missed calls**.
- Press the control knob. The available phone numbers are listed in the display.
- Turn the control knob to the phone number that will be stored and press the knob.
- Turn the control knob to **Store** and press the knob.
- To create a new entry, turn the control knob to **New entry** ⇒ page 57, fig. 58 and press the control knob ⇒ page 57, or
- To add a phone number to an existing entry, turn the control knob to **Find entry** and press the knob ⇒ page 61, or
- Turn the control knob to an entry in the list and press the knob. The address card opens.
- Turn the control knob to **Store entry** and press the knob. The phone number is stored.



#### Tips

You can edit the directory ⇒ page 57. ■

Applies to vehicles: with cell phone prep

## Dialing stored phone numbers

You can dial a phone number from the call lists or from the MMI directory.



Fig. 77 Searching stored telephone numbers

Requirement: Telephone mode must be started ⇒ page 22 and a phone number must be stored.

- Press the **Memory** control button.
- Turn the control knob to **Directory**, for example.
- Press the control knob. **Find entry** and a list of stored entries appear in the MMI at the same time ⇒ fig. 77.
- Turn the control knob to **Find entry** ⇒ fig. 77 and press the knob. The speller appears in the display so you can enter names, or
- Turn the control knob to a name from the list and press the control knob. The phone number is shown in the MMI display.
- To dial the phone number, press the control knob and then select **OK** in the speller and press the knob, or
- Press the **Dial** control button. ■

Applies to vehicles: with cell phone prep

## Deleting local call lists

Requirement: Telephone mode must be active ⇒ page 22.

### Delete individually

- Press the **Memory** control button.
- Turn the control knob to **Delete local call lists** and press the knob.
- Turn the control knob to **Dialed numbers, Missed calls or Received calls** and press the knob.
- Turn the control knob to **Yes** and press the knob to delete a call list.

### Delete all entries

- Press the **Memory** control button.
- Turn the control knob to **Delete local call lists** and press the knob.
- Turn the control knob to **Delete all entries** and press the knob.
- Turn the control knob to **Yes** and press the knob to delete all the call lists. ■

MMI high B8, for internal use only

Applies to vehicles: with cell phone prep

## Bluetooth settings



Fig. 78 Bluetooth symbol

- Press the **SETUP** function button.
- Press the **Bluetooth** control button. The Bluetooth settings menu is shown in the MMI display.

### Switching Bluetooth on/off

The MMI Bluetooth function can be switched **On** or **Off**. The Bluetooth symbol  ⇒ fig. 78 appears in the MMI display when the function is switched on.

### Discovery mode

The visibility of the cell phone prep or cell phone can be switched **On** or **Off**. When auto is selected, the cell phone prep is visible to cell phones for approximately five minutes when the vehicle is stopped and the ignition key is inserted. The visibility switches off after that. However, it is still possible to establish a Bluetooth connection with cell phones that have already been paired when the visibility is switched off. The function should be switched off when the pairing process is complete so the cell phone prep is not visible to others.

### Find Bluetooth devices

The system searches for lists Bluetooth devices that are within range.

### Paired devices

Bluetooth devices that have been paired with the MMI are listed. The active connected Bluetooth device is identified with the Bluetooth symbol.

To delete paired Bluetooth devices individually, select the device and delete it with the **Delete device** function.

### Bluetooth name

The name of the vehicle cradle for your cell phone prep (such as “AUDI MMI 2613”) is displayed and can be changed.

### Delete Bluetooth devices

All paired cell phones can be deleted by confirming with **Yes**. ■

## Additional settings

Applies to vehicles: with cell phone prep

### Options during a call

Requirement: There must be an active phone call ⇒ *page 70*.

- Select the **Options** control button.

### Switching the microphone off and on

When the microphone is **Mute** the connected party cannot hear anything from your phone. However, you can hear your connected party. **Mute off** appears in the MMI display.

### Accepting another call

If another call comes in during an active call, the **Answer** and **Ignore** functions appear in the MMI display.

If you select **Answer**, the active call is put on hold and the incoming call is active. If you select **Ignore**, the incoming call will be ignored. ►

### Replacing a call

If a call comes in while you have an active call and another call on hold, the **Replace** and **Ignore** functions appear in the MMI display.

If you select **Replace**, the active call will be replaced with the incoming call. If you select **Ignore**, the incoming call will be ignored. A call on hold remains in queue.

The display in the MMI may still be visible for a few seconds depending on the cell phone in use. If you use the **Replace** or **Ignore** functions in the MMI while the display is still visible, the current telephone call will be ended.



#### Tips

The **Call waiting** function must be activated in your cell phone to be alerted to an incoming call during an active call. The call options depend on the cell phone and service provider. ■

Applies to vehicles: with cell phone prep **MMI high B8, for internal use only**

### Telephone settings

- Select the **TEL** function button > **SETUP** function button > **Telephone settings**.

#### Ring tone volume

You can increase (**Vol. -**) or decrease (**Vol. +**) the ring tone volume.

#### Call volume

The call volume can be adjusted. ■

Applies to vehicles: with cell phone prep

### Call options

- Select the **TEL** function button > **SETUP** function button > **Call options**.

### 3-way calling (GSM)

Up to six parties can participate in a conference call.

You begin a conference call with the **3-way calling (GSM)** option. The parties on hold and the active party are added to the conference call.

#### Auto redial

- **On** - a phone number will be redialed automatically up to five times if it is busy. Automatic redial can be cancelled with the **End call** function.
- **Off** - a phone number is *not* redialed if it is busy.

#### Auto answer

- **On** - An incoming call is answered automatically. This can be ignored with the **Ignore** function if the call was not answered automatically.
- **Off** - An incoming call is *not* answered automatically.

#### Invert call lists

The telephone numbers in the call lists are sorted according to the time they called. Switching this function on will sort them in the opposite order. ■

Applies to vehicles: with cell phone prep

### Voicemail number

- Select: **TEL** function button > **SETUP** function button > **Voicemail number**.

Enter the voicemail number with the speller or from a **List** (directory) and store with **OK**.

When a voicemail number is stored, the voicemail can be accessed with the **OO** symbol in the speller.

This service must be set up and activated in advance in the cell phone network. You can obtain more information from your cell phone service provider. ►

**Tips**

The mailbox number depends on the cell phone service provider. ■

**MMI high B8, for internal use only**

MMI components

MMI control panel

Multifunction steering wheel

Voice recognition system

## Navigating

### Introduction

*Let the “Global Positioning System” (GPS) lead you to your destination!*

Studying complicated maps, skimming through confusing atlases - that is all in the past! Now simply enter your desired destination in the navigation system and follow the directions given. Or you can navigate to your destination with up to nine stopovers.

The system provides directions in the form of spoken cues that inform you about all driving maneuvers early enough to perform them. In what language would you like to hear the navigation announcements? You can choose from English, French and Spanish. You can repeat the current navigation announcement by pressing the right thumbwheel on the multifunction steering wheel ⇒ *page 105*.

The route is shown on a map in the MMI High-Display ⇒ *page 86*. You can also display information about your route in the driver information system ⇒ *page 87*.

You do not want to follow one of the directions? No problem! The navigation system recalculates the route based on the current vehicle position. If when dynamic route is activated, the navigation system takes traffic reports into account so you can reach your destination more quickly.

The navigation system will notify you if your vehicle is in a location the system does not recognize (such as a parking lot or parking garage).

#### WARNING

- **The demands of traffic require your full attention. Refer to and follow the guidelines provided in ⇒ *page 7*, “Traffic safety tips”.**
- **Obey all traffic laws when driving.**

#### WARNING (continued)

- **The route calculated by the navigation system is a recommendation for reaching your destination. Obey traffic lights, stopping restrictions, one-way streets, lane change restrictions, etc.**

#### Note

- If the driving directions conflict with traffic laws, obey the traffic laws.
- Adjust the volume of the navigation system so signals from outside the vehicle such as police and fire sirens can be heard easily at all times.

#### Tips

- Snow and objects on the GPS antenna or shade from trees and large buildings can prevent satellite reception and affect the system's ability to determine the vehicle position. Several deactivated or malfunctioning satellites can also interrupt GPS reception and affect the system's ability to determine the vehicle position.
- When the vehicle is at an altitude above approximately 3000 meters, the MMI hard drive shuts down temporarily to protect it. Navigation mode and the Jukebox are not available when that happens. All of the MMI functions will be available again as usual once you start the engine again at a location below 3000 meters.
- Because street names sometimes change, the names stored in the MMI may in rare cases differ from the actual street name.
- Contact your authorized Audi dealer for information on updating the navigation information. ■



## Starting Navigation mode



Fig. 79 Entry field

Requirement: The MMI must be switched on ⇒ page 28.

- Press the **NAV** function button. The input field ⇒ fig. 79 or the last active navigation menu appears in the MMI display.

**MMI high B8, for internal use only**

The menu that was open the last time you used the navigation system is shown in the MMI display. Press the **NAV** function button again while in Navigation mode to switch to the input field.

### Tips

The navigation system can be opened in demo mode for simulations or planning purposes when the vehicle is stationary ⇒ page 94. ■

## Entering a destination

### Tips for entering a destination



Fig. 80 Entering the destination using the speller

#### Cities

When making an entry with the speller, the system suggest cities that you have entered in the past. The suggested city is shown in the speller input field ⇒ fig. 80. Additional cities that match your entry are listed below. The number of cities found is displayed at the bottom right **A** ⇒ fig. 80.

If the desired city is shown in the speller input field or the list below, you can press and hold the control knob to switch to the city list.

#### Street

You can also begin entering a destination with the street name. From the list of suggestions that follows, select a city in which you would like to enter a street or select the menu item **In all cities** to search for a streets independent of the location. When entering the street, the system suggests street names that match the entry.

After selecting the street, you can define the destination in detail by entering an **Intersection** or **House number**. ▶

### Points of interest in a city

By selecting a point of interest, you can select landmarks and public places (hospitals, movie theaters, recreation areas, etc.) as destinations.

### Downtown (end entry)

The navigation system calculates the route to the center of the city entered.

### Select destination on map

You can select a new destination from the map by moving the crosshairs horizontally, vertically or diagonally with the joystick ⇒ page 32 ⇒ page 81.



### Tips

Has your route or tour plan changed? No problem! Simply select the destination/stopover with the control knob and press the knob. You can now **Drive to this destination now** or **Change, Move or Delete** the destination/stopover. ■

MMI high B8, for internal use only

### Entering a destination with an address

*A single destination always consists of a region and city. You can pinpoint the destination more closely by entering a street name or point of interest.*



Fig. 81 Entering a house number/intersection

Requirement: Navigation mode must be active ⇒ page 79.

- If the input field ⇒ page 79, fig. 79 is not shown in the MMI display, press the **NAV** function button.
- Turn the control knob to **Region** and press the knob. A list of regions is displayed.
- Turn the control knob to select a region and press the knob to enter that region into the input field.
- Turn the control knob to **City/ZIP** and press the knob. The speller appears in the MMI display ⇒ page 31.
- Enter the city or ZIP code using the speller and confirm the entry with **OK**.
- To complete the entry, turn the control knob to **Downtown (end entry)** and press the knob, or ▶

- To enter additional information about the destination or to enter a stopover, turn the control knob to **Street** or **Point of interest in city** and press the knob.
- Entering additional information.
- To start route guidance, turn the control knob to **Start route guidance** and press the knob. The route criteria and then the map with three possible routes ⇒ *page 85*, *fig. 86* are shown in the MMI display.
- To select a route, turn the control knob to the left or right and press the knob.

To enter a house number or intersection after you have completed entering your destination, turn and press the control knob to select the line ① ⇒ *page 80*, *fig. 81* and complete your entry.



**Tips**

**MMI high B8, for internal use only**

To repeat the last navigation announcement, press the **Nav-Info** control button ⇒ *page 91* or the right thumbwheel on the multifunction steering wheel ⇒ *page 99*. ■

**Setting a destination from the map**

*A point on the map can be selected as a destination or stopover, stored in the directory or called up\*.*

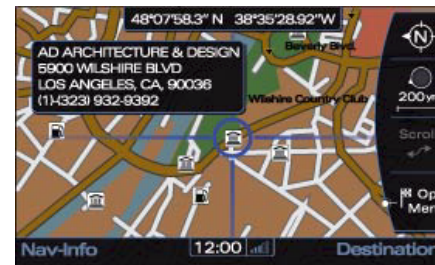

**Fig. 82** Changing the destination with the crosshairs



**Fig. 83** Setting a map location as the destination

Requirement: Navigation mode must be active ⇒ *page 79*.

- Press the **Map** control button. A map is shown in the MMI display.
- Slide the crosshairs ⇒ *fig. 82* horizontally, vertically or diagonally with the joystick to the desired destination ⇒ *page 32*.
- Press the control knob. The map side menu is activated. ▶

- Turn the control knob to **Opt. menu** and press the knob. The **Map position** menu is displayed.
- Turn the control knob to **Set as destination** and press the knob.
- Turn the control knob to **Set as single destination** or **Set as stopover** ⇒ *page 84* and press the knob.
- To start route guidance, turn the control knob to **Start route guidance** and press the knob. The route criteria and then the map with three possible routes ⇒ *page 85*, fig. 86 are shown in the MMI display.
- To select a route, turn the control knob to the left or right and press the knob.

If a destination is *not* present in the navigation data, you can move the crosshairs to the location of the desired city and set the geodata as a destination or add an entry in the address book.



#### Tips

- If you stop moving the crosshairs for a moment, additional information about the position of the crosshairs (such as city or street name if available) will be displayed.
- Turn the control knob to the left or right to increase or decrease the map scale in order to locate the desired destination more quickly with the crosshairs. ■

### Entering a point of interest

*Points of interest can be selected in the input field when entering single destinations. Six search categories are available.*

Requirement: Navigation mode must be active ⇒ *page 79*.

- Turn the control knob to **Point of interest** ⇒ *page 80*, fig. 81 and press the knob. A list with search categories for points of interest appears in the MMI display.
- Turn the control knob to **Top categories** for example and press the knob.
- Turn the control knob to a category such as **Next parking lot**.
- Press the control knob. A list, for example of parking lots, appears in the MMI display. Arrows indicate the direction and the distance from the vehicle to the point of interest.
- Turn the control knob to a point of interest that is displayed and press the control knob. Details about the point of interest are displayed.
- To set the point of interest as a destination, turn the control knob to **Set as destination** and press the knob.
- To start route guidance, turn the control knob to **Start route guidance** and press the knob. The route criteria and then the map with three possible routes ⇒ *page 85*, fig. 86 are shown in the MMI display.
- To select a route, turn the control knob to the left or right and press the knob.

Additional search categories are:

#### In immediate vicinity

The point of interest is within the immediate vicinity of the vehicle. Points of interest can be selected from various categories. This function is useful when planning stopovers.

#### In vicinity of destination

The point of interest is in the vicinity of a destination that has been entered. For example, you can find a hotel in the destination city with ►

MMI High 88, for internal use only

this function. Points of interest can be selected from various categories.

**In new city**

Enter the name of the city using the speller. You can either search for the point of interest by name or select it from various categories. This function is useful for searching for points of interest in a city independent from the destination.

**Nationwide**

You can either search for the point of interest by name or select it from various categories. The point of interest is independent from the vehicle position and navigation destination. For example, you can navigate to an airfield in the selected country using this function.

**i Tips**

- The points of interest in the **Top categories, In immediate vicinity** and **In vicinity of destination** search categories are sorted according to straight-line distance. The distance from the vehicle to the point of interest is updated automatically.
- When calculating the distance to a point of interest, the straight-line distance (empty arrow) is displayed first and then the actual driving distance (solid arrow). The points of interest are sorted according to straight-line distance from your current location.
- Some list entries cannot be displayed completely in the MMI display because they have too many letters/numbers. If you select these entries with the control knob, a separate window containing detailed information about the selected entry will open. ■

**Entering a destination from the memory**

Your previous destinations are stored automatically and be loaded directly as navigation destinations.



Fig. 84 Loading the last destination

Requirement: Navigation mode must be active ⇒ page 79.

- Press the **Memory** control button ⇒ fig. 84.
- Turn the control knob to **Last destinations** ⇒ fig. 84.
- Press the control knob. A list with the last destinations you entered appears in the MMI display.
- Turn the control knob to select a destination.
- Press the control knob. The destination data is set as a destination/stopover.
- To start route guidance, turn the control knob to **Start route guidance** and press the knob. The route criteria and then the map with three possible routes ⇒ page 85, fig. 86 are shown in the MMI display.
- To select a route, turn the control knob to the left or right and press the knob. ▶

**Tips**

The list of previous destinations can be erased ⇒ *page 94*. ■

### Entering a stopover

You can include up to nine stopovers and the end destination in the tour plan.



Fig. 85 Tour plan

Requirement: The Navigation mode must be started ⇒ *page 79*, a destination must be entered ⇒ *page 79* and the input field must be displayed ⇒ *page 79*, fig. 79.

#### Entering stopover with an address

- Turn the control knob to **Add stopover** and press the knob.
- Enter the stopover ⇒ *page 80*.
- Turn the control knob to **Set as stopover** and press the knob.
- To select the desired location in the tour plan, turn the control knob to the left or right and press the knob ⇒ fig. 85.

- To start route guidance, turn the control knob to **Start route guidance** and press the knob. The route criteria and then the map ⇒ *page 86* are displayed in the MMI display.

#### Setting a stopover from the map

- Press the **Map** control button. A map is shown in the MMI display.
- Select a stopover in the map ⇒ *page 81*, fig. 82.
- Turn the control knob to **Set as stopover** and press the knob.
- To select the desired location in the tour plan, turn the control knob to the left or right and press the knob ⇒ fig. 85.
- To start route guidance, turn the control knob to **Start route guidance** and press the knob. The route criteria and then the map ⇒ *page 86* are displayed in the MMI display.

#### Setting a stopover from the memory

- Turn the control knob to **Add stopover** and press the knob.
- Select a destination from the list of the last destinations you entered ⇒ *page 83*.
- Press the control knob. The destination data is set as the stopover.
- To select the desired location in the tour plan, turn the control knob to the left or right and press the knob ⇒ fig. 85.
- To start route guidance, turn the control knob to **Start route guidance** and press the knob. The route criteria and then the map ⇒ *page 86* are displayed in the MMI display. ►

To delete all stopovers from the tour plan, turn the control knob to **Enter single destination** and confirm the message in the MMI display with **Yes**.

**i** **Tips**

Has your route or tour plan changed? No problem! Simply select the destination/stopover with the control knob and press the knob. You can now **Drive to this destination now** or **Change, Move** or **Delete** the destination/stopover. ■

**Alternative route**

Select your preferred route to a single destination from up to three suggested routes.



Fig. 86 Suggested routes

The route highlighted after switching to the map display is the route that was calculated according to the route criteria you selected ⇒ page 91. For example, if you have selected **Short** in the **Route options** menu, the shortest route is highlighted. If possible, three alternative routes with the same route criteria will be offered for your selection.

The suggested routes and your criteria are displayed in the route side menu in the MMI display.

Information applicable to the route you have selected is highlighted in white:

- Distance to the destination and calculated arrival time
- Symbols for using highways, toll roads or ferries on the planned route

You can select the possible routing in the alternative routes by turning and pressing the control knob.

**i** **Tips**

The routes may overlap if there are only a few routes available to the destination. ■

**Stopping route guidance**

Requirement: Route guidance must be active ⇒ page 79.

- Press the **NAV** function button, or
- Press the **Dest.** control button.
- Turn the control knob to **Stop route guidance** and press the knob.

You can also stop route guidance by entering a new destination ⇒ page 80.

**i** **Tips**

The data and settings remain entered when route guidance is stopped. ■

## Display

### In the MMI display



Fig. 87 Map with inactive side menu

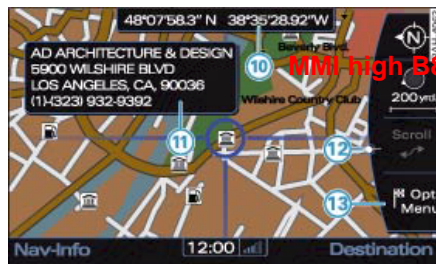

Fig. 88 Map with active side menu

If you press the **Map** control button once route guidance has started, the map with inactive side menu ⇒ fig. 87 will appear in the MMI display.

In this view, you can turn the control knob to the right or left to increase or decrease the map scale. You can move the crosshairs in the map with the joystick to select a city ⇒ page 32.

Press the control knob to activate the side menu ⇒ fig. 88. You can now change the map display in the side menu. Turn the control knob to the desired location and press the knob.

Press the **(RETURN)** button to leave the side menu.

- ① Direction. The map is either oriented to the **north** or according to the **dir. of travel** ⇒ page 92. You can switch between north and the direction of travel by selecting the direction in the active side menu and pressing the control knob. This setting is saved.
- ② Scale. Turn the control knob to the left or right to decrease or increase the scale. You can also change the scale in the active side menu.
- ③ Distance to destination/stopover
- ④ Calculated arrival time to the destination/stopover
- ⑤ TMC status display
- ⑥ Altitude display
- ⑦ **Dest.** control button. Change to input field ⇒ page 79, fig. 79 or the tour plan ⇒ page 84, fig. 85.
- ⑧ Examples of selected map contents
- ⑨ Vehicle location
- ⑩ Display of the geocoordinates where the crosshairs are located (latitude and longitude)
- ⑪ If you select the map content with the crosshairs, available information such as the address, telephone number or traffic reports will be displayed.
- ⑫ Move along the route. This function can be used while route guidance is active. Turn the control knob to the left or right to move the map along the current route.
- ⑬ Map location menu. The location of the crosshairs can be set at the destination or stopover, stored in the directory or called up ⇒ page 81. The geocoordinates (latitude and longitude) of the crosshairs are displayed.

### **i** Tips

You can choose between four map types ⇒ page 92. ■



**In the driver information system**



Fig. 89 Lane display



Fig. 90 Turn display

Once you have entered a destination or tour and started route guidance, the navigation information will be displayed in the driver information system. If you select another function such as the radio with the multifunction steering wheel, the navigation will be replaced with the selected function => page 98.

- ① Distance until change of direction
- ② Calculated arrival time
- ③ Total mileage to the destination/stopover
- ④ Name of the current highway or street. An arrow in front of the street name indicates that you should turn onto that street.

- ⑤ Maneuver arrow. An upcoming turn is also indicated.
- ⑥ Bar graph. A bar graph appears when a direction arrow is displayed. The fewer bars are shown, the shorter the distance is until the turn.

**! WARNING**

The route calculated by the navigation system is a recommendation for reaching your destination. Obey traffic lights, stopping restrictions, one-way streets, lane change restrictions, etc.

**i Tips**

An exclamation mark “!” in front of the street name indicates that the information about this street or this section of the route is not complete in the navigation data that the MMI contains. Obey traffic laws such as one-way streets or pedestrian zones. ■

MMI high B8, for internal use only

**Storing a destination**

**In the directory (single destination)**

A single destination can either be stored as a new address car or assigned to an existing one.



Fig. 91 Address card ▶

Requirement: You must enter a single destination  
⇒ *page 79*.

#### Storing a destination as a new address card

- Press the **Memory** control button.
- Turn the control knob to **Store in directory** and press the knob.
- Turn the control knob to **New entry** and press the knob. An input field appears ⇒ *page 87*, fig. 91.
- Turn the control knob to **Name** and press the knob. The speller appears in the MMI display ⇒ *page 31*.
- Enter the name with the speller.
- Enter additional data.
- Turn the control knob to **Store entry** and press the knob.

#### Assigning the destination to an existing address card

- Press the **Memory** control button.
- Turn the control knob to **Store in directory** and press the knob.
- To assign the destination to an address card, turn the control knob to an entry, or
- Turn the control knob to **Find entry** and press the knob to search for an address card. The speller appears in the MMI display ⇒ *page 31*.
- Enter the name of the entry you would like to search for, or
- Turn the control knob in the speller to **LIST** and press the knob. All stored directory entries are listed.

- Turn the control knob to the desired entry and press the knob. The address card opens.
- Turn the control knob to **Store entry** and press the knob.

If you have already stored a destination for an existing address card, the new destination automatically overwrites the old destination.

Check the box for the **display as top destination** function to access the destination quickly. Top destinations are listed in the input menu ⇒ *page 79*, fig. 79 and can be selected there directly.



#### Tips

- You can use the **Edit directory** function to access the address card to enter more information ⇒ *page 63*.
- For information on managing the directory, refer to ⇒ *page 57*. ■

#### Storing a tour plan

*Tour plans can be stored and loaded later as a new navigation destination.*

Requirement: You have entered a tour plan ⇒ *page 79*.

- Press the **Memory** control button.
- Turn the control knob to **Store tour plan**.
- Press the control knob. The speller appears in the MMI display ⇒ *page 31*.
- Enter a name for the tour plan using the speller.
- Select **OK** in the speller and press the control knob. The tour plan entered is stored.

If the **Store tour plan** function is *grayed out*, either the tour memory is full or no tour plan was entered. Please delete any tours you do not need from the memory ⇒ *page 90* or enter a tour plan. ■

## Loading a destination

### Loading from the directory



Fig. 92 Loading a destination from the directory

Requirement: Navigation mode must be started ⇒ page 79 and a navigation destination must be stored in the directory ⇒ page 63.

**MMI high B8, for internal use only**

- Press the **Memory** control button.
- Turn the control knob to **Load from directory**.
- Press the control knob. A list of entries appears in the MMI display ⇒ fig. 92.
- To select a destination from the list, turn the control knob to an entry and press the knob, or
- Turn the control knob to **Find entry** and press the knob to search for an entry. You can now search for a name using the speller.

- To start route guidance, turn the control knob to **Start route guidance** and press the knob. The route criteria and then the map ⇒ page 86 with three possible routes ⇒ page 85, fig. 86 are shown in the MMI display. An arrow appears in the driver information system.
- To select a route, turn the control knob to the left or right and press the knob. ■

### Loading a tour plan

*Stored tour plans can be loaded as a new navigation destination.*

Requirement: Navigation mode must be started ⇒ page 79 and a tour must be stored ⇒ page 88.

- Press the **Memory** control button.
- Turn the control knob to **Load tour plan**.
- Press the control knob. A list of entries appears in the MMI display.
- To select a tour from the list, turn the control knob to an entry and press the knob, or
- To start route guidance, turn the control knob to **Start route guidance** and press the knob. The route criteria and then the map ⇒ page 86 are displayed in the MMI display. ■

### Display traffic reports in the map

Traffic reports can be displayed in the map.

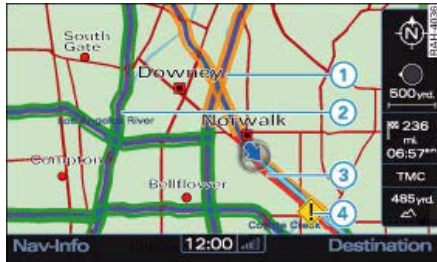

Fig. 93 Traffic reports display in the map

Requirement: Navigation mode must be active ⇒ page 79.

- Press the **SETUP** function button.
- Turn the control knob to **Map** and press the knob.
- Turn the control knob to **Traffic information** and press the knob.

The traffic information is displayed in the map with colored lines:

- ① orange lines: slow traffic
- ② green lines: free flow traffic
- ③ red lines: stop and go

A colored warning symbol ④ in the map indicates there is a traffic incident directly ahead.

In addition to traffic reports, you can also display (✓) or hide additional information such as expressway exits, 3D landmarks or restaurants in the map. ■

### Additional settings

#### Top destination

- Select: the **NAV** function button.

You can activate the **Display as top destination** function (✓) when storing a navigation destination in the directory. Top destinations are displayed at the end of the input field ⇒ page 79, fig. 79 and can be selected directly when entering a destination. ■

#### Store current position

- Select: **NAV** function button > **Memory** control button > **Store current position**.

The current vehicle position is added to a new/existing entry in the directory. ■

#### Deleting a tour plan

- Select: **NAV** function button > **Memory** control button > **Delete tour plan**.

Stored tour plans can be deleted individually. ■

#### Route list

- Select: **NAV** function button > **Route** control button > **Route list**.

The route list is only visible when route guidance is active. It contains the following information: ►

- Information on the route characteristics
- Length of the route sections
- Street names

On longer route sections, additional information may be displayed such as possible junctions when driving on highways. ■

### Route criteria

- Select: **NAV** function button > **Route** control button > **Route criteria**.

The route is calculated based on various criteria.

### Alternative routes

The option to select from up to three suggested routes to a single destination can be switched on (✓) or off.

### Dyn. route

**MMI high B8, for internal use only**

When dynamic route is switched on, the route is adapted automatically<sup>2)</sup> according to traffic conditions.

If the system does not calculate a detour even though you have selected Dynamic route **on** and a traffic jam was reported on the calculated route, then the detour the system calculated would take more time than the time spent waiting in the traffic jam.

### Route options

You can select a **short**, **fast** or **economical** route.

### Highway/Toll road/Ferry

Select the **avoid** option if the navigation system should not include expressways, toll roads or ferries when calculating a route.

<sup>2)</sup> Only with a valid SDARS subscription.



### Tips

If avoiding a criterium makes route guidance impossible, that criterium will still be used when calculating the route. ■

### Avoiding a route

- Select: **NAV** function button > **Route** control button > **Avoid route from here**.

When route guidance is active, the calculated route will avoid the area you have specified. The navigation system calculates an alternative route.

You can adjust the length of the route to be avoided by turning the control knob.

When you restart route guidance, the area to be avoided must be entered again if you would still like to avoid it.



### Tips

If the MMI does not calculate an alternative route, that means one is not available. ■

### Information

- Select: **NAV** function button > **Nav-Info** control button.

When route guidance is active, you will receive the following information about your destination:

- Receivable satellites
- Data about the vehicle location: current street, data about the geographical location of the vehicle (latitude and longitude, altitude)
- Destination city/stopovers

- Calculated arrival time to the destination/stopover
- Distance to destination/stopover

The last navigation announcement is repeated.

#### Calling: (telephone number)\*

If telephone numbers for a point of interest are stored in the MMI navigation data and your vehicle is equipped with a *factory installed* telephone\*, you can call the selected point of interest. For example, you can make reservations at a restaurant before you reach your destination. ■

### Map display

- Select: **NAV** function button > **SETUP** function button > **Map display**.

#### Day

The map is displayed with a light background.

#### Night

The map is displayed with a dark background.

#### Auto

The map display changes from day to night when the headlights are switched on. ■

### Orientation

- Select: **NAV** function button > **SETUP** function button > **Orientation**.

#### North<sup>3)</sup>

The map is oriented to the north.

#### Dir. of travel

The map is oriented to the direction of travel. At a scale of 100 km, the map is oriented to the north.

#### Auto

At a scale up to 1.5 miles (2.41 km), the map is oriented to the direction of travel. At a scale greater than 1.5 miles (2.41 km), the map is oriented to the north. ■

### Map type

- Select: **NAV** function button > **SETUP** function button > **Map type**.

#### Destination

The destination is marked with a destination flag. The map indicates the destination is oriented to the north.

#### Position 2D

The current vehicle position is displayed. The map orientation corresponds to the setting in the **Orientation** menu ⇒ *page 92*.

#### Position 3D

The current vehicle position is displayed in a three-dimensional terrain map. The **Dir. of travel** orientation is automatically selected ⇒ *page 92*. The map orientation is set to **North** when the scale is 100 km or greater. At a scale between 30 - 100 m, the display will show three-dimensional city models and landmarks. ►

<sup>3)</sup> Only possible in the 2D map type display

**Overview**

The entire route from the vehicle location to the destination is displayed on the map. The map scale depends on the length of the route. The map is oriented to the north. ■

**Automatic zoom**

- Select: **NAV** function button > **SETUP** function button > **Autom. zoom**.

When automatic zoom is switched on, the map automatically zooms to the intersection. This provides a detailed display and makes it easier to recognize the streets. The map is oriented to the direction of travel when it is zoomed in. The three-dimensional city model is hidden for a short time. ■

**Additional information**

- Select: **NAV** function button > **SETUP** function button > **Addit. info**.

**On**

The **Route** and **Exit** information is displayed on the map.

**Route**

Information on upcoming maneuvers or traffic reports are displayed in the left half of the map. The right half of the map continues to show the map display you have selected.

**Exit**

The left half of the map contains a window that shows expressway exits. The right half of the map continues to show the map display you have selected. Parallel to this, the window also shows an enlarged view of the intersection area.

The updated distance to the turn is displayed next to the enlarged view. The name of the street you will turn onto, the street number and/or name of the exit and the direction of travel are also displayed at the same time.

**Off**

No additional info is shown in the MMI display. ■

**Voice guidance**

- Select: **NAV** function button > **SETUP** function button > **Voice guid..**

The navigation announcements in the navigation mode can be **Complete** or **Compact**.

With **off**, only *important* announcements are played during route guidance. You can press the right thumbwheel (4) ⇒ page 98, fig. 95 to play a navigation announcement. ■

**Spoken cues (phone)**

- Select: **NAV** function button > **SETUP** function button > **Spoken cue**.

With the **Off (phone)** setting, navigation announcements play during route guidance but they do *not* play during a phone call. ■

**Volume of spoken cues**

- Select: **NAV** function button > **SETUP** function button > **Volume of spoken cues**. ▶

MMI high B8, for internal use only

Turn the control knob to the left or right to adjust the volume of the navigation announcements. Press the control knob to leave the menu. ■

### Presentation mode

---

- Select: **NAV** function button > **SETUP** function button > **Set starting point** or **Demo mode**.

You enter a starting point manually when you would like to calculate a route starting from a location other than the vehicle position, for example. Start demo mode to simulate route guidance. The demo mode helps you effectively plan and display a route by showing map contents or route criteria.



#### Tips

Route simulation guidance in demo mode is only displayed when the vehicle is stationary for safety reasons. ■

MMI high B8, for internal use only

### Deleting last destinations

---

- Select: **NAV** function button > **Memory** control button > **Delete last destinations**.

The destinations you have entered last are automatically stored ⇒ *page 83*. They can be deleted individually or all at once. ■



## Calling up traffic information

Applies to vehicles: with Satellite Digital Audio Radio Service

### Introduction

TMC traffic reports can be shown in the MMI display through Sirius\* (satellite radio) ⇒ page 41. This happens automatically and silently. Even more practical is the fact that the MMI uses these messages when dynamic route is switched on to navigate around traffic problems such as traffic jams, when possible ⇒ page 91.

Traffic report reception is indicated by the **TMC** symbol in the title line in the Navigation and Info modes:

TMC symbol	Explanation
The TMC symbol is displayed	TMC stations are available and dynamic navigation is switched <b>on</b> ⇒ page 91.
The TMC Symbol is crossed out	TMC stations are not available and dynamic navigation is switched <b>on</b> .
No TMC symbol	Dynamic navigation is switched <b>off</b> .

Applies to vehicles: with Satellite Digital Audio Radio Service

### Calling up TMC traffic reports

The TMC traffic reports are sorted according to the distance from the current position. Traffic reports for an active route are displayed first.



Fig. 94 Calling up traffic reports

- Press the **INFO** function button.
- Turn the control knob to an entry.
- Press the control knob. A detailed view is displayed.
- To call up the next traffic report in the detailed view, turn the control knob to **Next message** and press the knob.

When route guidance is active, traffic reports that affect your route are displayed in order based on distance and marked with a colored symbol ① ⇒ fig. 94. A traffic incident that is immediately ahead is displayed first.

All remaining traffic reports are listed last with a grayed-out symbol and sorted according to straight-line distance from the current position ② ⇒ fig. 94.

Traffic reports that are especially important such as a driver driving the wrong way are displayed automatically in the MMI display. Press the **(RETURN)** button or the control knob to cancel the report.

When route guidance is deactivated, traffic reports are displayed with a colored symbol and sorted according to distance from the current position.

**Tips**

To use the traffic message channel (TMC), you must contract the Sirius\* service provider ⇒ *page 41*. ■

**MMI high B8, for internal use only**

**MMI high B8, for internal use only**

MMI components

MMI control panel

Multifunction steering wheel

Voice recognition system

## General operation

### Introduction

You can call up and control the MMI functions such as Navigation, Telephone\*, Radio, Media or the voice recognition system with the multifunction steering wheel.



Fig. 95 Controls on the multifunction steering wheel.



Fig. 96 Display in the driver information system

With the multifunction steering wheel, you can control selected functions of the active audio source, telephone\* or navigation with active route guidance without taking your hands off the wheel. It's very convenient!

The functions are shown in the driver information system ⇒ fig. 96. You can also switch the voice recognition system on and off and change the volume with the multifunction steering wheel.

It is operated by pressing and rolling the buttons ① to ④ ⇒ fig. 95.

- Pressing the **MODE** ② button multiple times changes between navigation, the telephone\* and the active audio source. The function is also displayed in the driver information system ⇒ fig. 96. You can exit the submenu for the active function by pressing the **MODE** button.
- You can select a submenu for the active function by rolling the left thumbwheel ①.
- The voice recognition system is activated by pressing the Talk button ③. Pressing and holding the Talk button again ends the dialogue.
- Rolling the right thumbwheel ④ up/down increases/decreases the volume.

#### Tips

- You can switch the navigation display off with the reset button on the windshield washer stalk. Comprehensive information on this topic can be found in the Owner's Manual of your vehicle.
- The trip computer is also displayed in the driver information system. Comprehensive information on this topic can be found in the Owner's Manual of your vehicle. ■

## Adjusting the volume

You can change the volume of the active audio source and the navigation announcements with the multifunction steering wheel.

Requirement: The MMI must be switched on ⇒ page 28.

### Increasing and decreasing the volume

- Roll the right thumbwheel ④ ⇒ page 98, fig. 95 up/down.

### Muting

- To mute the MMI, roll the right thumbwheel ④ down until a speaker symbol with a line through it appears in the status line in the MMI display. If the drive is active, it will be stopped.
- Roll the right thumbwheel up to deactivate the mute or pause function. The drive that was stopped will start playing again.

MMI high B8, for internal use only

### Navigation announcements

- Press the right thumbwheel ④. The last navigation announcement is repeated.
- To change the volume, roll the right thumbwheel ④ up or down while an announcement is playing. ■

## Listening to the radio

### Selecting the radio



Fig. 97 Frequency band list

Requirement: The radio is on ⇒ page 41.

- Press the **[MODE]** button ② ⇒ page 98, fig. 95 until the radio menu appears in the driver information system ⇒ fig. 97.

For detailed information about the radio function, refer to ⇒ page 40. ■

### Selecting the frequency band

The three frequency bands FM, AM and Sirius\* (satellite radio) are displayed in the title line of the driver information system.

Requirement: The radio menu is displayed ⇒ page 99.

- Roll the left thumbwheel ① ⇒ page 98, fig. 95 down to a frequency band.
- Press the left thumbwheel to select the frequency band. ■

### Selecting a station from the station list



Fig. 98 Radio menu

Requirement: The radio menu is displayed ⇒ fig. 98.

- Roll the left thumbwheel ① ⇒ page 98, fig. 95 down/up to a radio station.
- Press the left thumbwheel to select the station. ■

MMI high B8, for internal use only

### Selecting a stored station

Requirement: The radio menu is displayed ⇒ fig. 98 and a station is stored in the preset list ⇒ page 45.

- Roll the left thumbwheel ① ⇒ page 98, fig. 95 to **Memory**.
- Press the left thumbwheel. The preset list is displayed.
- Roll the left thumbwheel to a radio station and press the left thumbwheel. The radio station is selected. ■

## Playing media

### Calling up media



Fig. 99 Track list

Requirement: The selected source must contain audio files.

- Press the **[MODE]** button ② ⇒ page 98, fig. 95 repeatedly until a track list ⇒ page 101, fig. 101 or folder structure ⇒ page 49 appears in the driver information system.

For detailed information about the media function, refer to ⇒ page 48.

#### **i** Tips

Select an audio source or a CD in the CD changer\* through the MMI control panel ⇒ page 15. ■

### Selecting a folder



Fig. 100 Jukebox folder structure

Requirement: A folder must be displayed ⇒ fig. 100.

- Roll the left thumbwheel ① ⇒ page 98, fig. 95 to a folder ⇒ fig. 100.
- Press the left thumbwheel to select the folder.

MMI high B8, for internal use only

#### Tips

- To move to the next highest level, turn the left thumbwheel to the folder **Go up** ⇒ fig. 101 and press the thumbwheel.
- You can scroll through long lists of folders quickly by turning the control knob quickly. The scrolling speed depends on the number of folders. ■

### Selecting a track



Fig. 101 Track list

Requirement: Tracks must be displayed ⇒ fig. 101.

- Roll the left thumbwheel ① ⇒ page 98, fig. 95 to a track ⇒ fig. 101.
- Press the left thumbwheel to select the track.

#### Tips

You can scroll through long lists of tracks quickly by turning the control knob quickly. The scrolling speed depends on the number of tracks. ■

### Pausing/resuming playback

Requirement: And audio file must be playing ⇒ page 48.

- Turn the right thumbwheel ④ ⇒ page 98, fig. 95 all the way down to pause playback.
- Turn the right thumbwheel all the way up to resume playback. ■

## Calling

Applies to vehicles: with cell phone prep

### Introduction

Calling in the vehicle has become an everyday activity. You can operate all of the relevant telephone functions safely and easily using the multifunction steering wheel.

The following messages could appear in the driver information system:

<b>Please wait ...</b>	The connection between the MMI and the paired cell phone is being established.
<b>No connection</b>	There is no connection to the phone network.
<b>Call</b>	There is an incoming call. The caller's phone number will also be displayed if it was transmitted.
<b>Busy</b>	The number dialed is busy.
<b>Automatic redial</b>	The last number dialed is dialed again automatically after a brief waiting period.
<b>Telephone is switched off</b>	The telephone is switched off.
<b>Connecting</b>	The connection is established.
<b>End call</b>	The connection has ended.
<b>No entries available</b>	The directory does not contain any entries or the entries have not been read into the MMI.
<b>Please connect phone</b>	The telephone is not connected with the vehicle.

Would you like to learn more about operating the telephone in your vehicle? You will find a detailed description in ⇒ [page 69](#).

### Tips

- The telephone functions can only be controlled on the multifunction steering wheel if the telephone equipment was installed *at the factory*.
- The telephone functions depend on the cell phone and whether they are supported by your cell phone service provider or not. Refer to [www.audiusa.com/bluetooth](http://www.audiusa.com/bluetooth) ([www.audicanada.ca/technology](http://www.audicanada.ca/technology)) for compatible phone list. ■

Applies to vehicles: with cell phone prep

### Selecting telephone



Fig. 102 Telephone menu

Requirement: The cell phone package ⇒ [page 22](#) has been activated.

- Press the **(MODE)** button until the Telephone menu appears in the driver information system ⇒ [fig. 102](#).

The following options are shown in the telephone menu:

- Directory: contains the MMI directory entries ⇒ [page 57](#). ▶



- Dialed numbers: contains the telephone numbers dialed most recently.
- Missed calls: contains the most recent calls not received.
- Received calls: contains the most recently received calls.

You can dial the selected phone number directly from the call lists. Press the **(MODE)** button **(2)** to close an open call list. ■

Applies to vehicles: with cell phone prep

### Dialing a phone number and ending a call

Phone numbers stored in the directory and in the call lists can be dialed.



Fig. 103 List of directory entries

Requirement: The Telephone menu is displayed ⇒ page 102, fig. 102.

#### Calling

- Roll the left thumbwheel **(1)** ⇒ page 98, fig. 95 to **Dialed numbers, Directory, Missed calls** or **Received calls** ⇒ page 102, fig. 102.
- Press the left thumbwheel. A list with entries appears in the driver information system ⇒ fig. 103.

- Roll the left thumbwheel to an entry and press the left thumbwheel.

#### Making another call

- Roll the left thumbwheel **(1)** ⇒ page 98, fig. 95 to **Hold** and press the left thumbwheel. The phone call is placed on hold.
- Press the **(MODE)** button **(2)** ⇒ page 98, fig. 95 until the Telephone menu ⇒ page 102, fig. 102 is displayed in the driver information system.
- Roll the left thumbwheel either to one of the call lists or the **Directory** and press the left thumbwheel ⇒ fig. 103. A list with entries appears in the driver information system.
- Roll the left thumbwheel to the entry and press the left thumbwheel. All telephone numbers stored for that entry are displayed.
- Roll the left thumbwheel to a phone number and press the left thumbwheel. The phone call is made and the active audio sources is muted.

#### Ending a call

- Roll the left thumbwheel to **End call** and press the left thumbwheel.

If several phone numbers are stored in a directory entry, the list with stored numbers is displayed first when the entry is selected. Roll the left thumbwheel **(1)** to the desired phone number and press the left thumbwheel.

When you have ended an active call, the call on hold remains on hold. Select **Resume** and press the left thumbwheel to resume the call on hold. ▶

### Tips

- The multifunction steering wheel can only be used to dial stored telephone numbers. Enter a new phone number using the MMI speller ⇒ *page 70* or the voice recognition system ⇒ *page 110*.
- The telephone functions depend on the cell phone service provider and the cell phone you are using. You can obtain more information from your cell phone service provider.
- If you activate **Off (phone)** while in navigation mode, navigation announcements will not play during a call ⇒ *page 93*.
- You can scroll through the directory entries quickly in blocks by rolling the left thumbwheel. ■

Applies to vehicles: with cell phone prep

### Answering/ignoring a call



Fig. 104 Incoming call

Requirement: There must be an incoming call ⇒ fig. 104.

### Answering a call

- Roll the left thumbwheel  ⇒ *page 98*, fig. 95 to **Answer** and press the left thumbwheel.

### Ignoring a call

- Roll the left thumbwheel to **Ignore** and press the left thumbwheel.

The *Name, Phone number* or **Unknown** appears in the driver information system display depending on whether the caller has been stored in the directory and if the phone number has been transmitted. ■

Applies to vehicles: with cell phone prep

### Options during a call

When there is an incoming call during an active phone call, the **Replace** and **Ignore** functions appear in the driver information system.

If you select **Replace**, the active call will be replaced with the incoming call. If you select **Ignore**, the incoming call will be ignored. A call on hold remains in queue.

### Tips

The **Call waiting** function must be activated in your cell phone to be alerted to an incoming call during an active call. The call options depend on the cell phone and service provider. You can obtain more information from your cell phone service provider. ■

## Navigating

### Calling up navigation



Fig. 105 Navigation in the driver information system

Requirement: Navigation mode must be active ⇒ page 79.

- Press the **MODE** button ② ⇒ page 98, fig. 95 until navigation appears in the driver information system ⇒ fig. 105.

For detailed information about the navigation function, refer to ⇒ page 78.

#### Tips

You can switch the navigation display off with the reset button on the windshield washer stalk. Comprehensive information on this topic can be found in the Owner's Manual of your vehicle. ■

### Repeating navigation announcements

- Press the right thumbwheel ④ ⇒ page 98, fig. 95 to repeat the last navigation announcement. ■

## Name tag

### Switching the voice recognition system on and off

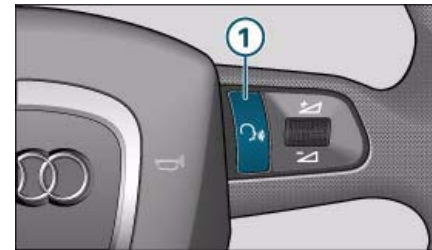

Fig. 106 Multi-function steering wheel: Talk button

#### Switching on

- Press button ① ⇒ fig. 106.

#### Switching off

- Press and hold the button until the message **Cancel** plays.

The input signal **Beep** plays when the system is ready for dialogue. Then the desired functions can be selected using voice commands ⇒ page 107.

#### Tips

For a detailed description of the voice recognition system, refer to ⇒ page 107. ■

**NAVIGATION**

- ENTER DESTINATION
- NAVIGATE TO (XY)
- LAST DESTINATIONS
- ENTER COUNTRY
- ENTER ZIP / CITY
- ENTER CENTERz
- ENTER STREET
- ENTER HOUSE NUMBER
- ENTER INTERSECTION
- START / CANCEL ROUTE GUIDANCE
- ENTER STREET IN VICINITY
- SHORT / FAST / ECON. ROUTE
- DYNAMIC ROUTE GUIDANCE ON / OFF
- ROUTE LIST
- VOICE GUIDANCE ON / OFF
- ENTER POINT OF INTEREST
- NEXT GAS STATION
- NEXT DIESEL GAS STATION
- NEXT PARKING LOT
- NEXT RESTAURANT
- NEXT ACCOMMODATION
- NEXT HOSPITAL
- NEXT AUDI DEALER
- NEXT POLICE STATION
- NEXT ATM
- NEXT COFFEE SHOP

**MAP**

- MAP ON / OFF
- POSITION 2D / 3D MAP
- DAY / NIGHT MAP
- DESTINATION / OVERVIEW MAP
- SCALE (XY) KM / METRE / MILE / YARD

**NAVIGATION**

- NAVIGATION
- TELEPHONE
- DIRECTORY
- ENTER DESTINATION
- NAVIGATE TO (XY)
- CANCEL ROUTE GUIDANCE
- MAP
- CALL (XY)
- DIAL NUMBER
- REDIAL

**GLOBAL COMMANDS**

- HELP
- HELP VOICE RECOGNITION
- HELP NAVIGATION
- HELP TELEPHONE
- HELP DIRECTORY
- HELP MAP

**DIRECTORY**

- CALL (XY)
- NAVIGATE TO (XY)
- FIND ENTRY
- STORE NAME
- READ NAME

**TELEPHONE**

- DIAL NUMBER
  - CORRECT / DELETE NUMBER
  - REPEAT
  - DIAL
- REDIAL
- CALL (XY)
  - (BUSINESS / PRIVATE / LAND LINE / CELL)
- RECEIVED CALLS
- DIALED NUMBERS
- MISSED CALLS

MMI high B8, for internal use only

Fig. 107 Voice recognition system command overview

## Voice recognition system

### Introduction

*You can control many MMI functions through the voice recognition system.*

With the voice recognition system, you can switch between the various modes easily by voice, for example for Navigation to Telephone\*. In conjunction with hands-free operation it is not necessary to pick up the cell phone. The voice recognition system recognizes commands and numbers regardless of the speaker.

Individual training improves the recognition function of the voice recognition system by adapting it to your voice or pronunciation ⇒ *page 38*.

The voice recognition system automatically creates a name tag for each entry in the directory. Using the voice recognition system, you can select the private or business address for a navigation destination or call up the entry. You can also access other functions: you can call up call lists, view the route list for a destination or show the map view in the MMI display ⇒ *page 112*.

It is okay if you do not know a particular command. Simply say the command **HELP** when the voice recognition system is switched on. The system will tell you the commands that are possible at that time or give you a tip ⇒ *page 108*. For the most important voice recognition system commands, refer to the command overview ⇒ *page 106*, fig. 107.

In which language would you like to use the voice recognition system? You can choose from English, French and Spanish ⇒ *page 38*.

#### For the system to understand you

- Speak clearly and distinctly at a normal volume. Speak louder when there is loud ambient noise.
- Pronounce the commands evenly and do not leave long pauses.

- Do not speak a command when the voice recognition system is making an announcement.
- Close the doors, the windows and the sunroof\* to reduce ambient noise. Make sure that passengers are not speaking when you are giving a voice command.
- Do not direct the air vents toward the hands-free microphone that is close to the front interior lights.
- Only use the system from the driver's position since the hands-free microphone is oriented toward that position.

#### Unrecognized voice commands

The systems reacts to your input with audible feedback. If a voice command is not recognized, the system asks **Pardon?** and asks you to repeat the command. After the third unsuccessful attempt, you will hear the message **Cancel** and the dialog ends.

#### WARNING

- **Please devote your full attention to driving. As the driver, you have complete responsibility for safety in traffic. Only use the functions in such a way that you always maintain complete control over your vehicle in all traffic situations.**
- **Do not use voice recognition in emergencies because your voice may change in stressful situations. It may take longer to dial the number or the system may not be able to dial it at all. Dial the emergency number manually. ■**

## General operation

### Switching on and off

You can switch the voice recognition system on and off with the multifunction steering wheel.

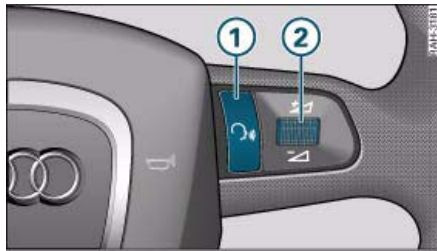



Fig. 108 Talk button and right thumbwheel

Requirement: The ignition must be switched on ⇒ page 28, the A/C system must not be activated and you must not have a phone call in progress.

- Press the Talk button  ① ⇒ fig. 108 on the multifunction steering wheel briefly to switch the voice recognition system on. The input signal **Beep** indicates that the voice recognition system is ready. The status symbol ① ⇒ fig. 109 appears in the MMI display. An active audio source is muted.
- Say the desired command.
- To switch the voice recognition system off, speak the command **CANCEL**, or
- Press the Talk button  ① ⇒ fig. 108 and hold it down until you hear the message **Cancel**.

You can shorten a message by pressing the talk button and speaking a new command.

### Tips

- You can also deactivate the voice recognition system by pressing any button on the MMI control panel in the center console ⇒ page 29.
- Traffic announcements do not play during the dialog.
- The dialog stops when there is an incoming phone call and will continue if you ignore the call. The dialog is cancelled if you answer the call. ■

### Operating the system



Fig. 109 Help texts in the MMI display



Fig. 110 Selecting an entry from the list

### Commands

The voice recognition system uses two types of commands:

- Commands for the active mode such as **LAST DESTINATIONS** in the **Navigation** mode
- Global commands (regardless of mode) such as **NAVIGATION**

The command overview ⇒ page 106, fig. 107 provides an overview of the most important voice recognition system commands.

### Selecting an entry from a list

The entries in a list such as missed calls, directory entries, street names, etc. are shown in the MMI display with item numbers ⇒ fig. 110. You can select a line by saying the line number, such as **LINE FOUR** or repeating one of the entries shown in the MMI display. You can also select a line through the MMI control panel by turning the control knob to an entry and pressing the knob.

You can scroll through the list displayed with the commands **NEXT PAGE/PREVIOUS PAGE** or **FIRST PAGE/LAST PAGE**.

### Voice guidance

To switch voice guidance on or off during route guidance, say the command **VOICE GUIDANCE ON** or **VOICE GUIDANCE OFF**. Use the **COMPACT VOICE GUIDANCE** command to shorten the announcement.

### Adjusting the volume

To adjust the voice recognition system volume with the multifunction steering wheel, turn the right thumbwheel ② ⇒ page 108, fig. 108 up or down while an announcement is playing.

You can also adjust the voice recognition system volume by pressing the **Sound** control button while in the radio/media menu ⇒ page 34.

### Help commands

You can say a help command when the voice recognition system is switched on ⇒ page 108. Possible help commands are:

- **HELP**
- **HELP SPEECH DIALOGUE SYSTEM**
- **HELP DIRECTORY**
- **HELP TELEPHONE\***
- **HELP NAVIGATION**
- **HELP MAP**

Say the command **BACK** to return to the main help menu.

### System-guided help

If the voice recognition system is switched on ⇒ page 108 but you do not give a command, the system gives the prompt **Please enter a command or say help**. If you still do not give a command, the voice recognition system offers possible commands.

Example of system-guided help (the telephone\* function is activated):



MMI components

MMI control panel

Multifunction steering wheel

Voice recognition system

Operation/ Commands	Voice recognition system announcement
Press talk button  briefly	Input signal: <b>Beep</b>
No command given	<b>Please enter a command or say help</b>
<b>HELP</b>	<b>Please choose one of the following topics. You can press the talk button at any time to enter a command.</b>
	<b>All telephone commands</b>
	<b>Important telephone commands</b>
	<b>Commands for phoning</b>
	<b>Commands for the call lists</b>

### Tips

- You can interrupt a voice recognition system announcement at any time by pressing the Talk button on the multifunction steering wheel ⇒ *page 108*, fig. 108 and enter a new command.
- You can also adjust the volume by the turning the On/Off knob ⇒ *page 33*. ■

## Calling

Applies to vehicles: with cell phone prep

### Starting telephone mode

Requirement: The MMI telephone function must be active ⇒ *page 22* and the voice recognition system must be switched on ⇒ *page 108*.

- Say **TELEPHONE**. Telephone mode starts. The voice recognition system remains switched on for approximately five seconds to accept an additional command. ■

Applies to vehicles: with cell phone prep

### Dialing a phone number

Requirement: The voice recognition system must be switched on ⇒ *page 108*.

- Say **DIAL NUMBER**.
- Enter a group of numbers such as “**0-1-7-2-2**”. The system repeats the block of numbers and displays them in the MMI.
- Say **DELETE** to delete the last block of numbers.
- Say **DIAL** to dial the number.

### Tips

You can correct incorrect entries when entering a telephone number with the **CORRECTION** command. ■

Applies to vehicles: with cell phone prep

### Calling

Requirement: The voice recognition system must be switched on ⇒ *page 108*.

- To call the phone number stored in a directory entry, say **CALL (XY)**, for example **CALL “JOHN SMITH”**. The telephone number is dialed. ▶



If several phone numbers are stored in an address card, you add the command **BUSINESS LAND LINE**, **BUSINESS MOBILE**, **PRIVATE LAND LINE** or **PRIVATE MOBILE**, for example **CALL JOHN SMITH PRIVATE MOBILE**.



#### Tips

When an address card is open, you can dial a phone number with the command **CALL PRIVATE** or **CALL BUSINESS** ⇒ *page 111*. ■

Applies to vehicles: with cell phone prep

### Additional telephone mode commands

Requirement: The voice recognition system must be switched on ⇒ *page 108*.

#### Accessing call lists

- Say **NUMBERS DIALED**, **MMI high BA for in-vehicle use only**, **RECENT CALLS** or **MESSAGE CALLS**. The call list is shown in the MMI display. You can dial a number by saying the line number.

#### Redialing

- Say **REDIAL**. The last numbered dialed is called. ■

## Using addresses

### Opening the directory

Requirement: The voice recognition system must be switched on ⇒ *page 108*.

- Say **DIRECTORY**. The directory opens. The voice recognition system remains switched on for approximately five seconds to accept an additional command. ■

### Using an entry

Requirement: The voice recognition system must be switched on ⇒ *page 108*.

#### Searching for/opening an entry

- Say **FIND ENTRY**.
- Say the name of the address card if prompted by the voice recognition system. The address card opens.

#### Calling up an entry

- To call the phone number stored in a directory entry, say **CALL (XY)**, for example **CALL "JOHN SMITH"** ⇒ *page 110*. The telephone number is dialed.

#### Navigating to an entry

- Say **NAVIGATE TO (XY)** such as **NAVIGATE TO "JOHN SMITH"**. If a navigation destination is assigned to an address card, that destination is entered and route guidance begins.



#### Tips

You can start route guidance when an address card is open with the commands **NAVIGATE TO PRIVATE ADDRESS** or **NAVIGATE TO BUSINESS ADDRESS**. You can also dial phone numbers with the commands **CALL PRIVATE** or **CALL BUSINESS**. ■

### Storing a voice memo

The MMI creates a name tag for each entry in the directory. You can also assign up to 50 personal name tags for address cards.

Requirement: An address card must be open ⇒ *page 111* and the voice recognition system must be switched on ⇒ *page 108*.

- Say **STORE NAME**.
- Say the personal name tag.
- Repeat the personal name tag if prompted by the voice recognition system. The personal name tag is stored in the MMI.

Name tags can only be stored using the voice recognition system. The name tags **do not** change the data stored in the directory.

You must repeat the name tag with the same pronunciation and volume. Assign clear, distinct names as name tags.

Do not include any long pauses in name tags. ■

### Reading name tags

You can have name tags read.

Requirement: An address card must be open ⇒ *page 111* and the voice recognition system must be switched on ⇒ *page 108*.

- Say **READ NAME**. The personal name tag is read.



#### Tips

You can also listen to personal name tags for address cards through the MMI control panel ⇒ *page 65*. ■

### Deleting personal name tags

#### Deleting in the address card

- Turn the control knob to **Delete name tag** and press the knob while the address card is open ⇒ *page 111*. The personal name tag is deleted.

#### Deleting in the SETUP menu

- Press the **(NAME)** function button. A list of entries appears in the MMI display.
- Press the **(SETUP)** function button.
- Turn the control knob to **Delete voice memos** and press the knob.
- Turn the control knob to **Delete individually** or **Delete all entries** and press the knob.
- Turn the control knob to **Yes** and press the knob to begin the deletion process. ■

## Navigating

### Starting navigation mode

Requirement: The voice recognition system must be switched on ⇒ *page 108*.

- Say **NAVIGATION**. Navigation mode starts. The voice recognition system remains switched on for approximately five seconds to accept an additional command. ■

## Entering a destination

The voice recognition system offers two ways to enter destinations: system-guided destination entry or entering individual commands.

Requirement: The voice recognition system must be switched on ⇒ page 108.

### System-guided destination entry

- Say **ENTER DESTINATION**. The input field appears in the MMI display ⇒ page 79, fig. 79.
- Say the desired city when prompted.
- Say the desired street when prompted.
- Say the desired house number when prompted, or
- Say **START ROUTE GUIDANCE** to navigate to the destination entered.

### Entering individual commands

- To enter the country, say **ENTER COUNTRY** and say the country name.
- To enter the town, say **ENTER TOWN** and say the name of the town.
- To enter the street, say **ENTER STREET** and say the complete name of the street, such as **NORTH FIFTH AVENUE**.
- To enter a street in the current town, say **ENTER STREET IN VICINITY** and say the complete name of the street, such as **NORTH FIFTH AVENUE**.
- To enter the house number, say **ENTER HOUSE NUMBER** and say the house number one digit at a time.

- Say **START ROUTE GUIDANCE** to navigate to the destination entered.

It may take a few seconds to search the location. The MMI display will then show a list of possible city names. You can select the desired location by saying the line number, such as **LINE FOUR** or turning and pressing the control knob. You can scroll through the list of location names with the commands **NEXT PAGE/PREVIOUS PAGE**. Because many countries have several cities with the same name, it may be necessary to select the city from a list again ⇒ page 109.

### Tips

- Once a city is entered into the input field, you can start route guidance to the city center by press the talk button and saying **START ROUTE GUIDANCE**. You can also start route guidance through the MMI control panel ⇒ page 80.
- You can also switch the voice recognition system on and enter a command during active route guidance and messages about driving maneuvers.
- For additional information on navigation functions, refer to ⇒ page 78. ■

### Points of interest

Requirement: The voice recognition system must be switched on ⇒ page 108.

- Say **ENTER SPECIAL DESTINATION**.
- After the announcement **Please enter the search area**, say **IN IMMEDIATE VICINITY, IN VICINITY OF DESTINATION, IN NEW TOWN** or **NATIONWIDE**. A list with point of interest categories appears in the MMI display. ▶

MMI components

MMI control panel

Multifunction steering wheel

Voice recognition system

- To select an entry from the list, say the line number, for example **LINE TWO** or say the name of the entry. The point of interest is set as the navigation destination.
- Say **START ROUTE GUIDANCE** to navigate to the destination entered.

The following top destinations can be set directly as navigation destinations:

- **NEXT GAS STATION**
- **NEXT DIESEL GAS STATION**
- **NEXT PARKING LOT**
- **NEXT RESTAURANT**
- **NEXT ACCOMMODATION**
- **NEXT HOSPITAL**
- **NEXT AUDI DEALER**
- **NEXT POLICE STATION**
- **NEXT ATM**
- **NEXT COFFEE SHOP**
- **NEXT AIRPORT**
- **NEXT TRAIN STATION**

MMI high B8, for internal use only



#### Tips

You can scroll through the list displayed with the commands **NEXT PAGE/PREVIOUS PAGE** or **FIRST PAGE/LAST PAGE**. ■

### Map options

*You can use the voice recognition system to control many map view functions in the MMI display.*

Requirement: The voice recognition system must be switched on ⇒ *page 108*.

Map option commands include:

#### General options

- **MAP ON/OFF** - The map is displayed or hidden in the MMI display.
- **DAY/NIGHT MAP** - The map background is light/dark ⇒ *page 92*.
- **ADDITIONAL INFO ON/OFF** - Upcoming turns with calculated distance are displayed when route guidance is active.

#### Map type

- **POSITION 2D /3D MAP** - The current vehicle position is shown in a two/three dimensional map ⇒ *page 92*.
- **DESTINATION MAP** - The map shows the destination ⇒ *page 92*.
- **DETAIL MAP** - The current vehicle position is shown in the map with 1 km scale. This function is only available through the voice recognition system.
- **OVERVIEW MAP** - The entire route from the starting point to the destination is shown on the map ⇒ *page 92*.

#### Orientation

- **ORIENTATION NORTH** - The map is oriented to the north ⇒ *page 92*.
- **ORIENTATION IN DIRECTION OF TRAVEL** - The map is oriented to the direction the vehicle is traveling ⇒ *page 92*.
- **ORIENTATION AUTOMATIC** - The map is oriented in the direction of travel at a scale less than 2.5. At a scale greater than 2.5 km, the map is oriented to the north ⇒ *page 92*.

#### Zoom

- **INTERSECTION ZOOM ON/OFF** - The map is displayed in zoom mode at intersections ⇒ *page 93*.
- **ZOOM OFF** - Switched the activated map zoom mode off.
- **MAP LARGER/SMALLER** - The map display is changed.
- **SCALE (XY)**, for example **SCALE 5 km** - The map scale is changed. Available scales are 50 m, 100 m, 200 m, 500 m, 1 km, 2 km, 5 km, ▶

10 km, 20 km, 50 km, 100 km, 200 km and 500 km. Units of measure are kilometers/meters or miles/yards. ■

### Additional navigation commands

Requirement: The voice recognition system must be switched on ⇒ *page 108*.

#### Route guidance

- Say **START/STOP ROUTE GUIDANCE**. Route guidance starts or stops.

#### Calling up navigation lists

- Say **LAST DESTINATIONS** or **TOP DESTINATIONS**. Follow the instructions from the voice recognition system.

#### Dynamic route guidance **MMI high B8, for internal use only**

- Say **DYNAMIC ROUTE GUIDANCE ON/OFF**. Dynamic route guidance is switched on or off.

#### Route criteria

- Say: **FAST ROUTE**, **ECONOMICAL ROUTE** or **SHORT ROUTE**. The route is calculated according to various criteria, or
- Say: **ROUTE LIST**. The route list can be viewed when route guidance is active.

#### Navigating to a directory entry

- Say **NAVIGATE TO (XY)** such as **NAVIGATE TO "JOHN SMITH"**. If a navigation destination is assigned to an address card, that destination is entered and route guidance begins.



#### Tips

To switch voice guidance on or off when route guidance is active, say the command **VOICE GUIDANCE ON** or **VOICE GUIDANCE OFF** ⇒ *page 108*. ■

**A**

AAC files ..... 12, 14, 16  
 Accepting a call ..... 76  
 Activate your Satellite Radio service ..... 41  
 Addit. info  
   MMI control panel ..... 93  
 Addresses  
   MMI control panel ..... 57  
   Voice recognition system ..... 111  
 Adjusting volume  
   MMI control panel ..... 34  
 Alternative route  
   on/off ..... 91  
   Selecting ..... 85  
 AM  
   Selecting frequency band ..... 40  
 Answering/ignoring a call  
   MMI control panel ..... 72  
   Multifunction steering wheel ..... 104  
 Aspect ratio ..... 55  
 Audi music interface  
   Connecting the adapter cable ..... 18  
   Repeat ..... 51  
   Starting ..... 17  
 Audi music interface adapter cable ..... 18  
 Audio source ..... 48  
 Automatic zoom  
   Voice recognition system ..... 114  
 Automatic zoom (Navigation) ..... 93

Aux-in connection  
   Connecting/removing an audio device . 21  
   MMI control panel ..... 48  
 Avoiding a route ..... 91

**B**

Balance (sound) ..... 34  
 Band ..... 42  
 Bass (sound) ..... 34  
 Bluetooth  
   Bluetooth name ..... 75  
   Cell phone prep ..... 22  
   Delete Bluetooth devices ..... 75  
   Discover Mode ..... 75  
   Find Bluetooth devices ..... 75  
   Paired devices ..... 75  
   Switching on/off ..... 75  
 Brightness  
   MMI display ..... 39  
 Buttons  
   MMI control panel ..... 29  
   Multifunction steering wheel ..... 98

**C**

Call lists ..... 76  
   Delete ..... 74  
   MMI control panel ..... 71  
   Multifunction steering wheel ..... 102  
   Voice recognition system ..... 111  
 Call options ..... 76  
 Call volume ..... 76

**Calling**

MMI control panel ..... 69, 70  
 Multifunction steering wheel ..... 102  
 Voice recognition system ..... 110  
 Calling up navigation lists (voice recognition system) ..... 115

**Calls**

MMI control panel ..... 71  
 Multifunction steering wheel ..... 103

**Care**

CD/DVD ..... 11  
 Memory cards ..... 12  
 MMI control panel ..... 8

Category filter (Satellite Radio) ..... 47

**CD**

Ejecting ..... 14  
 Ejecting (CD changer) ..... 16  
 Handling tips ..... 11  
 Loading ..... 14  
 Loading (CD changer) ..... 15  
 MMI control panel ..... 48  
 Multifunction steering wheel ..... 100  
 Repeat ..... 51  
 CD changer ..... 14  
 CD/DVD drive ..... 14

**Cell phone**

with hands-free profile ..... 24  
 with hands-free profile (cell phone prep) . 22

**Cell phone package**

Calling (multifunction steering wheel) . . . 102

**MMI high B8, for internal use only**

Cell phone prep	Dialing a phone number	Drives
Calling (MMI control panel) . . . . . 69	MMI control panel . . . . . 70, 71	Audi music interface . . . . . 17
Calling (voice recognition system) . . . 110	Multifunction steering wheel . . . . . 103	Aux-in connection . . . . . 21
Pairing cell phone . . . . . 24	Voice recognition system . . . . . 110	CD changer . . . . . 14
Searching for Bluetooth devices . . . . . 23	Dialing phone numbers	CD/DVD . . . . . 14
Starting . . . . . 22	MMI control panel . . . . . 74	File formats . . . . . 9
Chapter (drive)	Dialing stored phone numbers . . . . . 74	Jukebox . . . . . 12
Next/previous chapter . . . . . 50	Directory	Memory card reader . . . . . 16
Cleaning	Multifunction steering wheel . . . . . 102	MMI control panel . . . . . 9
CD/DVD . . . . . 11	Directory entries	DSP . . . . . 35
Control button . . . . . 29	Cell phone prep . . . . . 25	DSP Bang & Olufsen . . . . . 36
Control knob . . . . . 29	Directory entry	DTMF tones
Controls	Calling (voice recognition system) . . . 111	MMI control panel . . . . . 70
MMI control panel . . . . . 29	calling up (MMI control panel) . . . . . 62	DVD . . . . . 14
Multifunction steering wheel . . . . . 98	Change . . . . . 64	Ejecting . . . . . 14
Overview . . . . . 7	Deleting . . . . . 65	Full screen display . . . . . 53
	Editing . . . . . 63	Handling tips . . . . . 11
<b>D</b>	Importing . . . . . 60	Loading . . . . . 14
Data password . . . . . 39	Navigating (MMI control panel) . . . . . 62	Main menu . . . . . 52
Date . . . . . 36	Navigating (voice recognition system) . . .	Multifunction steering wheel . . . . . 100
Default settings	111, 115	Parental control . . . . . 53
MMI control panel . . . . . 38	Search/open (voice recognition system) .	Dynamic Navigation
Delete Bluetooth devices . . . . . 75	111	Voice recognition system . . . . . 115
Deleting local call lists . . . . . 74	searching (MMI control panel) . . . . . 61	Dynamic route
Deleting recent calls	Store new . . . . . 57	MMI control panel . . . . . 91
MMI control panel . . . . . 74	Voice memo . . . . . 112	<b>E</b>
Demo mode . . . . . 94	Directory memory capacity . . . . . 68	Edit (directory) . . . . . 64, 65
Dialed numbers	Discover Mode . . . . . 75	Editing (directory) . . . . . 68
MMI control panel . . . . . 71	Display	Ending a call
Multifunction steering wheel . . . . . 102	See Driver information system . . . . . 98	MMI control panel . . . . . 72
	See MMI Display . . . . . 29	Multifunction steering wheel . . . . . 103
	Displaying track information . . . . . 55	
	Driver information system . . . . . 98	

MMI high B8, for internal use only

MMI components	MMI control panel	Multifunction steering wheel	Voice recognition system
----------------	-------------------	------------------------------	--------------------------

- Entering a destination ..... 79  
 Address ..... 80  
 Alternative route ..... 85  
 Avoiding a route ..... 91  
 from the map ..... 81  
 Load last destination ..... 83  
 Loading a destination from the directory .  
 89  
 Loading a tour plan ..... 89  
 Point of interest ..... 82  
 Setting a starting point ..... 94  
 Tips ..... 79  
 Top destination ..... 90  
 Voice recognition system ..... 113
- Entering a point of interest  
 MMI control panel ..... 82  
 Voice recognition system ..... 113
- Entering destination  
 Tour plan ..... 84  
 with stopover ..... 84
- Entering stopover ..... 84
- External  
 Audio devices ..... 20  
 Bluetooth device ..... 75
- F**  
 Fader (sound) ..... 34  
 Fast forward in a track (drive) ..... 50  
 File formats ..... 9  
 Files  
 Erasing ..... 13  
 Importing ..... 12
- FM  
 Selecting frequency band ..... 40
- Folder  
 Repeat ..... 51  
 Selecting (MMI control panel) ..... 49  
 Selecting (multifunction steering wheel) .  
 101
- Folder structure ..... 49
- Frequency ..... 43
- Full screen (DVD) ..... 53
- Function button ..... 29
- G**  
 GALA ..... 35
- T**  
 Importing a phone number ..... 59  
 In immediate vicinity (point of interest) .. 82  
 In new city (point of interest) ..... 82  
 In vicinity of destination (point of interest) ..  
 82
- In-car entertainment fader ..... 39  
 Volume ..... 34
- INFO  
 MP3 CD/Audi music interface ..... 51  
 Sirius track information ..... 47  
 Traffic information ..... 95
- Information (Navigation) ..... 91
- Input level ..... 55
- Intersection zoom  
 Voice recognition system ..... 114
- Invert call lists ..... 76
- iPod ..... 19  
 MMI control panel ..... 48  
 Multifunction steering wheel ..... 100
- J**  
 Joystick ..... 32  
 Jukebox ..... 12  
 Erasing files ..... 13  
 Importing files ..... 12
- L**  
 Laser devices ..... 11  
 Last calls  
 Multifunction steering wheel ..... 103
- Last destinations  
 Delete ..... 94  
 Load ..... 83
- Loading from the directory (navigation) .. 89
- M**  
 Main menu (DVD) ..... 52  
 Making other calls  
 Multifunction steering wheel ..... 103
- Manual location entry ..... 94
- Map content  
 MMI control panel ..... 90  
 Voice recognition system ..... 114
- Map display ..... 86  
 MMI control panel ..... 92  
 Voice recognition system ..... 114



Map options	Restarting . . . . . 37	Names
MMI control panel . . . . . 90, 92, 93	Switching on/off . . . . . 28	Navigating to a directory entry . . . . . 111
Voice recognition system . . . . . 114	MMI control panel . . . . . 29	Nationwide (point of interest) . . . . . 82
Map orientation	MMI Display	Nav Info (Navigation) . . . . . 91
MMI control panel . . . . . 92	Standard menus . . . . . 29	Navigating
Voice recognition system . . . . . 114	MMI display	MMI control panel . . . . . 62, 78
Map type	Brightness . . . . . 39	Multifunction steering wheel . . . . . 105
MMI control panel . . . . . 92	Joystick . . . . . 32	Voice recognition system . . . . . 112
Voice recognition system . . . . . 114	Navigation display . . . . . 86	Navigation announcement
Map zoom (voice recognition system) . . . 114	Speller . . . . . 31	Volume . . . . . 34
Measurement units . . . . . 38	Switching on/off . . . . . 33	Navigation announcement volume . . . . . 34
Memory (radio)	MMI menu overview . . . . . 28	Navigation announcements . . . . . 78
Delete stations . . . . . 46	Moving stored stations . . . . . 46	Repeating . . . . . 105
Moving stations . . . . . 46	MP3	Volume . . . . . 34
Selecting a station (MMI control panel) . . 45	MMI control panel . . . . . 48	Navigation destination
Selecting a station (multifunction steering wheel) . . . . . 100	Multifunction steering wheel . . . . . 100	Store in the directory . . . . . 63
Storing stations . . . . . 45	MP3 player . . . . . 20	Storing . . . . . 87, 88
Memory card	Multifunction steering wheel . . . . . 98	See <i>also</i> Entering a destination . . . . . 79
Handling tips . . . . . 12	Mute	Navigation display
Inserting/removing . . . . . 16, 17	MMI control panel . . . . . 33	Driver information system . . . . . 87, 105
MMI control panel . . . . . 48	Multifunction steering wheel . . . . . 99	MMI display . . . . . 86
Repeat . . . . . 51	Muting	Next station
Memory card reader . . . . . 16	MMI control panel . . . . . 33	Radio (MMI control panel) . . . . . 43
Inserting/removing a memory card 16, 17		<b>O</b>
Missed calls	<b>N</b>	Options . . . . . 75
MMI control panel . . . . . 71	Name tags	Multifunction steering wheel . . . . . 104
Multifunction steering wheel . . . . . 102	Calling directory entry . . . . . 111	Orientation (map)
MMI . . . . . 7	deleting . . . . . 112	MMI control panel . . . . . 92
Components . . . . . 7	Erasing . . . . . 38	Voice recognition system . . . . . 114
Menu overview . . . . . 28	Reading . . . . . 112	

MMI components	MMI control panel	Multifunction steering wheel	Voice recognition system
----------------	-------------------	------------------------------	--------------------------

## P

Paired devices	75
Parental control (DVD)	53
Pause (drive)	
MMI control panel	54
Multifunction steering wheel	101
Pausing/continuing playback	54
Phone book	
See Addresses	57
Phone number	
importing into the directory	59
Storing in the directory	73
Presentation mode	
Demo mode	94
Setting a starting point	94

## Q

Quartz clock	36
--------------	----

## R

Radio	
Category filter (Satellite Radio)	47
MMI control panel	40
Multifunction steering wheel	99
Station info (Satellite Radio)	47
Station sorting (Satellite Radio)	47
System information (Satellite Radio)	40
Radio clock	36

Radio station on the MMI control panel	
Frequency	43
Next station	43
Scanning	44
Seek	43
Selecting from the memory	45
Storing	45
Radio station on the multifunction steering wheel	
Selecting from memory	100
Selecting from station list	100
Radio stations on the MMI control panel	
Moving	46
Selecting from the station list	43
Radio text	46
Read error messages (CD/DVD)	11
Received calls	
MMI control panel	71
Multifunction steering wheel	102
Receiver serial numbers	41
Recent calls	
MMI control panel	71
Redial	76
Voice recognition system	111
Repeat	51
Repeat options	51
Repeating a command	38
Replacing a call	75
Multifunction steering wheel	104
Reset	37
Restart (MMI)	37
Rewind in a track (drive)	50
Ring tone volume	34, 76

## Route criteria

MMI control panel	91
Voice recognition system	115
Route guidance	
Changing	79
in the driver information system	87
In the MMI display	86
Stopping	85
Route list	90
Route options	
MMI control panel	91
Voice recognition system	115
Route plan	
See Tour plan	84, 88, 89

## S

Safety	7
when calling	69
when navigating	78
Satellite Digital Audio Radio Service	
Activate your Satellite Radio service	41
Category filter	47
Station info	47
Station sorting (Satellite Radio)	47
Satellite radio	
Selecting frequency band	40
SCAN	44
Scrolling text	46
SD	
Multifunction steering wheel	100
SDARS	
See Selecting frequency band	40

MMI high B8, for internal use only

Seek (radio) . . . . .	43	Sound	
Selecting frequency band		Basic settings . . . . .	34
MMI control panel . . . . .	42	DSP . . . . .	35
Selecting source		DSP Bang & Olufsen . . . . .	36
Audi music interface . . . . .	48	Volume . . . . .	34
Aux-in . . . . .	48	Sound Focus . . . . .	35, 36
CD changer . . . . .	48	Speller . . . . .	31
CD/DVD . . . . .	48	Spoken cues	
Jukebox . . . . .	48	On/Off (phone) . . . . .	93
Memory card . . . . .	48	Volume . . . . .	93
Selecting the frequency band		Start/stop route guidance (voice recognition system) . . . . .	115
Multifunction steering wheel . . . . .	99	Starting	
Selecting the language		Cell phone prep . . . . .	22
MMI control panel . . . . .	38	Starting Navigation mode	
Selecting the menu language		MMI control panel . . . . .	79
MMI control panel . . . . .	38	Starting navigation mode	
Set from last destinations . . . . .	58	Voice recognition system . . . . .	112
Setting a starting point . . . . .	94	Starting radio mode . . . . .	41
Setting the volume		Starting Telephone mode	
Multifunction steering wheel . . . . .	99	MMI control panel . . . . .	69
Setup radio		Starting telephone mode	
Category filter (Satellite Radio) . . . . .	47	Voice recognition system . . . . .	110
Station info (Satellite Radio) . . . . .	47	Station info (Satellite Radio) . . . . .	47
Station sorting (Satellite Radio) . . . . .	47	Station list (radio)	
Show the next report . . . . .	95	Selecting a station (multifunction steering wheel) . . . . .	100
Shuffle . . . . .	52	Selecting station list (MMI control panel) . . . . .	43
Sirius		Update . . . . .	43
Selecting frequency band . . . . .	40	Station name (radio) . . . . .	46
Software version		Station sorting (Satellite Radio) . . . . .	47
MMI control panel . . . . .	39	Stereo jack . . . . .	20
Navigation . . . . .	39	Store current position . . . . .	90
		Storing a destination	
		in the directory . . . . .	87
		Subwoofer (sound) . . . . .	34
		Surround Level . . . . .	36
		Switching on/off	
		MMI control panel . . . . .	28
		Voice recognition system . . . . .	108
		Switching the microphone on/off . . . . .	75
		System information (Satellite Radio) . . . . .	40
		<b>T</b>	
		Talk button (multifunction steering wheel) . . . . .	105, 108
		Telephone settings . . . . .	76
		TEXT (radio) . . . . .	46
		Time . . . . .	36
		Tips	
		Caring for your MMI control panel . . . . .	8
		Handling CDs/DVDs . . . . .	11
		Handling memory cards . . . . .	12
		Traffic safety . . . . .	7
		TMC . . . . .	95
		Top destination . . . . .	87, 90
		Top destinations . . . . .	63
		Tour plan	
		Deleting . . . . .	90
		Entering . . . . .	84
		Entering stopover . . . . .	84
		Loading . . . . .	89
		Storing . . . . .	88

MMI components

MMI control panel

Multifunction steering wheel

Voice recognition system

