

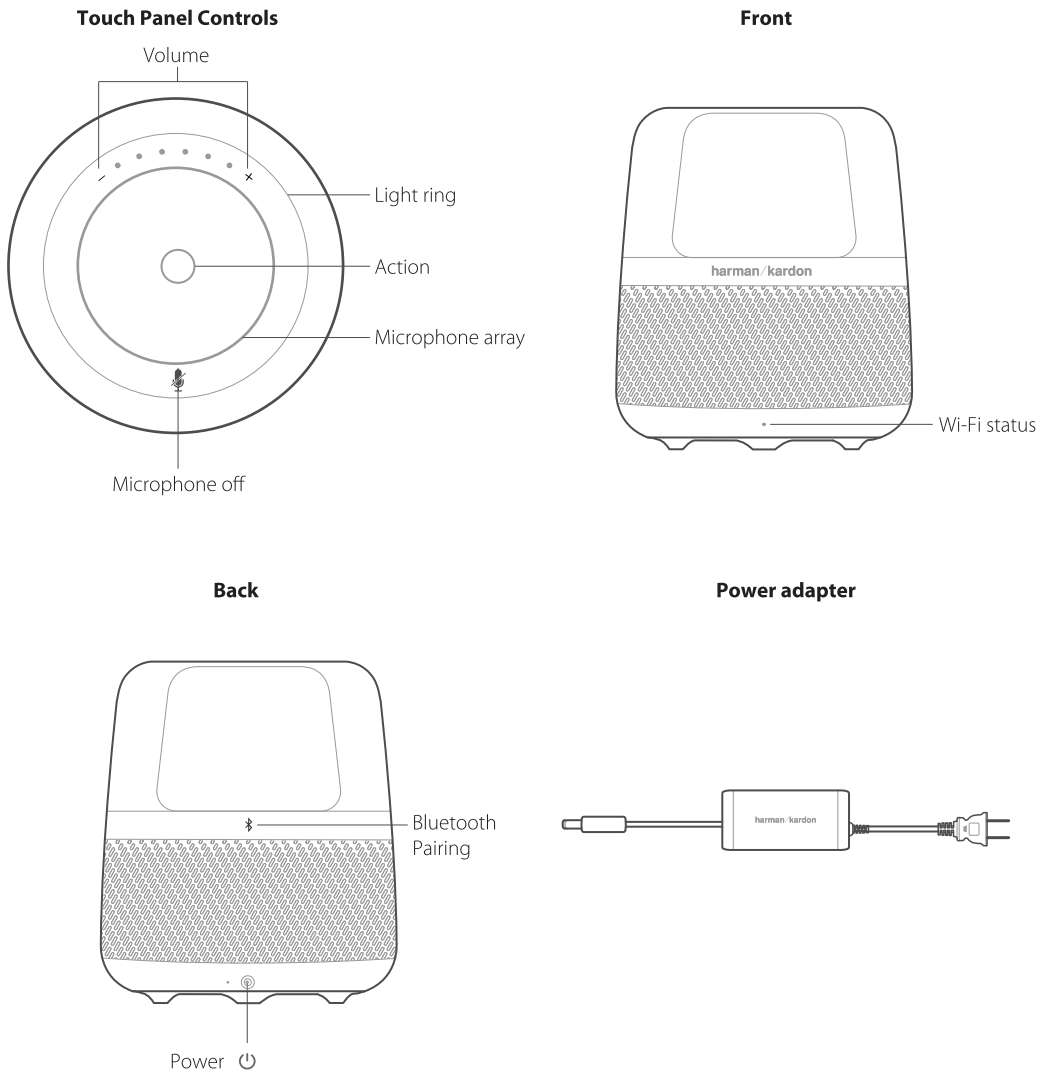

# ALLURE

## PRODUCT TOUR



## PLUG IN YOUR ALLURE

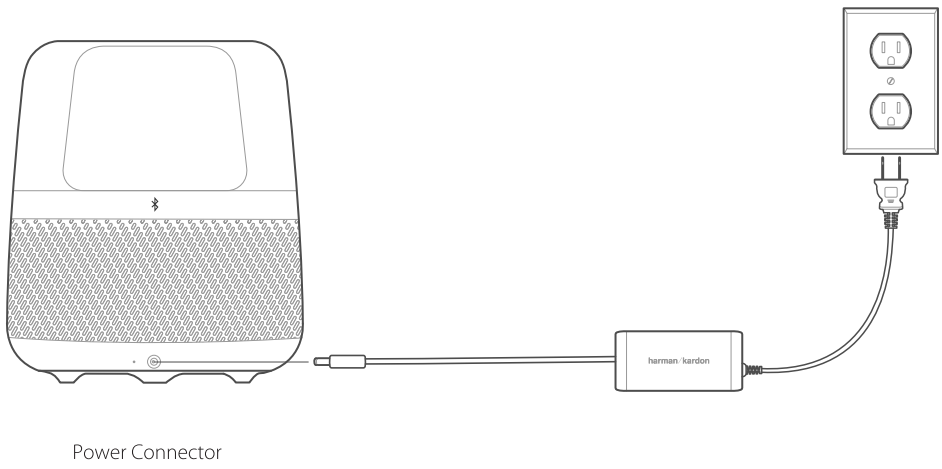



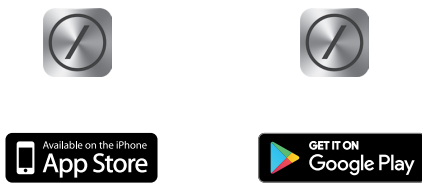

## DOWNLOAD THE HARMAN KARDON ALLURE SETUP APP

Download and run the free app in your phone or tablet. Opening the app will start the setup process.

During setup, you will connect Allure to the Internet and Amazon Alexa. Wi-Fi network and Amazon account need for the setup.



## GET TO KNOW ALLURE

-  **Microphone off**  
Tap to turn off the microphones
-  **Action**  
Double tap to wake up Allure  
Tap to turn off the alarm and timer
-  **Volume**  
Tap or slide to adjust the volume
-  **Bluetooth**  
Tap to pair Bluetooth
- Light ring**  
The color of the light ring indicates what Allure is doing. When it is blue, Allure is ready for your requests.

## GET TO START WITH ALLURE

- Talking to Allure**  
Say 'Alexa' to get Allure's attention. Then tell her what you want to do.
- Amazon Alexa app**  
The Alexa app helps you get more out of Allure. You can use the app to manage your lists, music and settings.
- Things to try**  
Ask Allure,
  - Alexa, play some relaxing music.
  - Alexa, what is the weather?
  - Alexa, set the alarm for 7 a.m.
  - Alexa, add milk to my shopping list?
  - Alexa, tell me a joke.

## USING ALLURE WITH SPOTIFY CONNECT



Spotify Connect lets you play Spotify through your Allure using the Spotify app as a remote control. You will need Spotify Premium account to use Spotify Connect.

1. Connect Allure to the same Wi-Fi network as your phone or tablet
2. Open Spotify app on your phone or tablet and play music
3. Tap the device icon at the bottom of the screen
4. Pick Allure from the list

### Licenses

The Spotify Software is subject to third party licenses found here:

[www.spotify.com/connect/third-party-licenses](http://www.spotify.com/connect/third-party-licenses)

## RESET WI-FI SETTINGS

Tap and hold for 5 sec., then use the Allure Setup app to reset Wi-Fi setting

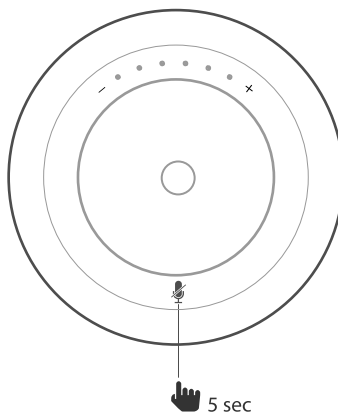

Questions? Visit our website for technical support:  
[www.harmanardon.com/invokehelp](http://www.harmanardon.com/invokehelp)



Alexa Voice Service

Spotify Connect feature requires Spotify Premium subscriptions. Spotify Connect feature may not be used in countries where Spotify service is not available. The Spotify software is subject to third party licenses found here: [www.spotify.com/connect/third-party-licenses](http://www.spotify.com/connect/third-party-licenses).

The Bluetooth® word mark and logos are registered trademarks owned by Bluetooth SIG, Inc. and any use of such marks by HARMAN International Industries, Incorporated is under license. Other trademarks and trade names are those of their respective owners.

The Wi-Fi CERTIFIED Logo is a certification mark of the Wi-Fi Alliance.

The Wi-Fi Protected Setup Identifier Mark is a mark of the Wi-Fi Alliance.



TR04218\_B