

Harman/Kardon Subwoofer VW6

Quick Start Guide

This product (Product name :Subwoofer, Model:VW6) is used in conjunction with Hisense TV, VW6 connect with Hisense TV via the 5.8G Wireless module. Hisense TV and this Subwoofer should have 5.8G wireless module.

1. Power this Subwoofer

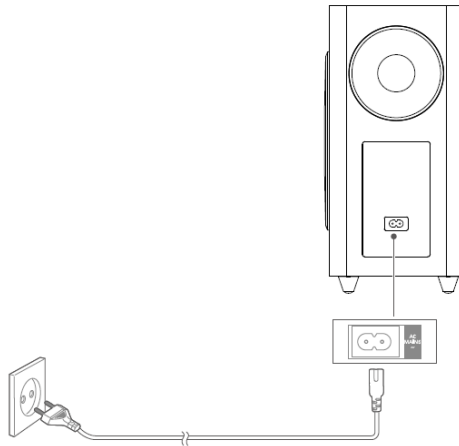

2. Turn on Hisense TV at the same time, you should set up Hisense TV to enter pairing mode.

3. The Subwoofer has a pair button with a LED indication for wireless connection.

To show status of the wireless connection, the status LED behavior shall like below:

- 1) White, flash quickly: enter the Wireless Paring state, wait for the new TX link.
- 2) White, flash slowly: Back to link, try to link the recently connected TX
- 3) White color light: Wireless Connection
- 4) Button: short press the pair button on subwoofer to make it enter the Wireless Paring state.

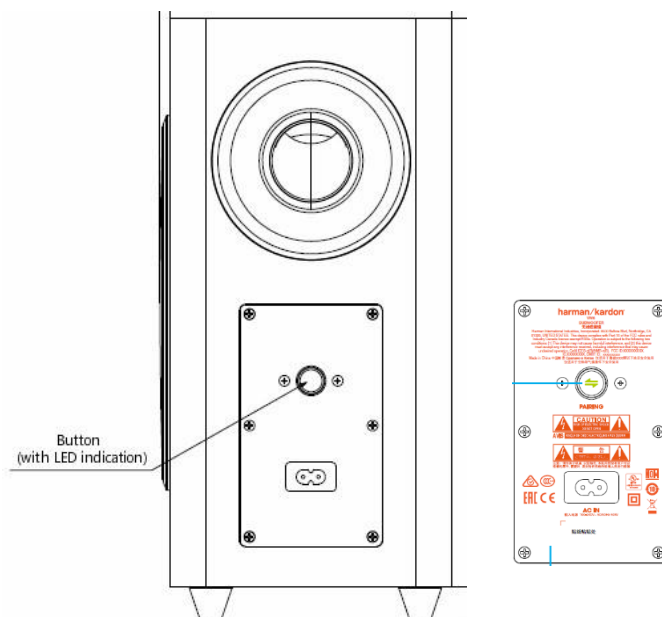

Product Specification

Subwoofer Output

Rated Power at THD 1%	100W (4 ohm load) Measure at 63Hz
Frequency Response (Output Power and THD+N)	
THD+N at 1W	<0.3 %
THD+N at Rated Output Power	<1%
Input Sensitivity (1W)	11mV +/- 1dB (From L and R Soundbar Input)
Signal to Noise Rate at 1W	>60dB (A-Weighting)
Residual Noise at 50 and 60Hz	<3mVrms

Operating Temperature : 0°C - 45°C

5.8G Wireless Frequency Range: 5743-5840MHz

For CE

Hereby, HARMAN INTERNATIONAL INDUSTRIES, INCORPORATED , declares that this Subwoofer is in compliance with the essential requirements and other relevant provisions of Directive 2014/53/EU.

Federal Communication Commission Interference Statement

Caution: changes or modifications not expressly approved by the party responsible for compliance could void the user's authority to operate the equipment.

This equipment has been tested and found to comply with the limits for a Class B digital device, pursuant to Part 15 of the FCC Rules. These limits are designed to provide reasonable protection against harmful interference in a residential installation. This equipment generates, uses and can radiate radio frequency energy and, if not installed and used in accordance with the instructions, may cause harmful interference to radio communications. However, there is no guarantee that interference will not occur in a particular installation.

If this equipment does cause harmful interference to radio or television reception, which can be determined by turning the equipment off and on, the user is encouraged to try to correct the interference by one or more of the following measures:

- Reorient or relocate the receiving antenna.
- Increase the separation between the equipment and receiver.
- Connect the equipment into an outlet on a circuit different from that to which the receiver is connected.
- Consult the dealer or an experienced radio/TV technician for help.

For Products That Transmit RF Energy:

FCC AND IC INFORMATION FOR USERS

This device complies with Industry Canada license-exempt RSS standard(s). Operation is subject to the following two conditions: (1) this device may not cause interference, and (2) this device must accept any interference, including interference that may cause undesired operation.

Le présent appareil est conforme aux CNR d'Industrie Canada applicables aux appareils radio exempts de licence. L'exploitation est autorisée aux deux conditions suivantes : (1) l'appareil ne doit pas produire de brouillage, et (2) l'utilisateur de l'appareil doit accepter tout brouillage radioélectrique subi, même si le brouillage est susceptible d'en compromettre le fonctionnement.

FCC/IC Radiation Exposure Statement

This equipment complies with FCC/IC RSS-102 radiation exposure limits set forth for an uncontrolled environment. This equipment should be installed and operated with minimum distance 20cm between the radiator & your body.

ce matériel est conforme aux limites de dose d'exposition aux rayonnements, FCC / CNR-102 énoncée dans un autre environnement. cette équipement devrait être installé et exploité avec distance minimale de 20 entre le radiateur et votre corps.