



E25BT



E25BT

Quick Start Guide
Guide de démarrage rapide

1 What's in the box

E25BT

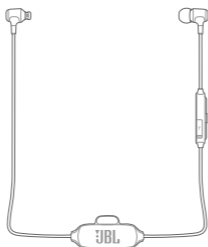

x 1

Charging cable



x 1

Ear tips

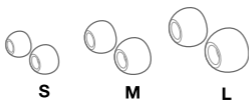

x 4

Clip



x 1

Carrying Pouch, Warranty card, QSG, Warning card image



E25BT

Quick Start Guide

Guide de démarrage rapide

2 Overview – Buttons & LEDs

1. Buttons and LED's

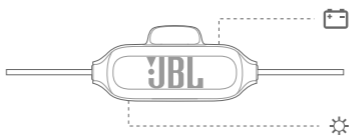
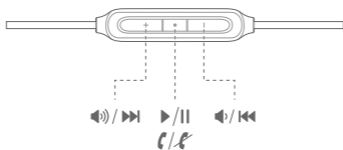

2. Connection

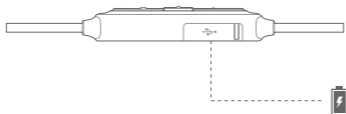

E25BT

Quick Start Guide
Guide de démarrage rapide

3 Wear the headphone

1. Select the right ear tips

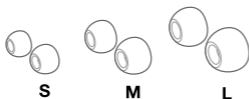

2. Wear behind the neck

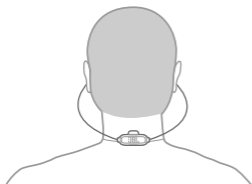

3.

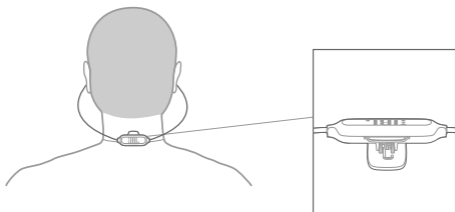

* Use when you want to fix the headphone

E25BT

Quick Start Guide Guide de démarrage rapide

4 Bluetooth connection

1. Bluetooth

a. Connecting device

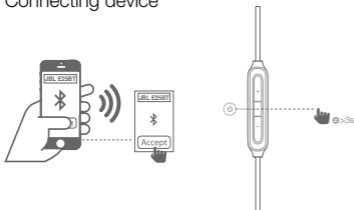

b. Connecting 2nd device

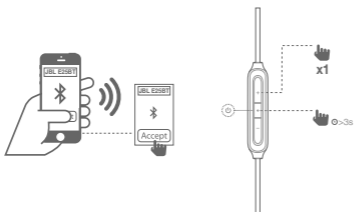

EN

Device mode	Bluetooth LED	
	Blue	Flash
Power on + No BT Connected	Yes	Slow
Power on + BT Pairing	Yes	Fast
Power on + BT Connected	Yes	On

FR

Device mode	Bluetooth LED	
	Blue	Flash
Power on + No BT Connected	Yes	Slow
Power on + BT Pairing	Yes	Fast
Power on + BT Connected	Yes	On

ES

Device mode	Bluetooth LED	
	Blue	Flash
Power on + No BT Connected	Yes	Slow
Power on + BT Pairing	Yes	Fast
Power on + BT Connected	Yes	On

DE

Device mode	Bluetooth LED	
	Blue	Flash
Power on + No BT Connected	Yes	Slow
Power on + BT Pairing	Yes	Fast
Power on + BT Connected	Yes	On

E25BT



Quick Start Guide

Guide de démarrage rapide

IT

Device mode	Bluetooth LED	
	Blue	Flash
Power on + No BT Connected	Yes	 Slow
Power on + BT Pairing	Yes	 Fast
Power on + BT Connected	Yes	 On



NL

Device mode	Bluetooth LED	
	Blue	Flash
Power on + No BT Connected	Yes	 Slow
Power on + BT Pairing	Yes	 Fast
Power on + BT Connected	Yes	 On

NO

Device mode	Bluetooth LED	
	Blue	Flash
Power on + No BT Connected	Yes	 Slow
Power on + BT Pairing	Yes	 Fast
Power on + BT Connected	Yes	 On

FI

Device mode	Bluetooth LED	
	Blue	Flash
Power on + No BT Connected	Yes	 Slow
Power on + BT Pairing	Yes	 Fast
Power on + BT Connected	Yes	 On

SV

Device mode	Bluetooth LED	
	Blue	Flash
Power on + No BT Connected	Yes	 Slow
Power on + BT Pairing	Yes	 Fast
Power on + BT Connected	Yes	 On

DA

Device mode	Bluetooth LED	
	Blue	Flash
Power on + No BT Connected	Yes	 Slow
Power on + BT Pairing	Yes	 Fast
Power on + BT Connected	Yes	 On

PO

Device mode	Bluetooth LED	
	Blue	Flash
Power on + No BT Connected	Yes	 Slow
Power on + BT Pairing	Yes	 Fast
Power on + BT Connected	Yes	 On

HU

Device mode	Bluetooth LED	
	Blue	Flash
Power on + No BT Connected	Yes	 Slow
Power on + BT Pairing	Yes	 Fast
Power on + BT Connected	Yes	 On

RU

Device mode	Bluetooth LED	
	Blue	Flash
Power on + No BT Connected	Yes	 Slow
Power on + BT Pairing	Yes	 Fast
Power on + BT Connected	Yes	 On



PT

Device mode	Bluetooth LED	
	Blue	Flash
Power on + No BT Connected	Yes	 Slow
Power on + BT Pairing	Yes	 Fast
Power on + BT Connected	Yes	 On

ID

Device mode	Bluetooth LED	
	Blue	Flash
Power on + No BT Connected	Yes	 Slow
Power on + BT Pairing	Yes	 Fast
Power on + BT Connected	Yes	 On

JP

Device mode	Bluetooth LED	
	Blue	Flash
Power on + No BT Connected	Yes	 Slow
Power on + BT Pairing	Yes	 Fast
Power on + BT Connected	Yes	 On

E25BT

Quick Start Guide

Guide de démarrage rapide

KO

Device mode	Bluetooth LED	
	Blue	Flash
Power on + No BT Connected	Yes	Slow
Power on + BT Pairing	Yes	Fast
Power on + BT Connected	Yes	On

CHS

Device mode	Bluetooth LED	
	Blue	Flash
Power on + No BT Connected	Yes	Slow
Power on + BT Pairing	Yes	Fast
Power on + BT Connected	Yes	On

CHT

Device mode	Bluetooth LED	
	Blue	Flash
Power on + No BT Connected	Yes	Slow
Power on + BT Pairing	Yes	Fast
Power on + BT Connected	Yes	On

HE

Device mode	Bluetooth LED	
	Blue	Flash
Power on + No BT Connected	Yes	Slow
Power on + BT Pairing	Yes	Fast
Power on + BT Connected	Yes	On

AR

Device mode	Bluetooth LED	
	Blue	Flash
Power on + No BT Connected	Yes	Slow
Power on + BT Pairing	Yes	Fast
Power on + BT Connected	Yes	On

5 Music control

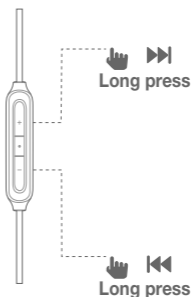
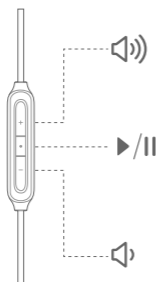

E25BT

Quick Start Guide

Guide de démarrage rapide

6 Phone call

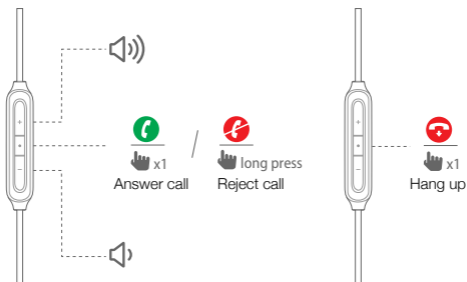

7 Charging

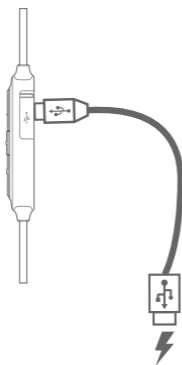

E25BT

Quick Start Guide Guide de démarrage rapide

8 LED behaviour

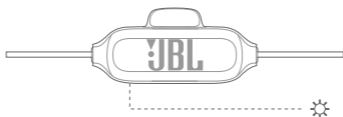

EN

Device mode	Bluetooth LED	
	White	Flash
Ⓜ Power on	Yes	Fast
Ⓜ Power off	Yes	Fast
🔋 Lower battery + No BT Connected	Yes	Slow
🔋 Lower battery + BT Pairing	Yes	Slow
🔋 Lower battery + BT Connected	Yes	Slow
🔋 Charging Complete	No	N/A
🔋 Charging Complete	Yes	On

FR

Device mode	Bluetooth LED	
	White	Flash
Ⓜ Power on	Yes	Fast
Ⓜ Power off	Yes	Fast
🔋 Lower battery + No BT Connected	Yes	Slow
🔋 Lower battery + BT Pairing	Yes	Slow
🔋 Lower battery + BT Connected	Yes	Slow
🔋 Charging Complete	No	N/A
🔋 Charging Complete	Yes	On

ES

Device mode	Bluetooth LED	
	White	Flash
Ⓜ Power on	Yes	Fast
Ⓜ Power off	Yes	Fast
🔋 Lower battery + No BT Connected	Yes	Slow
🔋 Lower battery + BT Pairing	Yes	Slow
🔋 Lower battery + BT Connected	Yes	Slow
🔋 Charging Complete	No	N/A
🔋 Charging Complete	Yes	On

DE

Device mode	Bluetooth LED	
	White	Flash
Ⓜ Power on	Yes	Fast
Ⓜ Power off	Yes	Fast
🔋 Lower battery + No BT Connected	Yes	Slow
🔋 Lower battery + BT Pairing	Yes	Slow
🔋 Lower battery + BT Connected	Yes	Slow
🔋 Charging Complete	No	N/A
🔋 Charging Complete	Yes	On

IT

Device mode	Bluetooth LED	
	White	Flash
Ⓜ Power on	Yes	Fast
Ⓜ Power off	Yes	Fast
🔋 Lower battery + No BT Connected	Yes	Slow
🔋 Lower battery + BT Pairing	Yes	Slow
🔋 Lower battery + BT Connected	Yes	Slow
🔋 Charging Complete	No	N/A
🔋 Charging Complete	Yes	On

NL

Device mode	Bluetooth LED	
	White	Flash
Ⓜ Power on	Yes	Fast
Ⓜ Power off	Yes	Fast
🔋 Lower battery + No BT Connected	Yes	Slow
🔋 Lower battery + BT Pairing	Yes	Slow
🔋 Lower battery + BT Connected	Yes	Slow
🔋 Charging Complete	No	N/A
🔋 Charging Complete	Yes	On

E25BT

Quick Start Guide

Guide de démarrage rapide

NO

Device mode	Bluetooth LED	
	White	Flash
Ⓜ Power on	Yes	Fast
Ⓜ Power off	Yes	Fast
🔋 Lower battery + BT Connected	Yes	Slow
🔋 Lower battery + Bluetooth pairing	Yes	Slow
🔋 Lower battery + BT Connected	Yes	Slow
🔋 Charging Complete	No	N/A
🔋 Charging Complete	Yes	On

FI

Device mode	Bluetooth LED	
	White	Flash
Ⓜ Power on	Yes	Fast
Ⓜ Power off	Yes	Fast
🔋 Lower battery + BT Connected	Yes	Slow
🔋 Lower battery + Bluetooth pairing	Yes	Slow
🔋 Lower battery + BT Connected	Yes	Slow
🔋 Charging Complete	No	N/A
🔋 Charging Complete	Yes	On

SV

Device mode	Bluetooth LED	
	White	Flash
Ⓜ Power on	Yes	Fast
Ⓜ Power off	Yes	Fast
🔋 Lower battery + BT Connected	Yes	Slow
🔋 Lower battery + Bluetooth pairing	Yes	Slow
🔋 Lower battery + BT Connected	Yes	Slow
🔋 Charging Complete	No	N/A
🔋 Charging Complete	Yes	On

DA

Device mode	Bluetooth LED	
	White	Flash
Ⓜ Power on	Yes	Fast
Ⓜ Power off	Yes	Fast
🔋 Lower battery + BT Connected	Yes	Slow
🔋 Lower battery + Bluetooth pairing	Yes	Slow
🔋 Lower battery + BT Connected	Yes	Slow
🔋 Charging Complete	No	N/A
🔋 Charging Complete	Yes	On

PO

Device mode	Bluetooth LED	
	White	Flash
Ⓜ Power on	Yes	Fast
Ⓜ Power off	Yes	Fast
🔋 Lower battery + BT Connected	Yes	Slow
🔋 Lower battery + Bluetooth pairing	Yes	Slow
🔋 Lower battery + BT Connected	Yes	Slow
🔋 Charging Complete	No	N/A
🔋 Charging Complete	Yes	On

HU

Device mode	Bluetooth LED	
	White	Flash
Ⓜ Power on	Yes	Fast
Ⓜ Power off	Yes	Fast
🔋 Lower battery + BT Connected	Yes	Slow
🔋 Lower battery + Bluetooth pairing	Yes	Slow
🔋 Lower battery + BT Connected	Yes	Slow
🔋 Charging Complete	No	N/A
🔋 Charging Complete	Yes	On

RU

Device mode	Bluetooth LED	
	White	Flash
Ⓜ Power on	Yes	Fast
Ⓜ Power off	Yes	Fast
🔋 Lower battery + BT Connected	Yes	Slow
🔋 Lower battery + Bluetooth pairing	Yes	Slow
🔋 Lower battery + BT Connected	Yes	Slow
🔋 Charging Complete	No	N/A
🔋 Charging Complete	Yes	On

PT

Device mode	Bluetooth LED	
	White	Flash
Ⓜ Power on	Yes	Fast
Ⓜ Power off	Yes	Fast
🔋 Lower battery + BT Connected	Yes	Slow
🔋 Lower battery + Bluetooth pairing	Yes	Slow
🔋 Lower battery + BT Connected	Yes	Slow
🔋 Charging Complete	No	N/A
🔋 Charging Complete	Yes	On

E25BT

Quick Start Guide

Guide de démarrage rapide

ID

Device mode	Bluetooth LED	
	White	Flash
Ⓜ Power on	Yes	Fast
Ⓜ Power off	Yes	Fast
🔋 Lower battery + BT Connected	Yes	Slow
🔋 Lower battery + BT Charging	Yes	Slow
🔋 Lower battery + BT Connected	Yes	Slow
🔋 Charging Complete	No	N/A
🔋 Charging Complete	Yes	On

JP

Device mode	Bluetooth LED	
	White	Flash
Ⓜ Power on	Yes	Fast
Ⓜ Power off	Yes	Fast
🔋 Lower battery + BT Connected	Yes	Slow
🔋 Lower battery + BT Charging	Yes	Slow
🔋 Lower battery + BT Connected	Yes	Slow
🔋 Charging Complete	No	N/A
🔋 Charging Complete	Yes	On

KO

Device mode	Bluetooth LED	
	White	Flash
Ⓜ Power on	Yes	Fast
Ⓜ Power off	Yes	Fast
🔋 Lower battery + BT Connected	Yes	Slow
🔋 Lower battery + BT Charging	Yes	Slow
🔋 Lower battery + BT Connected	Yes	Slow
🔋 Charging Complete	No	N/A
🔋 Charging Complete	Yes	On

CHS

Device mode	Bluetooth LED	
	White	Flash
Ⓜ Power on	Yes	Fast
Ⓜ Power off	Yes	Fast
🔋 Lower battery + BT Connected	Yes	Slow
🔋 Lower battery + BT Charging	Yes	Slow
🔋 Lower battery + BT Connected	Yes	Slow
🔋 Charging Complete	No	N/A
🔋 Charging Complete	Yes	On

CHT

Device mode	Bluetooth LED	
	White	Flash
Ⓜ Power on	Yes	Fast
Ⓜ Power off	Yes	Fast
🔋 Lower battery + BT Connected	Yes	Slow
🔋 Lower battery + BT Charging	Yes	Slow
🔋 Lower battery + BT Connected	Yes	Slow
🔋 Charging Complete	No	N/A
🔋 Charging Complete	Yes	On

HE

Device mode	Bluetooth LED	
	White	Flash
Ⓜ Power on	Yes	Fast
Ⓜ Power off	Yes	Fast
🔋 Lower battery + BT Connected	Yes	Slow
🔋 Lower battery + BT Charging	Yes	Slow
🔋 Lower battery + BT Connected	Yes	Slow
🔋 Charging Complete	No	N/A
🔋 Charging Complete	Yes	On

AR

Device mode	Bluetooth LED	
	White	Flash
Ⓜ Power on	Yes	Fast
Ⓜ Power off	Yes	Fast
🔋 Lower battery + BT Connected	Yes	Slow
🔋 Lower battery + BT Charging	Yes	Slow
🔋 Lower battery + BT Connected	Yes	Slow
🔋 Charging Complete	No	N/A
🔋 Charging Complete	Yes	On

E25BT

Quick Start Guide

Guide de démarrage rapide



Specifications

EN

- Driver size
- Dynamic frequency response range
- Driver sensitivity
- Maximum SPL
- Bluetooth spec
- Battery type
- Charging time
- Music play time with BT on
- Dimension W x H x L (mm)
- Weight (kg)

EN

- Driver size
- Dynamic frequency response range
- Driver sensitivity
- Maximum SPL
- Bluetooth spec
- Battery type
- Charging time
- Music play time with BT on
- Dimension W x H x L (mm)
- Weight (kg)

EN

- Driver size
- Dynamic frequency response range
- Driver sensitivity
- Maximum SPL
- Bluetooth spec
- Battery type
- Charging time
- Music play time with BT on
- Dimension W x H x L (mm)
- Weight (kg)

EN

- Driver size
- Dynamic frequency response range
- Driver sensitivity
- Maximum SPL
- Bluetooth spec
- Battery type
- Charging time
- Music play time with BT on
- Dimension W x H x L (mm)
- Weight (kg)

EN

- Driver size
- Dynamic frequency response range
- Driver sensitivity
- Maximum SPL
- Bluetooth spec
- Battery type
- Charging time
- Music play time with BT on
- Dimension W x H x L (mm)
- Weight (kg)

EN

- Driver size
- Dynamic frequency response range
- Driver sensitivity
- Maximum SPL
- Bluetooth spec
- Battery type
- Charging time
- Music play time with BT on
- Dimension W x H x L (mm)
- Weight (kg)

EN

- Driver size
- Dynamic frequency response range
- Driver sensitivity
- Maximum SPL
- Bluetooth spec
- Battery type
- Charging time
- Music play time with BT on
- Dimension W x H x L (mm)
- Weight (kg)

EN

- Driver size
- Dynamic frequency response range
- Driver sensitivity
- Maximum SPL
- Bluetooth spec
- Battery type
- Charging time
- Music play time with BT on
- Dimension W x H x L (mm)
- Weight (kg)

E25BT

Quick Start Guide

Guide de démarrage rapide

EN

- Driver size
- Dynamic frequency response range
- Driver sensitivity
- Maximum SPL
- Bluetooth spec
- Battery type
- Charging time
- Music play time with BT on
- Dimension W x H x L (mm)
- Weight (kg)

EN

- Driver size
- Dynamic frequency response range
- Driver sensitivity
- Maximum SPL
- Bluetooth spec
- Battery type
- Charging time
- Music play time with BT on
- Dimension W x H x L (mm)
- Weight (kg)

EN

- Driver size
- Dynamic frequency response range
- Driver sensitivity
- Maximum SPL
- Bluetooth spec
- Battery type
- Charging time
- Music play time with BT on
- Dimension W x H x L (mm)
- Weight (kg)

EN

- Driver size
- Dynamic frequency response range
- Driver sensitivity
- Maximum SPL
- Bluetooth spec
- Battery type
- Charging time
- Music play time with BT on
- Dimension W x H x L (mm)
- Weight (kg)

EN

- Driver size
- Dynamic frequency response range
- Driver sensitivity
- Maximum SPL
- Bluetooth spec
- Battery type
- Charging time
- Music play time with BT on
- Dimension W x H x L (mm)
- Weight (kg)

EN

- Driver size
- Dynamic frequency response range
- Driver sensitivity
- Maximum SPL
- Bluetooth spec
- Battery type
- Charging time
- Music play time with BT on
- Dimension W x H x L (mm)
- Weight (kg)

EN

- Driver size
- Dynamic frequency response range
- Driver sensitivity
- Maximum SPL
- Bluetooth spec
- Battery type
- Charging time
- Music play time with BT on
- Dimension W x H x L (mm)
- Weight (kg)

EN

- Driver size
- Dynamic frequency response range
- Driver sensitivity
- Maximum SPL
- Bluetooth spec
- Battery type
- Charging time
- Music play time with BT on
- Dimension W x H x L (mm)
- Weight (kg)

E25BT

Quick Start Guide

Guide de démarrage rapide

EN

- Driver size
- Dynamic frequency response range
- Driver sensitivity
- Maximum SPL
- Bluetooth range
- Battery type
- Charging time
- Music play time with BT on
- Dimension W x H x L (mm)
- Weight (kg)

EN

- Driver size
- Dynamic frequency response range
- Driver sensitivity
- Maximum SPL
- Bluetooth range
- Battery type
- Charging time
- Music play time with BT on
- Dimension W x H x L (mm)
- Weight (kg)

EN

- Driver size
- Dynamic frequency response range
- Driver sensitivity
- Maximum SPL
- Bluetooth range
- Battery type
- Charging time
- Music play time with BT on
- Dimension W x H x L (mm)
- Weight (kg)

EN

- Driver size
- Dynamic frequency response range
- Driver sensitivity
- Maximum SPL
- Bluetooth range
- Battery type
- Charging time
- Music play time with BT on
- Dimension W x H x L (mm)
- Weight (kg)

EN

- Driver size
- Dynamic frequency response range
- Driver sensitivity
- Maximum SPL
- Bluetooth range
- Battery type
- Charging time
- Music play time with BT on
- Dimension W x H x L (mm)
- Weight (kg)

E25BT

Quick Start Guide

Guide de démarrage rapide

Торговая марка: JBL

Назначение товара: Пользовательские наушники

Изготовитель: Харман Интернешнл Индастриз Инкорпорейтед, США, 06901 Коннектикут, г.Стэмфорд, Атлантик Стрит 400, офис 1500

Страна происхождения: Китай

Импортер в Россию: ООО "ХАРМАН РУС" «АйЭс», РОССИЯ, 127018, г.МОСКВА, УЛ. ДВИНЦЕВ, Д.12, КОРПУС 1

Гарантийный период: 1 год

Информация о сервисных центрах: www.harman.com/ru тел. +7-800-700-0467

Срок службы: 2 года

Срок хранения: не ограничен

Условия хранения: Стандартные при нормальных значениях климатических факторов внешней среды

Номер документа соответствия: Товар не подлежит обязательной сертификации

Дата производства: Дата изготовления устройства определяется по двум буквенным обозначениям из второй группы символов серийного номера изделия, следующих после разделительного знака. Кодировка соответствует порядку букв латинского алфавита, начиная с января 2010 года: 0000000-MY00000000, где «M» - месяц производства (А - январь, В - февраль, С - март и т.д.) и «Y» - год производства (А - 2010, В - 2011, С - 2012 и т.д.).

Группа	Символ	Символ	Символ
1	0	1	2
2	3	4	5
3	6	7	8
4	9	A	B
5	C	D	E
6	F	G	H
7	I	J	K
8	L	M	N
9	O	P	Q
10	R	S	T
11	U	V	W
12	X	Y	Z
13	AA	AB	AC
14	AD	AE	AF
15	AG	AH	AI
16	AJ	AK	AL
17	AM	AN	AO
18	AP	AQ	AR
19	AS	AT	AU
20	AV	AW	AX
21	AY	AZ	BA
22	BB	BC	BD
23	BE	BF	BG
24	BH	BI	BJ
25	BK	BL	BM
26	BN	BO	BP
27	BQ	BR	BS
28	BT	BU	BV
29	BW	BX	BY
30	BZ	CA	CB
31	CC	CD	CE
32	CF	CG	CH
33	CI	CJ	CK
34	CL	CM	CN
35	CO	CP	CQ
36	CR	CS	CT
37	CU	CV	CW
38	CX	CY	CZ
39	DA	DB	DC
40	DD	DE	DF
41	DG	DH	DI
42	DJ	DK	DL
43	DM	DN	DO
44	DP	DQ	DR
45	DS	DT	DU
46	DV	DW	DX
47	DY	DZ	EA
48	EB	EC	ED
49	EE	EF	EG
50	EH	EI	EJ
51	EK	EL	EM
52	EN	EO	EP
53	EQ	ER	ES
54	ET	EU	EV
55	EW	EX	EY
56	EZ	FA	FB
57	FC	FD	FE
58	FF	FG	FH
59	FI	FJ	FK
60	FL	FM	FN
61	FO	FP	FQ
62	FR	FS	FT
63	FU	FV	FW
64	FX	FY	FZ
65	GA	GB	GC
66	GD	GE	GF
67	GG	GH	GI
68	GJ	GK	GL
69	GM	GN	GO
70	GP	GQ	GR
71	GS	GT	GU
72	GV	GW	GX
73	GZ	HA	HB
74	HC	HD	HE
75	HF	HG	HH
76	HI	HJ	HK
77	HL	HM	HN
78	HO	HP	HQ
79	HR	HS	HT
80	HU	HV	HW
81	HX	HY	HZ
82	IA	IB	IC
83	ID	IE	IF
84	IG	IH	II
85	IJ	IK	IL
86	IM	IN	IO
87	IP	IQ	IR
88	IS	IT	IU
89	IV	IV	IW
90	IX	IY	IZ
91	JA	JB	JC
92	JD	JE	JF
93	JG	JH	JI
94	JJ	JK	JL
95	JM	JN	JO
96	JP	JQ	JR
97	JS	JT	JU
98	JV	JW	JX
99	JZ	KA	KB
100	KC	KD	KE
101	KF	KG	KH
102	KI	KJ	KK
103	KL	KM	KN
104	KO	KP	KQ
105	KR	KS	KT
106	KU	KV	KW
107	KX	KY	KZ
108	LA	LB	LC
109	LD	LE	LF
110	LG	LH	LI
111	LJ	LK	LL
112	LM	LN	LO
113	LP	LQ	LR
114	LS	LT	LU
115	LV	LW	LX
116	LZ	MA	MB
117	MC	MD	ME
118	MF	MG	MH
119	MI	MJ	MK
120	ML	MM	MN
121	MO	MP	MQ
122	MR	MS	MT
123	MU	MV	MW
124	MX	MY	MZ
125	NA	NB	NC
126	ND	NE	NF
127	NG	NH	NI
128	NJ	NK	NL
129	NM	NN	NO
130	NP	NQ	NR
131	NS	NT	NU
132	NV	NW	NX
133	NZ	OA	OB
134	OC	OD	OE
135	OF	OG	OH
136	OI	OJ	OK
137	OL	OM	ON
138	OO	OP	OQ
139	OR	OS	OT
140	OU	OV	OW
141	OX	OY	OZ
142	PA	PB	PC
143	PD	PE	PF
144	PG	PH	PI
145	PJ	PK	PL
146	PM	PN	PO
147	PP	PQ	PR
148	PS	PT	PU
149	PV	PW	PX
150	PZ	QA	QB
151	QC	QD	QE
152	QF	QG	QH
153	QI	QJ	QK
154	QL	QM	QN
155	QO	QP	QQ
156	QR	QS	QT
157	QU	QV	QW
158	QX	QY	QZ
159	RA	RB	RC
160	RD	RE	RF
161	RG	RH	RI
162	RJ	RK	RL
163	RM	RN	RO
164	RP	RQ	RR
165	RS	RT	RU
166	RV	RW	RX
167	RZ	SA	SB
168	SC	SD	SE
169	SF	SG	SH
170	SI	SJ	SK
171	SL	SM	SN
172	SO	SP	SQ
173	SR	SS	ST
174	SU	SV	SW
175	SX	SY	SZ
176	TA	TB	TC
177	TD	TE	TF
178	TG	TH	TI
179	TJ	TK	TL
180	TM	TN	TO
181	TP	TQ	TR
182	TS	TT	TU
183	TV	TW	TX
184	TZ	UA	UB
185	UC	UD	UE
186	UF	UG	UH
187	UI	UJ	UK
188	UL	UM	UN
189	UO	UP	UQ
190	UR	US	UT
191	UU	UV	UW
192	UX	UY	UZ
193	VA	VB	VC
194	VD	VE	VF
195	VG	VH	VI
196	VJ	VK	VL
197	VM	VN	VO
198	VP	VQ	VR
199	VS	VT	VU
200	VV	VW	VX
201	VZ	WA	WB
202	WC	WD	WE
203	WF	WG	WH
204	WI	WJ	WK
205	WL	WM	WN
206	WO	WP	WQ
207	WR	WS	WT
208	WU	WV	WW
209	WX	WY	WZ
210	XA	XB	XC
211	XD	XE	XF
212	XG	XH	XI
213	XJ	XK	XL
214	XM	XN	XO
215	XP	XQ	XR
216	XS	XT	XU
217	XV	XW	XX
218	XZ	YA	YB
219	YC	YD	YE
220	YF	YG	YH
221	YI	YJ	YK
222	YL	YM	YN
223	YO	YP	YQ
224	YR	YS	YT
225	YU	YV	YW
226	YZ	ZA	ZB
227	ZC	ZD	ZE
228	ZF	ZG	ZH
229	ZI	ZJ	ZK
230	ZL	ZM	ZN
231	ZO	ZP	ZQ
232	ZR	ZS	ZT
233	ZU	ZV	ZW
234	ZX	ZY	ZZ

E25BT

Quick Start Guide

Guide de démarrage rapide

Este equipamento opera em caráter secundário, isto é, não tem direito a proteção contra interferência prejudicial, mesmo de estações do mesmo tipo, e não pode causar interferência a sistemas operando em caráter primário"

Este produto está homologado pela ANATEL, de acordo com os procedimentos regulamentados pela Resolução 242/2000, e atende aos requisitos técnicos aplicados.

Para maiores informações, consulte o site da ANATEL - www.anatel.gov.br



(01)07896359541133



The Bluetooth® word mark and logos are registered trademarks owned by Bluetooth SIG, Inc. and any use of such marks by HARMAN International Industries, Incorporated is under license. Other trademarks and trade names are those of their respective owners.