



ENDURANCEPEAK



ENDURANCEPEAK

Quick Start Guide
Guide de démarrage rapide

1 What's in the box

Slave

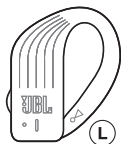

Master

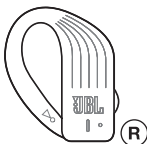

Charging case

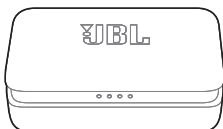

Ear tips

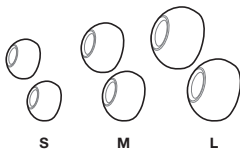

Enhancers

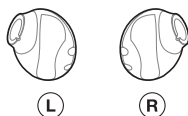

Charging cable



Warranty card, Warning card, Safety sheet, QSG



ENDURANCEPEAK

Quick Start Guide
Guide de démarrage rapide

2 Overview

2.1 Touch control panel & LEDs

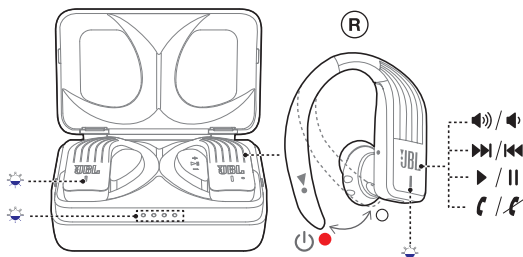

* All touch controls are on the Master Earbud (R).

2.2 Charging

Fully charge the earbuds along with the charging case before the first use.
Charging case is for charging the earbuds only.

a. Charging the case

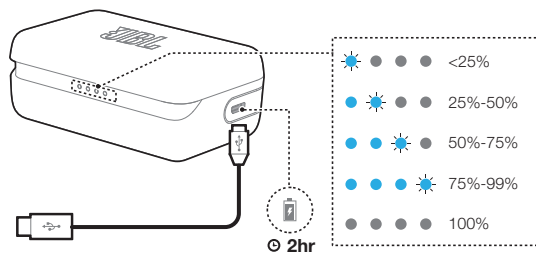

ENDURANCEPEAK

Quick Start Guide

Guide de démarrage rapide

b. Charging the earbuds

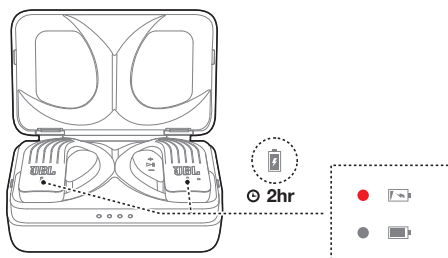

3

Wearing the headphone

1. Select the ear tips.

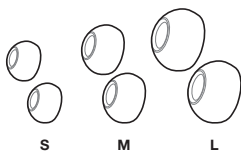

2. Attach the enhancers and ear tips onto the earbuds.

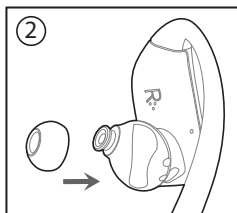
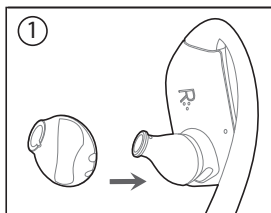

ENDURANCEPEAK

Quick Start Guide

Guide de démarrage rapide

3. TWISTLOCK™ Technology

Insert the earphones downwards into your ear. Twist backwards to lock in place. Adjust for comfort.

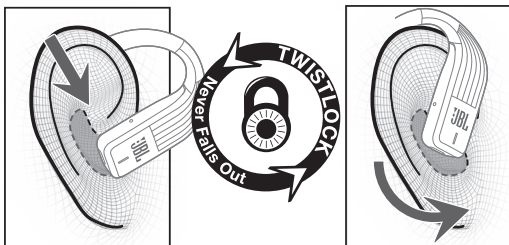

4

POWERHOOK™: Automatic Power On/Off

1. Take out the master earbud (R) from the charging case and unhook **POWERHOOK™**, it will power on and enter device pairing mode.

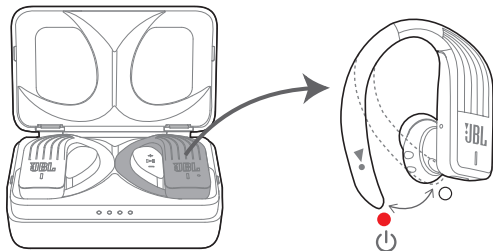

ENDURANCEPEAK

Quick Start Guide

Guide de démarrage rapide

2. Take out the slave earbud (L) from the charging case, it will power on and automatically connect with the master.

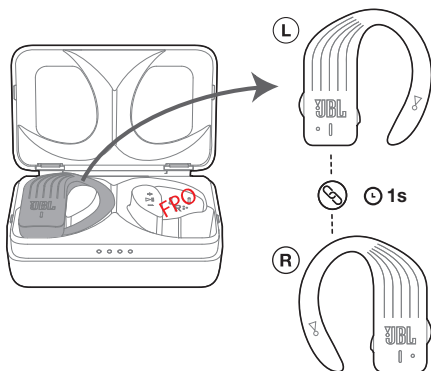

3a. Standby mode

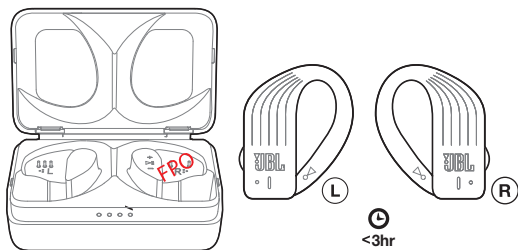

* You can keep the earbuds standby up to 3 hours without the case, then put them back into the case for charging.

ENDURANCE PEAK

Quick Start Guide

Guide de démarrage rapide

3b. To completely power off the earbuds, return them back to the charging case.

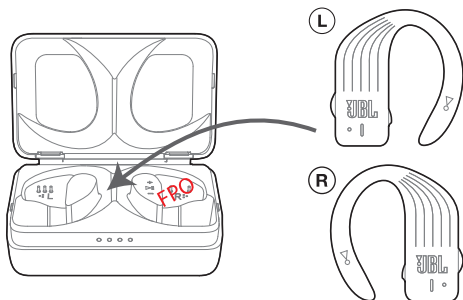

5 Bluetooth pairing

5.1 If connecting for the first time, the earbuds will enter Bluetooth pairing mode automatically after they are powered on.

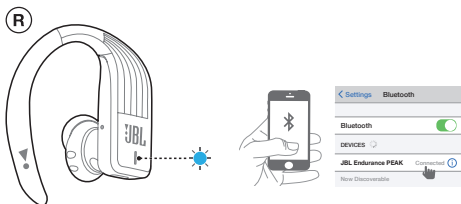

ENDURANCEPEAK

Quick Start Guide

Guide de démarrage rapide

5.2 To pair a new device, tap once, tap again and hold the touch control panel on master earbud for 5 seconds.

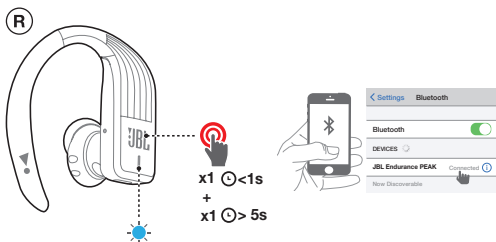

6 Controlling Music

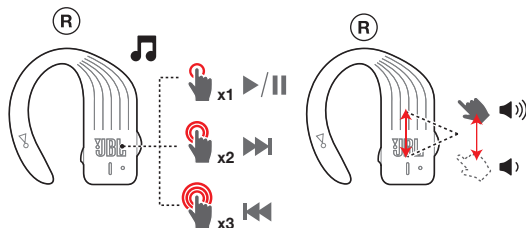

7 Managing Phone Calls

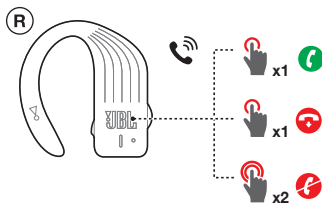

ENDURANCE PEAK

Quick Start Guide

Guide de démarrage rapide

8 Mono mode

Use the master earbud only and put the slave back into the charging case.

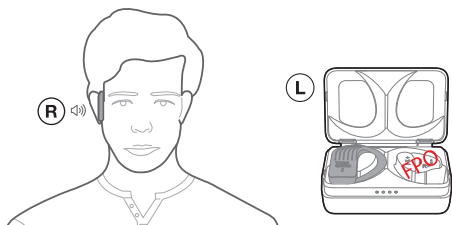

9 LED behaviour



● On Ⓞ Power on/off (L/R)

⚡ Slow 🔋 Low battery (L/R)

● Solid 🔋 Charging (L/R)

● Off 🔋 Full charging (L/R)

⚡ Fast ✎ TWS pairing (L/R) /
Bluetooth pairing (R)

● Solid ✎ TWS connected (L/R) /
Bluetooth connected (R)

10 Specifications

EN

- Model: JBL ENDURANCE PEAK
- Bluetooth version: 4.2
- Support: A2DP V1.3, AVRCP V1.5, HFP V1.6
- Headset Battery type: Lithium-ion polymer (3.7V, 85mA)
- Bluetooth transmitter power < 9.5dBm
- Bluetooth transmitter frequency range: 2.402 – 2.480GHz
- Bluetooth transmitter modulation: GFSK, $\pi/4$ DQPSK, 8DPSK
- Dynamic drivers: 5.6mm

ENDURANCEPEAK

Quick Start Guide

Guide de démarrage rapide

- Frequency Response: 10Hz – 22 kHz
- Charging case battery: 1,500 mA (est)
- Earbuds Battery life: Up to 4 hours
- Charging time: < 2 hours
- Compatibility: Use with Phones, Tablets, Computers



Торговая марка	:	JBL
Назначение товара	:	Пользовательские наушники
Изготовитель	:	Харман Интернешнл Индастриз Инкорпорейтед, США, 06901 Коннектикут, г.Стэмфорд, Атлантик Стрит 400, офис 1500
Страна происхождения	:	Китай
Импортер в Россию	:	ООО "ХАРМАН РУС СиАйЭс", Россия, 127018, г.Москва, ул. Двинцев, д.12, к 1
Гарантийный период	:	1 год
Информация о сервисных центрах	:	www.harman.com/ru тел. +7-800-700-0467
Срок службы	:	2 года



Товар сертифицирован :
Дата производства : Дата изготовления устройства определяется по двум буквенным обозначениям из второй группы символов серийного номера изделия, следующих после разделительного знака «-». Кодировка соответствует порядку букв латинского алфавита, начиная с января 2010 года: 000000-МУ0000000, где «М» - месяц производства (А - январь, В - февраль, С - март и т.д.) и «У» - год производства (А - 2010, В - 2011, С - 2012 и т.д.).

IC RF Exposure Information and Statement

The SAR limit of Canada (C) is 1.6 W/kg averaged over one gram of tissue. Device types: (IC: 6132A-JBLENPEAK) has also been tested against this SAR limit According to this standard, the highest SAR value reported during product certification for head use is 0.049 W / kg. The device was tested for typical bodily operations where the product was kept 5 mm from the head.

To maintain compliance with IC RF exposure requirements, use accessories that maintain a separation distance of 0mm between the user's head and the back of the headset. The use of belt clips, holsters and similar accessories shall not contain metal parts in its assembly. Use of accessories that do not meet these requirements may not comply with IC RF exposure requirements and should be avoided.

Head operation

The device was subjected to a typical head manipulation test. In order to comply with RF exposure requirements, a minimum separation distance of 0 cm must be maintained between the user's ear and the product (including the antenna). Head exposure that do not meet these requirements may not meet RF exposure requirements and should be avoided. Use only the supplied or approved antenna.

ENDURANCEPEAK

Quick Start Guide

Guide de démarrage rapide

IC: 6132A-JBLENPEAK

Informations et énoncés sur l'exposition RF de l'IC.

La limite DAS du Canada (C) est de 1,6 W/kg, arrondie sur un gramme de tissu. Types d'appareils:

(IC: 6132A-JBLENPEAK) a également été testé en relation avec cette limite DAS selon ce standard.

La valeur DAS la plus élevée mesurée pendant la certification du produit pour une utilisation au niveau de la tête est de 0,049 W / kg.

L'appareil a été testé dans des cas d'utilisation typiques en relation avec le corps, où le produit a été utilisé à 5 mm de la tête. Pour continuer à respecter les standards d'exposition RF de l'IC, utilisez des accessoires qui maintiennent une distance de séparation de 0 mm entre la tête de l'utilisateur et l'arrière du casque. L'utilisation de clips de ceinture, d'étui ou d'accessoires similaires ne doivent pas contenir de pièces métalliques. Les accessoires ne respectant pas ces exigences peuvent ne pas respecter les standards d'exposition RF de l'IC et doivent être évités.

Utilisation au niveau de la tête

L'appareil est testé dans un cas d'utilisation typique autour de la tête. Pour respecter les standards d'exposition RF, une distance de séparation minimum de 0 cm doit être maintenue entre l'oreille et le produit (antenne comprise). L'exposition de la tête ne respectant pas ces exigences peut ne pas respecter les standards d'exposition RF et doit être évité. Utilisez uniquement l'antenne incluse ou une antenne certifiée.

IC: 6132A-JBLENPEAK

FCC AND IC STATEMENT FOR USERS

THIS DEVICE COMPLIES WITH PART 15 OF THE FCC RULES. OPERATION IS SUBJECT TO THE FOLLOWING TWO CONDITIONS: (1) THIS DEVICE MAY NOT CAUSE HARMFUL INTERFERENCE, AND (2) THIS DEVICE MUST ACCEPT ANY INTERFERENCE RECEIVED, INCLUDING INTERFERENCE THAT MAY CAUSE UNDESIRE OPERATION. CAN ICES-3 (B) / NMB-3 (B).

FEDERAL COMMUNICATION COMMISSION INTERFERENCE STATEMENT

THIS EQUIPMENT HAS BEEN TESTED AND FOUND TO COMPLY WITH THE LIMITS FOR A CLASS B

DIGITAL DEVICE, PURSUANT TO PART 15 OF THE FCC RULES. THESE LIMITS ARE DESIGNED TO PROVIDE REASONABLE PROTECTION AGAINST HARMFUL INTERFERENCE IN A RESIDENTIAL INSTALLATION. THIS EQUIPMENT GENERATES, USES AND CAN RADIATE RADIO FREQUENCY ENERGY AND, IF NOT INSTALLED AND USED IN ACCORDANCE WITH THE INSTRUCTIONS, MAY CAUSE HARMFUL INTERFERENCE TO RADIO COMMUNICATIONS. HOWEVER, THERE IS NO GUARANTEE THAT INTERFERENCE WILL NOT OCCUR IN A PARTICULAR INSTALLATION. IF THIS EQUIPMENT DOES CAUSE HARMFUL INTERFERENCE TO RADIO OR TELEVISION RECEPTION, WHICH CAN BE DETERMINED BY TURNING THE EQUIPMENT OFF AND ON, THE USER IS ENCOURAGED TO TRY TO CORRECT THE INTERFERENCE BY ONE OR MORE OF THE FOLLOWING MEASURES:

- REORIENT OR RELOCATE THE RECEIVING ANTENNA.
- INCREASE THE SEPARATION BETWEEN THE EQUIPMENT AND RECEIVER.
- CONNECT THE EQUIPMENT INTO AN OUTLET ON A CIRCUIT DIFFERENT FROM THAT TO WHICH THE RECEIVER IS CONNECTED.
- CONSULT THE DEALER OR AN EXPERIENCED RADIO/TV TECHNICIAN FOR HELP.

ENDURANCEPEAK

Quick Start Guide

Guide de démarrage rapide

INSTRUCTIONS FOR USERS ON REMOVAL, RECYCLING AND DISPOSAL OF USED BATTERIES

FOR PRODUCTS WITH A BUILT-IN BATTERY THAT LASTS FOR THE LIFETIME OF THE PRODUCT, REMOVAL MAY NOT BE POSSIBLE FOR THE USER. IN THIS CASE, RECYCLING OR RECOVERY CENTERS HANDLE THE DISMANTLING OF THE PRODUCT AND THE REMOVAL OF THE BATTERY. IF, FOR ANY REASON, IT BECOMES NECESSARY TO REPLACE SUCH A BATTERY, THIS PROCEDURE MUST BE PERFORMED BY AUTHORIZED SERVICE CENTERS.

IN THE EUROPEAN UNION AND OTHER LOCATIONS, IT IS ILLEGAL TO DISPOSE OF ANY BATTERY WITH HOUSEHOLD TRASH. ALL BATTERIES MUST BE DISPOSED OF IN AN ENVIRONMENTALLY SOUND MANNER. CONTACT YOUR LOCAL WASTE-MANAGEMENT OFFICIALS FOR INFORMATION REGARDING THE ENVIRONMENTALLY SOUND COLLECTION, RECYCLING AND DISPOSAL OF USED BATTERIES.

WARNING: DANGER OF EXPLOSION IF BATTERY IS INCORRECTLY REPLACED. TO REDUCE RISK OF FIRE OR BURNS, DON'T DISASSEMBLE, CRUSH, PUNCTURE, SHORT EXTERNAL CONTACTS, EXPOSE TO TEMPERATURE ABOVE 60°C (140°F), OR DISPOSE OF IN FIRE OR WATER. REPLACE ONLY WITH SPECIFIED BATTERIES.

THE SYMBOL INDICATING 'SEPARATE COLLECTION' FOR ALL BATTERIES AND ACCUMULATORS SHALL BE THE CROSSED-OUT WHEELED BIN SHOWN BELOW:



IN CASE OF BATTERIES, ACCUMULATORS AND BUTTON CELLS CONTAINING MORE THAN 0.0005% MERCURY, MORE THAN 0.002% CADMIUM OR MORE THAN 0.004% LEAD, SHALL BE MARKED WITH THE CHEMICAL SYMBOL FOR THE METAL CONCERNED: Hg, Cd, OR Pb RESPECTIVELY. PLEASE REFER TO THE BELOW SYMBOL:



Pb



Cd



Hg

WARNING

DO NOT ATTEMPT TO OPEN, SERVICE, OR DISASSEMBLE THE BATTERY | DO NOT SHORT CIRCUIT | MAY EXPLODE IF DISPOSED OF IN FIRE | RISK OF EXPLOSION IF BATTERY IS REPLACED BY AN INCORRECT TYPE | DISPOSE OR RECYCLE USED BATTERIES ACCORDING TO THE INSTRUCTIONS

低功率射頻電機警語標示內容：「(1)經型式認證合格之低功率射頻電機，非經許可，公司、商號或使用者均不得擅自變更頻率、加大功率或變更原設計之特性及功能。(2)低功率射頻電機之使用不得影響飛航安全及干擾合法通信；經發現有干擾現象時，應立即停用，並改善至無干擾時方得繼續使用。前項合法通信，指依電信法規定作業之無線電通信。低功率射頻電機須忍受合法通信或工業、科學及醫療用電波輻射性電機設備之干擾。」

해당무선설비는전파혼신가능성이있으므로인명안전과관련된서비스는할수없음
Este equipamento não tem direito à proteção contra interferência prejudicial e não pode causar interferência em sistemas devidamente autorizados.

ENDURANCEPEAK

Quick Start Guide

Guide de démarrage rapide

Este produto está homologado pela ANATEL, de acordo com os procedimentos regulamentados pela Resolução 242/2000, e atende aos requisitos técnicos aplicados.

Para maiores informações, consulte o site da ANATEL – HYPERLINK
“<http://www.anatel.gov.br>”

ENDURANCEPEAK

Quick Start Guide
Guide de démarrage rapide



The Bluetooth® word mark and logos are registered trademarks owned by Bluetooth SIG, Inc. and any use of such marks by HARMAN International Industries, Incorporated is under license. Other trademarks and trade names are those of their respective owners.

