



Link 10



Product Tour

Front

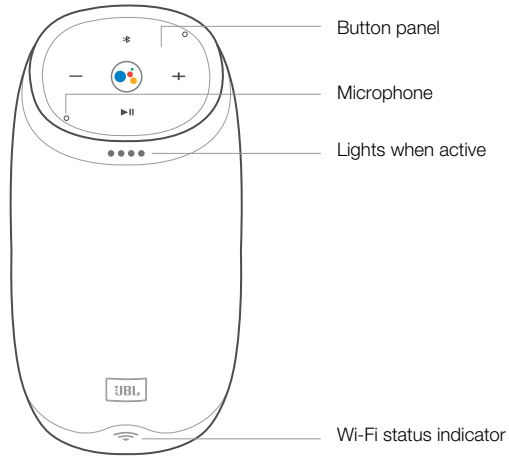

Top

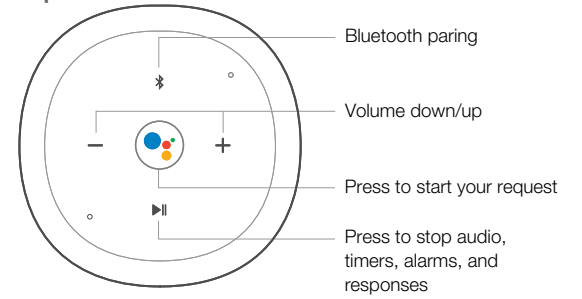

Back

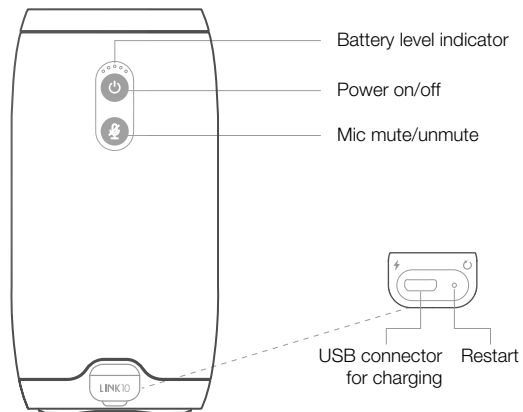

Micro USB cable



For more product information, please visit jbl.com

Get Started

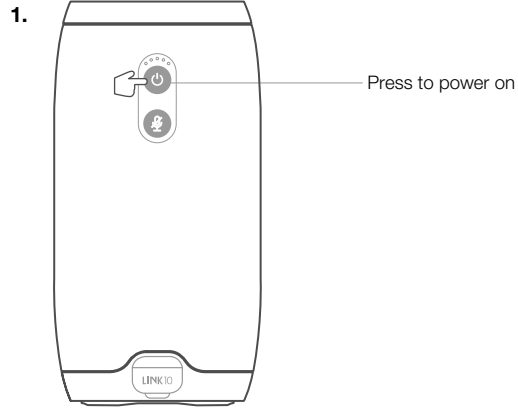

2.



Download and run the Google Home app on a phone or tablet.
Set up your JBL Link 10 in the **Google Home app**.

IPX 7 Waterproof

JBL Link 10 is IPX7 waterproof.

IPX7 waterproof is defined as the speaker can be immersed in water up to 1m for up to 30 minutes.

IMPORTANT: To ensure that the JBL Link 10 is waterproof, please remove all cable connections and tightly close the cap; exposing the JBL Link 10 to liquids without doing so may result in permanent damage to the speaker. And do not expose JBL Link 10 to water while charging, as doing so may result in permanent damage to the speaker or power source.

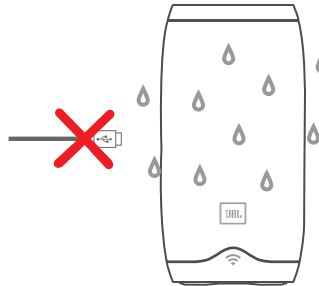

Specification

- Transducer: 2 x 40mm
- Output power: 2 x 8W
- Frequency response: 70Hz-20kHz
- Signal-to-noise ratio: >80dB
- Battery type: Lithium-ion Polymer (3.7V, 4000mAh)
- Battery charge time: 4 hours @5V 1A
- Music play time: up to 5 hours (varies by volume level and content)
- Wireless network: 802.11b/g/n/ac (2.4/5GHz)
- Bluetooth version: 4.1
- Supported audio formats: HE-AAC, LC-AAC, MP3, Vorbis, WAV (LPCM), FLAC, Opus
- Dimensions (Dia x H): 86 x 169 mm
- Weight: 670g



The Wi-Fi CERTIFIED Logo is a certification mark of the Wi-Fi Alliance. The Wi-Fi Protected Setup Identifier Mark is a mark of the Wi-Fi Alliance.

The Bluetooth® word mark and logos are registered trademarks owned by Bluetooth SIG, Inc. and any use of such marks by HARMAN International Industries, Incorporated is under license. Other trademarks and trade names are those of their respective owners.

Chromecast is a trademark of Google Inc. Google Play, and the Google Play logo are trademarks of Google Inc.

This equipment complies with FCC/IC RSS-102 radiation exposure limits set forth for an uncontrolled environment. This equipment should be installed and operated with minimum distance 20cm between the radiator & your body.

ce matériel est conforme aux limites de dose d'exposition aux rayonnements, fac / ic rss-102 énoncée dans un autre environnement.cette equipment devrait être installé et exploité avec distance minimale de 20 entre le radiateur et votre corps.