

Full-Size Tri-folding Aluminium Keyboard for Android/Windows/iOS User Manual Model:HB099



Package Contents

- 1.Foldable Aluminium Keyboard
- 2.User Manual
- 3.Micro USB Cable (charging cable for keyboard only)

Keyboard Characteristics:

- 1) High-tech tri-folding seamless design
- 2) Ultrathin and portable, convenient to carry
- 3) Automatic magnetic power on/off
- 4) Full-size keyboard layout
- 5) Suitable for Bluetooth enabled iOS/Windows/Android system devices
- 6) For keyboard with Bluetooth
 - ① Fn+ switch to Bluetooth connection.
- 7) Keyboard USB connecting for charging, easy to use
- 8) Built-in USA BOARDCOM Bluetooth module 3.0
- 9) Rechargeable lithium battery, 3 years of life time
- 10) Energy saving under the sleep mode
- 11) Front material: ABS. Backboard: imported aluminum alloy
- 12) Scissor feet construction, light weight, quiet keystrokes
- 13) For more option: welcome to buy this keyboard with 3-color changeable backlights, easily typing in darkness. Welcome to buy custom-fitted storage case, converts into device stand.

①

Indicator Lights Description

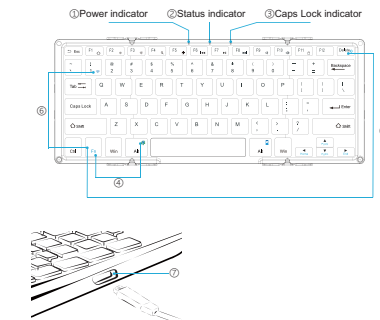

- ① Power indicator: Green light will turn on for 10s
Charging indicator: Red light will turn on when in charging and turns off once fully charged. Battery Low indicator: Red light will flash when it is time to charge. Battery capacity indicator: Press Fn+ , green light is blinking (every blinking represents 25% battery)
- ② Bluetooth Pairing Indicator: Blinking blue lights while waiting for pairing. Pair successfully will turn off.
- ③ Capslock Indicator: Blue light is on.
- ④ Backlit on/off
- ⑤ Bluetooth pairing
- ⑥ Switch to Bluetooth connection
- ⑦ Micro interface for charging

②

Bluetooth and USB Function Introduction

1. Bluetooth connection: for devices which are bluetooth enabled, for example, tablets smartphones, etc.
2. USB connection: for charging

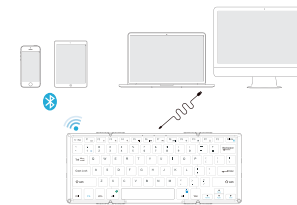

Connection Devices Steps.

I. Connect with Bluetooth devices.

- Step 1. Power the keyboard on by unfolding it. [Power] GREEN light stays on for 10s and [Status] light is blinking. The keyboard now is detectable by other Bluetooth devices.
- Step 2. On your devices, searching for keyboard pairing name " "
- Step 3. Select the pairing name. The blue LED stop blinking, indicating successfully pairing.
- Step 4. Press Fn+ Enjoy your wireless technology lifestyle.

③

Note:

1. After Bluetooth pairing for the first time, your devices will connect to keyboard automatically when opening the keyboard. The [Status] light stays blue instead of blinking.
2. If keyboard is not Bluetooth connected in 3 minutes or 10s, it will stop connecting. Please repeat the connection steps.
3. Without memory function under wired connection, keyboard needs to repeat the connection steps once disconnected with device.
4. Able to connect with a Bluetooth and a wired devices simultaneously, and switch simply.
 - ① Fn+ switch to wireless connection, [State] is BLUE
5. Press Fn+Helt "shlt"+right "shilt" [Caps] and [Status] light simultaneously blink once then turn off, keyboard is reset.

Function keys

	iOS	Android	Windows	FN+Shift on Windows
	Back	Back	Esc	N/A
	Home	Home	F1	Web Browser
	Decrease	N/A	F2	Decrease
	Increase	N/A	F3	Increase
	Search	Search	F4	Search
	Switch language	N/A	F5	Switch language

④

	iOS	Android	Windows	FN+Shift on Windows
	Previous track	Previous track	F6	Previous track
	Play/pause	Play/pause	F7	Play/pause
	Next track	Next track	F8	Next track
	Volume down	Volume down	F9	Volume down
	Volume up	Volume up	F10	Volume up
	Lock	Lock	F11	N/A
	N/A	N/A	F12	N/A
	Delete	Delete	Delete	
	Swift to Bluetooth connection	Swift to Bluetooth connection	Swift to Bluetooth connection	
	Backlit on/off	Backlit on/off	Backlit on/off	
	Battery capacity	Battery capacity	Battery capacity	
	Bluetooth pairing	Bluetooth pairing	Bluetooth pairing	
	Page up	Page up	Page up	
	Page down	Page down	Page down	
	Line head	Line head	Line head	
	Line ending	Line ending	Line ending	

Keyboard specification

1. Standard MICRO Interface
2. Operating distance is up to 10 meters
3. Modulation system: GFSK
4. Operation voltage: 3.1-4.2V
5. Operation current: $\leq 3.0\text{mA}$
6. Standby current: 0.3mA
7. Sleeping current: $\leq 40\mu\text{A}$
8. Charging current: $\leq 200\text{mA}$

⑤

9. Standby time: ≤ 218 days
10. Lithium battery capacity: 210mAh (Backlit Lithium battery capacity: 750mAh)
11. Charge time: ≤ 2 hours (for 210mAh battery), 3.5 hours (for 750mAh battery)
12. Uninterrupted working time: ≥ 84 hours (standby time with backlit: 5 hours)
13. Lithium battery specification: 30*2.5*35mm (Backlit Lithium battery specification: 3.0*43*55mm)
14. Keying force: 60 \pm 10g
15. Key life: 3 million strokes
16. Operating temperature: -10 \pm 55 $^{\circ}\text{C}$
17. Keyboard size: 165 x 120 x 14.7 mm

Energy Saving mode

Keyboard will be sleeping after idle for 10 minutes (1 minute for backlit keyboard). To activate it, press any key and wait for 3 seconds.

Charging the Keyboard

When [power] RED light is flashing, it's time to charge it.
To charge this keyboard, please connect it to a free USB port on your PC or USB AC adapter using the cable that comes with the keyboard.
(Output: DC5.0V/500mA)
Red light will turn on when in charging and turns off once fully charged.

Battery

The long-lasting rechargeable battery can service you for several weeks normal use. With no memory effect, the lithium battery can be charged at any time.
In order to extend service life, we recommend you turn the keyboard power off when there is long time with no interactive.

Safety Caution

- 1) Keep the keyboard away from sharp objects.
- 2) Do not place heavy object on the keyboard.
- 3) Do not Microwave the keyboard.
- 4) Do not force or distorted the keyboard
- 5) Keep away from oil, chemical or any other organic liquid.

⑥

Cleaning

Clean the keyboard with dry cloth, alcohol or alcohol based disinfectant.

Troubleshooting

A. Unable to connect

- 1) Make sure the keyboard is on.
- 2) Make sure the keyboard is in operating distance (within 10 meters).
- 3) Make sure the battery can work (right director is blinking red, need to charge the keyboard).
- 4) Make sure the tablet and keyboard bluetooth function is turned on.

B. Unable to Charge Keyboard

- 1) Make sure the USB cable is connected properly and correctly to the keyboard and the power source.
 - 2) make sure the wall charger is plug into the power outlet.
- Warm warning: the output voltage and current of power adapter cannot surpass DC5.0V, 500mA or it will damage the battery and keyboard.

⑦

NOTE: This equipment has been tested and found to comply with the limits for a Class B digital device, pursuant to part 15 of the FCC Rules. These limits are designed to provide reasonable protection against harmful interference in a residential installation. This equipment generates, uses and can radiate radio frequency energy and, if not installed and used in accordance with the instructions, may cause harmful interference to radio communications. However, there is no guarantee that interference will not occur in a particular installation. If this equipment does cause harmful interference to radio or television reception, which can be determined by turning the equipment off and on, the user is encouraged to try to correct the interference by one or more of the following measures:

- Reorient or relocate the receiving antenna.
- Increase the separation between the equipment and receiver.
- Connect the equipment into an outlet on a circuit different from that to which the receiver is connected.
- Consult the dealer or an experienced radio/TV technician for help.

This device complies with part 15 of the FCC rules. Operation is subject to the following two conditions:

- (1) this device may not cause harmful interference, and
- (2) this device must accept any interference received, including interference that may cause undesired operation.

Changes or modifications to this unit not expressly approved by the party responsible for compliance could void the user's authority to operate the equipment.