

**Patent Pending**

**MODEL: SFE-26**

**BUILDER BOX**

**INSTALLER / CONSUMER  
SAFETY INFORMATION**

**PLEASE READ THIS MANUAL  
BEFORE INSTALLING AND  
USING APPLIANCE**

**WARNING**  
**IF THE INFORMATION IN THIS  
MANUAL IS NOT FOLLOWED  
EXACTLY, AN ELECTRICAL  
SHOCK OR FIRE MAY RESULT,  
CAUSING PROPERTY DAMAGE,  
PERSONAL INJURY OR LOSS  
OF LIFE**

**FOR YOUR SAFETY**

**SERVICE MUST BE  
PERFORMED BY A QUALIFIED  
SERVICE AGENCY.**

**DO NOT STORE OR USE  
GASOLINE OR OTHER  
FLAMMABLE VAPORS AND  
LIQUIDS IN THE VICINITY OF  
THIS OR ANY OTHER  
APPLIANCE.**

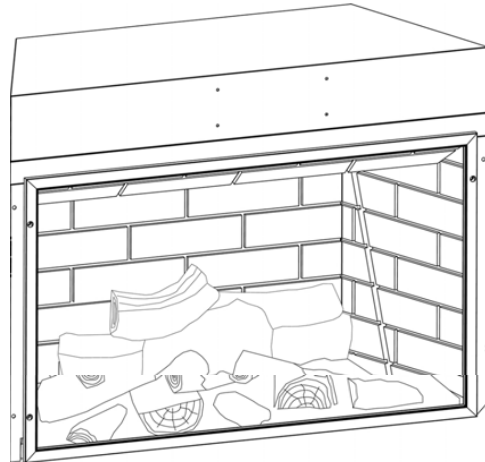

TUV LISTED AS SFE-26

**Homeowner's Installation &  
Operating Manual**

NOTE: The device complies with Part 15 of the FCC Rules. Operation is subject to the following two conditions:

1. This device may not cause harmful interference, and
2. This device must accept any interference received, including interference that may cause undesired operation.

ANSI / UL 2021. FIXED OR LOCATION DEDICATED ELECTRIC ROOM HEATER.  
**INSTALLER: DO NOT DISCARD THIS MANUAL— LEAVE FOR HOME OWNER  
SAVE THESE INSTRUCTIONS FOR FUTURE REFERENCE.**

# Congratulations!

Congratulations on selecting a Simplifyre electric fireplace. The unit you have selected is designed to provide the utmost in safety, reliability and efficiency.

As the owner of a new fireplace, you'll want to read and carefully follow all of the instructions contained in this owner's manual. Pay special attention to all cautions and warnings.

This owner's manual should be retained for future reference. We suggest you keep it with your other important documents and product manuals.

The information contained in this owner's manual unless noted otherwise, applies to all models.

Your new Simplifyre electric fireplace will give you years of durable use and trouble-free enjoyment.

Welcome to the Hearth & Home Technologies family of fireplace products!

## TABLE OF CONTENTS

**PLEASE READ THE INSTALLATION & OPERATION INSTRUCTIONS BEFORE USING THIS APPLIANCE.**

<b>Important Instructions</b>	3
Unpacking	4
Locating Your Electric Fireplace	4
Clearance to Combustibles	4
Electrical Specifications	4
Framing	4
Hardwire Electrical Connections	4
Optional-Wall switch/Thermostat	4
Finishing	4
<b>Framing Dimensions</b>	5
<b>Operating Instructions</b>	6
Remote Control Initialization	6
<b>Electrical Wiring Diagram</b>	7
<b>Service Instructions</b>	7
Replacing the Light Bulb	7
Screen Cleaning	7
Maintenance of Motors	7
<b>Replacement Parts</b>	
Replacement Parts List	8
<b>Warranty</b>	9

**⚠ WARNING**



**Fire Risk**

- **Do not** install or operate damaged heater.
- **Do not** modify heater.
- Installation other than as instructed by Hearth & Home Technologies Inc. is strictly prohibited.
- **Do not** operate the heater without fully assembling all components.
- Installation and/or use of any component part not approved by Hearth & Home Technologies.

Hearth & Home Technologies disclaims any responsibility for, and the warranty and agency listing will be voided by the above actions.

**⚠ WARNING**

Improper installation, adjustment, alteration, service or maintenance can cause injury or property damage. Refer to the owner's information manual provided with this heater. For assistance or additional information consult a qualified installer, service agency or your dealer.

**Not intended for use as a primary heat source.**

It should not be factored as a primary heat source in residential heating calculations.

### IMPORTANT INSTRUCTIONS

When using electrical heaters, basic precautions should always be followed to reduce the risk of fire, electric shock and injury to persons, including the following:

- Read all instructions before using this heater.
- This heater is hot when in use. To avoid burns, do not let bare skin touch hot surfaces. If provided, use handles when moving this heater. Keep combustible materials, such as furniture, pillows, bedding, papers, clothes and curtains away from sides and rear of heater, and at least 36 in. (914 mm) from the front.
- Extreme caution is necessary when any heater is used by or near children or invalids and whenever the heater is left operating and unattended.
- Always unplug heater when not in use.
- Do not operate any heater with a damaged cord or plug or after the heater malfunctions, has been dropped or damaged in any manner. Return heater to authorized service facility for examination, electrical or mechanical adjustment, or repair.
- Do not use outdoors.
- This heater is not intended for use in bathrooms, laundry areas and similar indoor locations. Never locate heater where it may fall into a bathtub or other water container.
- Do not run cord under carpeting. Do not cover cord with throw rugs, runners, or the like. Arrange cord away from traffic areas and where it will not be tripped over. Do not coil cord.
- To disconnect heater, turn controls to "OFF" then remove plug from outlet.
- Do not insert or allow foreign objects to enter any ventilation or exhaust opening as this may cause an electric shock or fire, or damage the heater.

- To prevent a possible fire, do not block air intakes or exhaust in any manner.
- An heater has hot and arcing or sparking parts inside. Do not use it in areas where gasoline, paint, or flammable liquids are used or stored.
- Use this heater only as described in this manual. Any other use not recommended by the manufacturer may cause fire, electric shock, or injury to persons.
- Always use properly grounded, fused and polarized outlets.
- Always use ground fault protection where required by electrical code.
- Always disconnect power before performing any cleaning, maintenance or relocation of the heater.
- To prevent a possible fire, do not burn wood or other materials in this heater.
- To prevent electric shock or fire, always use a certified electrician should new circuits or outlets be required.
- When transporting or storing the heater, keep in a dry place free from excessive vibration and store as to avoid damage.
- **SAVE THESE INSTRUCTIONS FOR FUTURE REFERENCE.**
- Changes or modification not expressly approved by the party responsible for compliance could void the user's authority to operate the equipment.

## UNPACKING THE UNIT

### WARNING

Do not use this fireplace if any part of it has been under water. Immediately call a qualified service technician to inspect and replace any of the electrical system if necessary.

Carefully remove packaging from the unit. The front screen is held in place with four Phillips head screws. To remove the screen, extract the screws. Grasp the screen frame and pull out.

## LOCATING YOUR ELECTRIC FIREPLACE

Your new electric fireplace may be installed virtually anywhere in your home. However, when choosing a location ensure that the general instructions are followed. For best results, install out of direct sunlight.

Power supply service must be either completed or placed within the heater prior to finishing to avoid reconstruction.

Protective cover may stay on during framing, but must be removed before final finishing. Once final finishing has been completed, the protective cover can be used to protect the heater until final

### CLEARANCE TO COMBUSTIBLES

Sides.....0 inches 0 mm

Floor.....0 inches 0 mm

Top.....0 inches 0 mm

Back.....0 inches 0 mm

## FRAMING

1. Choose a fireplace location and frame as shown in fig. 1
2. Frame in the fireplace with a header across the top.
3. It is important to allow for finished face when setting the depth of the frame.
4. If a hearth system or raised hearth is to be installed, The unit **MUST** be raised to provide service access and use of optional fronts.
5. The fireplace can now be positioned in the opening.
6. Level it with shims if necessary, and attach the unit to the frame using the nailing flanges provided.

## ELECTRICAL SPECIFICATIONS

Voltage: 120 V AC, 60 Hz  
Total Amps: 11.25 AMP  
Total Watts: 1350 Watts  
Heater Rating: 1300 Watts/4415 BTU

## HARDWIRE ELECTRICAL CONNECTIONS

### WARNING

Electrical wiring must comply with local building codes and other applicable regulations to reduce the risk of fire, electrical shock and injury .

### NOTE:

**All wiring must be completed prior to finishing the unit.**

For supply connections use No. 14 AWG or larger wires. Use copper wire only. Connect only to a 15 AMP branch circuit. A dedicated circuit is recommended as other appliances on the circuit may cause the breaker to trip or fuse to blow when the heater is operating.

1. Remove the screws securing the junction block cover.
2. Wire to a properly grounded, 120 volt, 60 Hz, 15 AMP circuit
3. Ensure all junction block connections are tight.
4. Replace the cover and retaining screws.
5. Plug in the IEC-320-C14 power plug to the IEC-320-C13 power inlet located on the upper right side of the unit.
6. All components and wiring may be inspected by removing the top inter-panel through the fireplace front opening.

## WALL SWITCH AND THERMOSTAT CONNECTIONS

**WARNING:** Do NOT connect the optional low voltage switch and/or thermostat to 120 volt branch circuit.

The Optional Wall Switch 4050-309 contains two single pole switches. ( LEVITON 5634 Series or equal)  
The Optional Wall Thermostat is a low voltage mechanical type. ( Columbus Electric RK120EAA or equal).

Maximum run distance is 30' with 20 gauge solid copper low voltage thermostat wire. Connect per the Electrical wiring diagram on page 7.

## FINISHING

Combustible or non-combustible materials may be used to finish up to the fireplace opening.

### NOTE:

Ensure that you leave adequate room to remove and replace the front screen or optional front.

# FIREPLACE DIMENSIONS

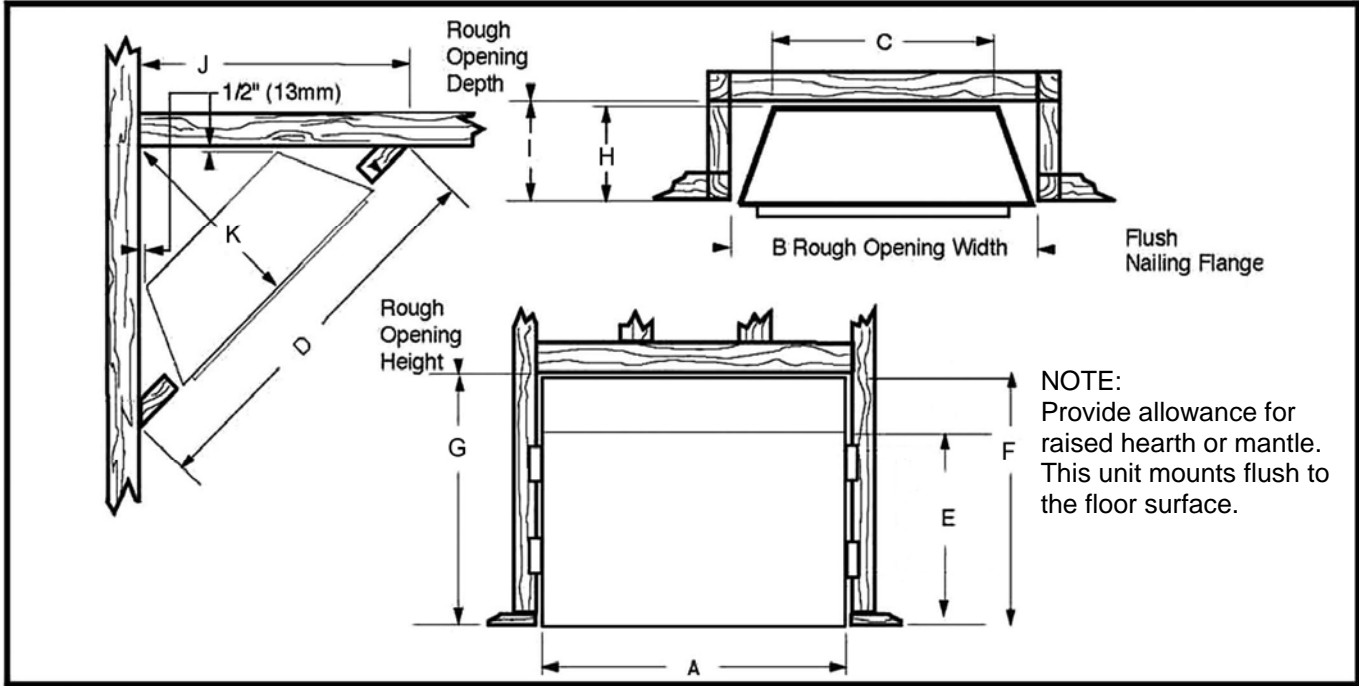

Fig. 1 FIREPLACE SPECIFICATIONS AND FRAMING DIMENSIONS

Ref.	inch	cm
<b>A</b>	26 3/4	67.9
<b>B</b>	27 1/4	69.9
<b>C</b>	18 5/8	46.7
<b>D</b>	40	101.6
<b>E</b>	18	45.7
<b>F</b>	22 3/4	57.8
	<b>FRAMING DIMENSIONS</b>	
<b>G</b>	23 1/4	59.0
<b>H</b>	10	25.4
<b>I</b>	10 1/2	26.7
<b>J</b>	28 1/4	71.8
<b>K</b>	20	50.8

## OPERATING INSTRUCTIONS

Ensure the appliance is connected to a properly grounded electrical outlet on a minimum 15 AMP circuit. If a new outlet is required, it should be installed by a qualified electrician according to applicable building codes.

### REMOTE CONTROL

NOTE: if the fireplace does not respond to the hand held control see “**Remote Control Initialization**” below.

This equipment has been tested and found to comply with the limits for Class B digital device, pursuant to Part 15 of the FCC Rules. These limits are designed to provide reasonable protection against harmful interference in residential installation. This equipment generates and uses, and can radiate radio frequency energy and, if not installed and used in accordance with the instructions, may cause harmful interference to radio communications. However, there is no guarantee that interference will not occur in a particular installation. If this equipment does cause harmful interference to radio or television reception, which can be determined by turning the equipment off and on, the user is encouraged to try to correct the interference by one or more of the following measures:

- Re-orient or relocate the receiving antenna.
- Increase the separation between the equipment and receiver.
- Connect the equipment into an outlet on a circuit different from that to which the receiver is connected.
- Consult the dealer or an experienced radio/TV technician for help.

### Remote Control Initialization

This procedure is required only when the unit is installed or the transmitter is replaced and is not affected by the loss of power.

- Ensure that power is supplied through main service panel.
- Place fresh batteries in the transmitter.
- Access the learn button by removing the front screen.
- Press and hold down the learn button. You will hear a beep.
- Press a button on the hand-held transmitter.
- Release the learn button when you hear the long beep.
- This completes the remote control receiver/transmitter initialization.

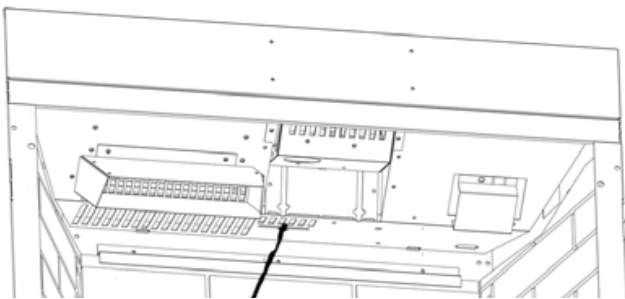

**LEARN BUTTON**

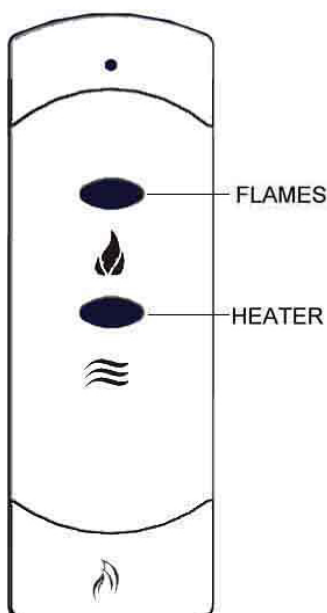

### Control Usage

The remote control operates the fireplace modes.

- The flame effect and backlog/embers are turned ON/OFF by alternate action of the FLAME button on the remote transmitter.
- The heater/blower and front embers are turned ON/OFF by alternate action of the HEATER button on the remote transmitter.
- The optional wall FLAME switch provides manual operation of the flame effect. On/Off
- The optional wall HEAT switch controls the front embers and activates the optional remote wall thermostat.
- Set the thermostat to the desired room temperature.

The optional wall switches / thermostat are in parallel with the remote control relays. The wall switches **MUST** be OFF for the Remote Transmitter to control the fireplace.

NOTE: While the heater is ON the embers in front will glow. Ensure the heater is OFF when unattended.

## ELECTRICAL WIRING

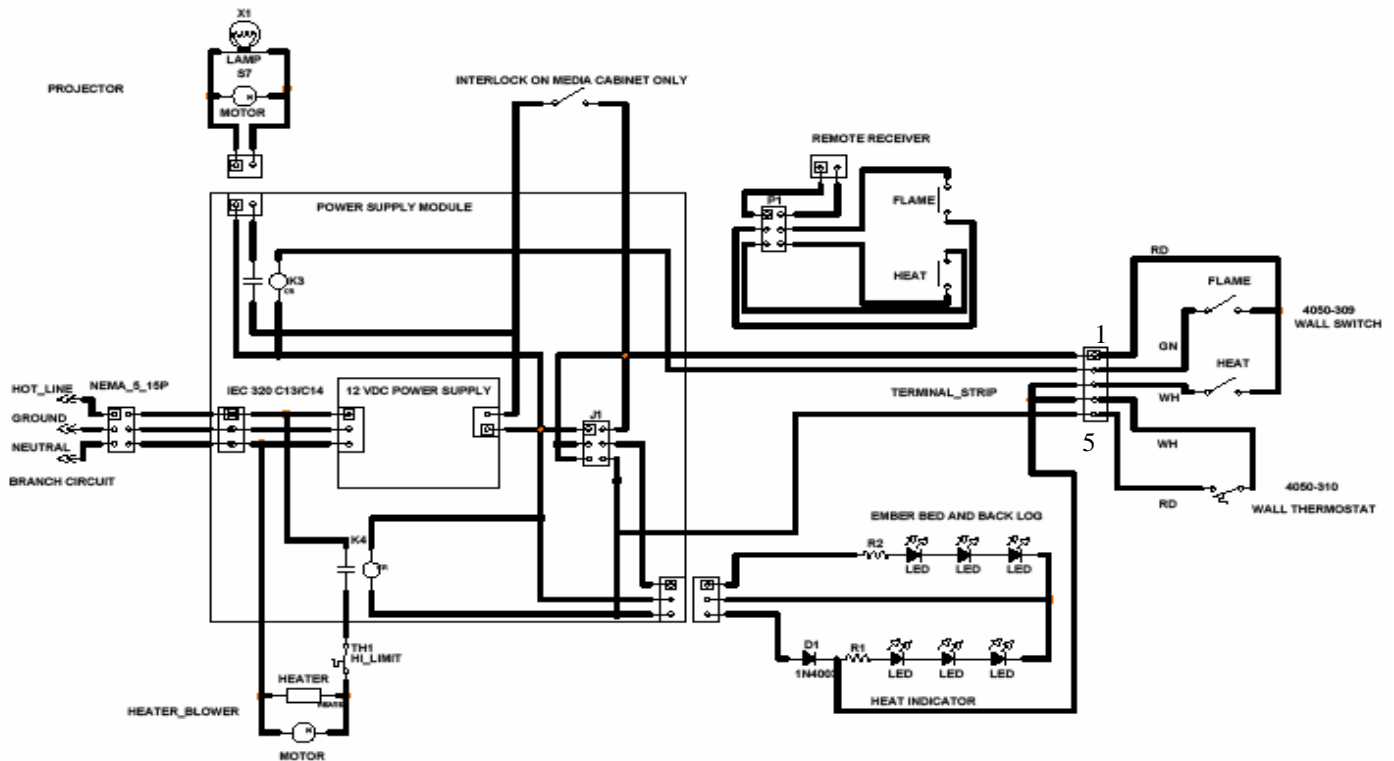

## SERVICE INSTRUCTIONS

### WARNING

Disconnect power at circuit breaker before attempting any maintenance or cleaning to reduce the risk of fire, electrical shock or personal injury.

### REPLACING THE LIGHT BULB

This appliance uses a single 12 Volt, 35 Watt, MR-16 bulb. The bulb is located behind the smoke shield.

A spare is provided with the unit. Replacement bulbs (Part No. 4050-123) are available through your Simplifyre dealer.

- Turn off power to the unit at the main service panel.
- Let the fireplace cool if it has been operating.
- Release the spring pins and remove the upper shield.
- Remove the two screws on the projector basket.
- Rotate the housing down to access the bulb.
- Remove the screws holding the bulb and socket.
- Unplug the bulb from the socket.
- Replace the bulb.
- Re-assemble in the reverse order.

### SCREEN CLEANING

During shipment, installation, handling, etc., the screen surface may collect dust particles; these can be removed by lightly wiping with a clean, dry cloth.

### MAINTENANCE OF MOTORS

The motors used on the fan and flame projector assembly are pre-lubricated for extended bearing life and require no further lubrication. However, periodic cleaning/vacuuming of the fan/heater unit is recommended.

### Resetting the Temperature Cutout Switch

The heater on this fireplace is protected with a safety device to prevent overheating. Should the heater overheat, an automatic cutout will turn OFF the heater/blower. The switch is reset by turning the unit OFF, waiting 10-15 minutes and switching the unit back ON.

## Replacement Parts List

1. Smoke Shield	4050-301
2. Back Log	4050-302
3. 120V Heater Assembly	4050-304
4. SFE-26 Installation Manual	4050-308
5. Remote Receiver	4050-108
6. Front Log/Emberbed Assembly	4050-300
7. Remote Transmitter	4050-105
8. Power Input Assembly	4050-005
9. Power Assembly	4050-305
10. Optional Wall Switch	4050-309
11. Optional Wall Thermostat	4050-310
12. LED Assembly	4050-306
13. Bulb	4050-123
14. Projector Assembly	4050-312
15. Front Screen Assembly	4050-307
16. Viewing Screen	4050-303

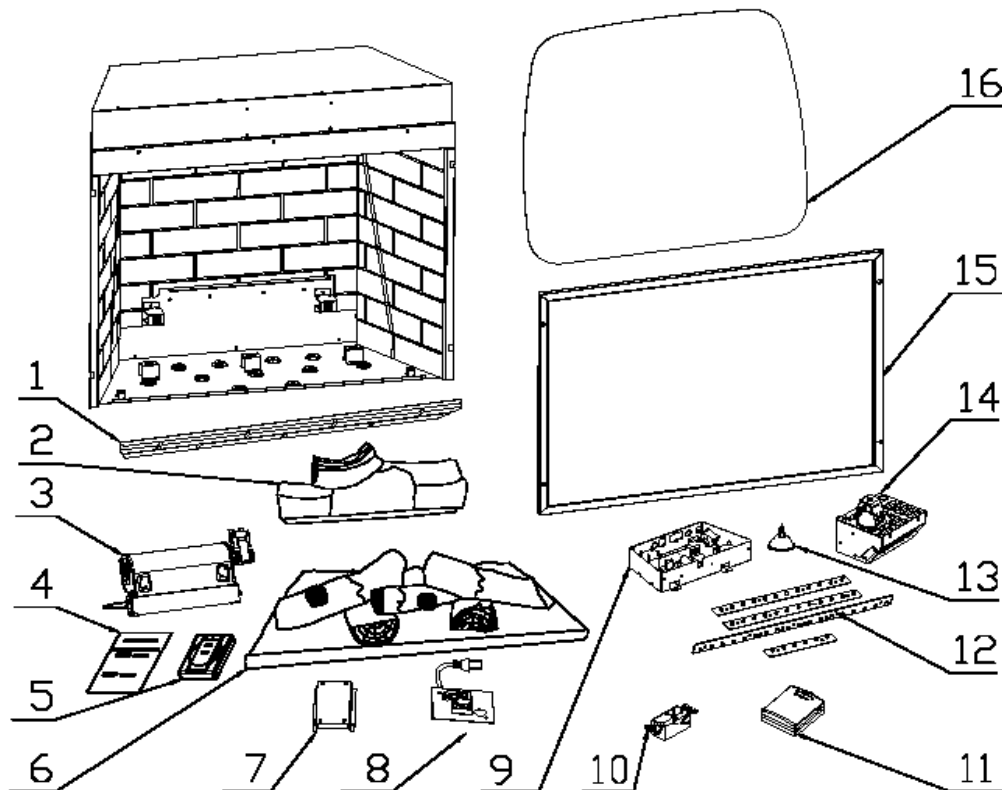





## WARRANTY

Hearth & Home Technologies Inc. (HHT) Electric Fireplaces are tested and inspected prior to shipment and are guaranteed from defect to the purchaser of each new product. Any part which proves to be defective in material or workmanship under normal use within one year will be repaired or replaced without charge.\* The Company will not be responsible for any expense incurred for installation, removal from service, or transportation costs. Any such defect should be brought to the attention of the Dealer where the product was purchased and is authorized to repair or replace within the terms of this warranty.

The Company's only obligation under this warranty will be at its sole option to repair or replace any part proving defective or to refund the purchase price thereof.

The owner/user assumes all other risks, if any, including the risk of any direct, indirect or consequential loss or damage arising out of the use of or inability to use the product.

The warranty will not apply if, in the sole judgement of the Company, damage or failure has resulted from accident, alteration, misuse, abuse, incorrect installation, or operation on an incorrect power source.

The foregoing is in lieu of all other warranties expressed, implied, or statutory, and the Company neither assumes, nor authorizes any person to assume for it any other obligation, or liability in connection with said product.

\*Light bulbs are not covered in the warranty.

### How to Obtain Service

To obtain service under this warranty you must:

1. Send written notice of the claimed condition to Heatilator Technical Service Department, Hearth & Home Technologies Inc., 1915 W. Saunders St., Mt. Pleasant, Iowa 52641.
2. Provide proof of purchase, model number, serial number, and manufacturing date code to HHT.
3. Provide HHT reasonable opportunity to investigate the claim, including reasonable opportunity to inspect the Appliance prior to any repair or replacement work and before the Appliance or any component of the Appliance has been removed from the place of original installation.
4. Obtain HHT's consent to any warranty work before the work is done.

ADDITIONAL INFORMATION: If you would like information on current HHT products or want to locate a dealer in your area, call 1-800-927-6841.

©2003 Heatilator® is a Registered Trademark of Hearth & Home Technologies Inc.