

# Bluetooth stereo headset user guide

## Bluetooth Introduction

The Bluetooth headset is a portable headset solution based on Bluetooth wireless technology. Bluetooth wireless technology is a short-range radio communication technology intended to replace the cables connecting electronic devices. The technology uses a globally available frequency range intended to ensure communication compatibility worldwide.

You can connect your headset to your mobile phone or any device with Bluetooth wireless technology that supports the Headset profile or the Handsfree profile. When the headset is connected to your mobile phone, you can handle incoming and outgoing calls, listen to music, and adjust the volume, using the buttons on the headset.

The inbuilt Bluetooth Headset in motorcycle helmet contain Bluetooth Cell Discreteness, Control Buttons and Earphone. The Bluetooth Cell Discreteness contain Inserted Bluetooth, Battery and Shell.

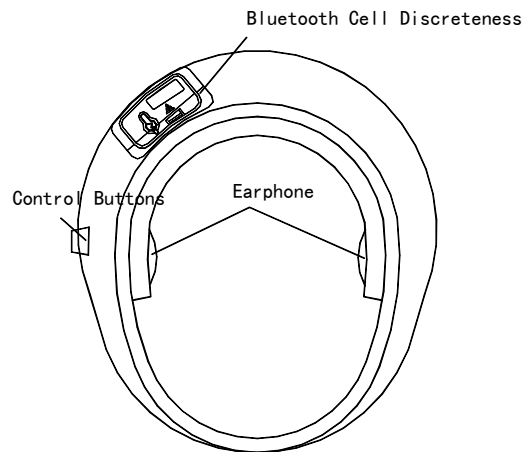

Figure 1

## Caution

Do not let your battery, charger, and headset get wet.

Listening at full volume to music or voice through a headset may damage your hearing.

## BlueToothHeadSet Control Buttons

BUTTON_MFB	Call handling Button
BUTTON_VOL+	Volume Increase
BUTTON_VOL-	Volume Decrease
BUTTON_PAIR	enter pairing mode

**To use your headset, your phone or music device should support the following Bluetooth profiles:**

Profile	Description
HFP (HandsfreeProfile)	<b>Providing a wireless means for both remote control of the Mobile Phone by the Hands-Free device and voice connections between the Mobile Phone and the Hands-Free device.</b>

### **Bluetooth Interference Issues**

The quality of Bluetooth transmission may also be affected by the position of your music device. Should you experience choppy or distorted audio, move the position of your music device or phone to a different location until the signal improves.

### **Getting started**

Before you can use your headset, you should first:

Charge the headset battery.

Pair the headset with a device, for example, a mobile phone.

### **Charging**

The headset comes with a built-in rechargeable battery. We recommend that you charge the battery before using the headset for the first time.

Connect the charger to the headset and to the mains.

The charging time is about 4 hours. During charging, the indicator shows a steady red light. When the battery is fully charged, the indicator red light will switch off. When you use the headset, if you hear a cadent tone, and the indicator red light flashes rhythmically, battery needs recharging.

To charge, please use the handle on Charging Port Rubber Cover gently pull out the Cover, and circumgyrate about 180 degrees. Expose the Charging Port and Plug the Charger Plug into the BlueTooth headset's Charging Port. At this time near the Control Buttons the indicator light turns red when the battery is charging. As Figure2 and Figure 3 shown.

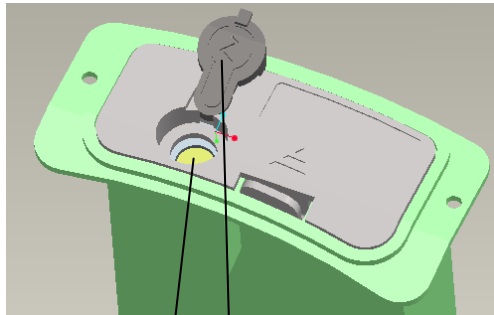

Charging Port

Charging Port Rubber Cover

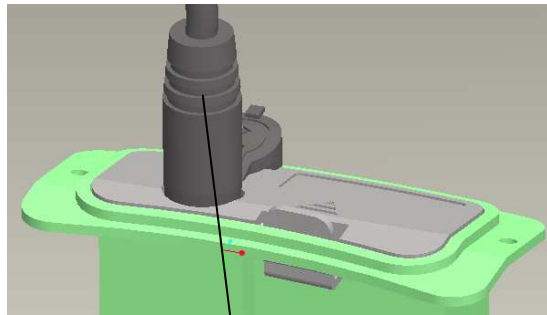

Charging Plug

Figure 2

Figure3

## To turn the headset on

Press and hold the Call Handling Button(MFB) for approximately 2 seconds until you hear a short low tone followed by a short high tone. The headset indicator light flashes yellow.

When turned on, the headset automatically establishes handsfree phone and streaming music connections with the last connected Bluetooth devices (phone and/or music devices).

## To turn the headset off

Press and hold the Call Handling Button(MFB) for approximately 5 seconds until will hear a short high tone followed by a short low tone. The headset indicator light switches off.

## To pairing the headset with a phone

Before using the headset,you should pair the headset to a phone.

Turn the headset on,then press BUTTON\_PAIR, the indicator light yellow and red flashes alternately.

Operate the phone to discover and connect the headset. The headset passkey is 0000. If pairing success the headset indicator YELLOW light flashes slowly and indicator red light is off. Pairing, done only once. Each time you use your headphones, it will be automatically connected to your phone.

Note:Before enter pairing mode,please make sure other BlueDevices are closed.

## Using the headset

### Listening to music

Your headset allows you to listen to music from your Bluetooth streaming music source.

**Note:** When placing or receiving calls, music playing from a Bluetooth music source is automatically paused. When the call is finished, music playing is resumed.

## **To Call**

Not every phone can support voice dial function,if your phone support voice dial then you can use headset to call someone. Otherwise,you using the keys on the phone, as usual.

## **To make a call using voice dialing**

Make sure the phone and the headset are on and within range of each other. Press the Call Handling Button(MFB).

It may take a while to set up the connection between the phone and the headset. During this time, you might hear a repeated tone in the headset. After the beep, voice dial as you normally would. Press the Call Handling Button(MFB) to terminate call.

## **To answer a call using the call handling button Or answer automatically by headset**

When the headset rings, press the Call Handling Button(MFB) to answer the incoming call .Or headset will auto answer the call after 3 seconds.

## **Terminate call**

Press the Call Handling Button(MFB)to terminate call.

## **To reject a call**

When the headset rings, press and hold the Call Handling Button(MFB) until you hear a long beep.

**Note: this function valid only if your phone support Hands-Free Profile.**

## **LastNumberRedial**

If headset in idle time, press and hold the Call Handling Button(MFB) until you hear a long beep,then release.

## **Adjusting the volume**

This headset have two volume control button: VOL+ and VOL- .

You can adjust the headset speaker volume during a call, or the ring volume when you are not engaged in a call.

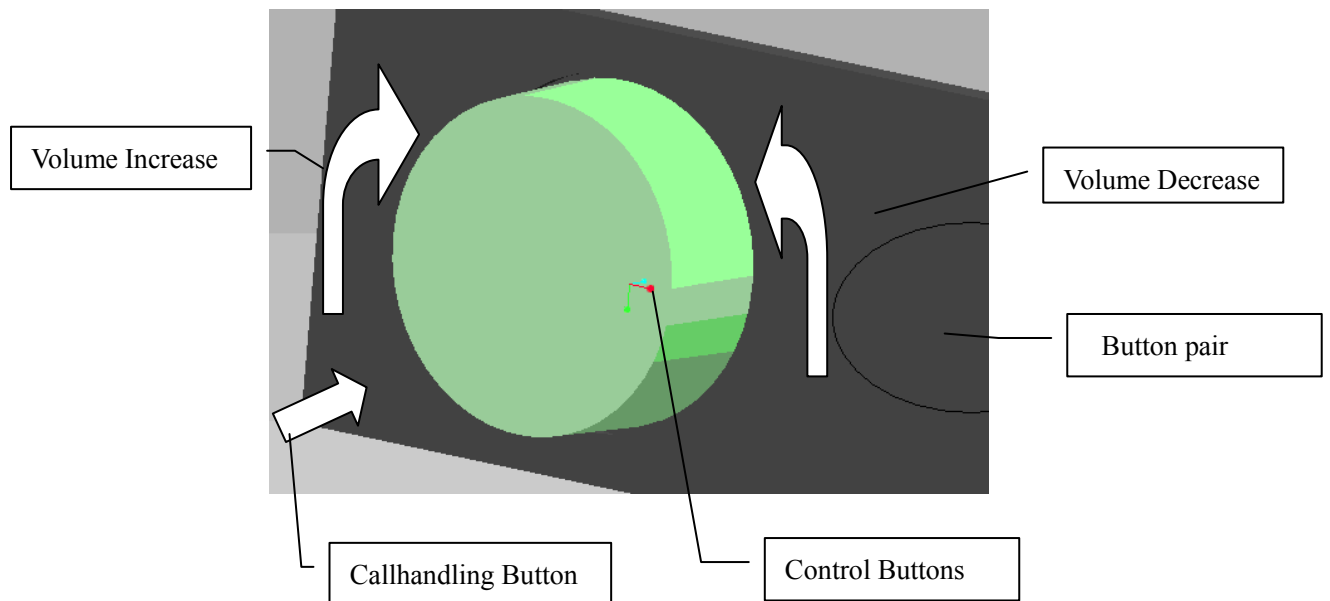

Figure 4

## To transfer the sound to the phone

During a call using your headset, press the Call Handling Button(MFB) 2 times quickly for approximately 0.5 Seconds every times . If your headset work with HeadSetProfile, you just need turn down your headset.

## Transferring sound from phone to headset

If you make a call using your phone, you can transfer the sound to the headset if the headset is on, press the Call Handling Button(MFB) 2 times quickly for approximately 0.5 Seconds every times .

## Replace Inserted BlueTooth:

For special requirements must be replaced Inserted BlueTooth, please follow the instruction have shown to open the Shell's cover, you will see the exposed Inserted BlueTooth, as Figure 5 shown. take out the Inserted BlueTooth as Figure 6 shown.

Be careful when you install the Inserted BlueTooth ,the Guideway of the Inserted BlueTooth should insert the Guideway of the Shell,and insertdeeply

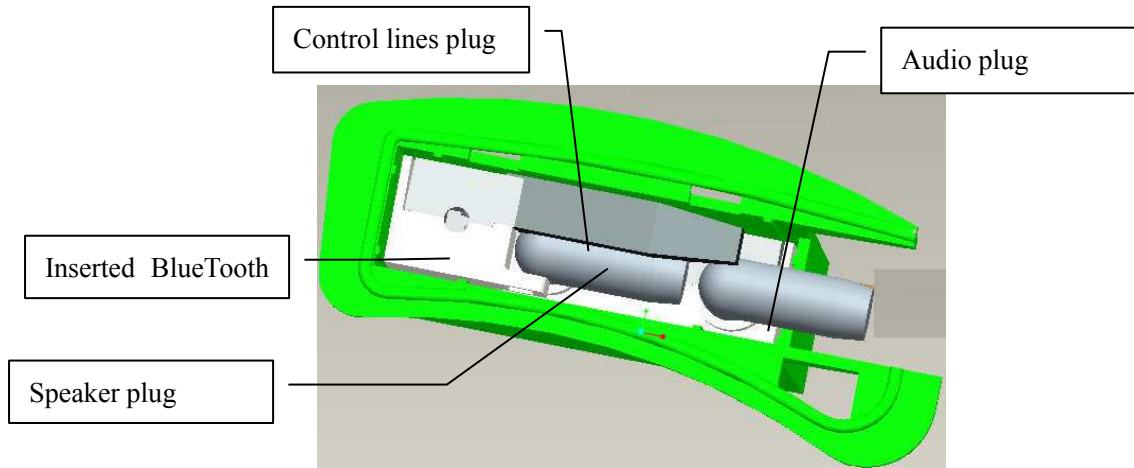

Figure 5

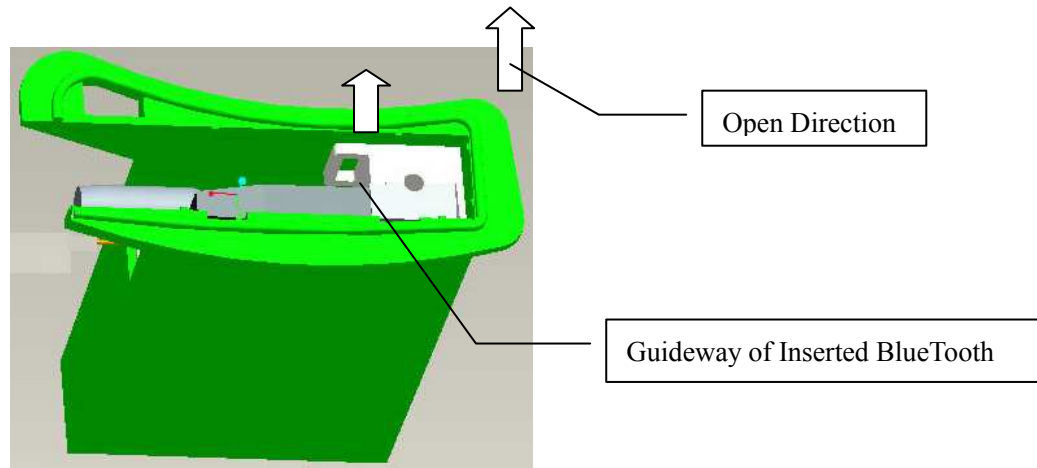

Figure 6

**Note : no special need should not take out the Inserted BlueTooth.**

FCC ID: VWU-Y6400

IMPORTANT REGULATORY INFORMATION

This device complies with Part 15 of the FCC Rules:

Operation is subject to the following two conditions:

1. This device may not cause harmful interference and
2. This device must accept any interference that is received, including any interference that may cause undesired operation.

WARNING:

Changes or modifications to this unit not expressly approved by the party responsible for compliance could void the user's authority to operate the equipments.