

## DataSeal-125 Installation

### DataSeal Installation

#### **step 1.**

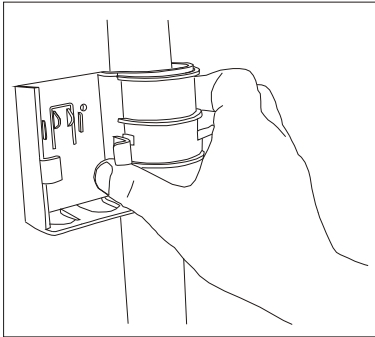

Fig. 1

To install the DataSeal-125 Mounting Fixture, attach the fixture to the keeper bar at the back of the container (fig.1). A click indicates that the fixture is in place.

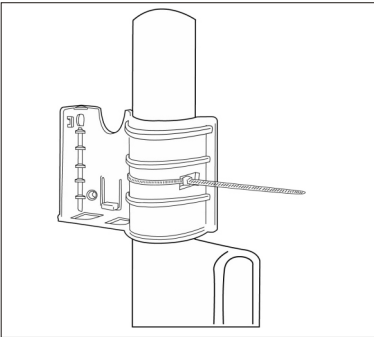

Fig. 2

The two side slots may be used to secure the mounting fixture to the container, using a 3-5mm width by 180-250 mm length plastic strap (fig 2).

#### **step 2.**

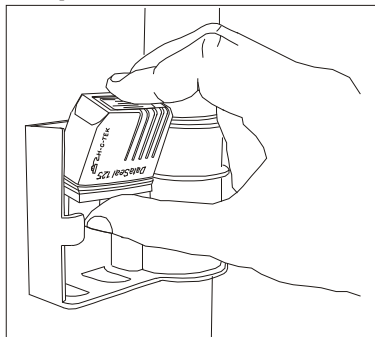

Fig. 3

To install the DataSeal-125, hold the unit at a 45° angle as illustrated and snap it into place in its cradle on the DataSeal Mounting Fixture. (fig. 3)

## DataSeal-125 Installation

### step 3.

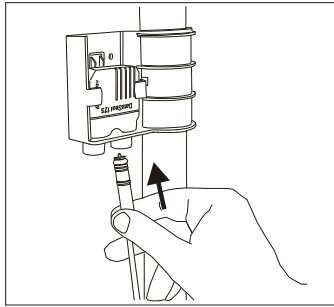

Fig. 4

To connect the DataSeal Wire, simply attach one end of the seal wire connectors to either of the sockets at the base of the DataSeal (fig 4).

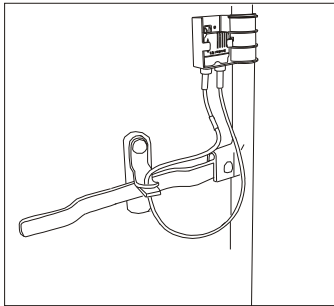

Fig. 5

Loop the wire through the container locking ring and the keeper bar, then insert the end into the other socket (fig. 5).

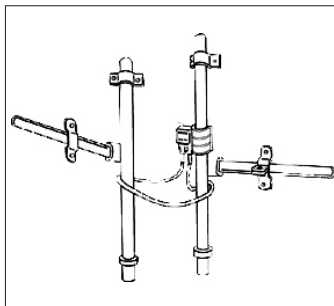

Fig. 6

Alternatively, you may loop the wire through both keeper bars then insert the end into the other socket (fig. 6).

## DataSeal-125 Installation

### **FCC ID: OB6-IGSA125**

This device complies with Part 15 of FCC rules. Operation is subject to the following two conditions: (1) This device may not cause harmful interference, and (2) This device must accept any interference that may cause undesired operation.

**NOTE:** This equipment has been tested and found to comply with the limits for a Class B digital device, pursuant to part 15 of the FCC Rules. These limits are designed to provide reasonable protection against harmful interference in a residential installation. This equipment generates, uses and can radiate radio frequency energy and, if not installed and used in accordance with the instructions, may cause harmful interference to radio communications.

However, there is no guarantee that interference will not occur in a particular installation. If this equipment does cause harmful interference to radio or television reception, which can be determined by turning the equipment off and on, the user is encouraged to try to correct the interference by one or more of the following measures:

- Reorient or relocate the receiving antenna.
- Increase the separation between the equipment and receiver.
- Connect the equipment into an outlet on a circuit different from that to which the receiver is connected.
- Consult the dealer or an experienced radio/TV technician for help.

Changes or modifications to this equipment not expressly approved by Hi-G-Tek Ltd. could void the user's authority to operate the equipment.