

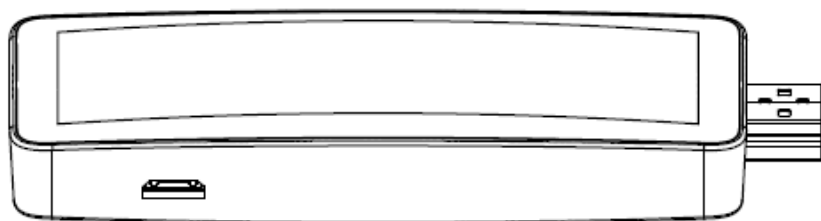

User Manual of Hisense TV Stick

All images are for illustration purposes only and may differ from the actual product by model and region

Package Contents



Hisense TV Stick

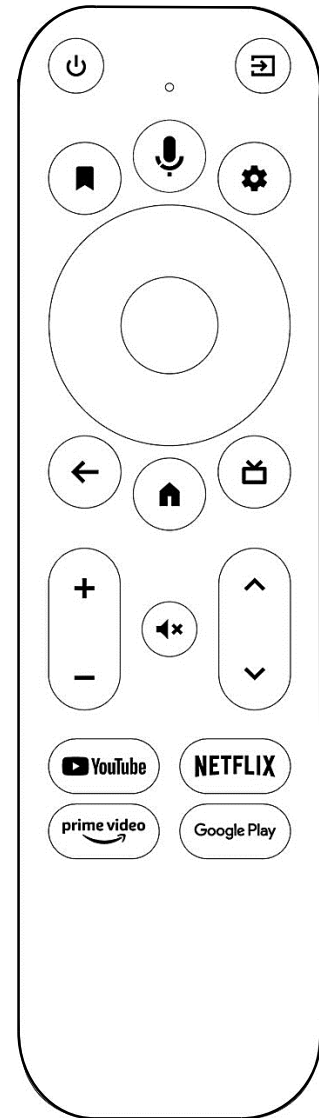

Remote Control

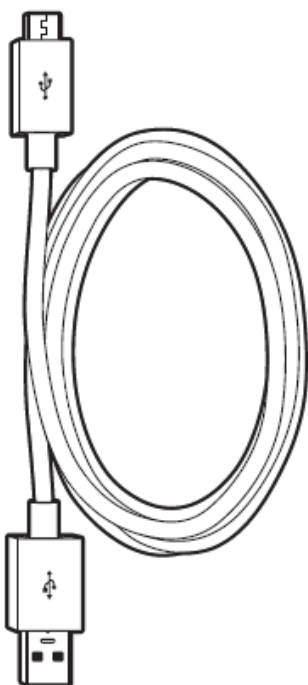

Power Cable



Power adapter

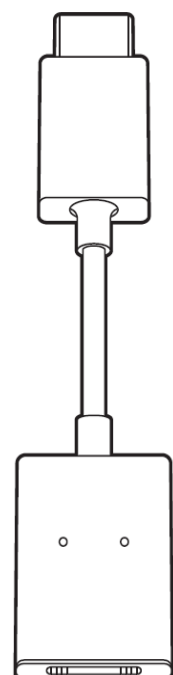

HDMI adapter

Connect your TV Stick

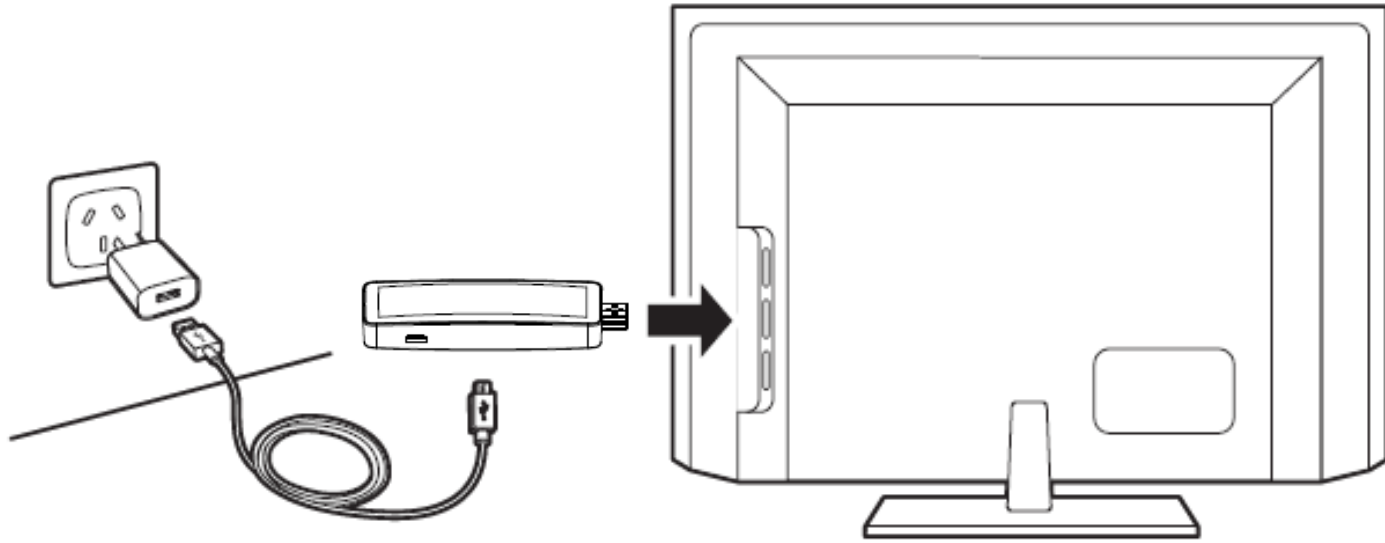

Connect one end of the power cable into your TV Stick and the other into the power adapter. Plug your TV Stick into the HDMI port on your TV, then plug the power adapter into a nearby electrical socket. Turn on your TV, then select the appropriate HDMI input.

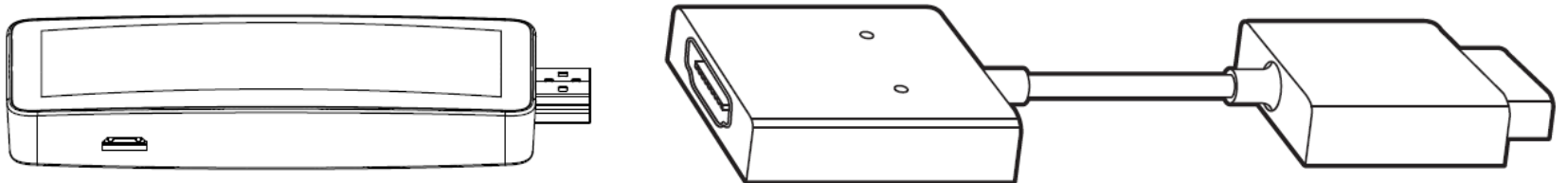

Use the included HDMI cable to improve Wi-Fi and remote performance, or if you have trouble fitting your TV Stick into an HDMI port on your TV.

Complete the on-screen set-up

Using your Remote Control, follow the on-screen instructions to choose your language, select your Wi-Fi network and register your device.

***Wi-Fi tips and troubleshooting**

For best Wi-Fi performance, use the 5 GHz band on your wireless router if available.

If you see a lock icon, your Wi-Fi network requires a password, so make sure you have it available.

Ensure your internet is working properly. Restarting your router and modem will solve most Wi-Fi network issues.

Do not place your wireless router or Fire TV Stick in a cabinet, as it may impact Wi-Fi signal strength.

Some Wi-Fi issues may be improved by connecting the included HDMI extender.

Remote Control Repairing

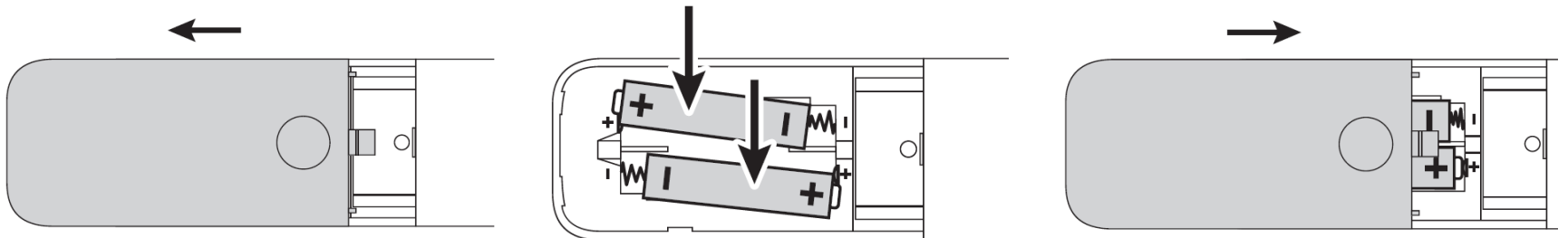

Before the begin, open the back of the Remote Control and insert the batteries.

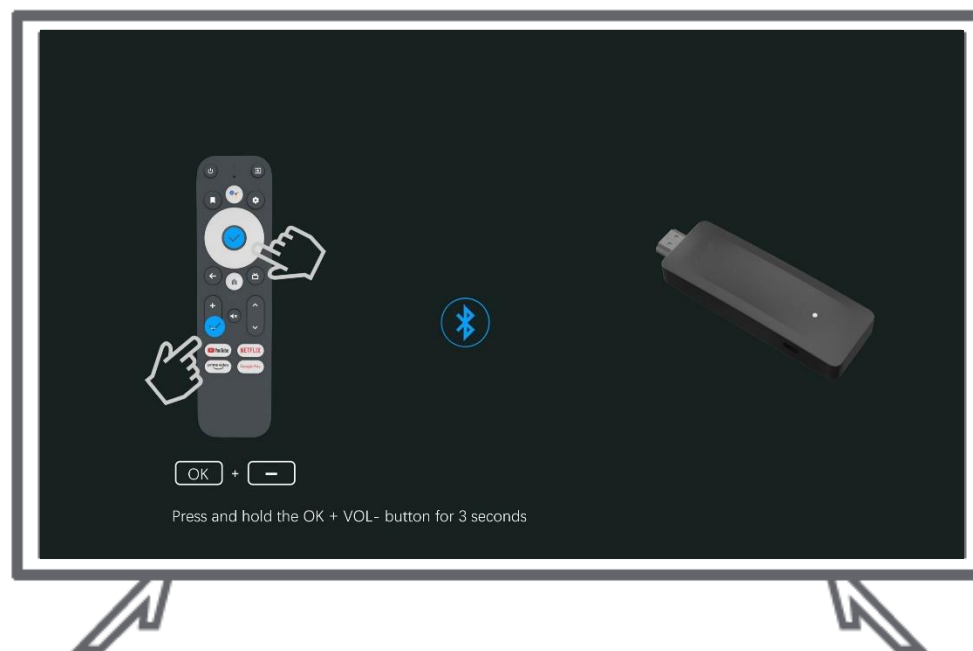

Press and hold the OK and VOL- button for 3 seconds to pair the Remote Control, keep Remote Control near to TV Stick.

Declaration

Do not install this equipment in a confined space such as a bookcase or similar unit.

Do not use the set near damp, and cold areas, protect the set from overheating.

Keep away from direct sunlight.

Do not use the set near dust place.

Do not place candles near the opening area, to avoid flammable foreign material from entering the device.

Google assistant is not available in certain languages and countries. Availability of services varies by countries and language.

Disney+ may not be available in certain countries.

FCC Statement:

This device complies with part 15 of the FCC Rules. Operation is subject to the following two conditions: (1) This device may not cause harmful interference, and (2) this device must accept any interference received, including interference that may cause undesired operation.

This equipment has been tested and found to comply with the limits for a Class B digital device, pursuant to part 15 of the FCC Rules. These limits are designed to provide reasonable protection against harmful interference in a residential installation. This

Equipment generates,uses and can radiate radio frequency energy and,if not installed and used in accordance with the instructions,may cause harmful interference to radio communications.However,there is no guarantee that interference will not occur in a Particular installation.If thise quipment does cause harmful interference to radio or television reception, which can be determined by turning the equipment off and on, the user is encouraged to try to correct the interference by one or more of the following measures:

- Reorient or relocate the receiving antenna.
- Increase the separation between the equipment and receiver.
- Connect the equipment into an outlet on a circuit different from that to which the receiver is connected.
- Consult the dealer or an experienced radio/TV technician for help.

Caution: Any changes or modifications not expressly approved by the party responsible for compliance could void the user's authority to operate the equipment.

This equipment complies with FCC radiation exposure limits set forth for an uncontrolled environment. This transmitter must not be co-located or operating in conjunction with any other antenna or transmitter.

This equipment should be installed and operated with minimum distance 20cm between the radiator&your body.