

# Hisense

-Innovation for life -

HOSPITALITY LED TELEVISION

MODEL NO.LTDN42A300MH

LTDN39K366MH

## USER MANUAL

---

Before using the TV, Please read this manual thoroughly, retain it for future reference.

ES-G

Remote Control and Stand are optional depending on customer's requirement.

English

## Table of contents

Important safety instructions .....	2
Warnings .....	2
Cautions .....	3
Accessories .....	3
Installing and removing the stand .....	3
Installing the stand .....	3
Attaching the TV to the desk .....	4
Removing the stand .....	4
Installing a wall-mount bracket .....	4
TV components .....	4
Front and side controls .....	4
Back connections .....	5
Remote control .....	5
Using the remote control .....	6
Installing remote control batteries .....	6
Aiming the remote control .....	6
Making connections .....	7
Connecting the power .....	7
Selecting a location .....	7
Connecting an HDMI device .....	7
Connecting a component video device .....	7
Connecting an antenna, cable TV, or satellite TV box .....	8
Connecting a VCR, camcorder, or game console .....	8
Connecting a computer .....	8
Connecting a home theater system .....	9
Connecting headphones .....	9
Connecting devices with USB interface .....	9
Understanding the basics .....	9
Turning your TV on or off .....	9
Selecting the video input source .....	9
Selecting a channel .....	9
Adjusting the volume .....	9
Displaying program information .....	10
Navigating the menus .....	10
On-screen menu overview .....	10
Adjusting the picture .....	12
Choosing the display format (aspect ratio) .....	12
Adjusting the sound .....	12
Selecting the audio mode .....	12
Adjusting the Features .....	12
Adjusting the Installation .....	14
Troubleshooting .....	14
Video and audio .....	15
Remote control .....	15
General .....	15
Maintenance .....	16
Cleaning .....	16
Specifications .....	16
Legal notices .....	16
Adjusting hotel settings .....	17

# CHILD SAFETY

It makes a difference how and where you use your flat panel display

**As you enjoy your new product, keep these safety tips in mind**

## *The issue*

The home theater entertainment experience is a growing trend, and larger TVs are popular purchases. However, TVs are not always supported on the proper stands or installed according to the manufacturer's recommendations. We and the consumer electronics industry are committed to making home entertainment enjoyable and safe.

TVs that are inappropriately placed on dressers, bookcases, shelves, desks, speakers, chests, or carts may fall over and cause injury.

## *Tune into safety*

- One size of TV stand does **not** fit all. Use only a TV stand rated for the weight of your TV.
- Carefully read and understand all enclosed instructions for proper use of this product.
- Don't let children climb on or play with entertainment system furniture and TVs.
- Don't place TVs on furniture that can easily be used as steps, such as a crate or chest of drawers.
- Remember that children can become excited while watching a program, especially on a "larger-than-life" TV. Make sure that you place or install the TV where it cannot be pushed, pulled over, or knocked down.
- Make sure that you route all cords and cables so that they cannot be pulled or grabbed by curious children.



## *Wall mounting*

If you decide to wall mount your TV, always remember:

- One size of wall mount does **not** fit all. Use only a wall mount rated for the weight of your TV and that has been recommended by this TV manufacturer, listed in this manual, or otherwise listed by an independent laboratory as suitable for your TV.
- Follow all instructions supplied by the TV and wall mount manufacturers.
- If you have any doubts about your ability to safely wall mount your TV, get help from a professional installer.
- Make sure that the wall where you are mounting the TV is appropriate. Some wall mounts are not designed to be mounted to walls backed with steel studs or cinder blocks. If you are unsure, ask a professional installer.
- TVs can be heavy. At least two people are required for safe wall mount installation.



## Important safety instructions

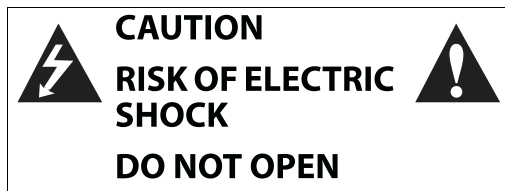

This symbol indicates that dangerous voltage constituting a risk of electric shock is present within your TV. This label is located on the back of your TV.



This symbol indicates that there are important operating and maintenance instructions in the literature accompanying your TV.

- 1 Read these instructions.
- 2 Keep these instructions.
- 3 Heed all warnings.
- 4 Follow all instructions.
- 5 Do not use this apparatus near water.
- 6 Clean only with a dry cloth.
- 7 Do not block any ventilation openings. Install in accordance with the manufacturer's instructions.
- 8 Do not install near any heat sources such as radiators, heat registers, stoves, or other apparatus (including amplifiers) that produce heat.
- 9 Do not defeat the safety purpose of the polarized or grounding-type plug. A polarized plug has two blades with one wider than the other. A grounding type plug has two blades and a third grounding prong. The wide blade or the third prong are provided for your safety. If the provided plug does not fit into your outlet, consult an electrician for replacement of the obsolete outlet.
- 10 Protect the power cord from being walked on or pinched particularly at plugs, convenience receptacles, and the point where they exit from the apparatus.
- 11 Only use attachments/accessories specified by the manufacturer.
- 12 Use only with a cart, stand, tripod, bracket, or table specified by the manufacturer, or sold with the apparatus. When a cart is used, use caution when moving the cart/apparatus combination to avoid injury from tip-over. 
- 13 Unplug this apparatus during lightning storms or when unused for long periods of time.
- 14 Refer all servicing to qualified service personnel. Servicing is required when the apparatus has been damaged in any way, such as power-supply cord or plug is damaged, liquid has been spilled or objects have fallen into the apparatus, the apparatus has been exposed to rain or moisture, does not operate normally, or has been dropped.
- 15 The wall plug is the disconnecting device. The plug must remain readily operable.
- 16 An apparatus with a three-prong, grounding-type plug is a Class I apparatus, which needs to be grounded to prevent possible electric shock. Make sure that you connect this Class I television to a grounding-type, three-prong outlet.
- 17 Remote control batteries should not be exposed to excessive heat such as sunshine, fire, or the like.

- 18 The apparatus should not be exposed to dripping or splashing, and no objects filled with liquids, such as vases, should be placed on the apparatus.

### Warnings

#### Electric shock hazard

To reduce the risk of fire or electric shock, do not remove any cover or expose the device to rain or moisture. No user-serviceable parts are inside. Refer servicing to qualified service technicians.

#### Lightning

For added protection for your device receiver during a lightning storm, or when it is left unattended and unused for long periods of time, unplug it from the power outlet and disconnect any antenna or cable system. This helps prevent property damage and personal injury from lightning and power line surges.

#### Power lines

An outside antenna system should not be located in the vicinity of overhead power lines or other electric light or power circuits, or where it can fall into such power lines or circuits. When installing an outside antenna system, extreme care should be taken to keep from touching such power lines or circuits as contact with them might be fatal.

#### Handling the LED panel

- Your TV's screen is made of glass. Do not drop your TV or hit, jolt, or press hard against the LED panel. If the screen breaks, be careful of broken glass.
- If the LED panel is broken, make absolutely sure that you do not touch the liquid in the panel. This may cause skin inflammation.
- If the liquid gets in your mouth, immediately gargle, rinse, and consult with your doctor. Also, if the liquid gets in your eyes or touches your skin, consult with your doctor after rinsing for at least 15 minutes or longer in clean water.

#### Replacement parts

When replacement parts are required, make sure that the service technician uses replacement parts specified by the manufacturer that have the same characteristics as the original part. Unauthorized substitutions may result in fire, electric shock, personal injury, or other hazards.

#### Safety check

After completing any service or repair to this device, ask the service technician to perform routine safety checks to determine that your TV is in correct operating condition.

#### Power source

Operate your TV only from the type of power source indicated on the marking label. If you are not sure of the type of power supplied to your home, consult an electrician or your local power company.

## HDMI™

This TV incorporates High-Definition Multimedia Interface (HDMI™) technology. HDMI, the HDMI logo and High-Definition Multimedia Interface are trademarks or registered trademarks of HDMI Licensing LLC.

## Cautions

### Damage requiring service

Unplug this TV from the power outlet and refer servicing to qualified service personnel under the following conditions:

- When the power supply cord or plug is damaged or frayed.
- If liquid has been spilled or objects have fallen into your TV.
- If your TV has been exposed to rain or water.
- If your TV does not operate normally by following the operating instructions. Adjust only those controls that are covered by the operating instructions because incorrect adjustment of other controls may result in damage and will often require extensive work by a qualified technician to restore your TV to its normal operation.
- If your TV has been dropped or damaged in any way.
- When your TV exhibits a distinct change in performance.

### Outdoor antenna grounding

If an outside antenna or cable system is connected to your TV, make sure that the antenna or cable system is grounded to provide some protection against voltage surges and built-up static charges. Article 810 of the National Electrical Code, ANSI/NFPA No. 70, provides information with respect to correct grounding of the mast and supporting structure, grounding of the lead-in wire to an antenna discharge unit, size of grounding conductors, location of the antenna-discharge unit, connection to grounding electrodes, and requirements for the grounding electrode.

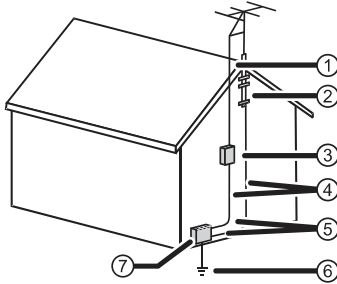

①	Antenna lead-in wire
②	Grounding clamp
③	Antenna discharge unit
④	Grounding conductors
⑤	Ground clamps
⑥	Power service grounding electrode system
⑦	Electric service equipment

### Note to CATV system installer

Article 820 of the National Electrical Code, ANSI/NFPA No. 40 provides guidance for correct grounding. Specifically, it states that the cable ground must be connected to the grounding system of the building as close to the point of cable entry as practical.

### Condensation

Moisture will form on the TV if the TV is brought from cool surroundings into a warm room or if the temperature of the room rises suddenly. When this happens, the TV's performance may be impaired. To prevent this, let the TV stand in its new surroundings for about an hour before switching it on, or make sure that the room temperature rises gradually.

Condensation may also form during the summer if the TV is exposed to the breeze from an air conditioner. In such cases, change the location of the TV.

### Mobile telephone warning

To avoid interference with your TV picture and sound, operating problems, or even damage, keep your cordless and cellular telephones away from the TV.

## End of life directives

Your TV contains tin-lead solder and a fluorescent lamp containing a small amount of mercury. Disposal of these materials may be regulated for environmental reasons. Your TV also contains material that can be recycled and reused. For disposal or recycling information, contact your local authorities or the Electronic Industries Alliance at [www.eia.org](http://www.eia.org) to find a recycler in your area.

## Non-active pixels

The LED panel contains almost 3 million thin film transistors, which provide exceptionally sharp video quality. Occasionally, a few non-active pixels may appear on the screen as a fixed blue, green, or red point. These non-active pixels do not adversely affect the performance of your TV, and are not considered defects.

## Accessories

Make sure the following accessories are included in the box with your TV:

- Remote control
- User manual
- AC power cord
- AAA batteries (2)
- Stand
- Quick Setup Guide

## Installing and removing the stand

You must install your TV into the stand in order for it to stand upright on a cabinet or other flat surface. If you intend to mount your TV on a wall or other vertical surface, you must remove the stand.

**Warning:** Before attempting assembly or removal of the stand, unplug the AC power cord.

### Cautions:

- Read these instructions carefully before you try to assemble the stand or remove the stand.
- Make sure that you handle the TV carefully when attempting to assemble or remove the stand. If you are not sure of your ability to do this, contact a professional installer or service technician. Hisense is not responsible for any damages or injuries that occur because of mishandling or incorrect assembly.
- Use a soft cushion or covering to prevent scratching or damage to the TV screen or cabinet.

## Installing the stand

**Note:** Your TV may differ from the illustrations shown.

### To install the stand:

1. Insert the stand column into the base plate, aligning the ridge on the column with the groove in the base plate. Making sure the FRONT of stand column match the FRONT of base plate. Secure the stand column to the base plate with the four screws (M4, 12mm) provided.

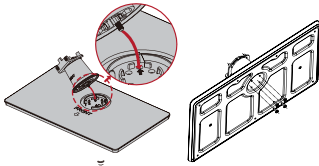

2 Secure the stand cover to the stand column vertically with the 2 screws (M4,12mm) provided. Secure the stand cover to the stand column horizontally with the 2 screws (ST4,14mm) provided.

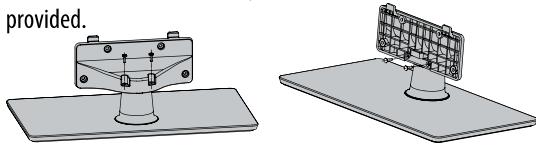

3 Insert the stand cover into the slot of TV bottom side and secure the stand to the TV with the four provided screws (M5, 12 mm).

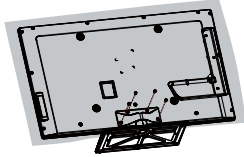

### Attaching the TV to a desk

Here shown may be somewhat different from your TV. The TV must be attached to desk so it cannot be pulled in a forward/backward direction, potentially causing injury or damaging the product.

**Screws: M5×L(table depth + 8~10mm)**  
**Example: Table depth = 15mm Screws: M5×25**

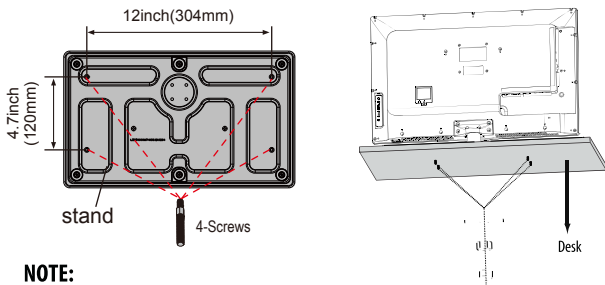

**NOTE:**  
 Be sure to follow the instructions, in correct installation of the stand (pedestal) may result in the TV falling over.

### Removing the stand

You must remove the stand before you can wall-mount the TV.

**Note:** Your TV may differ from the illustrations shown.

#### To remove the stand:

- 1 Lay the TV (screen down) on the edge of the table or bench. Make sure that you put a soft cloth or cushion between the table or bench and the TV.
- 2 Remove the 4 screws holding the stand to the TV, then remove the stand.

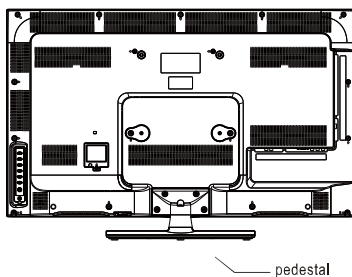

### Installing a wall-mount bracket

If you want to attach the TV to a wall-mount bracket, you should first remove the stand if it is pre-attached. Carefully place your TV screen face-down on a cushioned, clean surface to protect the screen from damages and scratches. Insert four spacers (provided) into the corresponding bracket screw holes on the back of your TV, then attach the wall-mount bracket to your TV using four M6 x 30 screws (provided) or the screws/spacers provided with the wall-mount bracket. See the instructions that came with the wall-mount bracket for screw/washer configurations and information on how to correctly hang your TV.

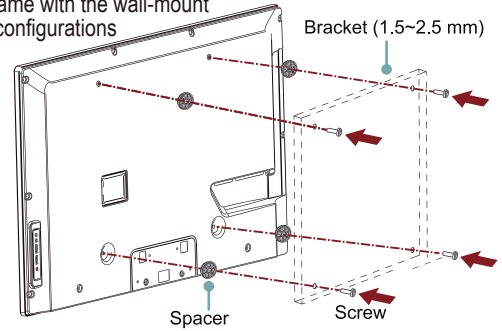

#### Warning

To prevent internal damage to the TV and ensure the TV is mounted securely, be sure to use fixing screws (provided)

Wall-mount hole pattern VESA (mm)	200 × 200
Wall-mount screw size (mm)	M6

### TV components

#### Front and side controls

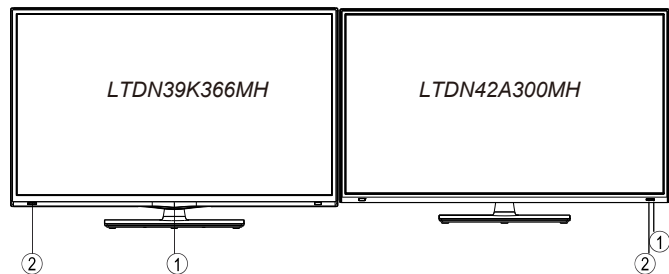
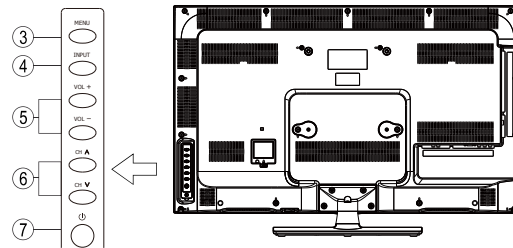

Item	Name	Description
①	Power indicator	The light shows whether the TV is on or standby mode.
②	Remote control sensor	Receives signals from the remote control. Please do not block.
③	MENU	Display the onscreen display(OSD) or Exit to close the OSD.
④	INPUT	Select the INPUT menu.
⑤	VOL+ / VOL-	Volume adjusting bottom, to increase or decrease the volume.
⑥	CH ▲/CH ▼	Channel selection bottom, to increase or decrease the channel.
⑦	⏻ (power)	Press to turn your TV on or off (standby mode).