

## K366 Series QUICK SETUP GUIDE

### 1 ACCESSORIES LIST

- User Manual
- Quick Setup Guide
- Warranty Card
- Remote Control
- Battery x 2
- Spacer for 40K366WH
- Screw (M5 x 12mm) x 4
- Screw (M6 x 12mm) x 6
- Screw (S7.5 x 14mm) x 2
- Wall-mounted screw (M6 x 30mm) x 4
- Spacer for 40K366WH/SK366WH
- Screw (M5 x 12mm) x 4
- Screw (M6 x 12mm) x 6
- Screw (S7.5 x 14mm) x 2
- Wall-mounted screw (M6 x 45mm) x 4

### 2 INSTALLING THE STAND

Follow the illustrations below to complete the installation steps.

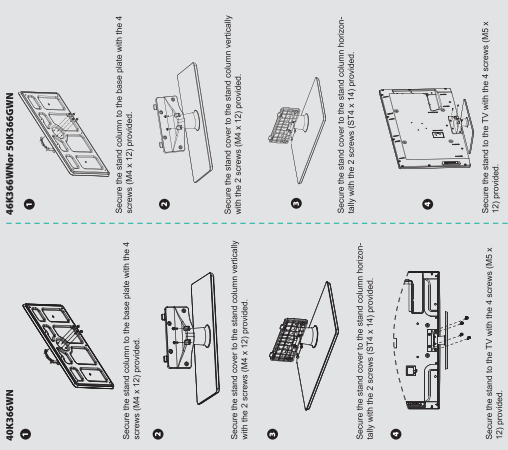

**Note:** Please do not touch the screen surface. Do not touch the screen surface with your hands. Do not touch the screen surface with any sharp objects. Do not touch the screen surface with any liquid. Do not touch the screen surface with any dust. Do not touch the screen surface with any oil. Do not touch the screen surface with any grease. Do not touch the screen surface with any dirt. Do not touch the screen surface with any debris. Do not touch the screen surface with any fibers. Do not touch the screen surface with any lint. Do not touch the screen surface with any hair. Do not touch the screen surface with any skin. Do not touch the screen surface with any nails. Do not touch the screen surface with any jewelry. Do not touch the screen surface with any tools. Do not touch the screen surface with any objects. Do not touch the screen surface with anything.

### 3 INSTALLING A WALL-MOUNT BRACKET

If you want to attach the TV to a wall-mount bracket (not provided), you should first remove the stand (if it is pre-attached) (see Step 1).

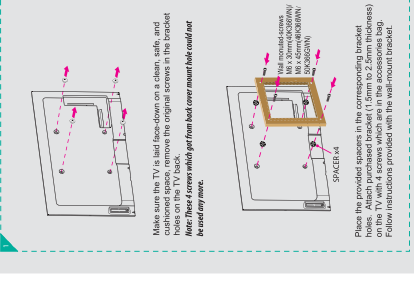

Make sure the TV is laid face-down on a clean, safe, and level surface. Do not touch the screen surface with your hands. Do not touch the screen surface with any sharp objects. Do not touch the screen surface with any liquid. Do not touch the screen surface with any dust. Do not touch the screen surface with any oil. Do not touch the screen surface with any grease. Do not touch the screen surface with any dirt. Do not touch the screen surface with any fibers. Do not touch the screen surface with any lint. Do not touch the screen surface with any hair. Do not touch the screen surface with any skin. Do not touch the screen surface with any nails. Do not touch the screen surface with any jewelry. Do not touch the screen surface with any tools. Do not touch the screen surface with any objects. Do not touch the screen surface with anything.

**Note:** These screws will not fit from back cover mount their end for best any case.

Place the provided spacers in the corresponding bracket holes on the TV back. Attach purchased bracket (1.5mm to 2.0mm thickness) on the TV with 4 screws which are in the accessories bag. Follow instructions provided with the wall-mount bracket.

The TV's ear cover (15.5 x 11.2 cm) is provided. Please refer to the TV's ear cover (15.5 x 11.2 cm) for more information.

Wall-Mount hole pattern (VESA) (mm) 400 x 400 (SK366WH) 200 x 200 (SK366WH) 400 x 400 (40K366WH) 400 x 400 (40K366WH)

### 4 REMOTE CONTROL



**Power:** Turns the TV on or off.

**Input:** Select source to watch.

**Hi-Smart:** Press to browse the services apps in Hi-Smart Home UI. The apps in the Home UI let you watch movies, listen to music, and much more.

**Netflix:** Press to launch NETFLIX instant video streaming.

### 7 TV CONNECTORS

Check the jacks for position and type before making any connections. Look for the following color markings. Make sure that all connections are tight and secure.

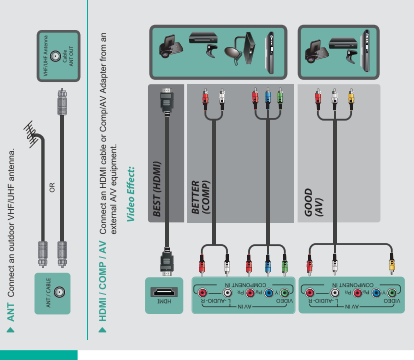

### 5 MAKING CONNECTIONS

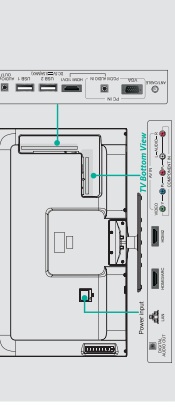

### 6 SPECIFICATIONS

Model Name	40K366WH	40K366WH	50K366WH
Dimension	Without Stand: 36.3 inches (92.8mm) x 41.6 inches (107mm) x 2.5 inches (64mm)	With Stand: 36.3 inches (92.8mm) x 41.6 inches (107mm) x 2.5 inches (64mm)	Without Stand: 50.3 inches (128mm) x 41.6 inches (107mm) x 2.5 inches (64mm)
Weight	Without Stand: 25.4 lbs (11.5 kg)	With Stand: 28.7 lbs (13 kg)	Without Stand: 38.7 lbs (18 kg)
LCD Panel Minimum size (diagonal)	40 inches	40 inches	48.6 inches
Power consumption	150W x 1000	150W x 1000	150W x 1000
Power supply	7 W x 7 W	8 W x 7 W	10 W x 10 W
Operating system	Android TV	Android TV	Android TV
Receiving channels	ATSC / QAM	ATSC / QAM	ATSC / QAM
TV set type	VHF: 2-13 BHF: 14-69 CATV: 1, 1-25	VHF: 2-13 BHF: 14-69 CATV: 1, 1-25	VHF: 2-13 BHF: 14-69 CATV: 1, 1-25
Environmental conditions	Temperature: 41°F ~ 95°F (5°C ~ 35°C)	Temperature: 41°F ~ 95°F (5°C ~ 35°C)	Temperature: 41°F ~ 95°F (5°C ~ 35°C)
Component Input	480i / 480p / 480P / 720P / 720P / 1080i / 1080P / 1080P / 1080P / 1080P	480i / 480p / 480P / 720P / 720P / 1080i / 1080P / 1080P / 1080P / 1080P	480i / 480p / 480P / 720P / 720P / 1080i / 1080P / 1080P / 1080P / 1080P
HDMI Input	1080i / 1080P / 1080P / 1080P / 1080P / 1080P / 1080P / 1080P / 1080P / 1080P	1080i / 1080P / 1080P / 1080P / 1080P / 1080P / 1080P / 1080P / 1080P / 1080P	1080i / 1080P / 1080P / 1080P / 1080P / 1080P / 1080P / 1080P / 1080P / 1080P

### 8 Turning the TV On for the First Time

**MENU OPERATIONS**

- Please press [ENTER] then press [▲▼] to select your language. English, Spanish or French, select [Next] to confirm enter the Welcome screen.
- In the Welcome screen introduced the available input devices and interfaces.
- Please press [▲▼] to select the country where you will operate the TV.
- Select the local time zone according to your region.
- Daylight Saving: Set the Daylight Saving time for your area.
- Select your Mode Setting: Home Mode or Retail Mode.
- Home Message Adapters: Are you sure to change to retail mode? Select "OK" to continue, or select "No" to change your selection.
- Home Mode is the recommended setting which offers full functionality of the television. If you selected Retail Mode, Energy Saving is not available.

**Language setting**

**Country setting**

**Time zone setting**

**Use Mode**

**Select Network**

**Channel Search**

**Note:** If you are using a cable or satellite box and you have connected to the TV using a Coaxial cable, you should select the cable option. Be sure the cable or satellite box is powered on before starting the Channel Scan. If you are using a satellite box connected to the TV, Component or HDMI, you don't need to start for channels.

### 9 HELP TOPICS

When there is something wrong with your TV, you can try turning off the TV and restarting it. You can also refer to the following chart for problem and solutions. If the problem cannot be resolved, please contact Hisense for additional assistance.

SYMPTOMS	POSSIBLE SOLUTIONS
No sound or picture	<ul style="list-style-type: none"> <li>• Confirm power cord is plugged into the AC outlet and the AC outlet is getting electricity.</li> <li>• Attempt to power on using the power button on both the TV and the Remote.</li> </ul>
Picture is normal, but no sound	<ul style="list-style-type: none"> <li>• Check the volume settings.</li> <li>• Check if mute mode is set "on".</li> </ul>
I have connected an external picture and/or audio device	<ul style="list-style-type: none"> <li>• Check network physical connection, make sure connection is correct.</li> <li>• Enter "Menu", "Network", "Configuration", "Connection Test" to make sure that network connection test is successful.</li> <li>• Check network physical connection, make sure connection is correct.</li> <li>• Check network physical connection, make sure configuration is correct according to your network service provider.</li> <li>• Enter "Menu", "Network", "Applications", "Netflix", "Description" to reset "Netflix" account.</li> </ul>
Network connection fail.	<ul style="list-style-type: none"> <li>• You need a broadband (high speed) internet service with speed of no less than 1.5 Mbps.</li> <li>• Check network physical connection, make sure connection is correct.</li> <li>• Check network physical connection, make sure configuration is correct.</li> <li>• Check network physical connection, make sure configuration is correct according to your network service provider.</li> <li>• Before calling for services, check the following information for possible solutions to problems you may experience. If none of these solutions work, turn off the TV, then turn it on again.</li> <li>• Caution: Do not try to repair the TV yourself. Refer all servicing to qualified repair personnel.</li> </ul>
How do I get easy PPTV to work on my TV?	