

INSTRUCTION MANUAL

with Catalog of Replacement Parts

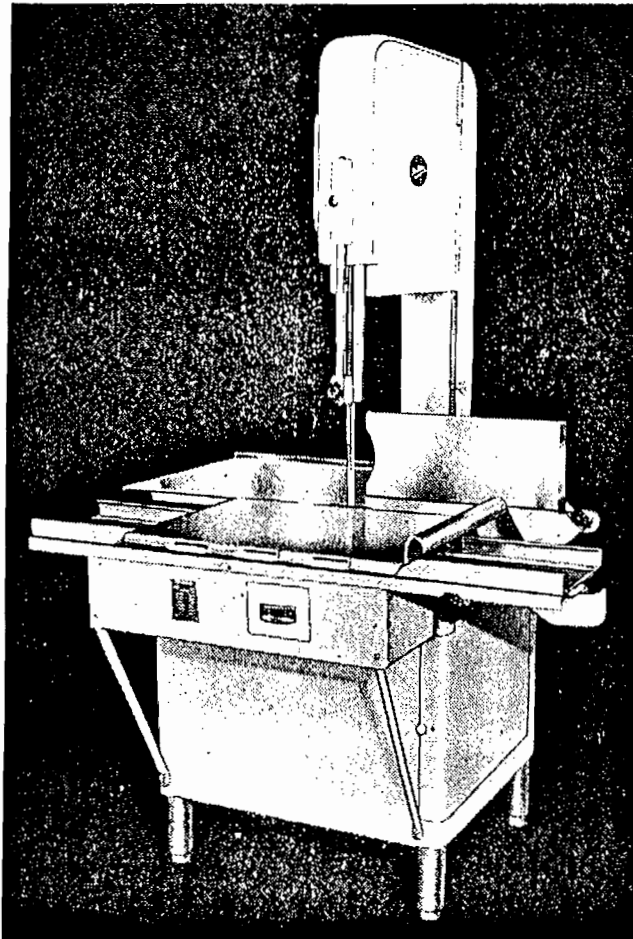

MODEL 5016 MEAT SAW

Spec. #8273



THE HOBART MANUFACTURING COMPANY

*The World's Oldest and Largest Manufacturer of Computing Scales and
Food Store, Kitchen, Bakery and Dishwashing Machines*

TROY, OHIO, U. S. A.

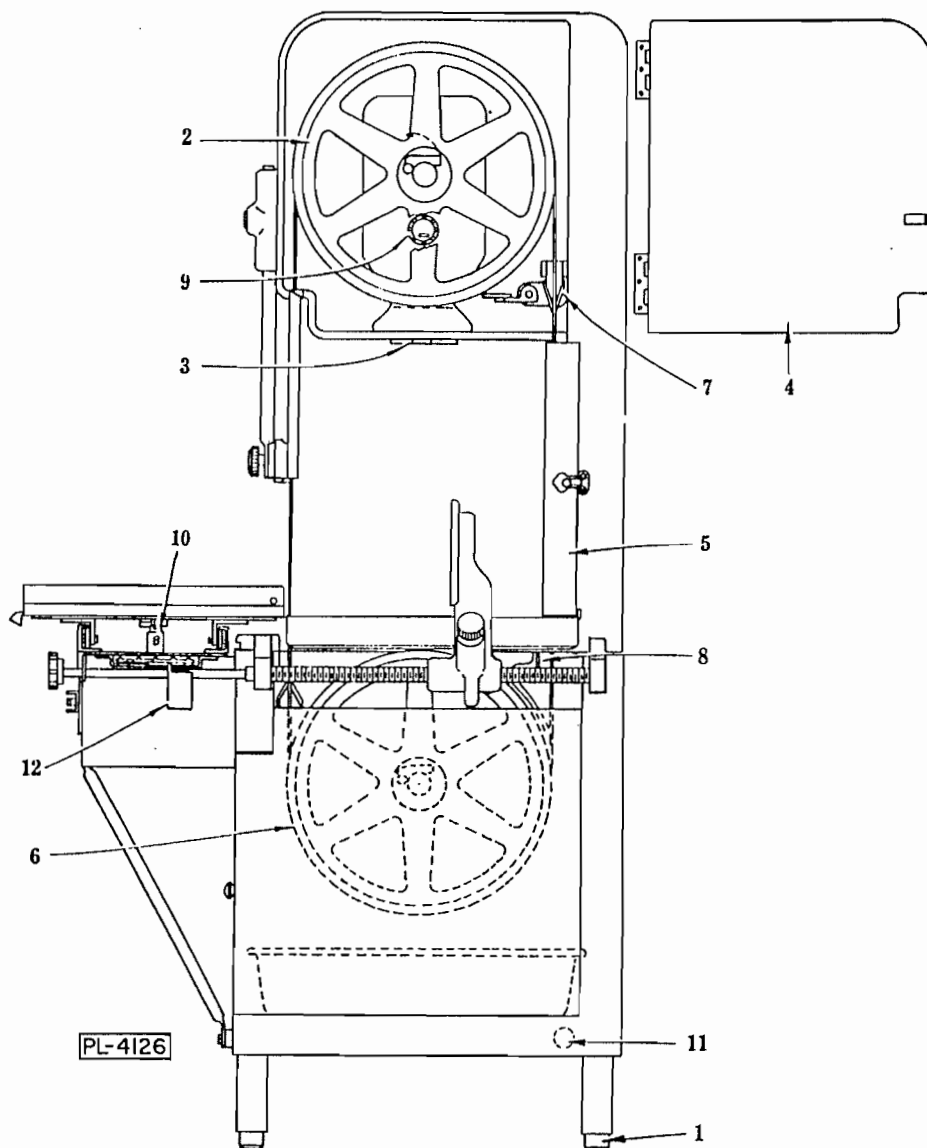

FIG. 1

INSTRUCTIONS FOR MODEL 5016 MEAT SAW

I. UNPACKING

Remove the shipping box that covers the saw. Next, unpack the following parts that were disassembled for shipping purposes; front track and gusset assembly, two base plate support braces, gage plate adjusting knob (with shaft), table, carriage assembly, and feet. (Instructions for re-assembly of these parts are given in section II, "Setting Up"). Remove the four retaining bolts from the underside of the skid.

II. SETTING UP

(1) Place the machine in the location where it is to be used. Re-assemble the feet (1, Fig. 1). Place a spirit level on top of the base unit and adjust the feet in the legs so that the base unit is level from side to side and front to back.

(2) Remove the motor access panel on the left side of the machine. Then using the two taper pins as locators, attach the front track and gusset assembly with the four retaining screws. Next assemble the two base plate support braces.

(3) Assemble the gage plate adjusting knob with shaft into position and lock in place with the rollpin furnished.

(4) Lower the upper blade pulley (2, Fig. 1) by giving the tension adjustment hand wheel (3, Fig. 1) a few turns to the left. Open the head door (4, Fig. 1), then unlatch and open the column cover (5, Fig. 1). Lift the knurled hand knob (1, Fig. 4) and raise the gage plate (2, Fig. 4) to its stopped position. Lift out the lower front wiper unit (Fig. 3) and lower the upper guide unit (Fig. 2) to its lowest position. Place the saw

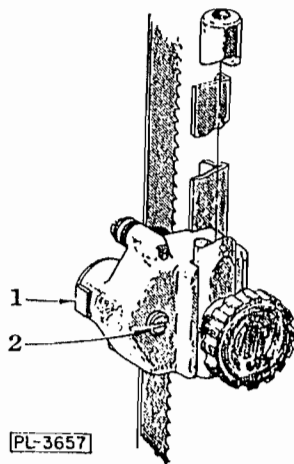

FIG. 2

blade over the upper blade pulley (2, Fig. 1) and lower blade pulley (6, Fig. 1). The teeth must point to the right and downward when viewed from the front as shown in Fig. 3. If they do not point downward, remove the blade, twist inside out and replace it on the saw. Make sure the blade is properly centered in the upper blade wiper (7, Fig. 1), the lower rear blade wiper (8, Fig. 1), and properly placed in the upper guide unit (Fig. 2). Turn the tension adjustment hand wheel (3, Fig. 1) to the right until the tension indicator (9, Fig. 1) reads "2." Give the upper blade pulley a few turns by hand so that the blade centers itself on the pulleys. Then turn the tension adjustment hand wheel slowly to the right until the indicator registers approximately "4". This is the best operating tension for the blade.

NOTE: See Paragraph IX for adjustment of blade back-up blocks.

(5) Close the head door (4, Fig. 1) and column cover (5, Fig. 1).

(6) Assemble the lower front wiper unit (Fig. 3). Before sliding it into place, swing up the bakelite guard (1, Fig. 3) and see that the saw blade is between the two wipers (2, Fig. 3) and in the guide slot of steel block (3, Fig. 3). After sliding the unit into place, close down the bakelite guard (1, Fig. 3).

(7) With the gage plate (2, Fig. 4) in the raised position (clear of the table area), assemble the table (3, Fig. 4). The table is positioned by the locating slots (4, Fig. 3) in the table rest angles of the base. Make sure the reinforcing angles of the table are outside the table rest angles of the base. Lock the table in place by the spring catch (4, Fig. 4).

(8) The carriage may be assembled from either side. When rolling the carriage into place depress the carriage stop (10, Fig. 1). After this stop is released, the carriage will then be retained from rolling off.

III. WIRING

Check the data on the name plate (5, Fig. 4) to make sure that it agrees with your electrical supply before connecting to the power line. Make your installation connection from the power line directly to the switch. To avoid having conduit at the front of the machine, it is recommended that flexible (or rigid) conduit be connected through the electrical inlet hole in the base (11, Fig. 1). The conduit connector on the end of the motor lead conduit should be assembled in the knock-out hole in the switch box. Next connect the motor leads to the switch.

Be sure to use wire large enough to meet your local code requirements. For proper performance use wire sizes of NOT LESS than #10 gage for 115 V., or #14 gage for 230 V. on single phase models. Use #14 gage for 208, 220, and 440 V. on three phase models. For long runs, between power inlet and saw, use a larger size.

IV. SAFETY FEATURES

The Hobart saw is provided with safety devices to give maximum protection to the operator. Keep the guards in place at all times.

(1) UPPER GUIDE ASSEMBLY (Fig. 2): Keep as low as the size of the work permits.

(2) DOORS: Keep all doors closed while the machine is running.

(3) BUTT-END PUSHER (6, Fig. 4): Use the pusher plate as described in paragraph VI and it will be unnecessary to hold your hand near the running saw blade.

(4) GAGE PLATE: The end of the gage plate (2, Fig. 4) is shaped to give maximum support and protection at this critical point, and at the same time, facilitate the taking off of slices.

V. LUBRICATION

Very little lubrication is required, because all the high-speed shafts have either roller or ball bearings which are grease packed and will operate a long time without attention.

(1) Keep a small amount of grease in the six ball bearing rollers on the carriage.

(2) Apply a few drops of oil occasionally to the gage plate screw (7, Fig. 4) and work the gage plate assembly back and forth a few times.

(3) Once a year, have a Hobart Service man look over the motor and main bearing carriers.

VI. OPERATION

Place the item to be cut on the carriage and turn on the motor switch. Stand in front of the

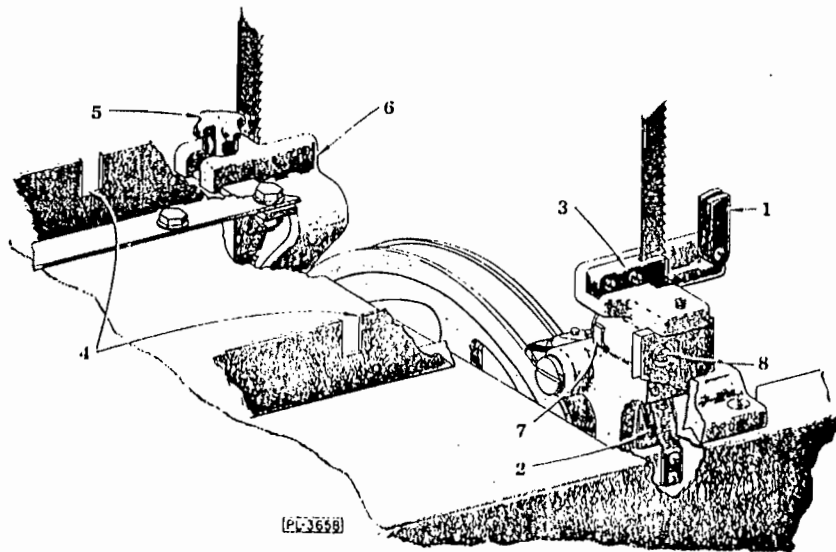

FIG. 3

machine, leaning lightly against the scalloped front of the carriage and move the carriage to the left, past the saw blade, at a steady and uniform rate. Your left hand will then be free to take away and stack the items as they are cut off. Make it a habit to move your hand around the left side, or back of the saw blade, when reaching for an item — NEVER IN FRONT OF THE TEETH. On the return stroke, pull the item toward you so that it clears the saw blade.

The saw cuts through bone and meat alike, and no preliminary preparation with the butcher knife is necessary as with a hand saw.

When cutting slices of uniform thickness, set the gage plate at the desired point with adjusting knob (8, Fig. 4) on the scale etched on the table. If the gage plate is not needed and interferes with the work, it may be raised out of the way. Lift the release knob (1, Fig. 4) and slide the gage plate on back to the end of gage plate screw (7, Fig. 4). The gage plate may be swung to a raised position at any setting along the gage plate screw without lifting the release knob.

To slice short ends, use the pusher plate (6, Fig. 4) to hold the meat against the gage plate. A rolled groove of the pusher plate slips over and slides along the rolled edge of the carriage. By holding the pusher plate with your right hand, your hand will then always be a safe distance from the saw blade and the stop will prevent the pusher plate from going too far. When not using the pusher plate, keep it stored beneath the carriage track, where provision has been made for holding it (12, Fig. 1).

VII. CLEANING

It is very important that any machine used in preparation of food be kept in a clean and sanitary condition. This saw has been designed

to make cleaning a quick and easy job.

Daily cleaning is recommended.

SUGGESTED CLEANING PROCEDURE:

(1) Roll carriage to extreme right or left. This exposes the carriage stop. Depress carriage stop and roll off stainless carriage.

(2) Rotate gage plate to raised position.

(3) Release spring catch and remove stainless steel table.

(4) Loosen the hand knob (9, Fig. 4), bump with hand to loosen stud and then remove the hand knob. Open head door and lift out upper blade wiper. Clean unit and lubricate with TASTELESS oil.

(5) Swing lower saw blade guard (1, Fig. 3) up and lift out lower wiper assembly. Clean unit thoroughly and lubricate with TASTELESS oil.

(6) Loosen hand knob (5, Fig. 3) and remove lower rear blade wiper (6, Fig. 3). Clean unit.

(7) Open base door and remove scrap pan.

(8) Release blade tension by turning tension adjustment hand wheel to the left. Open head door, unlatch and open the column cover. Remove saw blade.

(9) To remove the upper guide unit, remove the hand knob (10, Fig. 4) (blade tension already released) then lift off unit. Clean, lubricate with TASTELESS oil and replace.

(10) The upper and lower blade pulleys may be removed from their shafts by swinging the retaining latches clear of the shafts, then sliding the pulley from the shaft. Clean pulleys and lubricate bore before replacing.

All areas are now exposed for easy and thorough cleaning.

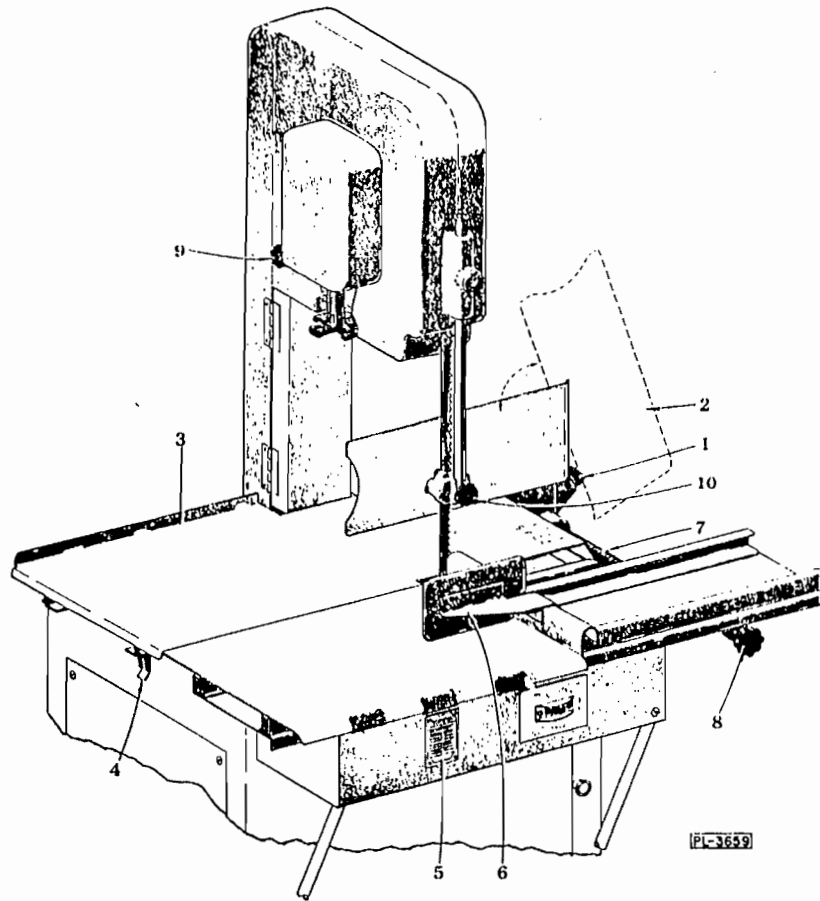

FIG. 4

NOTE: When replacing pulleys, make sure that pulley latches are properly seated in grooves of shaft. Also the blade and pulley wipers must be in proper operating positions.

VIII. CHANGING SAW BLADES

This meat saw is so designed that the saw blade may be quickly and easily replaced. Use the following method for replacement:

(1) Move the carriage to the left to the stop, then depress the stop and move the carriage a few more inches just beyond the bakelite guard.

(2) Rotate gage plate to raised position.

(3) Lower upper blade pulley by turning tension adjustment hand wheel to left.

(4) Open head door, unlatch and open column cover.

(5) Swing up lower blade guard (1, Fig. 3) and remove blade.

(6) Put on the new blade, turn the tension adjustment hand wheel to the right until the indicator reads "2". Turn the upper blade pulley (2, Fig. 1) by hand to center the blade. Then

turn the tension adjustment hand wheel until the indicator registers approximately "4". Close lower blade guard (1, Fig. 3). Make sure that front and rear lower blade wipers and the upper blade wiper (7, Fig. 1) are on both sides of the blade.

IX. ADJUSTMENT OF BLADE BACK-UP BLOCK

At the back edge of the saw blade in the upper guide (1, Fig. 2) and the front lower wiper unit (7, Fig. 3) are hardened blade back-up blocks which take the cutting thrust. The clearance between these blocks and the blade, with the saw running without load, should be approximately $1/32"$. Always check this dimension after changing blades. These back-up blocks should be adjusted to suit any variation in blade widths.

NOTE: Adjust the upper back-up block (1, Fig. 2) by turning screw (2, Fig. 2) and lower back-up block (7, Fig. 3) by turning the screw (8, Fig. 3).

X. BLADE REPLACEMENT

Two saw blades are furnished as regular equipment with every machine. Replacement blades are available thru all Hobart offices.

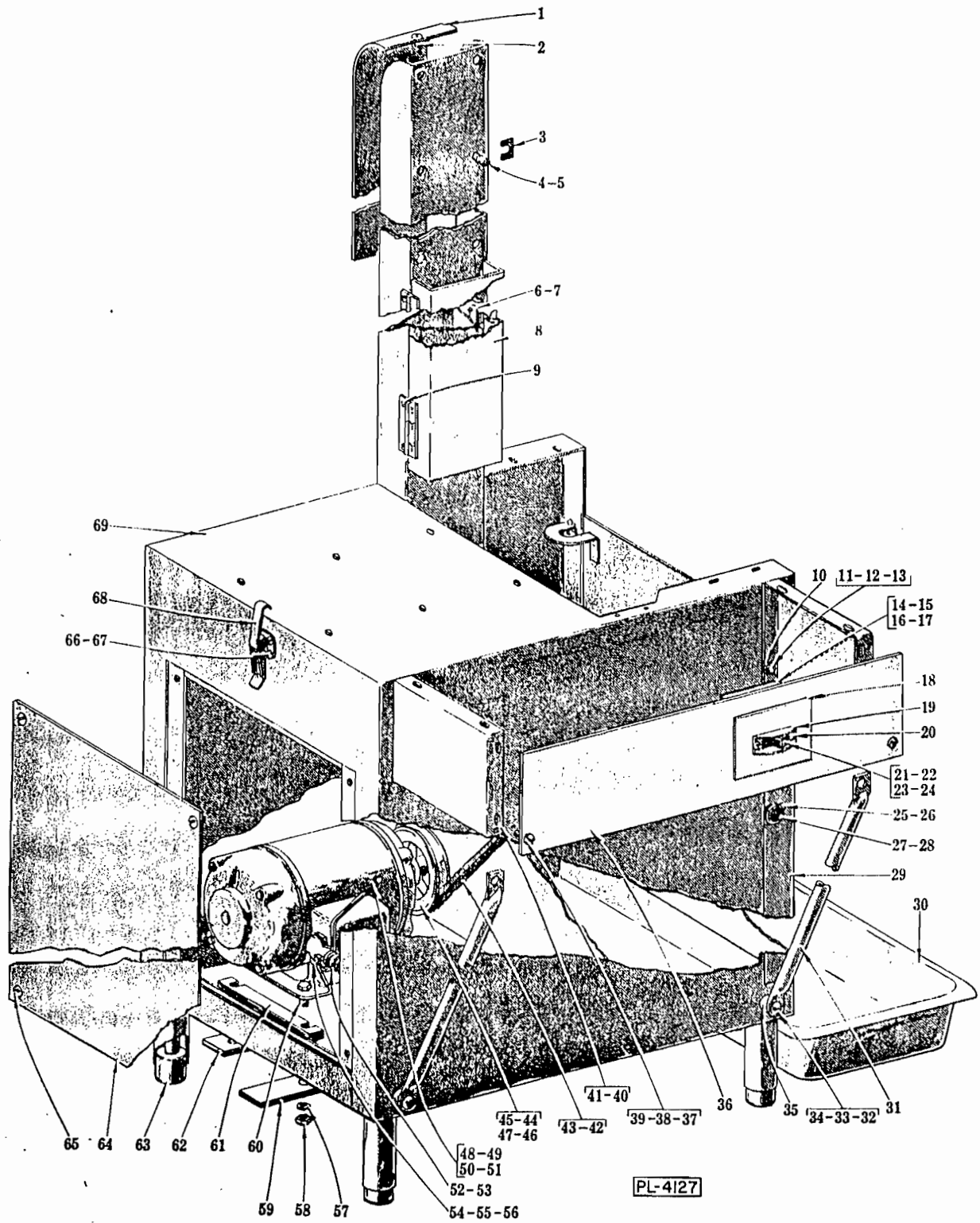

MAIN FRAME AND BASE UNIT

HOBART REPLACEMENT PARTS

MAIN FRAME AND BASE UNIT

| ILLUS. PL-4127 | PART NO. | NAME OF PART | AMT. |
|----------------|------------|---|-----------|
| 1 | S-71223 | Cover - Column Top ----- | 1 |
| 2 | SC-10-15 | Mach. Screw - #10-24 x 1/2" Truss Hd. ----- | 5 |
| 3 | M-74022 | Shim - Head ----- | As Req'd. |
| 4 | SC-36-50 | Fin. Bolt - 3/8"-16 x 1/2" Hex Hd. ----- | 8 |
| 5 | WL-4-2 | Lock Washer - 3/8" x .136" x .070" ----- | 8 |
| 6 | SC-21-8 | Mach. Screw - #6-32 x 3/8" Rd. Hd. ----- | 2 |
| 7 | M-72200 | Catch - Cover Clamp ----- | 1 |
| 8 | R-71399 | Cover Assy. ----- | 1 |
| 9 | SC-53-5 | Mach. Screw - #10-24 x 3/8" Truss Hd. ----- | 4 |
| 10 | WS-6-11 | Washer ----- | 8 |
| 11 | SC-36-54 | Fin. Bolt - 3/8"-16 x 1" Hex Hd. ----- | 4 |
| 12 | WL-4-2 | Lock Washer - 3/8" x .136" x .070" ----- | 4 |
| 13 | NS-13-22 | Full Nut - 3/8"-16 Hex Fin. ----- | 4 |
| 14 | P-67300 | Switch Box Assy. ----- | 1 |
| 15 | SC-9-28 | Mach. Screw - #10-24 x 3/8" Rd. Hd. ----- | 2 |
| 16 | WL-3-20 | Lock Washer - #10 x .055" x .040" ----- | 2 |
| 17 | NS-9-24 | Mach. Nut - #10-24 Hex ----- | 2 |
| 18 | P-71380 | Plate - Switch Cover ----- | 1 |
| 19 | M-14506-3 | Shield - Switch ----- | 1 |
| 20 | SC-9-44 | Mach. Screw - #6-32 x 1/2" Rd. Hd. ----- | 2 |
| 21 | SC-13-14 | Mach. Screw - #6-32 x 3/8" Flat Hd. ----- | 2 |
| 22 | R-24940-2 | Switch (2 & 3 Phase, Below 250 V.) ----- | 1 |
| 23 | R-24940-4 | Switch (1 Phase, Below 250 V.) ----- | 1 |
| 24 | SS-3-26 | Switch (2 & 3 Phase, Above 250 V.) ----- | 1 |
| 25 | SC-7-74 | Mach. Screw - #10-24 x 3/8" Rd. Hd. ----- | 2 |
| 26 | NS-9-21 | Mach. Nut - #10-24 Hex ----- | 1 |
| 27 | M-23274 | Knob - Door ----- | 1 |
| 28 | M-68176 | Clip - Base Door Spring ----- | 1 |
| 29 | S-71393 | Base Door Assy. ----- | 1 |
| 30 | S-71518 | Pan - Scrap ----- | 1 |
| 31 | S-71221 | Brace - Base Plate Support ----- | 2 |
| 32 | SC-60-65 | Mach. Screw - 3/8"-16 x 1-1/2" Rd. Hd. ----- | 2 |
| 33 | WL-4-4 | Lock Washer - 3/8" x .136" x .070" ----- | 2 |
| 34 | NS-13-22 | Full Nut - 3/8"-16 Hex Fin. ----- | 2 |
| 35 | M-62525 | Spacer ----- | 2 |
| 36 | R-71414 | Front Assy. ----- | 1 |
| 37 | SC-9-10 | Mach. Screw - 3/8"-16 x 3/4" Rd. Hd. ----- | 2 |
| 38 | WL-4-4 | Lock Washer - 3/8" x .136" x .070" ----- | 2 |
| 39 | NS-13-22 | Full Nut - 3/8"-16 Hex Fin. ----- | 2 |
| 40 | S-71387 | Gusset - Track Support ----- | 2 |
| 41 | PT-3-59 | Taper Pin - #4 x 3/4" Lg. ----- | 2 |
| 42 | BV-5-12 | "V" Belt (60 Cy.) ----- | 1 |
| 43 | BV-5-11 | "V" Belt (50 Cy.) ----- | 1 |
| 44 | R-71418-1 | "V" Pulley - Motor (5.6" O.D.) (60 Cy.) (Incls. item #46) ----- | 1 |
| 45 | R-71418-2 | "V" Pulley - Motor (6.6" O.D.) (50 Cy.) (Incls. item #46) ----- | 1 |
| 46 | SC-47-32 | Set Screw - 5/16"-18 x 5/16" Cup Pt. ----- | 1 |
| 47 | R-12430-62 | Key ----- | 1 |
| 48 | S-71466-1 | Motor - 1 Phase 115/230 V. 60 Cy. ----- | 1 |
| 49 | S-71466-2 | Motor - 1 Phase 208 V. 60 Cy. ----- | 1 |
| 50 | S-71467-1 | Motor - 3 Phase 208/220/440 V. 60 Cy. ----- | 1 |
| 51 | S-71467-2 | Motor - 3 Phase 550 V. 60 Cy. ----- | 1 |
| 52 | P-24127-89 | Conduit - 1/2" x 32" Flex. ----- | 1 |
| 53 | BF-2-19 | Bushing - 1/2" Anti-Short ----- | 2 |
| 54 | FE-2-17 | Connector - 90° (1/2" Male Thd. x 1/2" Flex Cnd.) ----- | 2 |
| 55 | FE-6-38 | Reducer (3/4" to 1/2" Female Cnd.) ----- | 1 |
| 56 | FE-6-6 | Lock Nut - 3/4" Cnd. ----- | 1 |
| 57 | WL-4-2 | Lock Washer - 3/8" x .136" x .070" ----- | 4 |
| 58 | NS-13-22 | Full Nut - 3/8"-16 Hex Fin. ----- | 4 |
| 59 | P-67593 | Reinforcement - Base (Long) ----- | 1 |
| 60 | SC-36-57 | Fin. Bolt - 3/8"-16 x 1-1/4" Hex Hd. ----- | 4 |
| 61 | M-67305 | Booster - Motor ----- | As Req'd. |
| 62 | P-71638 | Reinforcement - Base (Short) ----- | 1 |
| 63 | M-71335-1 | Foot & Stud Assy. ----- | 4 |
| 64 | R-71394 | Panel - Motor Access ----- | 1 |
| 65 | SC-10-33 | Mach. Screw - #10-24 x 1/2" Truss Hd. ----- | 4 |
| 66 | SC-10-33 | Mach. Screw - #10-24 x 1/2" Truss Hd. ----- | 4 |
| 67 | NS-31-12 | Stop Nut - #10-24" "Elastic" ----- | 4 |
| 68 | P-71437 | Clamp - Table ----- | 1 |
| 69 | T-71232 | Base Assy. ----- | 1 |

HOBART REPLACEMENT PARTS

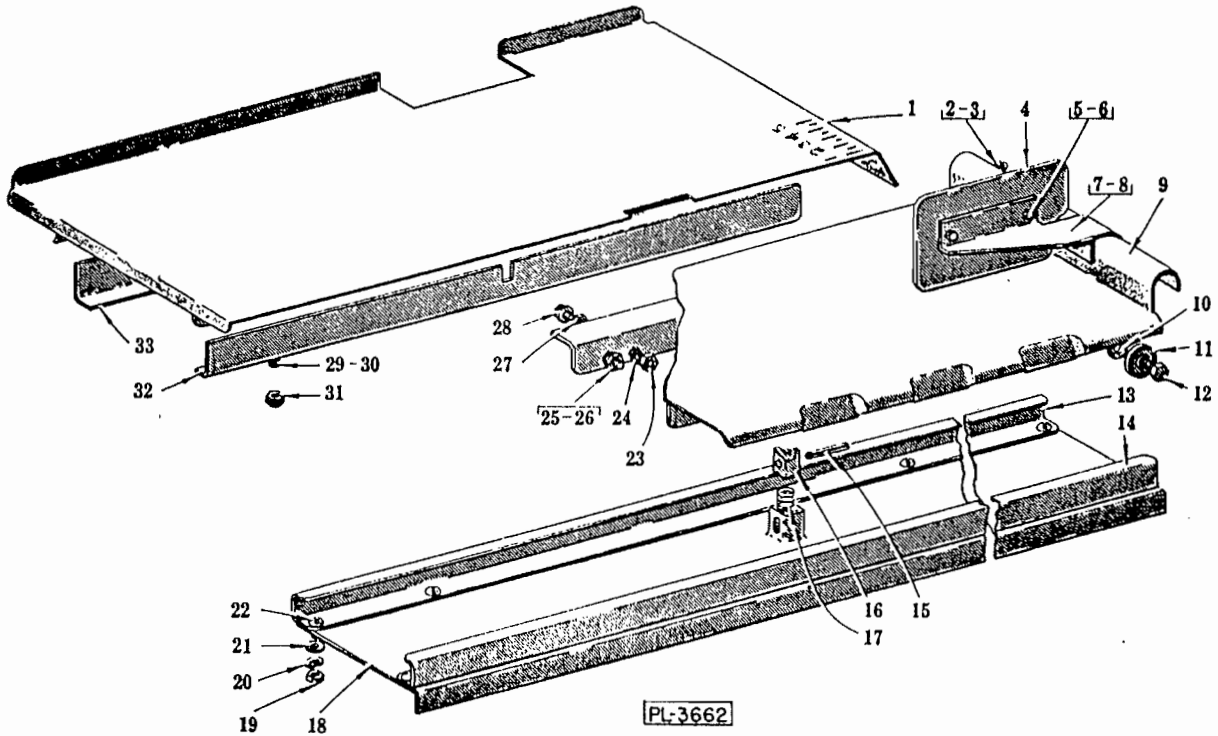

PL-3662

TABLE, CARRIAGE AND TRACK UNIT

| ILLUS. NO. | PART NO. | NAME OF PART | AMT. |
|------------|----------|--|------|
| 1 | S-71285 | Table Assy. ----- | 1 |
| 2 | NS-27-2 | Acorn Nut - #10-24 Hex ----- | 1 |
| 3 | SC-10-48 | Mach. Screw - #10-24 x 1/4" Truss Hd. ----- | 1 |
| 4 | R-71429 | Plate - Pusher ----- | 1 |
| 5 | SC-15-34 | Mach. Screw - #10-24 x 1/2" Oval Hd. ----- | 2 |
| 6 | NS-24-15 | Acorn Nut - #10-24 Hex ----- | 2 |
| 7 | P-71430 | Pusher Plate Bracket Assy. ----- | 1 |
| 8 | R-71434 | Pusher Plate Assy. (Incls. items #4, 5, 6 & 7) ----- | 1 |
| 9 | T-71278 | Carriage Sub-Assy. ----- | 1 |
| 10 | WS-18-5 | Washer ----- | 6 |
| 11 | BB-8-2 | Ball Bearing - Nice #400-24 ----- | 6 |
| 12 | SC-37-73 | Fln. Bolt - 3/8"-16 x 1" Hex Hd. ----- | 6 |
| 13 | R-71355 | Track - Back ----- | 1 |
| 14 | R-71356 | Track - Front ----- | 1 |
| 15 | RP-3-5 | Rollpin - 1/4" Dia. x 2" Lg. ----- | 1 |
| 16 | M-72576 | Stop - Carriage ----- | 1 |
| 17 | M-67317 | Spring - Carriage Stop ----- | 1 |
| 18 | S-71411 | Base Cover Plate Assy. ----- | 1 |
| 19 | NS-13-11 | Full Nut - 5/16"-18 Hex Fln. ----- | 8 |
| 20 | WL-3-44 | Lock Washer - 5/16" x .125" x .078" ----- | 8 |
| 21 | WS-4-25 | Washer ----- | 8 |
| 22 | SC-8-88 | Mach. Screw - 5/16"-18 x 3/4" Rd. Hd. ----- | 8 |
| 23 | NS-17-8 | Jam Nut - 5/16"-18 Hex Fln. ----- | 2 |
| 24 | WL-3-44 | Lock Washer - 5/16" x .125 x .078" ----- | 2 |
| 25 | NS-13-25 | Full Nut - 3/8"-16 Hex Fln. ----- | 6 |
| 26 | WL-4-4 | Lock Washer - 3/8" x .186" x .070" ----- | 6 |
| 27 | NS-17-8 | Jam Nut - 5/16"-18 Hex Fln. ----- | 2 |
| 28 | M-67245 | Thrust Plug & Holder Assy. ----- | 2 |
| 29 | SC-36-54 | Fln. Bolt - 3/8"-16 x 1" Hex Hd. ----- | 6 |
| 30 | WS-6-26 | Washer ----- | 6 |
| 31 | NS-31-47 | Stop Nut - 3/8"-16 "Elastic" ----- | 6 |
| 32 | R-71390 | Rest - Front Table ----- | 1 |
| 33 | R-71391 | Rest - Rear Table ----- | 1 |
| | M-72896 | Carriage Assy. Unit (Incls. items #2, 3, 9, 10, 11, 12, 23, 24, 25, 26, 27 & 28) ----- | 1 |

HOBART REPLACEMENT PARTS

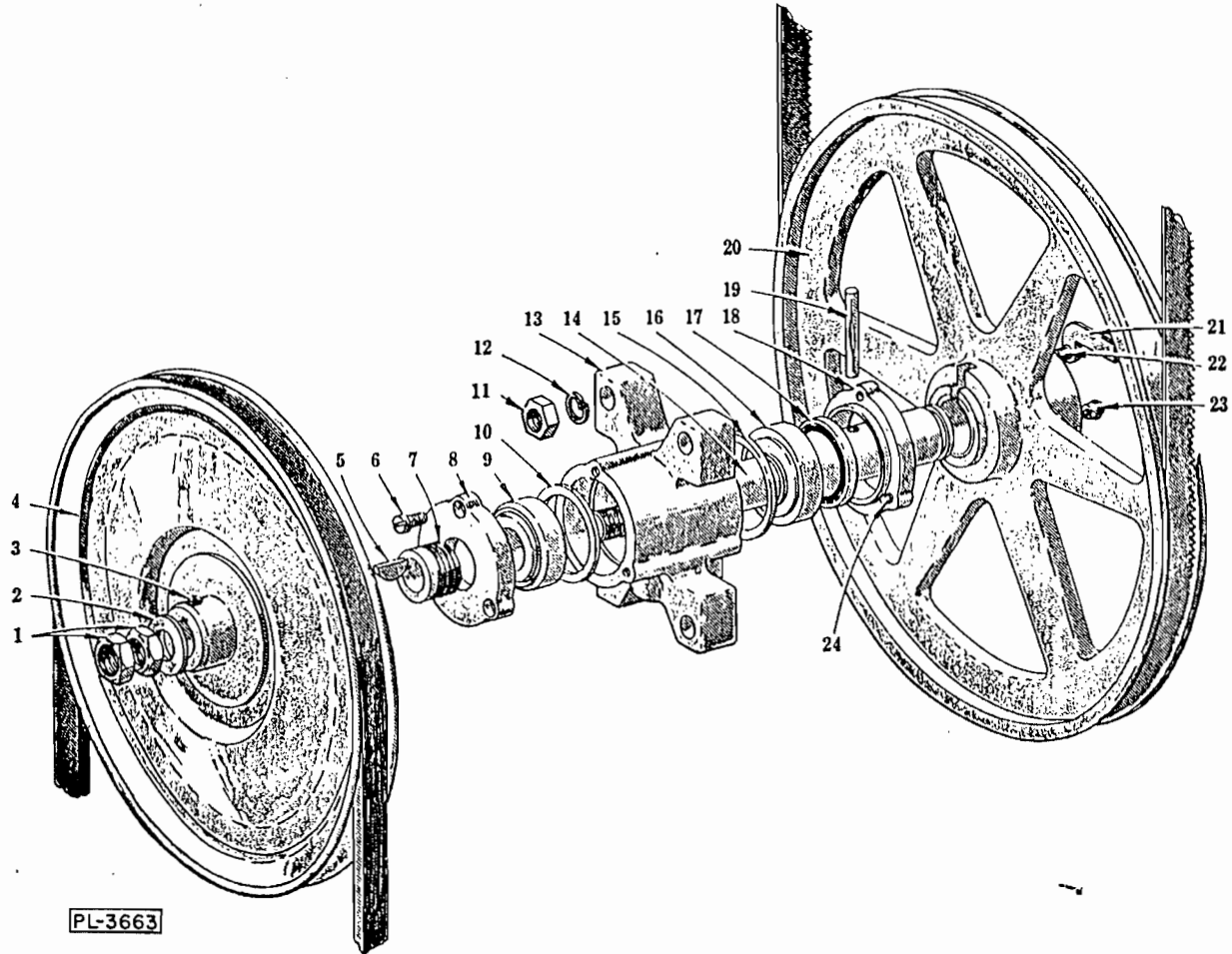

PL-3663

LOWER BEARING CARRIER UNIT

| ILLUS. NO. | PART NO. | NAME OF PART | AMT. |
|------------|----------|--|------|
| 1 | NS-17-49 | Jam Nut - 3/4"-16 Hex Fin. ----- | 2 |
| 2 | WS-11-24 | Washer ----- | 1 |
| 3 | SC-47-32 | Set Screw - 5/16"-18 x 5/16" Soc. Hdless. Cup Pt. ----- | 1 |
| 4 | R-74151 | "V" Pulley - Brg. Carrier (13" O.D.) (Incls. Item #3) ----- | 1 |
| 5 | KW-3-15 | Key - #807 Woodruff ----- | 1 |
| 6 | SC-12-69 | Mach. Screw - 1/4"-20 x 1/2" Fil. Hd. ----- | 3 |
| 7 | M-67243 | Conveyor - Grease ----- | 1 |
| 8 | P-67203 | Cap - Brg. Carrier ("V" Belt Side) ----- | 1 |
| 9 | BR-2-16 | Roller Bearing ----- | 1 |
| 10 | RR-6-1 | Retaining Ring ----- | 1 |
| 11 | NS-13-30 | Full Nut - 1/2"-13 Hex Fin. ----- | 8 |
| 12 | WL-8-31 | Lock Washer - 1/2" Int. Shakeproof ----- | 8 |
| 13 | R-71296 | Carrier - Lower Bearing ----- | 1 |
| 14 | R-71299 | Shaft - Lower Brg. Carrier ----- | 1 |
| 15 | RR-7-1 | Retaining Ring ----- | 1 |
| 16 | BR-2-20 | Roller Bearing ----- | 1 |
| 17 | M-71403 | Seal - Grease ----- | 1 |
| 18 | P-71297 | Cap - Brg. Carrier (Saw Pulley Side) ----- | 1 |
| 19 | PG-7-31 | Groov-Pin - Type #5, 5/16" x 2-1/4" ----- | 1 |
| 20 | R-72364 | Flanged Pulley (Blade) Sub-Assy. Unit (Incls. items #21, 22 & 23) ----- | 1 |
| 21 | M-20852 | Latch ----- | 1 |
| 22 | V-20851 | Screw - Latch ----- | 1 |
| 23 | M-24114 | Catch - #8-1/2 Frost ----- | 1 |
| 24 | SC-12-69 | Mach. Screw - 1/4"-20 x 1/2" Fil. Hd. ----- | 3 |
| | P-71433 | Lower Bearing Carrier Sub-Assy. (Incls. Items #6, 8, 9, 10, 13, 14, 15, 16, 17, 18, 19 & 24) ----- | 1 |

HOBART REPLACEMENT PARTS

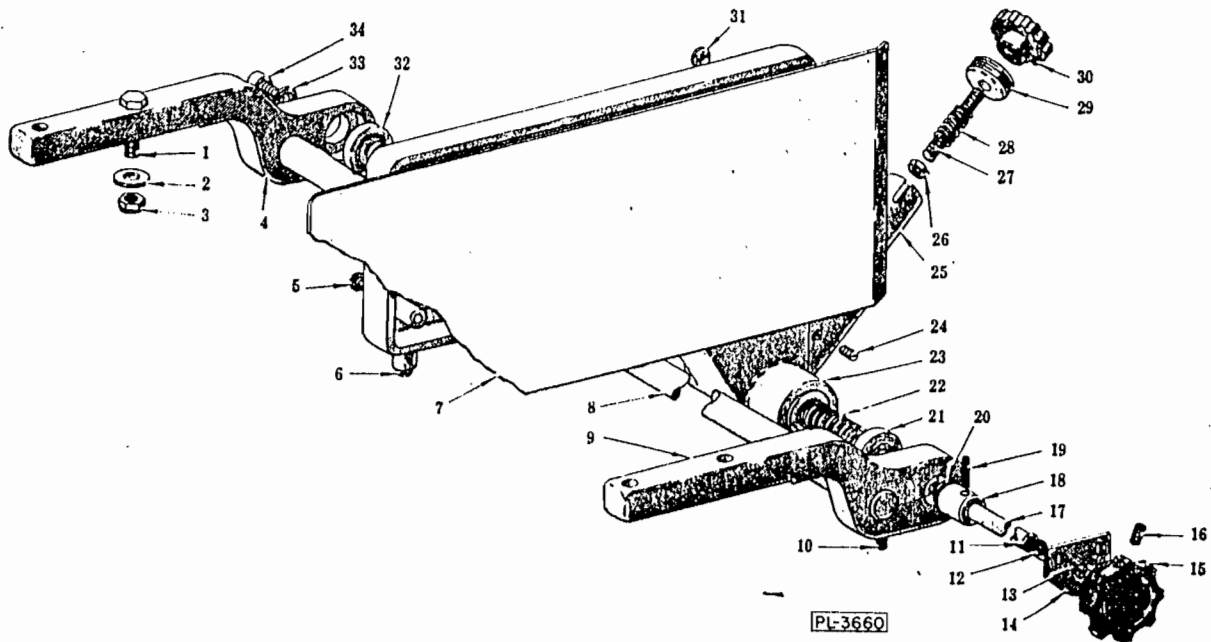

GAGE PLATE UNIT

| ILLUS. NO. | PART NO. | NAME OF PART | AMT. |
|------------|-----------|---|------|
| 1 | SC-36-60 | Fin. Bolt - 3/8"-16 x 1-3/4" Hex Hd. | 4 |
| 2 | WS-6-33 | Washer | 4 |
| 3 | NS-31-47 | Stop Nut - 3/8"-16 "Elastic" | 4 |
| 4 | R-71271 | Bracket - Rear Support | 1 |
| 5 | SC-9-57 | Mach. Screw - #10-24 x 7/8" Truss Hd. | 4 |
| 6 | M-67314 | Mach. Screw - Gage Plate (Nylon) | 1 |
| 7 | S-71301 | Gage Plate & Weld Stud Assy. | 1 |
| 8 | P-71371 | Rod - Gage Plate Stop | 1 |
| 9 | R-71270 | Bracket - Front Support | 1 |
| 10 | SC-47-43 | Set Screw - 3/8"-16 x 1/2" Soc. Hd. Kn. Cup Pt. | 2 |
| 11 | NS-9-21 | Mach. Nut - #10-24 Hex | 3 |
| 12 | WL-3-20 | Lock Washer - #10 x .055" x .040" | 3 |
| 13 | SC-7-77 | Mach. Screw - #10-24 x 1/2" Rd. Hd. | 3 |
| 14 | M-71406 | Support - Gage Plate Rod | 1 |
| 15 | M-71511 | Knob - Gage Plate Adjusting | 1 |
| 16 | SC-47-15 | Set Screw - 1/4"-20 x 1/2" Soc. Hd. Kn. Cup Pt. | 1 |
| 17 | P-71375 | Shaft - Gage Plate Extension | 1 |
| 18 | M-71374 | Adapter - Gage Plate Screw | 1 |
| 19 | RP-3-14 | Rollpin - 3/16" Dia. x 7/8" Lg. | 1 |
| 20 | WL-8-26 | Lock Washer - 3/8" Int. Shakeproof | 1 |
| 21 | BB-8-2 | Ball Bearing - Nice #400-24 | 1 |
| 22 | P-71367 | Screw - Gage Plate | 1 |
| 23 | R-71292-1 | Gage Plate Support & Bushing Assy. | 1 |
| 24 | SC-63-26 | Set Screw - 1/4"-20 x 1/4" Flat Pt. | 2 |
| 25 | M-69595 | Half Nut - Gage Plate | 1 |
| 26 | NS-17-6 | Jam Nut - 5/16"-18 Hex Fin. | 1 |
| 27 | M-67150 | Stud - Gage Plate | 1 |
| 28 | V-7433-2 | Spring | 1 |
| 29 | M-67191 | Retainer - Gage Plate Half Nut | 1 |
| 30 | M-67315 | Knob | 1 |
| 31 | M-69585-1 | Button - Plug | 1 |
| 32 | BB-8-2 | Ball Bearing - Nice #400-24 | 1 |
| 33 | WL-4-2 | Lock Washer - 3/8" x .136" x .070" | 1 |
| 34 | SC-40-70 | Cap Screw - 3/8"-16 x 1" Soc. Fil. Hd. | 1 |
| | S-71307-1 | Gage Plate Assy. (Incls. Items #5, 6, 7, 23, 24, 25, 26, 27, 28, 29, 30 & 31) | 1 |

HOBART REPLACEMENT PARTS

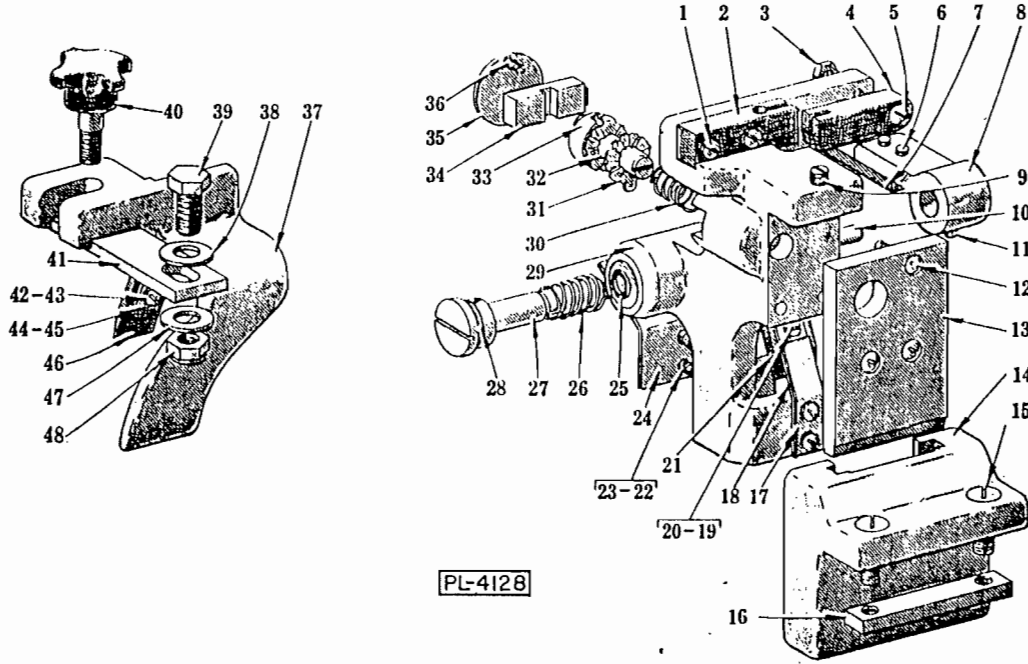

LOWER GUIDE AND WIPER UNIT

| ILLUS. NO. | PART NO. | NAME OF PART | AMT. |
|------------|----------|---|------|
| | 1 | SC-12-76 Mach. Screw - #10-24 x 1" Fil. Hd. ----- | 2 |
| | 2 | M-71369 Guide - Saw Blade ----- | 1 |
| | 3 | NS-9-24 Mach. Nut - #10-24 Hex ----- | 1 |
| | 4 | M-71363 Guard - Saw Blade ----- | 1 |
| | 5 | SC-9-55 Mach. Screw - #10-24 x 1-1/4" Rd. Hd. ----- | 1 |
| | 6 | SC-10-33 Mach. Screw - #10-24 x 1/2" Truss Hd. ----- | 2 |
| | 7 | M-71368 Wiper - Blade Pulley ----- | 1 |
| | 8 | P-71358 Bracket - Scraper Pivot ----- | 1 |
| | 9 | SC-63-21 Set Screw - #10-24 x 5/16" Flat Pt. ----- | 2 |
| | 10 | P-11800-244 Dowel ----- | 1 |
| | 11 | SC-75-5 Set Screw - #10-24 x 1/4" Soc. Hd. Kn. Cup Pt. ----- | 1 |
| | 12 | SC-12-69 Mach. Screw - 1/4"-20 x 1/2" Fil. Hd. ----- | 3 |
| | 13 | P-71372 Slide - Lower Wiper Brkt. ----- | 1 |
| | 14 | P-67189 Slideway - Wiper Brkt. ----- | 1 |
| | 15 | SC-8-92 Mach. Screw - 5/16"-18 x 1" Rd. Hd. ----- | 2 |
| | 16 | M-67702 Plate - Wiper Brkt. Retainer ----- | 1 |
| | 17 | M-74612 Spring - Back-up ----- | 2 |
| | 18 | M-67185 Spring - Scraper Blade ----- | 2 |
| | 19 | SC-21-85 Mach. Screw - #8-32 x 3/16" Rd. Hd. ----- | 4 |
| | 20 | WL-6-1 Lock Washer - #8 x .047" x .031" ----- | 4 |
| | 21 | M-67184 Blade - Scraper ----- | 2 |
| | 22 | SC-21-14 Mach. Screw - #8-32 x 3/8" Rd. Hd. ----- | 4 |
| | 23 | WL-6-1 Lock Washer - #8 x .047" x .031" ----- | 4 |
| | 24 | M-72443 Shield - Lower Pulley ----- | 1 |
| | 25 | R-67500-2 "O" Ring ----- | 1 |
| | 26 | M-71364 Spring - Blade Pulley Wiper ----- | 1 |
| | 27 | P-71376 Shaft - Lower Wiper Brkt. ----- | 1 |
| | 28 | R-67500-7 "O" Ring ----- | 1 |
| | 29 | S-71360 Bracket - Lower Wiper ----- | 1 |
| | 30 | V-23326 Spring - Adj. Blade Guide ----- | 1 |
| | 31 | M-23275 Lock Washer - Adj. Blade (Stat.) ----- | 1 |
| | 32 | M-23328 Lock Washer - Adj. Blade (Rot.) ----- | 1 |
| | 33 | M-71382 Shaft - Back-Up Block ----- | 1 |
| | 34 | M-71373 Block - Blade Back-Up ----- | 1 |
| | 35 | M-71377 Retainer - Blade Back-Up Block ----- | 1 |
| | 36 | SC-7-24 Mach. Screw - #6-32 x 3/8" Rd. Hd. ----- | 2 |
| | 37 | R-72365 Bracket - Wiper ----- | 1 |
| | 38 | WS-6-26 Washer ----- | 1 |
| | 39 | SC-37-73 Fin. Bolt - 3/8"-16 x 1" Hex Hd. ----- | 1 |
| | 40 | P-70200 Screw - Retaining ----- | 1 |
| | 41 | M-72372 Support - Wiper Bracket ----- | 1 |
| | 42 | SC-21-85 Mach. Screw - #8-32 x 3/16" Rd. Hd. ----- | 4 |
| | 43 | WL-6-1 Lock Washer - #8 x .047" x .031" ----- | 4 |
| | 44 | M-67185 Spring - Scraper Blade ----- | 1 |
| | 45 | M-74612 Spring - Back-up ----- | 1 |
| | 46 | M-67184 Blade - Scraper ----- | 1 |
| | 47 | WS-6-26 Washer ----- | 1 |
| | 48 | NS-31-47 Stop Nut - 3/8"-16 "Elastic" ----- | 1 |
| | | Wiper Brkt. & Wiper Assy. (Incls. Items #37, 42, 43, 44, 45 & 46) | 1 |
| | | Lower Wiper & Guide Unit Assy. (Incls. Items #1 to 13 inclusive & 17 to 36 inclusive) | 1 |

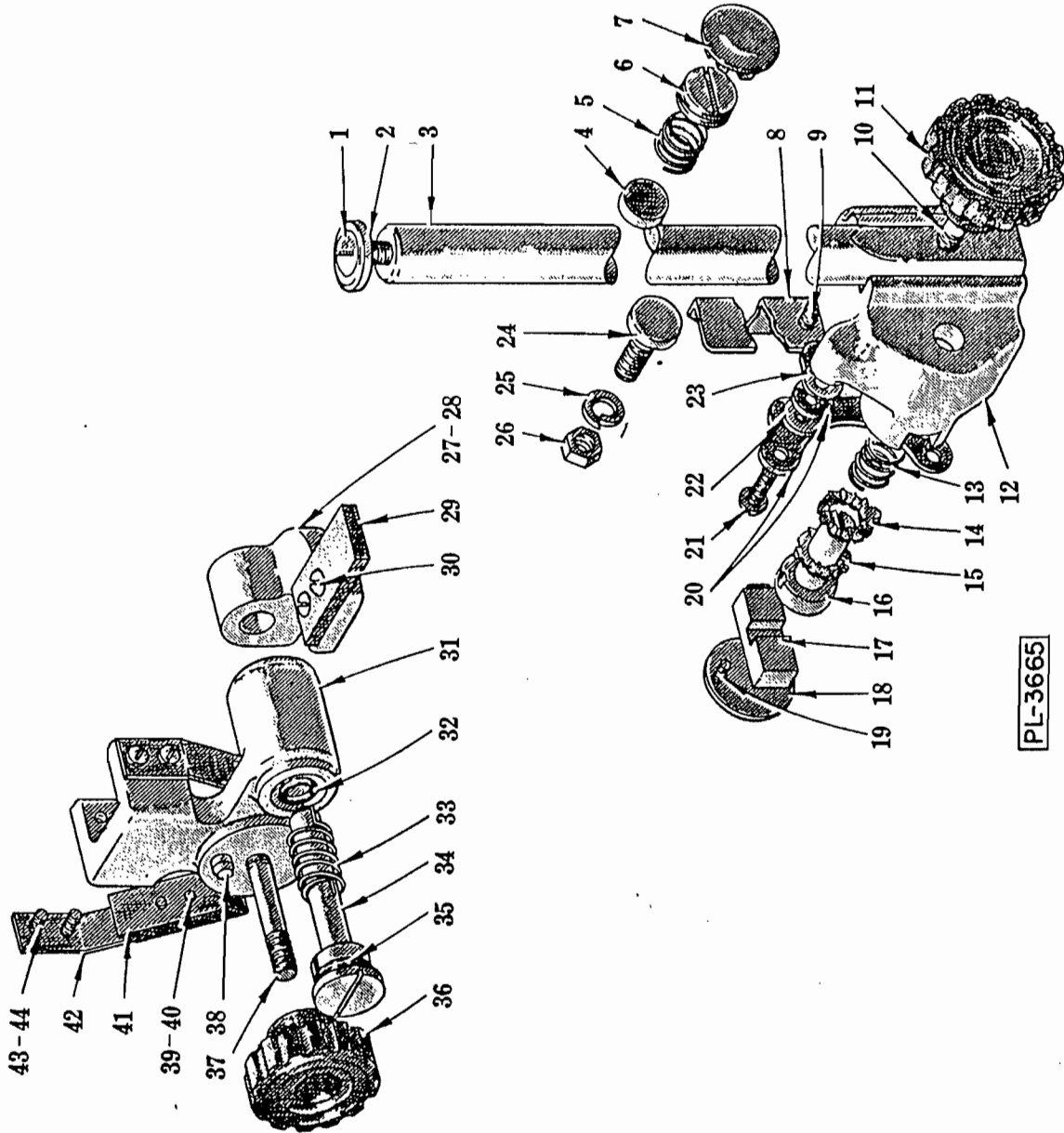

UPPER GUIDE AND WIPER UNIT

HOBART REPLACEMENT PARTS

UPPER GUIDE AND WIPER UNIT

| ILLUS. PL-3665 | PART NO. | NAME OF PART | AMT. |
|-------------------|-------------|---|---------|
| 1 | SC-53-16 | Mach. Screw - 5/16"-18 x 5/8" Truss Hd. ----- | 1 |
| 2 | M-69849 | Stop - Slide Rod ----- | 1 |
| 3 | P-71370 | Rod - Upper Blade Guide Slide ----- | 1 |
| 4 | M-67239 | Shoe - Slide Rod ----- | 1 |
| 5 | V-12734 | Spring ----- | 1 |
| 6 | M-67427 | Set Screw - Upper Guide ----- | 1 |
| 7 | PB-2-26 | Plug Button ----- | 1 |
| 8 | P-71397-1 | Guard - Upper Guide Blade ----- | 1 |
| 9 | SC-10-33 | Mach. Screw - #10-24 x 1/2" Truss Hd. ----- | 2 |
| 10 | V-21158 | Stud - Upper Guide Support ----- | 1 |
| 11 | M-67315 | Knob ----- | 1 |
| 12 | R-71361 | Support - Upper Guide ----- | 1 |
| 13 | V-23326 | Spring - Adj. Blade Guide ----- | 1 |
| 14 | M-23275 | Lock Washer - Adj. Blade (Stat.) / ----- | 1 |
| 15 | M-23328 | Lock Washer - Adj. Blade (Rot.) ----- | 1 |
| 16 | M-71382 | Shaft - Back-Up Block ----- | 1 |
| 17 | M-71373 | Block - Blade Back-Up ----- | 1 |
| 18 | M-71377 | Retainer - Blade Back-up Block ----- | 1 |
| 19 | SC-7-24 | Mach. Screw - #6-32 x 3/8" Rd. Hd. ----- | 2 |
| 20 | M-67182 | Guide - Blade ----- | 2 |
| 21 | SC-10-36 | Mach. Screw - #10-24 x 5/8" Truss Hd. ----- | 2 |
| 22 | M-67233 | Spacer - Blade Guide ----- | 2 |
| 23 | M-71449 | Shlm - Upper Guide Support ----- | As Reqd |
| 24 | M-67237 | Screw - Slide Rod Adjusting ----- | 1 |
| 25 | WL-4-2 | Lock Washer - 3/8" x .136" x .070" ----- | 1 |
| 26 | NS-17-20 | Jam Nut - 3/8"-24 Hex Fin. ----- | 1 |
| 27 | P-71359 | Bracket - Upper Wiper ----- | 1 |
| 28 | SC-75-5 | Set Screw - #10-24 x 1/4" Soc. Hdls. Kn. Cup Pt. ----- | 1 |
| 29 | M-71368 | Wiper - Blade Pulley ----- | 1 |
| 30 | SC-10-33 | Mach. Screw - #10-24 x 1/2" Truss Hd. ----- | 2 |
| 31 | R-71357 | Bracket - Upper Wiper ----- | 1 |
| 32 | R-67500-2 | "O" Ring ----- | 1 |
| 33 | M-71364 | Spring - Blade Pulley Wiper ----- | 1 |
| 34 | P-71376 | Shaft ----- | 1 |
| 35 | R-67500-7 | "O" Ring ----- | 1 |
| 36 | M-67315 | Knob ----- | 1 |
| 37 | M-71362 | Stud - Upper Guide Support ----- | 1 |
| 38 | M-67306 | Pin - Table Rest ----- | 1 |
| 39 | SC-21-14 | Mach. Screw - #8-32 x 3/8" Rd. Hd. ----- | 4 |
| 40 | WL-6-1 | Lock Washer - #8 x .047" x .031" ----- | 4 |
| 41 | M-67184 | Scraper - Blade ----- | 2 |
| 42 | M-67185 | Spring - Scraper Blade ----- | 2 |
| 43 | SC-21-85 | Mach. Screw - #8-32 x 3/16" Rd. Hd. ----- | 4 |
| 44 | WL-6-1 | Lock Washer - #8 x .047" x .031" ----- | 4 |
| | P-71398 | Upper Guide Unit Assy. (Incls. Items #8, 9, 10, 12, 13, 14, 15, 16, 17, 18, 19, 20, 21, 22 & 23) ----- | 1 |
| | R-71379-2 | Upper Wiper Brkt. Assy. (Incls. Items #27 to 44 Inclusive) ----- | 1 |

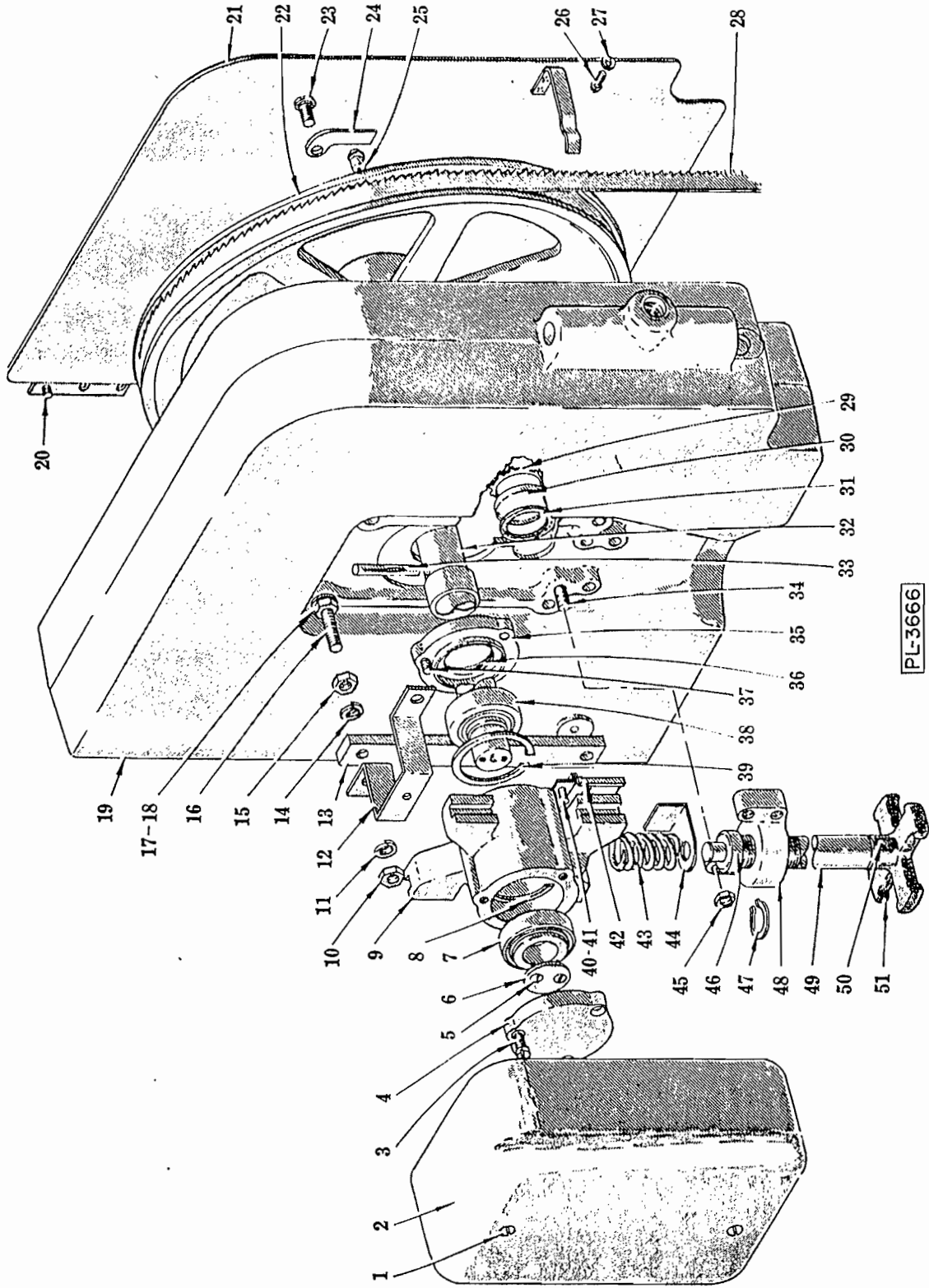

PL-3666

HEAD UNIT

HOBART REPLACEMENT PARTS

HEAD UNIT

| ILLUS. PL-3666 | PART NO. | NAME OF PART | AMT. |
|-------------------|-------------|--|------|
| 1 | SC-10-47 | Mach. Screw - #10-24 x 1-3/8" Truss Hd. ----- | 2 |
| 2 | R-67151-1 | Cover - Upper Bearing Carrier ----- | 1 |
| 3 | SC-12-69 | Mach. Screw - 1/4"-20 x 1/2" Fil. Hd. ----- | 3 |
| 4 | P-67210 | Cap - Bearing ----- | 1 |
| 5 | SC-13-46 | Mach. Screw - #10-24 x 1/2" Flat Hd. ----- | 2 |
| 6 | M-67241 | Retainer - Bearing ----- | 1 |
| 7 | BR-2-16 | Roller Bearing ----- | 1 |
| 8 | RR-6-1 | Retaining Ring ----- | 1 |
| 9 | R-71295 | Carrier - Upper Bearing ----- | 1 |
| 10 | NS-13-22 | Full Nut - 3/8"-16 Hex Fin. ----- | 4 |
| 11 | WL-4-2 | Lock Washer - 3/8" x .136" x .070" ----- | 4 |
| 12 | P-67147 | Cover Brkt. & Weld Nut Assy. ----- | 2 |
| 13 | P-67187 | Gib - Upper Brg. Carrier ----- | 2 |
| 14 | WL-4-2 | Lock Washer - 3/8" x .136" x .070" ----- | 4 |
| 15 | NS-13-22 | Full Nut - 3/8"-16 Hex Fin. ----- | 4 |
| 16 | M-68139 | Screw - Upper Brg. Carrier Support ----- | 4 |
| 17 | WL-4-2 | Lock Washer - 3/8" x .136" x .070" ----- | 4 |
| 18 | NS-13-22 | Full Nut - 3/8"-16 Hex Fin. ----- | 4 |
| 19 | T-71351 | Head ----- | 1 |
| 20 | SC-10-15 | Mach. Screw - #10-24 x 1/2" Truss Hd. ----- | 6 |
| 21 | S-71385 | Door Assy. (Head) ----- | 1 |
| 22 | R-72364 | Flanged Pulley (Blade) Sub-Assy. Unit (Incls. Items #23, 24 & 25) -- | 1 |
| 23 | V-20851 | Screw - Latch ----- | 1 |
| 24 | M-20852 | Latch ----- | 1 |
| 25 | M-24114 | Catch - #8-1/2 Frost ----- | 1 |
| 26 | SC-8-68 | Mach. Screw - 1/4"-20 x 1/2" Rd. Hd. ----- | 1 |
| 27 | WL-3-35 | Lock Washer - 1/4" x .047" x .078" ----- | 1 |
| 28 | P-71514 | Blade - Meat Saw (128" Lg.) ----- | 1 |
| 29 | M-23335 | Ring - Lens Retaining ----- | 1 |
| 30 | V-20889 | Lens - Indicator ----- | 1 |
| 31 | V-20898 | Gasket - Indicator Lens ----- | 1 |
| 32 | R-71298 | Shaft - Upper Brg. Carrier ----- | 1 |
| 33 | PG-7-31 | Groov-Pin - Type #5, 5/16" x 2-1/4" ----- | 1 |
| 34 | SC-10-38 | Mach. Screw - 5/16"-18 x 1-3/4" Truss Hd. ----- | 4 |
| 35 | P-71297 | Cap - Bearing (Saw Pulley Side) ----- | 1 |
| 36 | M-71403 | Seal - Grease ----- | 1 |
| 37 | SC-12-69 | Mach. Screw - 1/4"-20 x 1/2" Fil. Hd. ----- | 3 |
| 38 | BR-2-20 | Roller Bearing ----- | 1 |
| 39 | RR-7-1 | Retaining Ring ----- | 1 |
| 40 | SC-7-74 | Mach. Screw - #10-24 x 3/8" Rd. Hd. ----- | 2 |
| 41 | WL-3-20 | Lock Washer - #10 x .055" x .040" ----- | 2 |
| 42 | P-67249 | Plate - Blade Tension Sight ----- | 1 |
| 43 | M-20867 | Spring - Adj. Blade Tension ----- | 1 |
| 44 | M-67250 | Indicator - Tension ----- | 1 |
| 45 | NS-17-6 | Jam Nut - 5/16"-18 Hex Fin. ----- | 2 |
| 46 | BB-13-1 | Thrust Bearing - Nice #603 ----- | 1 |
| 47 | RR-4-8 | Retaining Ring ----- | 1 |
| 48 | P-67204 | Nut - Blade Tension Adj. ----- | 1 |
| 49 | P-71365 | Screw - Blade Tension Adj. ----- | 1 |
| 50 | RP-2-17 | Rollpin - 1/4" Dia. x 1" Lg. ----- | 1 |
| 51 | P-67190 | Wheel - Hand ----- | 1 |
| | R-71404 | Upper Bearing Carrier Assy. (Incls. Item #3, 4, 5, 6, 7, 8, 9, 32, 33, 35, 36, 37, 38 & 39) ----- | 1 |

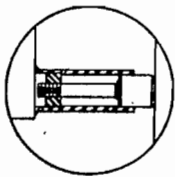

**ENLARGED VIEW OF LEG
SHOWING ADJUSTING FOOT**

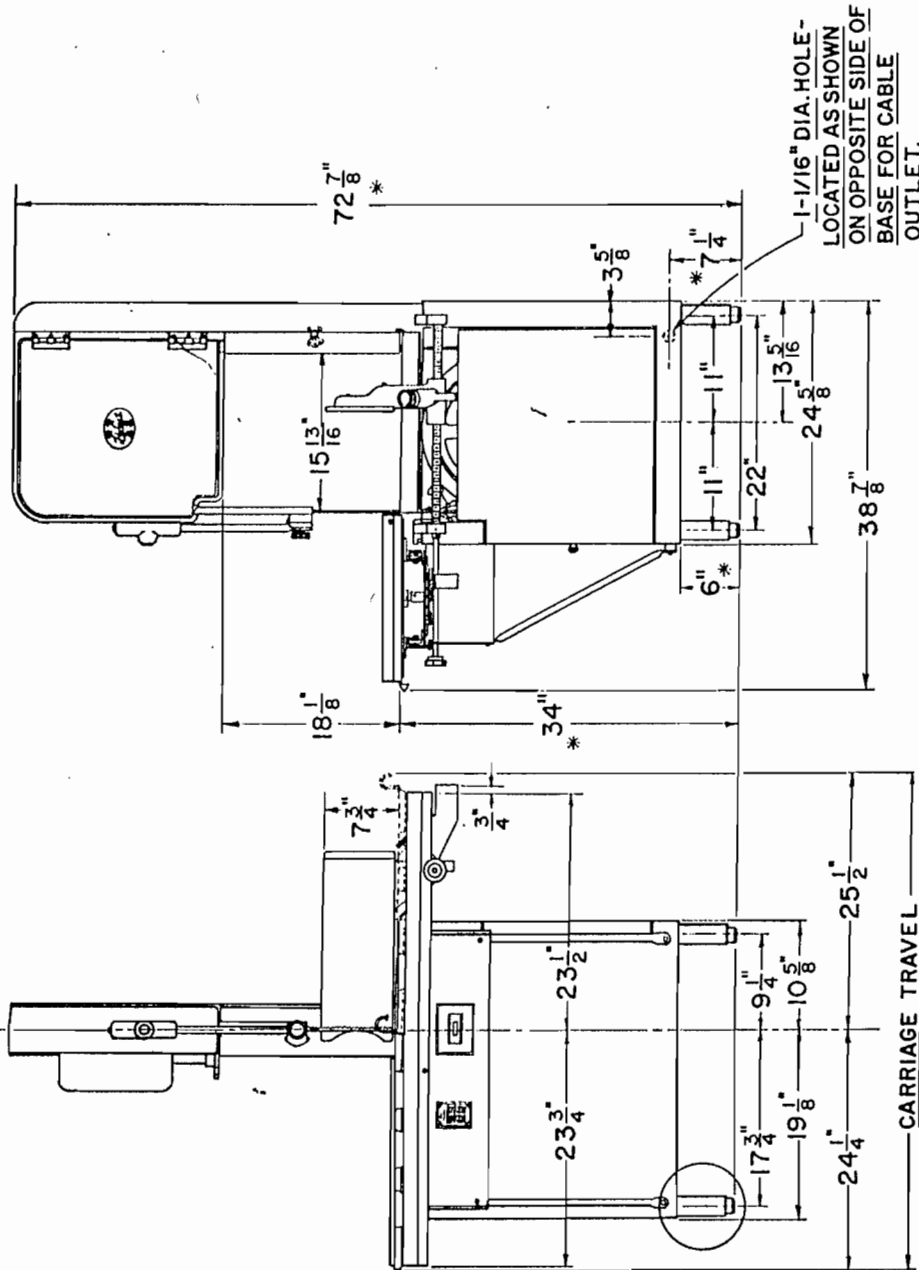

* THESE DIMENSIONS MAY INCREASE AS MUCH AS $\frac{1}{2}$ " DEPENDING ON LEG ADJUSTMENT

PL-3667

R-71622

INSTALLATION DIAGRAM