

# **2003 Civic GX**

## **Owner's Manual Supplement**

<b>Introduction</b> .....	2	<b>Maintenance</b>	
<b>Instruments and Controls</b>		Maintenance Schedule.....	20
Indicator Lights.....	3	Required Maintenance Record..	28
Gauges .....	5	Engine Oil.....	31
Rear Seat.....	6	Engine Coolant.....	31
<b>Before Driving</b>		Transmission Fluid.....	32
Fuel.....	7	Fuel Tank.....	34
Refueling Procedure .....	8	Spark Plugs.....	35
Fuel System Components.....	12	Tires .....	36
Fuel Cutoff System.....	13	Lights .....	37
Carrying Cargo .....	14	Storing Your Vehicle .....	38
<b>Driving</b>		<b>Taking Care of the Unexpected</b>	
Starting the Engine .....	15	Changing a Flat Tire .....	39
Automatic Transmission		If the Fuel System Has a Leak..	41
(CVT) .....	16	Jump Starting .....	42
		<b>Technical Information</b>	
		Specifications .....	43
		<b>Authorized Manuals .....</b>	<b>47</b>

## Introduction

---

Your Civic GX runs on Compressed Natural Gas (CNG), a highly pressurized version of the same clean-burning natural gas used in many homes.

Your Civic GX operates and performs like a gasoline-powered Civic. However, there are a few differences you should be aware of. In addition to reading the Civic Sedan owner's manual, please read this supplement carefully to understand the operation and unique features of your Civic GX.

You will find important safety information in this supplement and in the owner's manual. This information alerts you to potential hazards that could hurt you or others. Please read it carefully.

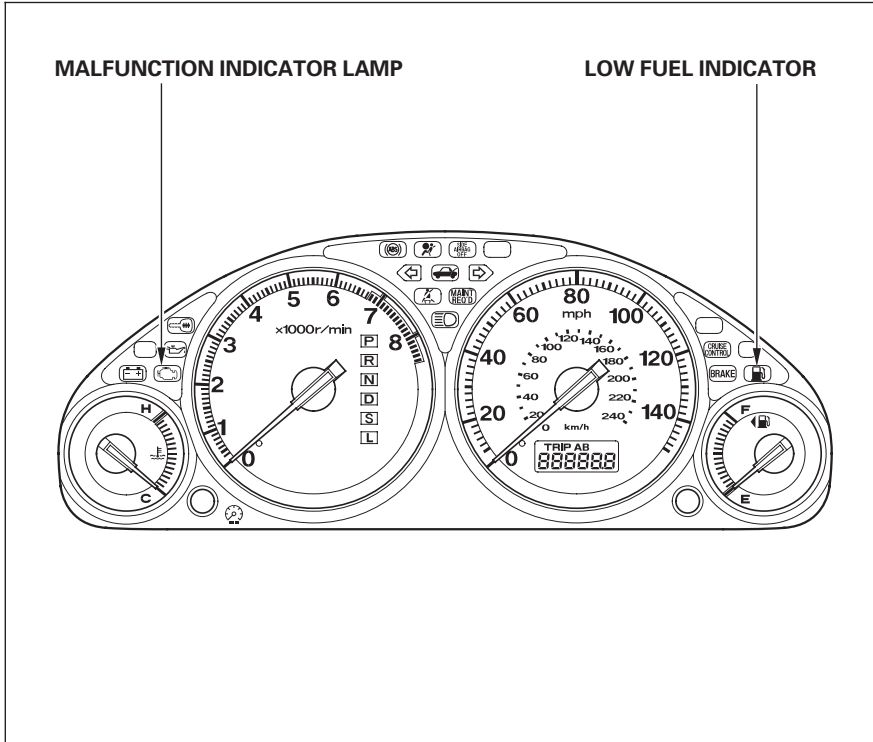

## Malfunction Indicator Lamp

This indicator comes on for a few seconds when you turn the ignition switch ON (II). If it comes on at any other time, it indicates one of the engine's emissions control systems may have a problem. For complete information, refer to the Civic Sedan owner's manual.

This indicator will also come on if there is a problem in the fuel system. If this happens, have the vehicle checked by an authorized Civic GX dealer as soon as possible. Drive moderately until the dealer has inspected the problem. Avoid full-throttle acceleration and driving at high speed.

*CONTINUED*

## Indicator Lights

---

If you smell natural gas or hear a hissing sound, except when refueling, the fuel system may have a leak.

Follow the instructions under **If the Fuel System Has a Leak** on page 41 of this supplement.



### Low Fuel Indicator

This indicator comes on for a few seconds when you turn ignition on (II).

This light comes on as a reminder that you must refuel soon. The approximate driving distance remaining when this light comes on is:

City driving – 20-25 miles

Highway driving – 25-30 miles

If the outside temperature falls below 25°F (–4°C), the pressure of the natural gas in the fuel tank may go down. If this happens, the fuel gauge will show less than the actual amount of fuel remaining, and this indicator may come on.

If this indicator starts blinking and the fuel level reading goes down to empty when the engine is running, it indicates a problem in the fuel system. Have the vehicle checked by an authorized Honda Civic GX dealer as soon as possible.

## Fuel Gauge

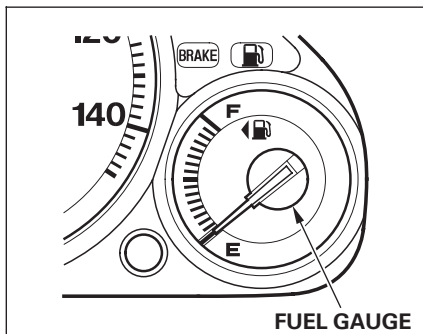

This gauge shows how much fuel you have. The quantity of fuel remaining in the tank is calculated based on the pressure and temperature of the natural gas in the fuel tank.

The lower "F" mark indicates a full tank at a fill pressure of 3,000 psi. The upper "F" mark indicates a full tank at a fill pressure of 3,600 psi.

The gauge may show slightly more or less than the actual amount. The outside temperature, fill method and ambient conditions may affect the pressure and temperature of the natural gas.

## Rear Seat

---

Unlike the standard Civic, only two people can ride in the rear seat. They should sit in the outer seating positions and wear the lap/shoulder belts. There is no center seat belt.

Your Civic GX is designed to operate on Compressed Natural Gas (CNG). The natural gas you use to refuel must meet NFPA-52 and SAE J1616 standards for fuel composition and quality.

If you use a fuel that does not meet these standards, you may feel a decrease in engine power and your vehicle's emissions controls may be damaged.

### **Compressed Natural Gas (CNG)**

The main component of compressed natural gas is methane, a highly flammable, colorless gas. While it is the same gas that is burned in everyday home appliances such as kitchen stoves and water heaters, the CNG in your vehicle is stored under high pressure (maximum 3,600 psi/24,800 kPa).

The CNG fuel system in your Civic, including the tank and hose, has been designed to hold gas at this pressure. It has also been tested for safety. You should never smell gas or hear a hissing sound unless you are refueling. If you smell gas or hear a hissing sound at any other time, you need to shut down the fuel system. Follow the instructions on page 13.

### **⚠ WARNING**

Compressed natural gas is flammable and highly explosive. You could be killed or seriously injured if leaking natural gas is ignited.

If you suspect a leak, have your vehicle immediately inspected and repaired by an authorized Honda Civic GX dealer.



# Fuel, Refueling Procedure

---

## CNG Identification

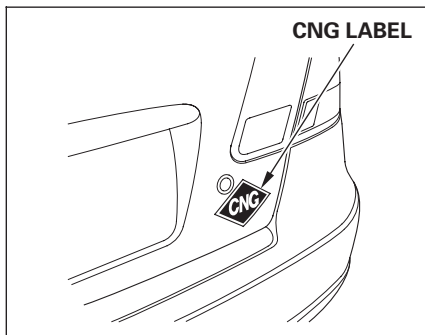

Your vehicle has an identifying “CNG” label attached next to the rear license plate. Do not remove this label. This label is necessary for insuring your vehicle. Driving without this label may violate the laws or regulations in some states.

## Refueling Procedure

There are two methods of refueling, fast filling or slow filling.

Fast filling is normally used in fuel stations for natural gas vehicles. It takes about three to five minutes to fill up the fuel tank.

Slow filling is done with a vehicle refueling appliance. Refueling takes approximately 1 hour per gallon.

Always observe all safety recommendations and operating instructions on the refueling equipment.

When refueling, you should use a fuel fill nozzle that complies with ANSI/AGA NGV-1-1994 standards. Nozzles are designed according to their maximum fill pressure: P24 for 2,400 psi (pounds per square inch), P30 for 3,000 psi, and P36 for 3,600 psi.

Your Civic’s maximum fill pressure is 3,600 psi (24,800 kPa), so you should refuel with a P36 nozzle. Using a P30 nozzle will fill the tank to the second (3,000 psi) fill mark on the fuel gauge. Using a P24 nozzle will not fill the tank completely.

During a fast fill, the natural gas will be warmed by the refueling process, causing it to expand and reduce the amount of fuel you can put in.

## Refueling Procedure

### Filling the Fuel Tank

The refueling procedure can vary with the refueling station. The following explains the typical refueling procedure with fast fill equipment. With slow fill equipment, or other types of refueling equipment, follow the instructions on the equipment.

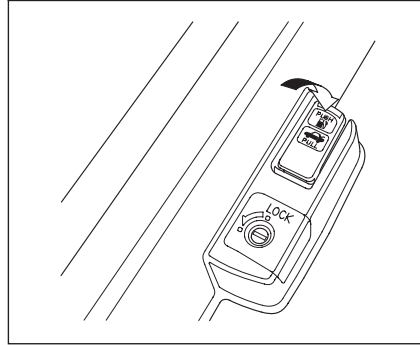

1. Because the fuel receptacle is on the driver's side of the vehicle, park with that side closest to the refueling station.
2. Turn the ignition switch to LOCK (0) and apply the parking brake.
3. Open the fuel receptacle door by pushing on the handle to the left of the driver's seat.

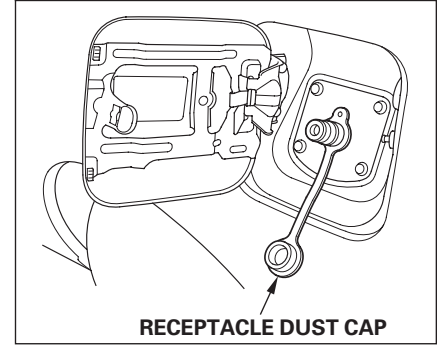

4. Remove the receptacle dust cap from the fuel receptacle. Clean up any dirt and debris around the fuel receptacle.

*CONTINUED*

## Refueling Procedure

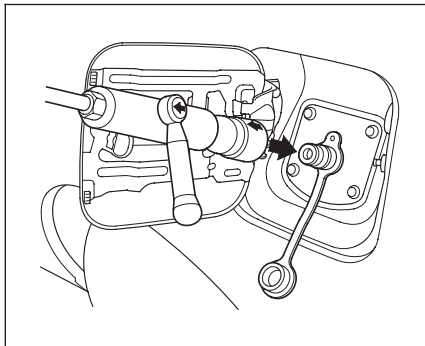

5. Securely connect the CNG fill nozzle to the fuel receptacle by turning the lever until the arrows on the nozzle point to each other.

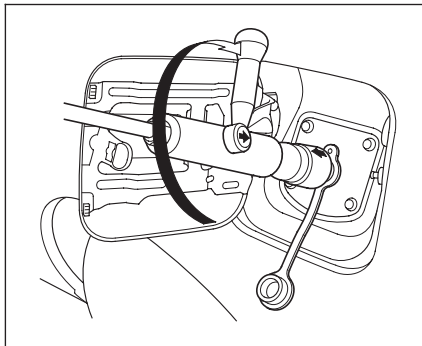

6. Follow the instructions on the refueling station to begin refueling.

While refueling, you may hear a chattering sound. This is normal.

If you hear or see fuel/vapor leaking from the nozzle-receptacle connection, stop refueling immediately. Dirt or other debris may be preventing a positive connection. Turn off the refueling station, remove the nozzle, reconnect it to the receptacle, and begin refueling again. If it continues to leak, have an authorized Honda Civic GX dealer inspect the sealing O-ring in the receptacle for damage and wear.

7. Refueling will stop automatically when the tank is full. Follow the instructions on the refueling station to turn it off.
8. Disconnect the CNG fill nozzle from the fuel receptacle by turning the lever on the nozzle 180 degrees. You may hear a brief hissing sound as a small amount of gas escapes. This is normal.

9. Put the receptacle dust cap on the fuel receptacle securely.

10. Push the fuel receptacle door closed until it latches.

If you are not sure how to operate the refueling station, ask for assistance.

### **Refueling Station Information**

To obtain information about the locations of Compressed Natural Gas (CNG) refueling stations, contact the Natural Gas Vehicle Coalition (NGVC) at (202) 824-7360, extension

1. Online, use [www.afdc.doe.gov](http://www.afdc.doe.gov) for the 49 states, or [www.cngvc.org](http://www.cngvc.org) for California.

## Fuel System Components

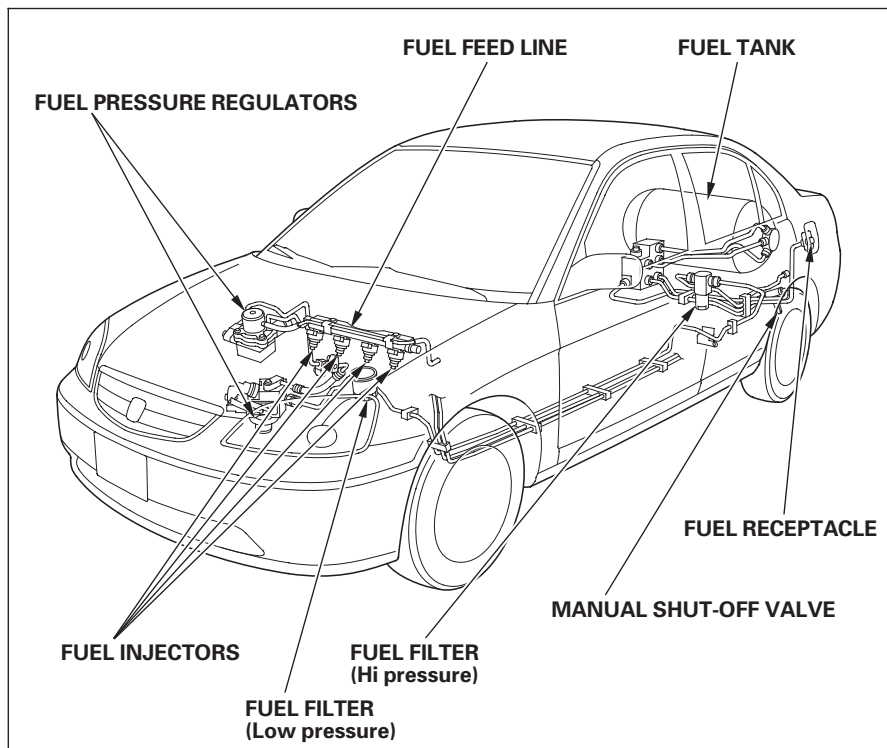

Fuel system components include a fuel tank located in the trunk, an integrated fuel pressure regulator, an in-tank fuel shut-off valve, fuel high pressure lines, electronically controlled multipoint fuel injectors and other equipment.

Fuel system components in the Civic CNG comply with NFPA-52 standards.

Your vehicle is equipped with genuine Honda component parts that have been designed and approved for use in a compressed natural gas vehicle. Never modify or replace any original components or parts with those specified for a gasoline-powered vehicle.

Improper parts or components can damage your vehicle's fuel system and affect your vehicle's safety and performance.

# Fuel System Components, Fuel Cutoff System

Fuel system maintenance and repair should be done only by an authorized Honda Civic GX dealer.

## **⚠ WARNING**

Tampering with, or improperly maintaining the high-pressure fuel system can cause a dangerous condition in which you can be seriously hurt or killed.

Never attempt to modify the fuel system, and always have maintenance performed by an authorized Honda Civic GX dealer.

## **Fuel Cutoff System**

The in-tank fuel shut-off valve is controlled by the ignition switch. When the ignition switch is in the LOCK (0) or ACCESSORY (I) position, the valve is closed, shutting off fuel flow to the engine. It opens when the ignition switch is turned to ON (II). This is similar to how an electric fuel pump works in a gasoline-powered vehicle.

## **Manual Shut-off Valve**

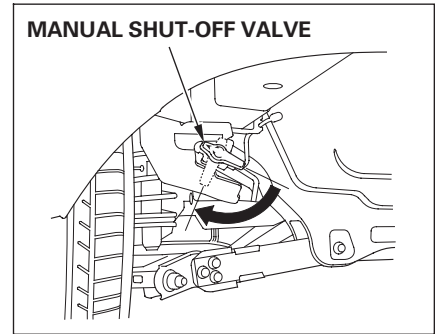

A manual shut-off valve is located underneath the vehicle, near the rear tire on the driver's side. We recommend that you locate this valve so you can find it quickly.

*CONTINUED*

## Fuel Cutoff System, Carrying Cargo

---

To turn off the valve, turn the lever one-quarter turn clockwise. Turn it counterclockwise to turn the valve back on.

Turn off the valve if you ever suspect a fuel leak or are involved in an accident.

### Carrying Cargo

The maximum load you can carry in your vehicle is 700 lbs (317 kg). That figure includes the total weight of four occupants (driver and three passengers), their cargo, and any accessories. The maximum recommended weight for cargo in the trunk is 100 lbs (45 kg).

The fuel tank is located in the trunk, with a partition between the fuel tank and the cargo space.

When you store small items in the trunk, secure them so they will not shift while you are driving. Loose items can fly over the partition and damage the fuel tank and fuel system components.

Do not carry large, heavy or pointed objects in the trunk. They may damage the fuel tank.

1. Apply the parking brake.
2. In cold weather, turn off all electrical accessories to reduce the drain on the battery.
3. Make sure the shift lever is in Park. Press on the brake pedal.
4. Without touching the accelerator pedal, turn the ignition key to the ON (II) position. You may hear a click from the in-tank fuel shut-off valve.  
  
Make sure the Malfunction Indicator Lamp goes out before you turn the ignition key to the START (III) position.
5. Turn the ignition key to START (III). If the engine does not start right away, do not hold the key in START (III) for more than 15 seconds at a time. Pause for at least 10 seconds before trying again.

6. If the engine does not start within 15 seconds, or starts but stalls right away, repeat step 5 with the accelerator pedal pressed half-way down. If the engine starts, release pressure on the accelerator pedal so the engine does not race.
7. If the engine still does not start, press the accelerator pedal all the way down and hold it there while starting. As before, keep the ignition key in the START (III) position for no more than 15 seconds. Return to step 6 if the engine does not start. If it starts, lift your foot off the accelerator pedal so the engine does not race.

If the outside temperature is below  $-4^{\circ}\text{F}$  ( $-20^{\circ}\text{C}$ ), the engine may be harder to start. In this case, use the starting procedure for cold weather at high altitude described in the next column.

### **Starting in Cold Weather at High Altitude (Above 5,000 feet/ 1,600 meters)**

An engine is harder to start in cold weather. The thinner air found at high altitude above 5,000 feet (1,600 meters) adds to the problem. Use the following procedure:

1. Turn off all electrical accessories to reduce the drain on the battery.
2. Make sure the Malfunction Indicator Lamp goes out before you turn the ignition key to the START (III) position.

*CONTINUED*



## Starting the Engine, Automatic Transmission (CVT)

3. Push the accelerator pedal half-way to the floor and hold it there while starting the engine. Do not hold the ignition key in START (III) for more than 15 seconds. When the engine starts, release the accelerator pedal gradually as the engine speeds up and smooths out.
4. If the engine fails to start in step 3, push the accelerator pedal to the floor and hold it there while you try to start the engine for no more than 15 seconds. If the engine does not start, return to step 3.

### Continuously Variable Transmission (CVT)

Honda's Continuously Variable automatic transmission's unique design provides a smooth, constant flow of power. It is electronically controlled for more precise operation and better fuel economy.

### Shift Lever Position Indicator

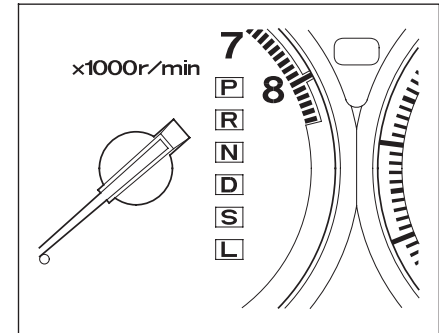

This indicator on the instrument panel shows which position the shift lever is in.

The “D” indicator comes on for a few seconds when you turn the ignition switch ON (II). If it flashes while driving (in any shift position), it indicates a possible problem in the transmission. Avoid rapid acceleration and have the transmission checked by an authorized Honda dealer as soon as possible.

## Shift Lever Positions

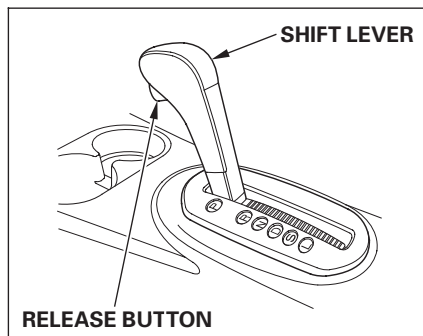

The shift lever has six positions. It must be in Park or Neutral to start the engine. When you are stopped in D, S, L, N or R, press firmly on the brake pedal and keep your foot off the accelerator pedal.

To shift from:	Do this:
P to R R to P N to R S to L	Press the release button.
N to D D to N L to S D to S S to D R to N	Move the lever.

*CONTINUED*

## Automatic Transmission (CVT)

---

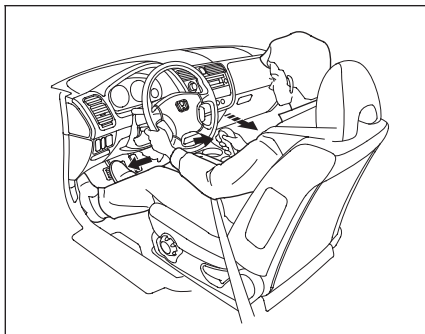

**Park (P)** – This position mechanically locks the transmission. Use Park whenever you are turning off or starting the engine. To shift out of Park, you must press on the brake pedal, have your foot off the accelerator pedal, and press the release button on the front of the shift lever.

If you have done all of the above and still cannot move the lever out of Park, see Shift Lock Release in the main Owner's manual.

You must also press the release button to shift into Park. To avoid transmission damage, come to a complete stop before shifting into Park. The shift lever must be in Park before you can remove the key from the ignition switch.

**Reverse (R)** – To shift from Reverse to Park, see the explanation under Park. To shift to Reverse from Neutral, come to a complete stop first. Press the release button before shifting into Reverse from Neutral.

**Neutral (N)** – Use Neutral if you need to restart a stalled engine, or if it is necessary to stop briefly with the engine idling. Shift to Park position if you need to leave the vehicle for any reason. Press on the brake pedal when you are moving the shift lever from Neutral to another gear.

**Drive (D)** – Use this position for your normal driving. The transmission automatically adjusts to keep the engine at the best speed for driving conditions. To help the engine warm up faster, the transmission will select ratios that allow the engine to run at higher speeds when it is cold.

**Second (S)** – Selecting Second shifts the transmission into a lower range of ratios for better acceleration and increased engine braking. Use Second when you are going down a steep hill, or in stop-and-go driving.

**Low (L)** – To shift to Low, press the release button on the front of the shift lever. Use Low to get more power when climbing, and for maximum engine braking when going down steep hills.

For faster acceleration when in D, S or L, the transmission will automatically “kick down” to a lower range of ratios by pushing the accelerator pedal to the floor.

### **Maximum Allowable Speeds**

The CVT shifts automatically to maintain proper engine speed in any shift position.

When the vehicle reaches the maximum speed in any shift position, you may feel the engine cut in and out. This is caused by a limiter (112 mph, 180 km/h) in the engine’s computer controls. The engine will run normally when you reduce the speed to below the maximum.

## Maintenance Schedule

---

The Maintenance Schedule specifies how often you should have your Civic GX serviced and what things need attention. It is essential that you have your vehicle serviced as scheduled to retain its high level of safety, dependability, and emissions control performance.

Refer to the important safety precautions and instructions in the primary owner's manual.

The fuel system is under high pressure (maximum 3,600 psi/24,800 kPa). It has no user-serviceable parts, and its components must not be modified. Whenever maintenance is required, take your vehicle to an authorized Honda Civic GX dealer, or a qualified NGV technician.

### **WARNING**

Tampering with, or improperly maintaining the high-pressure fuel system can cause a dangerous condition in which you can be seriously hurt or killed.

Never attempt to modify the fuel system, and always have maintenance performed by an authorized Honda Civic GX dealer.

The services and time or distance intervals shown in the maintenance schedule assume you will use your vehicle as normal transportation for passengers and their possessions. You should also follow these recommendations:

- Avoid exceeding your vehicle's load limit. This puts excess stress on the engine, brakes, and many other parts of your vehicle. The load limit is shown on the label on the driver's doorjamb.
- Operate your vehicle on reasonable roads within the legal speed limit.
- Drive your vehicle regularly over a distance of several miles (kilometers).

### **Which Schedule to Follow:**

Service your vehicle according to the time and mileage periods on one of the Maintenance Schedules on the following pages.

Follow the Maintenance Schedule for Severe Conditions if you drive your vehicle **MAINLY** under one or more of the following conditions.

- Driving less than 5 miles (8 km) per trip or, in freezing temperatures, driving less than 10 miles (16 km) per trip.
- Driving in extremely hot [over 90°F (32°C)] conditions.
- Extensive idling or long periods of stop-and-go driving, such as a taxi or a commercial delivery vehicle.
- Driving with a roof rack, or driving in mountainous conditions.
- Driving on muddy, dusty, or de-iced roads.

NOTE: If you only OCCASIONALLY or NEVER, drive under a “severe” condition, you should follow the Maintenance Schedule for Normal Conditions.

Your authorized Honda dealer knows your vehicle best and can provide competent, efficient service.

However, service at a dealer is not mandatory to keep your warranties in effect. Maintenance may be done by any qualified service facility or person who is skilled in this type of automotive service. Keep all the receipts as proof of completion, and have the person who does the work fill out the Maintenance Record. Check your warranty booklet for more information.

We recommend the use of Honda parts and fluids whenever you have maintenance done. These are manufactured to the same high-quality standards as the original components, so you can be confident of their performance and durability.

**Maintenance, replacement or repair of emissions control devices and systems may be done by any automotive repair establishment or individual using parts that are “certified” to EPA standards.**

According to state and federal regulations, failure to perform maintenance on the items marked with # will not void your emissions warranties. However, Honda recommends that all maintenance services be performed at the recommended time or mileage period to ensure long-term reliability.

Service at the indicated distance or time — whichever comes first.	miles x 1,000	10	20	30	40	50	60	70	80	90	100	110	120	130	140	150	160	170	180
	km x 1,000	16	32	48	64	80	96	112	128	144	160	176	192	208	224	240	256	272	288
	months	12	24	36	48	60	72	84	96	108	120	132	144	156	168	180	192	204	216
Replace engine oil																			
Inspect fuel filter (high pressure)* <sup>1</sup>																			
Replace fuel filter element (low pressure)		•	•	•	•	•	•	•	•	•	•	•	•	•	•	•	•	•	•
Rotate tires (Check tire inflation and condition at least once per month)																			
Replace engine oil filter																			
Inspect front and rear brakes																			
Check parking brake adjustment																			
Visually inspect the following items: Tie rod ends, steering gear box, and boots Suspension components, Driveshaft boots Brake hoses and lines (including ABS) All fluid levels and condition of fluids <sup>‡</sup> Exhaust system <sup>‡</sup> Fuel lines and connections			•		•		•		•		•		•		•		•		•
Inspect spark plugs* <sup>2</sup>																			
Inspect valve clearance																			
Replace fuel filter element (high pressure)				•			•			•			•			•			•
Inspect and adjust drive belts																			
Replace dust and pollen filter* <sup>3</sup>																			
Replace transmission fluid							•				•				•				•
Replace spark plugs												•							
<i>Service the following items at the recommended intervals.</i>																			
Replace air cleaner element	Every 30,000 miles (48,000 km)																		
Replace timing belt, inspect auto-tensioner, and water pump	Every 110,000 miles (176,000 km) or 7 years																		
<sup>‡</sup> Inspect idle speed																			
Replace engine coolant	At 120,000 miles (192,000 km) or 10 years, then every 60,000 miles (96,000 km) or 5 years																		
Replace brake fluid	Every 3 years																		
Inspect fuel tank* <sup>4</sup>	Inspect every 3 years or 36,000 miles. Whichever comes first, after the production date of the fuel tank																		

\* 1: Including drain.

\* 2: See Spark Plugs on page 35 for inspection information.

\* 3: See Dust and Pollen Filter in the Civic Sedan owner's manual for replacement information under special driving conditions.

\* 4: See Fuel Tank on page 34 for inspection and replacement information. Fuel tank should be replaced 15 years after it was manufactured.

This replacement is not covered by the emissions warranty.

# : See information on maintenance and emissions warranty, last column, page 21.

## 22 Maintenance

Service at the indicated distance or time, whichever comes first.  
Refer to page 20 to determine which schedule to use.

10,000 mi/16,000 km/1 yr	Do items in A.
20,000 mi/32,000 km/1 yr	Do items in A, B.
30,000 mi/48,000 km	Do item in D.
30,000 mi/48,000 km/2 yrs	Do items in A, C.
36,000 mi/57,600 km/3 yrs	<input type="checkbox"/> Inspect fuel tank* <sup>3</sup> .
40,000 mi/64,000 km/2 yrs	Do items in A, B.
50,000 mi/80,000 km/3 yrs	Do items in A.
60,000 mi/96,000 km	Do item in D.
60,000 mi/96,000 km/3 yrs	<input type="checkbox"/> Replace transmission fluid. Do items in A, B, C.
3 yrs	<input type="checkbox"/> Replace brake fluid (independent of mileage).
70,000 mi/112,000 km/4 yrs	Do items in A.
72,000 mi/115,200 km/6 yrs	<input type="checkbox"/> Inspect fuel tank* <sup>3</sup> .
80,000 mi/128,000 km/4 yrs	Do items in A, B.
90,000 mi/144,000 km	Do item in D.
90,000 mi/144,000 km/5 yrs	Do items in A, C.
100,000 mi/160,000 km/5 yrs	<input type="checkbox"/> Replace transmission fluid. Do items in A, B.
108,000 mi/172,800 km/9 yrs	<input type="checkbox"/> Inspect fuel tank* <sup>3</sup> .
110,000 mi/176,000 km/6 yrs	<input type="checkbox"/> Replace spark plugs. Do items in A.
110,000 mi/176,000 km/7 yrs	<input type="checkbox"/> Replace timing belt, inspect auto-tensioner, and water pump. <input type="checkbox"/> Inspect idle speed.
120,000 mi/192,000 km	Do item in D.
120,000 mi/192,000 km/6 yrs	Do items in A, B, C.
6 yrs	<input type="checkbox"/> Replace brake fluid (independent of mileage).
120,000 mi/192,000 km/10 yrs	<input type="checkbox"/> Replace engine coolant.
130,000 mi/208,000 km/7 yrs	Do items in A.
140,000 mi/224,000 km/7 yrs	<input type="checkbox"/> Replace transmission fluid. Do items in A, B.
144,000 mi/230,400 km/12 yrs	<input type="checkbox"/> Inspect fuel tank* <sup>3</sup> .
150,000 mi/240,000 km	Do item in D.

<b>A</b>	<input type="checkbox"/> Replace engine oil. <input type="checkbox"/> Rotate tires. <input type="checkbox"/> Inspect fuel filter (high pressure), including drain. <input type="checkbox"/> Replace fuel filter element (low pressure).
<b>B</b>	<input type="checkbox"/> Replace engine oil filter. <input type="checkbox"/> Inspect front and rear brakes. <input type="checkbox"/> Check parking brake adjustment. <input type="checkbox"/> Inspect tie rod ends, steering gearbox and boots. <input type="checkbox"/> Inspect suspension components. <input type="checkbox"/> Inspect driveshaft boots. <input type="checkbox"/> Inspect brake hoses and lines (including ABS). <input type="checkbox"/> Check all fluid levels, condition of fluids, and check for leaks. <input type="checkbox"/> Inspect exhaust system. <input type="checkbox"/> Inspect fuel lines and connections.
<b>C</b>	<input type="checkbox"/> Inspect spark plug* <sup>1</sup> . <input type="checkbox"/> Inspect valve clearance. <input type="checkbox"/> Replace fuel filter element (high pressure). <input type="checkbox"/> Inspect and adjust drive belts. <input type="checkbox"/> Replace dust and pollen filter* <sup>2</sup> .
<b>D</b>	<input type="checkbox"/> Replace air cleaner element every 30,000 mi/48,000 km (independent of time).

\*1: See Spark Plug on page 35 for inspection information.

\*2: See Dust and Pollen Filter in the Civic Sedan owner's manual for replacement information under special driving conditions.

\*3: See Fuel Tank on page 34 for inspection and replacement information. Fuel tank should be replaced 15 years after it was manufactured. This replacement is not covered by the emissions warranty.

# : See information on maintenance and emissions warranty, last column page 21 .

NOTE: Check engine oil and coolant at each fuel stop.



150,000 mi/240,000 km/8 yrs	Do items in A, C.
160,000 mi/256,000 km/8 yrs	Do items in A, B.
170,000 mi/272,000 km/9 yrs	Do items in A.
180,000 mi/288,000 km	Do item in D.
180,000 mi/288,000 km/9 yrs	<input type="checkbox"/> Replace transmission fluid. Do items in A, B, C.
9 yrs	<input type="checkbox"/> Replace brake fluid (independent of mileage).
180,000 mi/288,000 km/15 yrs	<input type="checkbox"/> Replace engine coolant. <input type="checkbox"/> Inspect fuel tank <sup>*3</sup> .

- \* 1 : See Spark Plug on page 35 for inspection information.
- \* 2 : See Dust and Pollen Filter in the Civic Sedan owner's manual for replacement information under special driving conditions.
- \* 3 : See Fuel Tank on page 34 for inspection and replacement information. Fuel tank should be replaced 15 years after it was manufactured. This replacement is not covered by the emissions warranty.
- # : See information on maintenance and emissions warranty, last column, page 21 .

NOTE : Check engine oil and coolant at each fuel stop.

Service at the indicated distance or time — whichever comes first.	miles x 1,000	10	20	30	40	50	60	70	80	90	100	110	120	130	140	150	160	170	180
	km x 1,000	16	32	48	64	80	96	112	128	144	160	176	192	208	224	240	256	272	288
months		12		24		36		48		60		72		84		96		108	
Replace engine oil	Replace every 5,000 miles (8,000 km) or 6 months																		
Replace engine oil filter																			
Rotate tires (Check tire inflation and condition at least once per month)																			
Inspect fuel filter (high pressure)* <sup>1</sup>																			
Replace fuel filter element (low pressure)	•	•	•	•	•	•	•	•	•	•	•	•	•	•	•	•	•	•	•
Inspect front and rear brakes																			
Lubricate all hinges, locks and latches																			
Visually inspect the following items: Tie rod ends, steering gear box, and boots Suspension components, Driveshaft boots																			
Check parking brake adjustment																			
Visually inspect the following items: Brake hoses and lines (including ABS) All fluid levels and condition of fluids Exhaust system Fuel lines and connections Light and controls, vehicle underbody		•		•		•		•		•		•		•		•		•	
Inspect valve clearance																			
Inspect spark plugs* <sup>2</sup>																			
Replace fuel filter element (high pressure)			•			•				•			•			•			•
Inspect and adjust drive belts																			
Replace dust and pollen filter* <sup>3</sup>																			
Replace transmission fluid							•				•				•				•
Replace spark plugs												•							
<i>Service the following items at the recommended intervals.</i>																			
Replace air cleaner element	Every 15,000 miles (24,000 km) in dusty conditions, otherwise use normal schedule																		
Replace timing belt* <sup>4</sup> , inspect auto-tensioner, and water pump	Every 110,000 miles (176,000 km) or 7 years																		
Inspect idle speed																			
Replace engine coolant	At 120,000 miles (192,000 km) or 10 years, then every 60,000 miles (96,000 km) or 5 years																		
Replace brake fluid	Every 3 years																		
Inspect fuel tank* <sup>5</sup>	Inspect every 3 years or 36,000 miles, whichever comes first, after the production date of the fuel tank																		

\*1: Including drain.

\*2: See Spark Plugs on page 35 for inspection information. \*3: See Dust and Pollen Filter in the Civic Sedan owner's manual for replacement information under special driving conditions.

\*4: See Timing Belt in the Civic Sedan owner's manual to determine need for replacement.

\*5: See Fuel Tank on page 34 for inspection and replacement information. Fuel tank should be replaced 15 years after it was manufactured. This replacement is not covered by the emissions warranty.

#: See information on maintenance and emissions warranty, last column, page 21.

Service at the indicated distance or time, whichever comes first.

Refer to page 20 to determine which schedule to use.

5,000 mi/8,000 km/6 mos	Do item in A.
10,000 mi/16,000 km/1 yr	Do items in A, B.
15,000 mi/24,000 km	Do item in E.
15,000 mi/24,000 km/1-½ yrs	Do item in A.
20,000 mi/32,000 km/1 yr	Do items in A, B, C.
25,000 mi/40,000 km/2 yrs	Do item in A.
30,000 mi/48,000 km	Do item in E.
30,000 mi/48,000 km/2 yrs	Do items in A, B, D.
35,000 mi/56,000 km/2-½ yrs	Do item in A.
36,000 mi/57,600 km/3 yrs	<input type="checkbox"/> Inspect fuel tank*4.
40,000 mi/64,000 km/2 yrs	Do items in A, B, C.
45,000 mi/72,000 km	Do item in E.
45,000 mi/72,000 km/3 yrs	Do item in A.
50,000 mi/80,000 km/3 yrs	Do items in A, B.
3 yrs	<input type="checkbox"/> Replace brake fluid (independent of mileage).
55,000 mi/88,000 km/3-½ yrs	Do item in A.
60,000 mi/96,000 km	Do item in E.
60,000 mi/96,000 km/3 yrs	<input type="checkbox"/> Replace transmission fluid. Do items in A, B, C, D.
65,000 mi/104,000 km/4 yrs	Do item in A.
70,000 mi/112,000 km/4 yrs	Do items in A, B.
72,000 mi/115,200 km/6 yrs	<input type="checkbox"/> Inspect fuel tank*4.
75,000 mi/120,000 km	Do item in E.
75,000 mi/120,000 km/4-½ yrs	Do item in A.
80,000 mi/128,000 km/4 yrs	Do items in A, B, C.
85,000 mi/136,000 km/5 yrs	Do item in A.
90,000 mi/144,000 km	Do item in E.
90,000 mi/144,000 km/5 yrs	Do items in A, B, D.
95,000 mi/152,000 km/5-½ yrs	Do item in A.
100,000 mi/160,000 km/5 yrs	<input type="checkbox"/> Replace transmission fluid. Do items in A, B, C.
105,000 mi/168,000 km	Do item in E.
105,000 mi/168,000 km/6 yrs	Do item in A.
108,000 mi/172,800 km/9 yrs	<input type="checkbox"/> Inspect fuel tank*4.
110,000 mi/176,000 km/6 yrs	<input type="checkbox"/> Replace spark plugs. Do items in A, B.

<b>A</b>	<input type="checkbox"/> Replace engine oil.
<b>B</b>	<input type="checkbox"/> Replace engine oil filter. <input type="checkbox"/> Inspect front and rear brakes. <input type="checkbox"/> Rotate tires. <input type="checkbox"/> Inspect fuel filter (high pressure), including drain. <input type="checkbox"/> Replace fuel filter element (low pressure). <input type="checkbox"/> Lubricate all hinges, locks, and latches. <input type="checkbox"/> Inspect tie rod ends, steering gearbox and boots. <input type="checkbox"/> Inspect suspension components. <input type="checkbox"/> Inspect driveshaft boots.
<b>C</b>	<input type="checkbox"/> Check parking brake adjustment. <input type="checkbox"/> Inspect brake hoses and lines (including ABS). <input type="checkbox"/> Check all fluid levels, condition of fluids, and check for leaks. <input type="checkbox"/> # Inspect exhaust system. <input type="checkbox"/> # Inspect fuel lines and connections. <input type="checkbox"/> Check all lights. <input type="checkbox"/> Inspect the underbody.
<b>D</b>	<input type="checkbox"/> Inspect valve clearance. <input type="checkbox"/> Replace fuel filter element (high pressure). <input type="checkbox"/> Inspect spark plugs*1. <input type="checkbox"/> Inspect and adjust drive belts. <input type="checkbox"/> Replace dust and pollen filter*3.
<b>E</b>	<input type="checkbox"/> Replace air cleaner element every 15,000 mi/24,000 km (independent of time) under dusty conditions, otherwise use the normal schedule.

\* 1 : See Spark Plug on page 35 for inspection information.

\* 2 : See Timing Belt in the Civic Sedan owner's manual to determine need for replacement.

\* 3 : See Dust and Pollen Filter in the Civic Sedan owner's manual for replacement information under special driving conditions.

\* 4 : See Fuel Tank on page 34 for inspection and replacement information. Fuel tank should be replaced 15 years after it was manufactured. This replacement is not covered by the emissions warranty.

# : See information on maintenance and emissions warranty, last column, page 21 .

NOTE : Check engine oil and coolant each fuel stop.

6 yrs	<input type="checkbox"/> Replace brake fluid (independent of mileage).
110,000 mi/176,000 km/7 yrs	<input type="checkbox"/> # Replace timing belt*, inspect auto-tensioner, and water pump. <input type="checkbox"/> # Inspect idel speed.
115,000 mi/184,000 km/6-½ yrs	Do item in A.
120,000 mi/192,000 km	Do item in E.
120,000 mi/192,000 km/6 yrs	Do items in A, B, C, D.
120,000 mi/192,000 km/10 yrs	<input type="checkbox"/> Replace engine coolant.
125,000 mi/200,000 km/7 yrs	Do item in A.
130,000 mi/208,000 km/7 yrs	Do items in A,B.
135,000 mi/216,000 km	Do item in E.
135,000 mi/216,000 km/7-½ yrs	Do item in A.
140,000 mi/224,000 km/7 yrs	<input type="checkbox"/> Replace transmission fluid. Do items in A, B, C.
144,000 mi/230,400 km/12 yrs	<input type="checkbox"/> Inspect fuel tank* <sup>4</sup>
145,000 mi/232,000 km/8 yrs	Do item in A.
150,000 mi/240,000 km	Do item in E.
150,000 mi/240,000 km/8 yrs	Do items in A, B, D.
155,000 mi/248,000 km/8-½ yrs	Do item in A.
160,000 mi/256,000 km/8 yrs	Do items in A, B, C.
165,000 mi/264,000 km	Do item in E.
165,000 mi/264,000 km/9 yrs	Do item in A.
170,000 mi/272,000 km/9 yrs	Do items in A, B.
9 yrs	<input type="checkbox"/> Replace brake fluid (independent of mileage).
175,000 mi/280,000 km/9-½ yrs	Do item in A.
180,000 mi/288,000 km	Do item in E.
180,000 mi/288,000 km/9 yrs	<input type="checkbox"/> Replace transmission fluid. Do items in A, B, C, D.
180,000 mi/288,000 km/15 yrs	<input type="checkbox"/> Replace engine coolant. <input type="checkbox"/> Inspect fuel tank* <sup>4</sup>

- \* 1 : See Spark Plug on page 35 for inspection information.
  - \* 2 : See Timing Belt in the Civic Sedan owner's manual to determine need for replacement.
  - \* 3 : See Dust and Pollen Filter in the Civic Sedan owner's manual for replacement information under special driving conditions.
  - \* 4 : See Fuel Tank on page 34 for inspection and replacement information. Fuel tank should be replaced 15 years after it was manufactured. This replacement is not covered by the emissions warranty.
- # : See information on maintenance and emissions warranty, last column, page 21 .
- NOTE: Check engine oil and coolant at each fuel stop.

## Required Maintenance Record (for Normal and Severe Schedules)

You or the servicing dealer can record all completed maintenance here, whether you follow the schedule for normal conditions (page 22 ) or severe conditions (page 25 ). Keep the receipts for all work done on your vehicle.

<b>5,000 mi</b> 8,000 km	Signature or dealer stamp	mi/km
		Date
<b>10,000 mi</b> 16,000 km		mi/km
		Date
<b>15,000 mi</b> 24,000 km		mi/km
		Date
<b>20,000 mi</b> 32,000 km (or 1 year)		mi/km
		Date
<b>25,000 mi</b> 40,000 km		mi/km
		Date
<b>30,000 mi</b> 48,000 km		mi/km
		Date

<b>35,000 mi</b> 56,000 km	Signature or dealer stamp	mi/km
		Date
<b>40,000 mi</b> 64,000 km (or 2 years)		mi/km
		Date
<b>45,000 mi</b> 72,000 km		mi/km
		Date
<b>50,000 mi</b> 80,000 km		mi/km
		Date
<b>55,000 mi</b> 88,000 km		mi/km
		Date
<b>60,000 mi</b> 96,000 km (or 3 years)		mi/km
		Date

## Required Maintenance Record (for Normal and Severe Schedules)

<b>65,000 mi</b> 104,000 km	Signature or dealer stamp	mi/km
		Date
<b>70,000 mi</b> 112,000 km		mi/km
		Date
<b>75,000 mi</b> 120,000 km		mi/km
		Date
<b>80,000 mi</b> 128,000 km (or 4 years)		mi/km
		Date
<b>85,000 mi</b> 136,000 km		mi/km
		Date
<b>90,000 mi</b> 144,000 km		mi/km
		Date

<b>95,000 mi</b> 152,000 km	Signature or dealer stamp	mi/km
		Date
<b>100,000 mi</b> 160,000 km (or 5 years)		mi/km
		Date
<b>105,000 mi</b> 168,000 km		mi/km
		Date
<b>110,000 mi</b> 176,000 km		mi/km
		Date
<b>115,000 mi</b> 184,000 km		mi/km
		Date
<b>120,000 mi</b> 192,000 km (or 6 years)		mi/km
		Date

# Required Maintenance Record (for Normal and Severe Schedules)

<b>120,000 mi</b> 192,000 km (or 6 years)	Signature or dealer stamp	mi/km
		Date
<b>125,000 mi</b> 200,000 km		mi/km
		Date
<b>130,000 mi</b> 208,000 km		mi/km
		Date
<b>135,000 mi</b> 216,000 km		mi/km
		Date
<b>140,000 mi</b> 224,000 km (or 7 years)		mi/km
		Date
<b>144,000 mi</b> 230,400 km		mi/km
		Date
<b>145,000 mi</b> 232,000 km		mi/km
		Date

<b>150,000 mi</b> 240,000 km	Signature or dealer stamp	mi/km
		Date
<b>155,000 mi</b> 248,000 km		mi/km
		Date
<b>160,000 mi</b> 256,000 km (or 8 years)		mi/km
		Date
<b>165,000 mi</b> 264,000 km		mi/km
		Date
<b>170,000 mi</b> 272,000 km		mi/km
		Date
<b>175,000 mi</b> 280,000 km		mi/km
		Date
<b>180,000 mi</b> 288,000 km (or 9 years)		mi/km
		Date

### Engine Oil

The SAE number tells you the oil's viscosity or weight. Select the oil for your vehicle according to this chart.

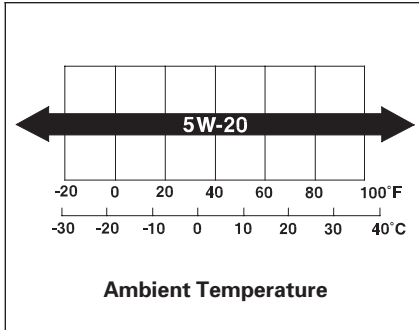

5W-20 oil is formulated for year-round protection of your Honda, to improve cold weather starting, and to help your engine use less fuel.

Refer to the primary owner's manual for engine oil adding and changing procedures.

Engine oil change capacity  
(including filter):  
3.4 US qt (3.2 ℓ , 2.8 Imp qt)

### Engine Coolant

Refer to the primary owner's manual for engine coolant adding and replacement procedures.

Engine coolant change capacity:  
1.03 US gal (3.9 ℓ , 0.86 Imp gal)



# Transmission Fluid

## Continuously Variable Transmission (CVT)

The engine and transmission must be at normal operating temperature before checking the fluid level. Drive the vehicle at least 10 miles (16 kilometers) before checking.

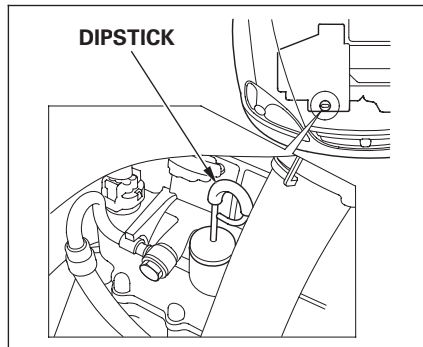

1. Park the vehicle on level ground. Shut off the engine. For accurate results, wait at least 60 seconds, and no more than 90 seconds, after shutting off the engine to check the fluid level.
2. Remove the dipstick (yellow loop) from the transmission and wipe it with a clean cloth.

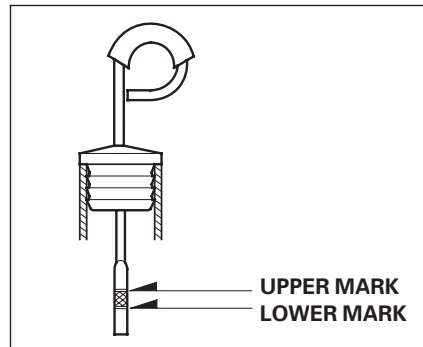

3. Insert the dipstick all the way into the transmission securely as shown in the illustration.
4. Remove the dipstick and check the fluid level. It should be between the upper and lower marks.

5. If the level is below the lower mark, add fluid into the filler hole to bring it to the upper mark.

Always use genuine Honda ATF-Z1 (Automatic Transmission Fluid). If it is not available, you may use a DEXRON® III automatic transmission fluid as a temporary replacement. However, continued use can affect shift quality. Have the transmission flushed and refilled with genuine Honda ATF-Z1 as soon as it is convenient.

6. Insert the dipstick all the way back into the transmission securely as shown in the illustration.

The transmission should be drained and refilled with new fluid according to the time and distance recommendations in the maintenance schedule.

If you drive at high speed in high temperatures [above 95°F (35°C)], the transmission fluid should be changed every 24,000 miles (40,000 km) or 2 years, whichever comes first.

# Fuel Tank

The fuel tank meets the safety standards of NGV-2/NFPA-52/DOT NHTSA FMVSS 304. The fuel tank should be inspected every three years after the production date of the fuel tank. Have a qualified technician inspect the fuel tank for damage or leaking.

You should also have the fuel tank inspected after a collision.

The fuel tank should be replaced fifteen years after it was manufactured. The expiration date of the fuel tank is on a label on the fuel tank and on a warning label in the engine compartment.

Have a qualified technician replace the fuel tank. Do not reuse the old fuel tank.

## HOOD

**⚠ WARNING**

THIS VEHICLE IS FUELED BY COMPRESSED NATURAL GAS STORED AT HIGH PRESSURE. DO NOT ATTEMPT TO SERVICE FUEL SYSTEM WITHOUT PROPER SYSTEM DEPRESSURIZATION. TO AVOID RISK OF INJURY, THIS VEHICLE SHOULD ONLY BE SERVICED BY A QUALIFIED TECHNICIAN. CNG TANK PRESSURE RELIEF DEVICE WILL VENT AT 103°C (217°F). DO NOT PARK OR SERVICE VEHICLE NEAR ANY SOURCE OF EXCESSIVE HEAT OR OPEN FLAME. DO NOT USE PAINT OVEN TO ANY PAINT REPAIRS.

SYSTEM SERVICE PRESSURE : 24.8 MPA (3600PSIG)  
 BUILT BY : HONDA OF AMERICA MFG., INC.  
 CNG TANK EXPIRATION DATE : \_\_\_\_\_  
 TOTAL WATER VOLUME OF CNG TANK : 100 (L)

↑  
**CNG TANK EXPIRATION DATE**

## FUEL TANK

<b>CNG ONLY</b>		<b>DOT TYPE 4</b>
<b>NGV2-4</b>	Certification No. : C144989	Re-Inspection? Stamp/Date
<b>SERVICE PRESSURE</b> 24800 KPA ( 3600 PSIG)		
<b>LINCOLN COMPOSITES</b>		<b>TUFFSHIELD™</b>
SN 05-004		
MODEL# RC36A18-037PQ		
MF'D IN : 01-98		
MAX TEMP 180 °F		
<b>DO NOT USE AFTER 2013</b>		

↑  
**CNG TANK EXPIRATION DATE**

## FUEL TANK

# CNG ONLY

### Safety Information

1. Maximum fast fill pressure not to exceed 105% of service pressure temperature corrected to 70°F.
2. Installation, inspection and service is to be performed by competent personnel. Consult the installation manual for appropriate procedures.
3. If this vehicle is involved in a collision or fire, or if the tank becomes damaged, as may be indicated by surface cuts, abrasions, dents or localized discoloration or paint chipping, the tank must be depressurized and removed from service. Consult inspection guidelines issued by tank manufacturer.

**IF THERE IS A QUESTION ABOUT THE PROPER USE, INSTALLATION, OR MAINTENANCE OF THIS CONTAINER CONTACT :**

**LINCOLN COMPOSITES  
 4300 INDUSTRIAL AVE, LINCOLN, NE, USA  
 PHONE 1-402-464-8211**

THIS CONTAINER SHOULD BE VISUALLY INSPECTED AFTER A MOTOR VEHICLE ACCIDENT OR FIRE AND AT LEAST EVERY 36 MONTHS OR 36,000MILES, WHICHEVER COMES FIRST, FOR DAMAGE AND DETERIORATION



Puncture



Drop



Drill



Fire

The spark plugs in your vehicle are a special platinum-tipped design for longer life. They only need to be replaced every 7 years or 105,000 miles (168,000 km), whichever comes first.

For the replacement procedure, refer to the primary owner's manual. The spark plug tightening torque is: 11 lbf·ft (15 N·m , 1.5 kgf·m)

The condition and gap of the spark plugs should be inspected according to the time and distance recommendations in the maintenance schedule in this supplement.

### ***Inspection***

To inspect the spark plugs, follow the replacement procedure for removal and reinstallation described in the owner's manual.

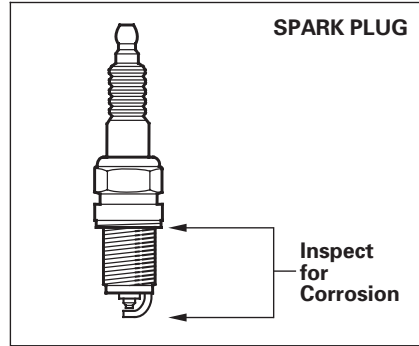

Inspect the threads and tip of the spark plugs for corrosion. If you find any corrosion in that area, the spark plugs should be replaced. You should not clean the spark plugs with a wire brush and reuse them.

### **Specifications:**

NGK: PFR7N-D

Spark Plug Gap:

0.03 in (0.8 mm)  $^{+0}_{-0.1\text{mm}}$

# Tires

---

The recommended cold tire pressures for most normal driving conditions is shown below.

Tire Size	Cold Tire Pressure for Normal Driving
P185/70R14 87S	Front/Rear: 30 psi (210 kPa , 2.1 kgf/cm <sup>2</sup> )

The compact spare tire pressure is:  
60 psi (420 kPa , 4.2 kgf/cm<sup>2</sup>)

These pressures are also given on the tire information label on the driver's doorjamb.

Tire pressures for high speed driving are shown below. Honda strongly recommends that you not drive faster than posted speed limits and conditions allow.

Tire Size	Cold Tire Pressure for Speeds over 100 mph (160 km/h)
P185/70R14 87S	Front/Rear: 35 psi (240 kPa , 2.4 kgf/cm <sup>2</sup> )

## Replacing a High-mount Brake Light Bulb

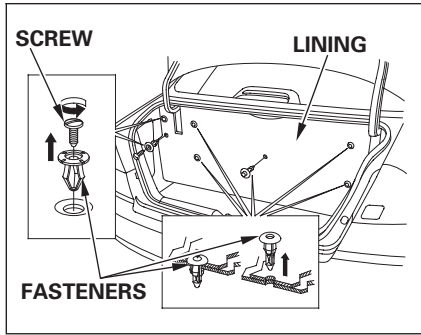

1. Open the trunk.
2. Undo the five fasteners on the upper part of the trunk lining by pushing on the center of each fastener's head until it pops in.
3. Remove the screw in the center of the two fasteners on the upper part of the trunk lining. Pull the lining back.

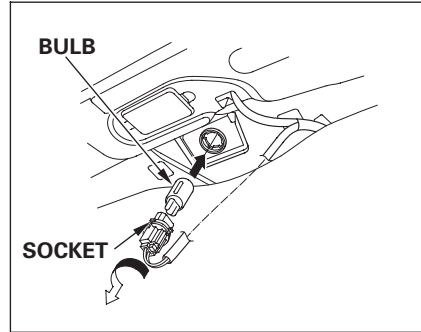

4. Remove the socket from the light assembly by turning it one-quarter turn counterclockwise.
5. Remove the burned out bulb from the socket by pulling it straight out of its socket.

6. Push the new bulb straight into the socket until it bottoms.
7. Reinstall the socket. Turn it clockwise until it locks. Make sure the new bulb is working.
8. Reinstall the trunk lining.
9. Put the two fasteners into the holes on the upper part of the trunk lining. Reinstall the screws.

*CONTINUED*

## Lights, Storing Your Vehicle

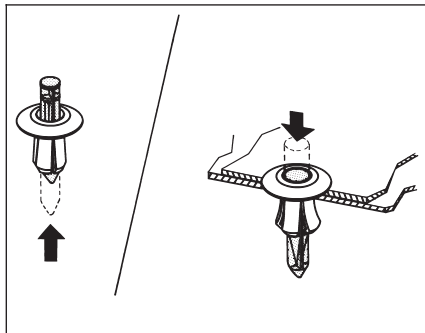

10. Reset each fastener by pushing on its pointed end until it pops back almost flush with the fingers on the housing.
11. Put each fastener in the hole of the lining and push on its center until it locks (the center is flush with the head).

### Storing Your Vehicle

If you need to park your vehicle for an extended period, refer to **Storing Your Vehicle** in the primary owner's manual for information. In addition to these procedures, you should do the following with your Civic GX:

- Turn the manual shut-off valve to the OFF position (see **Manual Shut-off Valve** on page 13 in this supplement).
- If you store your vehicle indoors, it should be parked in a well ventilated area. We recommend the installation of a natural gas leak detector.

After storing your vehicle for an extended period, and before starting the engine for the first time, open the trunk and leave it open for several minutes. This allows any natural gas vapors that have collected in the trunk to dissipate.

## Changing a Flat Tire

To change a flat tire, follow the instructions in the primary owner's manual. Since your vehicle is equipped with a fuel tank in the trunk, you should install the flat tire as described in this supplement.

### Removing the Spare Tire

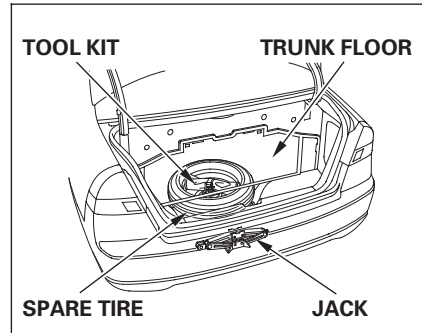

The spare tire is stored in the trunk. To remove the spare tire and the tool kit, open the trunk and raise the trunk floor by lifting up on the back edge.

### Storing the Flat Tire

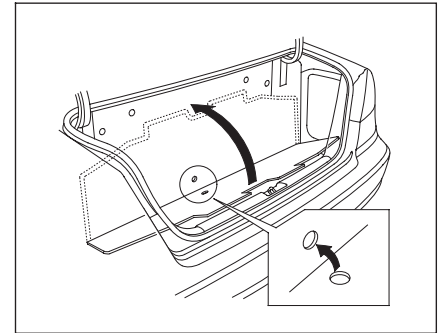

1. Raise the trunk floor and the lower part of the trunk lining as shown. Align the lower hole in the trunk lining with the hole in the trunk floor.

*CONTINUED*



## Changing a Flat Tire

---

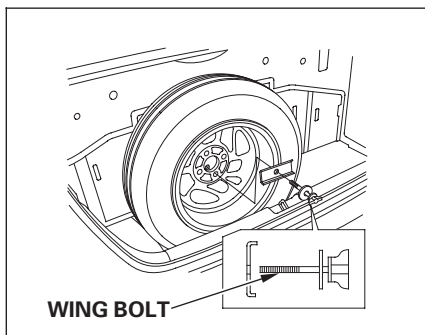

2. Remove the wheel cover.
3. Place the flat tire straight up in the trunk as shown, with the outside of the wheel facing forward.

4. Remove the support plate and the wing bolt from the tool kit. Put the plate on the wing bolt. Secure the flat tire by putting the wing bolt through the hole in the center of the wheel, through the hole in the trunk lining, then screwing it into the divider.

Store the support plate and wing bolt for the spare tire in the tool kit.

You may detect a slight natural gas odor for a few moments after refueling. This is normal. You should not be able to smell natural gas at any other time. If you do, or if you hear a hissing sound, your vehicle's fuel system may have a leak.

If this happens, follow these directions:

1. Park your vehicle in a well-ventilated area and apply the parking brake. Keep heat, sparks, and flame away. Open all the windows and the trunk lid for ventilation.
2. Turn the ignition switch to the LOCK (0) position.
3. Turn the manual shut-off valve to the OFF position to shut off the natural gas (see **Manual Shut-off Valve** on page 13 in this supplement).

You cannot continue driving. Your vehicle should be towed to an authorized Honda Civic GX dealer (see **Emergency Towing** in the primary owner's manual).

### **WARNING**

Compressed natural gas is flammable and highly explosive. You could be killed or seriously injured if leaking natural gas is ignited.

If you suspect a leak, have your vehicle immediately inspected and repaired by an authorized Honda Civic GX dealer.

## Jump Starting

---

Do not jump start your vehicle if you suspect a natural gas leak. If you smell natural gas or hear a hissing sound, the fuel system may have a leak that needs to be repaired by an authorized technician.

Turn the manual shut-off valve to the OFF position and have your vehicle towed to an authorized Honda Civic GX dealer (see **Emergency Towing** in the primary owner's manual).

If the fuel system is not leaking or damaged, you can jump start the vehicle. Refer to the primary owner's manual for the jump starting procedure.

# Specifications

## Dimensions

Length	174.6 in (4,435 mm)
Width	67.3 in (1,710 mm)
Height	56.9 in (1,445 mm)
Wheelbase	103.1 in (2,620 mm)
Track	57.9 in (1,470 mm)
Front	
Rear	57.9 in (1,470 mm)

## Weights

Gross vehicle weight rating	See the certification label attached to the driver's doorjamb.
-----------------------------	--

## Engine

Type	Water cooled 4-stroke SOHC 4-cylinder compressed natural gas engine
Bore x Stroke	2.95 x 3.72 in (75.0 x 94.4 mm)
Displacement	101.7 cu-in (1,668 cm <sup>3</sup> )
Compression ratio	12.5 : 1
Spark plugs	See spark plug maintenance section page 35 .

## Capacities

Fuel tank service pressure		3,600 psi (24,800 kPa) at 70°F (21°C)
Fuel tank capacity		3,000 psi: 7.2 gasoline gallons equivalent (GGE) 3,600 psi: 8.0 gasoline gallons equivalent
Engine coolant	Change* <sup>1</sup>	
	Automatic (CVT)	1.03 US gal (3.9 ℓ , 0.86 Imp gal)
Engine oil	Total	
	Automatic (CVT)	1.32 US gal (5.0 ℓ , 1.10 Imp gal)
Automatic transmission fluid (CVT)	Change* <sup>2</sup>	
	Including filter	3.4 US qt (3.2 ℓ , 2.8 Imp qt)
	Without filter	3.2 US qt (3.0 ℓ , 2.6 Imp qt)
Windshield washer reservoir	Total	4.4 US qt (4.2 ℓ , 3.7 Imp qt)
	Change	3.3 US qt (3.1 ℓ , 2.7 Imp qt)
Automatic transmission fluid (CVT)	Total	6.0 US qt (5.7 ℓ , 5.0 Imp qt)

\* 1 : Including the coolant in the reserve tank and that remaining in the engine.

Reserve tank capacity: 0.21 US gal (0.8 ℓ , 0.18 Imp gal)

\* 2 : Excluding the oil remaining in the engine.

CONTINUED

# Specifications

## Air Conditioning

Refrigerant type	HFC-134a (R-134a)
Charge quantity	17.6 – 19.4 oz (500 – 550 g)
Lubricant oil type	SP-10

## Lights

Headlights (H/L/O)	12 V – 60/55 W (HB2)
Front turn signal/side marker lights	12 V – 21/5 W
Front parking light	12 V – 3 CP
Rear turn signal lights	12 V – 21 W
Stop/Taillights/Rear side marker lights	12 V – 21/5 W
Back-up lights	12 V – 21 W
Taillights	12 V – 3 CP
High-mount brake light	12 V – 21 W
License plate lights	12 V – 5 W
Ceiling light	12 V – 8 W
Spotlights	12 V – 8 W
Trunk light	12 V – 5 W

## Battery

Capacity	12 V – 36 AH/5 HR
----------	-------------------

## Fuses

Interior	See <b>Fuses</b> in the primary owner's manual.
Under-hood	See <b>Fuses</b> in the primary owner's manual.

## Alignment

Toe-in	Front	0.00 in (0.0 mm)
	Rear	– 0.08 in (– 2.0 mm)
Camber	Front	0°
	Rear	– 45'
Caster	Front	1°33'

## Tires

Size	Front/Rear	P185/70R14 87S
	Spare	T115/70D14 88M <sup>*1</sup> T125/70D15 95M <sup>*2</sup>
Pressure	Front/Rear	30 psi (210 kPa, 2.1 kgf/cm <sup>2</sup> )
	Spare	60 psi (420 kPa, 4.2 kgf/cm <sup>2</sup> )

\* 1 : Without ABS

\* 2 : With ABS



## Authorized Manuals

---

### Purchasing Factory Authorized Manuals (U.S. only)

The publications shown below can be purchased from Helm Incorporated. You can order in any of three ways:

- Detach and mail the order form on the right half of this page
- Call Helm Inc. at 1-800-782-4356 (credit card orders only)
- Go online at [www.helminc.com](http://www.helminc.com)

If you are interested in other years or models, contact Helm Inc. at 1-800-782-4356

Publication Form Number	Form Description	Price Each*
61S5A06	2001-2003 Honda Civic 2/4 Door Service Manual	\$70.00
61S5A07	2001-2003 Honda Civic GX 4 Door Service Manual Supplement	\$35.00
61S5A06EL	2001-2003 Honda Civic 2/4 Door Electrical Troubleshooting Manual	\$50.00
61S5A30	2001-2003 Honda Civic 2/4 Door Body Repair Manual	\$44.00
31S5A920	2003 Honda Civic GX 4 Door Owner's Manual Supplement	\$22.00
31S5A620	2003 Honda Civic 4 Door Owner's Manual	\$34.00
31S5A800	2003 Honda Civic GX 4 Door Quick Start Guide	\$10.00
HON-R	Order Form for Previous Years- Indicate Year and Model Desired	FREE
* Prices are subject to change without notice and without incurring obligation.		

*Valid only for sales within the U.S. Canadian owners should contact their authorized Honda dealer.*

<b>ORDER TOLL FREE: 1-800-782-4356</b>
<b>(NOTE: For Credit Card Holder Orders Only)</b>
Monday-Friday 8:00 A.M. — 6:00 P.M. EST
<b>MINIMUM CREDIT CARD PURCHASE \$10.00</b>

**OR**

By completing this form you can order the materials desired. You can pay by check or money order, or charge to your credit card. Mail to Helm Incorporated at the address shown on the back of the order form.

2 0 0 3  H O N D A	PUBLICATION NUMBER	VEHICLE MODEL		Qty	Price Each*	Total Price	
		Name	Year				
* Prices are subject to change without notice and without incurring obligation.					TOTAL MATERIAL		
Orders are mailed within 10 days. Please allow adequate time for delivery.					Mich. Purchases Add 6% Sales Tax		
					HANDLING CHARGE		\$6.00
					GRAND TOTAL		





## Owner's Identification

---

OWNER \_\_\_\_\_  
\_\_\_\_\_

ADDRESS \_\_\_\_\_  
\_\_\_\_\_

STREET

\_\_\_\_\_ CITY

\_\_\_\_\_ STATE/PROVINCE

\_\_\_\_\_ ZIP CODE/  
POSTAL CODE

V. I. N. \_\_\_\_\_

DELIVERY DATE \_\_\_\_\_

(Date sold to original retail purchaser)

DEALER NAME \_\_\_\_\_ DEALER NO. \_\_\_\_\_

ADDRESS \_\_\_\_\_  
\_\_\_\_\_

STREET

\_\_\_\_\_ CITY

\_\_\_\_\_ STATE/PROVINCE

\_\_\_\_\_ ZIP CODE/  
POSTAL CODE

OWNER'S SIGNATURE \_\_\_\_\_

DEALER'S SIGNATURE \_\_\_\_\_

This Owner's Manual should be considered a permanent part of the vehicle, and should remain with the vehicle when it is sold.

The information and specifications included in this publication were in effect at the time of approval for printing. Honda Motor Co., Ltd. reserves the right, however, to discontinue or change specifications or design at any time without notice and without incurring any obligation whatsoever.