



HOVER



INSTRUCTION BOOK

DYC 710AV2BX

Condenser Tumble Dryer

English 2

DYNAMIC
DRY



AQUA
VISION

MEGA
10KG

INDEX

Introduction	3
Delivery Information	3
Safety Reminders	3
Use	4
Installation	5
The Laundry	5
Ventilation	6
Environmental Issues	7
Gas Service	7
Installation	7
Electrical Requirements	7
Adjusting the Feet	7
Drain Hose Kit: Fitting Instructions	8
Preparing the Load	9
Clothes Preparation	9
Do Not Tumble Dry	9
Energy Saving	9
Sorting the Load	9
Drying Guide	9
Controls and Indicators	10
Selecting the Programme	11
Door and Filter	12
Opening the Door	12
Filter	12
Filter Care Indicator	12
Water Container	12
To Remove the Container	12
Condenser	13
To Remove the Condenser	13
Operation	13
Delay Start Function	14
Cancelling and Resetting the Programme	14
Cleaning and Routine Maintenance	14
Cleaning the Dryer	14
Technical Specifications	14
Troubleshooting	15
Customer Service	15
Spares	15
Gas Service	15

INTRODUCTION

Please read and follow these instructions carefully and operate the machine accordingly. This booklet provides important guidelines for safe use, installation, maintenance and some useful advice for best results when using your machine.

Keep all documentation in a safe place for future reference or for any future owners.

Delivery Information

Please check that the following items are delivered with the appliance:

- Instruction manual
- Guarantee card
- Energy label

 Check that no damage has occurred to the machine during transit. If it has, call for service by GIAS.

 Failure to comply with the above can compromise the safety of the appliance. You may be charged for a service call if a problem with your machine is caused by misuse.

SAFETY REMINDERS

Use

- This appliance can be used by children aged from 8 years and above and persons with reduced physical, sensory or mental capabilities or lack of experience and knowledge if they have been given supervision or instruction concerning use of the appliance in a safe way and understand the hazards involved. Children shall not play with the appliance. Cleaning and user maintenance shall not be made by children without supervision. Children of less than 3 years should be kept away unless continuously supervised.
- **WARNING** Misuse of a tumble dryer may create a fire hazard.
- This appliances is intended to be used in household and similar applications such as:
 - Staff kitchen areas in shops, offices and other working environments;
 - Farm houses
 - By clients in hotels, motels and other residential type environments;
 - Bed and breakfast type environments.

A different use of this appliance from household environment or from typical housekeeping functions, as commercial use by expert or trained users, is excluded even in the above applications.

INTRODUCTION

SAFETY REMINDERS

Use

If the appliance is used in a manner inconsistent with this it may reduce the life of the appliance and may void the manufacturer's warranty. Any damage to the appliance or other damage or loss arising through use that is not consistent with domestic or household use (even if located in a domestic or household environment) shall not be accepted by the manufacturer to the fullest extent permitted by law."

- This machine should only be used for its intended purpose as described in this manual. Ensure that the instructions for installation and use are fully understood before operating the appliance.
- Do not touch the appliance when hands or feet are damp or wet.
- Do not lean on the door when loading the machine or use the door to lift or move the machine.
- Do not allow children to play with the machine or its controls.
- **WARNING** Do not use the product if the fluff filter is not in position or is damaged; fluff could be ignited.
- **WARNING** Where the hot surface symbol  is located the temperature rise during operation of the tumble dryer may be in excess of 60 degrees C.
- Remove the plug from the electricity supply. Always remove the plug before cleaning the appliance.
- Do not continue to use this machine if it appears to be faulty.
- Lint and fluff must not be allowed to collect on the floor around the outside of the machine.
- The final part of a tumble dryer cycle occurs without heat (cool down cycle) to ensure that the items are left at a temperature that ensures that the items will not be damaged.
- Maximum load drying weight 10 kg.
- The tumble dryer is not to be used if industrial chemicals have been used for cleaning.
- **WARNING:** Never stop a tumble dryer before the end of the drying cycle unless all items are quickly removed and spread out so that the heat is dissipated.

INTRODUCTION

SAFETY REMINDERS

Installation

- Check that the product has no visible signs of damage before use. If damaged do not use and please call GIAS Service.
- Do not use adapters, multiple connectors and/or extensions.
- Never install the dryer against curtains and be sure to prevent items from falling or collecting behind the dryer.
- The appliance must not be installed behind a lockable door, a sliding door or a door with a hinge on the opposite side to that of the tumble dryer.
- Clothes should be spin dried or thoroughly wrung before they are put into the tumble dryer. Clothes that are dripping wet should not be put into the dryer.
- Lighters and matches must not be left in pockets and NEVER use flammable liquids near the machine.
- Glass fibre curtains should NEVER be put in this machine. Skin irritation may occur if other garments are contaminated with the glass fibres.

The Laundry

- Do not dry unwashed items in the tumble dryer.
- WARNING Do not tumble dry fabrics treated with dry cleaning fluids.
- WARNING Foam rubber materials can, under certain circumstances, when heated become ignited by spontaneous combustion. Items such as foam rubber (latex foam), shower caps, waterproof textiles, rubber backed articles and clothes or pillows fitted with foam rubber pads MUST NOT be dried in the tumble dryer.
- Always refer to the laundry care labels for directions on suitability for drying.
- Items that have been soiled with substances such as cooking oil, acetone, alcohol, petrol, kerosene, spot removers, turpentine, waxes and wax removers should be washed in hot water with an extra amount of detergent before being dried in the tumble dryer.
- Fabric softeners, or similar products, should be used as specified by the fabric softener instructions.

INTRODUCTION

SAFETY REMINDERS

Ventilation

- Adequate ventilation must be provided in the room where the tumble dryer is located to prevent gases from appliances burning other fuels, including open fires, being drawn into the room during operation of the tumble dryer.
- Installing the rear of the appliance close to a wall or vertical surface.
- There should be a gap of at least 12 mm between the machine and any obstructions. The inlet and outlet should be kept clear of obstruction. To ensure adequate ventilation the space between the bottom of the machine and the floor must not be obstructed.
- Check regularly that the air flowing through the dryer is not restricted.
- Check frequently the fluff filter after use, and clean, if necessary.
- Prevent items from falling or collecting behind the dryer as these may obstruct the air inlet and outlet
- NEVER install the dryer up against curtains.
- In cases where the dryer is installed on top of a washing machine, a suitable stacking kit must be used according to the following configuration.
 - Stacking kit Mod 35100019: for minimum washing machine depth 49 cm
 - Stacking kit Mod 35900120: for minimum washing machine depth 51 cm

The instructions for installation and any fixing attachments, are provided with the staking kit.

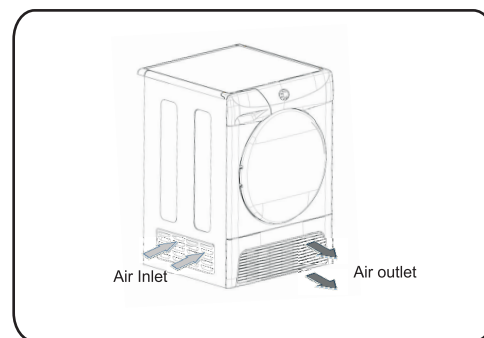

⚠ Do not install the product in a low temperature room or in a room where there is a risk of frost occurring. At temperature around freezing point the product may not be able to operate properly: there is a risk of damage if the water is allowed to freeze in the hydraulic circuit (valves, hoses, pumps). For a better product performance the ambient room temperature must be between +2°C and +35°C. Please note that operating in cold condition (between +2 and +15°C) might simply some water condensation and water drops on floor.

INSTALLATION

Environmental Issues

- All packaging materials used are environmentally-friendly and recyclable. Please help dispose of the packaging via environmentally-friendly means. Your local council will be able to give you details of current means of disposal.
- To ensure safety when disposing of an old tumble dryer disconnect the mains plug from the socket, cut the mains power cable and destroy this together with the plug. To prevent children shutting themselves in the machine break the door hinges or the door lock.

European Directive 2002/96/EC

This appliance is marked according to the European directive 2002/96/EC on Waste Electrical and Electronic Equipment (WEEE).



By ensuring this product is disposed of correctly, you will help prevent potential negative consequences for the environment and human health, which could otherwise be caused by inappropriate waste handling of this product.

The symbol on the product indicates that this product may not be treated as household waste. Instead it shall be handed over to the applicable collection point for the recycling of electrical and electronic equipment.

For more detailed information about treatment, recovery and recycling of this product, please contact your local city office, your household waste disposal service or the shop where you purchased the product. Disposal must be carried out in accordance with local environmental regulations for waste disposal.

GIAS Service

- To ensure the continued safe and efficient operation of this appliance we recommend that any servicing or repairs are only carried out by an authorised GIAS service engineer.

 If the appliance is not running properly or breaks down, switch it off and disconnect the plug from the socket. Consult GIAS Service for possible repair.

Electrical Requirements

Tumble dryers are supplied to operate at a voltage of 220-240V, 50 Hz single phase. Check that the supply circuit is rated to at least 10A.

Electricity can be extremely dangerous.

This appliance must be earthed.

The socket outlet and the plug on the appliance must be of the same type.

Do not use multiple adapters and/or extension leads.

The plug should be accessible for disconnection after the appliance has been installed.

CE Appliance complies with European Directive 2004/108/EC, 2006/95/EC and subsequent amendments.

 You may be charged for a service call if a problem with your machine is caused by incorrect installation.

 If the mains cord on this appliance is damaged, it must be replaced by a special cord which is **ONLY** obtainable from the spares service. It must be installed by a competent person.

 Do not plug the machine in and switch it on at the mains until the installation is completed. For your safety, this dryer must be correctly installed. If there is any doubt about installation, call GIAS Service for advice.

Adjusting the Feet

Once the machine is in place the feet should be adjusted to ensure that the machine is level.

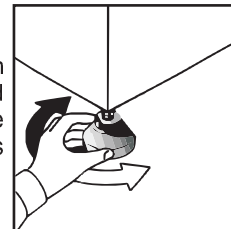

DRAIN HOSE : FITTING INSTRUCTIONS

To avoid emptying the water container after each drying cycle, the water can be discharged directly to a waste water drain pipe (the same drainage system as household sinks). Water Bye-Laws prohibit connection to a surface water drain. The waste water drain pipe should be located adjacent to the tumble dryer.

The kit consists of: 1 hose and 1 tap.

⚠ WARNING! Switch off and remove the tumble dryer plug from the electricity supply before carrying out any work.

Fit the Hose as Follows:

1. Tilt the machine backwards.

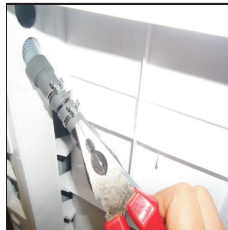

2. The waste water pipe is situated at the left-hand side of the machine (see the picture). A grey hose connects to the bridge at the left hand side of the machine. Using pliers, remove the pipe retaining clip from the bridge.



3. Pull the hose off the bridge connection.

4. Attach the black hose from the kit, (using the connector and pipe clips supplied), to the hose removed from the bridge connection.



5. Place the tap supplied by the kit to close the remaining hose.



6. Once the machine is in place the feet should be adjusted to ensure that the new hose does not kink when pushing the tumble dryer into position.

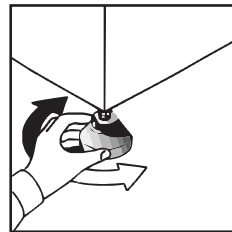

7. Connect the new drain hose to the waste Water pipe.



8. Connect to the mains electricity supply.



PREPARING THE LOAD

Before using the tumble dryer for the first time:

- Please read this instruction book thoroughly.
- Remove all items packed inside drum.
- Wipe the inside of the drum and door with a damp cloth to remove any dust which may have settled in transit.

Clothes Preparation

Make sure that the laundry you are going to dry is suitable for drying in a tumble dryer, as shown by the care symbols on each item.

Check that all fastenings are closed and that pockets are empty. Turn the articles inside out. Place clothes loosely in the drum to make sure that they don't get tangled.

Do Not Tumble Dry:

Woolens, silk, delicate fabrics, nylon stockings, delicate embroidery, fabrics with metallic decorations, garments with PVC or leather trimmings, training shoes, bulky items such as sleeping bags, etc.

⚠ IMPORTANT: Do not dry articles which have been treated with a dry cleaning fluid or rubber clothes (danger of fire or explosion).

During the last 15 minutes the load is always tumbled in cool air.

Energy Saving

Only put into the tumble dryer laundry which has been thoroughly wrung or spin-dried. The drier the laundry the shorter the drying time thus saving electricity.

ALWAYS

- Try to dry the maximum weight of laundry, this will save time and electricity.
- Check that the filter is clean before every drying cycle.

NEVER

- Exceed the maximum weight, this will waste time and electricity.
- Put dripping wet items into the tumble dryer, this may damage the appliance.

⚠ Do not overload the drum, large items when wet can exceed the maximum admissible clothes load (for example: sleeping bags, duvets).





Maximum Drying Weight

- Cottons **Max. 10 kg**
- Synthetics **Max. 4 kg**

Sort the Load as Follows

• By care symbols

These can be found on the collar or inside seam:

-  Suitable for tumble drying.
-  Tumble drying at high temperature.
-  Tumble drying at low temperature only.
-  Do not tumble dry.

If the item does not have a care label it must be assumed that it is not suitable for tumble drying.

• By amount and thickness

Whenever the load is bigger than the dryer capacity, separate clothes according to thickness (e.g. towels from thin underwear).

• By type of fabric

Cottons/linen: Towels, cotton jersey, bed and table linen.

Synthetics: Blouses, shirts, overalls, etc. made of polyester or polyamid, as well as for cotton/synthetic mixes.

• By drying level

Sort into: iron dry, cupboard dry, etc. For delicate articles press the Delicates button  to select low drying temperature.

Drying Guide

The standard cycle HANG DRY () is the most energy efficient and best suited for drying normal wet cotton laundry.

The table below shows the approximate time and energy consumption of the main drying programmes.

CYCLE	LOAD	ENERGY	TIME
		(kWh)	(Min)
All Towels	FULL	6,80	230
Store Dry	FULL	6,44	210
Hand Dry	FULL	5,70	195
Hang Dry	HALF	3,01	108
Iron Dry	FULL	4,56	159
Power consumption of "left on-mode"			0,75 W
Power consumption of "off-mode"			0,15 W

CONTROLS AND INDICATORS

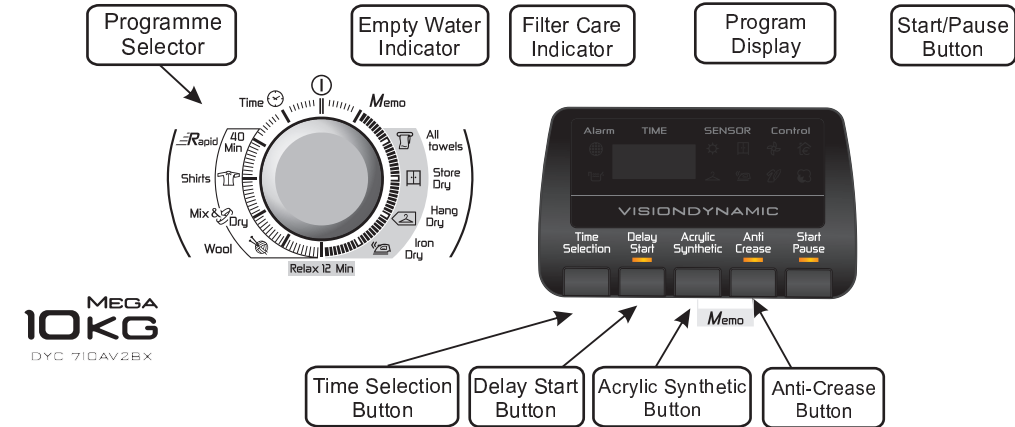

Control Panel and Indicator Lights

Programme Selector – Select the required programme.

Time Selection Button ⌚ – Allows the user to change duration of the programme selected by Programme Selector. It can be used only with the selection of: Mix&Dry, Shirts and Time Programmes.

Delay Start Button ⌚ – Allows the user to delay the start of the drying cycle (see details of Operation).

Acrylic and Synthetic Button – When pressed the 🌫 default indicator will fade and 🌫 will be illuminated.

Anti-Crease Button 🌫 – Allows the user to select a post drying anti-crease cycle.

Start/Pause Button ▶|| – Press to commence/ to pause the selected drying programme.

Memo Button – Allows user to record the programme by pressing simultaneously the Anti-Crease and the Acrylic Synthetic buttons for 3 seconds, after 2 minutes duration of the chosen programme/option.

Filter Care indicator 🌐 – Lights when the filter needs cleaning.

Empty Water indicator 🚰 – Lights when the water container is full.

Program Display – Related indicator lights when a auto programme has been selected.

🏠 – Indicator will come on when the eco programme has been selected.

Refresh 🔄 – The indicator lights up when the programme starts the cool down stage.

SELECTING THE PROGRAMME

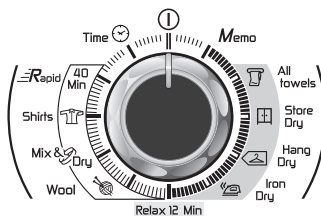

The Hoover Sensor Dry machine gives many options for drying the laundry to suit all circumstances. The table on the next page lists the programmes and the function of each programme.

Note:

The sensor may not detect a small load of small articles. For small loads and separate items or pre-dried fabrics with low moisture content, use the timed programmes.

If the sensor does not detect the item the dryer will only operate for 10 minutes before going into cooldown.

If the load is too large or too wet to tumble dry the dryer will automatically go into cooldown after approximately 3 hours.

In these cases we advise to use a time cycles between 30 and 75minutes depending on the load size and dryness required, and select high or low heat depending upon the fabric type.

ERROR: ioerror
OFFENDING COMMAND: image

STACK:

-mark-
-savelevel-
-mark-
-savelevel-