

HOOVER®

Wet/Dry Vac

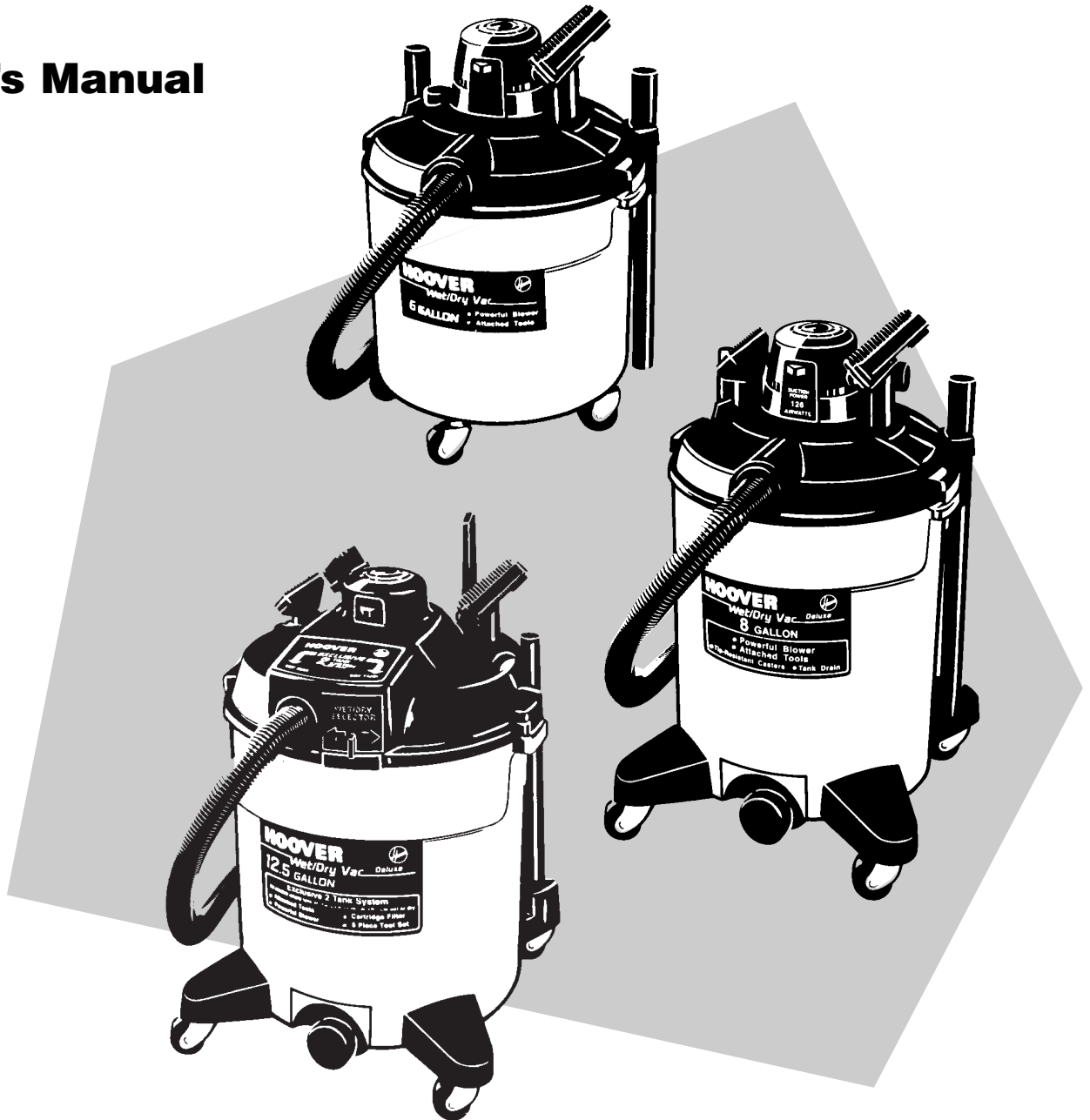

Owner's Manual



**Read these instructions
before operating cleaner**

Record and retain

The HOOVER cleaner you have purchased is designed for both wet and dry pick up and also has blower capabilities.

The model and serial number are located on the cleaner lid near the cord storage hook.

For your personal records, please enter the COMPLETE model and serial numbers in the spaces provided and retain this information.

Model number _____

Serial number _____

It is suggested that you attach your sales receipt to this owner's manual. Verification of date of purchase may be required for warranty service of your Hoover product.

**Thank you for selecting a
HOOVER® product.**

This cleaner was inspected and packaged carefully before being shipped from the factory. If you should happen to need assistance during assembly or operation, call **1-800-944-9200** for automated referral of authorized service outlet locations (U.S. only) or
1-330-499-9499 to speak with a representative in our Consumer Response Center.

PLEASE DO NOT RETURN THIS PRODUCT TO THE STORE.

Important Safeguards!

When using an electrical appliance, always follow basic precautions, including the following:

READ ALL INSTRUCTIONS BEFORE USING THIS APPLIANCE.

Warning: To reduce the risk of fire, electric shock, or injury:

- Do not expose to rain; store indoors only.
- Connect to a properly grounded outlet only. See "Grounding Instructions".
- Wear eye protection when operating blower.
- Close supervision is necessary when any appliance is used by or near children. Do not allow vacuum cleaner to be used as a toy or to run unattended at any time.
- Keep hair, loose clothing, fingers, feet and all parts of body away from openings, and moving parts.
- Do not pick up anything that is burning or smoking, such as cigarettes, matches, or hot ashes.
- Do not pick up flammable or combustible liquids such as gasoline, or use in areas where they may be present.
- Do not vacuum or use blower near toxic or health endangering materials such as asbestos, pesticides, fertilizers, or anything that is poisonous.
- Do not vacuum explosive dusts or use cleaner or blower in areas that may contain explosive substances such as coal, grain, or any other fine, combustible material.
- Avoid picking up hard, sharp objects with the cleaner. They may damage the cleaner and the filter.
- Do not use without filters in place. Clean filters frequently when picking up very fine materials such as powder.
- Use extra care when cleaning on stairs.
- Do not put any object into openings. Do not use with any opening blocked; keep free of dust, lint, hair, or anything that may reduce air flow.
- Do not pull or carry by cord, use cord as a handle, close door on cord or pull cord around sharp edges or corners. Do not run appliance over cord. Keep cord away from heated surfaces.
- Always disconnect cord from electrical outlet before servicing the cleaner.
- Unplug cleaner when not in use. Turn off all controls before unplugging.
- Do not unplug by pulling on cord. To unplug, grasp the plug, not the cord. Never handle plug or appliance with wet hands.
- If needed, connect to a suitable extension cord. See "Extension cord instructions".
- Do not use with damaged cord or plug. If appliance is not working as it should, has been dropped, damaged, left out doors, or dropped into water, take it to a Hoover Factory Service Center or Authorized Hoover Warranty Service Dealer (Depot).
- Use vacuum cleaner only for its intended use as described in the instructions. Use only attachments recommended by The Hoover Company; others may cause hazards.

Index

Assembly4-5

How to Use

 Automatic Wet Shut-Off7

 Blower7

 Cleaner Description6

 Dry pick-up7

 Extension cord7

 Wet pick-up7

If you have a problem9

Important Safeguards2

Maintenance

 Authorized Service8

 Emptying tank7-8

 Filters8

 Lubrication8

Storage7

© 1993 The Hoover Company
www.hoovercompany.com



Save these instructions!

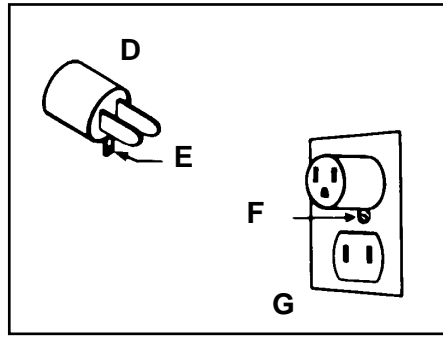
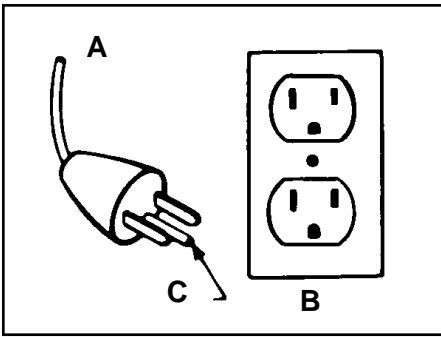

Grounding Instructions

This appliance must be grounded. If it should malfunction or breakdown, grounding provides a path of least resistance for electrical current to reduce the risk of electric shock. This appliance is equipped with a cord having an equipment-grounding conductor (C) and grounding plug (A). The plug must be plugged into an appropriate outlet (B) that is properly installed and grounded in accordance with all local codes and ordinances.

DANGER-

Improper connection of the equipment-grounding conductor can result in the risk of electric shock. Check with a qualified electrician or service person if you are in doubt as to whether the outlet is properly grounded. Do not modify the plug provided with the appliance - if it will not fit the outlet, have a proper outlet installed by a qualified electrician. This appliance is for use on a nominal 120 volt circuit and has a grounding plug that looks like the plug illustrated in sketch "A".

A temporary adapter (D) may be used to connect this plug to a 2-pole

receptacle (G) if a properly grounded outlet is not available. The temporary adapter should be used only until a properly grounded outlet (B) can be installed by a qualified electrician. The green colored rigid ear (E), lug, or the like extending from the adapter must be connected to a permanent ground such as a properly grounded outlet box cover. Whenever the adapter is used, it must be held in place by a metal screw (F).

NOTE: In Canada, the use of a temporary adapter is not permitted by the Canadian Electrical Code.

Questions or Concerns?

The Hoover Company wants to quickly resolve any concerns about your cleaner or questions regarding its use. Look on the list provided with the product for your local **Hoover Factory Service Center** or in the Yellow Pages under "Vacuum Cleaners - Household" for the nearest **Authorized Hoover Warranty Service Dealer** (Depot) or call:

1-800-944-9200 for an automated referral of authorized service outlet locations (U.S. only)

OR

1-330-499-9499 to speak with a representative in the Hoover Consumer Response Center.

PLEASE DO NOT RETURN THIS PRODUCT TO THE STORE OR SEND IT TO NORTH CANTON FOR SERVICE.

1. Assembly

Carton contents

Remove parts from tank and identify the following:

- A. Cleaner tank
- B. Cleaner lid and motor housing or cleaner lid and motor housing (Supreme 12.5 gallon)
- C. Hose
- D. Caster supports (4)*
- E. Casters(4)
- F. Wet/Dry nozzle
- G. Squeegee insert *
- H. Paper filter
- I. Foam filter
- J. Mounting ring
- K. Extension wands (2)
- L. Caster support screws (4)*

*included with some models

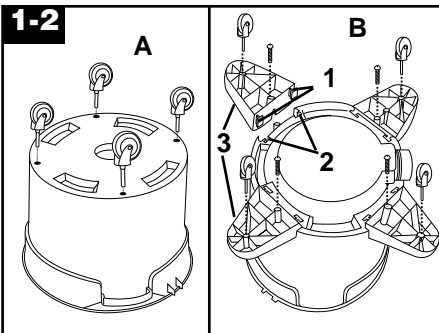
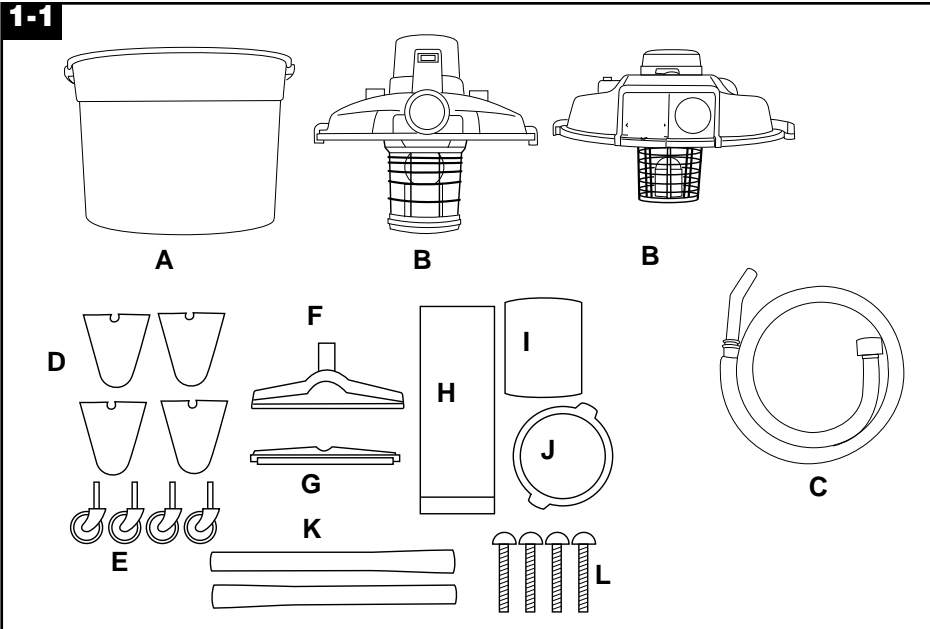

Attach casters

(standard models)

Remove cleaner lid. Turn cleaner tank upside down (A).

Insert caster stem into hole on bottom of tank. Press firmly until caster snaps into place.

Repeat with remaining casters.

Turn cleaner tank right side up.

Attach caster supports and casters

(supreme models)

Remove cleaner lid. Turn cleaner tank upside down (B).

Align square tabs (1) on caster supports (3) with rails (2) on tank. Slide tabs onto rails and press caster support down firmly.

Insert support screw into hole nearest tank. Tighten screw with a Phillips screwdriver.

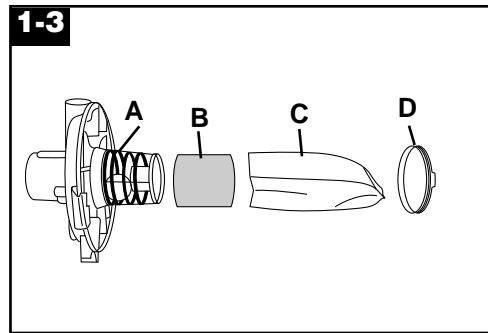

Insert caster stem into hole on bottom of caster support. Press firmly until caster snaps into place. Repeat with remaining casters. Turn cleaner tank right side up.

Attach filters

Disconnect cleaner from electrical outlet before attaching or removing filters.

NOTE: Do not attempt to remove the filter cage or float ball. They are not removable parts.

For dry pick-up

Slide foam filter (B) over filter cage (A).

Slide paper filter (C) over foam filter. Make sure foam filter and paper filter are to top of filter cage.

Slide mounting ring (D) to top of filters. Ring will rest against ribs (E) in housing.

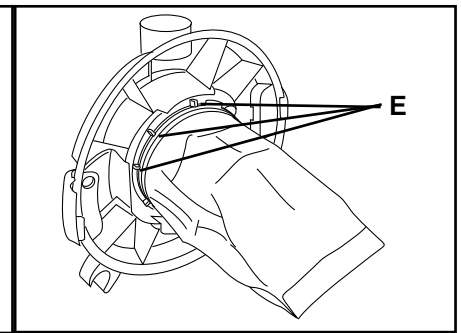

It is very important that the mounting ring (D) is pushed over the filters and all the way to the ribs (E), as shown in the illustration.

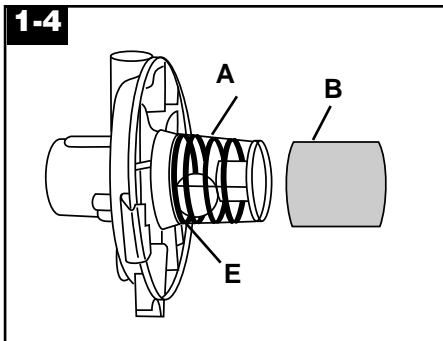

For wet pick-up

Slide foam filter (B) over filter cage (A).

Make sure that the foam filter is pushed to the top of filter cage near the ribs (E).

Do not use paper filter for wet pick-up.

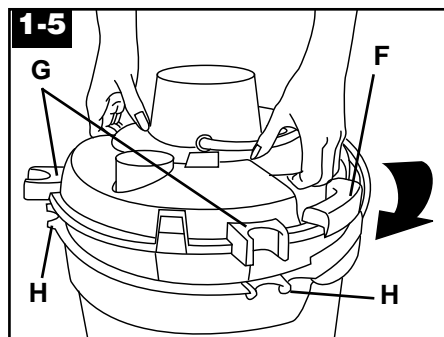

Attach cleaner lid (except Supreme 12.5 gallon)

With latches (F) rotated outward, align wand storage clips (G) with "ears" (H) on top of tank.

Rotate latches inward to lock lid in place.

Note: For convenience in attaching and removing the lid, finger holds have been provided.

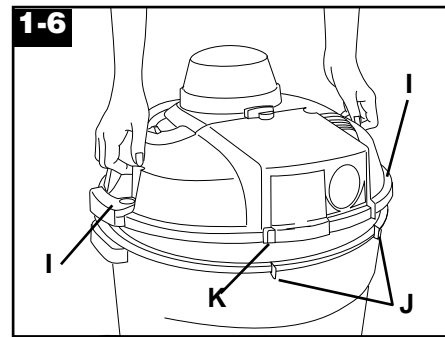

Attach cleaner lid (Supreme 12.5 gallon)

Rotate lid latches (I) outward. Align ribs (J) on front of tank with slots (K) on either side of hose inlets; place lid on tank.

Rotate latches inward to lock lid in place.

Note: For convenience in attaching and removing the lid, finger holds are provided.

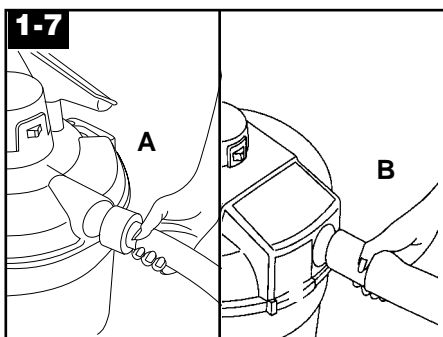

Attach hose, wands and cleaning tool

Push hose into hose inlet (A) or (B) on cleaner lid; twist hose to tighten or loosen connection.

The wands and tools attach to hose in the same manner.

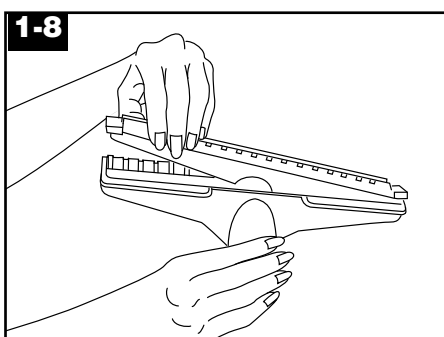

Press squeegee insert (available on some models) firmly into nozzle opening.

Use squeegee for wet pick-up only.

Additional tools and accessories that are not included with your model are available at additional cost from your Hoover Factory Service Center, Authorized Hoover Warranty Dealer, by using the enclosed order form, or through The Hoover Company on-line at www.hoovercompany.com

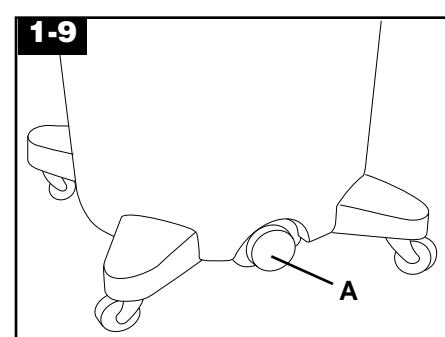

Attach drain cap (Available some models)

Screw drain cap onto lower, front of tank as shown.

2. How to use

The assembled cleaner will look like the drawing.

Cleaner Description

1. ON/OFF switch
2. Lid latches
3. Cleaner lid
4. Hose inlet
5. Hose
6. Tank
7. Caster supports*
8. Casters
9. Tank drain cap
10. Carrying handles located on both sides of tank
11. Extension wands
12. Wand storage clip
13. Cord hook: loop cord over hook for storage.
14. Tool storage area
15. Blower port
16. Wet/Dry nozzle (with squeegee insert*)

*Supreme models only

Operate cleaner only at voltage specified on data plate on bottom of cleaner.

This cleaner is intended for household use.

Wear ear protecton if operating cleaner for a prolonged period of time.

2-1

Standard models

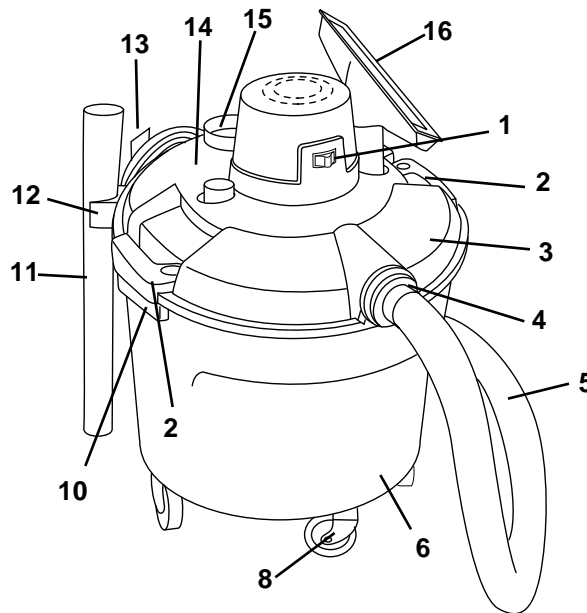

Supreme models

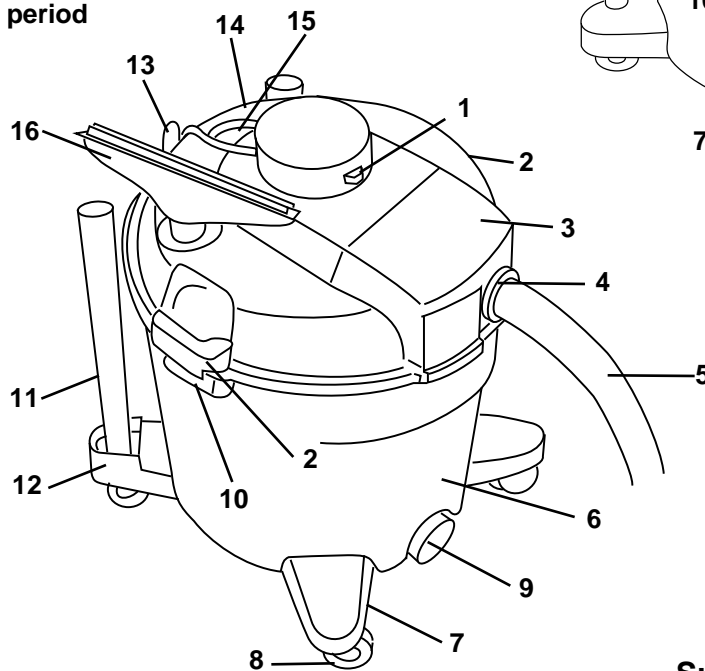
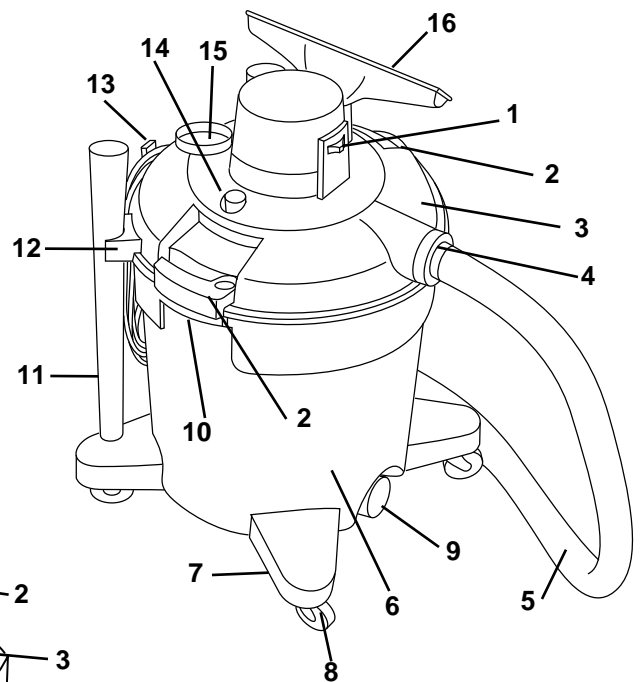

Supreme 12.5 gallon models

Extension cord instructions

Use at least a 16 gauge, grounding type, SVT or SJT type extension cord. The extension cord must employ a 3-prong grounding type plug and a 3-pole receptacle that accepts the machine plug.

Dry pick-up

With foam and paper filters in place and cleaner lid locked onto tank, attach the desired tool to hose end. Plug power cord into a **properly grounded outlet** and turn cleaner on.

Use paper filter with foam filter for dry pick-up only.

Wet pick-up

With foam filter **only** in place and cleaner lid locked onto tank, attach desired tool (with squeegee if available with your model) to hose end. Plug power cord into a **properly grounded outlet** and turn cleaner on.

Do not use paper filter for wet pick-up.

Do not use cleaner as a pump to clean out clogged drains, sinks, or other plumbing fixtures.

If cleaner will not pick up, check filters. They may need to be cleaned or changed (See "Maintenance" section).

Automatic wet shut-off

When the tank is full of liquid, the automatic shut-off mechanism will shut off cleaner pick-up. When this happens, the cleaner will no longer pick up and the motor sound will become noticeably higher in pitch. Turn cleaner off and empty tank to continue use.

The automatic shut-off will also engage if the cleaner has been tipped over. To continue use, **turn cleaner off** and set it upright. Wait a few seconds to allow motor to come to a complete stop.

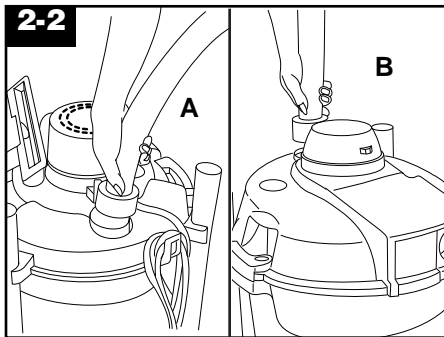

Blower feature

The blower can be used to blow dirt out of areas where it is impossible for suction to reach.

Inside of hose, and tools must be free of litter before operating blower.

We recommend that the filters be in place when operating the blower feature.

Disconnect cleaner from electrical outlet.

Push hose into blower port (A) or (B); twist hose to tighten or loosen connection. Attach tool if desired.

CAUTION: Wear safety goggles when using blower feature. Do not blow toward people, animals, or objects that may be damaged by flying debris.

Wear ear protection if using the blower for a prolonged period of time.

Plug power cord into a **properly grounded outlet**, grasp free end of hose, and turn cleaner on.

Do not use blower to spray paint or any other flammable or combustible materials.

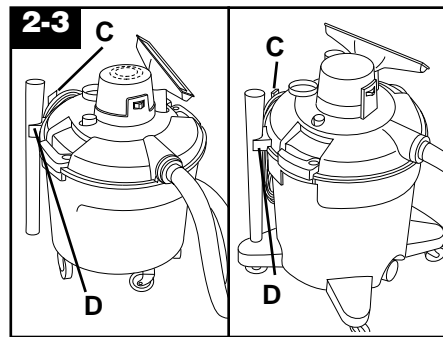

Storage

Empty tank (see Maintenance section). **Rinse inside of tank with clean water before storing particularly if kitchen spills or any substance other than plain water has been picked up.** Wipe dry.

Loop cord over cord storage hook (C).

Slide wands into wand storage clip (D) on sides of cleaner lid.

Press tools into areas located on top of cleaner lid.

3. Maintenance

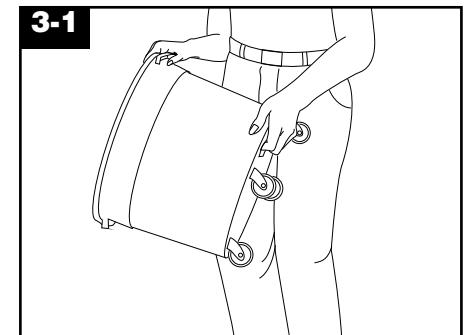

Emptying tank

After dry pick-up

Disconnect cleaner from electrical outlet.

1. Release lid latches and remove cleaner lid from tank.
2. **To avoid back strain, do not lift a full tank. First, scoop out enough debris to make tank easier to lift.**
3. For ease in emptying tank, "handles" are provided on bottom of tank.

Empty contents into a suitable receptacle.

Continued →

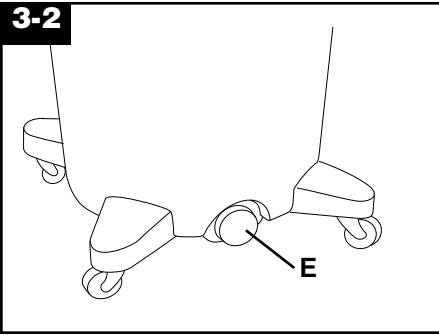

After wet pick-up

Disconnect cleaner from electrical outlet.

For standard models follow steps for “After dry pick up” then proceed with step 3 below.

For Supreme models, proceed as follows:

1. Unscrew drain cap (E) from bottom of tank. Empty contents into a suitable drain.
2. As the liquid level decreases, it may be necessary to tip cleaner to allow remaining liquid to drain out.
- 3. Rinse inside of tank thoroughly with clean water particularly if spills or other liquid substances other than plain water have been picked up. Wipe inside of tank dry.**

Filters

Dry paper filter

Disconnect cleaner from electrical outlet.

Replace paper filter periodically to ensure peak cleaner performance. See “filters” section in Assembly instructions for proper assembly of paper filter.

Foam filter

Disconnect cleaner from electrical outlet.

After each wet pick-up use, remove foam filter. Rinse filter with clean water and let air dry. See “filters” section of Assembly instructions for proper assembly of foam filter.

Optional reusable cartridge filter

The reusable cartridge filter, available at additional cost, can be used for both wet and dry pick-up. It can improve your cleaner's performance significantly. And since it is reusable, the cartridge filter will save you money that would otherwise be spent on replacement dry filter bags.

All filters, including the cartridge filter, are available at your Hoover Factory Service Center, Authorized Hoover Warranty Dealer, on the enclosed order form, or by writing to The Hoover Company, North Canton, Ohio 44720.

To assure that your cleaner operates at peak performance, it is imperative that you use only genuine HOOVER filters distributed by The Hoover Company. HOOVER filters can be identified by these trademarks -



Lubrication

The motor is equipped with bearings which contain sufficient lubrication for the life of the motor. The addition of lubricant could cause damage. **Do not add lubricant to motor bearings.**

Service

To obtain approved HOOVER service and genuine HOOVER parts, locate the nearest **Hoover Factory Service Center or Authorized Hoover Warranty Service Dealer (Depot)** by:

- checking the Yellow Pages under “Vacuum Cleaners - Household” OR -
- checking the list of Factory Service Centers provided with this cleaner OR -
- calling **1-800-944-9200** for an automated referral of authorized service outlet locations (U.S. only) OR -
- checking the Service section of The Hoover Company on-line at www.hoovercompany.com

Do not send your cleaner to The Hoover Company in North Canton for service, this will only result in delay.

If further assistance is needed, contact The Hoover Company Consumer Response Center, North Canton, Ohio 44720

Phone: 330-499-9499.

In Canada, contact Hoover Canada, Burlington, Ontario L7R 4A8, Phone: 1-800-263-6376.

Always identify your cleaner by the **complete** model number when requesting information or ordering parts. (The model number appears on the cleaner lid near the cord storage hook.)

If you have a problem

If a minor problem occurs, it usually can be solved quite easily by using the checklist below.

Problem: Cleaner won't run

Possible Cause

Possible Solution

- **Not firmly plugged in.**
 - *Plug cleaner in firmly*
- **No voltage in wall plug.**
 - *Check fuse or breaker.*
- **Blown fuse/tripped breaker.**
 - *Replace fuse/reset breaker.*

Problem: Loss of suction or air flow

Possible Cause

Possible Solution

- **Obstruction in hose, wand or tool.**
 - *Clear obstruction.*
- **Clogged cartridge or foam filter.**
 - *Clean filter as described in "Maintenance" section.*
- **Hole/split in hose.**
 - *Inspect and replace hose.*
- **Automatic shut-off engaged.**
 - *See "Automatic wet shut-off" section*

HOOVER y  son marcas registradas
THE HOOVER COMPANY, NORTH CANTON, OHIO 44720

HOOVER et  sont des marques déposées
THE HOOVER COMPANY, NORTH CANTON, OHIO 44720

HOOVER and  are registered trademarks
THE HOOVER COMPANY, NORTH CANTON, OHIO 44720