



HOOVER

SteamJet HANDY

INSTRUCTION MANUAL

ENGLISH GB



PRINTED IN P.R.C.
48007305

GENERATION FUTURE



Diagram A

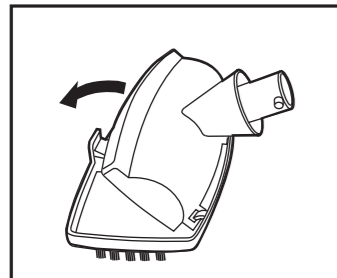

Diagram B

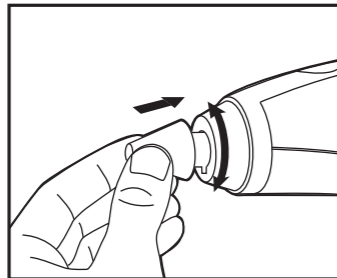

Diagram C

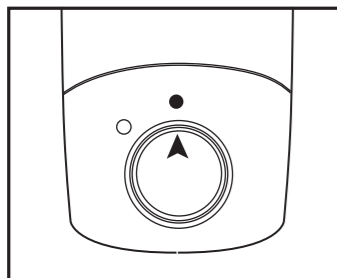

Diagram D

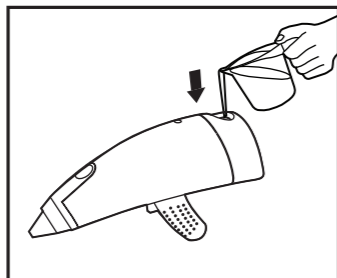
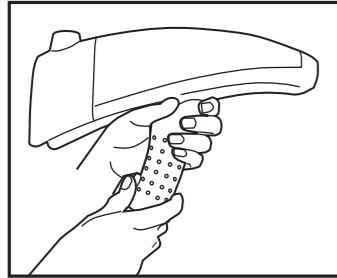
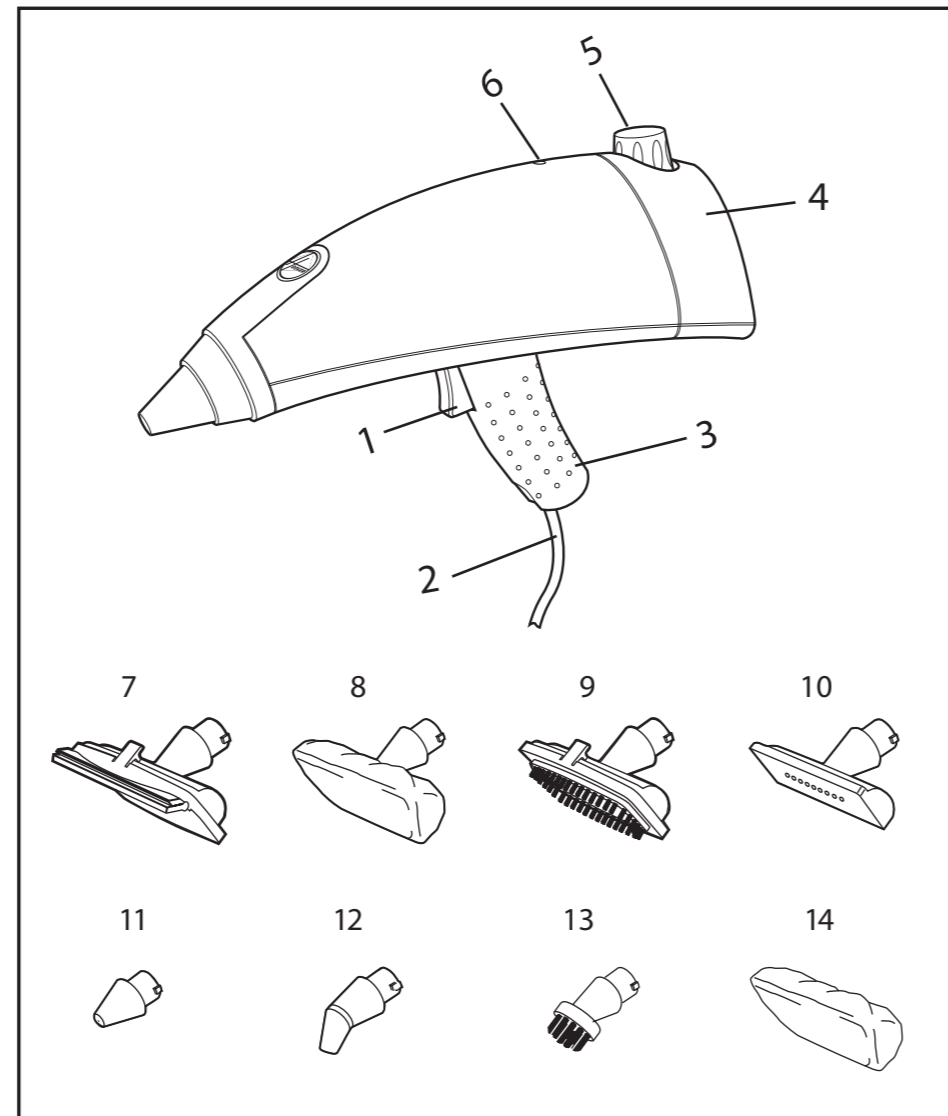

Diagram E



Product and Accessories





IMPORTANT SAFETY REMINDERS

This product should only be used for domestic cleaning as described in this user manual. Please ensure that this guide is fully understood before operating this appliance.

WARNING: Remember electricity can be dangerous, this appliance must be earthed. This plug is fitted with a 13-Amp fuse (UK only)

IMPORTANT: The wires in the mains lead are coloured in accordance with the following code:

BLUE – Neutral **BROWN** – Live **GREEN/YELLOW** – Earth

SAFETY WITH CHILDREN, ELDERLY OR THE INFIRM:

This appliance can be used by children aged from 8 years and above and persons with reduced physical, sensory or mental capabilities or lack of experience and knowledge if they have been given supervision or instruction concerning use of the appliance in a safe way and understand the hazards involved. Children shall not play with the appliance. Cleaning and user maintenance shall not be made by children without supervision.

REMEMBER: After use, switch the product off and remove the plug from the electricity supply. Always switch off and remove the plug before cleaning the appliance or attempting any maintenance.

GETTING TO KNOW YOUR CLEANER

The following features and accessories are mentioned within this user manual and are shown in the 'Product and Accessories' diagram on Page 2.

PRODUCT

1. Steam Release Button
2. Power Cord
3. Slider
4. Water Tank
5. Water Tank Cap
6. Power Light

ACCESSORIES

7. Window Squeegee*
8. Cloth Mounting*
9. Steam Brush Nozzle
10. Accessories Support*
11. Steam Jet Nozzle*
12. Angled Nozzle
13. Round Brush
14. Small Cloth*

* Certain models only

PRECAUTIONS DURING USE

- Read these instructions for use carefully before using the product.
- Before connecting the product, make sure that the mains voltage is the same as the voltage indicated on the data label and that the power outlet is connected to earth.
- Do not put any detergent or chemical substance in the tank.
- Never touch the product with wet hands or feet with the cable plugged into the mains.
- Never dip the product in water or other liquids.
- Never leave the product unattended with the cable plugged into the mains.
- Never let children or people who are not familiar with how the product works use it.
- If the product is left unused, always disconnect it from the mains.
- In case of breakdown or malfunction switch off the product and never attempt to disassemble it, but refer to an authorised service centre.
- The wiring system to which the product is connected must always comply with the laws in force.
- To ensure the safety of the product, use only original spare parts and accessories, approved by the manufacturer.
- Do not use the product if the power cable or other important parts are damaged.
- Use of the product in places where there is a danger of explosions is prohibited.
- Do not direct the jet of steam on electrical components or devices.
- Do not leave the product exposed to wind or rain.
- Do not lay the hot product on surfaces sensitive to heat.
- Do not use electric extension leads that are not authorised by the manufacturer, as they may cause damage or fire.
- If the product is accidentally dropped it must be checked by an authorised service centre because the internal mechanism may have been damaged thus compromising the safety of the product.

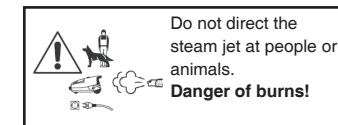
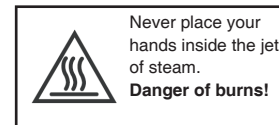

HOW TO START

- Fill the water tank (4) with normal tap water or demineralised water (**Diagram D**).
- Fit the water tank cap (5) into the water tank (4) and turn it clockwise to lock it (**Diagram C**).
- Plug in, press the trigger and within 20 seconds the steam is ready.

USING YOUR PRODUCT

- Attach the accessory most suited for the kind of surface to be cleaned. (See 'ACCESSORIES' P4)
- Plug the mains cable (2) into a suitable earthed mains power outlet. The power light will come on (6).
- To deliver steam, press the steam release trigger (1).

ELECTRONIC STEAM REGULATION

The steam pressure can be adjusted by moving the slide control (3) from lower to higher flow, depending on the cleaning application. (**Diagram E**)

WARNING: Before putting the product away, empty the water tank.

WARNING: Even when unplugged, the product may release steam. Therefore handle it carefully, and store out of reach of anyone who does not know how to use it.

PRECAUTIONS:

- For cleaning leather, wood or delicate fabrics especially dralon, velvet and other pile surfaces, consult the manufacturers instructions. Clean only by using the product at a safe distance together with a soft cloth and always do a test on a non visible part of the item first or on a sample. Allow the test area to dry completely before observing results and effects on surface or colour before proceeding to clean further areas, ensuring that exactly the same distance and technique are applied as for the test area. If in doubt, and on sensitive surfaces like fabrics, leather and wood it is always better to ask for advice from your Steam Cleaner Dealer.
- For cleaning wood surfaces (furniture, doors, etc...) take great care as too long an application of steam could alter the waxed



appearance, the shine or the colour of the surface cleaned. We therefore recommend you apply steam on such surfaces only for brief periods or to clean these surfaces using a cloth first held in the steam.

- Please pay particular attention while cleaning brick floors, too long an application of steam could damage wax, brightness or colour of these surfaces.
- For delicate surfaces (e.g. synthetic materials, lacquered surfaces etc...), we recommend that the small brush should always be covered with at least two cloths to reduce the intensity of the steam.
- If cleaning glass surfaces in particularly low temperatures pre-heat the glass using the product from about 50 centimetres distance from the surface to be cleaned.
- For care of your plants vaporise at a minimum distance of 50 centimetres.
- The product may be used on its own, without attaching the brushes, for specific cleaning tasks requiring steam to be applied from a short distance, which will vary according to the kind of material and the type of soiling to be removed. The more difficult the soil is to remove, the closer you must hold the product to it, because the temperature and pressure are higher closer to the steam outlet. In all cases, after applying steam, wipe the surface with a dry cloth or with a scouring cloth if the soil is more difficult to remove.

REFILLING THE EMPTY TANK

Whenever the water finishes, you can refill the tank while working, without unplugging the power cable. This feature ensures unlimited freedom of operation and steam. Just remove the cap as shown and fill up with water. Then proceed with steaming.

ACCESSORIES

Various kinds of accessories may be connected to the product, depending on the cleaning task to be performed.

- Window squeegee (7) - to clean mirrors, windows, tiles and smooth surfaces
- Cloth mounting (8) - to clean delicate surfaces
- Steam brush nozzle (9) - to clean upholstery and sofas
- Accessories support (10) - to fit windows squeegee and steam brush nozzle. It can be used for direct steam emission on various surfaces
- Steam jet nozzle (11) - to clean corners, grout between tiles, and to steam houseplants
- Angled nozzle (12) - to clean narrow and difficult to reach areas such as toilets, washbasins and taps
- Round brush (13) - to clean stubborn dirt from small surfaces such as hobs, shutters, grout between tiles, etc.
- Small cloth (14) - to be fitted to the accessories support, protects from direct hot steam.

The correct method of attaching accessories is as follows:

- Insert the studs on the base of the accessories into the special slots in the edge of the product
- Turn them anticlockwise until they fully lock onto the appliance (Diagram B).

WARNING: Since the accessories become very hot during use, you must be very careful when removing them or replacing them. Either use an oven glove to handle them or wait until they have cooled down. Make sure that the product is disconnected from the mains power before changing the accessories.

Consumables

ROUND BRUSHES SET	P14 35600272
MULTI FUNCTION NOZZLE	G78 35600274
SQUEEGEE INSERT	AC17 35600275
BRISTLE INSERT	AC18 35600276
MICROFIBRE CLOTH	AC19 35600277

These items can be purchased separately from Hoover.

IMPORTANT INFORMATION

GENUINE HOOVER SPARES AND CONSUMABLES

Always replace parts with genuine Hoover spares. These are available from your local Hoover dealer or direct from Hoover. When ordering parts, please always quote your model number.

HOOVER SERVICE

Should you require service at any time please call your local Hoover service office.

PRODUCT MAINTENANCE

Before carrying out any type of maintenance make sure that the power cable has been disconnected from the mains. When you finish using the round brush, allow the bristles to cool in their natural position to prevent them from drying out of shape. To clean the outside of the product use a damp cloth.

GUARANTEE STATEMENT

The guarantee conditions for this appliance are as defined by our representative in the country in which it is sold. Details regarding these conditions can be obtained from the dealer from whom the appliance was purchased. The bill of sale or receipt must be produced when making and claim under the terms of the guarantee. Subject to change without notice.

Quality: Our factories meet the strict standards that ensures that European safety standards are met and maintained throughout the production life of an appliance.

Safety: We gain independent approval to demonstrate that our domestic electrical appliances are safe.

ENVIRONMENT

Hoover has made a long-term commitment, in all its activities, to safeguarding the environment. Our environmental policy states: "To adopt the best practicable environmental methods in design, production, packaging, use and disposal of products, whilst continuing to improve benefits to the consumer".

This appliance is marked according to the European directive 2011/65/EC on Waste Electrical and Electronic Equipment (WEEE). By ensuring this product is disposed of correctly, you will help prevent potential negative consequences for the environment and human health, which could otherwise be caused by inappropriate waste handling of this product.

The symbol on the product indicates that this product may not be treated as household waste. Instead it shall be handed over to the applicable collection point for the recycling of electrical and electronic equipment. Disposal must be carried out in accordance with local environmental regulations for waste disposal. For more detailed information about treatment, recovery and recycling of this product, please contact your local city office, your household waste disposal service or the shop where you purchased the product.



CE This product complies with the European Directives 2006/95/EC, 2004/108/EC and 2011/65/EC.

Hoover Limited Pentrebach, Merthyr Tydfil, Mid Glamorgan CF48 4TU