

Technology makes life better

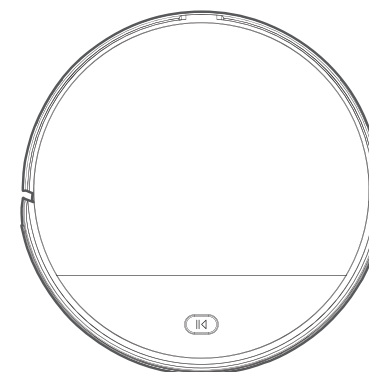

**Robotic Vacuum Cleaner
HX-V302
Instructions for use**

FCC Caution.

This device complies with part 15 of the FCC Rules. Operation is subject to the following two conditions: (1) This device may not cause harmful interference, and (2) this device must accept any interference received, including interference that may cause undesired operation.

Any Changes or modifications not expressly approved by the party responsible for compliance could void the user's authority to operate the equipment.

Note: This equipment has been tested and found to comply with the limits for a Class B digital device, pursuant to part 15 of the FCC Rules. These limits are designed to provide reasonable protection against harmful interference in a residential installation. This equipment generates uses and can radiate radio frequency energy and, if not installed and used in accordance with the instructions, may cause harmful interference to radio communications. However, there is no guarantee that interference will not occur in a particular installation. If this equipment does cause harmful interference to radio or television reception, which can be determined by turning the equipment off and on, the user is encouraged to try to correct the interference by one or more of the following measures:

- Reorient or relocate the receiving antenna.
- Increase the separation between the equipment and receiver.
- Connect the equipment into an outlet on a circuit different from that to which the receiver is connected.
- Consult the dealer or an experienced radio/TV technician for help.

*RF warning for Mobile device:

This equipment complies with FCC radiation exposure limits set forth for an uncontrolled environment. This equipment should be installed and operated with minimum distance 20cm between the radiator & your body.

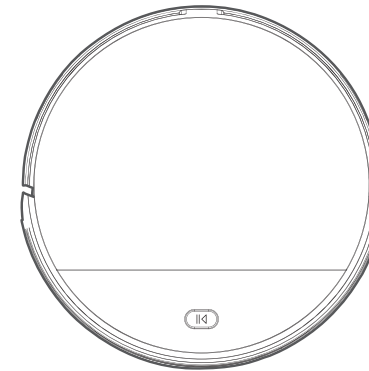

HX-V302

Instructions for use

Thank you for purchasing the smart cleaning Robot!

We hope that our product will bring you a smarter and more convenient lifestyle!

6.2 Replaceable Modules

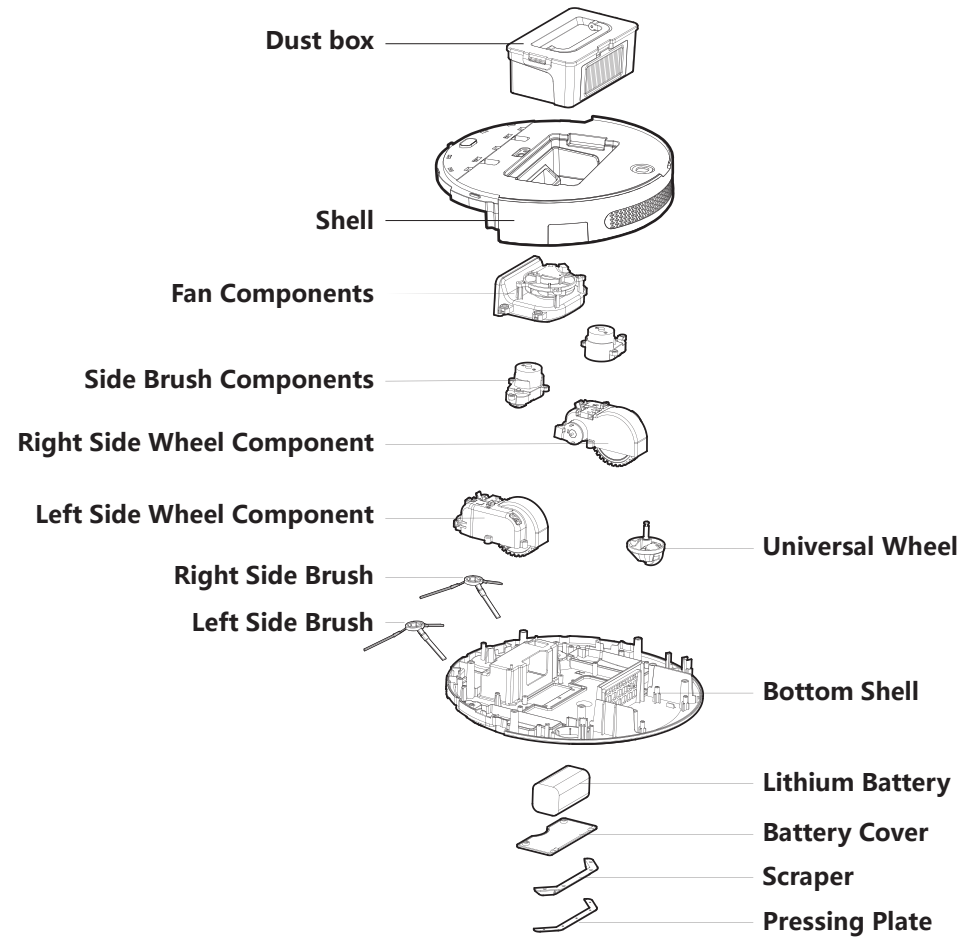

6.1 Alarm Warning

Prompt tone	Possible Reasons	Solutions
Dust box is not installed	The filter isn't put back to the right place after being taken out.	Place the dust box to the right place and press the "sweeping" button again.
Please check if the robot is stuck.	The wheels stop working.	The wheels are stuck by wires/cables on the ground, hanging curtains or obstacles around the carpets. Clean all those things.
Please check if the front part is stuck.	The front holder is stuck	Check if the holder can rebound itself.
Low power, please charge the robot.	The power is less than 20%	The robot will charge itself automatically
Please check if the side bushes are stuck	The side brushes don't work	Check if there is anything twining the brushes, and clear them
Please remove the robot to open area	The robot failed to help itself to get rid of the obstacle.	Please remove the robot to an open area, and press the "sweeping" button again.

Contents

1. Welcome

2. Safety Instructions

3. Product Components

3.1 Names of Parts

3.2 Product Specifications

3.3 Product Characteristics

4. Instructions for use

4.1 Remote Control Instructions

4.2 Operating Instructions

5. Product Maintenance

5.1 Side Brush Cleaning and Replacement

5.2 Cleaning of Dust Box and Filter

5.3 Maintenance of Rolling Brush Components

5.4 Replaceable Modules

6. Common Faults

6.1 Alarm and Warning

6.2 Replaceable Modules

Before using this product, please read the safety instructions below and follow all the routine safety precautions.

Please read the Instructions carefully and keep them for future reference. Any operation that does not conform to the Instructions may cause damage to the product.

Safety Considerations of Main Body and Accessories

A. Warning

01. Do not disassemble, repair or refit the product without authorization; otherwise it may damage the product or pose a hazard.
02. Do not use the product in an environment with risk of fire or explosion.
03. This product can only use the original power adapter; otherwise the product may be damaged or catch on fire.
04. Do not stand or sit on this product; doing so could damage the product or cause it to fall over.
05. When the metal part of the power plug is dusty, please wipe it with a dry cloth.
06. The power adapter is applied to a 100-240V AC voltage. Please plug into the socket properly and keep away from children.
07. Do not wash or soak the main body and electronic accessories in water; otherwise the product may be damaged by a short circuit.
08. Do not damage, load weight on, heat, pull, or bend it.
09. During cleaning, please pay attention to the safety of toddlers and elders at home to avoid tripping, and please do not touch the wheel and side brush to avoid injury. (Please pay special attention to toddlers).
10. This product is for home use. Please do not use it outdoors.
11. Do not allow metal and conductive materials to come in contact with the battery; doing so may cause a short circuit.
12. Do not use without dust bin and/or filters in place.
13. Do not operate the Appliance in an area where there are lit candles or fragile objects.
14. Do not use Appliance on wet surfaces or surfaces with standing water.
15. Do not use Appliance to pick up anything that is burning or smoking, such as cigarettes, matches, hot ashes, or anything that could cause a fire

B Attention

01. Do not touch the product with wet hands; doing so may cause an electric shock.
02. Please do not place the product in places where it could easily fall, such as tables, chairs, high platforms in room, etc.
03. The product has a sophisticated design and should be protected from long-term exposure to sunlight.
04. Please do not use the product in humid environments, such as bath-rooms.
05. Please do not place the product near cigarette butts, lighters or other open fires.
06. Please clean the product after the end of charging.
07. Please turn off the power switch on the side of the robot when the product is out of service for a long time.
08. Please check carefully to see if the power adapter is connected to the socket prior to use, to avoid damage to the robot.
09. Before using the product, please remove all vulnerable items on the floor, such as glass, lamps, and items such as wires and curtains that may entangle with the side brush and suction passages.

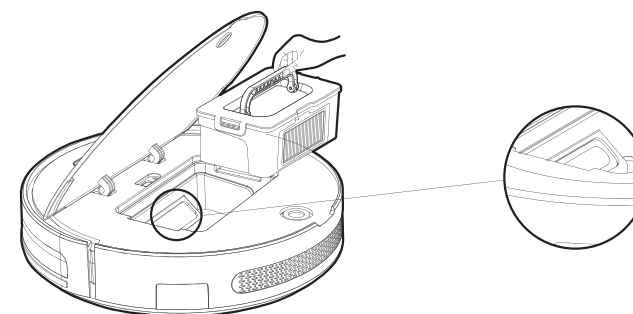
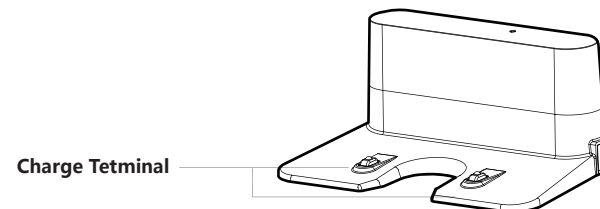

Use the cleaning tools or a dry soft cloth to periodically clean the charging plate of robot chassis and the sensor window.

5.3 Maintenance of Rolling Brush Components

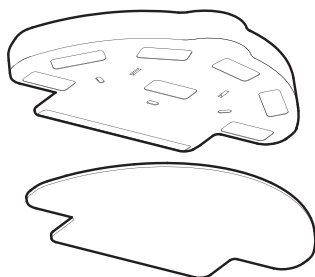

Open the rolling brush components. Remove the rolling brush and dry it flat. Please do not use the brush that is still dripping in case of slipping. This component can be applied to wooden floors, tile floors, marble floors, painted hard floors and so on.

5.4 Maintenance of Other Components

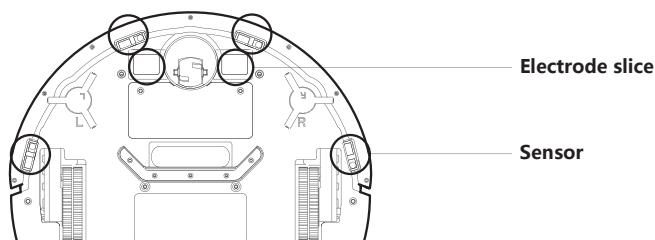

Use cleaning tools or a dry soft cloth to periodically clean the charging plate of robot chassis and the sensor window.

10. This product may not cross a vertical step of approximately 8 mm high.
11. When the dust box is full, please empty the garbage before using again.
12. Please do not use the robot to clean construction waste.
13. The operating temperature of the product ranges from 0 degrees Celsius to 40 degrees Celsius; please do not use it in a high temperature environment.
14. Before the product is scrapped, please remove the battery from the robot. When you remove the battery, please ensure that the product is not connected to a power supply. Please recycle the battery safely for environmental protection.

Safety Considerations for Rechargeable Battery

! Danger

01. Always use a dedicated battery adapter to avoid leakage, heating or rupture.
02. Do not short-circuit the battery or remove the battery; doing so may cause leakage, heating or rupture.
03. Do not transport or preserve with necklaces, hairpins and other metal objects; doing so may lead to short circuit, resulting in leakage, heating or rupture.
04. Do not burn or heat the battery; doing so may cause leakage, heating or rupture.

! Attention

01. If abnormal overheating is discovered during charging, stop using it immediately to avoid leakage, heating or rupture.
02. To prolong the service life of the battery, please remove the battery and place it in a cool, dry environment if it is out of service for a long time; this will avoid leakage, heating or rupture.
03. Do not soak it in water or let it come into contact with any liquid; otherwise it may cause leakage, heating or rupture.
04. Be sure to stop using it immediately in case of any exception (e.g. discoloration or deformation), to avoid leakage, heating or rupture.
05. Always use tape to insulate the battery's electrode when recycling or disposing of it.
06. Contact with other metals will cause heat to crack or catch fire. Please bring used batteries to recyclers or dispose of them according to local regulations.

! A Warning

01. When skin or clothing is exposed to the battery electrolyte, immediately wash with clean water to avoid inflammation of skin, etc.
02. Do not use the rechargeable battery on other devices. This battery is only suitable for Ciso Robotic Vacuum Cleaners.
03. If the battery's outer box is found to be deformed and expanded, or leakage of electrolytes is found, do not charge or continue to use to avoid danger.
04. Do not throw or inflict a strong impact on the battery; doing so may cause leakage, heating or rupture.
05. Do not disassemble the battery pack; doing so may cause battery rupture and electrolyte outflow, leading to fire, explosion and other dangers.

3.1 Names of components

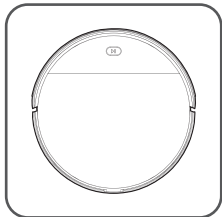

Main Body

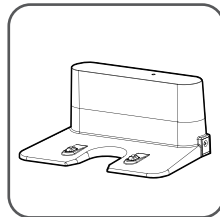

Charging base

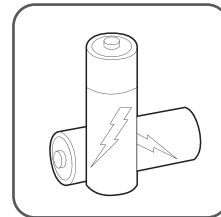

2 AAA batteries

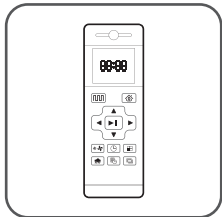

Remote control

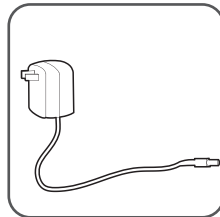

Ac adapter

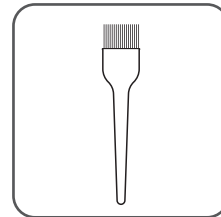

Cleaning tools

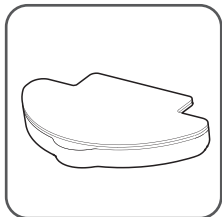

Cistern components

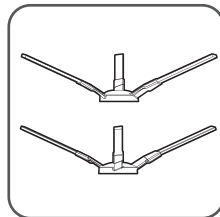

Side brushes

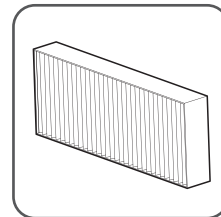

High-effective filter

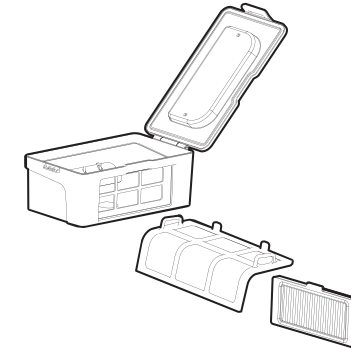
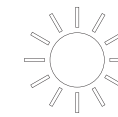

Dry all parts until they are completely dry

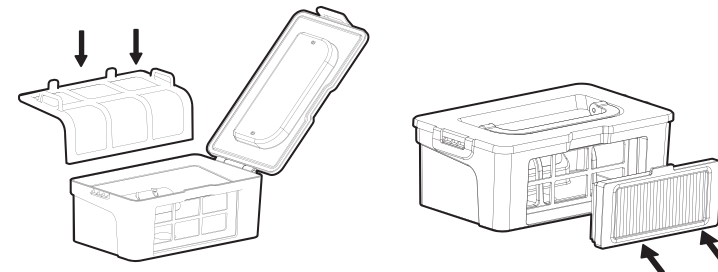

Replace the primary filter and high-efficiency filter back into the trash box

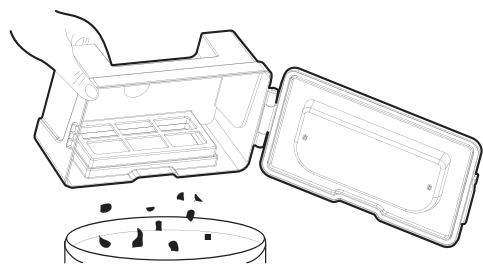

Lower the height of the dust box and dump the trash

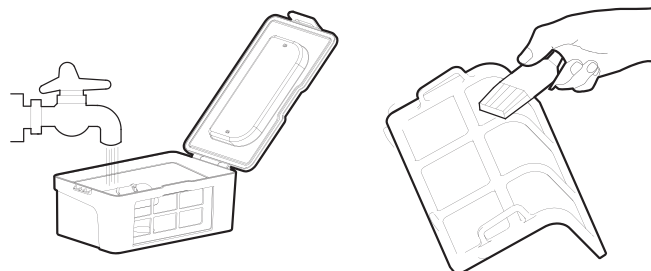

Clean the dust box, high efficiency filter and primary filter thoroughly. After the pre-filter is used for 15-30 days, it should be washed once.

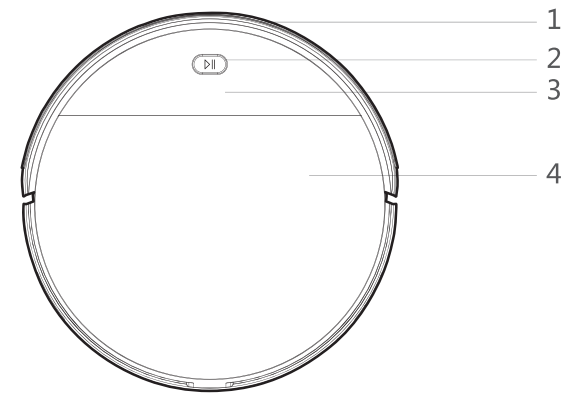

Main Body

1.Bumper

2.control keys

3.panel

4.Middle cover

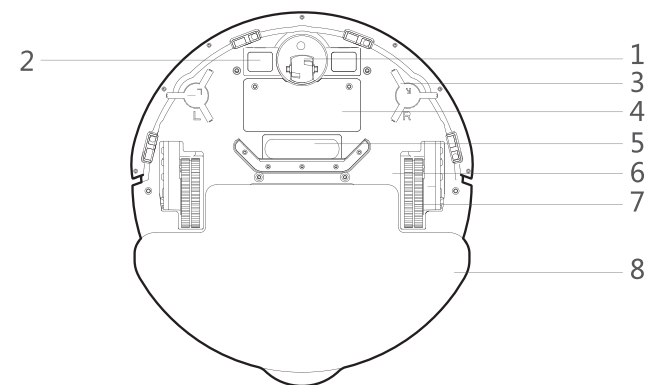

Main Body

1. Universal wheel
5. Suction port

2. Charging shrapnel
6. Base plate

3. Side brush
7. Cincture

4. Battery cover
8. Freezer/ cleaning cloth

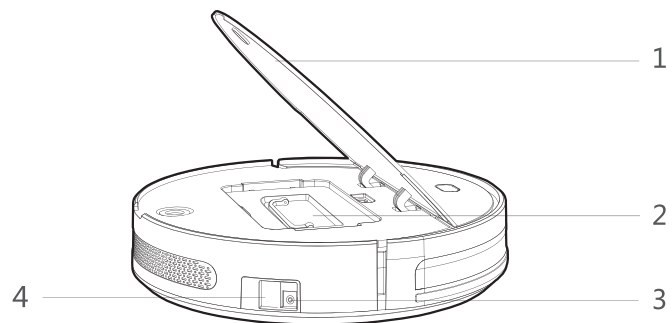

Main Body

- 1.Middle cover
- 2.Dust box
- 3.DC power jack
- 4.Power switch

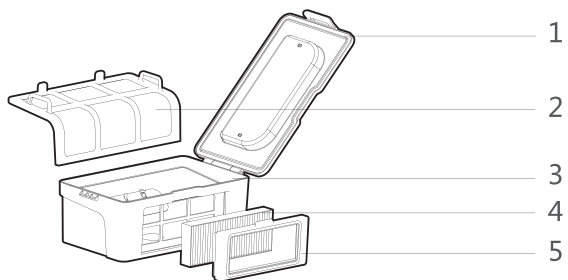

Dust Box

- 1. Dust box cover
- 2. Pre-filter
- 3. Dust box
- 4. High-effective filter
- 5. Dust box sealer

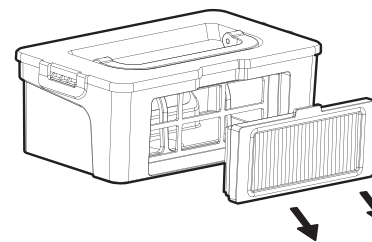

remove the high-efficient filter

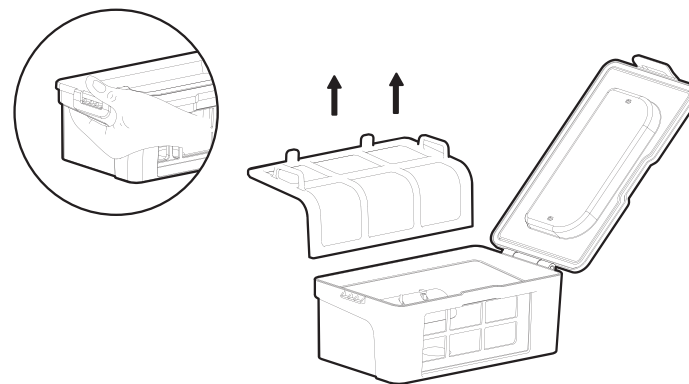

Open the dust box cover and remove the pre-filter

5.1 Side brush cleaning and replacement

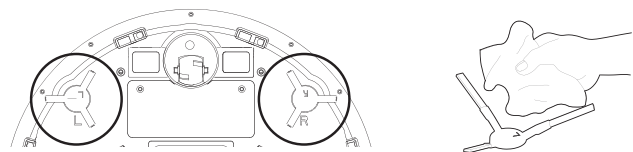

Check the side brush at variable intervals to see if it has been damaged or wrapped with something. Clean the side brush with a cleaning tool or a rag. When the side brush doesn't work, replace it in time. L and R correspond to each other.

5.2 Dust box and filter cleaning

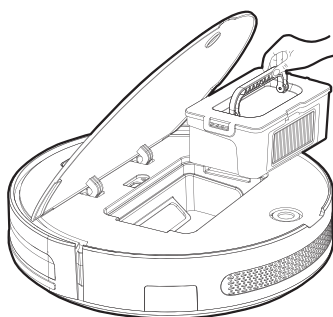

Lift the top cover and remove the dust box. Please check the suction channel and clean it up.

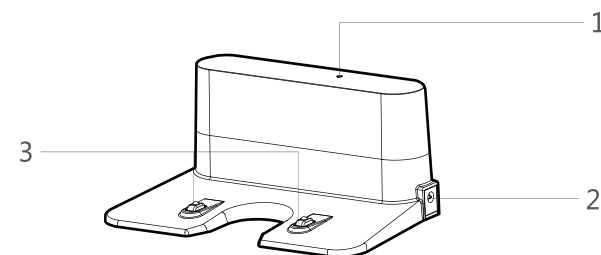

Charging Base

1. Charging indicator

2. DC power jack

3. Charging terminal

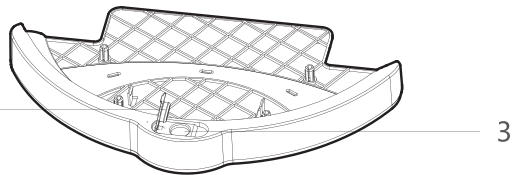
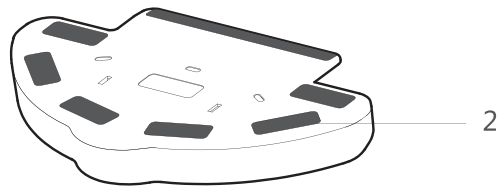
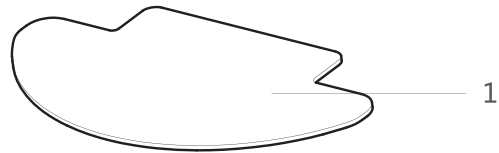

4

3

Water Tank Attachment

1.Rolling brush

2. Poron

3. Water inlet

4. Water box sealer

Cleaning Mode

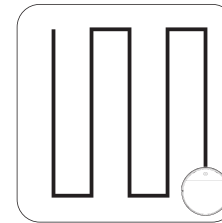

Plan Cleaning
 The robot will perform the smart Plan Cleaning according to the room environment.

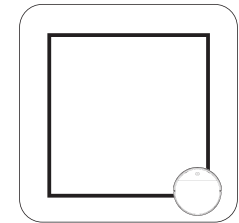

Edge Cleaning
 The robot will clean along the longest edge of the room

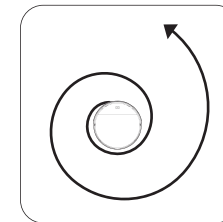

Fixed point cleaning
 This function is only applicable to the operation on the APP

Water box use-instrucions

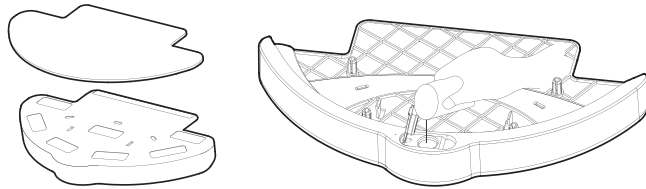

Please remove the tank when charging to avoid danger

Water tank assembly

There is a corresponding affixing place at the bottom of the water tank. Fix the bibulous rag according to the corresponding position on the bottom of the tank, open the tank sealing cover, and fill it with clear water to the position between its 1/2 and 2/3, and then cover the sealer well.

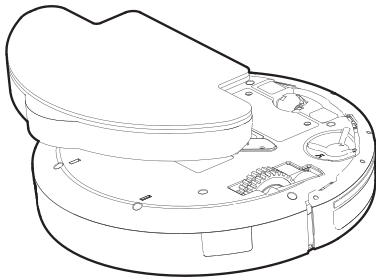

Please remove the tank when charging to avoid danger

Water tank installation

Hang the water tank components on the bottom of the main body according to the direction shown in the figure, and place the two columns on the water tank in the two holes of the main body base so that the water tank can be closely linked with the base.

3.2 Product Specifications

Structure Type

Diameter of main body	320mm
Thickness of main body	75mm
Net weight of main body	2.5 kg

Electronic Type

Voltage	14.4v
Battery capacity	2000mAh
Main body button type	Mechanical keys

Accessory Type

Water box capacity	180ml
Dust box capacity	600ml
Wipe size	316x177 x4mm

Process Parameters

Charging Type	Manual/Automatic
Operating duration	<= 100 min
Charging duration	240 – 300 min

3.3 Product Characteristics

Strong suction power

The suction power of this product is strong. Even tiny dust will be thoroughly cleaned.

Intelligent suction power regulation

This product automatically adjusts the suction power according to different cleaning modes. This not only greatly increases the cleaning efficiency, but also saves 30% of power. It can also be adjusted with the remote control

Humanized Design

It is simple to operate. You can control the robot only by pressing the Control button "start" ! Follow the prompt tone to operate the robot! 

Press the button and the voice "enter plan cleaning mode" and the robot will start sweeping, then press this key to control the machine to pause or continue working, and a voice "beep" can be heard. 

Press and hold the key, after hearing the "beep" sound and remove your finger, and the robot will say "robot is trying to connect the Internet", and then it can be connected according to the robot WIFI setting instructions. 

4.1 Remote Control Instructions

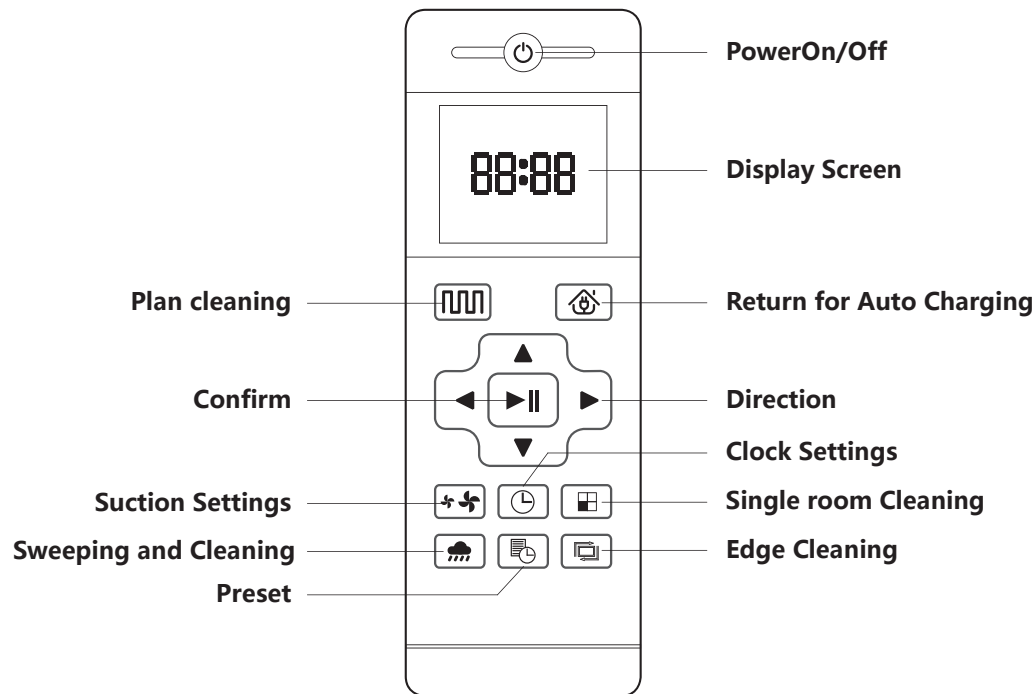

Mode switching

Standby mode.

The power switch is on, the "confirm" key is on, the machine is at rest

Sleeping mode. (▶||)

The power switch is on, the key is blinking, the machine is at rest.

Operating mode. (▶||)

The machine is working, the key light is on, the machine will start sweeping.

Operation peocedure.

sleeping mode-standby mode-operating mode

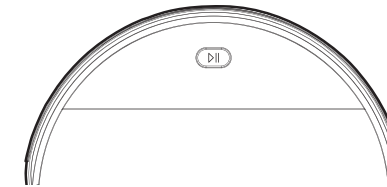
**Startup**

01. Make sure the power switch on the side of the robot is turned on.

02. Press the Control button or the Cleaning mode on the remote control to start the robot.

Pause

This function is to switch the robot from the operating mode to the select and the robot can be paused by the following operations:

01. Press the Control button on the robot to pause the robot. (▶||)

02. Press the power on/off button on the remote control to pause the robot. (▶||)

Sleep

The machine will not work in this mode, the key light is yellow. Without any operations, this robot will sleep in this mode. The machine can come back to work again through pressing the "confirm" button on the main body or through the remote control. (▶||)

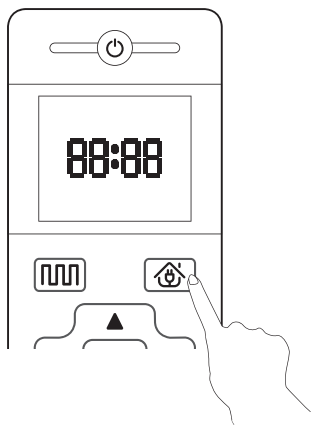

autocharge



Press the "recharging button" , this machine will automatically recharge itself. When the cleaning is completed or the battery is too low, the machine will automatically start to look for charging base. Keep the charging base powered on, otherwise the machine will not be able to find the base for charging.

Note: When charging itself, pressing the "Sweeping" button on the remote control will stop the charge and start cleaning. This operation cannot be performed when using the charging adapter to charge.

Notes for charging:

- A.the yellow light will be on when the power is low; 
- B.the green light will blink while charging; 
- C.the green light will be on when the power is full; 
- D.check the charging after the machine runs out of electricity;
- E. When charging for the first time, make sure the machine is charged for at least 12 hours.
- F.If you do not use the machine for a long time, turn off the power switch;
- G.If you need to use it everyday, place the machine on the charging base and make sure the charging base is powered on.
- H. When the power is low, it will find its own charger. Please make sure there are no obstacles around the charger;

 It is the button for plan cleaning no matter what mode the machine is in, this button will bring it to the plan cleaning.

 Recharging button
Pressing this button to shift the mode as recharging, and the logo will be shown on the play screen. 

 Forward
Forward /At the standby mode, press this button to continue moving forwards, and release it to return to the standby mode.At the Preset mode or the Time Settings mode, press this button to increase the number.

 Backward
At the standby mode, press this button to continue moving backwards, and release it to return to the standby mode. At the Preset mode or the Time Settings mode, press this button to decrease the number.

 Left Arrow
At the standby mode, press this button to continue turning left, and release it to return to the standby mode.At the Preset mode or the Time Settings mode, press this button to switch from minute to hour.

 Right Arrow
At the standby mode, press this button to continue turning right, and release it to return to the standby mode. At the Preset mode or the Time Settings mode, press this button to switch from hour to minute.





 Confirm button
During operation, press this button to stop the robot, and it is still working at the pause.In the preset or clock setting modes, this button can save all the settings

 Suction Settings button
At any cleaning mode, press this button to adjust the suction power.



 Clock Settings button
Press this button to enter the Clock Setting mode and press the OK button to exit.

 Single room cleaning button
Press the button to star cleaning a single room

 Floor mapping button
Press this button to map the floor

 Preset button
At the standby mode, press this button to enter the presetting mode, and the display  ashes icon. 
At the preset mode, press this button to save the data and exit the preset mode, and the display will always display the icon. 
At the preset mode, press the preset button for 3S to cancel the preset function, and the displayed icon will disappear. 

 Edge Cleaning button
Press this button to enter the Edge Cleaning mode.

  
3 buttons mentions above can adjust the suction power.

4.2 Operating Instructions

Placement of the Charging Base

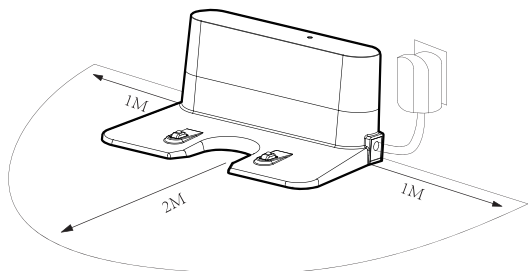

Place the seat flat against the wall. Do not place any objects within 2 meters to the left / right and 1 meter to the front, and do not place any mirrors or other reflective objects within this distance.

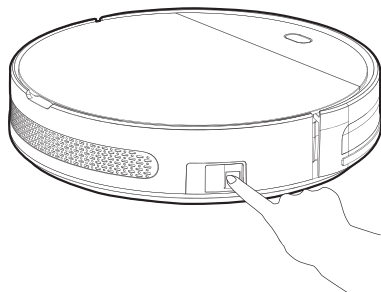

Switch on the robot, "I" means to turn on, "o" means to turn off which makes the Control button green, and enter the Select mode.
If the robot is not active within 5 minutes, the robot will enter Sleep mode.

Main body charging

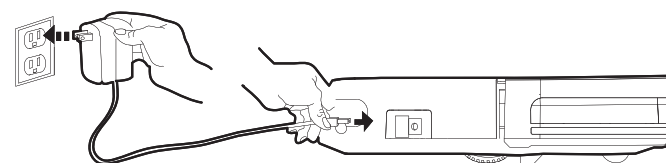

Make sure the power switch is turned on before charging the machine

Charging mode A

Plug the power adapter jack directly into the machine and the other end to the power supply to charge the machine.

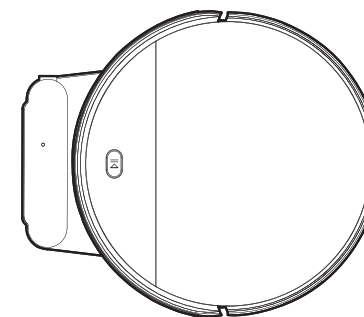

Make sure the power switch is turned on before charging the machine

Charging mode B

Place the main body in the charging base to charge the machine, making sure it inserts into the electrode slices. (The blinking green light indicates that the charging is in progress, and the charging is completed when it is on. ▶||)