

B890 LTE Wireless Gateway Quick Start

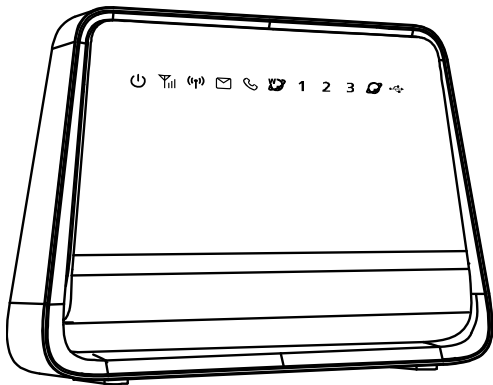

Note:

- Figures in this guide are only for your reference. For details about the particular model you have chosen, contact your service provider.
- Check the information about the product and its accessories when you purchase it. Some accessories are not provided in the product package. If necessary, contact your local dealer to purchase them.
- This guide briefly describes the device functions. For details about how to set the management parameters, see the help information on the web management page.

1 Getting to Know Your Device

Application Scenarios

Scenario 1:

With USIM card inserted and work properly in the device, you can connect your computer to the device to access the Internet, and connect your telephone to the device to answering or making a call.

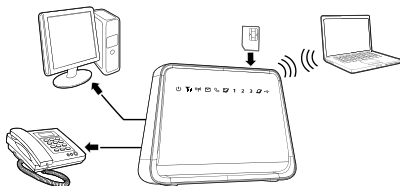

Scenario 2:

With connecting to the Ethernet, you can connect your computer to the device to access the Internet.

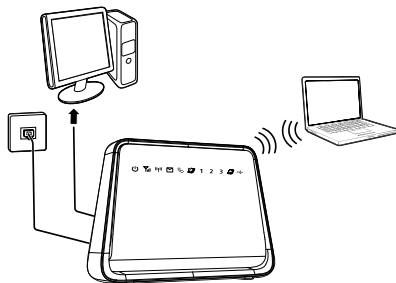

Scenario 3:

With connecting to the Ethernet and working with a USIM card, you can connect your computer to the device to access the Internet through Ethernet, and answering or making a call through the USIM card.

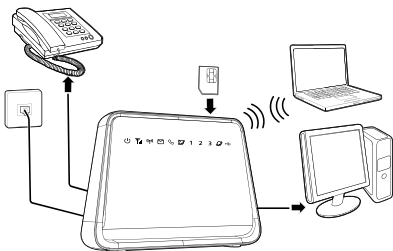



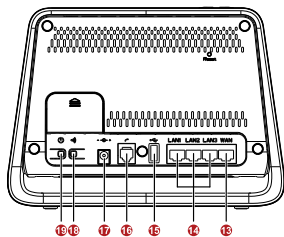
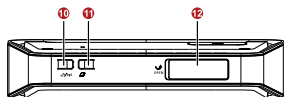
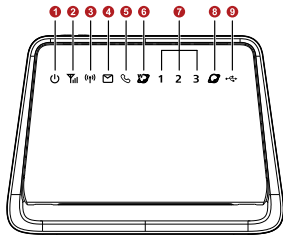





Appearance



1. Power indicator
2. Network status indicator
3. Wi-Fi/WPS indicator
4. SMS indicator
5. Telephone indicator
6. Wireless dialing indicator
7. LAN indicators
8. WAN indicator
9. USB indicator
10. Wi-Fi/WPS button

11. Dial-up button
12. SIM card slot
13. WAN port
14. LAN ports
15. USB port
16. Telephone port
17. Power port
18. Register button(not supported at this time)
19. Power button

Indicators

Indicator	Status
	<ul style="list-style-type: none"> Steady on: device powered on. Off: device powered off.
	<ul style="list-style-type: none"> Blinking red fast: Subscriber Identity Module (SIM) card unavailable (SIM card not installed or malfunctioning, or PIN code not verified). Steady yellow: device registered with the network. Steady green: device connected to the Internet. Off: no signal received.
	<ul style="list-style-type: none"> Steady on: Wi-Fi turned on or data transfer in progress. Blinking: WPS connection being set up. Off: Wi-Fi turned off.
	<ul style="list-style-type: none"> Steady on: The inbox is already full. Blinking: you have new SMS(s).
	<ul style="list-style-type: none"> Steady on: At least one handset registered. Fast blinking: Handset registration in progress. Slow blinking: Handset paging in progress. Off: No handsets registered.
	<ul style="list-style-type: none"> Steady on: Wireless dial-up successful. Blinking slowly: Wireless dial-up in progress. Blinking fast: Wireless dial-up failed.
	<ul style="list-style-type: none"> Steady on: network cable connected. Blinking: data transfer in progress. Off: network cable not connected.
	<ul style="list-style-type: none"> Steady on: Ethernet dial-up successful. Blinking slowly: Ethernet dial-up in progress. Blinking fast: Ethernet dial-up failed.
	<ul style="list-style-type: none"> Steady on: USB storage device connected. Off: USB storage device not connected.

2 Installation

Preparing Internet Connection

Your device not only support the mobile data network to access the Internet through USIM card, and also support connected to Ethernet to access to the Internet.

Method 1: Installing the USIM Card

- Step 1** Open and rotate the protective cover, to expose the SIM card slot.
- Step 2** Insert the USIM card into the card slot. Ensure that the beveled edge of the USIM card aligns with that of the card slot.
- Step 3** Rotate and close the protective cover.

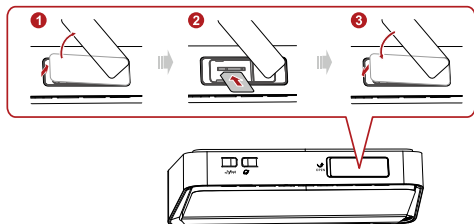

⚠Attention:

Before removing the SIM card, ensure that the device is powered off and disconnected from the power outlet.

Method 2: Connecting Ethernet cable

- Step 1** Use a Ethernet cable, insert one of the end into the WAN port of the device.
- Step 2** Insert another end of the cable into the Ethernet port of the wall.

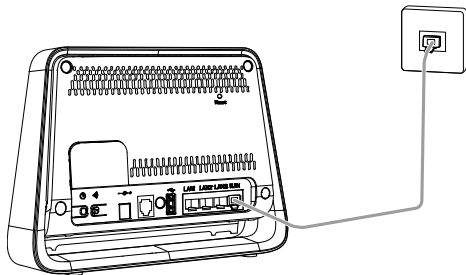

Connecting Cables

The following figure shows an example of how to connect the cables. In this example, the device is connected to a desktop computer, a laptop computer, and a telephone. If you do not insert the USIM card to the device, you will not be able to answer or make a call, you can skip to connect the telephone.

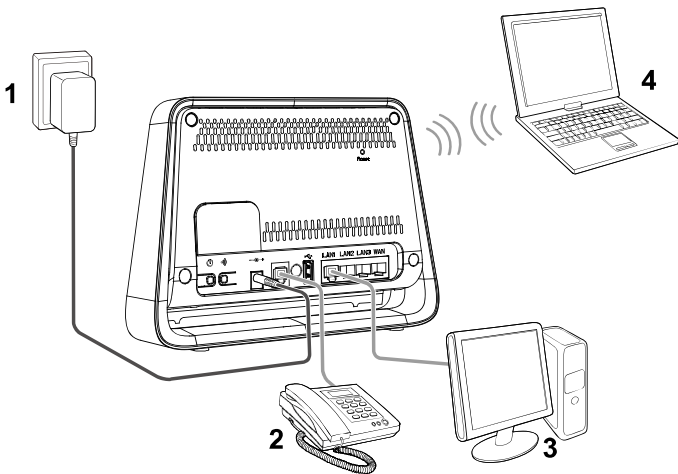

- | | |
|-------------------------|---------------------|
| 1. Power adapter | 3. Desktop computer |
| 2. Telephone (Optional) | 4. Laptop |

Note:

- Using an incompatible power adapter may damage the device..
- Radio signals can interfere with telephone call connection and quality. To eliminate the risk of possible interference, place the telephone at least 1 meter (3.28 feet) away from the device.
- Use an Ethernet cable that is not longer than 100 meters (328 feet), to connect a computer to one of the device's LAN ports.

(Optional) Installing an External Antenna

In areas with poor network coverage, connect an external antenna to the device's external antenna port. Screw the external antenna in fully, as shown in the following figure.

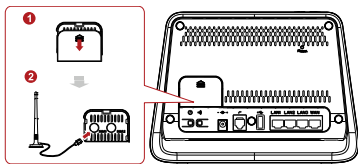

Note:

- Skip this section if you do not need to connect an external antenna to the device.
- Before using an external antenna, log in to the web management page (<http://192.168.1.1>) and set antenna mode to external. For details, see the help information on the web management page.
- Only use the external antenna indoors.
- You cannot switch between the internal antenna and the external antenna while using a voice or data service.

(Optional) Connecting to a USB device

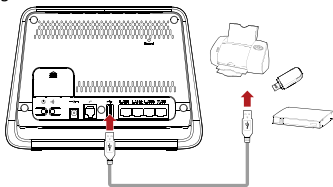

Connect a USB flash drive, portable hard disk drive, or USB printer to the device's USB port, as shown in the following figure. For details, see the help information on the web management page.



Note:

- Do not connect a computer to the device's USB port.
- The device's USB port can supply a maximum current of 500 mA to power connected USB devices. If the current required by a portable hard disk drive (or other peripherals) connected to the device is higher than 500 mA, the device may fail to recognize the hard disk drive. In this case, use an auxiliary power supply for the hard disk drive. For more information, contact your service provider.

3 Powering the Device On or Off

- After connecting to a power outlet, the device will power on automatically.
- To manually power the device on, press and hold  until all indicators turn on.
- To power the device off, press and hold  until all indicators turn off.

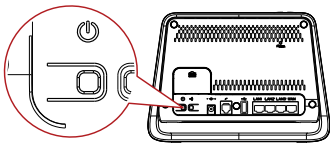

Note:





Keep your device stand placed when powered on, to avoid excessive heat to even damage the device. .

4 Setting Up a Wireless Connection

Note:

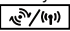
Before setting up a Wi-Fi connection, ensure that a wireless network adapter has been installed on your computer. If the wireless network adapter is functioning correctly, you will be able to find a wireless network connection in your computer's connection manager application.

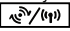
Turning the Device's Wi-Fi On

- By default, the device's Wi-Fi automatically turns on when the device is powered on.
- To manually turn Wi-Fi on, press and hold  until  turns steady on.
- To manually turn Wi-Fi off, press and hold  for 2 seconds, and then release your finger. The  indicator turns off.

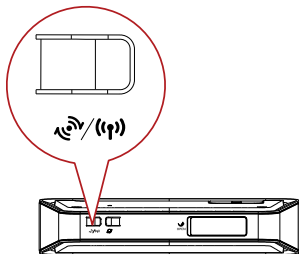

Setting Up a Wi-Fi Connection Manually

- Step 1** Ensure that  is steady on.
- Step 2** Scan for available wireless network connections using your computer's connection manager application.
- Step 3** Connect to the wireless network that has the same service set identification (SSID) as the device.



Note:

- If a security mechanism has been enabled for the wireless network connection, enter the correct network key.
- The SSID and the network key are printed on the device label.
- To protect your wireless network from unauthorized access, change the SSID and Wi-Fi key. For details, see the help information on the web management page.

Setting Up a Wi-Fi Connection through the WPS

If the client to which your device connects supports WPS, a network key is generated automatically.

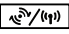



To set up a WPS connection:

- Step 1** Ensure that  is steady on.
- Step 2** Press and hold  until  blinks to activate the WPS connection on your device.
- Step 3** Activate the WPS connection on the client.

Note:



For details about the client's operations, see its user guide.

5 Accessing the Internet

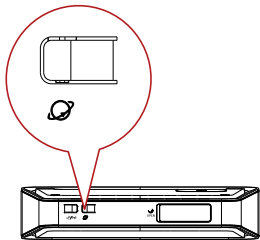
- If you want to switch wireless mode to wired mode, press and hold  until  steady on.
- If you want to switch wired mode to wireless mode, press and hold  until  steady on.



After a connection between your device and the client is set up, you can access the Internet using the modes listed in the following table.

Mode	Description
Auto	After being powered on, the device will automatically connect to the Internet. Once connected, the device will not automatically disconnect from the Internet.
Manual	<ul style="list-style-type: none">• Press , when  turns steady green, that indicates you are connected to the Internet.• Log in to the web management page, and then connect to or disconnect from the Internet as prompted.
On Demand	After being powered on, if there is data being transferred, the device will automatically connect to the Internet. If no data is transferred within a pre-defined period, the device will automatically disconnect from the Internet.

Note:

Select an appropriate mode according to your data service charging plan. For example, if you are charged according to the length of time you are connected to the Internet, it is recommended that you select manual mode. For details about your data service charging plan, contact your service provider.

6 Logging in to the management page

You can configure and manage the device settings using the web management page.

1. Launch a web browser, and enter **http://192.168.1.1** in the address bar.
2. Enter the password, and log in to the web management page. The default password is printed on the device label.

Note:

- To protect your device, only one user can log in to the web management page at a time.
- To protect your account, change the password promptly. For details, see the help information on the web management page.

7 Restoring Factory Defaults

If you are uncertain of which settings you have configured or changed, you can restore the factory defaults that the device came with, and then reconfigure the device.

To restore the factory defaults, Use a sharp-pointed object to press and hold the RESET button until the signal indicators on the bottom blink.

After the factory defaults are restored, the device will restart automatically.

Note: Restoring factory defaults will delete all the device's user-defined settings and restore all settings on the web management page to their defaults.

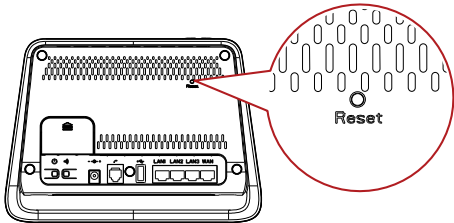

8 Further Tips

If the device does not work properly:

- See the help information on the web management page.
- Restart the device.
- Restore the device to its factory defaults.
- Contact your service provider.

Copyright © Huawei Technologies Co., Ltd. 2012. All rights reserved.

THIS DOCUMENT IS FOR INFORMATION PURPOSES ONLY, AND DOES NOT CONSTITUTE ANY KIND OF WARRANTIES.

Please visit www.huaweidevice.com/worldwide/support/hotline for recently updated hotline and email address in your country or region.

Version: V100R001_01 Part Number: 9672XXXX