

1 Parts List

The following images are for reference only. Actual components may differ in appearance. The cables delivered with a Box may be used only with that Box. If a component is damaged, missing, or wet upon being removed from the box, contact your local supplier.

 HUAWEI Box 500	 HDMI cables (x 2)	 HD-VI cable
 Power cable	 Screws (x 4), Mounting ears (x 2)	 Cable clips
 HUAWEI Touch power adapter	 HD-VI to DVI/Serial cable	 Cable ties
 Network cable	 Quick Installation Guide	 Qualification Card, Safety Precautions, and Warranty Card

HUAWEI Touch box

Includes:

- Tablet (x 1)
- Network cable (x 1)
- Type-C cable (x 1)
- HUAWEI Touch Quick Start Guide (x 1)
- Qualification Card, Safety Precautions, and Warranty Card (x 1)

2 Installing the Box

⚠ The voltage inside the Box is high. Do not disassemble it without the guidance of a professional engineer.

Installation on a Flat Surface

Place the Box on a table or other flat surface and connect the cables.
⚠ Do not stack objects above or under the Box or block the heat dissipation holes on the left or right.

Installation Inside a Cabinet

The cabinet in which the Box will be placed must be a 19-inch cabinet compliant with IEC 60297, such as the HUAWEI N68E-22 cabinet.
⚠ Reserve at least 1 U (44.45 mm) above and under the Box and 5 cm on its left and right for heat dissipation.

- Use a Phillips screwdriver to attach the mounting ears to the sides of the Box.
🔍 The Phillips screwdriver does not come with the Box.

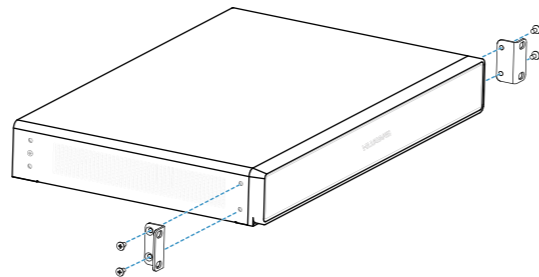

- Slide the Box into the cabinet and insert screws through the mounting ears to hold the Box in place.
🔍 Do not install guide rails for the cabinet. The screws do not come with the Box.

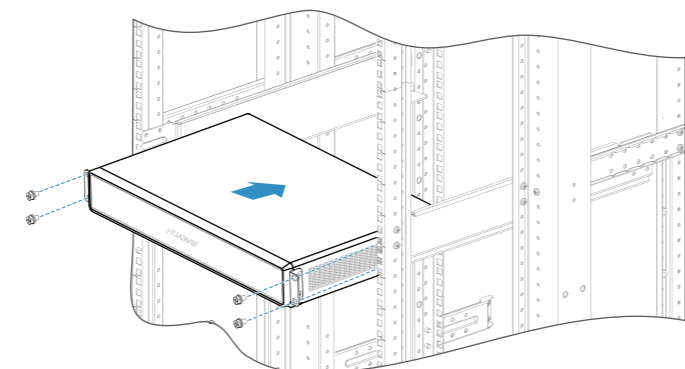

3 Connecting Cables

🔍 See the detailed description of the Box 500's ports under **Product Structure > Front Panel and Rear Panel** in the *HUAWEI Box 500 V600R019C00 Product Description*. To obtain the document, scan the Product Description QR code on the back cover. A device connected to the Box through the HD-VI or HD-BaseT port can be powered through this port. If both ports are in use, only one port (default: HD-VI port) can supply power for the connected device. The default port for power supply can be changed on the Box's web interface.

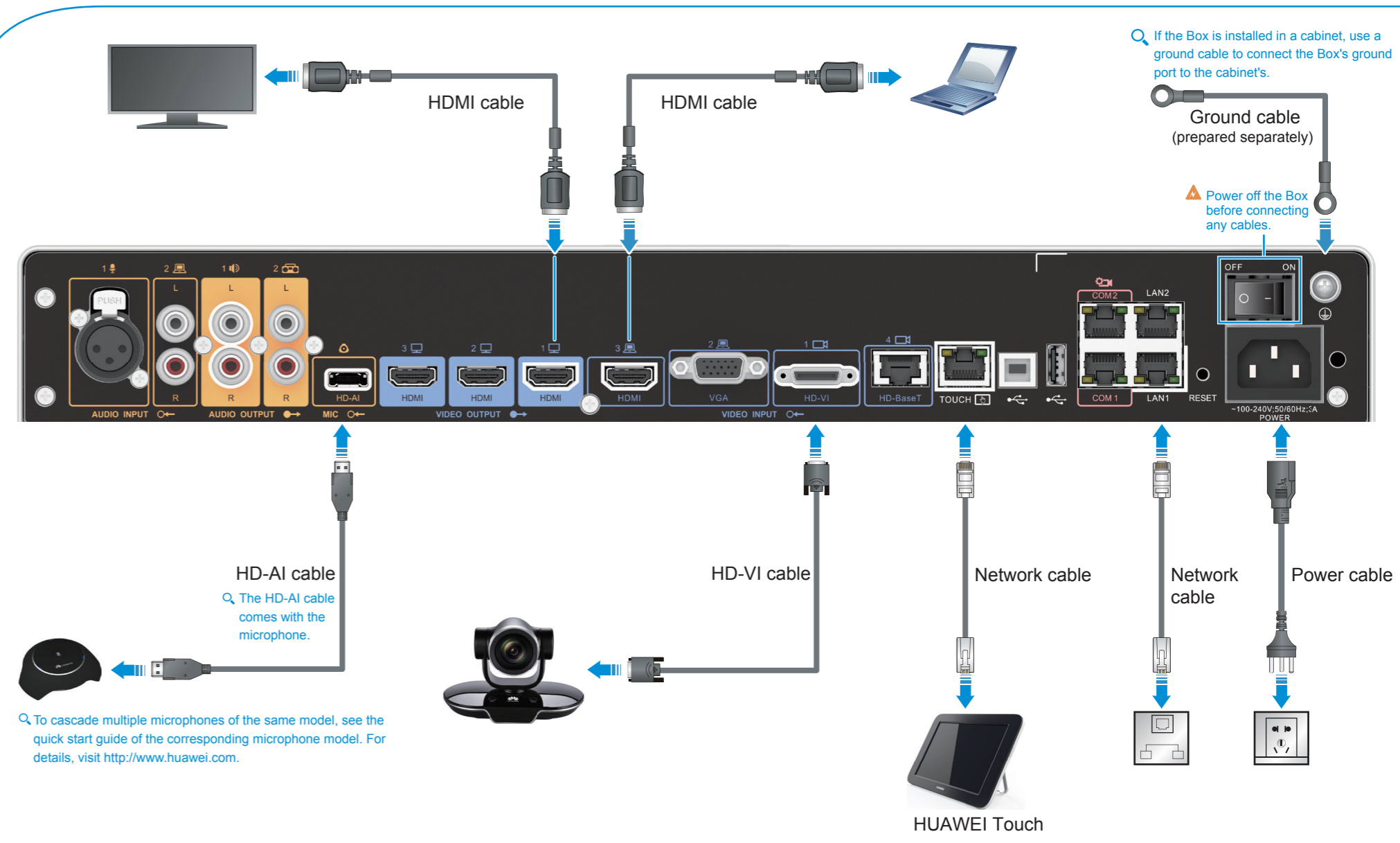

4 Powering On the Box

5 Configuring the Box

Scan the QR Codes

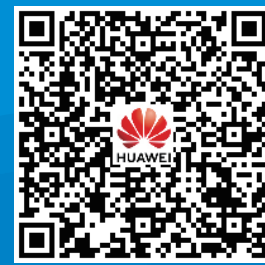
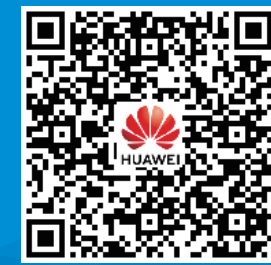
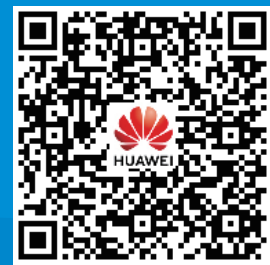

Product Description

Configuration Guide

Information Center

Connect the Box to a power supply and power it on.



The following figure shows where the status indicator of the Box is located.



If the Indicator Is...	The Box Is...
Off	Powered off.
Blinking green twice per second	Powering on.
Blinking green four times per second	Upgrading.
Steady green	Working properly.
Blinking green (on for 1s, off for 2s)	On standby.
Blinking red once every 5s	Faulty (hardware).
Blinking red four times per second	Faulty (software).
Blinking red once every 2.5s	Overheated.

If the status indicator is abnormal, contact your local supplier.

After the Box installation is complete, connect the Touch to the Box and use the System Configuration Wizard to set up the Box. For more information on how to use the wizard, see the "Setting Parameters on the Touch" section in the [HUAWEI Box 500, Box 700, and Box 900 V600R019C00 Configuration Guide](#). To obtain the document, scan the Configuration Guide QR code on the back cover.

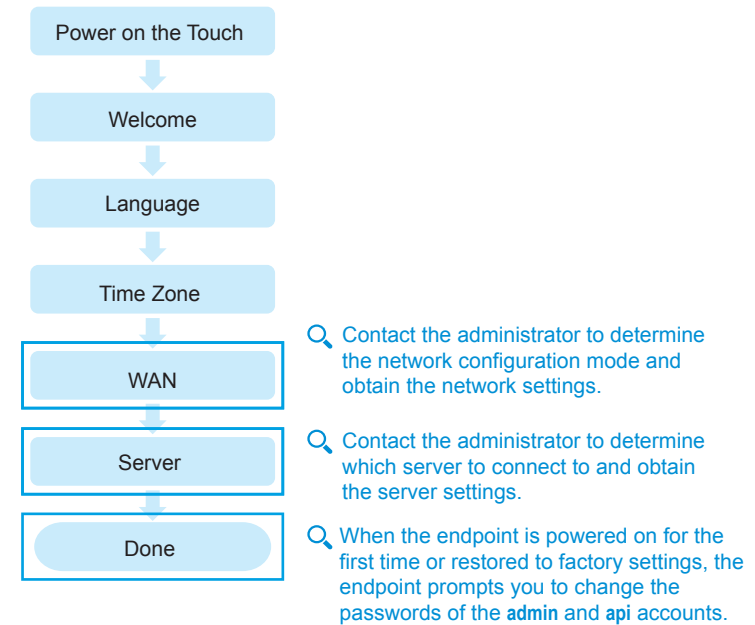

For more help, search for **Box 500 V600R019C00** at <http://www.huawei.com>. Contact Huawei technical support for further assistance.



OPEN SOURCE SOFTWARE NOTICE

For further details, log in to the Box's web interface and find online help at [?](#) > [?](#).