



# **HUAWEI C6005**

---

**CDMA 1X Mobile Phone**

**USER GUIDE**

Please refer color and shape to product.

Huawei reserves the right to make changes or improvements to any of the products without prior notice.

---

## **Huawei Technologies Co., Ltd.**

**Address:** Huawei Industrial Base, Bantian, Longgang, Shenzhen 518129, People's Republic of China

**Tel:** +86-755-28780808 **Global Hotline:** +86-755-28560808

**E-mail:** [mobile@huawei.com](mailto:mobile@huawei.com) **Website:** [www.huawei.com](http://www.huawei.com)

**Copyright © Huawei Technologies Co., Ltd. 2011. All rights reserved.**

No part of this document may be reproduced or transmitted in any form or by any means without prior written consent of Huawei Technologies Co., Ltd.

The product described in this manual may include copyrighted software of Huawei Technologies Co., Ltd and possible licensors. Customers shall not in any manner reproduce, distribute, modify, decompile, disassemble, decrypt, extract, reverse engineer, lease, assign, or sublicense the said software, unless such restrictions are prohibited by applicable laws or such actions are approved by respective copyright holders under licenses.

## **Trademarks and Permissions**



, HUAWEI, and  are trademarks or registered trademarks of Huawei Technologies Co., Ltd.

Other trademarks, product, service and company names mentioned are the property of their respective owners.

## **Notice**

Some features of the product and its accessories described herein rely on the software installed, capacities and settings of local network, and may not be activated or may be limited by local network operators or network service providers, thus the descriptions herein may not exactly match the product or its accessories you purchase.

Huawei Technologies Co., Ltd reserves the right to change or modify any information or specifications contained in this manual without prior notice or obligation.

## **NO WARRANTY**

THE CONTENTS OF THIS MANUAL ARE PROVIDED "AS IS". EXCEPT AS REQUIRED BY APPLICABLE LAWS, NO WARRANTIES OF ANY KIND, EITHER EXPRESS OR IMPLIED, INCLUDING BUT NOT LIMITED TO, THE IMPLIED WARRANTIES OF MERCHANTABILITY AND FITNESS FOR A PARTICULAR PURPOSE, ARE MADE IN RELATION TO THE ACCURACY, RELIABILITY OR CONTENTS OF THIS MANUAL.

TO THE MAXIMUM EXTENT PERMITTED BY APPLICABLE LAW, IN NO CASE SHALL HUAWEI TECHNOLOGIES CO., LTD BE LIABLE FOR ANY SPECIAL, INCIDENTAL, INDIRECT, OR CONSEQUENTIAL DAMAGES, OR LOST PROFITS, BUSINESS, REVENUE, DATA, GOODWILL OR ANTICIPATED SAVINGS.

## **Import and Export Regulations**

Customers shall comply with all applicable export or import laws and regulations and will obtain all necessary governmental permits and licenses in order to export, re-export or import the product mentioned in this manual including the software and technical data therein.

# Contents

1	Installing the UIM Card,microSD Card and the Battery ...	1
2	Charging the Battery .....	2
3	Getting to Know Your Phone.....	2
4	Keys and Functions .....	3
5	Screen Icons .....	6
6	Using the Shortcut Menus on the Standby Screen .....	7
7	Call Function.....	8
	Making a Call.....	8
	Answering a Call .....	9
8	Creating and Sending a Text Message.....	9
9	Security .....	9
	Locking the Keypad.....	9
	Enabling the Phone Lock.....	9
	PIN and PUK.....	10
10	Text input.....	10
	Entering English Letters (in Abc Mode).....	10
	Entering an English Word (in En Mode) .....	11
	Entering Indonesian (in In Mode) .....	11
	Entering a Number.....	11
	Entering a Symbol .....	12
11	Enabling the Power-Saving Mode .....	12
12	Alarms .....	12
	Enabling an Alarm .....	12
	Disabling One or All Alarms.....	12
13	Music Player.....	13
	Setting the Playlist.....	13
	Playing Music .....	13

<b>14 Radio.....</b>	<b>14</b>
<b>Switching On/Off the Radio .....</b>	<b>14</b>
<b>Automatic Tuning.....</b>	<b>14</b>
<b>Manual Tuning.....</b>	<b>14</b>
<b>Listening to a Radio Program.....</b>	<b>14</b>
<b>Recording a Radio Program .....</b>	<b>15</b>
<b>15 Recording an Audio Clip.....</b>	<b>15</b>
<b>16 CD-ROM Provided with Your Phone .....</b>	<b>15</b>
<b>17 Dial-Up Network Access .....</b>	<b>16</b>
<b>18 Warnings and Precautions .....</b>	<b>17</b>

# 1 Installing the UIM Card, microSD Card and the Battery

Contact your network operator to check whether a User Identity Module (UIM) card is required for the phone.

When installing the UIM card, ensure that the gold contact area on the UIM card is facing downward and that the beveled edge of the UIM card is properly aligned with that of the UIM card slot.

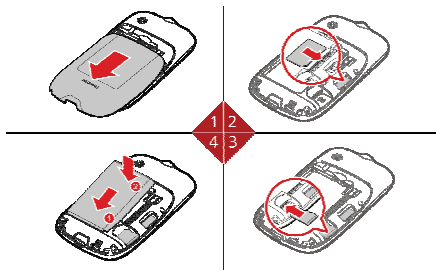

## 2 Charging the Battery

1. Connect the charger to the charger connector of the phone.
2. Connect the charger to a power socket. Charging starts and the charging icon is displayed in animation.
3. When the charging icon animation stops, indicating that the charging is complete, disconnect the charger from the phone.



## 3 Getting to Know Your Phone

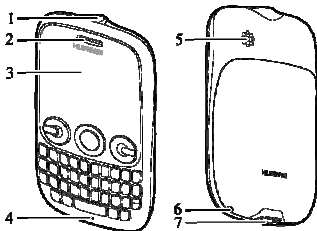



1. Headset jack
2. Earpiece
3. Screen
4. Microphone
5. Speaker
6. Strap hole
7. Charger connector



Note

*The preceding figure is provided for your reference only.*

## 4 Keys and Functions

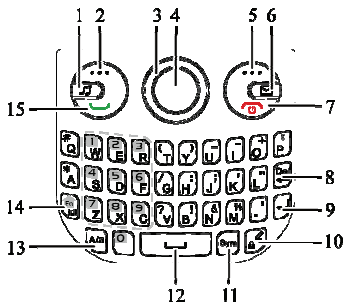





1	Music key	Access <b>Music Player</b> in standby mode.
2	Left soft key	<ul style="list-style-type: none"> <li>• Access the main menu in standby mode.</li> <li>• Select the option displayed in the lower left corner of the screen (directly above the key).</li> </ul>
3	Navigation keys	<p>In standby mode,</p> <ul style="list-style-type: none"> <li>• Up navigation key: access <b>Profiles</b>.</li> <li>• Down navigation key: access <b>Create Message</b>.</li> <li>• Left navigation key or Right navigation key: select the shortcuts.</li> </ul> <p>During a call,</p> <ul style="list-style-type: none"> <li>• Up navigation key or Right navigation key: increase the volume.</li> <li>• Left navigation key or Down navigation key: decrease the volume.</li> </ul>
4	Confirm key	Confirm a selection or display a menu.

5	Right soft key	<ul style="list-style-type: none"> <li>• Return to the previous menu or exit the function menu from a menu screen.</li> <li>• Select the option displayed in the lower right corner of the screen (directly above the key).</li> </ul>
6	Message key	Access <b>Messages</b> in standby mode.
7	End key	<ul style="list-style-type: none"> <li>• Power on or off the phone (press and hold the key).</li> <li>• End or reject a call.</li> </ul>
8	Del key	Delete a character in editing mode or delete a selected item in an application.
9	Enter key	In text input mode, press this key to enter a linefeed character.
10	Zi key	<ul style="list-style-type: none"> <li>• In text input mode, press this key to switch between text input modes.</li> <li>• In standby mode, press and hold this key to lock the keypad.</li> </ul>
11	Sym key	In text input mode, press this key to display the symbol list.
12	Space key	In text input mode, press this key to enter a space.

- |    |          |  |
|----|----------|--|
| 13 | A/a key  | <p>In text input mode:</p> <ul style="list-style-type: none"> <li>• Press this key to switch between "abc" mode (lower case), "Abc" mode (capitalization of the first letter).</li> <li>• Press and hold this key to switch "ABC" mode (upper case).</li> </ul>                            |
| 14 | Fn key   | <ul style="list-style-type: none"> <li>• In text input mode, press this key and later press another key to enter the upper character on the other key.</li> <li>• In text input mode, press and hold this key, and then press other keys to enter upper characters on the keys.</li> </ul> |
| 15 | Call key | <ul style="list-style-type: none"> <li>• View the call log in standby mode.</li> <li>• Make a call or answer an incoming call.</li> </ul>  |

## 5 Screen Icons

Icon	Indicates...	Icon	Indicates...
	Signal strength.		Battery power level.
	No signal.		Code division multiple access (CDMA) 1X network available.



Domestic roaming.



Call in progress.



New message received.



Emergency message received.



**General** profile activated.



**Meeting** profile activated.



**My Profile 1** profile activated.



The microSD card installed.



Alarm on.



International roaming.



Keypad locked.



Memory full.



Voicemail message received.



**Silence** profile activated.



**Outdoor** profile activated.



**My Profile 2** profile activated.



Headset connected.



The hands free function.

## 6 Using the Shortcut Menus on the Standby Screen

- In standby mode, press the Left soft key or the Right soft key to select the desired shortcut, and then press Confirm key to access the menu.
- To change or reorganize the shortcut menus on the standby screen, select **Menu > Settings > Display Settings > Shortcut**.



Note

- *You can set a maximum of 10 shortcuts.*

- To sort the shortcuts, do the following: Access the **Sort** screen. Press the Up navigation key or the Down navigation key to scroll to a shortcut, and press the Confirm key to select the shortcut. Then press the Up navigation key or the Down navigation key move the selected shortcut to a desired position, and select **OK** to confirm.

## 7 Call Function



### Note

*You can only dial emergency numbers and answer incoming calls when the keypad is locked. Unlock the keypad to make calls.*

### Making a Call

1. In standby mode, press the Number keys to enter a phone number.
  - To make an international call, press the \* key twice to enter a plus sign (+), and then enter the country or region code, area code, and phone number in sequence.
  - To dial an extension number, enter the phone number, press the \* key three times to enter P or four times to enter T, and then enter the extension number.
2. Press the Call key to dial the number.
3. Press the End key to end the call or cancel the dialing.



### Note

- *In standby mode, you can press the Call key to access the call log, select a desired number, and then press the Call key again to dial the number.*
- *In **Contacts**, select a desired number, and then press the Call key to dial the number.*

- *In **Inbox of Messages**, select a desired message, and then press the **Call** key to call the message sender.*

## Answering a Call

When there is an incoming call, press the **Call** key to answer the call or the **End** key to reject the call. If the any key answer function is enabled, press any key except the **Right soft** key and the **End** key to answer the call.

## 8 Creating and Sending a Text Message

1. In standby mode, select **Menu > Messages > Create Message**.
2. Write the message, and then select **Options > Send**.
3. Edit the list of message recipients.
4. Press the **Confirm** key to send the message.

## 9 Security

### Locking the Keypad

To prevent unintentional operations, you can press and hold the **Zi** key in standby mode to lock the keypad. When the keypad is locked, you can press the **Call** key to answer an incoming call and make an emergency call.

To unlock the keypad, press the **Left soft** key and then the **Right soft** key.

### Enabling the Phone Lock

The phone lock protects your phone from unauthorized use. By default, the phone lock is disabled.

Select **Menu > Settings > Security Settings > Phone Lock** to enable the phone lock with the following options:

- **Immediate:** to enable the phone lock immediately.
- **Power On:** to enable the phone lock when the phone is powered on next time.

When you enable the phone lock, you are prompted to enter the phone lock code. The default phone lock code is 0000. You can change the code to any string of 1 to 8 digits.

## PIN and PUK

Contact your network operator as to whether a User Identity Module (UIM) card is required for your phone.

The personal identification number (PIN) protects your UIM card from unauthorized use. The PIN Unlock Key (PUK) is used to unlock a blocked PIN.

If you enter wrong PINs three times consecutively, the phone prompts you to enter the PUK. If you enter wrong PUKs 10 times consecutively, the UIM card becomes permanently invalidated. In this case, contact your network operator for a replacement.

The PIN and the PUK are provided with your UIM card. For details, contact your network operator.

## 10 Text input

In editing mode, press the Zi key to switch between text input modes.



Note

*Press the Del key once to delete the character on the left of the cursor. Alternatively, press and hold the Del key to clear all characters at a time.*

### Entering English Letters (in Abc Mode)

The alphabetical text input mode allows you to enter uppercase or lowercase English letters.



When you enter letters, press the A/a key to switch between uppercase and lowercase of the highlighted letter.

## Entering an English Word (in En Mode)

You can enter English letters as follows:

1. Based on the sequence of the word, press the key labeled with the desired letter once. Then the phone displays the commonly used words according to the numeric sequence of key presses.
2. Press the Up navigation key or the Down navigation key to scroll to the desired word.
3. Press the Left navigation key, Right navigation key or Confirm key to confirm the selection.

You can also press the Space key to confirm the selection followed by a space.

## Entering Indonesian (in In Mode)

You can enter Indonesian words in Indonesian text input mode.

The traditional Indonesian input mode and the smart Indonesian input mode are similar to the traditional English input mode and the smart English input mode. For details, see “Entering an English Word (in En Mode)”.

## Entering a Number

- In **123** mode, press the number key labeled with the desired digit.
- In **Abc**, **En** and **In** mode, press Fn key and then the key labeled with the numbers.



Tip

*In **Abc**, **En**, **In** mode, you also can press and hold the number key labeled with the desired number until the number appears on the screen.*

## Entering a Symbol

In any input mode, you can enter a symbol as follows:

1. Press the Sym key to display the symbol list.
2. Press the Navigation keys to scroll to the desired symbol.
3. Press the Confirm key to enter the symbol.

## 11 Enabling the Power-Saving Mode

- In standby mode, if the screen backlight is on and if the keypad is unlocked, press the End key to turn off the screen backlight.
- If the screen backlight is off and if the keypad is locked, you can press the Left soft key or the End key to turn on the screen backlight.
- In standby mode, select **Menu > Settings > Phone Settings > Power-saving mode > On** to enable the power-saving mode, in which the keypad backlight is off from 09:00 to 17:00.

## 12 Alarms

You can set a maximum of 5 alarms. To set an alarm, on the main menu screen, select **Alarms** to access the **Alarms** screen.

### Enabling an Alarm

1. On the **Alarms** screen, select an alarm, and then set the alarm title, alarm time, repeat days, and alarm tone.
2. Save the settings to enable the alarm.

### Disabling One or All Alarms

On the **Alarms** screen, select an alarm and then select **Off** to disable the alarm or select **Cancel All** to disable all alarms.



## Note

- *When an alarm rings, select **Stop** to stop the alarm. If you select **Snooze**, the alarm will stop temporarily, and then ring again after 5 minutes.*
- *You can customize the days for repeating an alarm. You can browse the seven days in a week, and then select the days that you want the alarm to ring.*

# 13 Music Player

## Setting the Playlist

1. On the main menu screen, select **Multimedia > Music Player**.
2. Select **Options > Music Library**, and then select **Options > Refresh** to refresh all the songs in your phone.
3. Press the Left navigation key or the Right navigation key to access the **Playlist** screen. Then select **Options > Add New Playlist**, enter the name of the playlist and save the playlist.
4. Open a playlist, and select **Options > Add From My Files** to add songs to the playlist.

## Playing Music

On the **Music Player** screen:

- Press the Confirm key to start or pause playing music.
- Press the Right navigation key to play the next song. Press and hold this key to fast-forward the current song.
- Press the Left navigation key to play the previous song. Press and hold this key to rewind the current song.
- Press the Up navigation key to increase volume.
- Press the Down navigation key to decrease volume.

- Select **Minimize** to minimize the music player. The phone play music background and display the current music name in standby mode.
- Select **Options > Off** to stop playing music and exit the music player.

## 14 Radio



### Note

*To use the radio, connect the headset to the headset jack of the phone first.*

### Switching On/Off the Radio

- on the main menu screen, select **Multimedia> Radio** to switch on the radio.
- On the radio screen, select **Options > Switch off** to switch off the radio.

### Automatic Tuning

1. On the radio screen, select **Options > Tuning**.
2. Use the Navigation keys to select **Auto Tuning**. The phone performs automatic tuning, and then saves the channels found to the channel list.

### Manual Tuning

1. On the radio screen, select **Options > Tuning**.
2. Use the Navigation keys to select **Manual Tuning**.
3. Use the Left navigation key or the Right navigation key to perform manual tuning.

### Listening to a Radio Program

When listening to a radio program, you can perform the following operations:

- Press the Up navigation key or the Down navigation key to adjust the volume.
- Press the Left navigation key or the Right navigation key to switch between channels.
- Press the Confirm key to open or close the speaker.
- Select **Hide** to play the program background and display the current frequency in standby mode.

## Recording a Radio Program



Note

*Before recording a radio program, ensure that the channel has been saved in the channel list.*

To record the program being played on a saved channel, select **Options > Start Record** when you listen to the program.

All recorded files are stored in **My Files > Musics > recorder**.

## 15 Recording an Audio Clip

1. In standby mode, select **Menu > Multimedia > Recorder**.
2. Press the Confirm key to start or pause recording.
3. Press the Left soft key to stop recording.
4. Press the Confirm key to play the recorded audio clip.

All recorded audio clips are stored in **Menu > My Files > Musics > recorder**.

## 16 CD-ROM Provided with Your Phone

The CD-ROM provided with your phone contains the following software:

- Device Driver: driver of the phone compatible with a 64-bit system.

- **PC Suite:** PC assistant software that contains the driver of the phone compatible with a 32-bit system. Through this software, you can perform operations, such as contact management, file management on the phone, and sending and receiving of text messages. For details, see the Help information about the PC Suite.

## 17 Dial-Up Network Access

After you connect your phone to a PC, the phone can function as a high-speed modem. To set up a dial-up connection and access the network, do as follows:

1. Make sure that your UIM card supports the function of accessing the Internet and your phone is powered on and in service area.
2. Connect your phone to your PC with a USB cable.
3. Install the PC Suite stored on the CD-ROM that is provided with your phone on the PC. If there is no CD-ROM with your phone, you can visit the website <http://www.huaweidevice.com/worldwide/> to download the PC Suite software. During the installation, the driver files for the phone are installed automatically.
4. In the computer Management window of the PC, click **Device Manager**. Ensure that your phone is listed under modems.
5. On the PC, choose **Start > Control Panel > Network and Internet Connections**. Click **Create a connection to the network at your workplace**. Then create a connection by using the New Connection Wizard. For the phone number and the user name, contact your network operator.
6. Access the network by using the dial-up connection. If the data service icon appears on the phone screen and  appears in the notification area of the PC, it indicates that

**Note**

- Now, the dial-up access function is compatible with the Windows 2000/ XP/ Vista(32) operating systems.
- If you encounter any problem when connecting your phone to your PC, visit the website <http://www.huaweidevice.com/worldwide/> to download and install the driver of the full file version, or contact with the network operator or local dealer.

## 18 Warnings and Precautions

This section contains important information pertaining to the operating instructions of your device. It also contains information about how to use the device safely. Read this information carefully before using your device.

### Electronic Device

Power off your device if using the device is prohibited. Do not use the device when using the device causes danger or interference with electronic devices.

### Medical Device

- Follow rules and regulations set forth by hospitals and health care facilities. Do not use your device when using the device is prohibited.
- Pacemaker manufacturers recommend that a minimum distance of 15 cm be maintained between a device and a pacemaker to prevent potential interference with the pacemaker. If you are using a pacemaker, use the device on the opposite side of the pacemaker and do not carry the device in your front pocket.

### Potentially Explosive Atmosphere

Power off your device in any area with a potentially explosive atmosphere, and comply with all signs and instructions. Areas that may have potentially explosive atmospheres include the areas where you would normally be advised to turn off your vehicle engine. Triggering of sparks in such areas could cause an explosion or a fire, resulting in bodily injuries or even deaths. Do not power on your device at refueling points such as service stations. Comply with restrictions on the use of radio equipment in fuel depots, storage, and distribution areas, and chemical plants. In addition, adhere to restrictions in areas where blasting operations are in progress. Before using the device, watch out for areas that have potentially explosive atmospheres that are often, but not always, clearly marked. Such locations include areas below the deck on boats, chemical transfer or storage facilities, and areas where the air contains chemicals or particles such as grain, dust, or metal powders. Ask the manufacturers of vehicles using liquefied petroleum gas (such as propane or butane) whether this device can be safely used in their vicinity.

### **Traffic Security**

Observe local laws and regulations while using the device. In addition, if using the device while driving a vehicle, comply with the following guidelines:

- Concentrate on driving. Your first responsibility is to drive safely.
- Do not talk on the device while driving. Use hands-free accessories.
- When you have to make or answer a call, park the vehicle on the road side before using your device.
- Radio frequency (RF) signals may affect electronic systems of motor vehicles. For more information, consult the vehicle manufacturer.



- In a motor vehicle, do not place the device over the air bag or in the air bag deployment area. Otherwise, the device may hurt you owing to the strong force when the air bag inflates.
- Do not use your device while flying in an aircraft. Power off your device before boarding the aircraft. Using wireless devices in the aircraft may cause danger to the operation of the aircraft and disrupt the wireless telephone network. It may also be considered illegal.

### **Operating Environment**

- Do not use or charge the device in dusty, damp, and dirty places or places with magnetic fields. Otherwise, a malfunction of the circuit may be caused.
- The device complies with the RF specifications when the device is used near your ear or at a distance of 1.5 cm from your body. Ensure that the device accessories such as a device case and a device holster are not composed of metal components. Keep your device 1.5 cm away from your body to meet the requirement earlier mentioned.
- On a stormy day with thunder, do not use your device when it is being charged, to prevent any danger caused by lightning.
- When you are on a call, do not touch the antenna. Touching the antenna affects the call quality and results in increase in power consumption. As a result, the talk time and the standby time are reduced.
- While using the device, observe the local laws and regulations, and respect others' privacy and legal rights.
- Keep the ambient temperature between 0°C and 40°C while the device is being charged. Keep the ambient temperature between 0°C to 40°C while the device powered by a battery is being used.

### **Prevention of Hearing Damage**

Using a headset at high volume can damage your hearing. To reduce the risk of damage to hearing, lower the headset volume to a safe and comfortable level.

### **Safety of Children**

Comply with all precautions with regard to children's safety. Letting children play with your device or its accessories, which may include parts that can be detached from the device, may be dangerous, as it may present a choking hazard. Ensure that small children are kept away from the device and its accessories.

### **Accessories**

Use the accessories delivered only by the manufacturer. Using accessories of other manufacturers or vendors with this device model may invalidate any approval or warranty applicable to the device, result in the non-operation of the device, and cause danger.

### **Battery and Charger**

- Unplug the charger from the socket and the device when the device is not in use.
- The battery can be charged and discharged hundreds of times before it eventually wears out. When the standby time and the talk time are shorter than the normal time, replace the battery.
- Use the alternating current (AC) power supply defined in the specifications of the charger. An improper power voltage may cause a fire or a malfunction of the charger.
- Do not connect two poles of the battery with conductors, such as metal materials, keys, or any jewellery. Otherwise, the battery may get short-circuited and may cause injuries and burns on your body.
- Do not disassemble the battery or solder the battery poles. Otherwise, an electrolyte leakage, an overheating, a fire, or an explosion may be caused.

- If battery electrolyte leaks out, ensure that the electrolyte does not touch your skin and eyes. When the electrolyte touches your skin or splashes into your eyes, wash your skin or eyes with clean water immediately and consult a doctor.
- If there is a case of battery deformation, color change, or abnormal heating while you charge or store the battery, remove the battery immediately and stop using it. Otherwise, a battery leakage, an overheating, an explosion, or a fire may be caused.
- If the power cable is damaged (for example, the cord is exposed or broken), or the plug loosens, stop using the cable at once. Otherwise, an electric shock, a short circuit of the charger, or a fire may be caused.
- Do not dispose of batteries in fire as they may explode. Batteries may also explode if damaged.
- Danger of explosion if battery is incorrectly replaced. Recycle or dispose of used batteries according to the local regulations or reference instruction supplied with your device.

## **Cleaning and Maintenance**

- The device, battery, and charger are not water-resistant. Keep them dry and protect them from water and vapor. Do not touch the device or the charger with a wet hand. Otherwise, a short circuit, a malfunction of the device, and an electric shock to the user may be caused.
- Do not place your device, battery, and charger in places where they can get damaged because of collision. Otherwise, a battery leakage, a device malfunction, an overheating, a fire, or an explosion may be caused.
- Do not place magnetic storage media such as magnetic cards and floppy disks near the device. Radiation from the device may erase the information stored on them.

- Do not leave your device, battery, and charger in a place with an extremely high or low temperature. Otherwise, they may not function properly and may lead to a fire or an explosion. When the temperature is lower than 0°C, performance of the battery is affected.
- Do not place sharp metal objects such as pins near the earpiece. The earpiece may attract these objects and hurt you when you are using the device.
- Before you clean or maintain the device, power off the device and disconnect it from the charger.
- Do not use any chemical detergent, powder, or other agents (such as alcohol and benzene) to clean the device and the charger. Otherwise, parts of the device may get damaged or a fire can be caused. You can clean the device and the charger with a piece of damp and soft antistatic cloth.
- Do not dismantle the device or accessories. Otherwise, the warranty on the device and its accessories is rendered invalid and the manufacturer is not liable to pay for the damage.

## **Emergency Call**

You can use your device for emergency calls in the service area. The connection, however, cannot be guaranteed in all conditions. You should not rely solely on the device for essential communications.

## **Certification Information (SAR)**

This device meets guidelines for exposure to radio waves.

Your device is a low-power radio transmitter and receiver. As recommended by international guidelines, the device is designed not to exceed the limits for exposure to radio waves. These guidelines were developed by the independent scientific organization International Commission on Non-Ionizing Radiation Protection (ICNIRP) and include safety measures

designed to ensure safety for all users, regardless of age and health.

The Specific Absorption Rate (SAR) is the unit of measurement for the amount of radio frequency energy absorbed by the body when a device is being used. The SAR value is determined at the highest certified power level in laboratory conditions, but the actual SAR level of the device when the device is being operated can be well below the value. This is because the device is designed to use the minimum power required to reach the network.

The SAR limit adopted by USA and Canada is 1.6 watts/kilogram (W/kg) averaged over one gram of tissue. The highest SAR value reported to the Federal Communications Commission (FCC) and the Industry Canada (IC) for this device type when the device is tested for use at the ear is 1.08 W/kg, and that when the device is properly worn on the body is 0.648 W/kg.

### **FCC Statement**

This equipment has been tested and found to comply with the limits for a Class B digital device, pursuant to Part 15 of the FCC Rules. These limits are designed to provide reasonable protection against harmful interference in a residential installation. This equipment generates, uses and can radiate radio frequency energy and, if not installed and used in accordance with the instructions, may cause harmful interference to radio communications. However, there is no guarantee that interference will not occur in a particular installation. If this equipment does cause harmful interference to radio or television reception, which can be determined by turning the equipment off and on, the user is encouraged to try to correct the interference by one or more of the following measures:

- Reorient or relocate the receiving antenna.
- Increase the separation between the equipment and receiver.

--Connect the equipment into an outlet on a circuit different from that to which the receiver is connected.

--Consult the dealer or an experienced radio/TV technician for help.

This device complies with Part 15 of the FCC Rules. Operation is subject to the following two conditions: (1) this device may not cause harmful interference, and (2) this device must accept any interference received, including interference that may cause undesired operation.

**Caution:**

Changes or modifications made to this device not expressly approved by Huawei Technologies Co., Ltd. may void the FCC authorization to operate this device.