

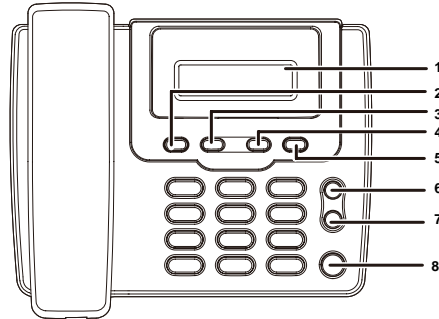



Packing List

The FWT package box contains the following items. Check the items according to the following table. If any of the items is missing or damaged, contact your local dealer.

Item	Quantity	Item	Quantity
Main unit, handset, and coiled cord	1	Battery	1
Power adapter	1	Antenna (optional)	1
FWT User Guide	1	Certificate of Quality	1

Front View of the FWT



No.	Item	Function
1	Display screen	Displays the current operation of the FWT
2	SET/OK key	Set and save various functions
3	RECEIVED/ key	Access Call In in standby mode
4	DIALED/ key	Access Call Out in standby mode
5	CANCEL key	Delete queried information
6	End key 	End or reject a call End the current operation when setting parameters Press and hold it to switch on/off the FWT
7	HAND-FREE key 	Make a call or receive an incoming call without lifting the handset
8	Call/Redial key 	Dial the telephone number on the screen Answer the call when there is an incoming call

Back View and Side View

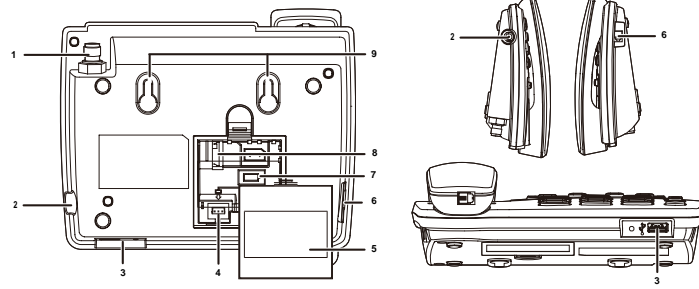

No.	Item	No.	Item
1	Antenna jack	2	Power jack
3	Data port	4	Battery cord jack
5	Battery container cover	6	Coiled cord jack on main unit
7	Battery case	8	UIM card slot
9	Hook		

Screen Icons

NO.	Item	Description
1		Indicates the signal strength. The more the bars are, the stronger the signal is.
2		Indicates that you are in the hands-free mode of the FWT.
3		Indicates that there is an incoming call or a call is ongoing.
4		Indicates that the FWT is powered by the power adapter.
5		Indicates that there is a missed call.
6		Indicates the battery power level.
7	Month/Day/Time	Indicates the current date and time. If the FWT does not find the network, this information is not displayed.
8	Call duration	Indicates the call duration of the current call.
9	Missed calls	Indicates the number of missed calls.

Installing UIM Card (Optional)



Caution:

- Whether an UIM card is needed, consult your service provider for details.
- The UIM card and its golden contact can be easily damaged by scratch or bending. Thus, be careful when installing or removing the UIM card.

After power off the FWT and disconnect the power, install or remove the UIM card. Make sure that the golden contact of the UIM card is facing downwards.

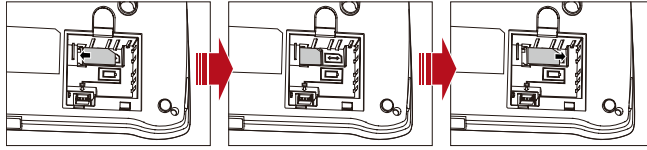

Installing the Battery

Note:

- The FWT can be powered by the power adapter or the battery.
- Before replacing the battery, disconnect the outdoor antenna.
- When the FWT installed with the battery is powered by the power adapter, the battery is auto charged. After the battery is fully charged, the charging stops.
- Before using the battery for the first time, charge the battery for at least eight hours. When the battery is fully charged but not used for a long time, charge it for five minutes before you can use it again normally.

After power off the FWT and disconnect the power, install the battery. When installing the battery, make sure the battery cord plug matches the battery jack. Do not insert conversely.

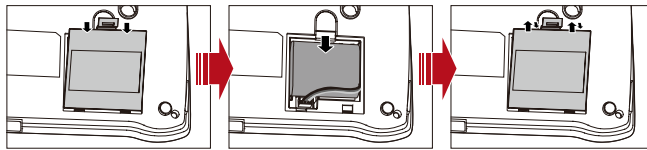

Installing the Antenna

Note:

For details of antenna selection and installation, consult your local dealer.

Power off the FWT. Then connect the indoor antenna with the antenna jack on the main unit. Screw the antenna to make sure that the antenna is tightly connected with the antenna jack.

Placing the FWT

Horizontally

Place the FWT on the flat surface. Select a cool and ventilated site to dissipate heat.

Vertically

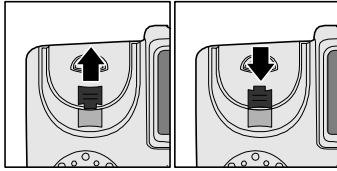

1. Pull out the handset retaining clip from the slot turn it around and then push it back so that the handset will not fall down when the FWT is placed vertically.



2. According to the distance between the two hooks (7.7 cm), hammer two nails into the wall with a 3 mm end left outside.
3. Snap the hooks to the nails.



Validating

You can make a call to check whether the FWT is correctly installed.



1. Press and hold  to power on the FWT. After connecting the FWT with the external power supply, the  icon appears, indicating that the FWT is powered normally.
2. Lift the handset. In standby mode, the signal strength icon appears normally.
3. If you can make a call, it indicates that the FWT is installed correctly.

Making a Call

Method 1:

1. Lift the handset or press .
2. Enter the number. If the number is incorrect, press **CANCEL** key to delete it.
3. Press  to dial the number.
4. After the conversation, put down the handset or press  to end the call.



Method 2:

1. Enter the number you want to dial without lifting the handset or pressing .
2. Press  to change the FWT to the hands-free mode and dial the number.
3. After the conversation, put down the handset or press  to end the call.

Note:

In the standby mode, if there is a missed call, the phone number of the missed call is displayed on the screen. At this time, you can press  to dial the number of the missed call.



Answering a Call

In standby mode, you can lift the handset, press  or press  to answer a call.

Note:

- In standby mode, press  to reject the incoming call.
- Caller ID display function is network dependent. Consult your service provider.

Options During a Call

To switch a call from the handset to the hands-free mode, press , and then put back the handset when the icon  is displayed on the screen. To switch a call from the hands-free mode to the handset, just lift the handset.

Speed Dial

Speed dial number allows you to call a FWT number by pressing one numeric key.

Setting the Speed Dial Function

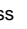
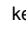
1. Press **SET/OK** key to display the selecting function item **Speed Dial**.
2. Press **SET/OK** key to switch to the modifying or setting status.
3. Press **SET/OK** key to confirm the modifying or setting number.
4. Enter the number, and then press **SET/OK** key to save the record.
5. Press  or  key to browse the phone numbers assigned to different speed dial keys. Repeat step 3 and step 4 to enter or modify the corresponding phone numbers of different speed dial keys.

Dialing the Speed Dial Number

1. In standby mode, press a speed dial number. (Positions 01–09 correspond to numeric keys 1–9).
2. Press  to dial the corresponding phone number assigned to the speed dial number.

Note:

If no phone number is assigned to the numeric key you press, the FWT displays **No Speed Dial**.

Locking Long Distance Call

In the standby mode, you can set and enable this function. When you dial a long distance number, you need to enter the preset long distance lock password.

Setting Long Distance Lock Password

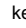
1. Press **SET/OK** key to display the selecting function menu.
2. Press **RECEIVED** key or **DIALED** key until the screen displays **Long Distance**.
3. Press **SET/OK** key to display **Code** inputting interface.
4. Enter the default password (0000) of the FWT. The screen displays the status (**On** or **Off**) of the long distance lock.
5. Press  or  key until the screen displays **On**. Set the long distance lock function. If you want to disable this function, select **Off**.
6. After setting, press **SET/OK** key.

Make a Call When the Long Distance Lock Is Enabled

When the long distance lock is enabled, adopt method 2 of Making a Call. Follow these steps:

1. Enter the long distance number you want to dial.
2. Press  to display code.
3. Enter the password. The FWT switches to the hands-free mode and dials the number.

Modifying the Long Distance Lock Password

1. Press **SET/OK** key to display the selecting function menu.
2. Press **or** key until the screen displays **Code**.
3. Press **SET/OK** key to display **Old Code** inputting interface.
4. Enter the old password (the initial password is 0000). The screen displays **Enter Code**.
5. Enter the new password, and then the screen displays **REnter Code**. Enter the new password again.
6. The new password should be restored automatically if the twice inputting is matched. Otherwise, reenter the new passwords..

Note:

If you forget the long distance lock password, consult the service provider.

Setting Ring Volume

1. Press **SET/OK** key to display the selecting function menu.
2. Press **or** key until the screen displays **Ring Vol**.
3. Press **SET/OK** key to display the items.
4. Press **or** key to select a ring volume.
5. After selecting, press **SET/OK** key.

Setting Ring Type

1. Press **SET/OK** key to display the selecting function menu.
2. Press **or** key until the screen displays **Ring Type**.
3. Press **SET/OK** key to display the items.
4. Press **or** key to select a ring type.
5. After selecting, press **SET/OK** key.

Supplementary Services

Supplementary services, including: Three way calling, Call forwarding.

Supplementary services are network dependent. For details, consult your service provider.

Maintenance

- The FWT should be deployed in a clean and dry environment. A temperature higher than 55°C or lower than –10°C may damage the FWT.
- If the FWT is covered with dust, clean it with a clean fine cloth. Do not clean the FWT with cleanser or other chemical solvents.
- If the battery fails and causes problems of the FWT, replace it or use the power adapter.
- If the FWT does not work properly, consult your service provider.

Troubleshooting

- The display screen keeps OFF after the FWT is turned on (no external power adapter is connected with the FWT).
- Open the battery case to check whether the battery is installed.
- If the battery is installed, it means that the battery is running low. Power on the FWT with a power adapter.

The display screen keeps OFF after the FWT is turned on (an external power adapter is connected with the FWT).

1. It is likely that the voltage output by the power adapter can not meet the requirement of FWT. In this case, you need to check whether the AC input is normal, and whether the power adapter is the one accompanying FWT.
2. It is also likely that the external voltage of the power adapter is lower or unstable, thus causing the case that FWT can not operate normally. In this case, you need to check whether the external voltage of the power adapter is normal, or power on FWT with a battery.

There is no signal indication on the FWT screen

1. Ensure that the antenna is installed properly.
2. If there is still no signal indication, contact the carrier to ensure that the signal covers the area of FWT.

The current time is not displayed on the FWT screen

1. Ensure that the antenna is installed properly.
2. Adjust the antenna of the FWT or move the FWT to the location where the signal can be received easily.
3. If the current time is still not displayed, contact the service provider to check whether the signal covers the area of the FWT.

The screen sometimes displays nothing or displays a power supply icon and a blinking battery icon after the FWT is turned off

It is normal that no information is displayed on the screen when the FWT is powered off. A power supply icon and a blinking battery icon indicate that the FWT battery is being charged.

I hear the ringing tone after hearing the busy tone

The ringing tone indicates that there is an incoming call. If you are not in a conversation, you can answer the call.

I hear the ringing tone when I am ready to dial or dialing a number

The ringing tone indicates that there is an incoming call. If you are not in a conversation, you can answer the call.

When the FWT is powered on, the screen displays invalid card in the standby mode or during a call

The FWT does not match the R-UIM card. Use a compatible R-UIM card. For details, consult the service provider.

After the FWT is powered on, the screen displays no card or Err Card.

The R-UIM card is not inserted properly. Insert a compatible R-UIM card.

After the FWT is powered on, the screen displays loc fail.

The FWT lock function is invalid. Consult the service provider.

The Screen does not display the power adapter icon but only the battery icon

It indicates that the FWT is powered by the battery. When the FWT is powered by the battery (without the power adapter connected), if the battery icon has no indication bar and blinks, the battery is running low. Connect the FWT to the power adapter to charge the battery or change the battery.

Warnings and Precautions

To use HUAWEI Fixed Wireless Terminal (FWT) correctly, efficiently and safely, you should notice following cautions.

Basic Cautions

- Check fittings based on the packing list to make sure they are complete and undamaged.
- Read this manual carefully before installing and using FWT.

Electronic Device

Switch your FWT off near high-precision electronic devices. The FWT may affect the performance of these devices.

Such devices include hearing aids, pacemakers, fire alarm systems, automatic gates, and other automatic-control devices. If you are using an electronic medical device, consult the device manufacturer and confirm whether the radio wave affects the operation of this electronic device.

Hospital

Pay attention to the following points in hospitals or health care facilities:

- Do not take your FWT into the operating room (OR), intensive care unit (ICU), or coronary care unit (CCU).
- Switch your FWT off near medial devices.
- Observe any instructions wherever the use of wireless device is prohibited.

Traffic Safety

- Do not use your FWT while driving. Secure the FWT on its holder. Do not place the FWT on the seat or other places where it can get loose in a sudden stop or collision.
- Observe the rules and regulations of airline companies. Switch your FWT off before boarding an aircraft.

Operating Environment

- Do not place magnetic storage media such as magnetic cards and floppy disks near the FWT. Radiation from the FWT may erase the information stored on them.
- Do not put your FWT, battery, or other accessories in containers with strong magnetic field, such as the induction cooker and microwave oven. Otherwise, circuit failure, fire, or explosion can be caused.
- Do not leave your FWT, battery, or power adapter in a high-temperature place or use them in a place with flammable gas. Otherwise, malfunction of the products, fire, or explosion can be caused.
- Because FWT needs to eliminate heat during working, put the FWT and the power supply in a ventilated and shadowy place. Never airtight the FWT or put something on it or place it near water, fire as well as inflammable and explosive materials.
- Because FWT contains precision devices, you should put it in a dry place and away from moist materials
- Before cleaning FWT, turn off the FWT, and then disconnect the power supply and take out the battery. Before moving FWT, disconnect the external power supply
- Do not subject your FWT, battery, and power adapter to serious collision or shock. Otherwise, battery leakage, FWT malfunction, overheat, fire, or explosion can be caused.
- Do not place sharp metal objects such as pins near the earpiece. The earpiece may attract these objects and hurt you when you are using the FWT.
- Do not place the FWT in the area over the air bag or in the air bag deployment area. Otherwise, the FWT may hurt you owing to the strong force when the air bag inflates.
- When lightning, if you use the power adapter, turn off the FWT and disconnect the power adapter from external power supply. If outdoor antenna is used, turn off the FWT and do not touch the interface between FWT and antenna
- Put your FWT, battery, and power adapter in places beyond the reach of children. Do not allow children to use the FWT, battery, or power adapter without guidance.
- Do not touch the antenna when a call is going on. Touching the antenna may affect call quality and cause the FWT to operate at a power level higher than needed.
- The network signal condition will directly affect the quality and stability of the call. Consequently, you should place FWT in a place where it can receive network signal well. Do not put FWT in a building with an iron or metal roof. The distance between FWT and other metal materials (such as metal brackets or metal doors and windows) should be greater than 25cm and the distance between FWTs should be greater than 30cm.
- Do not open the chassis in any case and the device should be maintained by a qualified maintenance department.
- Without permission, you are not allowed to modify the architecture and security design of FWT. You must bear any consequence resulted from the operation without permission
- Your FWT is designed to conform to the authoritative international radio frequency (RF) specifications. Use FWT accessories approved by Huawei only.

- The antenna(s) used for this transmitter must be installed to provide a separation distance of at least 20cm from all persons.
- Please observe the national local regulations in the location where product is to be used. This product may be restricted for use in some or all countries of European Union.

Emergency Call

You can use your FWT for emergency calls. However, connections in all conditions cannot be guaranteed. You should never rely solely on the FWT for essential communications.

Battery

- If the battery fluid gets into eyes, do not rub them. Wash with clean water and seek medical assistance immediately.
- If the battery fluid contacts skin or cloth, wash with clean water immediately to avoid irritation to the skin.
- Do not dispose of the battery in fire. Otherwise, the battery may ignite or explode.
- When installing the battery on your FWT, do not push the battery by force lest battery fluid leak out or the battery crack.
- Do not connect two poles of the battery with metallic materials such as cables.
- Do not disassemble the battery or solder the battery poles. Otherwise fluid leakage, overheat, fire, or explosion can be caused.
- If there is battery leakage, smoke, or strange smell, stop using the battery and keep it away from open flame to avoid fire or explosion.
- Disconnect the power adapter and take out the battery when FWT is not used for a long time.
- Do not select its self-contained complete battery and power adapter, otherwise, FWT may be spoiled. Dispose of used batteries according to the instructions
- Dispose of the battery according to local laws or regulations.

Power Adapter

- Use AC power as specified for the power adapter. Any violation of this rule can be caused in fire or malfunction of the power adapter.
- Do not short-circuit the power adapter. Short-circuiting the power adapter may cause fire or malfunction of the power adapter.
- Remove the dust on the power plug regularly.
- Do not use worn-out power cords. Otherwise, electric shock, short-circuiting of the power adapter, or fire can be caused.
- Do not put the power adapter near the container filled with liquid such as water. If the liquid comes into the power adapter, electrical leakage or other faults can be caused.
- If the liquid such as water comes into the power adapter accidentally, remove the plug of the power adapter from the socket immediately.
- Disconnect the power adapter from the socket before cleaning or maintaining it. Otherwise, electric shock or short-circuiting of the battery or power adapter can be caused.
- Ensure the plug of the power adapter is properly inserted into the power socket when charging the battery. Improper insertion can be caused in electric shock, fire, or explosion.
- Do not place any heavy object on the power cord of the power adapter. Do not damage, change, or pluck the power cord.

Using the USB Cable

To use the USB cable, you need operate abiding strictly by the following rules. Otherwise, your FWT or PC may be damaged:

- To connect your FWT and PC with the USB cable, connect to the FWT at first, and then connect to the PC.
- In the process of communication between your FWT and PC, it is strictly forbidden to plug or pull out the USB cable.
- To disconnect your FWT and PC from the USB cable, disconnect from the PC at first, and then disconnect from the FWT.

Environmental Protection

Abide by the local laws in proposing of the package materials of your handset, consumed batteries and used handsets, and try to recycle them.

FCC Statement:

This device complies with Part 15 of the FCC Rules. Operation is subject to the following two conditions: (1) this device may not cause harmful interference, and (2) this device must accept any interference received, including interference that may cause undesired operation.

Huawei Technologies Co., Ltd.

Address: Huawei Industrial Base, Bantian, Longgang, Shenzhen 518129, People's Republic of China

Website: <http://www.huawei.com>

Copyright © 2008 Huawei Technologies Co., Ltd.

All Rights Reserved. No part of this manual may be reproduced or transmitted in any form or by any means without prior written consent of Huawei Technologies Co., Ltd.



and HUAWEI are trademarks of Huawei Technologies Co., Ltd. All other trademarks mentioned in this manual are the property of their respective holders

Please refer color and shape to product. Huawei reserves the right to make changes or improvements to any of the products without prior notice.

The information in this manual is subject to change without notice. Every effort has been made in the preparation of this manual to ensure accuracy of the contents, but all statements, information, and recommendations in this manual do not constitute the warranty of any kind, expressed or implied.

Version: V100R001_01 Part Number: 31019359