

What is in Your Box

- Mobile phone
- Charger
- USB cable
- Battery
- Headset
- Quick Start Guide
- Safety Information

Phone at a Glance

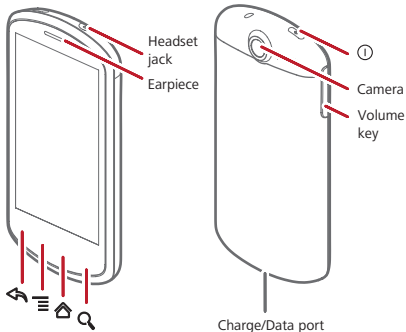

■ Note:

If you apply protective film on the phone, please use the protective film with good transmittance.

Key Functions at Your Fingertips

- ①
 - Press to power on your mobile phone.
 - Press and hold to open the **Phone options** menu.
 - Press to lock the screen when your mobile phone is active.
-

- ↶
 - Touch to return to the previous screen.
 - Touch to exit any application you are running.
 - Touch to hide the keyboard.
-

- ☰ Touch to open the menu on an active screen.
-

- 🏠
 - Touch to return to the Home screen.
 - Touch and hold to show the most recently used applications.
-

- 🔍
 - Touch to open Google search for searching your mobile phone and the web.
 - Touch and hold to open Google search by voice.
-

Installing the SIM Card

1



2

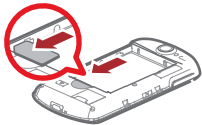

Installing the microSD Card (Optional)

Your mobile phone is already equipped with a large-volume built-in eMMC card. If you want to expand your phone memory, you can also insert a microSD card.

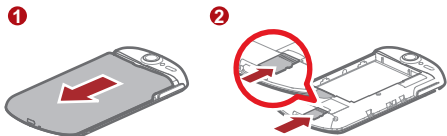

Installing the Battery

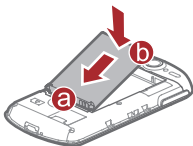

Charging the Battery

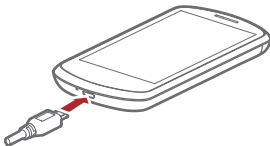

If your mobile phone is charged when it is powered on, the battery icon on the Notification bar shows the charging status. When the

battery icon changes to , it indicates that your mobile phone is fully charged.

Status Indicator

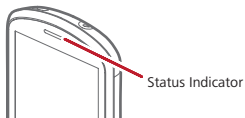

Green: Fully charged (when connected to charger).

Orange: Charging in progress (when connected to charger).

Red: Battery low.

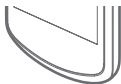

Powering On Your Mobile Phone

Press . The first time you power on your phone, you will be asked to sign in to your account and set up your mobile phone.

Powering Off Your Mobile Phone

1. Press and hold  to open the **Phone options** menu.
2. Touch **Power off**.
3. Touch **OK**.

Home Screen

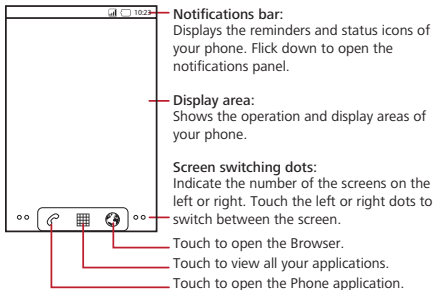

Viewing Other Parts of the Home Screen

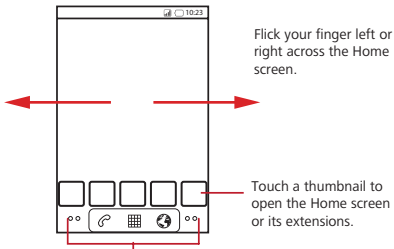

Touch and hold the small dots to view thumbnails of the Home screen and its extensions.

Adding a New Screen Item

1. Touch and hold a blank area on the Home screen until the **Add to Home screen** menu is displayed.
2. Select an item to add it to the Home screen.

Changing the Wallpaper

1. On the Home screen, touch  > **Wallpaper**.
2. Do any of the following:
 - Touch **Live wallpapers** to select a picture and set it as the wallpaper.
 - Touch **Gallery** to select a picture and set it as the wallpaper.
 - Touch **Wallpapers** to select a picture and set it as the wallpaper.

Locking the Screen



- When your mobile phone is on, press  to lock the screen. When the screen is locked, you can still receive messages and calls.
- If your mobile is idle for a while, the screen will lock automatically.

Unlocking the Screen

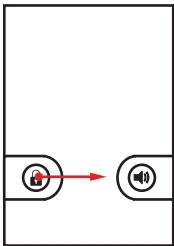

1. Press  to wake up the screen.
2. Drag the lock icon from left to right to unlock the screen.



Importing Contacts from a SIM Card

1. In the contact list, touch  > **Import/Export**.
2. Touch **Import from SIM card**.
3. If you have more than one account on your phone, touch the account into which you want to import the contacts.
4. Wait for the SIM card contents to be loaded. Select the contacts you want to import or touch  > **Import all** to import all contacts.

Making a Call with the Phone Application

1. Touch  > **Phone** to display the dialer.
2. Touch the appropriate numeric keys to enter the phone number.
3. Touch  to initiate the call.

Answering an Incoming Call

Drag the  to the right to answer the call.

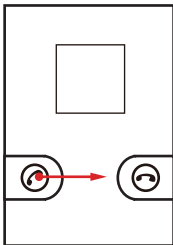



Choosing an Input Method

1. Touch and hold the space where you enter your text until the **Edit text** menu is displayed.
2. Touch **Input method**.
3. Select the input method.

The keyboard panel will be displayed automatically.

Creating and Sending a Multimedia Message

1. Touch  > **Messaging** > **New message**.
2. Enter a phone number in the **To** field.
3. Touch the composition text box to start entering your message.
4. Touch  to display the options panel.
 - Touch **Add subject** to add the message subject. Your mobile phone is now in multimedia message mode.
 - Touch **Attach** to add a picture, music, or video file.
5. When the message is ready to be sent, touch **Send**.

Turning on the Data Service

1. Touch  > **Settings**.
2. Touch **Wireless & networks** > **Mobile networks**.
3. Select the **Data enabled** check box to turn on the data connection.

Turning On Wi-Fi

1. Touch  > **Settings**.
2. Touch **Wireless & networks**, and then select the **Wi-Fi** check box to turn on Wi-Fi.

Sharing Your Phone's Data Connection via USB



To use USB tethering in different operating systems, you may need to prepare your computer to establish a network connection via USB.

■ Note:

You can not share your mobile phone's data connection and SD card via USB at the same time.

1. Touch  > **Settings**.
2. Touch **Wireless & networks** > **Tethering**.
3. Select the **USB tethering** check box to share your data connection.

Opening Your Camera

- Touch  > **Camera** to open the camera. The camera opens in landscape mode, ready to take a picture or record a video.
- Touch  to close the camera.

Capture Screen

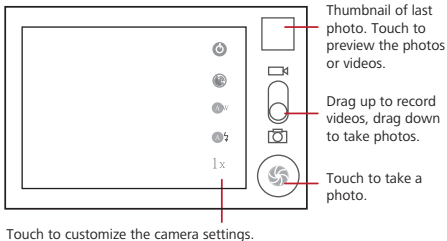

Using the microSD Card as USB Mass Storage

1. Connect your mobile phone to your PC with the USB cable. Your PC will detect the microSD card as a removable disk.
2. Open the notification bar, and then touch **USB connected**.
3. Touch **Turn on USB storage** in the dialog box that opens to confirm that you want to transfer files.

You can now transfer files from your PC to your mobile phone's microSD card.

Warnings and Precautions

Operating Environment

- The device complies with the RF specifications when the device is used near your ear or at a distance of 1.5 cm from your body. Ensure that the device accessories such as a device case and a device holster are not composed of metal components. Keep

your device 1.5 cm away from your body to meet the requirement earlier mentioned.

- While using the device, observe the local laws and regulations, and respect others' privacy and legal rights.
- Keep the ambient temperature between -10°C and 45°C while the device is being charged. Keep the ambient temperature between -10°C to 55°C for using the device powered by a battery.

Certification Information (SAR)

This device meets guidelines for exposure to radio waves.

Your device is a low-power radio transmitter and receiver. As recommended by international guidelines, the device is designed not to exceed the limits for exposure to radio waves. These guidelines were developed by the independent scientific organization International Commission on Non-Ionizing Radiation Protection (ICNIRP) and include safety measures designed to ensure safety for all users, regardless of age and health.

The Specific Absorption Rate (SAR) is the unit of measurement for the amount of radio frequency energy absorbed by the body when using a device. The SAR value is determined at the highest certified power level in laboratory conditions, but the actual SAR level of the device when being operated can be well below the value. This is because the device is designed to use the minimum power required to reach the network.

The SAR limit adopted by USA and Canada is 1.6 watts/kilogram (W/kg) averaged over one gram of tissue. The highest SAR value reported to the FCC and IC for this device type when tested for use at the ear is 0.34 W/kg, and when properly worn on the body is 0.79 W/kg.

The SAR limit also adopted by Europe is 2.0 W/kg averaged over 10 grams of tissue. The highest SAR value for this device type when

tested at the ear is 0.342 W/kg, and when properly worn on the body is 0.536 W/kg.

FCC Statement

This equipment has been tested and found to comply with the limits for a Class B digital device, pursuant to Part 15 of the FCC Rules. These limits are designed to provide reasonable protection against harmful interference in a residential installation. This equipment generates, uses and can radiate radio frequency energy and, if not installed and used in accordance with the instructions, may cause harmful interference to radio communications. However, there is no guarantee that interference will not occur in a particular installation. If this equipment does cause harmful interference to radio or television reception, which can be determined by turning the equipment off and on, the user is encouraged to try to correct the interference by one or more of the following measures:

- Reorient or relocate the receiving antenna.
- Increase the separation between the equipment and receiver.
- Connect the equipment into an outlet on a circuit different from that to which the receiver is connected.
- Consult the dealer or an experienced radio/TV technician for help.

This device complies with Part 15 of the FCC Rules. Operation is subject to the following two conditions: (1) this device may not cause harmful interference, and (2) this device must accept any interference received, including interference that may cause undesired operation.



Caution

Changes or modifications made to this device not expressly approved by Huawei Technologies Co., Ltd. may void the FCC authorization to operate this device.

Disposal and Recycling Information



This symbol on the device (and any included batteries) indicates that they should not be disposed of as normal household garbage. Do not dispose of your device or batteries as unsorted municipal waste. The device (and any batteries) should be handed over to a certified collection point for recycling or proper disposal at the end of their life.

For more detailed information about the recycling of the device or batteries, contact your local city office, the household waste disposal service, or the retail store where you purchased this device.

The disposal of this device is subject to the Waste from Electrical and Electronic Equipment (WEEE) directive of the European Union. The reason for separating WEEE and batteries from other waste is to minimize the potential environmental impacts on human health of any hazardous substances that may be present.

Reduction of Hazardous Substances

This device is compliant with the EU Registration, Evaluation, Authorisation and Restriction of Chemicals (REACH) Regulation (Regulation No 1907/2006/EC of the European Parliament and of the Council) and the EU Restriction of Hazardous Substances (RoHS) Directive (Directive 2002/95/EC of the European Parliament and of the Council). For more information about the REACH compliance of the device, visit the Web site

www.huaweidevice.com/certification. You are recommended to visit the Web site regularly for up-to-date information.

EU Regulatory Conformance

Hereby, Huawei Technologies Co., Ltd. declares that this device is in compliance with the essential requirements and other relevant provisions of Directive 1999/5/EC.

For the declaration of conformity, visit the Web site www.huaweidevice.com/certification.

CE 0682 Ⓢ

■ Note:

Observe the national local regulations in the location where the device is to be used. This device may be restricted for use in some or all member states of the European Union (EU).

■ Note:

This device may be operated in all member states of the EU.

France: Outdoor use limited to 10 mW e.i.r.p. within the band 2454-2483.5 MHz.

Italy: For private use, a general authorisation is required if WAS/ RLAN's are used outside own premises. For public use, a general authorisation is required.

Luxembourg: General authorisation required for network and service supply.

Norway: This subsection does not apply for the geographical area within a radius of 20 km from the centre of Ny-Ålesund.

FAQ

How do I prevent automatic switching of orientation when rotating phone?

Touch  > **Settings** > **Display** > **Auto-rotate screen** to disable the function.

How do I set the unlock pattern?

Touch  > **Settings** > **Location & security** > **Set up screen lock** > **Pattern**.

How can I change the keyboard mode?

Touch and hold the area where you write text and then select the input method you prefer.

How do I stop the song playing in the background?

Touch the notification bar, flick downwards to open the notifications panel, and then touch the music playing notification to go to the music playing screen.

How do I return to the calling screen?

While on a call, if you're on another screen, you can touch the notification bar, and drag downwards to open the notifications panel. Then touch the current call notification to return to the calling screen.

How do I create an application shortcut on the Home screen?

Touch and hold an application icon on the main menu screen until the Home screen is displayed. Then drag the icon where you want it to go and release your finger.

How do I hide the keyboard?

Touch  to hide the keyboard.