



Copyright © Huawei Technologies Co., Ltd. 2012. All rights reserved.

Trademarks and Permissions

 ,  and **HUAWEI** are trademarks or registered trademarks of Huawei Technologies Co., Ltd.

Manufactured under license from Dolby Laboratories.
Dolby and the double-D symbol are trademarks of Dolby Laboratories.

Android is a trademark of Google Inc.

DISCLAIMER OF WARRANTIES

THE CONTENTS OF THIS MANUAL ARE PROVIDED "AS IS". EXCEPT AS REQUIRED BY APPLICABLE LAWS, NO WARRANTIES OF ANY KIND, EITHER EXPRESS OR IMPLIED, INCLUDING BUT NOT LIMITED TO, THE IMPLIED WARRANTIES OF MERCHANTABILITY AND FITNESS FOR A PARTICULAR PURPOSE, ARE MADE IN RELATION TO THE ACCURACY, RELIABILITY OR CONTENTS OF THIS MANUAL.

LIMITATIONS OF LIABILITY

TO THE MAXIMUM EXTENT PERMITTED BY APPLICABLE LAW, IN NO EVENT SHALL HUAWEI TECHNOLOGIES CO., LTD. BE LIABLE FOR ANY SPECIAL, INCIDENTAL, INDIRECT, OR CONSEQUENTIAL DAMAGES, OR LOST PROFITS, BUSINESS, REVENUE, DATA, GOODWILL OR ANTICIPATED SAVINGS.

Getting to Know Your Phone



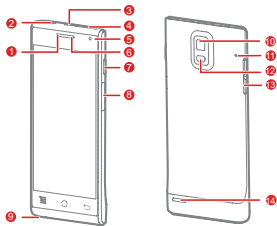

Figures in this guide are provided for your reference only. Depending on the software version, your phone's user interface may be different from the user interface shown in the figures.



1 Earpiece

2 Headset jack

- | | | | |
|----|---|----|-------------------|
| 3 | Charger jack/USB port | 4 | USIM card slot |
| 5 | Secondary camera | 6 | Status indicator |
| 7 |  Power key | 8 | microSD card slot |
| 9 | Microphone | 10 | Camera |
| 11 | Noise reduction microphone | 12 | Flash unit |
| 13 | Volume keys | 14 | Speaker |

-
- Press and hold to power on your phone.
 - Press and hold to display the options menu from where you can power off the phone and perform some shortcut operations.
- 
- Press to lock the screen when your phone is active.
 - Press and hold for 10 or more seconds to forcibly power off the phone.



-
- Touch to return to the previous screen.
 - Touch to exit the current application.



-
- Touch to return to the Home screen.



-
- Touch to display the current screen's options menu (some screens have no menu).
-

Installing SIM and microSD Cards

Install the USIM card or microSD card as shown in the following diagram. Power off your phone before installation.

1 Install a USIM card

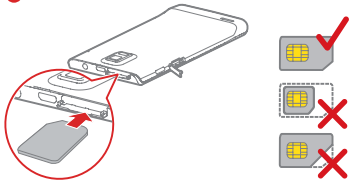

Standard USIM card dimensions:
25mmx15mmx0.76mm(DxWxH)

2 Install a microSD card

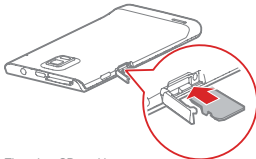

The micro SD card is
an optional accessory



- Your phone supports only standard USIM cards. Using a non-standard USIM card may cause damage to your phone.
- Do not install or remove a USIM card when your phone is powered on.

Charging Your Phone



Your mobile phone has an internal rechargeable battery. Do not attempt to open the battery cover and replace the battery by yourself. To replace the battery, contact Huawei or an authorized service provider.

When charging your phone while it is powered on, the battery is fully charged when the battery icon changes to .



Use the charger provided with your phone. If the phone has not been used for a long time or if the battery charge is fully depleted, the phone may not power on immediately after the charger is plugged in. Please charge the battery for a while before attempting to power on the phone.

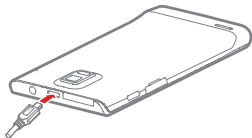

Battery status indicator



Steady green: The phone is charging and the battery level is high or full.

Steady yellow: The phone is charging and the battery level is higher than 10%.

Steady red: The phone is charging and the battery level is low.

Blinking red: The battery level is low and the phone needs to be charged.



Powering Your Phone On or Off

Powering Your Phone On

Press and hold the  key to power on your phone. If this is the first time you have powered on the phone, configure its initial settings. If your SIM card is PIN-protected, enter the personal identification number (PIN) to use the phone.

Powering Your Phone Off

Press and hold the Power key to display the options menu, and touch "**Power off**" to power your phone off.



If your phone malfunctions or cannot be properly powered off, press and hold the Power key for at least 10 seconds to forcibly power off your phone.

Using the Touchscreen

Touch: Touch the screen to select an option or start an application.



Touch and hold: Touch and hold the screen or text being edited to display the available options menu.



Slide: Quickly drag your finger across the screen vertically or horizontally.



Drag: Touch and hold an item, and then drag it to the desired location on the screen. For example, on the Home screen, you can move an icon by dragging it to another location or remove an icon by dragging it to the trash can.



Finding the User Guide

For more information about how to use your phone, please read the user guide. You can find the user guide by visiting the Web site: <http://www.huaweidevice.com/worldwide>.

Operating Environment

- The device complies with the RF specifications when the device is used near your ear or at a distance of 1.5 cm from your body. Ensure that the device accessories such as a device case and a device holster are not composed of metal components. Keep your device 1.5 cm away from your body to meet the requirement earlier mentioned.
- Keep the ambient temperature between -10°C and 45°C while the device is being charged. Keep the ambient temperature between -10°C to 45°C for using the device powered by a battery.

Certification Information (SAR)

This device meets guidelines for exposure to radio waves.

Your device is a low-power radio transmitter and receiver. As recommended by international guidelines, the device is designed not to exceed the limits for exposure to radio waves. These guidelines were developed by the independent scientific organization International Commission on Non-ionizing Radiation Protection (ICNIRP) and include safety measures designed to ensure safety for all users, regardless of age and health.

The Specific Absorption Rate (SAR) is the unit of measurement for the amount of radio frequency energy absorbed by the body when using a device. The SAR value is determined at the highest certified power level in laboratory conditions, but the actual SAR level of the device when being operated can be well below the value. This is because the device is designed to use the minimum power required to reach the network.

The SAR limit adopted by USA and Canada is 1.6 watts/kilogram (W/kg) averaged over one gram of tissue. The

Highest SAR value reported to the FCC and IC for this device type when tested for use at the ear is 0.745 W/kg, when properly worn on body is 1.020 W/kg, and when using Wi-Fi hotspot function is 1.290 W/kg.

The SAR limit also adopted by Europe is 2.0 W/kg averaged over 10 grams of tissue. The highest SAR value for this device type when tested at the ear is 0.573 W/kg, and when properly worn on the body is 0.540 W/kg.